



Rogers

Assessment Property Record Card for Tax Year 2026

Data provided by LISA DELOZIER County Assessor

Date 04/18/2026
Time 07:04:04
Page 1

Assessment Data					Primary Image														
Account 660013489 Parcel ID 23N16E-13-2-00000-000-0000 Cadastral ID 13-23-16-01000 Property Type REAL - Real Property Property Class RR VI Area 2 Tax Area 71 - CHELSEA RURAL/FOYIL FIRE Name ID 339171 HUMPHREYS, NATHAN DANIEL 9101 S 4180 RD CLAREMORE OK 74017-0000 Parcel Location Situs 09101 S 4180 RD Subdivision Lot/Block / Parcel Size 10 - Acres Sec/Twn/Rng 13 / 23 / 16 / 2 Neighborhood 4050 - CHELSEA FOYIL RURAL School District S003 - CHELSEA SCHOOLS					<p>\\tsclient\C\Users\Randy Necessary\Pictures\IMG_0005 (11).JPG 1/13/2021</p>														
Legal Description Lat/Long: 36.48053356 -95.56011707																			
NW NW NW					Building Permits <table border="1"> <thead> <tr> <th>Number</th> <th>Description</th> <th>Opened</th> <th>Closed</th> <th>Amount</th> </tr> </thead> <tbody> <tr> <td> </td> <td> </td> <td> </td> <td> </td> <td> </td> </tr> </tbody> </table>					Number	Description	Opened	Closed	Amount					
Number	Description	Opened	Closed	Amount															
Exemptions					Sale History														
Code	Type	Active	Maximum	Exemption	Bk/Pg	Grantor	Date	Price	Code										
HV	Veteran	Yes	999,999	26,784	/	MCCALL, JASON L &	07/22/2022	269,000	WG										
					2172/791	SHADDIX, STEVE &	05/06/2011	130,000	YES										
					1928/50	LAIRD, BRIAN D & TROYE	01/18/2008	130,000	YES										
					1169/165	WALKER, JOHNNY DALE	05/04/1999	22,500	Yes										
Parcel Valuation																			
Source	REAL		Fair Cash	Capped	Asmnt Level	Assessed	Levy Rate	95.740	Current Tax										
Remove Cap	2023		Land Value	124,288	124,288	11%	13,672	Assessed	26,784 2,564.30										
Year Frozen	0		Improvements	119,202	119,202		13,112	Penalty	0										
Uncapped Value	0		Mobile Home	0	0		0	Exemption	26,784 -2,216.00										
TIF Project ID	0		Total Value	243,490	243,490		26,784	Total Taxable	0 348.00										
Assessment History																			
Tax Year	Statement Number	Billed Owner			Tax Area	Total Value	Exemptions	Taxable Value	Billed Tax										
2025	2025-660013489	HUMPHREYS, NATHAN DANIEL			71	276,997	30470		396.00										
2024	2024-660013489	HUMPHREYS, NATHAN DANIEL			71	269,000	29590		390.00										
2023	2023-660013489	HUMPHREYS, NATHAN DANIEL &			71	269,000	1000	28,591	2,833.00										
2022	2022-660013489	HUMPHREYS, NATHAN DANIEL &			71	124,467	1000	12,692	1,272.00										
2021	2021-660013489	MCCALL, JASON L &			71	131,368	1000	13,451	1,358.00										
2020	2020-660013489	MCCALL, JASON L &			71	130,827	1000	13,157	1,343.00										
2019	2019-660013489	MCCALL, JASON L &			71	124,949	1000	12,745	1,323.00										
2018	2018-660013489	MCCALL, JASON L &			71	129,795	1000	12,987	1,333.00										
2017	2017-660013489	MCCALL, JASON L &			71	128,843	1000	12,580	1,306.00										
2016	2016-660013489	MCCALL, JASON L &			71	122,255	1000	12,184	1,285.00										
2015	2015-660013489	MCCALL, JASON L &			71	116,363	1000	11,800	1,229.00										
2014	2014-660013489	MCCALL, JASON L &			71	114,994	1000	11,649	1,252.00										
2013	2013-660013489	MCCALL, JASON L &			71	111,871	1000	11,306	1,199.00										



Rogers

Assessment Property Record Card for Tax Year 2026

Data provided by LISA DELOZIER County Assessor

Date 04/18/2026
 Time 07:04:05
 Page 2

Lot Data		Square-Foot - NBHD 4050 #1		Primary Image				
Lot Size				 <p>\\tsclient\C\Documents and Settings\RLN.ROGERSCOUNTY\My D 8/16/2012</p>				
Lot Count								
Units Buildable	10							
Non-Ag Acres	0							
Topography								
Street Access								
Utilities								
Amenities	LAND QUALITY	0						
		0						
Method	Square-Foot							
Base Lot Value	431,622.00 x .26 = 113,170							
Factor Value								
Adjustments	1.0982							
Lot Value	124,288							
Residential Data				GRM Approach				
Type				GRM Code				
Condition	-			Gross Rent	0.00			
Quality	-			Indicated Value				
Architecture				Multiple Regression				
Style				MRA Code				
Exterior Wall				Adusted R				
Base/Total Area /				Indicated Value				
Style				Direct Comparables				
HVAC				Selection Model	1 Res			
Roof Cover				Adjustment Model	A2 AO Test			
Area on Slab				Comparables				
Fixture/RghIn /				Indicated Value				
Bed/F/H Bath / /				Value Reconciliation				
Basement Area				Selected Approach	Cost Approach			
Garage Type				Improvements				
Remodel				Lot Value	124,288			
Year/Eff Age /				Indicated Value	124,288 0.00 Per SqFt			
				Agland Value				
				Site Improvements	40,491			
				Total Value	164,779 0.00 Total Value Per SqFt			
Cost Approach				Manual : 01/2025				
Base Cost	0.00	Total Misc Impr	+	0				
Roofing Adj	+ 0.00	Garage Cost	+					
Subfloor Adj	+ 0.00	Total RCN	=	0				
Heat/Cool Adj	+ 0.00	Depreciation (0%)	-	0				
Plumbing Adj	+ 0.00	Lump Sums	+	0				
Basement Adj	+ 0.00	RCNLD	=					
Adj Base Cost	= 0.00	Lot Value	+	124,288				
Total Area	x	Indicated Value	=	124,288				
Adjusted Cost	= 0	Value Per SqFt		0.00				
Miscellaneous Improvements								
Code	Description	Sketch ID	Size	Year	Units	Unit Cost	Depr	Value



Rogers



Assessment Property Record Card for Tax Year 2026

Data provided by LISA DELOZIER County Assessor

Date 04/18/2026
 Time 07:04:05
 Page 3

660013489

Outbuildings/Site Improvements

Building Image	Code	Description	Dimensions	Floor	Roofing	Total Units	
	UTIL	SHOP BUILDING	30x40x10	Concrete	Formed Metal	1,200	
	Qual	3	Cond 3	Year 2010	Eff Age 12		
	Valuation Summary		Modifier Total	RCN	Depr (25% Phys/ % Func)		RCNLD
	Base Cost (30.80 x 1,200)		36,960		36,960	9,240	27,720
	BNGP	Barn - General Purpose	20x30x8	Concrete	Formed Metal	600	
	Qual	3	Cond 3	Year 2010	Eff Age 12		
	Valuation Summary		Modifier Total	RCN	Depr (25% Phys/ % Func)		RCNLD
	Base Cost (25.71 x 600)		15,426		15,426	3,857	11,569
	LOAF	LOAFING SHED	8x14x8	Dirt	Formed Metal	112	
	Qual	3	Cond 3	Year 2010	Eff Age 12		
	Valuation Summary		Modifier Total	RCN	Depr (46% Phys/ % Func)		RCNLD
	Base Cost (7.12 x 112)		797		797	367	430
	LOAF	Loafing Shed	23x12x8	Dirt	Formed Metal	276	
	Qual	3	Cond 3	Year 2000	Eff Age 20		
	Valuation Summary		Modifier Total	RCN	Depr (59% Phys/ % Func)		RCNLD
	Base Cost (6.82 x 276)		1,882		1,882	1,110	772



Rogers

Assessment Property Record Card for Tax Year 2026

Data provided by LISA DELOZIER County Assessor

Date 04/18/2026
 Time 07:04:05
 Page 4

Lot Data	Primary Image
Lot Size Lot Count Units Buildable Non-Ag Acres Topography Street Access Utilities Amenities LAND QUALITY Method Base Lot Value Factor Value Adjustments Lot Value	

Residential Data	
Type	6 Mobile Home 60 x 28
Condition	4 - Good
Quality	4 - Good
Architecture	1DW EXCP DWIDE MH
Style	100% Double Wide
Exterior Wall	100% Frame, Siding, Vinyl
Base/Total Area	1,680 / 1,680
Style	100% Double Wide
HVAC	100% Warmed & Cooled Air
Roof Cover	1 Composition Shingle
Area on Slab	0
Fixture/RghIn	/
Bed/F/H Bath	3 / 2.0 /
Basement Area	
Garage Type	
Remodel	
Year/Eff Age	2000 / 16

\\tsclient\C\Users\Randy Necessary\Pictures\IMG_0005 (11).JPG 1/13/2021
--

GRM Approach	
GRM Code	
Gross Rent	0.00
Indicated Value	

Multiple Regression	
MRA Code	
Adusted R	
Indicated Value	

Direct Comparables	
Selection Model	1 Res
Adjustment Model	A2 AO Test
Comparables	
Indicated Value	

Value Reconciliation			
Selected Approach	Cost Approach		
Improvements	78,711		
Lot Value			
Indicated Value	78,711	46.85	Per SqFt
Agland Value			
Site Improvements			
Total Value	78,711	46.85	Total Value Per SqFt

Cost Approach				Manual : 01/2025			
Base Cost	73.06	Total Misc Impr	+	0			
Roofing Adj	+ 3.53	Garage Cost	+				
Subfloor Adj	+ 0.00	Total RCN	=	149,117			
Heat/Cool Adj	+ 3.53	Depreciation (51%)	-	76,050			
Plumbing Adj	+ 8.64	Lump Sums	+	5,644			
Basement Adj	+ 0.00	RCNLD	=	78,711			
Adj Base Cost	= 88.76	Lot Value	+				
Total Area	x 1,680	Indicated Value	=	78,711			
Adjusted Cost	= 149,117	Value Per SqFt		46.85			

Miscellaneous Improvements								
Code	Description	Sketch ID	Size	Year	Units	Unit Cost	Depr	Value
WODO	WOOD DECK - OPEN	124169	20x10		200	27.63	50%	2,763
WODO	WOOD DECK - OPEN	124170	217		217	26.55	50%	2,881



Rogers

Assessment Property Record Card for Tax Year 2026

Data provided by LISA DELOZIER County Assessor

Date 04/18/2026

Time 07:04:05

Page 5

Sketch Image

660013489

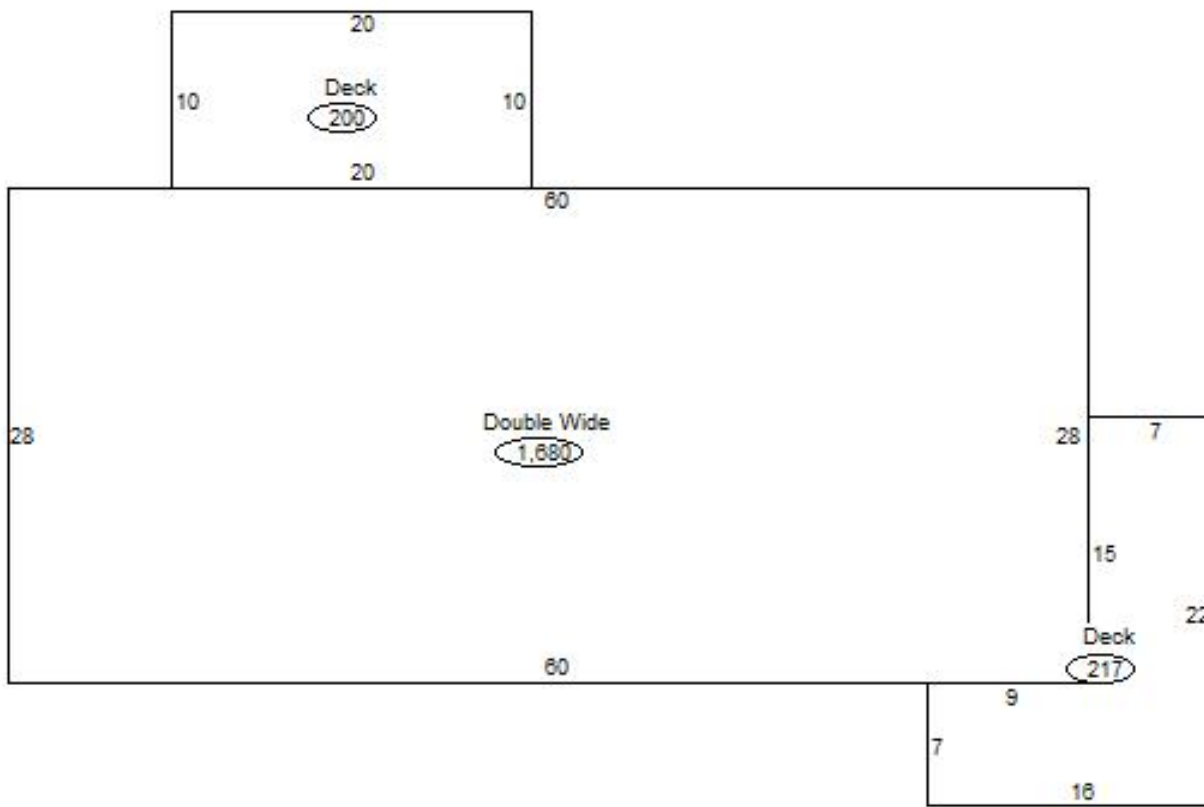

Sketch Vector Information

Sequence	Code	Type	Built Over	Scale	Section Label	Base Area	Multiplier	Total Area
1	R	14		13	Double Wide	1,680	1.000	1,680
2	M	WODO		13	WODO	200	1.000	200
3	M	WODO		13	WODO	217	1.000	217
Total Building Area						1,680		1,680