



Rogers

Assessment Property Record Card for Tax Year 2026

Data provided by LISA DELOZIER County Assessor

Date 04/17/2026
 Time 06:29:15
 Page 1

Assessment Data					Primary Image																																																																																																																				
Account 660013565 Parcel ID 24N16E-13-1-00000-000-0000 Cadastral ID 13-24-16-02500 Property Type REAL - Real Property Property Class RA VI Area 2 Tax Area 14 - CHELSEA RURAL Name ID 258536 COX, HENRY ALLEN & CAROL JOYCE & PAULA JO ANDERSON & JEFF RAY BURNETT 3400 S 4190 RD CHELSEA OK 74016-0000																																																																																																																									
Parcel Location Situs 03400 S 4190 RD Subdivision Lot/Block / Parcel Size 20 - Acres Sec/Twn/Rng 13 / 24 / 16 / 1 Neighborhood 4050 - CHELSEA FOYIL RURAL School District S003 - CHELSEA SCHOOLS																																																																																																																									
Legal Description Lat/Long: 36.56212315 -95.54543606					Building Permits <table border="1"> <thead> <tr> <th>Number</th> <th>Description</th> <th>Opened</th> <th>Closed</th> <th>Amount</th> </tr> </thead> <tbody> <tr> <td colspan="5" style="height: 100px;"> </td> </tr> </tbody> </table>					Number	Description	Opened	Closed	Amount																																																																																																											
Number	Description	Opened	Closed	Amount																																																																																																																					
Exemptions <table border="1"> <thead> <tr> <th>Code</th> <th>Type</th> <th>Active</th> <th>Maximum</th> <th>Exemption</th> </tr> </thead> <tbody> <tr> <td>H</td> <td>Homestead</td> <td>Yes</td> <td>1,000</td> <td>1,000</td> </tr> </tbody> </table>					Code	Type	Active	Maximum	Exemption	H	Homestead	Yes	1,000	1,000	Sale History <table border="1"> <thead> <tr> <th>Bk/Pg</th> <th>Grantor</th> <th>Date</th> <th>Price</th> <th>Code</th> </tr> </thead> <tbody> <tr> <td>956/592</td> <td>MADISON, LAWRENCE &</td> <td>05/10/1994</td> <td>38,000</td> <td>Yes</td> </tr> <tr> <td>829/514</td> <td></td> <td></td> <td>39,500</td> <td>No</td> </tr> </tbody> </table>					Bk/Pg	Grantor	Date	Price	Code	956/592	MADISON, LAWRENCE &	05/10/1994	38,000	Yes	829/514			39,500	No																																																																																							
Code	Type	Active	Maximum	Exemption																																																																																																																					
H	Homestead	Yes	1,000	1,000																																																																																																																					
Bk/Pg	Grantor	Date	Price	Code																																																																																																																					
956/592	MADISON, LAWRENCE &	05/10/1994	38,000	Yes																																																																																																																					
829/514			39,500	No																																																																																																																					
Parcel Valuation <table border="1"> <thead> <tr> <th>Source</th> <th>REAL</th> <th>Fair Cash</th> <th>Capped</th> <th>Asmnt Level</th> <th>Assessed</th> <th>Levy Rate</th> <th>82.750</th> <th>Current Tax</th> </tr> </thead> <tbody> <tr> <td>Remove Cap</td> <td>0</td> <td>Land Value 4,480</td> <td>3,907</td> <td>11%</td> <td>430</td> <td>Assessed</td> <td>6,908</td> <td>571.64</td> </tr> <tr> <td>Year Frozen</td> <td>2018</td> <td>Improvements 67,531</td> <td>58,892</td> <td></td> <td>6,478</td> <td>Penalty</td> <td>0</td> <td></td> </tr> <tr> <td>Uncapped Value</td> <td>0</td> <td>Mobile Home 0</td> <td>0</td> <td></td> <td>0</td> <td>Exemption</td> <td>1,000</td> <td>-83.00</td> </tr> <tr> <td>TIF Project ID</td> <td>0</td> <td>Total Value 72,011</td> <td>62,799</td> <td></td> <td>6,908</td> <td>Total Taxable</td> <td>5,908</td> <td>489.00</td> </tr> </tbody> </table>										Source	REAL	Fair Cash	Capped	Asmnt Level	Assessed	Levy Rate	82.750	Current Tax	Remove Cap	0	Land Value 4,480	3,907	11%	430	Assessed	6,908	571.64	Year Frozen	2018	Improvements 67,531	58,892		6,478	Penalty	0		Uncapped Value	0	Mobile Home 0	0		0	Exemption	1,000	-83.00	TIF Project ID	0	Total Value 72,011	62,799		6,908	Total Taxable	5,908	489.00																																																																			
Source	REAL	Fair Cash	Capped	Asmnt Level	Assessed	Levy Rate	82.750	Current Tax																																																																																																																	
Remove Cap	0	Land Value 4,480	3,907	11%	430	Assessed	6,908	571.64																																																																																																																	
Year Frozen	2018	Improvements 67,531	58,892		6,478	Penalty	0																																																																																																																		
Uncapped Value	0	Mobile Home 0	0		0	Exemption	1,000	-83.00																																																																																																																	
TIF Project ID	0	Total Value 72,011	62,799		6,908	Total Taxable	5,908	489.00																																																																																																																	
Assessment History <table border="1"> <thead> <tr> <th>Tax Year</th> <th>Statement Number</th> <th>Billed Owner</th> <th>Tax Area</th> <th>Total Value</th> <th>Exemptions</th> <th>Taxable Value</th> <th>Billed Tax</th> </tr> </thead> <tbody> <tr><td>2025</td><td>2025-660013565</td><td>COX, HENRY ALLEN &</td><td>14</td><td>62,831</td><td>1000</td><td>5,908</td><td>489.00</td></tr> <tr><td>2024</td><td>2024-660013565</td><td>COX, HENRY ALLEN &</td><td>14</td><td>79,169</td><td>1000</td><td>5,908</td><td>499.00</td></tr> <tr><td>2023</td><td>2023-660013565</td><td>COX, HENRY ALLEN &</td><td>14</td><td>81,584</td><td>1000</td><td>5,908</td><td>504.00</td></tr> <tr><td>2022</td><td>2022-660013565</td><td>COX, HENRY ALLEN &</td><td>14</td><td>82,774</td><td>1000</td><td>5,908</td><td>500.00</td></tr> <tr><td>2021</td><td>2021-660013565</td><td>COX, HENRY ALLEN &</td><td>14</td><td>85,388</td><td>1000</td><td>5,908</td><td>501.00</td></tr> <tr><td>2020</td><td>2020-660013565</td><td>COX, HENRY ALLEN &</td><td>14</td><td>65,458</td><td>1000</td><td>3,819</td><td>324.00</td></tr> <tr><td>2019</td><td>2019-660013565</td><td>COX, HENRY ALLEN &</td><td>14</td><td>63,069</td><td>1000</td><td>3,818</td><td>328.00</td></tr> <tr><td>2018</td><td>2018-660013565</td><td>COX, HENRY ALLEN &</td><td>14</td><td>66,579</td><td>1000</td><td>3,819</td><td>326.00</td></tr> <tr><td>2017</td><td>2017-660013565</td><td>COX, HENRY ALLEN &</td><td>14</td><td>65,933</td><td>1000</td><td>3,678</td><td>315.00</td></tr> <tr><td>2016</td><td>2016-660013565</td><td>COX, HENRY ALLEN &</td><td>14</td><td>64,086</td><td>1000</td><td>3,542</td><td>309.00</td></tr> <tr><td>2015</td><td>2015-660013565</td><td>COX, HENRY ALLEN &</td><td>14</td><td>62,990</td><td>1000</td><td>3,410</td><td>294.00</td></tr> <tr><td>2014</td><td>2014-660013565</td><td>COX, HENRY ALLEN &</td><td>14</td><td>63,575</td><td>1000</td><td>3,282</td><td>292.00</td></tr> <tr><td>2013</td><td>2013-660013565</td><td>COX, HENRY ALLEN &</td><td>14</td><td>61,814</td><td>1000</td><td>3,157</td><td>280.00</td></tr> </tbody> </table>										Tax Year	Statement Number	Billed Owner	Tax Area	Total Value	Exemptions	Taxable Value	Billed Tax	2025	2025-660013565	COX, HENRY ALLEN &	14	62,831	1000	5,908	489.00	2024	2024-660013565	COX, HENRY ALLEN &	14	79,169	1000	5,908	499.00	2023	2023-660013565	COX, HENRY ALLEN &	14	81,584	1000	5,908	504.00	2022	2022-660013565	COX, HENRY ALLEN &	14	82,774	1000	5,908	500.00	2021	2021-660013565	COX, HENRY ALLEN &	14	85,388	1000	5,908	501.00	2020	2020-660013565	COX, HENRY ALLEN &	14	65,458	1000	3,819	324.00	2019	2019-660013565	COX, HENRY ALLEN &	14	63,069	1000	3,818	328.00	2018	2018-660013565	COX, HENRY ALLEN &	14	66,579	1000	3,819	326.00	2017	2017-660013565	COX, HENRY ALLEN &	14	65,933	1000	3,678	315.00	2016	2016-660013565	COX, HENRY ALLEN &	14	64,086	1000	3,542	309.00	2015	2015-660013565	COX, HENRY ALLEN &	14	62,990	1000	3,410	294.00	2014	2014-660013565	COX, HENRY ALLEN &	14	63,575	1000	3,282	292.00	2013	2013-660013565	COX, HENRY ALLEN &	14	61,814	1000	3,157	280.00
Tax Year	Statement Number	Billed Owner	Tax Area	Total Value	Exemptions	Taxable Value	Billed Tax																																																																																																																		
2025	2025-660013565	COX, HENRY ALLEN &	14	62,831	1000	5,908	489.00																																																																																																																		
2024	2024-660013565	COX, HENRY ALLEN &	14	79,169	1000	5,908	499.00																																																																																																																		
2023	2023-660013565	COX, HENRY ALLEN &	14	81,584	1000	5,908	504.00																																																																																																																		
2022	2022-660013565	COX, HENRY ALLEN &	14	82,774	1000	5,908	500.00																																																																																																																		
2021	2021-660013565	COX, HENRY ALLEN &	14	85,388	1000	5,908	501.00																																																																																																																		
2020	2020-660013565	COX, HENRY ALLEN &	14	65,458	1000	3,819	324.00																																																																																																																		
2019	2019-660013565	COX, HENRY ALLEN &	14	63,069	1000	3,818	328.00																																																																																																																		
2018	2018-660013565	COX, HENRY ALLEN &	14	66,579	1000	3,819	326.00																																																																																																																		
2017	2017-660013565	COX, HENRY ALLEN &	14	65,933	1000	3,678	315.00																																																																																																																		
2016	2016-660013565	COX, HENRY ALLEN &	14	64,086	1000	3,542	309.00																																																																																																																		
2015	2015-660013565	COX, HENRY ALLEN &	14	62,990	1000	3,410	294.00																																																																																																																		
2014	2014-660013565	COX, HENRY ALLEN &	14	63,575	1000	3,282	292.00																																																																																																																		
2013	2013-660013565	COX, HENRY ALLEN &	14	61,814	1000	3,157	280.00																																																																																																																		



Rogers

Assessment Property Record Card for Tax Year 2026

Data provided by LISA DELOZIER County Assessor

Date 04/17/2026
 Time 06:29:16
 Page 2

Lot Data	
Lot Size	
Lot Count	
Units Buildable	
Non-Ag Acres	0
Topography	
Street Access	
Utilities	
Amenities	LAND QUALITY
Method	Units-Buildable
Base Lot Value	
Factor Value	
Adjustments	
Lot Value	



Residential Data	
Type	1 Single Family Residence
Condition	2 - Fair
Quality	2.5 - Fair
Architecture	TRAD TRADITIONAL
Style	100% One Story
Exterior Wall	100% Frame, Siding, Wood
Base/Total Area	1,512 / 1,512
Style	100% One Story
HVAC	100% Floor Furnace
Roof Cover	4 Metal, Preformed
Area on Slab	0
Fixture/RghIn	4 /
Bed/F/H Bath	2 / 1.0 /
Basement Area	
Garage Type	
Remodel	
Year/Eff Age	1940 / 86

GRM Approach	
GRM Code	
Gross Rent	0.00
Indicated Value	

Multiple Regression	
MRA Code	
Adusted R	
Indicated Value	

Direct Comparables	
Selection Model	1 Res
Adjustment Model	A2 AO Test
Comparables	
Indicated Value	

Cost Approach		Manual : 01/2025	
Base Cost	89.51	Total Misc Impr	+ 15,123
Roofing Adj	+ 4.85	Garage Cost	+
Subfloor Adj	+ 1.07	Total RCN	= 167,608
Heat/Cool Adj	+ 1.80	Depreciation (80%)	- 134,086
Plumbing Adj	+ 3.62	Lump Sums	+ 0
Basement Adj	+ 0.00	RCNLD	= 33,522
Adj Base Cost	= 100.85	Lot Value	+
Total Area	x 1,512	Indicated Value	= 33,522
Adjusted Cost	= 152,485	Value Per SqFt	22.17

Value Reconciliation	
Selected Approach	Cost Approach
Improvements	33,522
Lot Value	
Indicated Value	33,522 22.17 Per SqFt
Agland Value	4,480
Site Improvements	34,009
Total Value	72,011 47.63 Total Value Per SqFt

Miscellaneous Improvements								
Code	Description	Sketch ID	Size	Year	Units	Unit Cost	Depr	Value
PRCH	SLAB PORCH - COVERED	32540	10x4		40	23.66		946
EPSW	ENCLOSED PORCH - SOLID WALL	32541	30x5		150	61.22		9,183
FPR1	Fireplace - Residential 1 Story		1		1	4,994.06		4,994



Rogers

Assessment Property Record Card for Tax Year 2026

Data provided by LISA DELOZIER County Assessor

Date 04/17/2026
Time 06:29:16
Page 3

Sketch Image

660013565

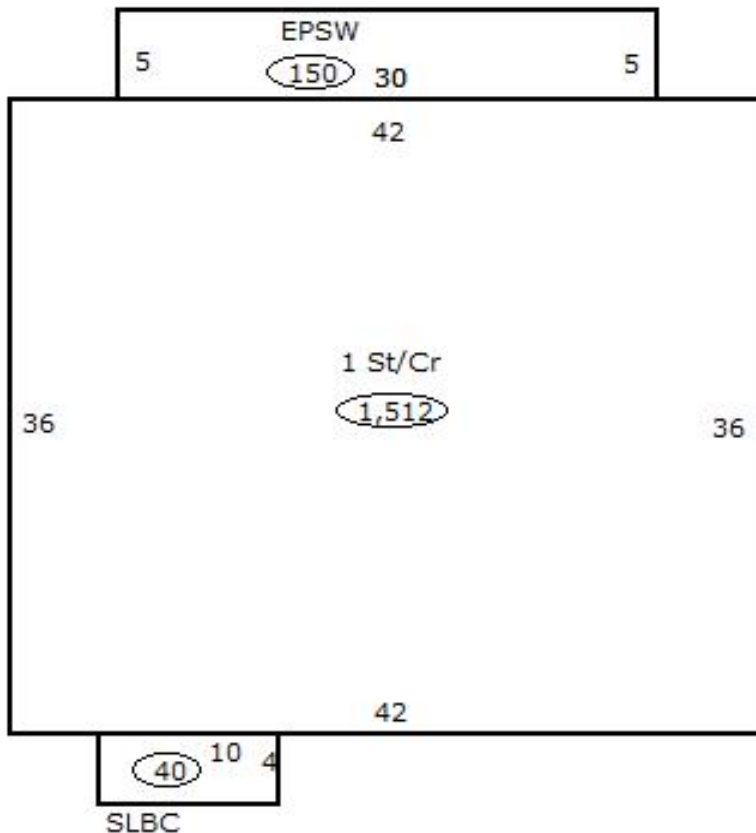

Sketch Vector Information

Sequence	Code	Type	Built Over	Scale	Section Label	Base Area	Multiplier	Total Area
1	R	1	Crawl	13	1 St/Cr	1,512	1.000	1,512
2	M	PRCH		13	SLBC	40	1.000	40
3	M	EPSW		13	EPSW	150	1.000	150
Total Building Area						1,512		1,512



Rogers



Assessment Property Record Card for Tax Year 2026

Data provided by LISA DELOZIER County Assessor

Date 04/17/2026
 Time 06:29:16
 Page 4

660013565

Outbuildings/Site Improvements

Building Image	Code	Description	Dimensions	Floor	Roofing	Total Units
	UTIL	SHOP BUILDING	30x40x10	Concrete	Formed Metal	1,200
	Qual 3	Cond 3	Year 2020	Eff Age 5		
	Valuation Summary		Modifier Total	RCN	Depr (9% Phys/ % Func)	RCNLD
Base Cost (29.51 x 1,200)		35,412		35,412	3,187	32,225
	CPDT	Carport - Detached	20x30x8	Dirt	Formed Metal	600
	Qual 3	Cond 3	Year 2010	Eff Age 12		
	Valuation Summary		Modifier Total	RCN	Depr (52% Phys/ % Func)	RCNLD
Base Cost (5.35 x 600)		3,210		3,210	1,669	1,541
	LOAF	LOAFING SHED	20x10x8	Dirt	Formed Metal	200
	Qual 2	Cond 2	Year 1990	Eff Age 36		
	Valuation Summary		Modifier Total	RCN	Depr (80% Phys/ % Func)	RCNLD
Base Cost (6.08 x 200)		1,216		1,216	973	243



Rogers

Assessment Property Record Card for Tax Year 2026

Data provided by LISA DELOZIER County Assessor

Date 04/17/2026
Time 06:29:16
Page 5

Agland Inventory

660013565

Soi	Description	Land Use	LPI	Adj Type	Adj Code	Acres	Use/Acre	Mkt/Acre	Use Value	Market Value
DNB	DENNIS SILT LOAM 1-3% SLO	IMP PST	80			20.000	224	224	4,480	4,480
IMP PST Totals						20.000			4,480	4,480
Total Agland						20.000			4,480	4,480