



Rogers

Assessment Property Record Card for Tax Year 2026

Data provided by LISA DELOZIER County Assessor

Date 04/17/2026
Time 06:08:25
Page 1

Assessment Data					Primary Image																																																																																																																				
Account 660013687 Parcel ID 21N14E-14-2-00000-000-0000 Cadastral ID 14-21-14-00100 Property Type REAL - Real Property Property Class RA VI Area 4 Tax Area 3 - OWASSO RURAL/NO FIRE Name ID 336752 KELTNER HOMES LLC 10521 N 161ST E AVE OWASSO OK 74055-0000 Parcel Location Situs 10521 N 161ST E AVE Subdivision Lot/Block / Parcel Size 55 - Acres Sec/Twn/Rng 14 / 21 / 14 / 2 Neighborhood 6110 - UNPLATTED School District S021 - OWASSO SCHOOLS					<p>\\tsclient\T\LOGAN\LOGAN RESIDENTIAL VI\2022-8-11\IMG_003! 8/11/2022</p>																																																																																																																				
Legal Description Lat/Long: 36.30581472 -95.79005259 N/2 N/W LESS S/2 SE/4 NE/4 NW/4 & LESS TR DESC 2024-015955 AS THE SW NW NW & LESS TRACT CONTAINED IN THE SW NW NW DESC 2024-015265 AS BEG 805.06' S & 329.29' E OF NW/C NW NW; E 206.40'; S 110.88'; W 206.40'; N 110.88' TO POB. & LESS TR DESC 2025 007221 AS NE NE NE.																																																																																																																									
Exemptions <table border="1"> <thead> <tr> <th>Code</th> <th>Type</th> <th>Active</th> <th>Maximum</th> <th>Exemption</th> </tr> </thead> <tbody> <tr> <td>H</td> <td>Homestead</td> <td>No</td> <td>1,000</td> <td></td> </tr> </tbody> </table>					Code	Type	Active	Maximum	Exemption	H	Homestead	No	1,000		Building Permits <table border="1"> <thead> <tr> <th>Number</th> <th>Description</th> <th>Opened</th> <th>Closed</th> <th>Amount</th> </tr> </thead> <tbody> <tr> <td>R5</td> <td>R5 PARENT SPLIT</td> <td>04/2004</td> <td>12/2004</td> <td></td> </tr> </tbody> </table>					Number	Description	Opened	Closed	Amount	R5	R5 PARENT SPLIT	04/2004	12/2004																																																																																													
Code	Type	Active	Maximum	Exemption																																																																																																																					
H	Homestead	No	1,000																																																																																																																						
Number	Description	Opened	Closed	Amount																																																																																																																					
R5	R5 PARENT SPLIT	04/2004	12/2004																																																																																																																						
Parcel Valuation <table border="1"> <thead> <tr> <th>Source</th> <th>REAL</th> <th>Fair Cash</th> <th>Capped</th> <th>Asmnt Level</th> <th>Assessed</th> <th>Levy Rate</th> <th>97.960</th> <th>Current Tax</th> </tr> </thead> <tbody> <tr> <td>Remove Cap</td> <td>2025</td> <td>Land Value 6,762</td> <td>6,762</td> <td>11%</td> <td>744</td> <td>Assessed</td> <td>13,737</td> <td>1,345.68</td> </tr> <tr> <td>Year Frozen</td> <td>2020</td> <td>Improvements 123,604</td> <td>118,122</td> <td></td> <td>12,993</td> <td>Penalty</td> <td>0</td> <td></td> </tr> <tr> <td>Uncapped Value</td> <td>0</td> <td>Mobile Home 0</td> <td>0</td> <td></td> <td>0</td> <td>Exemption</td> <td>0</td> <td>0.00</td> </tr> <tr> <td>TIF Project ID</td> <td>0</td> <td>Total Value 130,366</td> <td>124,884</td> <td></td> <td>13,737</td> <td>Total Taxable</td> <td>13,737</td> <td>1,346.00</td> </tr> </tbody> </table>					Source	REAL	Fair Cash	Capped	Asmnt Level	Assessed	Levy Rate	97.960	Current Tax	Remove Cap	2025	Land Value 6,762	6,762	11%	744	Assessed	13,737	1,345.68	Year Frozen	2020	Improvements 123,604	118,122		12,993	Penalty	0		Uncapped Value	0	Mobile Home 0	0		0	Exemption	0	0.00	TIF Project ID	0	Total Value 130,366	124,884		13,737	Total Taxable	13,737	1,346.00	Sale History <table border="1"> <thead> <tr> <th>Bk/Pg</th> <th>Grantor</th> <th>Date</th> <th>Price</th> <th>Code</th> </tr> </thead> <tbody> <tr> <td>/</td> <td>HUNTER, RALPH M &</td> <td>07/18/2024</td> <td>1,530,000</td> <td>21</td> </tr> <tr> <td>1599/536</td> <td>HUNTER, SALLY L</td> <td>06/21/2004</td> <td>0</td> <td></td> </tr> <tr> <td>1591/469</td> <td>MCCRAY, W D &</td> <td>04/27/2004</td> <td>0</td> <td>4</td> </tr> <tr> <td>879/354</td> <td>SELLER</td> <td>04/10/1992</td> <td>0</td> <td>No</td> </tr> </tbody> </table>					Bk/Pg	Grantor	Date	Price	Code	/	HUNTER, RALPH M &	07/18/2024	1,530,000	21	1599/536	HUNTER, SALLY L	06/21/2004	0		1591/469	MCCRAY, W D &	04/27/2004	0	4	879/354	SELLER	04/10/1992	0	No																																										
Source	REAL	Fair Cash	Capped	Asmnt Level	Assessed	Levy Rate	97.960	Current Tax																																																																																																																	
Remove Cap	2025	Land Value 6,762	6,762	11%	744	Assessed	13,737	1,345.68																																																																																																																	
Year Frozen	2020	Improvements 123,604	118,122		12,993	Penalty	0																																																																																																																		
Uncapped Value	0	Mobile Home 0	0		0	Exemption	0	0.00																																																																																																																	
TIF Project ID	0	Total Value 130,366	124,884		13,737	Total Taxable	13,737	1,346.00																																																																																																																	
Bk/Pg	Grantor	Date	Price	Code																																																																																																																					
/	HUNTER, RALPH M &	07/18/2024	1,530,000	21																																																																																																																					
1599/536	HUNTER, SALLY L	06/21/2004	0																																																																																																																						
1591/469	MCCRAY, W D &	04/27/2004	0	4																																																																																																																					
879/354	SELLER	04/10/1992	0	No																																																																																																																					
Assessment History <table border="1"> <thead> <tr> <th>Tax Year</th> <th>Statement Number</th> <th>Billed Owner</th> <th>Tax Area</th> <th>Total Value</th> <th>Exemptions</th> <th>Taxable Value</th> <th>Billed Tax</th> </tr> </thead> <tbody> <tr><td>2025</td><td>2025-660013687</td><td>KELTNER HOMES LLC</td><td>3</td><td>121,247</td><td>0</td><td>13,338</td><td>1,307.00</td></tr> <tr><td>2024</td><td>2024-660013687</td><td>KELTNER HOMES LLC</td><td>3</td><td>130,146</td><td>1000</td><td>10,061</td><td>967.00</td></tr> <tr><td>2023</td><td>2023-660013687</td><td>HUNTER, RALPH M &</td><td>3</td><td>115,146</td><td>1000</td><td>10,061</td><td>943.00</td></tr> <tr><td>2022</td><td>2022-660013687</td><td>HUNTER, RALPH M &</td><td>3</td><td>110,729</td><td>1000</td><td>10,061</td><td>986.00</td></tr> <tr><td>2021</td><td>2021-660013687</td><td>HUNTER, RALPH M &</td><td>3</td><td>100,615</td><td>1000</td><td>10,062</td><td>973.00</td></tr> <tr><td>2020</td><td>2020-660013687</td><td>HUNTER, RALPH M &</td><td>3</td><td>102,095</td><td>1000</td><td>10,061</td><td>972.00</td></tr> <tr><td>2019</td><td>2019-660013687</td><td>HUNTER, RALPH M &</td><td>3</td><td>97,628</td><td>1000</td><td>9,739</td><td>941.00</td></tr> <tr><td>2018</td><td>2018-660013687</td><td>HUNTER, RALPH M &</td><td>3</td><td>105,298</td><td>1000</td><td>10,583</td><td>985.00</td></tr> <tr><td>2017</td><td>2017-660013687</td><td>HUNTER, RALPH M &</td><td>3</td><td>104,496</td><td>1000</td><td>10,494</td><td>987.00</td></tr> <tr><td>2016</td><td>2016-660013687</td><td>HUNTER, RALPH M &</td><td>3</td><td>102,142</td><td>1000</td><td>10,235</td><td>964.00</td></tr> <tr><td>2015</td><td>2015-660013687</td><td>HUNTER, RALPH M &</td><td>3</td><td>104,335</td><td>1000</td><td>10,476</td><td>993.00</td></tr> <tr><td>2014</td><td>2014-660013687</td><td>HUNTER, RALPH M &</td><td>3</td><td>95,914</td><td>1000</td><td>9,105</td><td>872.00</td></tr> <tr><td>2013</td><td>2013-660013687</td><td>HUNTER, RALPH M &</td><td>3</td><td>92,005</td><td>1000</td><td>8,810</td><td>825.00</td></tr> </tbody> </table>										Tax Year	Statement Number	Billed Owner	Tax Area	Total Value	Exemptions	Taxable Value	Billed Tax	2025	2025-660013687	KELTNER HOMES LLC	3	121,247	0	13,338	1,307.00	2024	2024-660013687	KELTNER HOMES LLC	3	130,146	1000	10,061	967.00	2023	2023-660013687	HUNTER, RALPH M &	3	115,146	1000	10,061	943.00	2022	2022-660013687	HUNTER, RALPH M &	3	110,729	1000	10,061	986.00	2021	2021-660013687	HUNTER, RALPH M &	3	100,615	1000	10,062	973.00	2020	2020-660013687	HUNTER, RALPH M &	3	102,095	1000	10,061	972.00	2019	2019-660013687	HUNTER, RALPH M &	3	97,628	1000	9,739	941.00	2018	2018-660013687	HUNTER, RALPH M &	3	105,298	1000	10,583	985.00	2017	2017-660013687	HUNTER, RALPH M &	3	104,496	1000	10,494	987.00	2016	2016-660013687	HUNTER, RALPH M &	3	102,142	1000	10,235	964.00	2015	2015-660013687	HUNTER, RALPH M &	3	104,335	1000	10,476	993.00	2014	2014-660013687	HUNTER, RALPH M &	3	95,914	1000	9,105	872.00	2013	2013-660013687	HUNTER, RALPH M &	3	92,005	1000	8,810	825.00
Tax Year	Statement Number	Billed Owner	Tax Area	Total Value	Exemptions	Taxable Value	Billed Tax																																																																																																																		
2025	2025-660013687	KELTNER HOMES LLC	3	121,247	0	13,338	1,307.00																																																																																																																		
2024	2024-660013687	KELTNER HOMES LLC	3	130,146	1000	10,061	967.00																																																																																																																		
2023	2023-660013687	HUNTER, RALPH M &	3	115,146	1000	10,061	943.00																																																																																																																		
2022	2022-660013687	HUNTER, RALPH M &	3	110,729	1000	10,061	986.00																																																																																																																		
2021	2021-660013687	HUNTER, RALPH M &	3	100,615	1000	10,062	973.00																																																																																																																		
2020	2020-660013687	HUNTER, RALPH M &	3	102,095	1000	10,061	972.00																																																																																																																		
2019	2019-660013687	HUNTER, RALPH M &	3	97,628	1000	9,739	941.00																																																																																																																		
2018	2018-660013687	HUNTER, RALPH M &	3	105,298	1000	10,583	985.00																																																																																																																		
2017	2017-660013687	HUNTER, RALPH M &	3	104,496	1000	10,494	987.00																																																																																																																		
2016	2016-660013687	HUNTER, RALPH M &	3	102,142	1000	10,235	964.00																																																																																																																		
2015	2015-660013687	HUNTER, RALPH M &	3	104,335	1000	10,476	993.00																																																																																																																		
2014	2014-660013687	HUNTER, RALPH M &	3	95,914	1000	9,105	872.00																																																																																																																		
2013	2013-660013687	HUNTER, RALPH M &	3	92,005	1000	8,810	825.00																																																																																																																		



Rogers

Assessment Property Record Card for Tax Year 2026

Data provided by LISA DELOZIER County Assessor

Date 04/17/2026
Time 06:08:25
Page 2

Lot Data	Square-Foot - UNPLATTED (ACRES) AG LAND	Primary Image
Lot Size		
Lot Count		
Units Buildable		
Non-Ag Acres	0	
Topography		
Street Access		
Utilities		
Amenities	LAND QUALITY	
Method	Square-Foot	
Base Lot Value		
Factor Value		
Adjustments		
Lot Value		

Residential Data	
Type	1 Single Family Residence
Condition	2 - Fair
Quality	2.5 - Fair
Architecture	
Style	100% One Story
Exterior Wall	80% Veneer, Masonry 20% Frame, Siding, Vinyl
Base/Total Area	1,640 / 1,640
Style	100% One Story
HVAC	100% Warmed & Cooled Air
Roof Cover	1 Composition Shingle
Area on Slab	1,640
Fixture/RghIn	5 /
Bed/F/H Bath	3 / 1.5 /
Basement Area	
Garage Type	672 Attached Garage - Unfinished 2 Stalls
Remodel	
Year/Eff Age	1969 / 57

\\tsclient\T\LOGAN\LOGAN RESIDENTIAL VI\2022-8-11\IMG_003! 8/11/2022

GRM Approach	
GRM Code	
Gross Rent	0.00
Indicated Value	

Multiple Regression	
MRA Code	
Adjusted R	
Indicated Value	

Direct Comparables	
Selection Model	1 Res
Adjustment Model	A2 AO Test
Comparables	
Indicated Value	

Cost Approach				Manual : 01/2025			
Base Cost	103.11	Total Misc Impr	+	6,182			
Roofing Adj	+ 4.44	Garage Cost	+	17,418			
Subfloor Adj	+ -1.15	Total RCN	=	223,713			
Heat/Cool Adj	+ 11.47	Depreciation (62%)	-	138,702			
Plumbing Adj	+ 4.15	Lump Sums	+	2,409			
Basement Adj	+ 0.00	RCNLD	=	87,420			
Adj Base Cost	= 122.02	Lot Value	+				
Total Area	x 1,640	Indicated Value	=	87,420			
Adjusted Cost	= 200,113	Value Per SqFt		53.30			

Value Reconciliation			
Selected Approach	Cost Approach		
Improvements	87,420		
Lot Value			
Indicated Value	87,420	53.30	Per SqFt
Agland Value	6,762		
Site Improvements	36,184		
Total Value	215,377	131.33	Total Value Per SqFt

Miscellaneous Improvements								
Code	Description	Sketch ID	Size	Year	Units	Unit Cost	Depr	Value
FPR1	FIREPLACE - RESIDENTIAL 1 STORY	0		1	1	5,095.98		5,096
PRCH	SLAB PORCH - COVERED	32772		45	45	24.13		1,086
WODO	WOOD DECK - OPEN	32773	10x10		100	25.63	6%	2,409



Rogers

Assessment Property Record Card for Tax Year 2026

Data provided by LISA DELOZIER County Assessor

Date 04/17/2026
 Time 06:08:25
 Page 3

Sketch Image

660013687

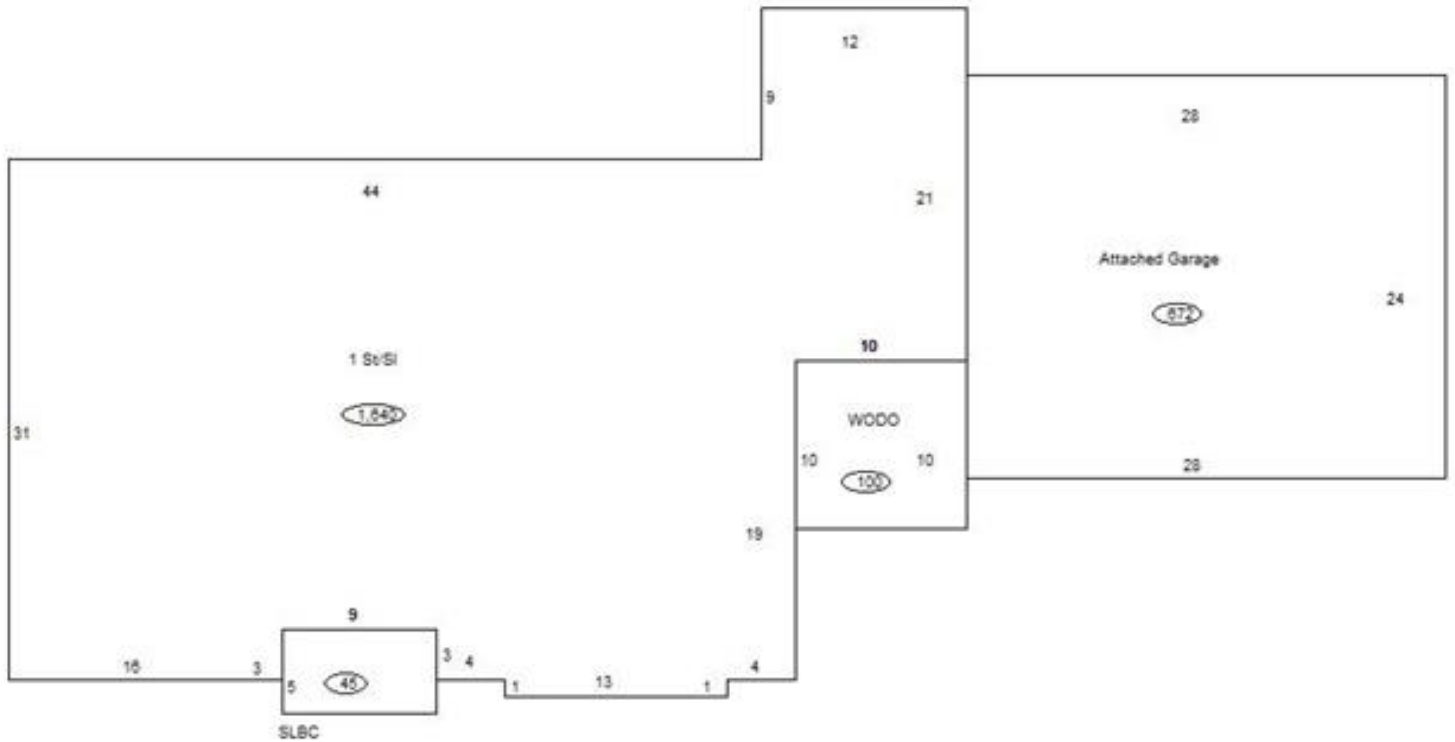

Sketch Vector Information

Sequence	Code	Type	Built Over	Scale	Section Label	Base Area	Multiplier	Total Area
1	R	1	Slab	10	1 St/SI	1,640	1.000	1,640
2	G	1		10	Attached Garage	672	1.000	672
3	M	PRCH		10	SLBC	45	1.000	45
4	M	WODO		10	WODO	100	1.000	100
Total Building Area						1,640		1,640



Rogers



Assessment Property Record Card for Tax Year 2026

Data provided by LISA DELOZIER County Assessor

Date 04/17/2026
 Time 06:08:25
 Page 4

660013687

Outbuildings/Site Improvements

Building Image	Code	Description	Dimensions	Floor	Roofing	Total Units
	UTIL	SHOP BUILDING	30x50x0			1,500
	Qual 2	Cond 3	Year 2014	Eff Age	9	
	Valuation Summary Base Cost (27.50 x 1,500) 41,250		Modifier Total	RCN 41,250	Depr (17% Phys/ % Func) 7,013	RCNLD 34,237
	BARN	BARN	0x0x0			768
	Qual 3	Cond 3	Year	Eff Age		
	Valuation Summary Base Cost (10.48 x 768) 8,049		Modifier Total	RCN 8,049	Depr (80% Phys/ % Func) 6,439	RCNLD 1,610
	STF	STG FAIR	0x0x0			240
	Qual 2	Cond 3	Year	Eff Age		
	Valuation Summary Base Cost (4.68 x 240) 1,123		Modifier Total	RCN 1,123	Depr (70% Phys/ % Func) 786	RCNLD 337



Rogers

Assessment Property Record Card for Tax Year 2026

Data provided by LISA DELOZIER County Assessor

Date 04/17/2026
Time 06:08:25
Page 5

Agland Inventory

660013687

Soi	Description	Land Use	LPI	Adj Type	Adj Code	Acres	Use/Acre	Mkt/Acre	Use Value	Market Value
BR	BREAKS-ALLUVIAL LAND COMP	TMBR	30			.752	54	54	41	41
CHB	CHOTEAU SILT LOAM 1-3% SL	NTV PST	80			.219	192	192	42	42
DNB	DENNIS SILT LOAM 1-3% SLO	IMP PST	80			2.803	224	224	628	628
DWA	DWIGHT SILT LOAM 0-1% SLO	NTV PST	50			10.674	120	120	1,281	1,281
PAA	PARSONS SILT LOAM 0-1% SL	IMP PST	76			5.535	213	213	1,178	1,178
VE	VERDIGRIS CLAY LOAM	TMBR	90			8.127	162	162	1,317	1,317
VF	VERDIGRIS SOILS FREQUENTL	TMBR	47			26.890	85	85	2,275	2,275
TMBR Totals						55.000			6,762	6,762
Total Agland						55.000			6,762	6,762