



Rogers

Assessment Property Record Card for Tax Year 2026

Data provided by LISA DELOZIER County Assessor

Date 04/16/2026
 Time 22:13:00
 Page 1

Assessment Data					Primary Image																																																																																																																				
Account 660013695 Parcel ID 21N14E-14-3-00000-000-0000 Cadastral ID 14-21-14-00800 Property Type REAL - Real Property Property Class RR VI Area 4 Tax Area 3 - OWASSO RURAL/NO FIRE Name ID 137814 VANAMAN, WILLIAM H TRUSTEE 16501 E 96TH ST N OWASSO OK 74055-0000 Parcel Location Situs 16501 E 96TH ST N Subdivision Lot/Block / Parcel Size 2.5 - Acres Sec/Twn/Rng 14 / 21 / 14 / 3 Neighborhood 6110 - UNPLATTED School District S021 - OWASSO SCHOOLS																																																																																																																									
Legal Description Lat/Long: 36.29346826 -95.78704112																																																																																																																									
Legal Description TR IN SE SW, BEG; 330' W SE/C SE SW PT 330' W SE/C SW; W 330' N 330', E 330' S 330' TO POB					Building Permits <table border="1"> <thead> <tr> <th>Number</th> <th>Description</th> <th>Opened</th> <th>Closed</th> <th>Amount</th> </tr> </thead> <tbody> <tr> <td>R2011 01 6</td> <td>R12-NEW 30X60 1800 SQ FT DETACHE</td> <td>01/2011</td> <td>05/2011</td> <td>35,000</td> </tr> </tbody> </table>					Number	Description	Opened	Closed	Amount	R2011 01 6	R12-NEW 30X60 1800 SQ FT DETACHE	01/2011	05/2011	35,000																																																																																																						
Number	Description	Opened	Closed	Amount																																																																																																																					
R2011 01 6	R12-NEW 30X60 1800 SQ FT DETACHE	01/2011	05/2011	35,000																																																																																																																					
Exemptions <table border="1"> <thead> <tr> <th>Code</th> <th>Type</th> <th>Active</th> <th>Maximum</th> <th>Exemption</th> </tr> </thead> <tbody> <tr> <td>H</td> <td>Homestead</td> <td>Yes</td> <td>1,000</td> <td>1,000</td> </tr> </tbody> </table>					Code	Type	Active	Maximum	Exemption	H	Homestead	Yes	1,000	1,000	Sale History <table border="1"> <thead> <tr> <th>Bk/Pg</th> <th>Grantor</th> <th>Date</th> <th>Price</th> <th>Code</th> </tr> </thead> <tbody> </tbody> </table>					Bk/Pg	Grantor	Date	Price	Code																																																																																																	
Code	Type	Active	Maximum	Exemption																																																																																																																					
H	Homestead	Yes	1,000	1,000																																																																																																																					
Bk/Pg	Grantor	Date	Price	Code																																																																																																																					
Parcel Valuation <table border="1"> <thead> <tr> <th>Source</th> <th>REAL</th> <th>Fair Cash</th> <th>Capped</th> <th>Asmnt Level</th> <th>Assessed</th> <th>Levy Rate</th> <th>97.960</th> <th>Current Tax</th> </tr> </thead> <tbody> <tr> <td>Remove Cap</td> <td>0</td> <td>Land Value 46,268</td> <td>46,268</td> <td>11%</td> <td>5,089</td> <td>Assessed</td> <td>28,463</td> <td>2,788.24</td> </tr> <tr> <td>Year Frozen</td> <td>0</td> <td>Improvements 252,155</td> <td>212,491</td> <td></td> <td>23,374</td> <td>Penalty</td> <td>0</td> <td></td> </tr> <tr> <td>Uncapped Value</td> <td>0</td> <td>Mobile Home 0</td> <td>0</td> <td></td> <td>0</td> <td>Exemption</td> <td>1,000</td> <td>-98.00</td> </tr> <tr> <td>TIF Project ID</td> <td>0</td> <td>Total Value 298,423</td> <td>258,759</td> <td></td> <td>28,463</td> <td>Total Taxable</td> <td>27,463</td> <td>2,690.00</td> </tr> </tbody> </table>										Source	REAL	Fair Cash	Capped	Asmnt Level	Assessed	Levy Rate	97.960	Current Tax	Remove Cap	0	Land Value 46,268	46,268	11%	5,089	Assessed	28,463	2,788.24	Year Frozen	0	Improvements 252,155	212,491		23,374	Penalty	0		Uncapped Value	0	Mobile Home 0	0		0	Exemption	1,000	-98.00	TIF Project ID	0	Total Value 298,423	258,759		28,463	Total Taxable	27,463	2,690.00																																																																			
Source	REAL	Fair Cash	Capped	Asmnt Level	Assessed	Levy Rate	97.960	Current Tax																																																																																																																	
Remove Cap	0	Land Value 46,268	46,268	11%	5,089	Assessed	28,463	2,788.24																																																																																																																	
Year Frozen	0	Improvements 252,155	212,491		23,374	Penalty	0																																																																																																																		
Uncapped Value	0	Mobile Home 0	0		0	Exemption	1,000	-98.00																																																																																																																	
TIF Project ID	0	Total Value 298,423	258,759		28,463	Total Taxable	27,463	2,690.00																																																																																																																	
Assessment History <table border="1"> <thead> <tr> <th>Tax Year</th> <th>Statement Number</th> <th>Billed Owner</th> <th>Tax Area</th> <th>Total Value</th> <th>Exemptions</th> <th>Taxable Value</th> <th>Billed Tax</th> </tr> </thead> <tbody> <tr><td>2025</td><td>2025-660013695</td><td>VANAMAN, WILLIAM H</td><td>3</td><td>254,574</td><td>1000</td><td>26,634</td><td>2,609.00</td></tr> <tr><td>2024</td><td>2024-660013695</td><td>VANAMAN, WILLIAM H</td><td>3</td><td>266,801</td><td>1000</td><td>25,829</td><td>2,481.00</td></tr> <tr><td>2023</td><td>2023-660013695</td><td>VANAMAN, WILLIAM H</td><td>3</td><td>241,059</td><td>1000</td><td>25,048</td><td>2,347.00</td></tr> <tr><td>2022</td><td>2022-660013695</td><td>VANAMAN, WILLIAM H</td><td>3</td><td>242,677</td><td>1000</td><td>24,290</td><td>2,380.00</td></tr> <tr><td>2021</td><td>2021-660013695</td><td>VANAMAN, WILLIAM H</td><td>3</td><td>254,207</td><td>1000</td><td>23,553</td><td>2,279.00</td></tr> <tr><td>2020</td><td>2020-660013695</td><td>VANAMAN, WILLIAM H</td><td>3</td><td>250,580</td><td>1000</td><td>22,838</td><td>2,206.00</td></tr> <tr><td>2019</td><td>2019-660013695</td><td>VANAMAN, WILLIAM H</td><td>3</td><td>232,349</td><td>1000</td><td>22,143</td><td>2,141.00</td></tr> <tr><td>2018</td><td>2018-660013695</td><td>VANAMAN, WILLIAM H</td><td>3</td><td>241,968</td><td>1000</td><td>21,469</td><td>1,998.00</td></tr> <tr><td>2017</td><td>2017-660013695</td><td>VANAMAN, WILLIAM H</td><td>3</td><td>237,653</td><td>1000</td><td>20,816</td><td>1,958.00</td></tr> <tr><td>2016</td><td>2016-660013695</td><td>VANAMAN, WILLIAM H</td><td>3</td><td>234,557</td><td>1000</td><td>20,180</td><td>1,900.00</td></tr> <tr><td>2015</td><td>2015-660013695</td><td>VANAMAN, WILLIAM H</td><td>3</td><td>232,552</td><td>1000</td><td>19,563</td><td>1,855.00</td></tr> <tr><td>2014</td><td>2014-660013695</td><td>VANAMAN, WILLIAM H</td><td>3</td><td>235,153</td><td>1000</td><td>18,965</td><td>1,815.00</td></tr> <tr><td>2013</td><td>2013-660013695</td><td>VANAMAN, WILLIAM H</td><td>3</td><td>228,282</td><td>1000</td><td>18,382</td><td>1,722.00</td></tr> </tbody> </table>										Tax Year	Statement Number	Billed Owner	Tax Area	Total Value	Exemptions	Taxable Value	Billed Tax	2025	2025-660013695	VANAMAN, WILLIAM H	3	254,574	1000	26,634	2,609.00	2024	2024-660013695	VANAMAN, WILLIAM H	3	266,801	1000	25,829	2,481.00	2023	2023-660013695	VANAMAN, WILLIAM H	3	241,059	1000	25,048	2,347.00	2022	2022-660013695	VANAMAN, WILLIAM H	3	242,677	1000	24,290	2,380.00	2021	2021-660013695	VANAMAN, WILLIAM H	3	254,207	1000	23,553	2,279.00	2020	2020-660013695	VANAMAN, WILLIAM H	3	250,580	1000	22,838	2,206.00	2019	2019-660013695	VANAMAN, WILLIAM H	3	232,349	1000	22,143	2,141.00	2018	2018-660013695	VANAMAN, WILLIAM H	3	241,968	1000	21,469	1,998.00	2017	2017-660013695	VANAMAN, WILLIAM H	3	237,653	1000	20,816	1,958.00	2016	2016-660013695	VANAMAN, WILLIAM H	3	234,557	1000	20,180	1,900.00	2015	2015-660013695	VANAMAN, WILLIAM H	3	232,552	1000	19,563	1,855.00	2014	2014-660013695	VANAMAN, WILLIAM H	3	235,153	1000	18,965	1,815.00	2013	2013-660013695	VANAMAN, WILLIAM H	3	228,282	1000	18,382	1,722.00
Tax Year	Statement Number	Billed Owner	Tax Area	Total Value	Exemptions	Taxable Value	Billed Tax																																																																																																																		
2025	2025-660013695	VANAMAN, WILLIAM H	3	254,574	1000	26,634	2,609.00																																																																																																																		
2024	2024-660013695	VANAMAN, WILLIAM H	3	266,801	1000	25,829	2,481.00																																																																																																																		
2023	2023-660013695	VANAMAN, WILLIAM H	3	241,059	1000	25,048	2,347.00																																																																																																																		
2022	2022-660013695	VANAMAN, WILLIAM H	3	242,677	1000	24,290	2,380.00																																																																																																																		
2021	2021-660013695	VANAMAN, WILLIAM H	3	254,207	1000	23,553	2,279.00																																																																																																																		
2020	2020-660013695	VANAMAN, WILLIAM H	3	250,580	1000	22,838	2,206.00																																																																																																																		
2019	2019-660013695	VANAMAN, WILLIAM H	3	232,349	1000	22,143	2,141.00																																																																																																																		
2018	2018-660013695	VANAMAN, WILLIAM H	3	241,968	1000	21,469	1,998.00																																																																																																																		
2017	2017-660013695	VANAMAN, WILLIAM H	3	237,653	1000	20,816	1,958.00																																																																																																																		
2016	2016-660013695	VANAMAN, WILLIAM H	3	234,557	1000	20,180	1,900.00																																																																																																																		
2015	2015-660013695	VANAMAN, WILLIAM H	3	232,552	1000	19,563	1,855.00																																																																																																																		
2014	2014-660013695	VANAMAN, WILLIAM H	3	235,153	1000	18,965	1,815.00																																																																																																																		
2013	2013-660013695	VANAMAN, WILLIAM H	3	228,282	1000	18,382	1,722.00																																																																																																																		



Rogers

Assessment Property Record Card for Tax Year 2026

Data provided by LISA DELOZIER County Assessor

Date 04/16/2026
 Time 22:13:00
 Page 2

Lot Data		Square-Foot - NBHD 6110 #1	
Lot Size			
Lot Count			
Units Buildable	2.5		
Non-Ag Acres	2.3739		
Topography			
Street Access			
Utilities			
Amenities	LAND QUALITY	0	
		0	
Method	Square-Foot		
Base Lot Value	103,408.00 x .45 = 46,268		
Factor Value			
Adjustments	1.0000		
Lot Value	46,268		



\\tsclient\T\LOGAN\LOGAN RESIDENTIAL VI\2022-8-12\IMG_003 8/12/2022

Residential Data	
Type	1 Single Family Residence
Condition	3 - Average
Quality	2.5 - Fair
Architecture	
Style	100% One Story
Exterior Wall	30% Veneer, Masonry 70% Frame, Siding, Vinyl
Base/Total Area	1,456 / 1,456
Style	100% One Story
HVAC	100% Warmed & Cooled Air
Roof Cover	1 Composition Shingle
Area on Slab	1,456
Fixture/RghIn	11 /
Bed/F/H Bath	3 / 2.0 /
Basement Area	
Garage Type	598 Attached Garage - Unfinished
Remodel	
Year/Eff Age	1975 / 38

GRM Approach	
GRM Code	
Gross Rent	0.00
Indicated Value	

Multiple Regression			
MRA Code	1	Test	
Adusted R	0.8445		
Indicated Value	304,239	208.96	Per SqFt

Direct Comparables	
Selection Model	1 Res
Adjustment Model	A2 AO Test
Comparables	
Indicated Value	

Cost Approach		Manual : 01/2025	
Base Cost	94.30	Total Misc Impr	+ 15,562
Roofing Adj	+ 4.26	Garage Cost	+ 15,751
Subfloor Adj	+ -1.12	Total RCN	= 203,965
Heat/Cool Adj	+ 11.47	Depreciation (47%)	- 95,864
Plumbing Adj	+ 9.67	Lump Sums	+ 4,683
Basement Adj	+ 0.00	RCNLD	= 112,784
Adj Base Cost	= 118.58	Lot Value	+ 46,268
Total Area	x 1,456	Indicated Value	= 159,052
Adjusted Cost	= 172,652	Value Per SqFt	109.24

Value Reconciliation			
Selected Approach	Cost Approach		
Improvements	112,784		
Lot Value	46,268		
Indicated Value	159,052	109.24	Per SqFt
Agland Value			
Site Improvements	139,371		
Total Value	298,423	204.96	Total Value Per SqFt

Miscellaneous Improvements								
Code	Description	Sketch ID	Size	Year	Units	Unit Cost	Depr	Value
PRCH	SLAB PORCH - COVERED	32790	8x4		32	24.17		773
EPSW	ENCLOSED PORCH - SOLID WALL	32791	24x10		240	61.62		14,789
WODO	WOOD DECK - OPEN	32792	31x10		310	16.07	6%	4,683



Sketch Image

660013695

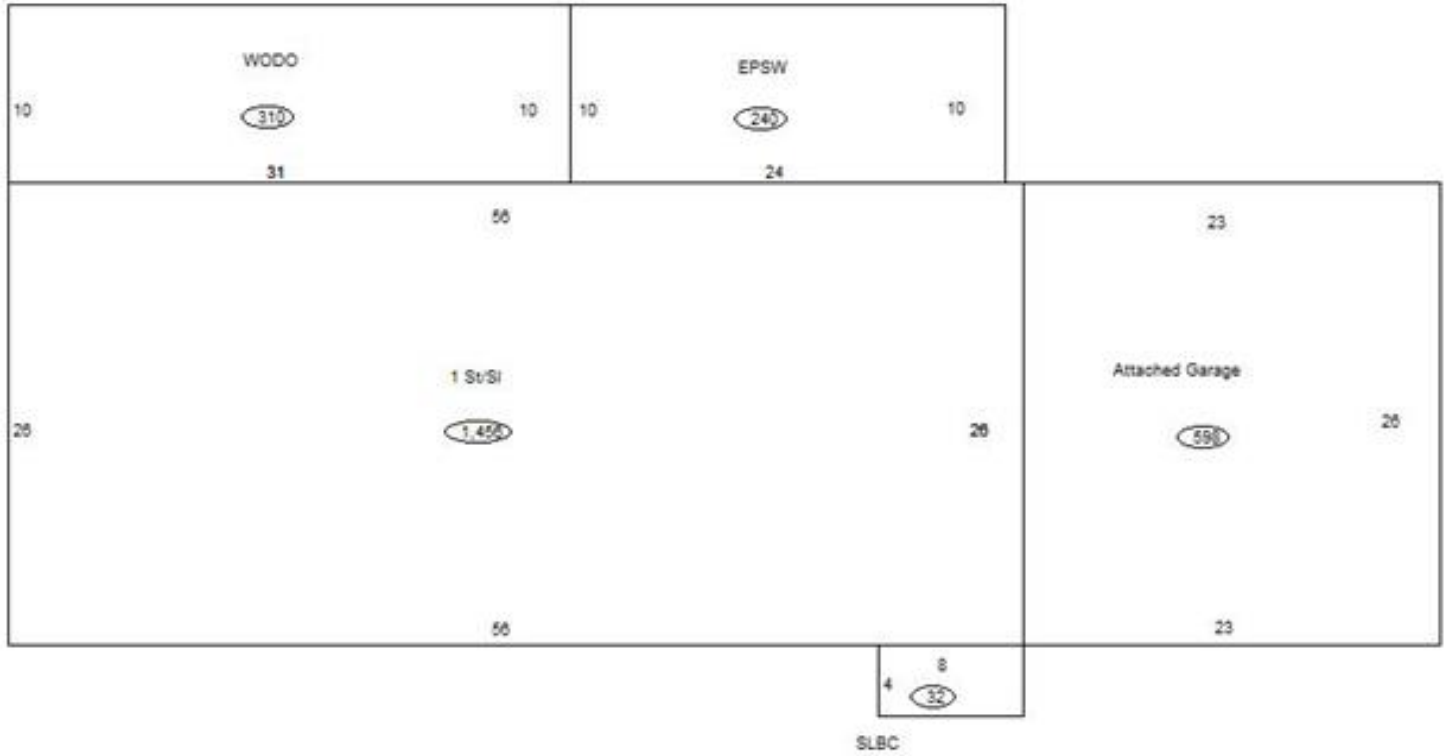

Sketch Vector Information

Sequence	Code	Type	Built Over	Scale	Section Label	Base Area	Multiplier	Total Area
1	R	1	Slab	10	1 St/SI	1,456	1.000	1,456
2	G	1		10	Attached Garage	598	1.000	598
3	M	PRCH		10	SLBC	32	1.000	32
4	M	EPSW		10	EPSW	240	1.000	240
5	M	WODO		10	WODO	310	1.000	310
Total Building Area						1,456		1,456



Rogers



Assessment Property Record Card for Tax Year 2026

Data provided by LISA DELOZIER County Assessor

Date 04/16/2026
 Time 22:13:00
 Page 4

660013695

Outbuildings/Site Improvements

Building Image	Code	Description	Dimensions	Floor	Roofing	Total Units
	UTIL	SHOP BUILDING	30x60x0			1,800
	Qual 4	Cond 3	Year 2011	Eff Age		
	Valuation Summary Base Cost (31.88 x 1,800) 57,384		Modifier Total	RCN 57,384	Depr (0% Phys/ % Func)	RCNLD 57,384
	BARN	BARN	24x30x0			720
	Qual 3	Cond 3	Year	Eff Age		
	Valuation Summary Base Cost (10.48 x 720) 7,546		Modifier Total	RCN 7,546	Depr (60% Phys/ % Func) 4,528	RCNLD 3,018
	UTIL	SHOP BUILDING	42x83x0			3,486
	Qual 3	Cond 3	Year	Eff Age		
	Valuation Summary Base Cost (25.17 x 3,486) 87,743		Modifier Total	RCN 87,743	Depr (10% Phys/ % Func) 8,774	RCNLD 78,969