



# Rogers

## Assessment Property Record Card for Tax Year 2026

Data provided by LISA DELOZIER County Assessor

Date 04/16/2026  
Time 21:29:32  
Page 1

Assessment Data					Primary Image																																																																																																																				
<b>Account</b> 660013739 <b>Parcel ID</b> 000000-00-0-00519-001-0005 <b>Cadastral ID</b> 14-21-14-02790 <b>Property Type</b> REAL - Real Property <b>Property Class</b> RRP VI Area 4 <b>Tax Area</b> 3 - OWASSO RURAL/NO FIRE <b>Name ID</b> 291900 ALVAREZ, PIO &  ERNESTINA 9838 N 165TH E AVE OWASSO OK 74055-0000																																																																																																																									
<b>Parcel Location</b> <b>Situs</b> 09838 N 165TH E AVE <b>Subdivision</b> MORGANS ACRES <b>Lot/Block</b> 0005 / 0001 <b>Parcel Size</b> 1 - Lots <b>Sec/Twn/Rng</b> 14 / 21 / 14 / 5 <b>Neighborhood</b> 1069 - R-V04-SW OWASSO <b>School District</b> S021 - OWASSO SCHOOLS																																																																																																																									
<b>Legal Description</b> Lat/Long: 36.29825311 -95.78817037 LOT 5 BLOCK 1 MORGANS ACRES					<b>Building Permits</b> <table border="1"> <thead> <tr> <th>Number</th> <th>Description</th> <th>Opened</th> <th>Closed</th> <th>Amount</th> </tr> </thead> <tbody> <tr> <td> </td> <td> </td> <td> </td> <td> </td> <td> </td> </tr> </tbody> </table>					Number	Description	Opened	Closed	Amount																																																																																																											
Number	Description	Opened	Closed	Amount																																																																																																																					
<b>Exemptions</b> <table border="1"> <thead> <tr> <th>Code</th> <th>Type</th> <th>Active</th> <th>Maximum</th> <th>Exemption</th> </tr> </thead> <tbody> <tr> <td> </td> <td> </td> <td> </td> <td> </td> <td> </td> </tr> </tbody> </table>					Code	Type	Active	Maximum	Exemption						<b>Sale History</b> <table border="1"> <thead> <tr> <th>Bk/Pg</th> <th>Grantor</th> <th>Date</th> <th>Price</th> <th>Code</th> </tr> </thead> <tbody> <tr> <td>1772/218</td> <td>COX, JAMES R &amp; LYNETTE G</td> <td>05/05/2006</td> <td>127,000</td> <td>YES</td> </tr> <tr> <td>1262/646</td> <td>YOUNG, EARNEST M</td> <td>12/19/2000</td> <td>112,500</td> <td>Yes</td> </tr> </tbody> </table>					Bk/Pg	Grantor	Date	Price	Code	1772/218	COX, JAMES R & LYNETTE G	05/05/2006	127,000	YES	1262/646	YOUNG, EARNEST M	12/19/2000	112,500	Yes																																																																																							
Code	Type	Active	Maximum	Exemption																																																																																																																					
Bk/Pg	Grantor	Date	Price	Code																																																																																																																					
1772/218	COX, JAMES R & LYNETTE G	05/05/2006	127,000	YES																																																																																																																					
1262/646	YOUNG, EARNEST M	12/19/2000	112,500	Yes																																																																																																																					
<b>Parcel Valuation</b> <table border="1"> <thead> <tr> <th>Source</th> <th>REAL</th> <th>Fair Cash</th> <th>Capped</th> <th>Asmnt Level</th> <th>Assessed</th> <th>Levy Rate</th> <th>97.960</th> <th>Current Tax</th> </tr> </thead> <tbody> <tr> <td>Remove Cap</td> <td>2007</td> <td>Land Value 60,685</td> <td>28,177</td> <td>11%</td> <td>3,099</td> <td>Assessed</td> <td>16,487</td> <td>1,615.07</td> </tr> <tr> <td>Year Frozen</td> <td>0</td> <td>Improvements 121,705</td> <td>121,705</td> <td></td> <td>13,388</td> <td>Penalty</td> <td>0</td> <td></td> </tr> <tr> <td>Uncapped Value</td> <td>0</td> <td>Mobile Home 0</td> <td>0</td> <td></td> <td>0</td> <td>Exemption</td> <td>0</td> <td>0.00</td> </tr> <tr> <td>TIF Project ID</td> <td>0</td> <td>Total Value 182,390</td> <td>149,882</td> <td></td> <td>16,487</td> <td>Total Taxable</td> <td>16,487</td> <td>1,615.00</td> </tr> </tbody> </table>										Source	REAL	Fair Cash	Capped	Asmnt Level	Assessed	Levy Rate	97.960	Current Tax	Remove Cap	2007	Land Value 60,685	28,177	11%	3,099	Assessed	16,487	1,615.07	Year Frozen	0	Improvements 121,705	121,705		13,388	Penalty	0		Uncapped Value	0	Mobile Home 0	0		0	Exemption	0	0.00	TIF Project ID	0	Total Value 182,390	149,882		16,487	Total Taxable	16,487	1,615.00																																																																			
Source	REAL	Fair Cash	Capped	Asmnt Level	Assessed	Levy Rate	97.960	Current Tax																																																																																																																	
Remove Cap	2007	Land Value 60,685	28,177	11%	3,099	Assessed	16,487	1,615.07																																																																																																																	
Year Frozen	0	Improvements 121,705	121,705		13,388	Penalty	0																																																																																																																		
Uncapped Value	0	Mobile Home 0	0		0	Exemption	0	0.00																																																																																																																	
TIF Project ID	0	Total Value 182,390	149,882		16,487	Total Taxable	16,487	1,615.00																																																																																																																	
<b>Assessment History</b> <table border="1"> <thead> <tr> <th>Tax Year</th> <th>Statement Number</th> <th>Billed Owner</th> <th>Tax Area</th> <th>Total Value</th> <th>Exemptions</th> <th>Taxable Value</th> <th>Billed Tax</th> </tr> </thead> <tbody> <tr><td>2025</td><td>2025-660013739</td><td>ALVAREZ, PIO &amp;</td><td>3</td><td>181,541</td><td>0</td><td>15,702</td><td>1,538.00</td></tr> <tr><td>2024</td><td>2024-660013739</td><td>ALVAREZ, PIO &amp;</td><td>3</td><td>189,789</td><td>0</td><td>14,954</td><td>1,437.00</td></tr> <tr><td>2023</td><td>2023-660013739</td><td>ALVAREZ, PIO &amp;</td><td>3</td><td>129,475</td><td>0</td><td>14,242</td><td>1,335.00</td></tr> <tr><td>2022</td><td>2022-660013739</td><td>ALVAREZ, PIO &amp;</td><td>3</td><td>134,716</td><td>0</td><td>14,819</td><td>1,452.00</td></tr> <tr><td>2021</td><td>2021-660013739</td><td>ALVAREZ, PIO &amp;</td><td>3</td><td>138,135</td><td>0</td><td>15,195</td><td>1,470.00</td></tr> <tr><td>2020</td><td>2020-660013739</td><td>ALVAREZ, PIO &amp;</td><td>3</td><td>140,025</td><td>0</td><td>15,403</td><td>1,488.00</td></tr> <tr><td>2019</td><td>2019-660013739</td><td>ALVAREZ, PIO &amp;</td><td>3</td><td>133,682</td><td>0</td><td>14,705</td><td>1,422.00</td></tr> <tr><td>2018</td><td>2018-660013739</td><td>ALVAREZ, PIO &amp;</td><td>3</td><td>144,109</td><td>0</td><td>15,852</td><td>1,476.00</td></tr> <tr><td>2017</td><td>2017-660013739</td><td>ALVAREZ, PIO &amp;</td><td>3</td><td>142,998</td><td>0</td><td>15,730</td><td>1,480.00</td></tr> <tr><td>2016</td><td>2016-660013739</td><td>ALVAREZ, PIO &amp;</td><td>3</td><td>139,579</td><td>0</td><td>15,354</td><td>1,446.00</td></tr> <tr><td>2015</td><td>2015-660013739</td><td>ALVAREZ, PIO &amp;</td><td>3</td><td>140,746</td><td>0</td><td>15,482</td><td>1,468.00</td></tr> <tr><td>2014</td><td>2014-660013739</td><td>ALVAREZ, PIO &amp;</td><td>3</td><td>145,297</td><td>0</td><td>15,983</td><td>1,530.00</td></tr> <tr><td>2013</td><td>2013-660013739</td><td>ALVAREZ, PIO &amp;</td><td>3</td><td>140,655</td><td>0</td><td>15,274</td><td>1,431.00</td></tr> </tbody> </table>										Tax Year	Statement Number	Billed Owner	Tax Area	Total Value	Exemptions	Taxable Value	Billed Tax	2025	2025-660013739	ALVAREZ, PIO &	3	181,541	0	15,702	1,538.00	2024	2024-660013739	ALVAREZ, PIO &	3	189,789	0	14,954	1,437.00	2023	2023-660013739	ALVAREZ, PIO &	3	129,475	0	14,242	1,335.00	2022	2022-660013739	ALVAREZ, PIO &	3	134,716	0	14,819	1,452.00	2021	2021-660013739	ALVAREZ, PIO &	3	138,135	0	15,195	1,470.00	2020	2020-660013739	ALVAREZ, PIO &	3	140,025	0	15,403	1,488.00	2019	2019-660013739	ALVAREZ, PIO &	3	133,682	0	14,705	1,422.00	2018	2018-660013739	ALVAREZ, PIO &	3	144,109	0	15,852	1,476.00	2017	2017-660013739	ALVAREZ, PIO &	3	142,998	0	15,730	1,480.00	2016	2016-660013739	ALVAREZ, PIO &	3	139,579	0	15,354	1,446.00	2015	2015-660013739	ALVAREZ, PIO &	3	140,746	0	15,482	1,468.00	2014	2014-660013739	ALVAREZ, PIO &	3	145,297	0	15,983	1,530.00	2013	2013-660013739	ALVAREZ, PIO &	3	140,655	0	15,274	1,431.00
Tax Year	Statement Number	Billed Owner	Tax Area	Total Value	Exemptions	Taxable Value	Billed Tax																																																																																																																		
2025	2025-660013739	ALVAREZ, PIO &	3	181,541	0	15,702	1,538.00																																																																																																																		
2024	2024-660013739	ALVAREZ, PIO &	3	189,789	0	14,954	1,437.00																																																																																																																		
2023	2023-660013739	ALVAREZ, PIO &	3	129,475	0	14,242	1,335.00																																																																																																																		
2022	2022-660013739	ALVAREZ, PIO &	3	134,716	0	14,819	1,452.00																																																																																																																		
2021	2021-660013739	ALVAREZ, PIO &	3	138,135	0	15,195	1,470.00																																																																																																																		
2020	2020-660013739	ALVAREZ, PIO &	3	140,025	0	15,403	1,488.00																																																																																																																		
2019	2019-660013739	ALVAREZ, PIO &	3	133,682	0	14,705	1,422.00																																																																																																																		
2018	2018-660013739	ALVAREZ, PIO &	3	144,109	0	15,852	1,476.00																																																																																																																		
2017	2017-660013739	ALVAREZ, PIO &	3	142,998	0	15,730	1,480.00																																																																																																																		
2016	2016-660013739	ALVAREZ, PIO &	3	139,579	0	15,354	1,446.00																																																																																																																		
2015	2015-660013739	ALVAREZ, PIO &	3	140,746	0	15,482	1,468.00																																																																																																																		
2014	2014-660013739	ALVAREZ, PIO &	3	145,297	0	15,983	1,530.00																																																																																																																		
2013	2013-660013739	ALVAREZ, PIO &	3	140,655	0	15,274	1,431.00																																																																																																																		



# Rogers

## Assessment Property Record Card for Tax Year 2026

Data provided by LISA DELOZIER County Assessor

Date 04/16/2026  
Time 21:29:32  
Page 2

Lot Data	Square-Foot - NBHD 1069 #1	Primary Image
Lot Size		
Lot Count		
Units Buildable	1	
Non-Ag Acres	1.1552	
Topography		
Street Access		
Utilities		
Amenities	LAND QUALITY	
	0	
	0	
Method	Square-Foot	
Base Lot Value	50,322.00 x 1.21 = 60,685	
Factor Value		
Adjustments	1.0000	
Lot Value	60,685	

Residential Data	
Type	1 Single Family Residence
Condition	3 - Average
Quality	2.5 - Fair
Architecture	
Style	100% One Story
Exterior Wall	100% Veneer, Masonry
Base/Total Area	2,220 / 2,220
Style	100% One Story
HVAC	100% Warmed & Cooled Air
Roof Cover	1 Composition Shingle
Area on Slab	0
Fixture/RghIn	8 /
Bed/F/H Bath	3 / 2.0 /
Basement Area	
Garage Type	600 Attached Garage - Unfinished
Remodel	
Year/Eff Age	1960 / 50

Cost Approach		Manual : 01/2025	
Base Cost	93.77	Total Misc Impr	+ 12,076
Roofing Adj	+ 3.97	Garage Cost	+ 15,792
Subfloor Adj	+ 1.03	Total RCN	= 283,035
Heat/Cool Adj	+ 11.47	Depreciation ( 57%)	- 161,330
Plumbing Adj	+ 4.70	Lump Sums	+ 0
Basement Adj	+ 0.00	RCNLD	= 121,705
Adj Base Cost	= 114.94	Lot Value	+ 60,685
Total Area	x 2,220	Indicated Value	= 182,390
Adjusted Cost	= 255,167	Value Per SqFt	82.16



\\tsclient\T\LOGAN\LOGAN RESIDENTIAL VI\2022-8-12\IMG\_000! 8/12/2022

GRM Approach	
GRM Code	
Gross Rent	0.00
Indicated Value	

Multiple Regression	
MRA Code	1 Test
Adjusted R	0.8445
Indicated Value	199,260 89.76 Per SqFt

Direct Comparables	
Selection Model	A Adam Test
Adjustment Model	1 2022 Residential
Comparables	6
Indicated Value	310,100 Per SqFt

Value Reconciliation	
Selected Approach	Cost Approach
Improvements	121,705
Lot Value	60,685
Indicated Value	182,390 82.16 Per SqFt
Agland Value	
Site Improvements	
Total Value	182,390 82.16 Total Value Per SqFt

Miscellaneous Improvements								
Code	Description	Sketch ID	Size	Year	Units	Unit Cost	Depr	Value
FPR1	FIREPLACE - RESIDENTIAL 1 STORY	0		1	1	5,095.98		5,096
PRCH	SLAB PORCH - COVERED	32917	15x12		180	23.64		4,255
PRCH	SLAB PORCH - COVERED	32918	19x6		114	23.90		2,725



# Rogers

## Assessment Property Record Card for Tax Year 2026

Data provided by LISA DELOZIER County Assessor

Date 04/16/2026

Time 21:29:32

Page 3

### Sketch Image

660013739

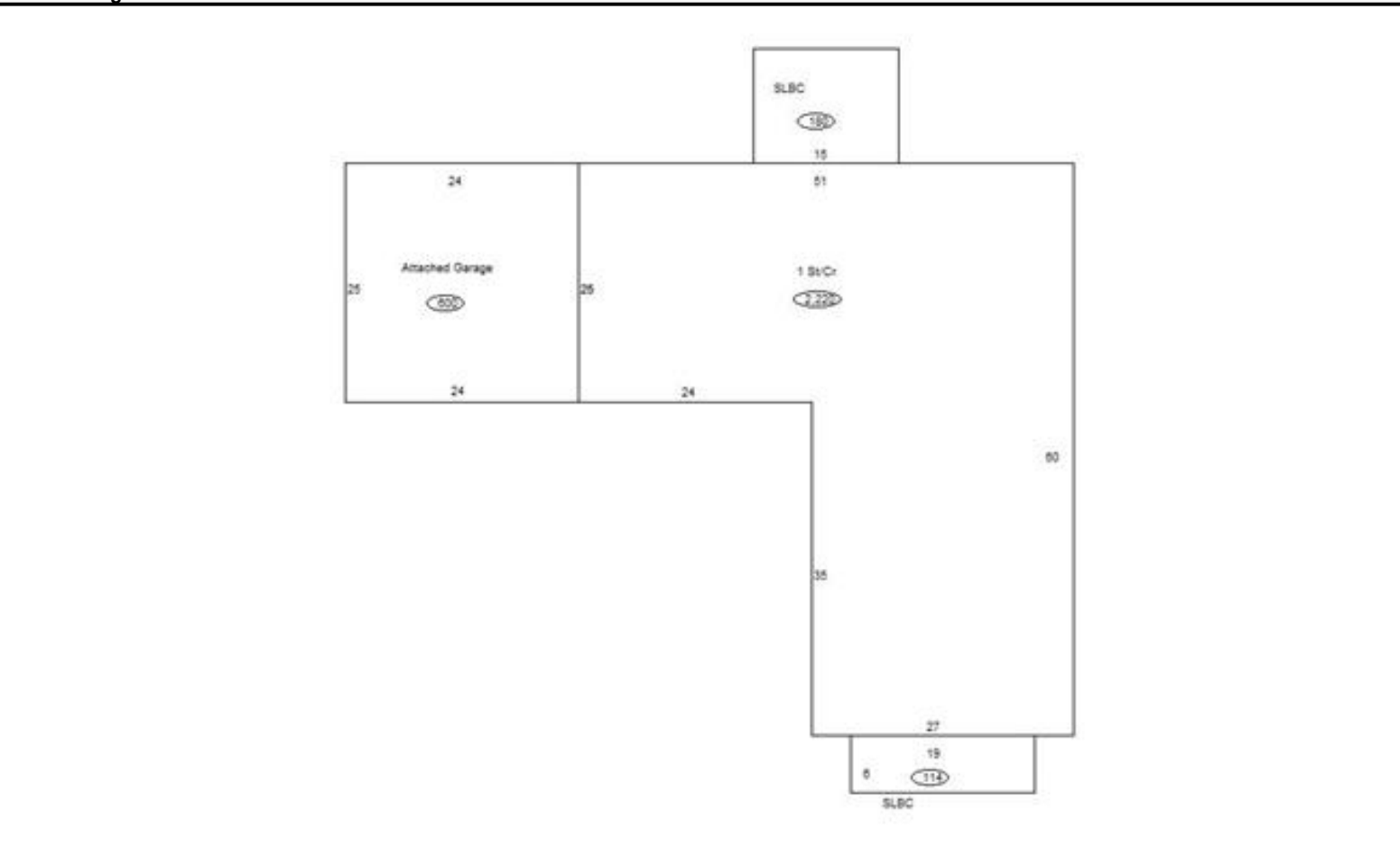

### Sketch Vector Information

Sequence	Code	Type	Built Over	Scale	Section Label	Base Area	Multiplier	Total Area
1	R	1	Crawl	13	1 St/Cr	2,220	1.000	2,220
2	G	1		13	Attached Garage	600	1.000	600
3	M	PRCH		13	SLBC	180	1.000	180
4	M	PRCH		13	SLBC	114	1.000	114
<b>Total Building Area</b>						<b>2,220</b>		<b>2,220</b>