



Rogers

Assessment Property Record Card for Tax Year 2026

Data provided by LISA DELOZIER County Assessor

Date 04/18/2026
 Time 07:10:26
 Page 1

Assessment Data					Primary Image																																																																																																																				
Account 660013753 Parcel ID 000000-00-0-00519-002-0006 Cadastral ID 14-21-14-02940 Property Type REAL - Real Property Property Class RRP VI Area 4 Tax Area 3 - OWASSO RURAL/NO FIRE Name ID 334174 POOL, CHRIS A & LISA G 9835 N 165TH E AVE OWASSO OK 74055-0000 Parcel Location Situs 09835 N 165TH E AVE Subdivision MORGANS ACRES Lot/Block 0006 / 0002 Parcel Size 2 - Lots Sec/Twn/Rng 14 / 21 / 14 / 5 Neighborhood 1069 - R-V04-SW OWASSO School District S021 - OWASSO SCHOOLS																																																																																																																									
Legal Description Lot/Long: 36.29778653 -95.78697783																																																																																																																									
Legal Description LOT 6 & LOT 23 & W2 VACATED RD BLOCK 2 MORGANS ACRES					Building Permits <table border="1"> <thead> <tr> <th>Number</th> <th>Description</th> <th>Opened</th> <th>Closed</th> <th>Amount</th> </tr> </thead> <tbody> <tr> <td> </td> <td> </td> <td> </td> <td> </td> <td> </td> </tr> </tbody> </table>					Number	Description	Opened	Closed	Amount																																																																																																											
Number	Description	Opened	Closed	Amount																																																																																																																					
Exemptions <table border="1"> <thead> <tr> <th>Code</th> <th>Type</th> <th>Active</th> <th>Maximum</th> <th>Exemption</th> </tr> </thead> <tbody> <tr> <td>H</td> <td>Homestead</td> <td>Yes</td> <td>1,000</td> <td>1,000</td> </tr> </tbody> </table>					Code	Type	Active	Maximum	Exemption	H	Homestead	Yes	1,000	1,000	Sale History <table border="1"> <thead> <tr> <th>Bk/Pg</th> <th>Grantor</th> <th>Date</th> <th>Price</th> <th>Code</th> </tr> </thead> <tbody> <tr> <td>/</td> <td>SLAUF, KIMBERLY A</td> <td>04/18/2021</td> <td>251,000</td> <td>YES</td> </tr> <tr> <td>2463/30</td> <td>HEASLET, DONALD R &</td> <td>02/18/2015</td> <td>199,000</td> <td>YES</td> </tr> </tbody> </table>					Bk/Pg	Grantor	Date	Price	Code	/	SLAUF, KIMBERLY A	04/18/2021	251,000	YES	2463/30	HEASLET, DONALD R &	02/18/2015	199,000	YES																																																																																							
Code	Type	Active	Maximum	Exemption																																																																																																																					
H	Homestead	Yes	1,000	1,000																																																																																																																					
Bk/Pg	Grantor	Date	Price	Code																																																																																																																					
/	SLAUF, KIMBERLY A	04/18/2021	251,000	YES																																																																																																																					
2463/30	HEASLET, DONALD R &	02/18/2015	199,000	YES																																																																																																																					
Parcel Valuation <table border="1"> <thead> <tr> <th>Source</th> <th>REAL</th> <th>Fair Cash</th> <th>Capped</th> <th>Asmnt Level</th> <th>Assessed</th> <th>Levy Rate</th> <th>97.960</th> <th>Current Tax</th> </tr> </thead> <tbody> <tr> <td>Remove Cap</td> <td>2022</td> <td>Land Value 60,073</td> <td>60,073</td> <td>11%</td> <td>6,608</td> <td>Assessed</td> <td>25,801</td> <td>2,527.47</td> </tr> <tr> <td>Year Frozen</td> <td>2011</td> <td>Improvements 182,350</td> <td>174,485</td> <td></td> <td>19,193</td> <td>Penalty</td> <td>0</td> <td></td> </tr> <tr> <td>Uncapped Value</td> <td>0</td> <td>Mobile Home 0</td> <td>0</td> <td></td> <td>0</td> <td>Exemption</td> <td>1,000</td> <td>-97.00</td> </tr> <tr> <td>TIF Project ID</td> <td>0</td> <td>Total Value 242,423</td> <td>234,558</td> <td></td> <td>25,801</td> <td>Total Taxable</td> <td>24,801</td> <td>2,430.00</td> </tr> </tbody> </table>										Source	REAL	Fair Cash	Capped	Asmnt Level	Assessed	Levy Rate	97.960	Current Tax	Remove Cap	2022	Land Value 60,073	60,073	11%	6,608	Assessed	25,801	2,527.47	Year Frozen	2011	Improvements 182,350	174,485		19,193	Penalty	0		Uncapped Value	0	Mobile Home 0	0		0	Exemption	1,000	-97.00	TIF Project ID	0	Total Value 242,423	234,558		25,801	Total Taxable	24,801	2,430.00																																																																			
Source	REAL	Fair Cash	Capped	Asmnt Level	Assessed	Levy Rate	97.960	Current Tax																																																																																																																	
Remove Cap	2022	Land Value 60,073	60,073	11%	6,608	Assessed	25,801	2,527.47																																																																																																																	
Year Frozen	2011	Improvements 182,350	174,485		19,193	Penalty	0																																																																																																																		
Uncapped Value	0	Mobile Home 0	0		0	Exemption	1,000	-97.00																																																																																																																	
TIF Project ID	0	Total Value 242,423	234,558		25,801	Total Taxable	24,801	2,430.00																																																																																																																	
Assessment History <table border="1"> <thead> <tr> <th>Tax Year</th> <th>Statement Number</th> <th>Billed Owner</th> <th>Tax Area</th> <th>Total Value</th> <th>Exemptions</th> <th>Taxable Value</th> <th>Billed Tax</th> </tr> </thead> <tbody> <tr><td>2025</td><td>2025-660013753</td><td>POOL, CHRIS A & LISA G</td><td>3</td><td>227,727</td><td>1000</td><td>24,050</td><td>2,356.00</td></tr> <tr><td>2024</td><td>2024-660013753</td><td>POOL, CHRIS A & LISA G</td><td>3</td><td>234,859</td><td>1000</td><td>24,834</td><td>2,386.00</td></tr> <tr><td>2023</td><td>2023-660013753</td><td>POOL, CHRIS A & LISA G</td><td>3</td><td>251,000</td><td>1000</td><td>26,610</td><td>2,494.00</td></tr> <tr><td>2022</td><td>2022-660013753</td><td>POOL, CHRIS A & LISA G</td><td>3</td><td>251,000</td><td>0</td><td>27,610</td><td>2,705.00</td></tr> <tr><td>2021</td><td>2021-660013753</td><td>POOL, CHRIS A & LISA G</td><td>3</td><td>210,040</td><td>0</td><td>23,104</td><td>2,235.00</td></tr> <tr><td>2020</td><td>2020-660013753</td><td>SLAUF, LEONARD J & KIMBERLY A</td><td>3</td><td>207,014</td><td>0</td><td>22,772</td><td>2,200.00</td></tr> <tr><td>2019</td><td>2019-660013753</td><td>SLAUF, LEONARD J & KIMBERLY A</td><td>3</td><td>199,589</td><td>0</td><td>21,955</td><td>2,122.00</td></tr> <tr><td>2018</td><td>2018-660013753</td><td>SLAUF, LEONARD J & KIMBERLY A</td><td>3</td><td>206,526</td><td>0</td><td>22,718</td><td>2,115.00</td></tr> <tr><td>2017</td><td>2017-660013753</td><td>SLAUF, LEONARD J & KIMBERLY A</td><td>3</td><td>204,483</td><td>0</td><td>22,493</td><td>2,116.00</td></tr> <tr><td>2016</td><td>2016-660013753</td><td>SLAUF, LEONARD J & KIMBERLY A</td><td>3</td><td>200,411</td><td>0</td><td>22,045</td><td>2,076.00</td></tr> <tr><td>2015</td><td>2015-660013753</td><td>SLAUF, LEONARD J & KIMBERLY A</td><td>3</td><td>177,068</td><td>0</td><td>9,341</td><td>886.00</td></tr> <tr><td>2014</td><td>2014-660013753</td><td>HEASLET, DONALD R &</td><td>3</td><td>178,568</td><td>0</td><td>9,342</td><td>894.00</td></tr> <tr><td>2013</td><td>2013-660013753</td><td>HEASLET, DONALD R &</td><td>3</td><td>170,782</td><td>0</td><td>9,342</td><td>875.00</td></tr> </tbody> </table>										Tax Year	Statement Number	Billed Owner	Tax Area	Total Value	Exemptions	Taxable Value	Billed Tax	2025	2025-660013753	POOL, CHRIS A & LISA G	3	227,727	1000	24,050	2,356.00	2024	2024-660013753	POOL, CHRIS A & LISA G	3	234,859	1000	24,834	2,386.00	2023	2023-660013753	POOL, CHRIS A & LISA G	3	251,000	1000	26,610	2,494.00	2022	2022-660013753	POOL, CHRIS A & LISA G	3	251,000	0	27,610	2,705.00	2021	2021-660013753	POOL, CHRIS A & LISA G	3	210,040	0	23,104	2,235.00	2020	2020-660013753	SLAUF, LEONARD J & KIMBERLY A	3	207,014	0	22,772	2,200.00	2019	2019-660013753	SLAUF, LEONARD J & KIMBERLY A	3	199,589	0	21,955	2,122.00	2018	2018-660013753	SLAUF, LEONARD J & KIMBERLY A	3	206,526	0	22,718	2,115.00	2017	2017-660013753	SLAUF, LEONARD J & KIMBERLY A	3	204,483	0	22,493	2,116.00	2016	2016-660013753	SLAUF, LEONARD J & KIMBERLY A	3	200,411	0	22,045	2,076.00	2015	2015-660013753	SLAUF, LEONARD J & KIMBERLY A	3	177,068	0	9,341	886.00	2014	2014-660013753	HEASLET, DONALD R &	3	178,568	0	9,342	894.00	2013	2013-660013753	HEASLET, DONALD R &	3	170,782	0	9,342	875.00
Tax Year	Statement Number	Billed Owner	Tax Area	Total Value	Exemptions	Taxable Value	Billed Tax																																																																																																																		
2025	2025-660013753	POOL, CHRIS A & LISA G	3	227,727	1000	24,050	2,356.00																																																																																																																		
2024	2024-660013753	POOL, CHRIS A & LISA G	3	234,859	1000	24,834	2,386.00																																																																																																																		
2023	2023-660013753	POOL, CHRIS A & LISA G	3	251,000	1000	26,610	2,494.00																																																																																																																		
2022	2022-660013753	POOL, CHRIS A & LISA G	3	251,000	0	27,610	2,705.00																																																																																																																		
2021	2021-660013753	POOL, CHRIS A & LISA G	3	210,040	0	23,104	2,235.00																																																																																																																		
2020	2020-660013753	SLAUF, LEONARD J & KIMBERLY A	3	207,014	0	22,772	2,200.00																																																																																																																		
2019	2019-660013753	SLAUF, LEONARD J & KIMBERLY A	3	199,589	0	21,955	2,122.00																																																																																																																		
2018	2018-660013753	SLAUF, LEONARD J & KIMBERLY A	3	206,526	0	22,718	2,115.00																																																																																																																		
2017	2017-660013753	SLAUF, LEONARD J & KIMBERLY A	3	204,483	0	22,493	2,116.00																																																																																																																		
2016	2016-660013753	SLAUF, LEONARD J & KIMBERLY A	3	200,411	0	22,045	2,076.00																																																																																																																		
2015	2015-660013753	SLAUF, LEONARD J & KIMBERLY A	3	177,068	0	9,341	886.00																																																																																																																		
2014	2014-660013753	HEASLET, DONALD R &	3	178,568	0	9,342	894.00																																																																																																																		
2013	2013-660013753	HEASLET, DONALD R &	3	170,782	0	9,342	875.00																																																																																																																		



Rogers

Assessment Property Record Card for Tax Year 2026

Data provided by LISA DELOZIER County Assessor

Date 04/18/2026
 Time 07:10:26
 Page 2

Lot Data	Square-Foot - NBHD 1069 #1	Primary Image
Lot Size		
Lot Count		
Units Buildable	2	
Non-Ag Acres	1.1318	
Topography		
Street Access		
Utilities		
Amenities	LAND QUALITY	
	0	
	0	
Method	Square-Foot	
Base Lot Value	49,302.00 x 1.22 = 60,073	
Factor Value		
Adjustments	1.0000	
Lot Value	60,073	

Residential Data	
Type	1 Single Family Residence
Condition	3 - Average
Quality	2.5 - Fair
Architecture	
Style	100% One Story
Exterior Wall	100% Veneer, Masonry
Base/Total Area	1,736 / 1,736
Style	100% One Story
HVAC	100% Warmed & Cooled Air
Roof Cover	1 Composition Shingle
Area on Slab	1,736
Fixture/RghIn	22 /
Bed/F/H Bath	3 / 2.0 /
Basement Area	
Garage Type	570 Attached Garage - Unfinished
Remodel	
Year/Eff Age	1987 / 29



\\tsclient\T\LOGAN\LOGAN RESIDENTIAL VI\2022-8-12\IMG_001 8/12/2022

GRM Approach	
GRM Code	
Gross Rent	0.00
Indicated Value	

Multiple Regression			
MRA Code	1	Test	
Adusted R	0.8445		
Indicated Value	224,609	129.38	Per SqFt

Direct Comparables			
Selection Model	A	Adam Test	
Adjustment Model	1	2022 Residential	
Comparables	6		
Indicated Value	334,290		Per SqFt

Cost Approach				Manual : 01/2025			
Base Cost	96.61	Total Misc Impr	+	8,508			
Roofing Adj	+ 4.10	Garage Cost	+	15,191			
Subfloor Adj	+ -1.09	Total RCN	=	243,980			
Heat/Cool Adj	+ 11.47	Depreciation (39%)	-	95,152			
Plumbing Adj	+ 15.80	Lump Sums	+	0			
Basement Adj	+ 0.00	RCNLD	=	148,828			
Adj Base Cost	= 126.89	Lot Value	+	60,073			
Total Area	x 1,736	Indicated Value	=	208,901			
Adjusted Cost	= 220,281	Value Per SqFt		120.33			

Value Reconciliation			
Selected Approach	Cost Approach		
Improvements	148,828		
Lot Value	60,073		
Indicated Value	208,901	120.33	Per SqFt
Agland Value			
Site Improvements	33,522		
Total Value	242,423	139.64	Total Value Per SqFt

Miscellaneous Improvements								
Code	Description	Sketch ID	Size	Year	Units	Unit Cost	Depr	Value
PRCH	SLAB PORCH - COVERED	32954	23x16		368	23.12		8,508



Rogers

Assessment Property Record Card for Tax Year 2026

Data provided by LISA DELOZIER County Assessor

Date 04/18/2026

Time 07:10:26

Page 3

Sketch Image

660013753

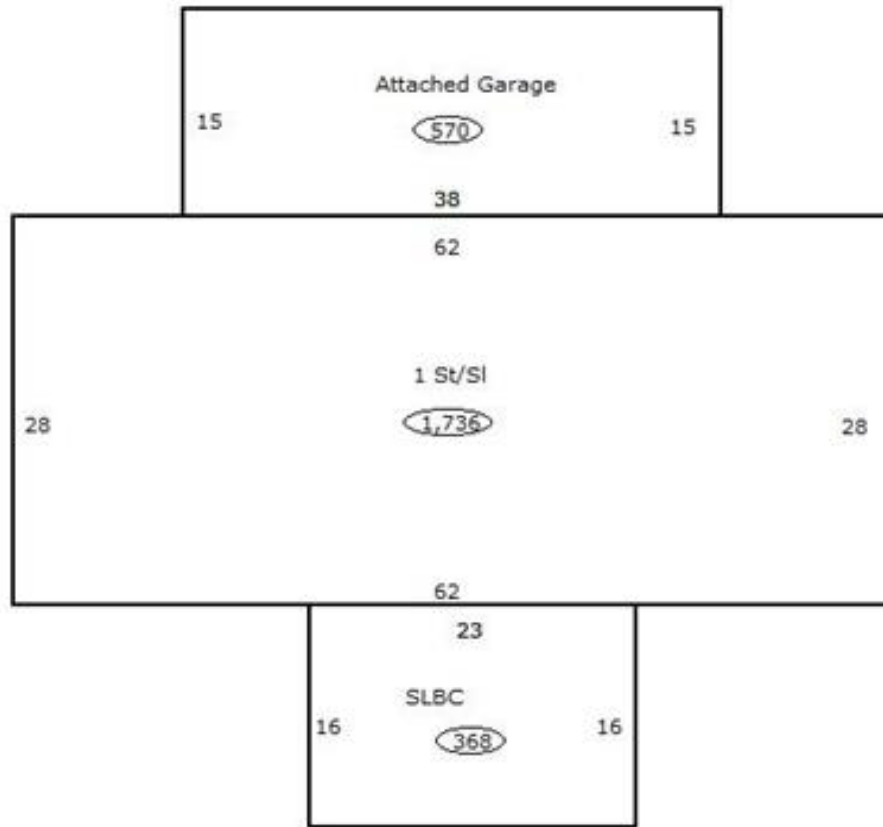

Sketch Vector Information

Sequence	Code	Type	Built Over	Scale	Section Label	Base Area	Multiplier	Total Area
1	R	1	Slab	13	1 St/SI	1,736	1.000	1,736
2	M	PRCH		13	SLBC	368	1.000	368
3	G	1		13	Attached Garage	570	1.000	570
Total Building Area						1,736		1,736



Rogers



Assessment Property Record Card for Tax Year 2026

Data provided by LISA DELOZIER County Assessor

Date 04/18/2026
Time 07:10:26
Page 4

660013753

Outbuildings/Site Improvements

Building Image	Code	Description	Dimensions	Floor	Roofing	Total Units
	LF	LOAFING SHED	12x12x0			144
	Qual	3	Cond 3	Year 2018	Eff Age	
	Valuation Summary		Modifier Total	RCN	Depr (25% Phys/ % Func)	RCNLD
	Base Cost (4.26 x 144)		613		613 153	460
	UTIL	SHOP BUILDING	40x40x0			1,600
	Qual	3	Cond 3	Year	Eff Age	
	Valuation Summary		Modifier Total	RCN	Depr (30% Phys/ % Func)	RCNLD
	Base Cost (29.52 x 1,600)		47,232		47,232 14,170	33,062
	STF	STG FAIR	10x16x0			160
	Qual	2	Cond 3	Year	Eff Age 1520	
	Valuation Summary		Modifier Total	RCN	Depr (100% Phys/ % Func)	RCNLD
	Base Cost (4.68 x 160)		749		749 749	