



Rogers

Assessment Property Record Card for Tax Year 2026

Data provided by LISA DELOZIER County Assessor

Date 04/16/2026
Time 22:18:38
Page 1

Assessment Data					Primary Image																																																																																																																				
Account 660013870 Parcel ID 000000-00-0-00936-001-0005 Cadastral ID 14-21-15-03270 Property Type REAL - Real Property Property Class RRP VI Area 4 Tax Area 18 - CLAREMORE RURAL/W/O FIRE Name ID 326345 HOFFMAN, HUNTER J 21488 S COLT AVE CLAREMORE OK 74019-0000 Parcel Location Situs 21488 S COLT AVE Subdivision WINCHESTER HEIGHTS II Lot/Block 0005 / 0001 Parcel Size 1 - Lots Sec/Twn/Rng 14 / 21 / 15 / 5 Neighborhood 1209 - R-V03,3-SW CLAREMORE School District S001 - CLAREMORE SCHOOLS																																																																																																																									
Legal Description Lot/Long: 36.30112780 -95.68469481 LOT 5 BLOCK 1 WINCHESTER HEIGHTS 2																																																																																																																									
Exemptions <table border="1"> <thead> <tr> <th>Code</th> <th>Type</th> <th>Active</th> <th>Maximum</th> <th>Exemption</th> </tr> </thead> <tbody> <tr> <td>H</td> <td>Homestead</td> <td>Yes</td> <td>1,000</td> <td>1,000</td> </tr> </tbody> </table>					Code	Type	Active	Maximum	Exemption	H	Homestead	Yes	1,000	1,000	Building Permits <table border="1"> <thead> <tr> <th>Number</th> <th>Description</th> <th>Opened</th> <th>Closed</th> <th>Amount</th> </tr> </thead> <tbody> <tr> <td>R18</td> <td>R20- POSS REMODEL</td> <td>12/2018</td> <td>12/2019</td> <td></td> </tr> </tbody> </table>					Number	Description	Opened	Closed	Amount	R18	R20- POSS REMODEL	12/2018	12/2019																																																																																													
Code	Type	Active	Maximum	Exemption																																																																																																																					
H	Homestead	Yes	1,000	1,000																																																																																																																					
Number	Description	Opened	Closed	Amount																																																																																																																					
R18	R20- POSS REMODEL	12/2018	12/2019																																																																																																																						
Parcel Valuation <table border="1"> <thead> <tr> <th>Source</th> <th>REAL</th> <th>Fair Cash</th> <th>Capped</th> <th>Asmnt Level</th> <th>Assessed</th> <th>Levy Rate</th> <th>92.430</th> <th>Current Tax</th> </tr> </thead> <tbody> <tr> <td>Remove Cap</td> <td>2019</td> <td>Land Value</td> <td>93,181</td> <td>35,232</td> <td>11%</td> <td>3,876</td> <td>Assessed</td> <td>18,319 1,693.23</td> </tr> <tr> <td>Year Frozen</td> <td>0</td> <td>Improvements</td> <td>138,696</td> <td>131,302</td> <td></td> <td>14,443</td> <td>Penalty</td> <td>0</td> </tr> <tr> <td>Uncapped Value</td> <td>0</td> <td>Mobile Home</td> <td>0</td> <td>0</td> <td></td> <td>0</td> <td>Exemption</td> <td>1,000 -92.00</td> </tr> <tr> <td>TIF Project ID</td> <td>0</td> <td>Total Value</td> <td>231,877</td> <td>166,534</td> <td></td> <td>18,319</td> <td>Total Taxable</td> <td>17,319 1,601.00</td> </tr> </tbody> </table>					Source	REAL	Fair Cash	Capped	Asmnt Level	Assessed	Levy Rate	92.430	Current Tax	Remove Cap	2019	Land Value	93,181	35,232	11%	3,876	Assessed	18,319 1,693.23	Year Frozen	0	Improvements	138,696	131,302		14,443	Penalty	0	Uncapped Value	0	Mobile Home	0	0		0	Exemption	1,000 -92.00	TIF Project ID	0	Total Value	231,877	166,534		18,319	Total Taxable	17,319 1,601.00	Sale History <table border="1"> <thead> <tr> <th>Bk/Pg</th> <th>Grantor</th> <th>Date</th> <th>Price</th> <th>Code</th> </tr> </thead> <tbody> <tr> <td>/</td> <td>JPMORGAN CHASE BANK NA</td> <td>09/26/2018</td> <td>121,000</td> <td>3</td> </tr> <tr> <td>2722/292</td> <td>JONES, ROGER</td> <td>06/20/2018</td> <td>0</td> <td>10</td> </tr> <tr> <td>2236/601</td> <td>JOHNSON, JOLEEN L</td> <td>03/26/2012</td> <td>140,000</td> <td>YES</td> </tr> <tr> <td>857/654</td> <td></td> <td></td> <td>76,000</td> <td>No</td> </tr> </tbody> </table>					Bk/Pg	Grantor	Date	Price	Code	/	JPMORGAN CHASE BANK NA	09/26/2018	121,000	3	2722/292	JONES, ROGER	06/20/2018	0	10	2236/601	JOHNSON, JOLEEN L	03/26/2012	140,000	YES	857/654			76,000	No																																										
Source	REAL	Fair Cash	Capped	Asmnt Level	Assessed	Levy Rate	92.430	Current Tax																																																																																																																	
Remove Cap	2019	Land Value	93,181	35,232	11%	3,876	Assessed	18,319 1,693.23																																																																																																																	
Year Frozen	0	Improvements	138,696	131,302		14,443	Penalty	0																																																																																																																	
Uncapped Value	0	Mobile Home	0	0		0	Exemption	1,000 -92.00																																																																																																																	
TIF Project ID	0	Total Value	231,877	166,534		18,319	Total Taxable	17,319 1,601.00																																																																																																																	
Bk/Pg	Grantor	Date	Price	Code																																																																																																																					
/	JPMORGAN CHASE BANK NA	09/26/2018	121,000	3																																																																																																																					
2722/292	JONES, ROGER	06/20/2018	0	10																																																																																																																					
2236/601	JOHNSON, JOLEEN L	03/26/2012	140,000	YES																																																																																																																					
857/654			76,000	No																																																																																																																					
Assessment History <table border="1"> <thead> <tr> <th>Tax Year</th> <th>Statement Number</th> <th>Billed Owner</th> <th>Tax Area</th> <th>Total Value</th> <th>Exemptions</th> <th>Taxable Value</th> <th>Billed Tax</th> </tr> </thead> <tbody> <tr><td>2025</td><td>2025-660013870</td><td>HOFFMAN, HUNTER J</td><td>18</td><td>227,027</td><td>1000</td><td>16,786</td><td>1,552.00</td></tr> <tr><td>2024</td><td>2024-660013870</td><td>HOFFMAN, HUNTER J</td><td>18</td><td>217,899</td><td>1000</td><td>16,267</td><td>1,503.00</td></tr> <tr><td>2023</td><td>2023-660013870</td><td>HOFFMAN, HUNTER J</td><td>18</td><td>152,403</td><td>1000</td><td>15,764</td><td>1,444.00</td></tr> <tr><td>2022</td><td>2022-660013870</td><td>HOFFMAN, HUNTER J</td><td>18</td><td>148,641</td><td>1000</td><td>15,351</td><td>1,421.00</td></tr> <tr><td>2021</td><td>2021-660013870</td><td>HOFFMAN, HUNTER J</td><td>18</td><td>158,688</td><td>1000</td><td>16,456</td><td>1,453.00</td></tr> <tr><td>2020</td><td>2020-660013870</td><td>HOFFMAN, HUNTER J</td><td>18</td><td>156,258</td><td>1000</td><td>16,081</td><td>1,473.00</td></tr> <tr><td>2019</td><td>2019-660013870</td><td>HOFFMAN, HUNTER J</td><td>18</td><td>129,864</td><td>1000</td><td>13,285</td><td>1,230.00</td></tr> <tr><td>2018</td><td>2018-660013870</td><td>JPMORGAN CHASE BANK NA</td><td>18</td><td>156,261</td><td>1000</td><td>16,189</td><td>1,496.00</td></tr> <tr><td>2017</td><td>2017-660013870</td><td>JONES, ROGER</td><td>18</td><td>155,028</td><td>1000</td><td>16,053</td><td>1,473.00</td></tr> <tr><td>2016</td><td>2016-660013870</td><td>JONES, ROGER</td><td>18</td><td>151,342</td><td>1000</td><td>15,648</td><td>1,467.00</td></tr> <tr><td>2015</td><td>2015-660013870</td><td>JONES, ROGER</td><td>18</td><td>148,689</td><td>1000</td><td>15,356</td><td>1,383.00</td></tr> <tr><td>2014</td><td>2014-660013870</td><td>JONES, ROGER</td><td>18</td><td>150,280</td><td>1000</td><td>15,151</td><td>1,405.00</td></tr> <tr><td>2013</td><td>2013-660013870</td><td>JONES, ROGER</td><td>18</td><td>142,554</td><td>1000</td><td>14,681</td><td>1,343.00</td></tr> </tbody> </table>										Tax Year	Statement Number	Billed Owner	Tax Area	Total Value	Exemptions	Taxable Value	Billed Tax	2025	2025-660013870	HOFFMAN, HUNTER J	18	227,027	1000	16,786	1,552.00	2024	2024-660013870	HOFFMAN, HUNTER J	18	217,899	1000	16,267	1,503.00	2023	2023-660013870	HOFFMAN, HUNTER J	18	152,403	1000	15,764	1,444.00	2022	2022-660013870	HOFFMAN, HUNTER J	18	148,641	1000	15,351	1,421.00	2021	2021-660013870	HOFFMAN, HUNTER J	18	158,688	1000	16,456	1,453.00	2020	2020-660013870	HOFFMAN, HUNTER J	18	156,258	1000	16,081	1,473.00	2019	2019-660013870	HOFFMAN, HUNTER J	18	129,864	1000	13,285	1,230.00	2018	2018-660013870	JPMORGAN CHASE BANK NA	18	156,261	1000	16,189	1,496.00	2017	2017-660013870	JONES, ROGER	18	155,028	1000	16,053	1,473.00	2016	2016-660013870	JONES, ROGER	18	151,342	1000	15,648	1,467.00	2015	2015-660013870	JONES, ROGER	18	148,689	1000	15,356	1,383.00	2014	2014-660013870	JONES, ROGER	18	150,280	1000	15,151	1,405.00	2013	2013-660013870	JONES, ROGER	18	142,554	1000	14,681	1,343.00
Tax Year	Statement Number	Billed Owner	Tax Area	Total Value	Exemptions	Taxable Value	Billed Tax																																																																																																																		
2025	2025-660013870	HOFFMAN, HUNTER J	18	227,027	1000	16,786	1,552.00																																																																																																																		
2024	2024-660013870	HOFFMAN, HUNTER J	18	217,899	1000	16,267	1,503.00																																																																																																																		
2023	2023-660013870	HOFFMAN, HUNTER J	18	152,403	1000	15,764	1,444.00																																																																																																																		
2022	2022-660013870	HOFFMAN, HUNTER J	18	148,641	1000	15,351	1,421.00																																																																																																																		
2021	2021-660013870	HOFFMAN, HUNTER J	18	158,688	1000	16,456	1,453.00																																																																																																																		
2020	2020-660013870	HOFFMAN, HUNTER J	18	156,258	1000	16,081	1,473.00																																																																																																																		
2019	2019-660013870	HOFFMAN, HUNTER J	18	129,864	1000	13,285	1,230.00																																																																																																																		
2018	2018-660013870	JPMORGAN CHASE BANK NA	18	156,261	1000	16,189	1,496.00																																																																																																																		
2017	2017-660013870	JONES, ROGER	18	155,028	1000	16,053	1,473.00																																																																																																																		
2016	2016-660013870	JONES, ROGER	18	151,342	1000	15,648	1,467.00																																																																																																																		
2015	2015-660013870	JONES, ROGER	18	148,689	1000	15,356	1,383.00																																																																																																																		
2014	2014-660013870	JONES, ROGER	18	150,280	1000	15,151	1,405.00																																																																																																																		
2013	2013-660013870	JONES, ROGER	18	142,554	1000	14,681	1,343.00																																																																																																																		



Rogers

Assessment Property Record Card for Tax Year 2026

Data provided by LISA DELOZIER County Assessor

Date 04/16/2026
Time 22:18:39
Page 2

Lot Data	Square-Foot - NBHD 1209 #1	Primary Image
Lot Size		
Lot Count		
Units Buildable	1	
Non-Ag Acres	1.469	
Topography		
Street Access		
Utilities		
Amenities	LAND QUALITY	
	0	
	0	
Method	Square-Foot	
Base Lot Value	63,988.00 x 1.46 = 93,181	
Factor Value		
Adjustments	1.0000	
Lot Value	93,181	

Residential Data	
Type	1 Single Family Residence
Condition	3 - Average
Quality	2.5 - Fair
Architecture	
Style	100% One Story
Exterior Wall	70% Veneer, Masonry 30% Frame, Siding, Vinyl
Base/Total Area	1,664 / 1,664
Style	100% One Story
HVAC	100% Warmed & Cooled Air
Roof Cover	1 Composition Shingle
Area on Slab	1,664
Fixture/RghIn	11 /
Bed/F/H Bath	3 / 2.0 /
Basement Area	
Garage Type	676 Attached Garage - Unfinished
Remodel	
Year/Eff Age	1987 / 29

\\tsclient\C\Users\Randy Necessary\Pictures\101_0727\IMG_0066. 7/28/2022

GRM Approach	
GRM Code	
Gross Rent	0.00
Indicated Value	

Multiple Regression			
MRA Code	1	Test	
Adusted R	0.8445		
Indicated Value	196,144	117.88	Per SqFt

Direct Comparables			
Selection Model	A	Adam Test	
Adjustment Model	1	2022 Residential	
Comparables	6		
Indicated Value	246,060		Per SqFt

Cost Approach				Manual : 01/2025			
Base Cost	94.96	Total Misc Impr	+	13,626			
Roofing Adj	+ 4.13	Garage Cost	+	17,508			
Subfloor Adj	+ -1.09	Total RCN	=	227,370			
Heat/Cool Adj	+ 11.47	Depreciation (39%)	-	88,674			
Plumbing Adj	+ 8.46	Lump Sums	+	0			
Basement Adj	+ 0.00	RCNLD	=	138,696			
Adj Base Cost	= 117.93	Lot Value	+	93,181			
Total Area	x 1,664	Indicated Value	=	231,877			
Adjusted Cost	= 196,236	Value Per SqFt		139.35			

Value Reconciliation			
Selected Approach	Cost Approach		
Improvements	138,696		
Lot Value	93,181		
Indicated Value	231,877	139.35	Per SqFt
Agland Value			
Site Improvements			
Total Value	231,877	139.35	Total Value Per SqFt

Miscellaneous Improvements								
Code	Description	Sketch ID	Size	Year	Units	Unit Cost	Depr	Value
FPR1	FIREPLACE - RESIDENTIAL 1 STORY	0		1	1	5,095.98		5,096
PRCH	SLAB PORCH - COVERED	33288	52x6		312	23.23		7,248
PATO	SLAB PORCH - OPEN	33289	12x10		120	10.68		1,282



Rogers

Assessment Property Record Card for Tax Year 2026

Data provided by LISA DELOZIER County Assessor

Date 04/16/2026

Time 22:18:39

Page 3

Sketch Image

660013870

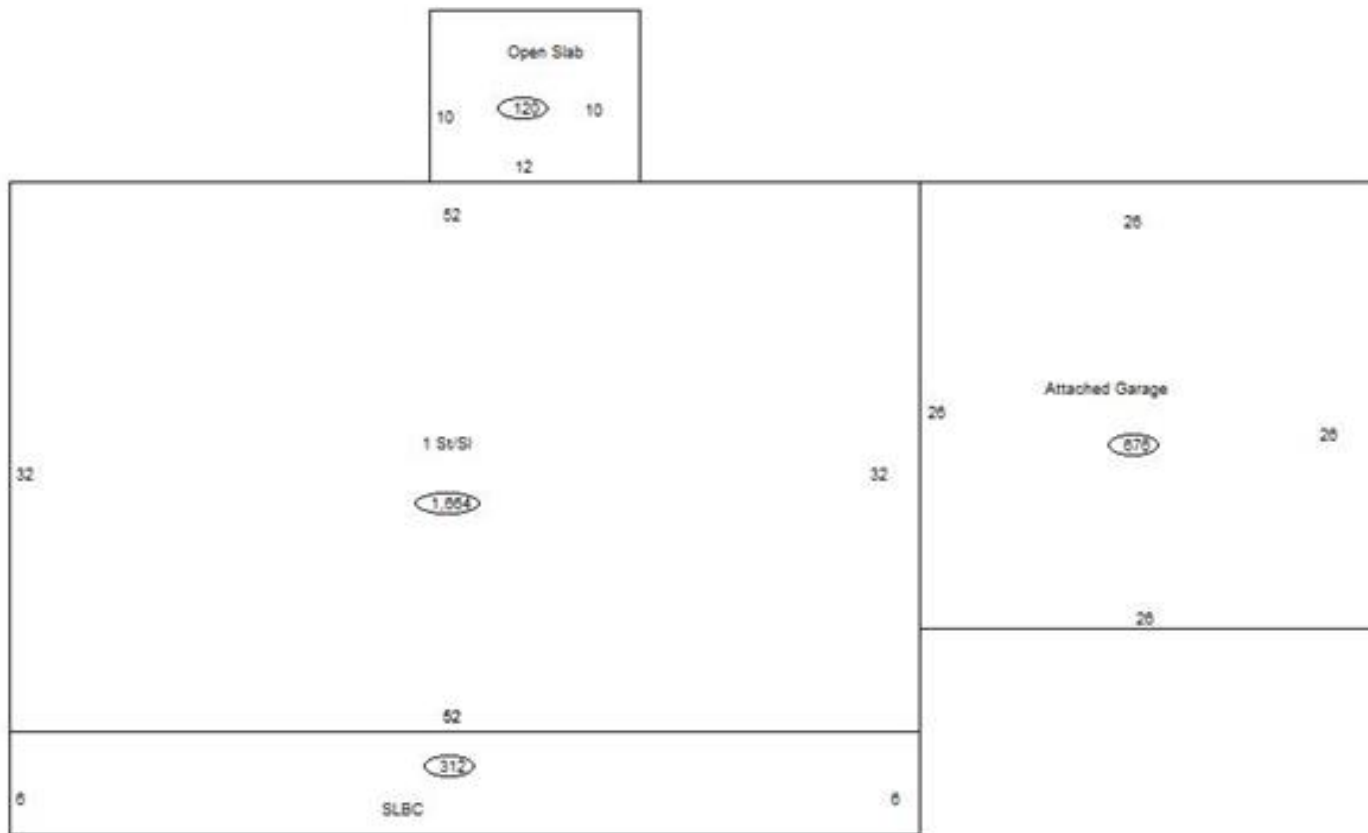

Sketch Vector Information

Sequence	Code	Type	Built Over	Scale	Section Label	Base Area	Multiplier	Total Area
1	R	1	Slab	10	1 St/SI	1,664	1.000	1,664
2	G	1		10	Attached Garage	676	1.000	676
3	M	PRCH		10	SLBC	312	1.000	312
4	M	PATO		10	Open Slab	120	1.000	120
Total Building Area						1,664		1,664