



# Rogers

## Assessment Property Record Card for Tax Year 2026

Data provided by LISA DELOZIER County Assessor

Date 04/16/2026  
Time 22:51:16  
Page 1

Assessment Data					Primary Image																																																																																																																				
<b>Account</b> 660014023 <b>Parcel ID</b> 22N15E-14-2-00000-000-0000 <b>Cadastral ID</b> 14-22-15-00800 <b>Property Type</b> REAL - Real Property <b>Property Class</b> RR VI Area 4 <b>Tax Area</b> 10 - OOLOGAH RURAL/NW FIRE <b>Name ID</b> 315981 HORNER, TIMOTHY GENE & ANITA LOUISE TRUSTEES HORNER FAMILY TRUST 8461 E 435 RD UNIT B CLAREMORE OK 74017-0000					<p>05/17/2022</p> <p>\\\\tsclient\\T\\TOMMY DUNLAP\\051722 (66)\\IMG_0018.JPG 5/17/2022</p>																																																																																																																				
<b>Parcel Location</b> <b>Situs</b> 08461 E 435 RD UNIT <b>Subdivision</b> <b>Lot/Block</b> / <b>Parcel Size</b> .94 - Acres <b>Sec/Twn/Rng</b> 14 / 22 / 15 / 2 <b>Neighborhood</b> 6020 - UNPLATTED <b>School District</b> S004 - OOLOGAH SCHOOLS																																																																																																																									
<b>Legal Description</b> Lat/Long: 36.38763525 -95.67904016 TR CONTAINED IN SE 9.95 AC OF GOVT LOT 1 DESC 2647-656 AS COMM SE/C OF SE LOT 1; N89.5811W 330' TO POB; N89.5811W 150'; N05.1244E 195'; S89.5811E 47'; N00.0432W 211'; S89.5811E 85.03'; S00 0432E 405.20' TO POB LESS PORTION DEEDED TO ROGERS COUNTY ON BOOK 187-336					<b>Building Permits</b> <table border="1"> <thead> <tr> <th>Number</th> <th>Description</th> <th>Opened</th> <th>Closed</th> <th>Amount</th> </tr> </thead> <tbody> <tr> <td></td> <td></td> <td></td> <td></td> <td></td> </tr> </tbody> </table>					Number	Description	Opened	Closed	Amount																																																																																																											
Number	Description	Opened	Closed	Amount																																																																																																																					
<b>Exemptions</b> <table border="1"> <thead> <tr> <th>Code</th> <th>Type</th> <th>Active</th> <th>Maximum</th> <th>Exemption</th> </tr> </thead> <tbody> <tr> <td>H</td> <td>Homestead</td> <td>No</td> <td>1,000</td> <td></td> </tr> <tr> <td>PD</td> <td>Add-Homestead</td> <td>No</td> <td>1,000</td> <td></td> </tr> </tbody> </table>					Code	Type	Active	Maximum	Exemption	H	Homestead	No	1,000		PD	Add-Homestead	No	1,000		<b>Sale History</b> <table border="1"> <thead> <tr> <th>Bk/Pg</th> <th>Grantor</th> <th>Date</th> <th>Price</th> <th>Code</th> </tr> </thead> <tbody> <tr> <td>2647/656</td> <td>HORNER, TIMOTHY G &amp; ANITA L</td> <td>07/19/2017</td> <td>0</td> <td>4</td> </tr> <tr> <td>2494/216</td> <td>HORNER, ELTA MAE</td> <td>08/24/2015</td> <td>0</td> <td>4</td> </tr> </tbody> </table>					Bk/Pg	Grantor	Date	Price	Code	2647/656	HORNER, TIMOTHY G & ANITA L	07/19/2017	0	4	2494/216	HORNER, ELTA MAE	08/24/2015	0	4																																																																																		
Code	Type	Active	Maximum	Exemption																																																																																																																					
H	Homestead	No	1,000																																																																																																																						
PD	Add-Homestead	No	1,000																																																																																																																						
Bk/Pg	Grantor	Date	Price	Code																																																																																																																					
2647/656	HORNER, TIMOTHY G & ANITA L	07/19/2017	0	4																																																																																																																					
2494/216	HORNER, ELTA MAE	08/24/2015	0	4																																																																																																																					
<b>Parcel Valuation</b> <table border="1"> <thead> <tr> <th>Source</th> <th>REAL</th> <th>Fair Cash</th> <th>Capped</th> <th>Asmnt Level</th> <th>Assessed</th> <th>Levy Rate</th> <th>108.182</th> <th>Current Tax</th> </tr> </thead> <tbody> <tr> <td>Remove Cap</td> <td>0</td> <td>Land Value 19,564</td> <td>14,125</td> <td>11%</td> <td>1,554</td> <td>Assessed</td> <td>6,844</td> <td>740.39</td> </tr> <tr> <td>Year Frozen</td> <td>2002</td> <td>Improvements 54,856</td> <td>48,094</td> <td></td> <td>5,290</td> <td>Penalty</td> <td>0</td> <td></td> </tr> <tr> <td>Uncapped Value</td> <td>0</td> <td>Mobile Home 0</td> <td>0</td> <td></td> <td>0</td> <td>Exemption</td> <td>0</td> <td>0.00</td> </tr> <tr> <td>TIF Project ID</td> <td>0</td> <td>Total Value 74,420</td> <td>62,219</td> <td></td> <td>6,844</td> <td>Total Taxable</td> <td>6,844</td> <td>740.00</td> </tr> </tbody> </table>										Source	REAL	Fair Cash	Capped	Asmnt Level	Assessed	Levy Rate	108.182	Current Tax	Remove Cap	0	Land Value 19,564	14,125	11%	1,554	Assessed	6,844	740.39	Year Frozen	2002	Improvements 54,856	48,094		5,290	Penalty	0		Uncapped Value	0	Mobile Home 0	0		0	Exemption	0	0.00	TIF Project ID	0	Total Value 74,420	62,219		6,844	Total Taxable	6,844	740.00																																																																			
Source	REAL	Fair Cash	Capped	Asmnt Level	Assessed	Levy Rate	108.182	Current Tax																																																																																																																	
Remove Cap	0	Land Value 19,564	14,125	11%	1,554	Assessed	6,844	740.39																																																																																																																	
Year Frozen	2002	Improvements 54,856	48,094		5,290	Penalty	0																																																																																																																		
Uncapped Value	0	Mobile Home 0	0		0	Exemption	0	0.00																																																																																																																	
TIF Project ID	0	Total Value 74,420	62,219		6,844	Total Taxable	6,844	740.00																																																																																																																	
<b>Assessment History</b> <table border="1"> <thead> <tr> <th>Tax Year</th> <th>Statement Number</th> <th>Billed Owner</th> <th>Tax Area</th> <th>Total Value</th> <th>Exemptions</th> <th>Taxable Value</th> <th>Billed Tax</th> </tr> </thead> <tbody> <tr><td>2025</td><td>2025-660014023</td><td>HORNER, TIMOTHY GENE &amp;</td><td>10</td><td>72,730</td><td>0</td><td>6,519</td><td>705.00</td></tr> <tr><td>2024</td><td>2024-660014023</td><td>HORNER, TIMOTHY G &amp; ANITA L</td><td>10</td><td>76,586</td><td>0</td><td>6,208</td><td>650.00</td></tr> <tr><td>2023</td><td>2023-660014023</td><td>HORNER, TIMOTHY G &amp; ANITA L</td><td>10</td><td>64,973</td><td>0</td><td>5,912</td><td>615.00</td></tr> <tr><td>2022</td><td>2022-660014023</td><td>HORNER, TIMOTHY G &amp; ANITA L</td><td>10</td><td>66,959</td><td>0</td><td>5,630</td><td>583.00</td></tr> <tr><td>2021</td><td>2021-660014023</td><td>HORNER, TIMOTHY G &amp; ANITA L</td><td>10</td><td>69,113</td><td>0</td><td>5,363</td><td>559.00</td></tr> <tr><td>2020</td><td>2020-660014023</td><td>HORNER, TIMOTHY G &amp; ANITA L</td><td>10</td><td>68,160</td><td>0</td><td>5,107</td><td>540.00</td></tr> <tr><td>2019</td><td>2019-660014023</td><td>HORNER, TIMOTHY G &amp; ANITA L</td><td>10</td><td>66,193</td><td>0</td><td>4,864</td><td>505.00</td></tr> <tr><td>2018</td><td>2018-660014023</td><td>HORNER, TIMOTHY G &amp; ANITA L</td><td>10</td><td>71,234</td><td>0</td><td>4,633</td><td>498.00</td></tr> <tr><td>2017</td><td>2017-660014023</td><td>HORNER, TIMOTHY G &amp; ANITA L</td><td>10</td><td>70,721</td><td>0</td><td>4,412</td><td>502.00</td></tr> <tr><td>2016</td><td>2016-660014023</td><td>HORNER, TIMOTHY G &amp; ANITA L</td><td>10</td><td>76,877</td><td>0</td><td>5,753</td><td>596.00</td></tr> <tr><td>2015</td><td>2015-660014023</td><td>HORNER, TIMOTHY G &amp; ANITA L</td><td>10</td><td>75,641</td><td>2000</td><td>3,479</td><td>367.00</td></tr> <tr><td>2014</td><td>2014-660014023</td><td>HORNER, ELTA MAE</td><td>10</td><td>76,106</td><td>2000</td><td>3,479</td><td>363.00</td></tr> <tr><td>2013</td><td>2013-660014023</td><td>HORNER, ELTA MAE</td><td>10</td><td>74,423</td><td>2000</td><td>3,479</td><td>352.00</td></tr> </tbody> </table>										Tax Year	Statement Number	Billed Owner	Tax Area	Total Value	Exemptions	Taxable Value	Billed Tax	2025	2025-660014023	HORNER, TIMOTHY GENE &	10	72,730	0	6,519	705.00	2024	2024-660014023	HORNER, TIMOTHY G & ANITA L	10	76,586	0	6,208	650.00	2023	2023-660014023	HORNER, TIMOTHY G & ANITA L	10	64,973	0	5,912	615.00	2022	2022-660014023	HORNER, TIMOTHY G & ANITA L	10	66,959	0	5,630	583.00	2021	2021-660014023	HORNER, TIMOTHY G & ANITA L	10	69,113	0	5,363	559.00	2020	2020-660014023	HORNER, TIMOTHY G & ANITA L	10	68,160	0	5,107	540.00	2019	2019-660014023	HORNER, TIMOTHY G & ANITA L	10	66,193	0	4,864	505.00	2018	2018-660014023	HORNER, TIMOTHY G & ANITA L	10	71,234	0	4,633	498.00	2017	2017-660014023	HORNER, TIMOTHY G & ANITA L	10	70,721	0	4,412	502.00	2016	2016-660014023	HORNER, TIMOTHY G & ANITA L	10	76,877	0	5,753	596.00	2015	2015-660014023	HORNER, TIMOTHY G & ANITA L	10	75,641	2000	3,479	367.00	2014	2014-660014023	HORNER, ELTA MAE	10	76,106	2000	3,479	363.00	2013	2013-660014023	HORNER, ELTA MAE	10	74,423	2000	3,479	352.00
Tax Year	Statement Number	Billed Owner	Tax Area	Total Value	Exemptions	Taxable Value	Billed Tax																																																																																																																		
2025	2025-660014023	HORNER, TIMOTHY GENE &	10	72,730	0	6,519	705.00																																																																																																																		
2024	2024-660014023	HORNER, TIMOTHY G & ANITA L	10	76,586	0	6,208	650.00																																																																																																																		
2023	2023-660014023	HORNER, TIMOTHY G & ANITA L	10	64,973	0	5,912	615.00																																																																																																																		
2022	2022-660014023	HORNER, TIMOTHY G & ANITA L	10	66,959	0	5,630	583.00																																																																																																																		
2021	2021-660014023	HORNER, TIMOTHY G & ANITA L	10	69,113	0	5,363	559.00																																																																																																																		
2020	2020-660014023	HORNER, TIMOTHY G & ANITA L	10	68,160	0	5,107	540.00																																																																																																																		
2019	2019-660014023	HORNER, TIMOTHY G & ANITA L	10	66,193	0	4,864	505.00																																																																																																																		
2018	2018-660014023	HORNER, TIMOTHY G & ANITA L	10	71,234	0	4,633	498.00																																																																																																																		
2017	2017-660014023	HORNER, TIMOTHY G & ANITA L	10	70,721	0	4,412	502.00																																																																																																																		
2016	2016-660014023	HORNER, TIMOTHY G & ANITA L	10	76,877	0	5,753	596.00																																																																																																																		
2015	2015-660014023	HORNER, TIMOTHY G & ANITA L	10	75,641	2000	3,479	367.00																																																																																																																		
2014	2014-660014023	HORNER, ELTA MAE	10	76,106	2000	3,479	363.00																																																																																																																		
2013	2013-660014023	HORNER, ELTA MAE	10	74,423	2000	3,479	352.00																																																																																																																		



# Rogers

## Assessment Property Record Card for Tax Year 2026

Data provided by LISA DELOZIER County Assessor

Date 04/16/2026  
Time 22:51:16  
Page 2

Lot Data		Square-Foot - NBHD 6020 #1	
Lot Size	0	0	
Lot Count	0		
Units Buildable	0		
Non-Ag Acres	0.8982		
Topography			
Street Access			
Utilities			
Amenities	LAND QUALITY		0
			0
Method	Square-Foot		
Base Lot Value	39,127.00 x .50 = 19,564		
Factor Value			
Adjustments	1.0000		
Lot Value	19,564		



\\tsclient\T\TOMMY DUNLAP\051722 (66)\IMG\_0018.JPG 5/17/2022

Residential Data	
Type	1 Single Family Residence
Condition	3 - Average
Quality	2 - Fair
Architecture	
Style	100% One Story
Exterior Wall	100% Frame, Siding, Vinyl
Base/Total Area	1,304 / 1,304
Style	100% One Story
HVAC	100% Wall Furnace
Roof Cover	1 Composition Shingle
Area on Slab	0
Fixture/RghIn	4 /
Bed/F/H Bath	3 / 1.0 /
Basement Area	
Garage Type	
Remodel	
Year/Eff Age	1957 / 52

### GRM Approach

GRM Code	
Gross Rent	0.00
Indicated Value	

### Multiple Regression

MRA Code	1 Test
Adjusted R	0.8445
Indicated Value	71,095 54.52 Per SqFt

### Direct Comparables

Selection Model	1 Res
Adjustment Model	A2 AO Test
Comparables	
Indicated Value	

### Value Reconciliation

Selected Approach	Cost Approach
Improvements	54,856
Lot Value	19,564
Indicated Value	74,420 57.07 Per SqFt
Agland Value	
Site Improvements	
Total Value	74,420 57.07 Total Value Per SqFt

Cost Approach		Manual : 01/2025	
Base Cost	88.51	Total Misc Impr	+ 7,496
Roofing Adj	+ 4.00	Garage Cost	+
Subfloor Adj	+ 2.31	Total RCN	= 137,140
Heat/Cool Adj	+ 0.76	Depreciation ( 60%)	- 82,284
Plumbing Adj	+ 3.84	Lump Sums	+ 0
Basement Adj	+ 0.00	RCNLD	= 54,856
Adj Base Cost	= 99.42	Lot Value	+ 19,564
Total Area	x 1,304	Indicated Value	= 74,420
Adjusted Cost	= 129,644	Value Per SqFt	57.07

### Miscellaneous Improvements

Code	Description	Sketch ID	Size	Year	Units	Unit Cost	Depr	Value
FPR1	FIREPLACE - RESIDENTIAL 1 STORY	0		1	1	4,576.55		4,577
PRCH	SLAB PORCH - COVERED	33762	20x7		140	20.85		2,919



# Rogers

## Assessment Property Record Card for Tax Year 2026

Data provided by LISA DELOZIER County Assessor

Date 04/16/2026

Time 22:51:16

Page 3

### Sketch Image

660014023

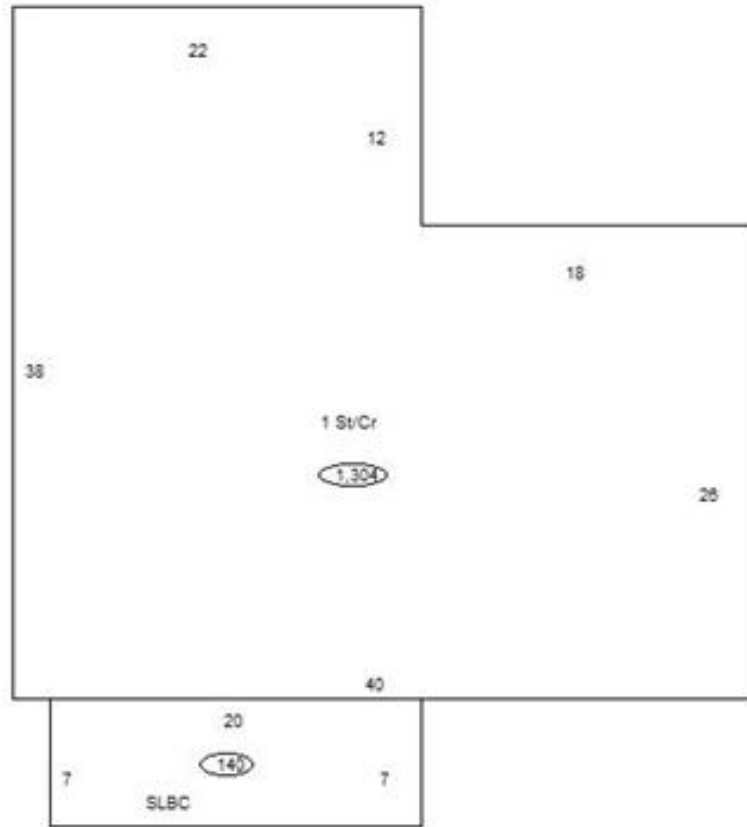

### Sketch Vector Information

Sequence	Code	Type	Built Over	Scale	Section Label	Base Area	Multiplier	Total Area
1	R	1	Crawl	10	1 St/Cr	1,304	1.000	1,304
2	M	PRCH		10	SLBC	140	1.000	140
<b>Total Building Area</b>						1,304		1,304