



Rogers

Assessment Property Record Card for Tax Year 2026

Data provided by LISA DELOZIER County Assessor

Date 04/16/2026
Time 22:51:20
Page 1

Assessment Data					Primary Image																																																																																																																				
Account 660014026 Parcel ID 22N15E-14-2-00000-000-0000 Cadastral ID 14-22-15-01100 Property Type REAL - Real Property Property Class RR VI Area 4 Tax Area 10 - OOLOGAH RURAL/NW FIRE Name ID 315981 HORNER, TIMOTHY GENE & ANITA LOUISE TRUSTEES HORNER FAMILY TRUST 8461 E 435 RD UNIT B CLAREMORE OK 74017-0000																																																																																																																									
Parcel Location Situs 08461 E 435 RD UNIT Subdivision Lot/Block / Parcel Size 6.4 - Acres Sec/Twn/Rng 14 / 22 / 15 / 2 Neighborhood 6020 - UNPLATTED School District S004 - OOLOGAH SCHOOLS																																																																																																																									
Legal Description Lat/Long: 36.38826107 -95.67899563 TR IN SE 9.95 AC OF LOT 1 DESC 2647-655 AS COMM SE/C SE LOT 1; N89.5811W 480' TO POB; N05.1244E 195'; S89.5811E 47'; N00.0432W 211'; S89.5811E 85.03'; S00.0432E 93.20'; S89.5811E 330.00'; N00 0432W 348.74' TO NE/C OF SE LOT 1; N89.5752W 660.17' TO NW/C SE LOT 1; S00.0238E 660.80'; S89.5811E 180.54' TO POB					Building Permits <table border="1"> <thead> <tr> <th>Number</th> <th>Description</th> <th>Opened</th> <th>Closed</th> <th>Amount</th> </tr> </thead> <tbody> <tr> <td></td> <td></td> <td></td> <td></td> <td></td> </tr> </tbody> </table>					Number	Description	Opened	Closed	Amount																																																																																																											
Number	Description	Opened	Closed	Amount																																																																																																																					
Exemptions <table border="1"> <thead> <tr> <th>Code</th> <th>Type</th> <th>Active</th> <th>Maximum</th> <th>Exemption</th> </tr> </thead> <tbody> <tr> <td>H</td> <td>Homestead</td> <td>Yes</td> <td>1,000</td> <td>1,000</td> </tr> </tbody> </table>					Code	Type	Active	Maximum	Exemption	H	Homestead	Yes	1,000	1,000	Sale History <table border="1"> <thead> <tr> <th>Bk/Pg</th> <th>Grantor</th> <th>Date</th> <th>Price</th> <th>Code</th> </tr> </thead> <tbody> <tr> <td>2647/654</td> <td>HORNER, TIMOTHY G</td> <td>07/19/2017</td> <td>0</td> <td>4</td> </tr> </tbody> </table>					Bk/Pg	Grantor	Date	Price	Code	2647/654	HORNER, TIMOTHY G	07/19/2017	0	4																																																																																												
Code	Type	Active	Maximum	Exemption																																																																																																																					
H	Homestead	Yes	1,000	1,000																																																																																																																					
Bk/Pg	Grantor	Date	Price	Code																																																																																																																					
2647/654	HORNER, TIMOTHY G	07/19/2017	0	4																																																																																																																					
Parcel Valuation <table border="1"> <thead> <tr> <th>Source</th> <th>REAL</th> <th>Fair Cash</th> <th>Capped</th> <th>Asmnt Level</th> <th>Assessed</th> <th>Levy Rate</th> <th>108.182</th> <th>Current Tax</th> </tr> </thead> <tbody> <tr> <td>Remove Cap</td> <td>0</td> <td>Land Value 70,949</td> <td>51,762</td> <td>11%</td> <td>5,694</td> <td>Assessed</td> <td>14,028</td> <td>1,517.57</td> </tr> <tr> <td>Year Frozen</td> <td>0</td> <td>Improvements 98,791</td> <td>75,767</td> <td></td> <td>8,334</td> <td>Penalty</td> <td>0</td> <td></td> </tr> <tr> <td>Uncapped Value</td> <td>0</td> <td>Mobile Home 0</td> <td>0</td> <td></td> <td>0</td> <td>Exemption</td> <td>1,000</td> <td>-95.00</td> </tr> <tr> <td>TIF Project ID</td> <td>0</td> <td>Total Value 169,740</td> <td>127,529</td> <td></td> <td>14,028</td> <td>Total Taxable</td> <td>13,028</td> <td>1,423.00</td> </tr> </tbody> </table>										Source	REAL	Fair Cash	Capped	Asmnt Level	Assessed	Levy Rate	108.182	Current Tax	Remove Cap	0	Land Value 70,949	51,762	11%	5,694	Assessed	14,028	1,517.57	Year Frozen	0	Improvements 98,791	75,767		8,334	Penalty	0		Uncapped Value	0	Mobile Home 0	0		0	Exemption	1,000	-95.00	TIF Project ID	0	Total Value 169,740	127,529		14,028	Total Taxable	13,028	1,423.00																																																																			
Source	REAL	Fair Cash	Capped	Asmnt Level	Assessed	Levy Rate	108.182	Current Tax																																																																																																																	
Remove Cap	0	Land Value 70,949	51,762	11%	5,694	Assessed	14,028	1,517.57																																																																																																																	
Year Frozen	0	Improvements 98,791	75,767		8,334	Penalty	0																																																																																																																		
Uncapped Value	0	Mobile Home 0	0		0	Exemption	1,000	-95.00																																																																																																																	
TIF Project ID	0	Total Value 169,740	127,529		14,028	Total Taxable	13,028	1,423.00																																																																																																																	
Assessment History <table border="1"> <thead> <tr> <th>Tax Year</th> <th>Statement Number</th> <th>Billed Owner</th> <th>Tax Area</th> <th>Total Value</th> <th>Exemptions</th> <th>Taxable Value</th> <th>Billed Tax</th> </tr> </thead> <tbody> <tr><td>2025</td><td>2025-660014026</td><td>HORNER, TIMOTHY GENE &</td><td>10</td><td>160,205</td><td>1000</td><td>12,620</td><td>1,379.00</td></tr> <tr><td>2024</td><td>2024-660014026</td><td>HORNER, TIMOTHY G & ANITA L</td><td>10</td><td>164,316</td><td>1000</td><td>12,223</td><td>1,294.00</td></tr> <tr><td>2023</td><td>2023-660014026</td><td>HORNER, TIMOTHY G & ANITA L</td><td>10</td><td>123,304</td><td>1000</td><td>11,838</td><td>1,245.00</td></tr> <tr><td>2022</td><td>2022-660014026</td><td>HORNER, TIMOTHY G & ANITA L</td><td>10</td><td>121,162</td><td>1000</td><td>11,464</td><td>1,201.00</td></tr> <tr><td>2021</td><td>2021-660014026</td><td>HORNER, TIMOTHY G & ANITA L</td><td>10</td><td>110,009</td><td>1000</td><td>11,101</td><td>1,171.00</td></tr> <tr><td>2020</td><td>2020-660014026</td><td>HORNER, TIMOTHY G & ANITA L</td><td>10</td><td>111,643</td><td>1000</td><td>11,271</td><td>1,206.00</td></tr> <tr><td>2019</td><td>2019-660014026</td><td>HORNER, TIMOTHY G & ANITA L</td><td>10</td><td>108,301</td><td>1000</td><td>10,913</td><td>1,147.00</td></tr> <tr><td>2018</td><td>2018-660014026</td><td>HORNER, TIMOTHY G & ANITA L</td><td>10</td><td>114,282</td><td>1000</td><td>10,647</td><td>1,158.00</td></tr> <tr><td>2017</td><td>2017-660014026</td><td>HORNER, TIMOTHY G & ANITA L</td><td>10</td><td>113,698</td><td>1000</td><td>10,308</td><td>1,185.00</td></tr> <tr><td>2016</td><td>2016-660014026</td><td>HORNER, TIMOTHY G</td><td>10</td><td>98,959</td><td>1000</td><td>8,428</td><td>887.00</td></tr> <tr><td>2015</td><td>2015-660014026</td><td>HORNER, TIMOTHY G</td><td>10</td><td>97,315</td><td>1000</td><td>8,154</td><td>812.00</td></tr> <tr><td>2014</td><td>2014-660014026</td><td>HORNER, TIMOTHY G</td><td>10</td><td>90,779</td><td>1000</td><td>6,870</td><td>684.00</td></tr> <tr><td>2013</td><td>2013-660014026</td><td>HORNER, TIMOTHY G</td><td>10</td><td>89,216</td><td>1000</td><td>6,642</td><td>640.00</td></tr> </tbody> </table>										Tax Year	Statement Number	Billed Owner	Tax Area	Total Value	Exemptions	Taxable Value	Billed Tax	2025	2025-660014026	HORNER, TIMOTHY GENE &	10	160,205	1000	12,620	1,379.00	2024	2024-660014026	HORNER, TIMOTHY G & ANITA L	10	164,316	1000	12,223	1,294.00	2023	2023-660014026	HORNER, TIMOTHY G & ANITA L	10	123,304	1000	11,838	1,245.00	2022	2022-660014026	HORNER, TIMOTHY G & ANITA L	10	121,162	1000	11,464	1,201.00	2021	2021-660014026	HORNER, TIMOTHY G & ANITA L	10	110,009	1000	11,101	1,171.00	2020	2020-660014026	HORNER, TIMOTHY G & ANITA L	10	111,643	1000	11,271	1,206.00	2019	2019-660014026	HORNER, TIMOTHY G & ANITA L	10	108,301	1000	10,913	1,147.00	2018	2018-660014026	HORNER, TIMOTHY G & ANITA L	10	114,282	1000	10,647	1,158.00	2017	2017-660014026	HORNER, TIMOTHY G & ANITA L	10	113,698	1000	10,308	1,185.00	2016	2016-660014026	HORNER, TIMOTHY G	10	98,959	1000	8,428	887.00	2015	2015-660014026	HORNER, TIMOTHY G	10	97,315	1000	8,154	812.00	2014	2014-660014026	HORNER, TIMOTHY G	10	90,779	1000	6,870	684.00	2013	2013-660014026	HORNER, TIMOTHY G	10	89,216	1000	6,642	640.00
Tax Year	Statement Number	Billed Owner	Tax Area	Total Value	Exemptions	Taxable Value	Billed Tax																																																																																																																		
2025	2025-660014026	HORNER, TIMOTHY GENE &	10	160,205	1000	12,620	1,379.00																																																																																																																		
2024	2024-660014026	HORNER, TIMOTHY G & ANITA L	10	164,316	1000	12,223	1,294.00																																																																																																																		
2023	2023-660014026	HORNER, TIMOTHY G & ANITA L	10	123,304	1000	11,838	1,245.00																																																																																																																		
2022	2022-660014026	HORNER, TIMOTHY G & ANITA L	10	121,162	1000	11,464	1,201.00																																																																																																																		
2021	2021-660014026	HORNER, TIMOTHY G & ANITA L	10	110,009	1000	11,101	1,171.00																																																																																																																		
2020	2020-660014026	HORNER, TIMOTHY G & ANITA L	10	111,643	1000	11,271	1,206.00																																																																																																																		
2019	2019-660014026	HORNER, TIMOTHY G & ANITA L	10	108,301	1000	10,913	1,147.00																																																																																																																		
2018	2018-660014026	HORNER, TIMOTHY G & ANITA L	10	114,282	1000	10,647	1,158.00																																																																																																																		
2017	2017-660014026	HORNER, TIMOTHY G & ANITA L	10	113,698	1000	10,308	1,185.00																																																																																																																		
2016	2016-660014026	HORNER, TIMOTHY G	10	98,959	1000	8,428	887.00																																																																																																																		
2015	2015-660014026	HORNER, TIMOTHY G	10	97,315	1000	8,154	812.00																																																																																																																		
2014	2014-660014026	HORNER, TIMOTHY G	10	90,779	1000	6,870	684.00																																																																																																																		
2013	2013-660014026	HORNER, TIMOTHY G	10	89,216	1000	6,642	640.00																																																																																																																		



Rogers

Assessment Property Record Card for Tax Year 2026

Data provided by LISA DELOZIER County Assessor

Date 04/16/2026
 Time 22:51:20
 Page 2

Lot Data		Square-Foot - NBHD 6020 #1
Lot Size		
Lot Count	0	
Units Buildable		
Non-Ag Acres	6.3939	
Topography		
Street Access		
Utilities		
Amenities	LAND QUALITY	0
		0
Method	Square-Foot	
Base Lot Value	278,517.00 x .25 = 70,949	
Factor Value		
Adjustments	1.0000	
Lot Value	70,949	



\\tsclient\T\TOMMY DUNLAP\051722 (66)\IMG_0019.JPG 5/17/2022

Residential Data	
Type	1 Single Family Residence
Condition	3 - Average
Quality	2 - Fair
Architecture	
Style	100% One Story
Exterior Wall	100% Frame, Siding, Vinyl
Base/Total Area	1,896 / 1,896
Style	100% One Story
HVAC	100% Warmed & Cooled Air
Roof Cover	4 Metal, Preformed
Area on Slab	0
Fixture/RghIn	8 /
Bed/F/H Bath	3 / 2.0 /
Basement Area	
Garage Type	
Remodel	
Year/Eff Age	1944 / 62

GRM Approach	
GRM Code	
Gross Rent	0.00
Indicated Value	

Multiple Regression			
MRA Code	1	Test	
Adusted R	0.8445		
Indicated Value	127,723	67.36	Per SqFt

Direct Comparables	
Selection Model	1 Res
Adjustment Model	A2 AO Test
Comparables	
Indicated Value	

Cost Approach				Manual : 01/2025	
Base Cost	81.51	Total Misc Impr	+	2,181	
Roofing Adj	+ 4.43	Garage Cost	+		
Subfloor Adj	+ 2.43	Total RCN	=	198,626	
Heat/Cool Adj	+ 10.30	Depreciation (69%)	-	137,052	
Plumbing Adj	+ 4.94	Lump Sums	+	0	
Basement Adj	+ 0.00	RCNLD	=	61,574	
Adj Base Cost	= 103.61	Lot Value	+	70,949	
Total Area	x 1,896	Indicated Value	=	132,523	
Adjusted Cost	= 196,445	Value Per SqFt		69.90	

Value Reconciliation			
Selected Approach	Cost Approach		
Improvements	61,574		
Lot Value	70,949		
Indicated Value	132,523	69.90	Per SqFt
Agland Value			
Site Improvements	37,217		
Total Value	169,740	89.53	Total Value Per SqFt

Miscellaneous Improvements								
Code	Description	Sketch ID	Size	Year	Units	Unit Cost	Depr	Value
PRCH	SLAB PORCH - COVERED	33773	13x8		104	20.97		2,181



Rogers

Assessment Property Record Card for Tax Year 2026

Data provided by LISA DELOZIER County Assessor

Date 04/16/2026

Time 22:51:20

Page 3

Sketch Image

660014026

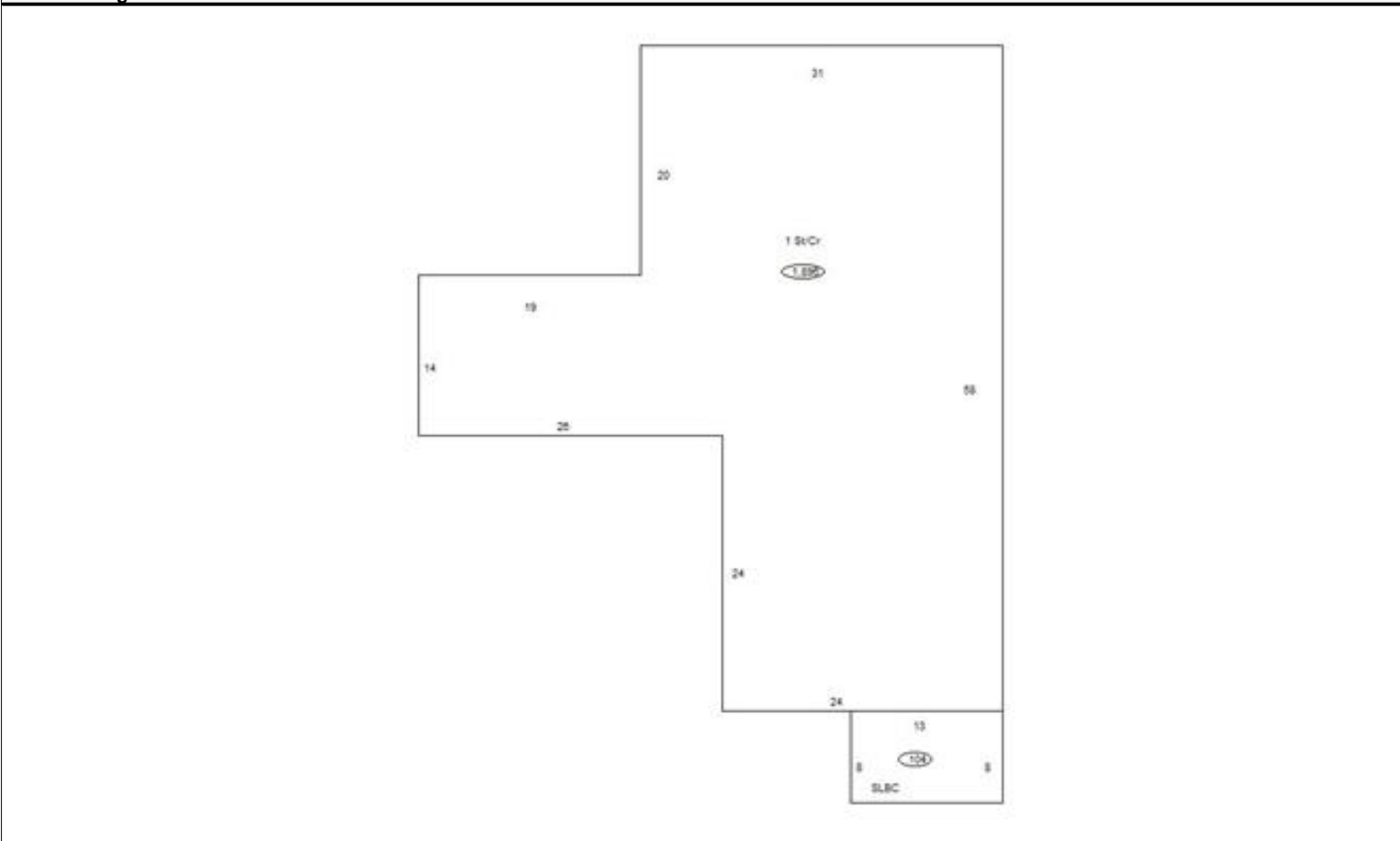

Sketch Vector Information

Sequence	Code	Type	Built Over	Scale	Section Label	Base Area	Multiplier	Total Area
1	R	1	Crawl	10	1 St/Cr	1,896	1.000	1,896
2	M	PRCH		10	SLBC	104	1.000	104
Total Building Area						1,896		1,896



Rogers



Assessment Property Record Card for Tax Year 2026

Data provided by LISA DELOZIER County Assessor

Date 04/16/2026
Time 22:51:20
Page 4

660014026

Outbuildings/Site Improvements

Building Image	Code	Description	Dimensions	Floor	Roofing	Total Units
	UTIL	SHOP BUILDING	30x40x0			1,200
	Qual 2	Cond 3	Year 2014	Eff Age 9		
	Valuation Summary		Modifier Total	RCN	Depr (0% Phys/ % Func)	RCNLD
	Base Cost (28.97 x 1,200)		34,764		34,764	34,764
	LF	LOAFING SHED	0x0x0			640
	Qual 3	Cond 3	Year	Eff Age		
	Valuation Summary		Modifier Total	RCN	Depr (10% Phys/ % Func)	RCNLD
	Base Cost (4.26 x 640)		2,726		2,726	2,453