



# Rogers

## Assessment Property Record Card for Tax Year 2026

Data provided by LISA DELOZIER County Assessor

Date 04/16/2026  
 Time 22:10:12  
 Page 1

Assessment Data					Primary Image																			
<b>Account</b> 660014309 <b>Parcel ID</b> 000000-00-0-00378-002-0003 <b>Cadastral ID</b> 15-21-14-02080 <b>Property Type</b> REAL - Real Property <b>Property Class</b> RRP VI Area 4 <b>Tax Area</b> 3 - OWASSO RURAL/NO FIRE <b>Name ID</b> 308821 STRONG, ROBERT & KRISTAL  9919 N 149TH E AVE OWASSO OK 74055-0000  <b>Parcel Location</b> <b>Situs</b> 09919 N 149TH E AVE <b>Subdivision</b> HIGHLAND TERRACE <b>Lot/Block</b> 0003 / 0002 Parcel Size 1 - Lots <b>Sec/Twn/Rng</b> 15 / 21 / 14 / 5 <b>Neighborhood</b> 1069 - R-V04-SW OWASSO <b>School District</b> S021 - OWASSO SCHOOLS					<p>\\tsclient\T\TOM\COMMERCIAL PICS\2022-08-30\IMG_0072.JPG 8/31/2022</p>																			
<b>Legal Description</b> Lat/Long: 36.29852732 -95.80647307																								
<b>LOT 3 BLOCK 2 HIGHLAND TERRACE</b>					<b>Building Permits</b> <table border="1"> <thead> <tr> <th>Number</th> <th>Description</th> <th>Opened</th> <th>Closed</th> <th>Amount</th> </tr> </thead> <tbody> <tr> <td>R23 297</td> <td>R24 NEW DTCH ACC BLDG 30X40</td> <td>10/2023</td> <td>03/2024</td> <td>70,000</td> </tr> <tr> <td>P21 000055</td> <td>R22- NEW POOL (REPLACING OLD ON</td> <td>07/2021</td> <td>10/2021</td> <td>50,000</td> </tr> </tbody> </table>					Number	Description	Opened	Closed	Amount	R23 297	R24 NEW DTCH ACC BLDG 30X40	10/2023	03/2024	70,000	P21 000055	R22- NEW POOL (REPLACING OLD ON	07/2021	10/2021	50,000
Number	Description	Opened	Closed	Amount																				
R23 297	R24 NEW DTCH ACC BLDG 30X40	10/2023	03/2024	70,000																				
P21 000055	R22- NEW POOL (REPLACING OLD ON	07/2021	10/2021	50,000																				
<b>Exemptions</b>					<b>Sale History</b>																			
<b>Code</b>	<b>Type</b>	<b>Active</b>	<b>Maximum</b>	<b>Exemption</b>	<b>Bk/Pg</b>	<b>Grantor</b>	<b>Date</b>	<b>Price</b>	<b>Code</b>															
H	Homestead	Yes	1,000	1,000	2293/547	HODSON, MATTHEW SCOTT	12/13/2012	174,000	YES															
					2282/331	HODSON, HAROLD D JR	11/01/2012	0	4															
<b>Parcel Valuation</b>																								
<b>Source</b>	<b>REAL</b>		<b>Fair Cash</b>	<b>Capped</b>	<b>Asmnt Level</b>	<b>Assessed</b>	<b>Levy Rate</b>	97.960	<b>Current Tax</b>															
Remove Cap	2013		Land Value 58,678	50,505	11%	5,556	Assessed	28,264	2,768.74															
Year Frozen	0		Improvements 212,079	206,432		22,708	Penalty	0																
Uncapped Value	0		Mobile Home 0	0		0	Exemption	1,000	-98.00															
TIF Project ID	0		Total Value 270,757	256,937		28,264	Total Taxable	27,264	2,671.00															
<b>Assessment History</b>																								
<b>Tax Year</b>	<b>Statement Number</b>	<b>Billed Owner</b>			<b>Tax Area</b>	<b>Total Value</b>	<b>Exemptions</b>	<b>Taxable Value</b>	<b>Billed Tax</b>															
2025	2025-660014309	STRONG, ROBERT & KRISTAL			3	259,098	1000	26,440	2,590.00															
2024	2024-660014309	STRONG, ROBERT & KRISTAL			3	272,208	1000	22,814	2,192.00															
2023	2023-660014309	STRONG, ROBERT & KRISTAL			3	219,680	1000	22,120	2,073.00															
2022	2022-660014309	STRONG, ROBERT & KRISTAL			3	204,062	1000	21,447	2,101.00															
2021	2021-660014309	STRONG, ROBERT & KRISTAL			3	184,355	0	20,279	1,962.00															
2020	2020-660014309	STRONG, ROBERT & KRISTAL			3	181,432	0	19,958	1,928.00															
2019	2019-660014309	STRONG, ROBERT & KRISTAL			3	174,296	0	19,173	1,853.00															
2018	2018-660014309	STRONG, ROBERT & KRISTAL			3	193,008	0	21,231	1,976.00															
2017	2017-660014309	STRONG, ROBERT & KRISTAL			3	191,038	0	21,014	1,977.00															
2016	2016-660014309	STRONG, ROBERT & KRISTAL			3	186,518	0	20,517	1,932.00															
2015	2015-660014309	STRONG, ROBERT & KRISTAL			3	181,490	0	19,964	1,893.00															
2014	2014-660014309	STRONG, ROBERT & KRISTAL			3	183,105	0	20,070	1,921.00															
2013	2013-660014309	STRONG, ROBERT & KRISTAL			3	173,767	0	19,114	1,791.00															



# Rogers

## Assessment Property Record Card for Tax Year 2026

Data provided by LISA DELOZIER County Assessor

Date 04/16/2026  
Time 22:10:13  
Page 2

Lot Data	Square-Foot - NBHD 1069 #1	Primary Image
Lot Size		
Lot Count	1	
Units Buildable	1	
Non-Ag Acres	1.0784	
Topography		
Street Access		
Utilities		
Amenities	LAND QUALITY	
	0	
	0	
Method	Square-Foot	
Base Lot Value	46,976.00 x 1.25 = 58,678	
Factor Value		
Adjustments	1.0000	
Lot Value	58,678	

Residential Data	
Type	1 Single Family Residence
Condition	3 - Average
Quality	2.5 - Fair
Architecture	
Style	100% One Story
Exterior Wall	90% Veneer, Masonry 10% Frame, Siding, Wood
Base/Total Area	1,981 / 1,981
Style	100% One Story
HVAC	100% Warmed & Cooled Air
Roof Cover	1 Composition Shingle
Area on Slab	1,981
Fixture/RghIn	8 /
Bed/F/H Bath	3 / 2.0 /
Basement Area	
Garage Type	594 Attached Garage - Unfinished
Remodel	
Year/Eff Age	1975 / 38

\\tsclient\T\TOM\COMMERCIAL PICS\2022-08-30\IMG_0072.JPG	8/31/2022
--	-----------

GRM Approach	
GRM Code	
Gross Rent	0.00
Indicated Value	

Multiple Regression			
MRA Code	1	Test	
Adusted R	0.8445		
Indicated Value	256,949	129.71	Per SqFt

Direct Comparables	
Selection Model	A Adam Test
Adjustment Model	1 2022 Residential
Comparables	6
Indicated Value	267,910 Per SqFt

Value Reconciliation			
Selected Approach	Cost Approach		
Improvements	151,847		
Lot Value	58,678		
Indicated Value	210,525	106.27	Per SqFt
Agland Value			
Site Improvements	60,232		
Total Value	270,757	136.68	Total Value Per SqFt

Cost Approach				Manual : 01/2025			
Base Cost	100.28	Total Misc Impr	+	30,372			
Roofing Adj	+ 4.27	Garage Cost	+	15,670			
Subfloor Adj	+ -1.10	Total RCN	=	284,119			
Heat/Cool Adj	+ 11.47	Depreciation ( 47%)	-	133,536			
Plumbing Adj	+ 5.26	Lump Sums	+	1,264			
Basement Adj	+ 0.00	RCNLD	=	151,847			
Adj Base Cost	= 120.18	Lot Value	+	58,678			
Total Area	x 1,981	Indicated Value	=	210,525			
Adjusted Cost	= 238,077	Value Per SqFt		106.27			

Miscellaneous Improvements								
Code	Description	Sketch ID	Size	Year	Units	Unit Cost	Depr	Value
FPR1	FIREPLACE - RESIDENTIAL 1 STORY	0		1	1	5,095.98		5,096
PRCH	SLAB PORCH - COVERED	34285		165	165	23.70		3,911
WODO	WOOD DECK - OPEN	34286	17x12		204	20.66	70%	1,264
EPSW	ENCLOSED PORCH - SOLID WALL	34287	27x13		351	60.87		21,365



# Rogers

## Assessment Property Record Card for Tax Year 2026

Data provided by LISA DELOZIER County Assessor

Date 04/16/2026  
 Time 22:10:13  
 Page 3

Sketch Image

660014309

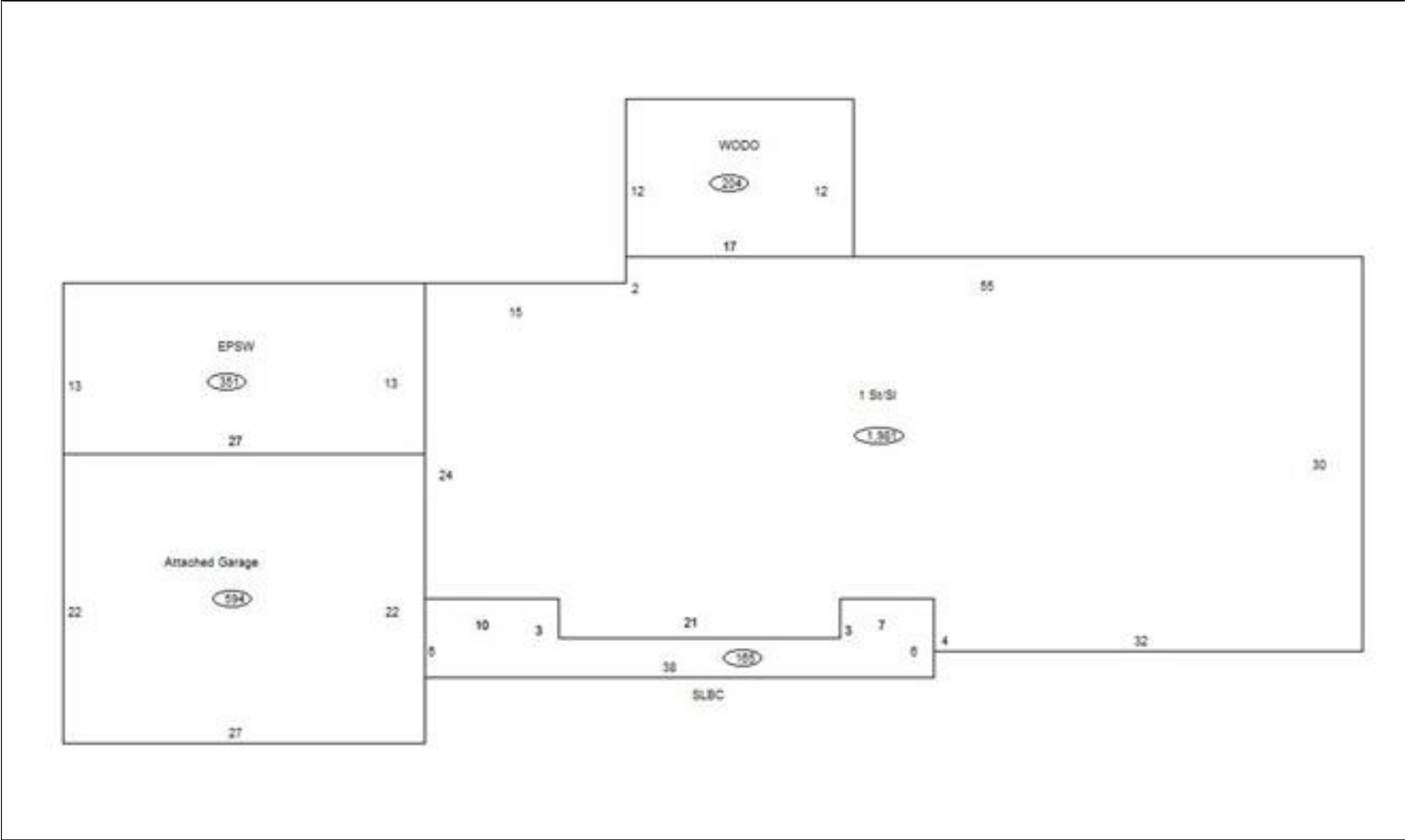

### Sketch Vector Information

Sequence	Code	Type	Built Over	Scale	Section Label	Base Area	Multiplier	Total Area
1	R	1	Slab	10	1 St/SI	1,981	1.000	1,981
2	G	1		10	Attached Garage	594	1.000	594
3	M	PRCH		10	SLBC	165	1.000	165
4	M	WODO		10	WODO	204	1.000	204
5	M	EPSW		10	EPSW	351	1.000	351
<b>Total Building Area</b>						1,981		1,981



# Rogers



## Assessment Property Record Card for Tax Year 2026

Data provided by LISA DELOZIER County Assessor

Date 04/16/2026  
 Time 22:10:13  
 Page 4

660014309

### Outbuildings/Site Improvements

Building Image	Code	Description	Dimensions	Floor	Roofing	Total Units	
	UTIL	Shop Building	30x40x12	Concrete	Formed Metal	1,200	
	Qual	3	Cond 3	Year 2024	Eff Age 2		
	<b>Valuation Summary</b>		<b>Modifier Total</b>		<b>RCN</b>	<b>Depr (3% Phys/ % Func)</b>	<b>RCNLD</b>
	Base Cost (31.23 x 1,200)		37,476		37,476	1,124	36,352
	SG	SWIM-GUNITE	0x0x0			1	
	Qual	3	Cond 3	Year 2021	Eff Age 4		
	<b>Valuation Summary</b>		<b>Modifier Total</b>		<b>RCN</b>	<b>Depr (21% Phys/ % Func)</b>	<b>RCNLD</b>
	Base Cost (30,000.00 x 1)		30,000		30,000	6,300	23,700
	STF	STG FAIR	0x0x0			128	
	Qual	2	Cond 3	Year	Eff Age		
	<b>Valuation Summary</b>		<b>Modifier Total</b>		<b>RCN</b>	<b>Depr (70% Phys/ % Func)</b>	<b>RCNLD</b>
	Base Cost (4.68 x 128)		599		599	419	180