



Rogers

Assessment Property Record Card for Tax Year 2026

Data provided by LISA DELOZIER County Assessor

Date 04/16/2026
Time 21:30:40
Page 1

Assessment Data					Primary Image																																																																																																																				
Account 660014398 Parcel ID 000000-00-0-00741-001-0007 Cadastral ID 15-21-14-03000 Property Type REAL - Real Property Property Class RRP VI Area 4 Tax Area 3 - OWASSO RURAL/NO FIRE Name ID 336819 QUILLMAN, MICHELLE 14509 E 99TH ST N OWASSO OK 74055-0000 Parcel Location Situs 14509 E 99TH ST N Subdivision SHERRI-LAVERNE ESTS Lot/Block 0007 / 0001 Parcel Size 1 - Lots Sec/Twn/Rng 15 / 21 / 14 / 5 Neighborhood 1069 - R-V04-SW OWASSO School District S021 - OWASSO SCHOOLS					<p>\\tsclient\T\TOMMY DUNLAP\New folder (106)\IMG_0071.JPG 9/7/2022</p>																																																																																																																				
Legal Description Lat/Long: 36.29809361 -95.81183769 LOT 7 BLOCK 1 SHERRI-LAVERNE EST.																																																																																																																									
Exemptions <table border="1"> <thead> <tr> <th>Code</th> <th>Type</th> <th>Active</th> <th>Maximum</th> <th>Exemption</th> </tr> </thead> <tbody> <tr> <td>H</td> <td>Homestead</td> <td>Yes</td> <td>1,000</td> <td>1,000</td> </tr> <tr> <td>H</td> <td>Homestead</td> <td>No</td> <td>1,000</td> <td></td> </tr> </tbody> </table>					Code	Type	Active	Maximum	Exemption	H	Homestead	Yes	1,000	1,000	H	Homestead	No	1,000		Building Permits <table border="1"> <thead> <tr> <th>Number</th> <th>Description</th> <th>Opened</th> <th>Closed</th> <th>Amount</th> </tr> </thead> <tbody> <tr> <td></td> <td></td> <td></td> <td></td> <td></td> </tr> </tbody> </table>					Number	Description	Opened	Closed	Amount																																																																																												
Code	Type	Active	Maximum	Exemption																																																																																																																					
H	Homestead	Yes	1,000	1,000																																																																																																																					
H	Homestead	No	1,000																																																																																																																						
Number	Description	Opened	Closed	Amount																																																																																																																					
Parcel Valuation <table border="1"> <thead> <tr> <th>Source</th> <th>REAL</th> <th>Fair Cash</th> <th>Capped</th> <th>Asmnt Level</th> <th>Assessed</th> <th>Levy Rate</th> <th>97.960</th> <th>Current Tax</th> </tr> </thead> <tbody> <tr> <td>Remove Cap</td> <td>2022</td> <td>Land Value</td> <td>60,429</td> <td>60,429</td> <td>11%</td> <td>6,647</td> <td>Assessed</td> <td>25,013 2,450.27</td> </tr> <tr> <td>Year Frozen</td> <td>0</td> <td>Improvements</td> <td>166,962</td> <td>166,962</td> <td></td> <td>18,366</td> <td>Penalty</td> <td>0</td> </tr> <tr> <td>Uncapped Value</td> <td>0</td> <td>Mobile Home</td> <td>0</td> <td>0</td> <td></td> <td>0</td> <td>Exemption</td> <td>1,000 -98.00</td> </tr> <tr> <td>TIF Project ID</td> <td>0</td> <td>Total Value</td> <td>227,391</td> <td>227,391</td> <td></td> <td>25,013</td> <td>Total Taxable</td> <td>24,013 2,352.00</td> </tr> </tbody> </table>					Source	REAL	Fair Cash	Capped	Asmnt Level	Assessed	Levy Rate	97.960	Current Tax	Remove Cap	2022	Land Value	60,429	60,429	11%	6,647	Assessed	25,013 2,450.27	Year Frozen	0	Improvements	166,962	166,962		18,366	Penalty	0	Uncapped Value	0	Mobile Home	0	0		0	Exemption	1,000 -98.00	TIF Project ID	0	Total Value	227,391	227,391		25,013	Total Taxable	24,013 2,352.00	Sale History <table border="1"> <thead> <tr> <th>Bk/Pg</th> <th>Grantor</th> <th>Date</th> <th>Price</th> <th>Code</th> </tr> </thead> <tbody> <tr> <td>/</td> <td>PHILLIPS, LOUELLA-ESTATE</td> <td>12/08/2021</td> <td>227,500</td> <td>YES</td> </tr> <tr> <td>925/392</td> <td>HAKEL, LAWRENCE J</td> <td>08/13/1993</td> <td>110,000</td> <td>Yes</td> </tr> </tbody> </table>					Bk/Pg	Grantor	Date	Price	Code	/	PHILLIPS, LOUELLA-ESTATE	12/08/2021	227,500	YES	925/392	HAKEL, LAWRENCE J	08/13/1993	110,000	Yes																																																				
Source	REAL	Fair Cash	Capped	Asmnt Level	Assessed	Levy Rate	97.960	Current Tax																																																																																																																	
Remove Cap	2022	Land Value	60,429	60,429	11%	6,647	Assessed	25,013 2,450.27																																																																																																																	
Year Frozen	0	Improvements	166,962	166,962		18,366	Penalty	0																																																																																																																	
Uncapped Value	0	Mobile Home	0	0		0	Exemption	1,000 -98.00																																																																																																																	
TIF Project ID	0	Total Value	227,391	227,391		25,013	Total Taxable	24,013 2,352.00																																																																																																																	
Bk/Pg	Grantor	Date	Price	Code																																																																																																																					
/	PHILLIPS, LOUELLA-ESTATE	12/08/2021	227,500	YES																																																																																																																					
925/392	HAKEL, LAWRENCE J	08/13/1993	110,000	Yes																																																																																																																					
Assessment History <table border="1"> <thead> <tr> <th>Tax Year</th> <th>Statement Number</th> <th>Billed Owner</th> <th>Tax Area</th> <th>Total Value</th> <th>Exemptions</th> <th>Taxable Value</th> <th>Billed Tax</th> </tr> </thead> <tbody> <tr><td>2025</td><td>2025-660014398</td><td>QUILLMAN, MICHELLE</td><td>3</td><td>221,916</td><td>1000</td><td>23,411</td><td>2,293.00</td></tr> <tr><td>2024</td><td>2024-660014398</td><td>QUILLMAN, MICHELLE</td><td>3</td><td>251,612</td><td>1000</td><td>24,775</td><td>2,380.00</td></tr> <tr><td>2023</td><td>2023-660014398</td><td>QUILLMAN, MICHELLE</td><td>3</td><td>227,500</td><td>0</td><td>25,025</td><td>2,345.00</td></tr> <tr><td>2022</td><td>2022-660014398</td><td>QUILLMAN, MICHELLE</td><td>3</td><td>227,500</td><td>0</td><td>25,025</td><td>2,452.00</td></tr> <tr><td>2021</td><td>2021-660014398</td><td>PHILLIPS, JAMES R &</td><td>3</td><td>191,631</td><td>1000</td><td>16,707</td><td>1,616.00</td></tr> <tr><td>2020</td><td>2020-660014398</td><td>PHILLIPS, JAMES R &</td><td>3</td><td>188,699</td><td>1000</td><td>16,191</td><td>1,564.00</td></tr> <tr><td>2019</td><td>2019-660014398</td><td>PHILLIPS, JAMES R &</td><td>3</td><td>181,716</td><td>1000</td><td>15,691</td><td>1,517.00</td></tr> <tr><td>2018</td><td>2018-660014398</td><td>PHILLIPS, JAMES R &</td><td>3</td><td>185,074</td><td>1000</td><td>15,204</td><td>1,415.00</td></tr> <tr><td>2017</td><td>2017-660014398</td><td>PHILLIPS, JAMES R &</td><td>3</td><td>183,648</td><td>1000</td><td>14,732</td><td>1,386.00</td></tr> <tr><td>2016</td><td>2016-660014398</td><td>PHILLIPS, JAMES R &</td><td>3</td><td>179,187</td><td>1000</td><td>14,275</td><td>1,344.00</td></tr> <tr><td>2015</td><td>2015-660014398</td><td>PHILLIPS, JAMES R &</td><td>3</td><td>173,792</td><td>1000</td><td>13,830</td><td>1,311.00</td></tr> <tr><td>2014</td><td>2014-660014398</td><td>PHILLIPS, JAMES R &</td><td>3</td><td>175,133</td><td>1000</td><td>13,397</td><td>1,282.00</td></tr> <tr><td>2013</td><td>2013-660014398</td><td>PHILLIPS, JAMES R &</td><td>3</td><td>165,787</td><td>1000</td><td>12,979</td><td>1,216.00</td></tr> </tbody> </table>										Tax Year	Statement Number	Billed Owner	Tax Area	Total Value	Exemptions	Taxable Value	Billed Tax	2025	2025-660014398	QUILLMAN, MICHELLE	3	221,916	1000	23,411	2,293.00	2024	2024-660014398	QUILLMAN, MICHELLE	3	251,612	1000	24,775	2,380.00	2023	2023-660014398	QUILLMAN, MICHELLE	3	227,500	0	25,025	2,345.00	2022	2022-660014398	QUILLMAN, MICHELLE	3	227,500	0	25,025	2,452.00	2021	2021-660014398	PHILLIPS, JAMES R &	3	191,631	1000	16,707	1,616.00	2020	2020-660014398	PHILLIPS, JAMES R &	3	188,699	1000	16,191	1,564.00	2019	2019-660014398	PHILLIPS, JAMES R &	3	181,716	1000	15,691	1,517.00	2018	2018-660014398	PHILLIPS, JAMES R &	3	185,074	1000	15,204	1,415.00	2017	2017-660014398	PHILLIPS, JAMES R &	3	183,648	1000	14,732	1,386.00	2016	2016-660014398	PHILLIPS, JAMES R &	3	179,187	1000	14,275	1,344.00	2015	2015-660014398	PHILLIPS, JAMES R &	3	173,792	1000	13,830	1,311.00	2014	2014-660014398	PHILLIPS, JAMES R &	3	175,133	1000	13,397	1,282.00	2013	2013-660014398	PHILLIPS, JAMES R &	3	165,787	1000	12,979	1,216.00
Tax Year	Statement Number	Billed Owner	Tax Area	Total Value	Exemptions	Taxable Value	Billed Tax																																																																																																																		
2025	2025-660014398	QUILLMAN, MICHELLE	3	221,916	1000	23,411	2,293.00																																																																																																																		
2024	2024-660014398	QUILLMAN, MICHELLE	3	251,612	1000	24,775	2,380.00																																																																																																																		
2023	2023-660014398	QUILLMAN, MICHELLE	3	227,500	0	25,025	2,345.00																																																																																																																		
2022	2022-660014398	QUILLMAN, MICHELLE	3	227,500	0	25,025	2,452.00																																																																																																																		
2021	2021-660014398	PHILLIPS, JAMES R &	3	191,631	1000	16,707	1,616.00																																																																																																																		
2020	2020-660014398	PHILLIPS, JAMES R &	3	188,699	1000	16,191	1,564.00																																																																																																																		
2019	2019-660014398	PHILLIPS, JAMES R &	3	181,716	1000	15,691	1,517.00																																																																																																																		
2018	2018-660014398	PHILLIPS, JAMES R &	3	185,074	1000	15,204	1,415.00																																																																																																																		
2017	2017-660014398	PHILLIPS, JAMES R &	3	183,648	1000	14,732	1,386.00																																																																																																																		
2016	2016-660014398	PHILLIPS, JAMES R &	3	179,187	1000	14,275	1,344.00																																																																																																																		
2015	2015-660014398	PHILLIPS, JAMES R &	3	173,792	1000	13,830	1,311.00																																																																																																																		
2014	2014-660014398	PHILLIPS, JAMES R &	3	175,133	1000	13,397	1,282.00																																																																																																																		
2013	2013-660014398	PHILLIPS, JAMES R &	3	165,787	1000	12,979	1,216.00																																																																																																																		



Rogers

Assessment Property Record Card for Tax Year 2026

Data provided by LISA DELOZIER County Assessor

Date 04/16/2026
Time 21:30:40
Page 2

Lot Data	Square-Foot - NBHD 1069 #1	Primary Image
Lot Size		
Lot Count	1	
Units Buildable	1	
Non-Ag Acres	1.1454	
Topography		
Street Access		
Utilities		
Amenities	LAND QUALITY	
	0	
	0	
Method	Square-Foot	
Base Lot Value	49,895.00 x 1.21 = 60,429	
Factor Value		
Adjustments	1.0000	
Lot Value	60,429	

Residential Data	
Type	1 Single Family Residence
Condition	3 - Average
Quality	3 - Average
Architecture	
Style	100% 1 1/2 Story Finished
Exterior Wall	100% Veneer, Masonry
Base/Total Area	1,689 / 2,289
Style	100% 1 1/2 Story Finished
HVAC	100% Warmed & Cooled Air
Roof Cover	1 Composition Shingle
Area on Slab	1,689
Fixture/RghIn	14 /
Bed/F/H Bath	4 / 3.0 /
Basement Area	
Garage Type	525 Attached Garage - Unfinished
Remodel	
Year/Eff Age	1975 / 38

Cost Approach				Manual : 01/2025			
Base Cost	96.24	Total Misc Impr	+ 13,930				
Roofing Adj	+ 3.59	Garage Cost	+ 16,559				
Subfloor Adj	+ -1.70	Total RCN	= 303,567				
Heat/Cool Adj	+ 12.64	Depreciation (45%)	- 136,605				
Plumbing Adj	+ 8.53	Lump Sums	+ 0				
Basement Adj	+ 0.00	RCNLD	= 166,962				
Adj Base Cost	= 119.30	Lot Value	+ 60,429				
Total Area	x 2,289	Indicated Value	= 227,391				
Adjusted Cost	= 273,078	Value Per SqFt	99.34				

GRM Approach	
GRM Code	
Gross Rent	0.00
Indicated Value	

Multiple Regression			
MRA Code	1	Test	
Adusted R	0.8445		
Indicated Value	237,530	103.77	Per SqFt

Direct Comparables			
Selection Model	A	Adam Test	
Adjustment Model	1	2022 Residential	
Comparables	6		
Indicated Value	242,560		Per SqFt

Value Reconciliation			
Selected Approach	Cost Approach		
Improvements	166,962		
Lot Value	60,429		
Indicated Value	227,391	99.34	Per SqFt
Agland Value			
Site Improvements			
Total Value	227,391	99.34	Total Value Per SqFt

Miscellaneous Improvements								
Code	Description	Sketch ID	Size	Year	Units	Unit Cost	Depr	Value
FPR1	FIREPLACE - RESIDENTIAL 1 STORY	0		1	1	5,615.40		5,615
PRCH	SLAB PORCH - COVERED	34586	20x4		80	26.68		2,134
PRCH	SLAB PORCH - COVERED	34587	236		236	26.19		6,181



Rogers

Assessment Property Record Card for Tax Year 2026

Data provided by LISA DELOZIER County Assessor

Date 04/16/2026
 Time 21:30:40
 Page 3

Sketch Image

660014398

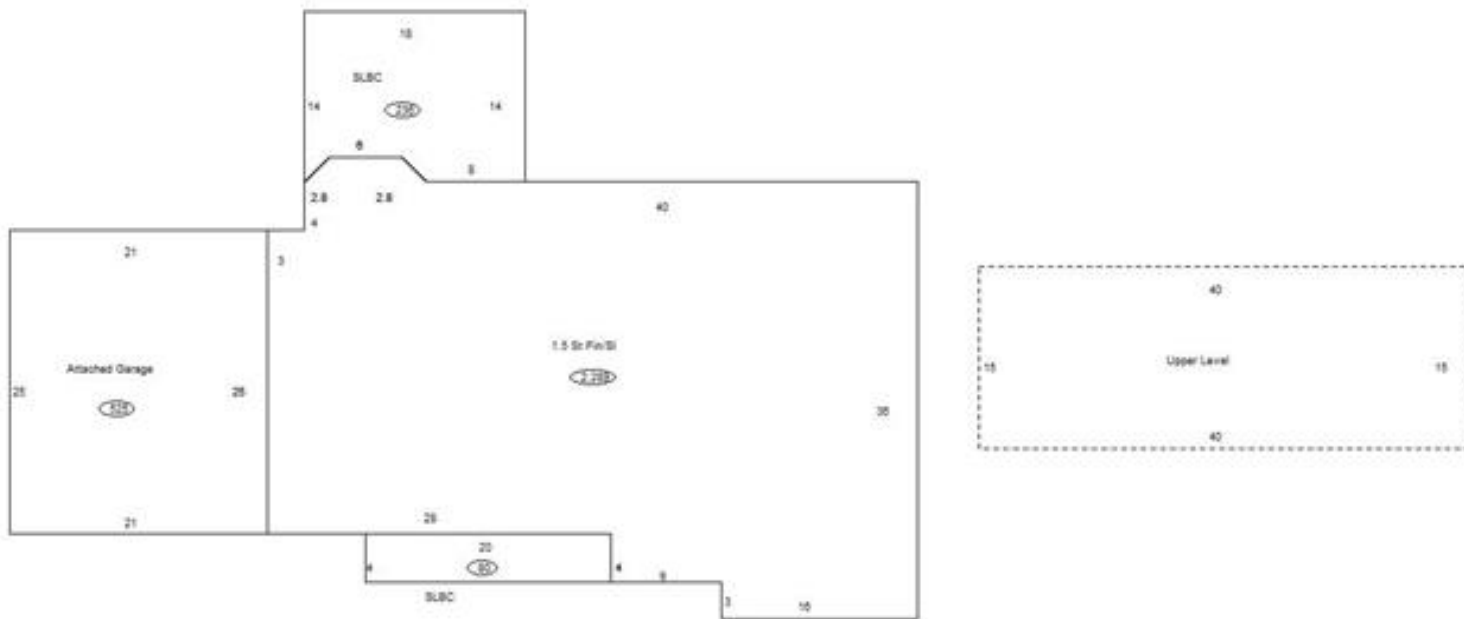

Sketch Vector Information

Sequence	Code	Type	Built Over	Scale	Section Label	Base Area	Multiplier	Total Area
1	R	5	Slab	10	1.5 St Fin/SI	1,689	1.355	2,289
2	G	1		10	Attached Garage	525	1.000	525
3	M	PRCH		10	SLBC	80	1.000	80
4	M	PRCH		10	SLBC	236	1.000	236
5	U	^UL	Overhang	10	Upper Level	600	1.000	600
Total Building Area						1,689		2,289



Rogers

Assessment Property Record Card for Tax Year 2026

Data provided by LISA DELOZIER County Assessor

Date 04/16/2026
Time 21:30:40
Page 4

660014398

Outbuildings/Site Improvements

Building Image	Code	Description	Dimensions	Floor	Roofing	Total Units
	STF	STG FAIR	12x16x0			192
	Qual	2	Cond 3	Year	Eff Age 1520	
Valuation Summary		Modifier Total		RCN	Depr (100% Phys/ % Func)	RCNLD
Base Cost (4.68 x 192)		899			899	899