



Rogers

Assessment Property Record Card for Tax Year 2026

Data provided by LISA DELOZIER County Assessor

Date 04/16/2026
 Time 21:31:02
 Page 1

Assessment Data					Primary Image																																																	
Account 660014414 Parcel ID 000000-00-0-00741-003-0006 Cadastral ID 15-21-14-03150 Property Type REAL - Real Property Property Class RRP VI Area 4 Tax Area 3 - OWASSO RURAL/NO FIRE Name ID 137014 JOHNS, GERALD R & KAY D 14707 E 97TH ST N OWASSO OK 74055-0000 Parcel Location Situs 14707 97TH ST Subdivision SHERRI-LAVERNE ESTS Lot/Block 0006 / 0003 Parcel Size 1 - Lots Sec/Twn/Rng 15 / 21 / 14 / 5 Neighborhood 1069 - R-V04-SW OWASSO School District S021 - OWASSO SCHOOLS					<p>\\tsclient\T\TOMMY DUNLAP\090822(107)\IMG_0001.JPG 9/8/2022</p>																																																	
Legal Description Lat/Long: 36.29489885 -95.80977351																																																						
LOT 6 BLOCK 3 SHERRI-LAVERNE EST.					Building Permits <table border="1"> <thead> <tr> <th>Number</th> <th>Description</th> <th>Opened</th> <th>Closed</th> <th>Amount</th> </tr> </thead> <tbody> <tr> <td> </td> <td> </td> <td> </td> <td> </td> <td> </td> </tr> </tbody> </table>					Number	Description	Opened	Closed	Amount																																								
Number	Description	Opened	Closed	Amount																																																		
Exemptions					Sale History																																																	
Code	Type	Active	Maximum	Exemption	Bk/Pg	Grantor	Date	Price	Code																																													
H	Homestead	Yes	1,000	1,000																																																		
Parcel Valuation					<table border="1"> <thead> <tr> <th>Source</th> <th>REAL</th> <th>Fair Cash</th> <th>Capped</th> <th>Asmnt Level</th> <th>Assessed</th> <th>Levy Rate</th> <th>97.960</th> <th>Current Tax</th> </tr> </thead> <tbody> <tr> <td>Remove Cap</td> <td>0</td> <td>Land Value 63,397</td> <td>32,732</td> <td>11%</td> <td>3,601</td> <td>Assessed</td> <td>11,408</td> <td>1,117.53</td> </tr> <tr> <td>Year Frozen</td> <td>2009</td> <td>Improvements 137,461</td> <td>70,970</td> <td> </td> <td>7,807</td> <td>Penalty</td> <td>0</td> <td> </td> </tr> <tr> <td>Uncapped Value</td> <td>0</td> <td>Mobile Home 0</td> <td>0</td> <td> </td> <td>0</td> <td>Exemption</td> <td>1,000</td> <td>-98.00</td> </tr> <tr> <td>TIF Project ID</td> <td>0</td> <td>Total Value 200,858</td> <td>103,702</td> <td> </td> <td>11,408</td> <td>Total Taxable</td> <td>10,408</td> <td>1,020.00</td> </tr> </tbody> </table>					Source	REAL	Fair Cash	Capped	Asmnt Level	Assessed	Levy Rate	97.960	Current Tax	Remove Cap	0	Land Value 63,397	32,732	11%	3,601	Assessed	11,408	1,117.53	Year Frozen	2009	Improvements 137,461	70,970		7,807	Penalty	0		Uncapped Value	0	Mobile Home 0	0		0	Exemption	1,000	-98.00	TIF Project ID	0	Total Value 200,858	103,702		11,408	Total Taxable	10,408	1,020.00
Source	REAL	Fair Cash	Capped	Asmnt Level	Assessed	Levy Rate	97.960	Current Tax																																														
Remove Cap	0	Land Value 63,397	32,732	11%	3,601	Assessed	11,408	1,117.53																																														
Year Frozen	2009	Improvements 137,461	70,970		7,807	Penalty	0																																															
Uncapped Value	0	Mobile Home 0	0		0	Exemption	1,000	-98.00																																														
TIF Project ID	0	Total Value 200,858	103,702		11,408	Total Taxable	10,408	1,020.00																																														
Assessment History																																																						
Tax Year	Statement Number	Billed Owner	Tax Area	Total Value	Exemptions	Taxable Value	Billed Tax																																															
2025	2025-660014414	JOHNS, GERALD R &	3	196,612	1000	10,408	1,020.00																																															
2024	2024-660014414	JOHNS, GERALD R &	3	226,046	1000	10,408	1,000.00																																															
2023	2023-660014414	JOHNS, GERALD R &	3	185,931	1000	10,407	975.00																																															
2022	2022-660014414	JOHNS, GERALD R &	3	153,770	1000	10,407	1,020.00																																															
2021	2021-660014414	JOHNS, GERALD R &	3	161,618	1000	10,407	1,007.00																																															
2020	2020-660014414	JOHNS, GERALD R &	3	162,711	1000	10,407	1,005.00																																															
2019	2019-660014414	JOHNS, GERALD R &	3	155,355	1000	10,407	1,006.00																																															
2018	2018-660014414	JOHNS, GERALD R &	3	161,896	1000	10,407	969.00																																															
2017	2017-660014414	JOHNS, GERALD R &	3	160,548	1000	10,407	979.00																																															
2016	2016-660014414	JOHNS, GERALD R &	3	156,929	1000	10,407	980.00																																															
2015	2015-660014414	JOHNS, GERALD R &	3	155,815	1000	10,407	987.00																																															
2014	2014-660014414	JOHNS, GERALD R &	3	158,594	1000	10,407	996.00																																															
2013	2013-660014414	JOHNS, GERALD R &	3	151,268	1000	10,407	975.00																																															



Rogers

Assessment Property Record Card for Tax Year 2026

Data provided by LISA DELOZIER County Assessor

Date 04/16/2026
Time 21:31:03
Page 2

Lot Data	Square-Foot - NBHD 1069 #1	Primary Image
Lot Size		
Lot Count	1	
Units Buildable	1	
Non-Ag Acres	1.259	
Topography		
Street Access		
Utilities		
Amenities	LAND QUALITY 0	
	0	
Method	Square-Foot	
Base Lot Value	54,841.00 x 1.16 = 63,397	
Factor Value		
Adjustments	1.0000	
Lot Value	63,397	

Residential Data	
Type	1 Single Family Residence
Condition	3 - Average
Quality	2.5 - Fair
Architecture	
Style	100% 1 1/2 Story Finished
Exterior Wall	80% Veneer, Masonry 20% Frame, Siding, Wood
Base/Total Area	1,198 / 2,146
Style	100% 1 1/2 Story Finished
HVAC	100% Warmed & Cooled Air
Roof Cover	1 Composition Shingle
Area on Slab	1,198
Fixture/RghIn	10 /
Bed/F/H Bath	3 / 2.5 /
Basement Area	
Garage Type	550 Attached Garage - Unfinished
Remodel	
Year/Eff Age	1974 / 39

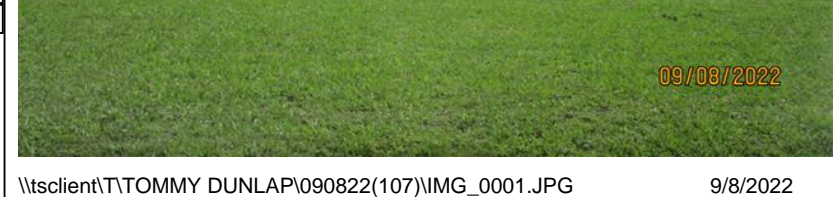

\\tsclient\T\TOMMY DUNLAP\090822(107)\IMG_0001.JPG 9/8/2022

GRM Approach	
GRM Code	
Gross Rent	0.00
Indicated Value	

Multiple Regression			
MRA Code	1	Test	
Adusted R	0.8445		
Indicated Value	206,586	96.27	Per SqFt

Direct Comparables			
Selection Model	A	Adam Test	
Adjustment Model	1	2022 Residential	
Comparables	8		
Indicated Value	253,860		Per SqFt

Value Reconciliation			
Selected Approach	Cost Approach		
Improvements	132,885		
Lot Value	63,397		
Indicated Value	196,282	91.46	Per SqFt
Agland Value			
Site Improvements	4,576		
Total Value	200,858	93.60	Total Value Per SqFt

Cost Approach				Manual : 01/2025			
Base Cost	87.91	Total Misc Impr	+	10,392			
Roofing Adj	+ 2.66	Garage Cost	+	14,784			
Subfloor Adj	+ -0.68	Total RCN	=	255,549			
Heat/Cool Adj	+ 11.47	Depreciation (48%)	-	122,664			
Plumbing Adj	+ 5.99	Lump Sums	+	0			
Basement Adj	+ 0.00	RCNLD	=	132,885			
Adj Base Cost	= 107.35	Lot Value	+	63,397			
Total Area	x 2,146	Indicated Value	=	196,282			
Adjusted Cost	= 230,373	Value Per SqFt		91.46			

Miscellaneous Improvements								
Code	Description	Sketch ID	Size	Year	Units	Unit Cost	Depr	Value
FPR1	FIREPLACE - RESIDENTIAL 1 STORY	0		1	1	5,095.98		5,096
PRCH	SLAB PORCH - COVERED	34662	19x4		76	24.03		1,826
PRCH	SLAB PORCH - COVERED	34663	146		146	23.77		3,470



Rogers

Assessment Property Record Card for Tax Year 2026

Data provided by LISA DELOZIER County Assessor

Date 04/16/2026
 Time 21:31:03
 Page 3

Sketch Image

660014414

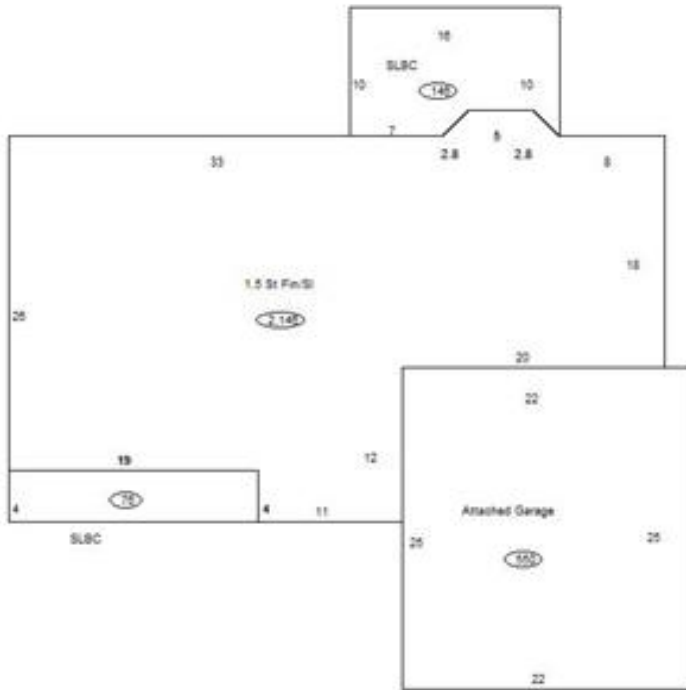

Sketch Vector Information

Sequence	Code	Type	Built Over	Scale	Section Label	Base Area	Multiplier	Total Area
1	R	5	Slab	10	1.5 St Fin/SI	1,198	1.791	2,146
2	G	1		10	Attached Garage	550	1.000	550
3	M	PRCH		10	SLBC	76	1.000	76
4	M	PRCH		10	SLBC	146	1.000	146
5	U	^UL		10	Upper Level (1)	948	1.000	948
Total Building Area						1,198		2,146



Rogers

Assessment Property Record Card for Tax Year 2026

Data provided by LISA DELOZIER County Assessor

Date 04/16/2026
Time 21:31:03
Page 4

660014414

Outbuildings/Site Improvements

Building Image	Code	Description	Dimensions	Floor	Roofing	Total Units
	DTGF	DETACHED GARAGE FAIR	0x0x0			440
	Qual 2	Cond 3	Year	Eff Age		
Valuation Summary		Modifier Total	RCN	Depr (35% Phys/ % Func)		RCNLD
Base Cost (16.00 x 440)		7,040		7,040	2,464	4,576