



Rogers

Assessment Property Record Card for Tax Year 2026

Data provided by LISA DELOZIER County Assessor

Date 04/16/2026
Time 21:31:06
Page 1

Assessment Data					Primary Image																																																																																																																				
Account 660014418 Parcel ID 000000-00-0-00741-003-0010 Cadastral ID 15-21-14-03190 Property Type REAL - Real Property Property Class RRP VI Area 4 Tax Area 3 - OWASSO RURAL/NO FIRE Name ID 137174 HASTINGS, DONALD L & CHERYL S TRUSTEES 14910 E 98TH ST N OWASSO OK 74055-0000 Parcel Location Situs 14910 E 98TH ST N Subdivision SHERRI-LAVERNE ESTS Lot/Block 0010 / 0003 Parcel Size 1 - Lots Sec/Twn/Rng 15 / 21 / 14 / 5 Neighborhood 1069 - R-V04-SW OWASSO School District S021 - OWASSO SCHOOLS																																																																																																																									
Legal Description Lot/Long: 36.29555938 -95.80724888																																																																																																																									
Building Permits					<table border="1"> <thead> <tr> <th>Number</th> <th>Description</th> <th>Opened</th> <th>Closed</th> <th>Amount</th> </tr> </thead> <tbody> <tr> <td colspan="5" style="height: 100px;"> </td> </tr> </tbody> </table>					Number	Description	Opened	Closed	Amount																																																																																																											
Number	Description	Opened	Closed	Amount																																																																																																																					
Exemptions					Sale History																																																																																																																				
<table border="1"> <thead> <tr> <th>Code</th> <th>Type</th> <th>Active</th> <th>Maximum</th> <th>Exemption</th> </tr> </thead> <tbody> <tr> <td>H</td> <td>Homestead</td> <td>Yes</td> <td>1,000</td> <td>1,000</td> </tr> </tbody> </table>					Code	Type	Active	Maximum	Exemption	H	Homestead	Yes	1,000	1,000	<table border="1"> <thead> <tr> <th>Bk/Pg</th> <th>Grantor</th> <th>Date</th> <th>Price</th> <th>Code</th> </tr> </thead> <tbody> <tr> <td>2470/637</td> <td>HASTINGS, DONALD L</td> <td>04/27/2015</td> <td>0</td> <td>4</td> </tr> <tr> <td>865/654</td> <td>SELLER</td> <td>10/23/1991</td> <td>80,000</td> <td>Yes</td> </tr> </tbody> </table>					Bk/Pg	Grantor	Date	Price	Code	2470/637	HASTINGS, DONALD L	04/27/2015	0	4	865/654	SELLER	10/23/1991	80,000	Yes																																																																																							
Code	Type	Active	Maximum	Exemption																																																																																																																					
H	Homestead	Yes	1,000	1,000																																																																																																																					
Bk/Pg	Grantor	Date	Price	Code																																																																																																																					
2470/637	HASTINGS, DONALD L	04/27/2015	0	4																																																																																																																					
865/654	SELLER	10/23/1991	80,000	Yes																																																																																																																					
Parcel Valuation																																																																																																																									
<table border="1"> <thead> <tr> <th>Source</th> <th>REAL</th> <th>Fair Cash</th> <th>Capped</th> <th>Asmnt Level</th> <th>Assessed</th> <th>Levy Rate</th> <th>97.960</th> <th>Current Tax</th> </tr> </thead> <tbody> <tr> <td>Remove Cap</td> <td>0</td> <td>Land Value 66,529</td> <td>40,753</td> <td>11%</td> <td>4,483</td> <td>Assessed</td> <td>20,573</td> <td>2,015.33</td> </tr> <tr> <td>Year Frozen</td> <td>0</td> <td>Improvements 146,976</td> <td>146,275</td> <td></td> <td>16,090</td> <td>Penalty</td> <td>0</td> <td></td> </tr> <tr> <td>Uncapped Value</td> <td>0</td> <td>Mobile Home 0</td> <td>0</td> <td></td> <td>0</td> <td>Exemption</td> <td>1,000</td> <td>-98.00</td> </tr> <tr> <td>TIF Project ID</td> <td>0</td> <td>Total Value 213,505</td> <td>187,028</td> <td></td> <td>20,573</td> <td>Total Taxable</td> <td>19,573</td> <td>1,917.00</td> </tr> </tbody> </table>		Source	REAL	Fair Cash	Capped	Asmnt Level	Assessed	Levy Rate	97.960	Current Tax	Remove Cap	0	Land Value 66,529	40,753	11%	4,483	Assessed	20,573	2,015.33	Year Frozen	0	Improvements 146,976	146,275		16,090	Penalty	0		Uncapped Value	0	Mobile Home 0	0		0	Exemption	1,000	-98.00	TIF Project ID	0	Total Value 213,505	187,028		20,573	Total Taxable	19,573	1,917.00																																																																											
Source	REAL	Fair Cash	Capped	Asmnt Level	Assessed	Levy Rate	97.960	Current Tax																																																																																																																	
Remove Cap	0	Land Value 66,529	40,753	11%	4,483	Assessed	20,573	2,015.33																																																																																																																	
Year Frozen	0	Improvements 146,976	146,275		16,090	Penalty	0																																																																																																																		
Uncapped Value	0	Mobile Home 0	0		0	Exemption	1,000	-98.00																																																																																																																	
TIF Project ID	0	Total Value 213,505	187,028		20,573	Total Taxable	19,573	1,917.00																																																																																																																	
Assessment History																																																																																																																									
<table border="1"> <thead> <tr> <th>Tax Year</th> <th>Statement Number</th> <th>Billed Owner</th> <th>Tax Area</th> <th>Total Value</th> <th>Exemptions</th> <th>Taxable Value</th> <th>Billed Tax</th> </tr> </thead> <tbody> <tr><td>2025</td><td>2025-660014418</td><td>HASTINGS, DONALD L & CHERYL S</td><td>3</td><td>208,728</td><td>1000</td><td>18,974</td><td>1,859.00</td></tr> <tr><td>2024</td><td>2024-660014418</td><td>HASTINGS, DONALD L & CHERYL S</td><td>3</td><td>247,622</td><td>1000</td><td>18,393</td><td>1,767.00</td></tr> <tr><td>2023</td><td>2023-660014418</td><td>HASTINGS, DONALD L & CHERYL S</td><td>3</td><td>214,124</td><td>1000</td><td>17,828</td><td>1,671.00</td></tr> <tr><td>2022</td><td>2022-660014418</td><td>HASTINGS, DONALD L & CHERYL S</td><td>3</td><td>184,118</td><td>1000</td><td>17,280</td><td>1,693.00</td></tr> <tr><td>2021</td><td>2021-660014418</td><td>HASTINGS, DONALD L & CHERYL S</td><td>3</td><td>190,101</td><td>1000</td><td>16,747</td><td>1,620.00</td></tr> <tr><td>2020</td><td>2020-660014418</td><td>HASTINGS, DONALD L & CHERYL S</td><td>3</td><td>187,187</td><td>1000</td><td>16,230</td><td>1,568.00</td></tr> <tr><td>2019</td><td>2019-660014418</td><td>HASTINGS, DONALD L & CHERYL S</td><td>3</td><td>180,145</td><td>1000</td><td>15,728</td><td>1,520.00</td></tr> <tr><td>2018</td><td>2018-660014418</td><td>HASTINGS, DONALD L & CHERYL S</td><td>3</td><td>175,173</td><td>1000</td><td>14,116</td><td>1,314.00</td></tr> <tr><td>2017</td><td>2017-660014418</td><td>HASTINGS, DONALD L & CHERYL S</td><td>3</td><td>173,900</td><td>1000</td><td>13,675</td><td>1,286.00</td></tr> <tr><td>2016</td><td>2016-660014418</td><td>HASTINGS, DONALD L & CHERYL S</td><td>3</td><td>169,698</td><td>1000</td><td>13,248</td><td>1,247.00</td></tr> <tr><td>2015</td><td>2015-660014418</td><td>HASTINGS, DONALD L & CHERYL S</td><td>3</td><td>164,823</td><td>1000</td><td>12,833</td><td>1,217.00</td></tr> <tr><td>2014</td><td>2014-660014418</td><td>HASTINGS, DONALD L</td><td>3</td><td>166,048</td><td>1000</td><td>12,431</td><td>1,190.00</td></tr> <tr><td>2013</td><td>2013-660014418</td><td>HASTINGS, DONALD L</td><td>3</td><td>157,367</td><td>1000</td><td>12,039</td><td>1,128.00</td></tr> </tbody> </table>										Tax Year	Statement Number	Billed Owner	Tax Area	Total Value	Exemptions	Taxable Value	Billed Tax	2025	2025-660014418	HASTINGS, DONALD L & CHERYL S	3	208,728	1000	18,974	1,859.00	2024	2024-660014418	HASTINGS, DONALD L & CHERYL S	3	247,622	1000	18,393	1,767.00	2023	2023-660014418	HASTINGS, DONALD L & CHERYL S	3	214,124	1000	17,828	1,671.00	2022	2022-660014418	HASTINGS, DONALD L & CHERYL S	3	184,118	1000	17,280	1,693.00	2021	2021-660014418	HASTINGS, DONALD L & CHERYL S	3	190,101	1000	16,747	1,620.00	2020	2020-660014418	HASTINGS, DONALD L & CHERYL S	3	187,187	1000	16,230	1,568.00	2019	2019-660014418	HASTINGS, DONALD L & CHERYL S	3	180,145	1000	15,728	1,520.00	2018	2018-660014418	HASTINGS, DONALD L & CHERYL S	3	175,173	1000	14,116	1,314.00	2017	2017-660014418	HASTINGS, DONALD L & CHERYL S	3	173,900	1000	13,675	1,286.00	2016	2016-660014418	HASTINGS, DONALD L & CHERYL S	3	169,698	1000	13,248	1,247.00	2015	2015-660014418	HASTINGS, DONALD L & CHERYL S	3	164,823	1000	12,833	1,217.00	2014	2014-660014418	HASTINGS, DONALD L	3	166,048	1000	12,431	1,190.00	2013	2013-660014418	HASTINGS, DONALD L	3	157,367	1000	12,039	1,128.00
Tax Year	Statement Number	Billed Owner	Tax Area	Total Value	Exemptions	Taxable Value	Billed Tax																																																																																																																		
2025	2025-660014418	HASTINGS, DONALD L & CHERYL S	3	208,728	1000	18,974	1,859.00																																																																																																																		
2024	2024-660014418	HASTINGS, DONALD L & CHERYL S	3	247,622	1000	18,393	1,767.00																																																																																																																		
2023	2023-660014418	HASTINGS, DONALD L & CHERYL S	3	214,124	1000	17,828	1,671.00																																																																																																																		
2022	2022-660014418	HASTINGS, DONALD L & CHERYL S	3	184,118	1000	17,280	1,693.00																																																																																																																		
2021	2021-660014418	HASTINGS, DONALD L & CHERYL S	3	190,101	1000	16,747	1,620.00																																																																																																																		
2020	2020-660014418	HASTINGS, DONALD L & CHERYL S	3	187,187	1000	16,230	1,568.00																																																																																																																		
2019	2019-660014418	HASTINGS, DONALD L & CHERYL S	3	180,145	1000	15,728	1,520.00																																																																																																																		
2018	2018-660014418	HASTINGS, DONALD L & CHERYL S	3	175,173	1000	14,116	1,314.00																																																																																																																		
2017	2017-660014418	HASTINGS, DONALD L & CHERYL S	3	173,900	1000	13,675	1,286.00																																																																																																																		
2016	2016-660014418	HASTINGS, DONALD L & CHERYL S	3	169,698	1000	13,248	1,247.00																																																																																																																		
2015	2015-660014418	HASTINGS, DONALD L & CHERYL S	3	164,823	1000	12,833	1,217.00																																																																																																																		
2014	2014-660014418	HASTINGS, DONALD L	3	166,048	1000	12,431	1,190.00																																																																																																																		
2013	2013-660014418	HASTINGS, DONALD L	3	157,367	1000	12,039	1,128.00																																																																																																																		



Rogers

Assessment Property Record Card for Tax Year 2026

Data provided by LISA DELOZIER County Assessor

Date 04/16/2026
Time 21:31:06
Page 2

Lot Data		Square-Foot - NBHD 1069 #1		Primary Image				
Lot Size								
Lot Count	1							
Units Buildable	1							
Non-Ag Acres	1.3788							
Topography								
Street Access								
Utilities								
Amenities	LAND QUALITY	0						
		0						
Method	Square-Foot							
Base Lot Value	60,062.00 x 1.11 = 66,529			\\tsclient\T\LOGAN\LOGAN RESIDENTIAL VI\2202-9-7\IMG_0005. 9/7/2022				
Factor Value				GRM Approach				
Adjustments	1.0000			GRM Code				
Lot Value	66,529			Gross Rent 0.00				
Residential Data				Indicated Value				
Type	1 Single Family Residence			Multiple Regression				
Condition	3 - Average			MRA Code 1 Test				
Quality	2.5 - Fair			Adusted R 0.8445				
Architecture				Indicated Value 206,588 93.65 Per SqFt				
Style	100% 1 1/2 Story Finished			Direct Comparables				
Exterior Wall	90% Veneer, Masonry 10% Frame, Siding, Wood			Selection Model A Adam Test				
Base/Total Area	1,228 / 2,206			Adjustment Model 1 2022 Residential				
Style	100% 1 1/2 Story Finished			Comparables 8				
HVAC	100% Warmed & Cooled Air			Indicated Value 281,910 Per SqFt				
Roof Cover	1 Composition Shingle			Value Reconciliation				
Area on Slab	1,228			Selected Approach Cost Approach				
Fixture/RghIn	8 /			Improvements 146,976				
Bed/F/H Bath	4 / 2.0 /			Lot Value 66,529				
Basement Area				Indicated Value 213,505 96.78 Per SqFt				
Garage Type	550 Attached Garage - Unfinished			Agland Value				
Remodel				Site Improvements				
Year/Eff Age	1975 / 38			Total Value 213,505 96.78 Total Value Per SqFt				
Cost Approach		Manual : 01/2025						
Base Cost	87.96	Total Misc Impr	+ 20,756					
Roofing Adj	+ 2.63	Garage Cost	+ 14,784					
Subfloor Adj	+ -0.68	Total RCN	= 269,619					
Heat/Cool Adj	+ 11.47	Depreciation (47%)	- 126,721					
Plumbing Adj	+ 4.73	Lump Sums	+ 4,078					
Basement Adj	+ 0.00	RCNLD	= 146,976					
Adj Base Cost	= 106.11	Lot Value	+ 66,529					
Total Area	x 2,206	Indicated Value	= 213,505					
Adjusted Cost	= 234,079	Value Per SqFt	96.78					
Miscellaneous Improvements								
Code	Description	Sketch ID	Size	Year	Units	Unit Cost	Depr	Value
FPR1	FIREPLACE - RESIDENTIAL 1 STORY	0		1	1	5,095.98		5,096
PRCH	SLAB PORCH - COVERED	34680	19x4		76	24.03		1,826
EPSW	ENCLOSED PORCH - SOLID WALL	34681	16x14		224	61.76		13,834
WODO	WOOD DECK - OPEN	138171	16x12		192	21.24		4,078



Rogers
Assessment Property Record Card for Tax Year 2026

Data provided by LISA DELOZIER County Assessor

Date 04/16/2026
 Time 21:31:06
 Page 3

Sketch Image

660014418

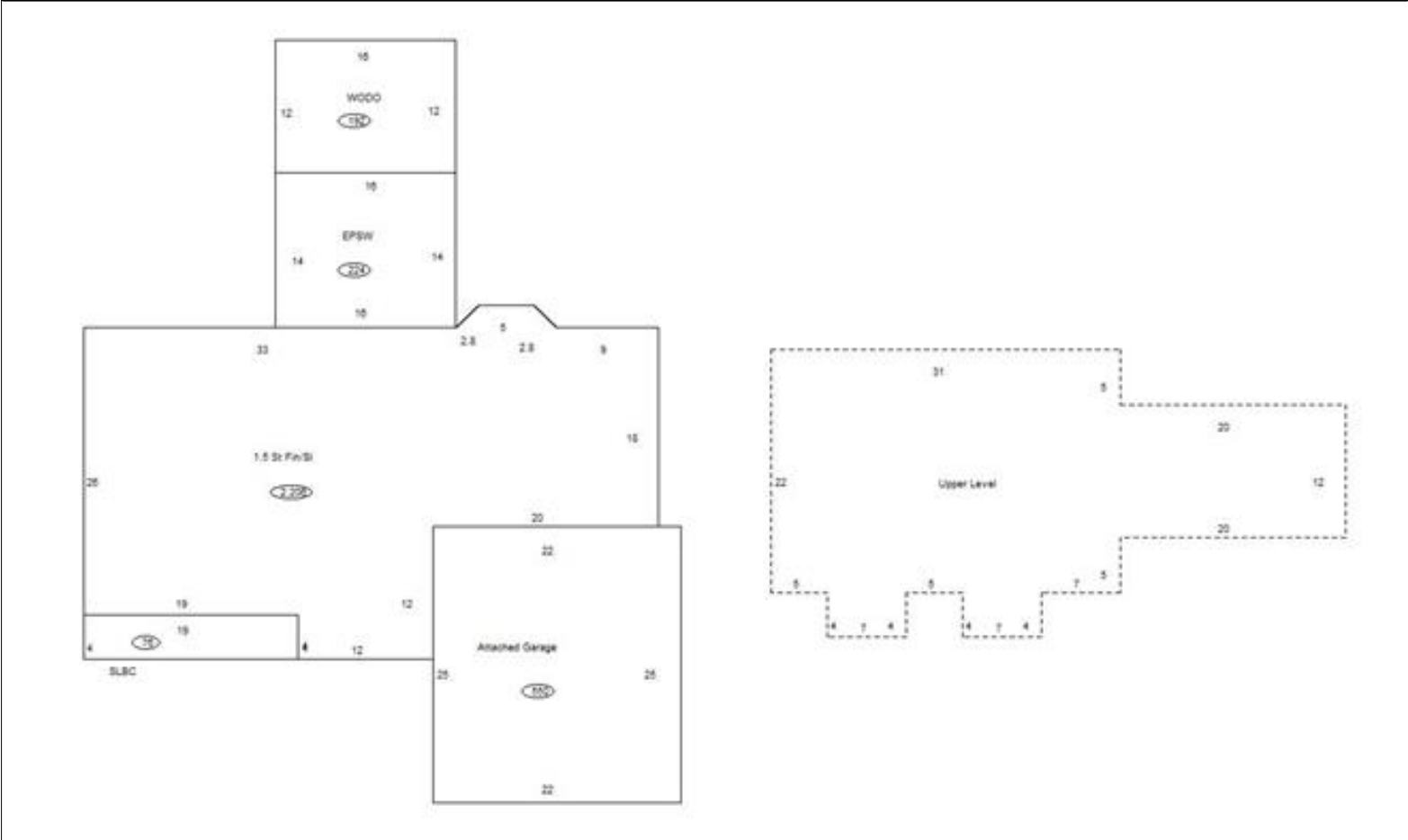

Sketch Vector Information

Sequence	Code	Type	Built Over	Scale	Section Label	Base Area	Multiplier	Total Area
1	R	5	Slab	10	1.5 St Fin/SI	1,228	1.796	2,206
2	G	1		10	Attached Garage	550	1.000	550
3	M	PRCH		10	SLBC	76	1.000	76
4	M	EPSW		10	EPSW	224	1.000	224
5	U	^UL	Overhang	10	Upper Level	978	1.000	978
6	M	WODO		10	WODO	192	1.000	192
Total Building Area						1,228		2,206



Rogers



Assessment Property Record Card for Tax Year 2026

Data provided by LISA DELOZIER County Assessor

Date 04/16/2026
Time 21:31:06
Page 4

660014418

Outbuildings/Site Improvements

Building Image	Code	Description	Dimensions	Floor	Roofing	Total Units
	STF	STG FAIR	0x0x0			
	Qual	Cond	Year	Eff Age		
	Valuation Summary		Modifier Total	RCN	Depr (100% Phys/ % Func)	RCNLD
	Base Cost (4.68 x)					
	STF	STG FAIR	0x0x0			
	Qual	Cond	Year	Eff Age		
	Valuation Summary		Modifier Total	RCN	Depr (100% Phys/ % Func)	RCNLD
	Base Cost (4.68 x)					