



# Rogers

## Assessment Property Record Card for Tax Year 2026

Data provided by LISA DELOZIER County Assessor

Date 04/16/2026  
Time 21:31:16  
Page 1

<b>Assessment Data</b>	<b>Primary Image</b>
------------------------	----------------------

Account 660014426  
Parcel ID 000000-00-0-00741-004-0006  
Cadastral ID 15-21-14-03270  
Property Type REAL - Real Property  
Property Class RRP VI Area 4  
Tax Area 3 - OWASSO RURAL/NO FIRE  
Name ID 311090  
COOK, MELISSA DANIELLE

9621 N 151ST E AVE  
OWASSO OK 74055-0000

**Parcel Location**

Situs 09621 N 151ST E AVE  
Subdivision SHERRI-LAVERNE ESTS  
Lot/Block 0006 / 0004 Parcel Size 1 - Lots  
Sec/Twn/Rng 15 / 21 / 14 / 5  
Neighborhood 1069 - R-V04-SW OWASSO  
School District S021 - OWASSO SCHOOLS



\\tsclient\T\LOGAN\LOGAN RESIDENTIAL VI\2202-9-7\IMG\_0012. 9/7/2022

<b>Legal Description</b> Lat/Long: 36.29403208 -95.80413571	<b>Building Permits</b>
---	-------------------------

LOT 6 BLOCK 4 SHERRI-LAVERNE EST.

Number	Description	Opened	Closed	Amount

<b>Exemptions</b>	<b>Sale History</b>
-------------------	---------------------

Code	Type	Active	Maximum	Exemption
H	Homestead	Yes	1,000	1,000
H	Homestead	No	1,000	

Bk/Pg	Grantor	Date	Price	Code
2368/135	PERSICHINI, GARY J &	11/06/2013	280,000	YES
2145/536	BLEVINS, WILLIAM D	12/07/2010	225,000	YES
1230/926	WYLIE, MAXINE J	05/25/2000	177,000	Yes
816/655			0	No

<b>Parcel Valuation</b>
-------------------------

Source	REAL	Fair Cash	Capped	Asmnt Level	Assessed	Levy Rate	97.960	Current Tax
Remove Cap	2014	Land Value 84,085	84,085	11%	9,249	Assessed	36,254	3,551.44
Year Frozen	0	Improvements 245,501	245,501		27,005	Penalty	0	
Uncapped Value	0	Mobile Home 0	0		0	Exemption	1,000	-98.00
TIF Project ID	0	Total Value 329,586	329,586		36,254	Total Taxable	35,254	3,453.00

<b>Assessment History</b>
---------------------------

Tax Year	Statement Number	Billed Owner	Tax Area	Total Value	Exemptions	Taxable Value	Billed Tax
2025	2025-660014426	COOK, MELISSA DANIELLE	3	328,057	1000	35,086	3,437.00
2024	2024-660014426	COOK, MELISSA DANIELLE	3	372,871	1000	35,907	3,450.00
2023	2023-660014426	COOK, MELISSA DANIELLE	3	361,659	1000	34,832	3,264.00
2022	2022-660014426	COOK, MELISSA DANIELLE	3	335,211	1000	33,788	3,310.00
2021	2021-660014426	COOK, MELISSA DANIELLE	3	307,047	1000	32,775	3,171.00
2020	2020-660014426	COOK, MELISSA DANIELLE	3	304,842	1000	32,083	3,099.00
2019	2019-660014426	COOK, MELISSA DANIELLE	3	291,993	1000	31,119	3,008.00
2018	2018-660014426	COOK, MELISSA DANIELLE	3	296,936	1000	31,663	2,947.00
2017	2017-660014426	COOK, MELISSA DANIELLE	3	294,434	1000	31,374	2,951.00
2016	2016-660014426	COOK, MELISSA DANIELLE	3	286,541	1000	30,431	2,865.00
2015	2015-660014426	COOK, MELISSA DANIELLE	3	277,414	1000	29,516	2,799.00
2014	2014-660014426	COOK, MELISSA DANIELLE	3	285,116	1000	30,363	2,906.00
2013	2013-660014426	PERSICHINI, GARY J &	3	230,147	1000	24,307	2,277.00



# Rogers

## Assessment Property Record Card for Tax Year 2026

Data provided by LISA DELOZIER County Assessor

Date 04/16/2026  
Time 21:31:16  
Page 2

Lot Data	Square-Foot - NBHD 1069 #1	Primary Image
Lot Size		
Lot Count	1	
Units Buildable	1	
Non-Ag Acres	2.0892	
Topography		
Street Access		
Utilities		
Amenities	LAND QUALITY	
	0	
	0	
Method	Square-Foot	
Base Lot Value	91,006.00 x .92 = 84,085	
Factor Value		
Adjustments	1.0000	
Lot Value	84,085	

Residential Data	
Type	1 Single Family Residence
Condition	3 - Average
Quality	3 - Average
Architecture	
Style	100% 1 1/2 Story Finished
Exterior Wall	100% Veneer, Masonry
Base/Total Area	1,982 / 3,109
Style	100% 1 1/2 Story Finished
HVAC	100% Warmed & Cooled Air
Roof Cover	1 Composition Shingle
Area on Slab	1,982
Fixture/RghIn	8 /
Bed/F/H Bath	3 / 2.0 /
Basement Area	
Garage Type	1,364 Attached Garage - Unfinished
Remodel	RMA -
Year/Eff Age	1975 / 30



\\tsclient\TLOGAN\LOGAN RESIDENTIAL VI\2202-9-7\IMG\_0012. 9/7/2022

GRM Approach	
GRM Code	
Gross Rent	0.00
Indicated Value	

Multiple Regression			
MRA Code	1	Test	
Adusted R	0.8445		
Indicated Value	372,875	119.93	Per SqFt

Direct Comparables			
Selection Model	A	Adam Test	
Adjustment Model	1	2022 Residential	
Comparables	3		
Indicated Value	470,390		Per SqFt

Value Reconciliation			
Selected Approach	Cost Approach		
Improvements	245,501		
Lot Value	84,085		
Indicated Value	329,586	106.01	Per SqFt
Agland Value			
Site Improvements			
Total Value	329,586	106.01	Total Value Per SqFt

Cost Approach				Manual : 01/2025			
Base Cost	89.36	Total Misc Impr	+	16,138			
Roofing Adj	+ 2.93	Garage Cost	+	40,634			
Subfloor Adj	+ -1.55	Total RCN	=	389,684			
Heat/Cool Adj	+ 12.64	Depreciation ( 37%)	-	144,183			
Plumbing Adj	+ 3.70	Lump Sums	+	0			
Basement Adj	+ 0.00	RCNLD	=	245,501			
Adj Base Cost	= 107.08	Lot Value	+	84,085			
Total Area	x 3,109	Indicated Value	=	329,586			
Adjusted Cost	= 332,912	Value Per SqFt		106.01			

Miscellaneous Improvements								
Code	Description	Sketch ID	Size	Year	Units	Unit Cost	Depr	Value
FPR1	FIREPLACE - RESIDENTIAL 1 STORY	0		1	1	5,615.40		5,615
PRCH	SLAB PORCH - COVERED	34713	19x4		76	26.69		2,028
PRCH	SLAB PORCH - COVERED	34714	328		328	25.90		8,495



# Rogers

## Assessment Property Record Card for Tax Year 2026

Data provided by LISA DELOZIER County Assessor

Date 04/16/2026  
 Time 21:31:16  
 Page 3

### Sketch Image

660014426

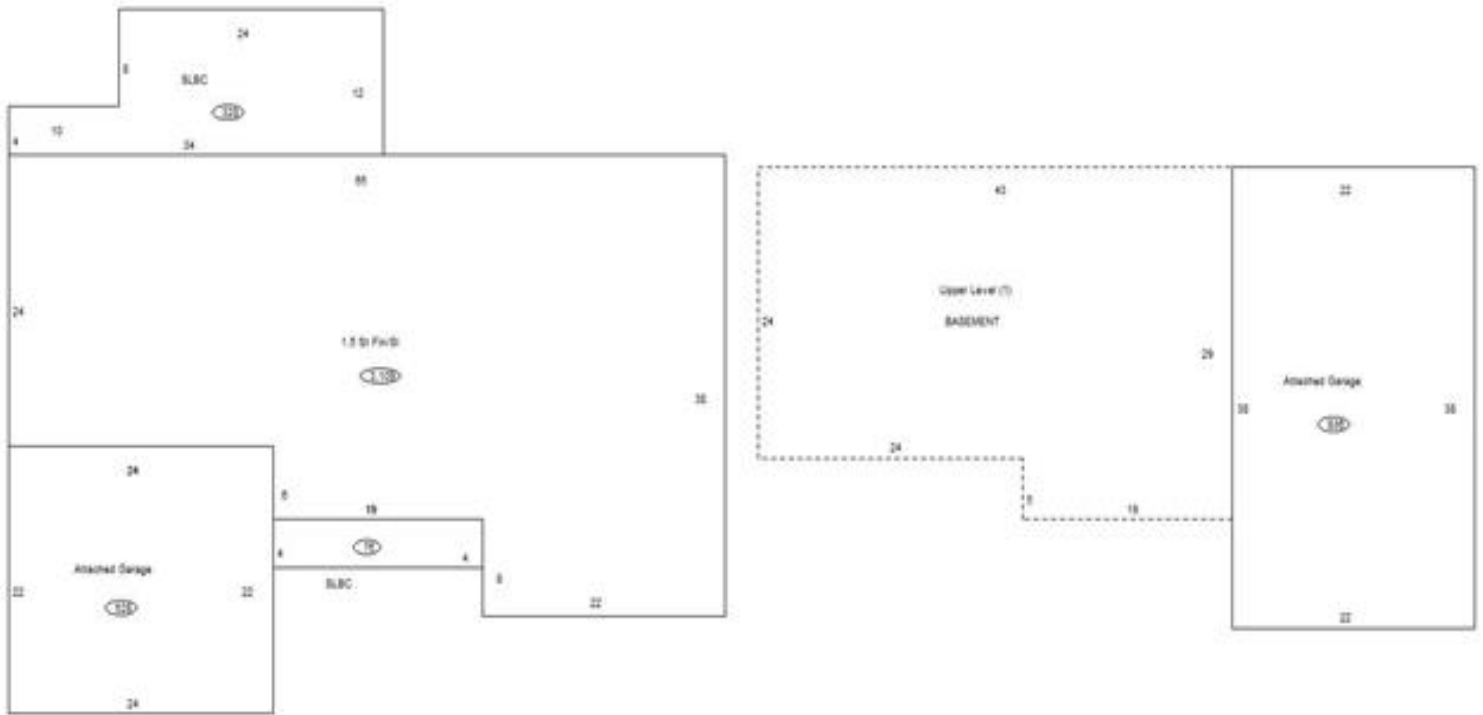

### Sketch Vector Information

Sequence	Code	Type	Built Over	Scale	Section Label	Base Area	Multiplier	Total Area
1	R	5	Slab	10	1.5 St Fin/SI	1,982	1.569	3,109
2	G	1		10	Attached Garage	528	1.000	528
3	M	PRCH		10	SLBC	76	1.000	76
4	M	PRCH		10	SLBC	328	1.000	328
5	G	1		10	Attached Garage	836	1.000	836
6	N	0		10	BASEMENT		0.000	
7	U	^UL		10	Upper Level (1)	1,127	1.000	1,127
<b>Total Building Area</b>						1,982		3,109