



Rogers

Assessment Property Record Card for Tax Year 2026

Data provided by LISA DELOZIER County Assessor

Date 04/16/2026
Time 21:31:57
Page 1

Assessment Data					Primary Image																																																																																																																				
Account 660014492 Parcel ID 000000-00-0-00588-002-0004 Cadastral ID 15-21-14-03940 Property Type REAL - Real Property Property Class RRP VI Area 4 Tax Area 3 - OWASSO RURAL/NO FIRE Name ID 214134 PENNEKAMP, PAUL E & LINDA L-TRUSTEES 14814 E 104TH ST N OWASSO OK 74055-0000 Parcel Location Situs 14814 E 104TH ST Subdivision PINE BROOK CROSSING Lot/Block 0004 / 0002 Parcel Size 1 - Lots Sec/Twn/Rng 15 / 21 / 14 / 5 Neighborhood 1069 - R-V04-SW OWASSO School District S021 - OWASSO SCHOOLS																																																																																																																									
Legal Description Lot/Long: 36.30339427 -95.81015351																																																																																																																									
Legal Description LOT 4 BLOCK 2 PINE BROOK CROSSING					Building Permits <table border="1"> <thead> <tr> <th>Number</th> <th>Description</th> <th>Opened</th> <th>Closed</th> <th>Amount</th> </tr> </thead> <tbody> <tr> <td> </td> <td> </td> <td> </td> <td> </td> <td> </td> </tr> </tbody> </table>					Number	Description	Opened	Closed	Amount																																																																																																											
Number	Description	Opened	Closed	Amount																																																																																																																					
Exemptions <table border="1"> <thead> <tr> <th>Code</th> <th>Type</th> <th>Active</th> <th>Maximum</th> <th>Exemption</th> </tr> </thead> <tbody> <tr> <td>H</td> <td>Homestead</td> <td>Yes</td> <td>1,000</td> <td>1,000</td> </tr> </tbody> </table>					Code	Type	Active	Maximum	Exemption	H	Homestead	Yes	1,000	1,000	Sale History <table border="1"> <thead> <tr> <th>Bk/Pg</th> <th>Grantor</th> <th>Date</th> <th>Price</th> <th>Code</th> </tr> </thead> <tbody> <tr> <td>2625/154</td> <td>PENNEKAMP, PAUL E &</td> <td>04/07/2017</td> <td>0</td> <td>4</td> </tr> <tr> <td>869/372</td> <td>SELLER</td> <td>12/11/1991</td> <td>121,000</td> <td>Yes</td> </tr> </tbody> </table>					Bk/Pg	Grantor	Date	Price	Code	2625/154	PENNEKAMP, PAUL E &	04/07/2017	0	4	869/372	SELLER	12/11/1991	121,000	Yes																																																																																							
Code	Type	Active	Maximum	Exemption																																																																																																																					
H	Homestead	Yes	1,000	1,000																																																																																																																					
Bk/Pg	Grantor	Date	Price	Code																																																																																																																					
2625/154	PENNEKAMP, PAUL E &	04/07/2017	0	4																																																																																																																					
869/372	SELLER	12/11/1991	121,000	Yes																																																																																																																					
Parcel Valuation <table border="1"> <thead> <tr> <th>Source</th> <th>REAL</th> <th>Fair Cash</th> <th>Capped</th> <th>Asmnt Level</th> <th>Assessed</th> <th>Levy Rate</th> <th>97.960</th> <th>Current Tax</th> </tr> </thead> <tbody> <tr> <td>Remove Cap</td> <td>0</td> <td>Land Value 56,845</td> <td>35,944</td> <td>11%</td> <td>3,954</td> <td>Assessed</td> <td>30,248</td> <td>2,963.09</td> </tr> <tr> <td>Year Frozen</td> <td>0</td> <td>Improvements 264,299</td> <td>239,039</td> <td></td> <td>26,294</td> <td>Penalty</td> <td>0</td> <td></td> </tr> <tr> <td>Uncapped Value</td> <td>0</td> <td>Mobile Home 0</td> <td>0</td> <td></td> <td>0</td> <td>Exemption</td> <td>1,000</td> <td>-98.00</td> </tr> <tr> <td>TIF Project ID</td> <td>0</td> <td>Total Value 321,144</td> <td>274,983</td> <td></td> <td>30,248</td> <td>Total Taxable</td> <td>29,248</td> <td>2,865.00</td> </tr> </tbody> </table>										Source	REAL	Fair Cash	Capped	Asmnt Level	Assessed	Levy Rate	97.960	Current Tax	Remove Cap	0	Land Value 56,845	35,944	11%	3,954	Assessed	30,248	2,963.09	Year Frozen	0	Improvements 264,299	239,039		26,294	Penalty	0		Uncapped Value	0	Mobile Home 0	0		0	Exemption	1,000	-98.00	TIF Project ID	0	Total Value 321,144	274,983		30,248	Total Taxable	29,248	2,865.00																																																																			
Source	REAL	Fair Cash	Capped	Asmnt Level	Assessed	Levy Rate	97.960	Current Tax																																																																																																																	
Remove Cap	0	Land Value 56,845	35,944	11%	3,954	Assessed	30,248	2,963.09																																																																																																																	
Year Frozen	0	Improvements 264,299	239,039		26,294	Penalty	0																																																																																																																		
Uncapped Value	0	Mobile Home 0	0		0	Exemption	1,000	-98.00																																																																																																																	
TIF Project ID	0	Total Value 321,144	274,983		30,248	Total Taxable	29,248	2,865.00																																																																																																																	
Assessment History <table border="1"> <thead> <tr> <th>Tax Year</th> <th>Statement Number</th> <th>Billed Owner</th> <th>Tax Area</th> <th>Total Value</th> <th>Exemptions</th> <th>Taxable Value</th> <th>Billed Tax</th> </tr> </thead> <tbody> <tr><td>2025</td><td>2025-660014492</td><td>PENNEKAMP, PAUL E &</td><td>3</td><td>312,403</td><td>1000</td><td>28,367</td><td>2,779.00</td></tr> <tr><td>2024</td><td>2024-660014492</td><td>PENNEKAMP, PAUL E &</td><td>3</td><td>346,070</td><td>1000</td><td>27,512</td><td>2,643.00</td></tr> <tr><td>2023</td><td>2023-660014492</td><td>PENNEKAMP, PAUL E &</td><td>3</td><td>319,879</td><td>1000</td><td>26,682</td><td>2,500.00</td></tr> <tr><td>2022</td><td>2022-660014492</td><td>PENNEKAMP, PAUL E &</td><td>3</td><td>288,257</td><td>1000</td><td>25,875</td><td>2,535.00</td></tr> <tr><td>2021</td><td>2021-660014492</td><td>PENNEKAMP, PAUL E &</td><td>3</td><td>293,337</td><td>1000</td><td>25,093</td><td>2,427.00</td></tr> <tr><td>2020</td><td>2020-660014492</td><td>PENNEKAMP, PAUL E &</td><td>3</td><td>288,338</td><td>1000</td><td>24,333</td><td>2,351.00</td></tr> <tr><td>2019</td><td>2019-660014492</td><td>PENNEKAMP, PAUL E &</td><td>3</td><td>278,828</td><td>1000</td><td>23,595</td><td>2,281.00</td></tr> <tr><td>2018</td><td>2018-660014492</td><td>PENNEKAMP, PAUL E &</td><td>3</td><td>287,801</td><td>1000</td><td>22,878</td><td>2,129.00</td></tr> <tr><td>2017</td><td>2017-660014492</td><td>PENNEKAMP, PAUL E &</td><td>3</td><td>284,861</td><td>1000</td><td>22,183</td><td>2,087.00</td></tr> <tr><td>2016</td><td>2016-660014492</td><td>PENNEKAMP, PAUL E &</td><td>3</td><td>277,680</td><td>1000</td><td>21,508</td><td>2,025.00</td></tr> <tr><td>2015</td><td>2015-660014492</td><td>PENNEKAMP, PAUL E &</td><td>3</td><td>268,953</td><td>1000</td><td>20,853</td><td>1,977.00</td></tr> <tr><td>2014</td><td>2014-660014492</td><td>PENNEKAMP, PAUL E &</td><td>3</td><td>271,418</td><td>1000</td><td>20,216</td><td>1,935.00</td></tr> <tr><td>2013</td><td>2013-660014492</td><td>PENNEKAMP, PAUL E &</td><td>3</td><td>256,276</td><td>1000</td><td>19,599</td><td>1,836.00</td></tr> </tbody> </table>										Tax Year	Statement Number	Billed Owner	Tax Area	Total Value	Exemptions	Taxable Value	Billed Tax	2025	2025-660014492	PENNEKAMP, PAUL E &	3	312,403	1000	28,367	2,779.00	2024	2024-660014492	PENNEKAMP, PAUL E &	3	346,070	1000	27,512	2,643.00	2023	2023-660014492	PENNEKAMP, PAUL E &	3	319,879	1000	26,682	2,500.00	2022	2022-660014492	PENNEKAMP, PAUL E &	3	288,257	1000	25,875	2,535.00	2021	2021-660014492	PENNEKAMP, PAUL E &	3	293,337	1000	25,093	2,427.00	2020	2020-660014492	PENNEKAMP, PAUL E &	3	288,338	1000	24,333	2,351.00	2019	2019-660014492	PENNEKAMP, PAUL E &	3	278,828	1000	23,595	2,281.00	2018	2018-660014492	PENNEKAMP, PAUL E &	3	287,801	1000	22,878	2,129.00	2017	2017-660014492	PENNEKAMP, PAUL E &	3	284,861	1000	22,183	2,087.00	2016	2016-660014492	PENNEKAMP, PAUL E &	3	277,680	1000	21,508	2,025.00	2015	2015-660014492	PENNEKAMP, PAUL E &	3	268,953	1000	20,853	1,977.00	2014	2014-660014492	PENNEKAMP, PAUL E &	3	271,418	1000	20,216	1,935.00	2013	2013-660014492	PENNEKAMP, PAUL E &	3	256,276	1000	19,599	1,836.00
Tax Year	Statement Number	Billed Owner	Tax Area	Total Value	Exemptions	Taxable Value	Billed Tax																																																																																																																		
2025	2025-660014492	PENNEKAMP, PAUL E &	3	312,403	1000	28,367	2,779.00																																																																																																																		
2024	2024-660014492	PENNEKAMP, PAUL E &	3	346,070	1000	27,512	2,643.00																																																																																																																		
2023	2023-660014492	PENNEKAMP, PAUL E &	3	319,879	1000	26,682	2,500.00																																																																																																																		
2022	2022-660014492	PENNEKAMP, PAUL E &	3	288,257	1000	25,875	2,535.00																																																																																																																		
2021	2021-660014492	PENNEKAMP, PAUL E &	3	293,337	1000	25,093	2,427.00																																																																																																																		
2020	2020-660014492	PENNEKAMP, PAUL E &	3	288,338	1000	24,333	2,351.00																																																																																																																		
2019	2019-660014492	PENNEKAMP, PAUL E &	3	278,828	1000	23,595	2,281.00																																																																																																																		
2018	2018-660014492	PENNEKAMP, PAUL E &	3	287,801	1000	22,878	2,129.00																																																																																																																		
2017	2017-660014492	PENNEKAMP, PAUL E &	3	284,861	1000	22,183	2,087.00																																																																																																																		
2016	2016-660014492	PENNEKAMP, PAUL E &	3	277,680	1000	21,508	2,025.00																																																																																																																		
2015	2015-660014492	PENNEKAMP, PAUL E &	3	268,953	1000	20,853	1,977.00																																																																																																																		
2014	2014-660014492	PENNEKAMP, PAUL E &	3	271,418	1000	20,216	1,935.00																																																																																																																		
2013	2013-660014492	PENNEKAMP, PAUL E &	3	256,276	1000	19,599	1,836.00																																																																																																																		



Rogers

Assessment Property Record Card for Tax Year 2026

Data provided by LISA DELOZIER County Assessor

Date 04/16/2026
Time 21:31:57
Page 2

Lot Data	Square-Foot - NBHD 1069 #1	Primary Image
Lot Size		
Lot Count	1	
Units Buildable	1	
Non-Ag Acres	1.0083	
Topography		
Street Access		
Utilities		
Amenities	LAND QUALITY	
	0	
	0	
Method	Square-Foot	
Base Lot Value	43,921.00 x 1.29 = 56,845	
Factor Value		
Adjustments	1.0000	
Lot Value	56,845	

Residential Data	
Type	1 Single Family Residence
Condition	3 - Average
Quality	3 - Average
Architecture	
Style	100% One Story
Exterior Wall	100% Veneer, Masonry
Base/Total Area	2,662 / 2,662
Style	100% One Story
HVAC	100% Warmed & Cooled Air
Roof Cover	1 Composition Shingle
Area on Slab	2,662
Fixture/RghIn	14 /
Bed/F/H Bath	3 / 3.0 /
Basement Area	
Garage Type	672 Attached Garage - Unfinished
Remodel	
Year/Eff Age	1991 / 26

\\tsclient\TOM\COMMERCIAL PICS\2022-08-30\IMG_0036.JPG 9/1/2022

GRM Approach	
GRM Code	
Gross Rent	0.00
Indicated Value	

Multiple Regression			
MRA Code	1	Test	
Adusted R	0.8445		
Indicated Value	303,274	113.93	Per SqFt

Direct Comparables			
Selection Model	A	Adam Test	
Adjustment Model	1	2022 Residential	
Comparables	8		
Indicated Value	395,110		Per SqFt

Value Reconciliation			
Selected Approach	Cost Approach		
Improvements	254,931		
Lot Value	56,845		
Indicated Value	311,776	117.12	Per SqFt
Agland Value			
Site Improvements	9,368		
Total Value	321,144	120.64	Total Value Per SqFt

Cost Approach				Manual : 01/2025			
Base Cost	102.29	Total Misc Impr	+	22,967			
Roofing Adj	+ 4.46	Garage Cost	+	20,220			
Subfloor Adj	+ -2.12	Total RCN	=	374,899			
Heat/Cool Adj	+ 12.64	Depreciation (32%)	-	119,968			
Plumbing Adj	+ 7.34	Lump Sums	+	0			
Basement Adj	+ 0.00	RCNLD	=	254,931			
Adj Base Cost	= 124.61	Lot Value	+	56,845			
Total Area	x 2,662	Indicated Value	=	311,776			
Adjusted Cost	= 331,712	Value Per SqFt		117.12			

Miscellaneous Improvements								
Code	Description	Sketch ID	Size	Year	Units	Unit Cost	Depr	Value
FPR1	FIREPLACE - RESIDENTIAL 1 STORY	0		1	1	5,615.40		5,615
FPR1	FIREPLACE - RESIDENTIAL 1 STORY	0		1	1	5,615.40		5,615
PRCH	SLAB PORCH - COVERED	35007	272		272	26.08		7,094
PRCH	SLAB PORCH - COVERED	35008	22x8		176	26.38		4,643



Rogers

Assessment Property Record Card for Tax Year 2026

Data provided by LISA DELOZIER County Assessor

Date 04/16/2026
 Time 21:31:57
 Page 3

Sketch Image

660014492

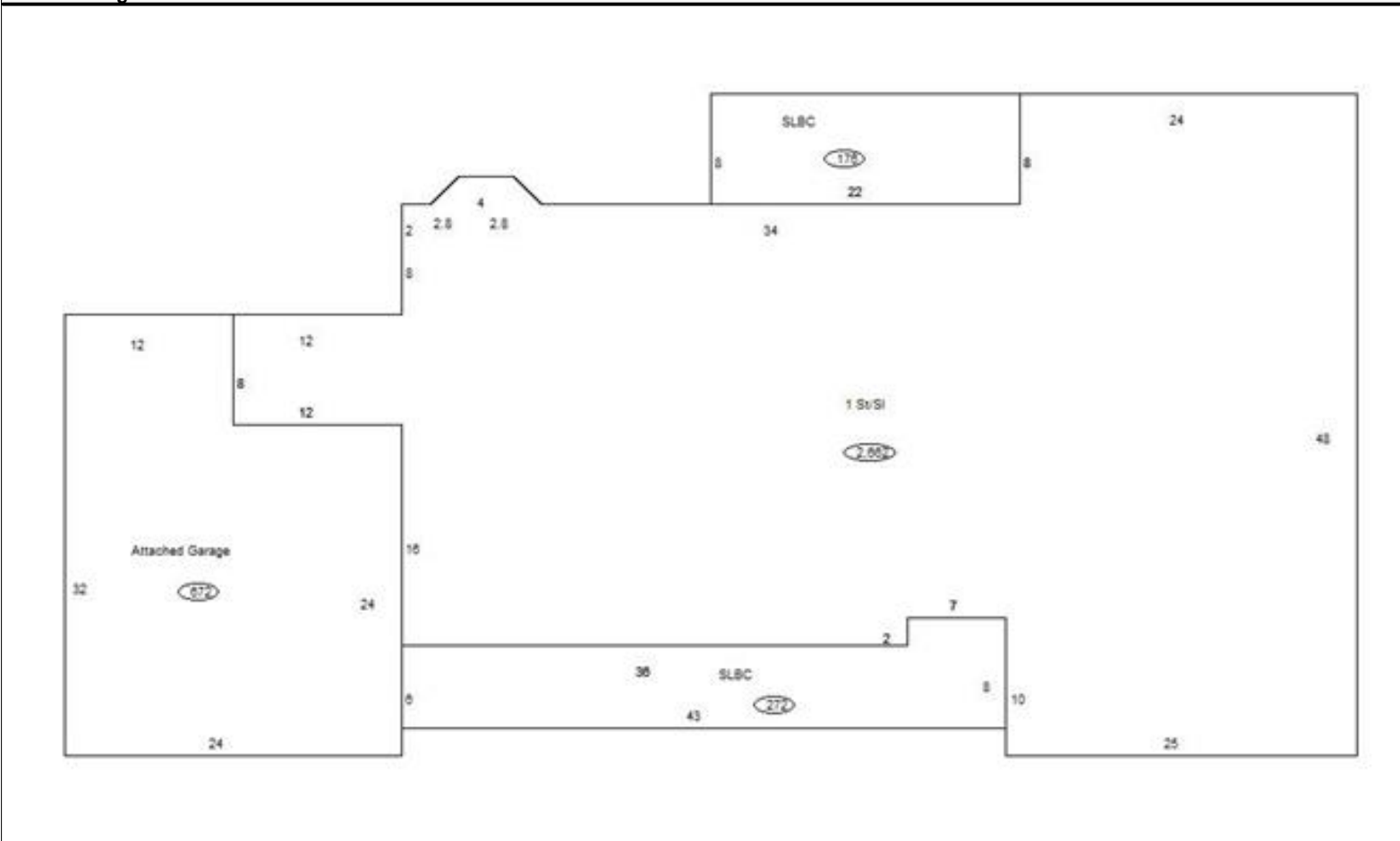

Sketch Vector Information

Sequence	Code	Type	Built Over	Scale	Section Label	Base Area	Multiplier	Total Area
1	R	1	Slab	10	1 St/SI	2,662	1.000	2,662
2	G	1		10	Attached Garage	672	1.000	672
3	M	PRCH		10	SLBC	272	1.000	272
4	M	PRCH		10	SLBC	176	1.000	176
Total Building Area						2,662		2,662



Rogers

Assessment Property Record Card for Tax Year 2026

Data provided by LISA DELOZIER County Assessor

Date 04/16/2026
Time 21:31:57
Page 4

660014492

Outbuildings/Site Improvements

Building Image	Code	Description	Dimensions	Floor	Roofing	Total Units
	GRDT	GARAGE - DETACHED	0x0x0			667
	Qual 3	Cond 3	Year 2000	Eff Age 20		
Valuation Summary		Modifier Total	RCN	Depr (49% Phys/ % Func)		RCNLD
Base Cost (27.54 x 667)		18,369	18,369	9,001		9,368