



Rogers

Assessment Property Record Card for Tax Year 2026

Data provided by LISA DELOZIER County Assessor

Date 04/18/2026
Time 07:05:04
Page 1

Assessment Data					Primary Image																																																																																																																				
Account 660014674 Parcel ID 22N16E-15-3-00000-000-0000 Cadastral ID 15-22-16-00600 Property Type REAL - Real Property Property Class RA VI Area 1 Tax Area 11 - SEQUOYAH/NW FIRE Name ID 298591 KIRKENDALL, CHARLES B & LENNON J 13173 E 440 RD CLAREMORE OK 74017-6858 Parcel Location Situs 13173 E 440 RD Subdivision Lot/Block / Parcel Size 10 - Acres Sec/Twn/Rng 15 / 22 / 16 / 3 Neighborhood 6050 - UNPLATTED School District S006 - SEQUOYAH SCHOOLS																																																																																																																									
Legal Description Lat/Long: 36.38066116 -95.59356937																																																																																																																									
SE SW SW					Building Permits																																																																																																																				
					<table border="1"> <thead> <tr> <th>Number</th> <th>Description</th> <th>Opened</th> <th>Closed</th> <th>Amount</th> </tr> </thead> <tbody> <tr> <td colspan="5" style="height: 100px;"> </td> </tr> </tbody> </table>					Number	Description	Opened	Closed	Amount																																																																																																											
Number	Description	Opened	Closed	Amount																																																																																																																					
Exemptions					Sale History																																																																																																																				
<table border="1"> <thead> <tr> <th>Code</th> <th>Type</th> <th>Active</th> <th>Maximum</th> <th>Exemption</th> </tr> </thead> <tbody> <tr> <td>H</td> <td>Homestead</td> <td>Yes</td> <td>1,000</td> <td>1,000</td> </tr> </tbody> </table>					Code	Type	Active	Maximum	Exemption	H	Homestead	Yes	1,000	1,000	<table border="1"> <thead> <tr> <th>Bk/Pg</th> <th>Grantor</th> <th>Date</th> <th>Price</th> <th>Code</th> </tr> </thead> <tbody> <tr> <td>1970/596</td> <td>DIKEMAN, JIMMIE LYNN</td> <td>07/31/2008</td> <td>128,000</td> <td>YES</td> </tr> </tbody> </table>					Bk/Pg	Grantor	Date	Price	Code	1970/596	DIKEMAN, JIMMIE LYNN	07/31/2008	128,000	YES																																																																																												
Code	Type	Active	Maximum	Exemption																																																																																																																					
H	Homestead	Yes	1,000	1,000																																																																																																																					
Bk/Pg	Grantor	Date	Price	Code																																																																																																																					
1970/596	DIKEMAN, JIMMIE LYNN	07/31/2008	128,000	YES																																																																																																																					
Parcel Valuation																																																																																																																									
<table border="1"> <thead> <tr> <th>Source</th> <th>REAL</th> <th>Fair Cash</th> <th>Capped</th> <th>Asmnt Level</th> <th>Assessed</th> <th>Levy Rate</th> <th>102.332</th> <th>Current Tax</th> </tr> </thead> <tbody> <tr> <td>Remove Cap</td> <td>2009</td> <td>Land Value 1,022</td> <td>1,022</td> <td>11%</td> <td>112</td> <td>Assessed</td> <td>6,681</td> <td>683.68</td> </tr> <tr> <td>Year Frozen</td> <td>0</td> <td>Improvements 59,718</td> <td>59,718</td> <td></td> <td>6,569</td> <td>Penalty</td> <td>0</td> <td></td> </tr> <tr> <td>Uncapped Value</td> <td>0</td> <td>Mobile Home 0</td> <td>0</td> <td></td> <td>0</td> <td>Exemption</td> <td>1,000</td> <td>-89.00</td> </tr> <tr> <td>TIF Project ID</td> <td>0</td> <td>Total Value 60,740</td> <td>60,740</td> <td></td> <td>6,681</td> <td>Total Taxable</td> <td>5,681</td> <td>595.00</td> </tr> </tbody> </table>										Source	REAL	Fair Cash	Capped	Asmnt Level	Assessed	Levy Rate	102.332	Current Tax	Remove Cap	2009	Land Value 1,022	1,022	11%	112	Assessed	6,681	683.68	Year Frozen	0	Improvements 59,718	59,718		6,569	Penalty	0		Uncapped Value	0	Mobile Home 0	0		0	Exemption	1,000	-89.00	TIF Project ID	0	Total Value 60,740	60,740		6,681	Total Taxable	5,681	595.00																																																																			
Source	REAL	Fair Cash	Capped	Asmnt Level	Assessed	Levy Rate	102.332	Current Tax																																																																																																																	
Remove Cap	2009	Land Value 1,022	1,022	11%	112	Assessed	6,681	683.68																																																																																																																	
Year Frozen	0	Improvements 59,718	59,718		6,569	Penalty	0																																																																																																																		
Uncapped Value	0	Mobile Home 0	0		0	Exemption	1,000	-89.00																																																																																																																	
TIF Project ID	0	Total Value 60,740	60,740		6,681	Total Taxable	5,681	595.00																																																																																																																	
Assessment History																																																																																																																									
<table border="1"> <thead> <tr> <th>Tax Year</th> <th>Statement Number</th> <th>Billed Owner</th> <th>Tax Area</th> <th>Total Value</th> <th>Exemptions</th> <th>Taxable Value</th> <th>Billed Tax</th> </tr> </thead> <tbody> <tr><td>2025</td><td>2025-660014674</td><td>KIRKENDALL, CHARLES B &</td><td>11</td><td>63,183</td><td>1000</td><td>5,701</td><td>598.00</td></tr> <tr><td>2024</td><td>2024-660014674</td><td>KIRKENDALL, CHARLES B &</td><td>11</td><td>61,481</td><td>1000</td><td>5,505</td><td>579.00</td></tr> <tr><td>2023</td><td>2023-660014674</td><td>KIRKENDALL, CHARLES B &</td><td>11</td><td>57,424</td><td>1000</td><td>5,316</td><td>571.00</td></tr> <tr><td>2022</td><td>2022-660014674</td><td>KIRKENDALL, CHARLES B &</td><td>11</td><td>59,895</td><td>1000</td><td>5,588</td><td>603.00</td></tr> <tr><td>2021</td><td>2021-660014674</td><td>KIRKENDALL, CHARLES B &</td><td>11</td><td>63,563</td><td>1000</td><td>5,992</td><td>623.00</td></tr> <tr><td>2020</td><td>2020-660014674</td><td>KIRKENDALL, CHARLES B &</td><td>11</td><td>66,062</td><td>1000</td><td>6,266</td><td>672.00</td></tr> <tr><td>2019</td><td>2019-660014674</td><td>KIRKENDALL, CHARLES B &</td><td>11</td><td>64,393</td><td>1000</td><td>6,083</td><td>645.00</td></tr> <tr><td>2018</td><td>2018-660014674</td><td>KIRKENDALL, CHARLES B &</td><td>11</td><td>70,375</td><td>1000</td><td>6,742</td><td>720.00</td></tr> <tr><td>2017</td><td>2017-660014674</td><td>KIRKENDALL, CHARLES B &</td><td>11</td><td>69,597</td><td>1000</td><td>6,655</td><td>694.00</td></tr> <tr><td>2016</td><td>2016-660014674</td><td>KIRKENDALL, CHARLES B &</td><td>11</td><td>67,608</td><td>1000</td><td>6,436</td><td>677.00</td></tr> <tr><td>2015</td><td>2015-660014674</td><td>KIRKENDALL, CHARLES B &</td><td>11</td><td>102,700</td><td>1000</td><td>10,019</td><td>1,054.00</td></tr> <tr><td>2014</td><td>2014-660014674</td><td>KIRKENDALL, CHARLES B &</td><td>11</td><td>104,731</td><td>1000</td><td>9,699</td><td>1,021.00</td></tr> <tr><td>2013</td><td>2013-660014674</td><td>KIRKENDALL, CHARLES B &</td><td>11</td><td>99,594</td><td>1000</td><td>9,388</td><td>971.00</td></tr> </tbody> </table>										Tax Year	Statement Number	Billed Owner	Tax Area	Total Value	Exemptions	Taxable Value	Billed Tax	2025	2025-660014674	KIRKENDALL, CHARLES B &	11	63,183	1000	5,701	598.00	2024	2024-660014674	KIRKENDALL, CHARLES B &	11	61,481	1000	5,505	579.00	2023	2023-660014674	KIRKENDALL, CHARLES B &	11	57,424	1000	5,316	571.00	2022	2022-660014674	KIRKENDALL, CHARLES B &	11	59,895	1000	5,588	603.00	2021	2021-660014674	KIRKENDALL, CHARLES B &	11	63,563	1000	5,992	623.00	2020	2020-660014674	KIRKENDALL, CHARLES B &	11	66,062	1000	6,266	672.00	2019	2019-660014674	KIRKENDALL, CHARLES B &	11	64,393	1000	6,083	645.00	2018	2018-660014674	KIRKENDALL, CHARLES B &	11	70,375	1000	6,742	720.00	2017	2017-660014674	KIRKENDALL, CHARLES B &	11	69,597	1000	6,655	694.00	2016	2016-660014674	KIRKENDALL, CHARLES B &	11	67,608	1000	6,436	677.00	2015	2015-660014674	KIRKENDALL, CHARLES B &	11	102,700	1000	10,019	1,054.00	2014	2014-660014674	KIRKENDALL, CHARLES B &	11	104,731	1000	9,699	1,021.00	2013	2013-660014674	KIRKENDALL, CHARLES B &	11	99,594	1000	9,388	971.00
Tax Year	Statement Number	Billed Owner	Tax Area	Total Value	Exemptions	Taxable Value	Billed Tax																																																																																																																		
2025	2025-660014674	KIRKENDALL, CHARLES B &	11	63,183	1000	5,701	598.00																																																																																																																		
2024	2024-660014674	KIRKENDALL, CHARLES B &	11	61,481	1000	5,505	579.00																																																																																																																		
2023	2023-660014674	KIRKENDALL, CHARLES B &	11	57,424	1000	5,316	571.00																																																																																																																		
2022	2022-660014674	KIRKENDALL, CHARLES B &	11	59,895	1000	5,588	603.00																																																																																																																		
2021	2021-660014674	KIRKENDALL, CHARLES B &	11	63,563	1000	5,992	623.00																																																																																																																		
2020	2020-660014674	KIRKENDALL, CHARLES B &	11	66,062	1000	6,266	672.00																																																																																																																		
2019	2019-660014674	KIRKENDALL, CHARLES B &	11	64,393	1000	6,083	645.00																																																																																																																		
2018	2018-660014674	KIRKENDALL, CHARLES B &	11	70,375	1000	6,742	720.00																																																																																																																		
2017	2017-660014674	KIRKENDALL, CHARLES B &	11	69,597	1000	6,655	694.00																																																																																																																		
2016	2016-660014674	KIRKENDALL, CHARLES B &	11	67,608	1000	6,436	677.00																																																																																																																		
2015	2015-660014674	KIRKENDALL, CHARLES B &	11	102,700	1000	10,019	1,054.00																																																																																																																		
2014	2014-660014674	KIRKENDALL, CHARLES B &	11	104,731	1000	9,699	1,021.00																																																																																																																		
2013	2013-660014674	KIRKENDALL, CHARLES B &	11	99,594	1000	9,388	971.00																																																																																																																		



Rogers

Assessment Property Record Card for Tax Year 2026

Data provided by LISA DELOZIER County Assessor

Date 04/18/2026
Time 07:05:05
Page 2

Lot Data	Units-Buildable - UNPLATTED (UNITS BUILDABLE)	Primary Image
Lot Size		
Lot Count		
Units Buildable		
Non-Ag Acres	0	
Topography		
Street Access		
Utilities		
Amenities	LAND QUALITY	
Method	Units-Buildable	
Base Lot Value		
Factor Value		
Adjustments		
Lot Value		

Residential Data	
Type	1 Single Family Residence
Condition	2 - Fair
Quality	2 - Fair
Architecture	
Style	100% One Story
Exterior Wall	100% Frame, Siding, Wood
Base/Total Area	1,250 / 1,250
Style	100% One Story
HVAC	100% Warmed & Cooled Air
Roof Cover	1 Composition Shingle
Area on Slab	0
Fixture/RghIn	4 /
Bed/F/H Bath	2 / 1.0 /
Basement Area	
Garage Type	
Remodel	RMA -
Year/Eff Age	1964 / 51

\\tsclient\T\LOGAN\LOGAN RESIDENTIAL VI\2022-11-28\IMG_00; 11/28/2022

GRM Approach	
GRM Code	
Gross Rent	0.00
Indicated Value	

Multiple Regression	
MRA Code	
Adjusted R	
Indicated Value	

Direct Comparables	
Selection Model	1 Res
Adjustment Model	A2 AO Test
Comparables	
Indicated Value	

Cost Approach				Manual : 01/2025			
Base Cost	90.48	Total Misc Impr	+ 1,932				
Roofing Adj	+ 4.05	Garage Cost	+ 0				
Subfloor Adj	+ 2.31	Total RCN	= 140,870				
Heat/Cool Adj	+ 10.30	Depreciation (60%)	- 84,522				
Plumbing Adj	+ 4.01	Lump Sums	+ 0				
Basement Adj	+ 0.00	RCNLD	= 56,348				
Adj Base Cost	= 111.15	Lot Value	+ 0				
Total Area	x 1,250	Indicated Value	= 56,348				
Adjusted Cost	= 138,938	Value Per SqFt	45.08				

Value Reconciliation			
Selected Approach	Cost Approach		
Improvements	56,348		
Lot Value			
Indicated Value	56,348	45.08	Per SqFt
Agland Value	1,022		
Site Improvements	3,370		
Total Value	60,740	48.59	Total Value Per SqFt

Miscellaneous Improvements								
Code	Description	Sketch ID	Size	Year	Units	Unit Cost	Depr	Value
PATO	SLAB PORCH - OPEN	35487	16x13		208	9.29		1,932



Rogers

Assessment Property Record Card for Tax Year 2026

Data provided by LISA DELOZIER County Assessor

Date 04/18/2026

Time 07:05:05

Page 3

Sketch Image

660014674

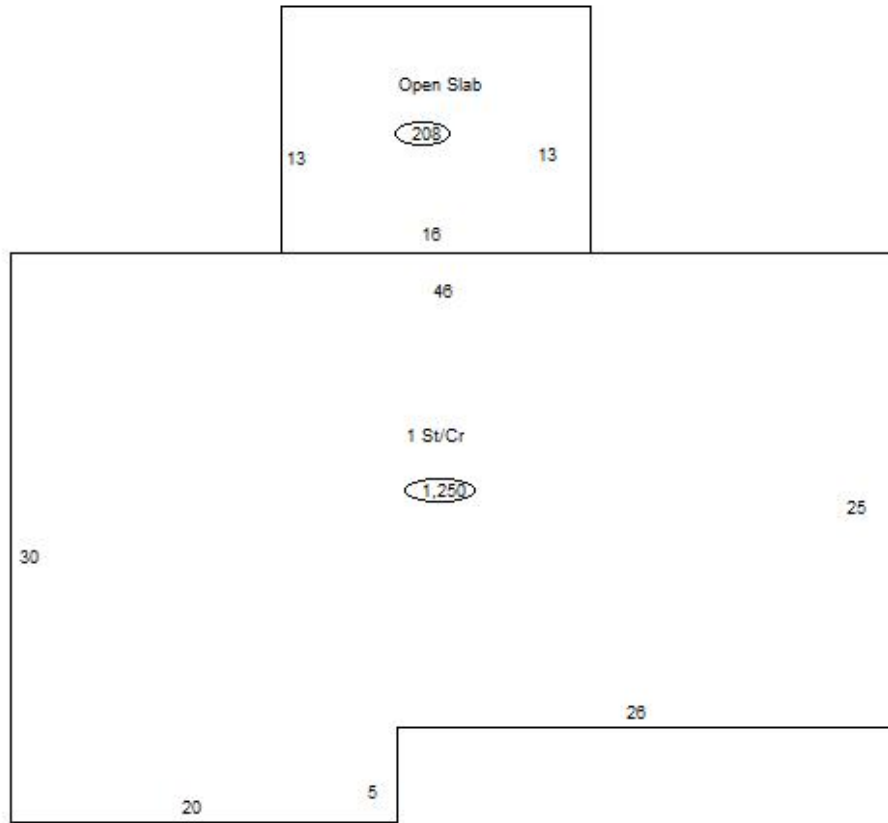

Sketch Vector Information

Sequence	Code	Type	Built Over	Scale	Section Label	Base Area	Multiplier	Total Area
1	M	PATO		10	Open Slab	208	1.000	208
2	R	1	Crawl	10	1 St/Cr	1,250	1.000	1,250
Total Building Area						1,250		1,250



Rogers

Assessment Property Record Card for Tax Year 2026

Data provided by LISA DELOZIER County Assessor

Date 04/18/2026
Time 07:05:05
Page 4

660014674

Outbuildings/Site Improvements

Building Image	Code	Description	Dimensions	Floor	Roofing	Total Units
	STF	STG FAIR	24x30x0			720
	Qual 2	Cond 3	Year 1973	Eff Age 40		

Valuation Summary	Modifier Total	RCN	Depr (0% Phys/ % Func)	RCNLD
Base Cost (4.68 x 720)	3,370		3,370	3,370



Rogers

Assessment Property Record Card for Tax Year 2026

Data provided by LISA DELOZIER County Assessor

Date 04/18/2026
Time 07:05:05
Page 5

Agland Inventory

660014674

Soi	Description	Land Use	LPI	Adj Type	Adj Code	Acres	Use/Acre	Mkt/Acre	Use Value	Market Value
HC	HECTOR STONY SANDY LOAM	TMBR	20			3.480	36	36	125	125
HLC	HECTOR-LINKER FINE SANDY	TMBR	35			.720	63	63	45	45
SUC	SUMMIT SILTY CLAY LOAM 3-	TMBR	67			2.000	121	121	241	241
TMBR Totals						6.200			411	411
SUC	SUMMIT SILTY CLAY LOAM 3-	NTV PST	67			3.800	161	161	611	611
NTV PST Totals						3.800			611	611
Total Agland						10.000			1,022	1,022