



Rogers

Assessment Property Record Card for Tax Year 2026

Data provided by LISA DELOZIER County Assessor

Date 04/16/2026
Time 22:57:57
Page 1

Assessment Data					Primary Image									
Account	660014681				 <p>\\tsclient\T\LOGAN\LOGAN RESIDENTIAL VI\2022-11-28\IMG_00: 11/28/2022</p>									
Parcel ID	22N16E-15-4-00000-000-0000													
Cadastral ID	15-22-16-01200													
Property Type	REAL - Real Property													
Property Class	RA	VI Area 1												
Tax Area	11 - SEQUOYAH/NW FIRE													
Name ID	305966													
MARTIN, PAMILA														
TRUSTEE														
15940 S 4170 RD CLAREMORE OK 74017-8815														
Parcel Location														
Situs	15940 S 4170 RD													
Subdivision														
Lot/Block	/	Parcel Size	70 - Acres											
Sec/Twn/Rng	15 / 22 / 16 / 4													
Neighborhood	6050 - UNPLATTED													
School District	S006 - SEQUOYAH SCHOOLS													
Legal Description														
Lat/Long: 36.38318127 -95.58095527														
SE SE & E2 NE SE & E2 W2 NE SE														
Building Permits														
<table border="1"> <thead> <tr> <th>Number</th> <th>Description</th> <th>Opened</th> <th>Closed</th> <th>Amount</th> </tr> </thead> <tbody> <tr> <td colspan="5"> </td> </tr> </tbody> </table>					Number	Description	Opened	Closed	Amount					
Number	Description	Opened	Closed	Amount										
Exemptions														
Code	Type	Active	Maximum	Exemption										
H	Homestead	Yes	1,000	1,000										
Sale History														
Bk/Pg	Grantor	Date	Price	Code										
2210/847	SCROGGS, PAMILA JANE-{MARTIN}	11/10/2011	0	4										
Parcel Valuation														
Source	REAL	Fair Cash	Capped	Asmnt Level	Assessed	Levy Rate	102.332	Current Tax						
Remove Cap	0	Land Value	7,835	5,150	11%	567	Assessed	17,921	1,833.88					
Year Frozen	2017	Improvements	240,022	157,766		17,354	Penalty	0						
Uncapped Value	0	Mobile Home	0	0		0	Exemption	1,000	-88.00					
TIF Project ID	0	Total Value	247,857	162,916		17,921	Total Taxable	16,921	1,746.00					
Assessment History														
Tax Year	Statement Number	Billed Owner	Tax Area	Total Value	Exemptions	Taxable Value	Billed Tax							
2025	2025-660014681	MARTIN, PAMILA	11	221,055	1000	16,921	1,745.00							
2024	2024-660014681	MARTIN, PAMILA	11	211,456	1000	16,921	1,752.00							
2023	2023-660014681	MARTIN, PAMILA	11	199,067	1000	16,920	1,787.00							
2022	2022-660014681	MARTIN, PAMILA	11	199,062	1000	16,920	1,798.00							
2021	2021-660014681	MARTIN, PAMILA	11	173,654	1000	16,921	1,736.00							
2020	2020-660014681	MARTIN, PAMILA	11	172,317	1000	16,921	1,792.00							
2019	2019-660014681	MARTIN, PAMILA	11	162,916	1000	16,921	1,768.00							
2018	2018-660014681	MARTIN, PAMILA	11	167,667	1000	17,250	1,821.00							
2017	2017-660014681	MARTIN, PAMILA	11	166,152	1000	17,250	1,779.00							
2016	2016-660014681	MARTIN, PAMILA	11	161,416	1000	16,719	1,736.00							
2015	2015-660014681	MARTIN, PAMILA	11	156,601	1000	16,203	1,697.00							
2014	2014-660014681	MARTIN, PAMILA	11	159,623	1000	15,701	1,645.00							
2013	2013-660014681	MARTIN, PAMILA	11	149,191	1000	15,215	1,567.00							



Rogers

Assessment Property Record Card for Tax Year 2026

Data provided by LISA DELOZIER County Assessor

Date 04/16/2026
Time 22:57:57
Page 2

Lot Data	Units-Buildable - UNPLATTED (UNITS BUILDABLE)	Primary Image
Lot Size		
Lot Count		
Units Buildable		
Non-Ag Acres	0	
Topography		
Street Access		
Utilities		
Amenities	LAND QUALITY	
Method	Units-Buildable	
Base Lot Value		
Factor Value		
Adjustments		
Lot Value		

Residential Data	
Type	1 Single Family Residence
Condition	3 - Average
Quality	3 - Average
Architecture	
Style	100% One Story
Exterior Wall	60% Veneer, Masonry 40% Frame, Siding, Wood
Base/Total Area	1,962 / 1,962
Style	100% One Story
HVAC	100% Warmed & Cooled Air
Roof Cover	1 Composition Shingle
Area on Slab	1,962
Fixture/RghIn	11 /
Bed/F/H Bath	3 / 2.0 /
Basement Area	
Garage Type	576 Attached Garage - Unfinished
Remodel	
Year/Eff Age	2006 / 15



\\tsclient\T\LOGAN\LOGAN RESIDENTIAL VI\2022-11-28\IMG_00: 11/28/2022

GRM Approach	
GRM Code	
Gross Rent	0.00
Indicated Value	

Multiple Regression	
MRA Code	
Adjusted R	
Indicated Value	

Direct Comparables	
Selection Model	1 Res
Adjustment Model	A2 AO Test
Comparables	
Indicated Value	

Cost Approach				Manual : 01/2025			
Base Cost	104.63	Total Misc Impr	+ 17,438				
Roofing Adj	+ 4.72	Garage Cost	+ 17,775				
Subfloor Adj	+ -2.21	Total RCN	= 285,741				
Heat/Cool Adj	+ 12.64	Depreciation (16%)	- 45,719				
Plumbing Adj	+ 7.91	Lump Sums	+ 0				
Basement Adj	+ 0.00	RCNLD	= 240,022				
Adj Base Cost	= 127.69	Lot Value	+ 240,022				
Total Area	x 1,962	Indicated Value	= 240,022				
Adjusted Cost	= 250,528	Value Per SqFt	122.34				

Value Reconciliation			
Selected Approach	Cost Approach		
Improvements	240,022		
Lot Value			
Indicated Value	240,022	122.34	Per SqFt
Agland Value	7,835		
Site Improvements			
Total Value	487,879	248.66	Total Value Per SqFt

Miscellaneous Improvements								
Code	Description	Sketch ID	Size	Year	Units	Unit Cost	Depr	Value
FPR1	FIREPLACE - RESIDENTIAL 1 STORY	0		1	1	5,615.40		5,615
PRCH	SLAB PORCH - COVERED	35505	464		464	25.48		11,823



Rogers

Assessment Property Record Card for Tax Year 2026

Data provided by LISA DELOZIER County Assessor

Date 04/16/2026
 Time 22:57:57
 Page 3

Sketch Image

660014681

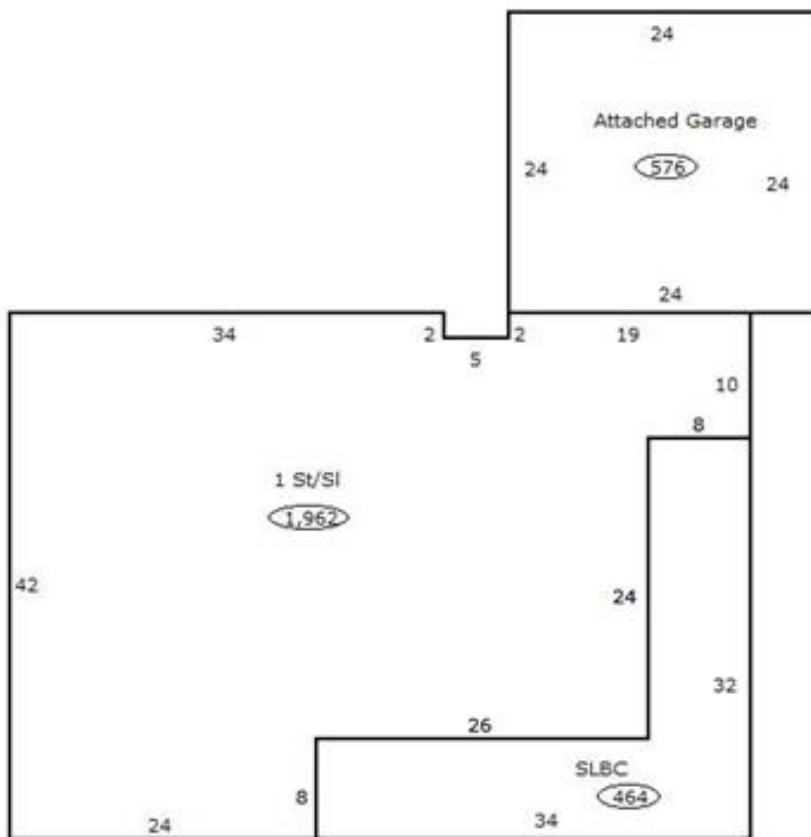

Sketch Vector Information

Sequence	Code	Type	Built Over	Scale	Section Label	Base Area	Multiplier	Total Area
1	R	1	Slab	13	1 St/SI	1,962	1.000	1,962
2	G	1		13	Attached Garage	576	1.000	576
3	M	PRCH		13	SLBC	464	1.000	464
Total Building Area						1,962		1,962



Rogers

Assessment Property Record Card for Tax Year 2026

Data provided by LISA DELOZIER County Assessor

Date 04/16/2026
Time 22:57:58
Page 4

Agland Inventory

660014681

Soi	Description	Land Use	LPI	Adj Type	Adj Code	Acres	Use/Acre	Mkt/Acre	Use Value	Market Value
BR	BREAKS-ALLUVIAL LAND COMP	TMBR	30			9.779	54	54	528	528
HC	HECTOR STONY SANDY LOAM	TMBR	20			4.334	36	36	156	156
OKA	OKEMAH SILTY CLAY LOAM	NTV PST	90			20.815	216	216	4,496	4,496
SUC	SUMMIT SILTY CLAY LOAM 3-	TMBR	67			22.016	121	121	2,655	2,655
TMBR Totals						56.945			7,835	7,835
Total Agland						56.945			7,835	7,835