



# Rogers

## Assessment Property Record Card for Tax Year 2026

Data provided by LISA DELOZIER County Assessor

Date 04/16/2026  
Time 23:58:15  
Page 1

Assessment Data					Primary Image																																																																																																															
<b>Account</b> 660015086 <b>Parcel ID</b> 000000-00-0-10010-143-0009 <b>Cadastral ID</b> 16-21-16-01350 <b>Property Type</b> REAL - Real Property <b>Property Class</b> URP VI Area 1 <b>Tax Area</b> 17 - CLAREMORE OT <b>Name ID</b> 322915 SMITH, MIKE T  316 A S CHOCTAW AVE CLAREMORE OK 74017-0000  <b>Parcel Location</b> <b>Situs</b> 00316 S CHOCTAW AVE <b>Subdivision</b> CLAREMORE O T <b>Lot/Block</b> 0009 / 0143 <b>Parcel Size</b> .75 - Lots <b>Sec/Twn/Rng</b> 16 / 21 / 16 / 5 <b>Neighborhood</b> 1177 - R-V01-SW CLAREMORE <b>School District</b> S001 - CLAREMORE SCHOOLS																																																																																																																				
<b>Legal Description</b> Lat/Long: 36.30653218 -95.60888467 N 178' LOT 9 BLOCK 143 CLAREMORE O T																																																																																																																				
<b>Exemptions</b> <table border="1"> <thead> <tr> <th>Code</th> <th>Type</th> <th>Active</th> <th>Maximum</th> <th>Exemption</th> </tr> </thead> <tbody> <tr> <td></td> <td></td> <td></td> <td></td> <td></td> </tr> </tbody> </table>					Code	Type	Active	Maximum	Exemption						<b>Building Permits</b> <table border="1"> <thead> <tr> <th>Number</th> <th>Description</th> <th>Opened</th> <th>Closed</th> <th>Amount</th> </tr> </thead> <tbody> <tr> <td></td> <td></td> <td></td> <td></td> <td></td> </tr> </tbody> </table>					Number	Description	Opened	Closed	Amount																																																																																												
Code	Type	Active	Maximum	Exemption																																																																																																																
Number	Description	Opened	Closed	Amount																																																																																																																
<b>Parcel Valuation</b> <table border="1"> <thead> <tr> <th>Source</th> <th>REAL</th> <th>Fair Cash</th> <th>Capped</th> <th>Asmnt Level</th> <th>Assessed</th> <th>Levy Rate</th> <th>92.430</th> <th>Current Tax</th> </tr> </thead> <tbody> <tr> <td>Remove Cap</td> <td>2018</td> <td>Land Value</td> <td>37,592</td> <td>37,592</td> <td>11%</td> <td>4,135</td> <td>Assessed</td> <td>13,633 1,260.10</td> </tr> <tr> <td>Year Frozen</td> <td>0</td> <td>Improvements</td> <td>86,346</td> <td>86,346</td> <td></td> <td>9,498</td> <td>Penalty</td> <td>0</td> </tr> <tr> <td>Uncapped Value</td> <td>0</td> <td>Mobile Home</td> <td>0</td> <td>0</td> <td></td> <td>0</td> <td>Exemption</td> <td>0 0.00</td> </tr> <tr> <td>TIF Project ID</td> <td>0</td> <td>Total Value</td> <td>123,938</td> <td>123,938</td> <td></td> <td>13,633</td> <td>Total Taxable</td> <td>13,633 1,260.00</td> </tr> </tbody> </table>					Source	REAL	Fair Cash	Capped	Asmnt Level	Assessed	Levy Rate	92.430	Current Tax	Remove Cap	2018	Land Value	37,592	37,592	11%	4,135	Assessed	13,633 1,260.10	Year Frozen	0	Improvements	86,346	86,346		9,498	Penalty	0	Uncapped Value	0	Mobile Home	0	0		0	Exemption	0 0.00	TIF Project ID	0	Total Value	123,938	123,938		13,633	Total Taxable	13,633 1,260.00	<b>Sale History</b> <table border="1"> <thead> <tr> <th>Bk/Pg</th> <th>Grantor</th> <th>Date</th> <th>Price</th> <th>Code</th> </tr> </thead> <tbody> <tr> <td>2670/264</td> <td>DININGER, RANDALL C &amp;</td> <td>10/23/2017</td> <td>103,000</td> <td>YES</td> </tr> <tr> <td>1233/1</td> <td>GIBSON, JEWEL</td> <td>06/20/2000</td> <td>0</td> <td>No</td> </tr> <tr> <td>1152/673</td> <td>BROWN, MARION DANIEL</td> <td>01/20/1999</td> <td>45,000</td> <td>Yes</td> </tr> <tr> <td>926/153</td> <td>GENERAL ELECTRIC MTG INS--CORP</td> <td>08/17/1993</td> <td>35,000</td> <td>No</td> </tr> <tr> <td>920/771</td> <td>MIDLAND MORTGAGE CO</td> <td>06/21/1993</td> <td>0</td> <td>No</td> </tr> <tr> <td>920/770</td> <td>NATIONSBANK OF VIRGINIA</td> <td>06/02/1993</td> <td>0</td> <td>No</td> </tr> </tbody> </table>					Bk/Pg	Grantor	Date	Price	Code	2670/264	DININGER, RANDALL C &	10/23/2017	103,000	YES	1233/1	GIBSON, JEWEL	06/20/2000	0	No	1152/673	BROWN, MARION DANIEL	01/20/1999	45,000	Yes	926/153	GENERAL ELECTRIC MTG INS--CORP	08/17/1993	35,000	No	920/771	MIDLAND MORTGAGE CO	06/21/1993	0	No	920/770	NATIONSBANK OF VIRGINIA	06/02/1993	0	No																											
Source	REAL	Fair Cash	Capped	Asmnt Level	Assessed	Levy Rate	92.430	Current Tax																																																																																																												
Remove Cap	2018	Land Value	37,592	37,592	11%	4,135	Assessed	13,633 1,260.10																																																																																																												
Year Frozen	0	Improvements	86,346	86,346		9,498	Penalty	0																																																																																																												
Uncapped Value	0	Mobile Home	0	0		0	Exemption	0 0.00																																																																																																												
TIF Project ID	0	Total Value	123,938	123,938		13,633	Total Taxable	13,633 1,260.00																																																																																																												
Bk/Pg	Grantor	Date	Price	Code																																																																																																																
2670/264	DININGER, RANDALL C &	10/23/2017	103,000	YES																																																																																																																
1233/1	GIBSON, JEWEL	06/20/2000	0	No																																																																																																																
1152/673	BROWN, MARION DANIEL	01/20/1999	45,000	Yes																																																																																																																
926/153	GENERAL ELECTRIC MTG INS--CORP	08/17/1993	35,000	No																																																																																																																
920/771	MIDLAND MORTGAGE CO	06/21/1993	0	No																																																																																																																
920/770	NATIONSBANK OF VIRGINIA	06/02/1993	0	No																																																																																																																
<b>Assessment History</b> <table border="1"> <thead> <tr> <th>Tax Year</th> <th>Statement Number</th> <th>Billed Owner</th> <th>Tax Area</th> <th>Total Value</th> <th>Exemptions</th> <th>Taxable Value</th> <th>Billed Tax</th> </tr> </thead> <tbody> <tr><td>2025</td><td>2025-660015086</td><td>SMITH, MIKE T</td><td>17</td><td>121,334</td><td>0</td><td>13,347</td><td>1,234.00</td></tr> <tr><td>2024</td><td>2024-660015086</td><td>SMITH, MIKE T</td><td>17</td><td>121,920</td><td>0</td><td>13,002</td><td>1,202.00</td></tr> <tr><td>2023</td><td>2023-660015086</td><td>SMITH, MIKE T</td><td>17</td><td>116,179</td><td>0</td><td>12,383</td><td>1,134.00</td></tr> <tr><td>2022</td><td>2022-660015086</td><td>SMITH, MIKE T</td><td>17</td><td>107,214</td><td>0</td><td>11,794</td><td>1,092.00</td></tr> <tr><td>2021</td><td>2021-660015086</td><td>SMITH, MIKE T</td><td>17</td><td>111,513</td><td>0</td><td>12,013</td><td>1,061.00</td></tr> <tr><td>2020</td><td>2020-660015086</td><td>SMITH, MIKE T</td><td>17</td><td>104,007</td><td>0</td><td>11,441</td><td>1,048.00</td></tr> <tr><td>2019</td><td>2019-660015086</td><td>SMITH, MIKE T</td><td>17</td><td>101,554</td><td>0</td><td>11,171</td><td>1,035.00</td></tr> <tr><td>2018</td><td>2018-660015086</td><td>SMITH, MIKE T</td><td>17</td><td>105,463</td><td>0</td><td>11,601</td><td>1,072.00</td></tr> <tr><td>2017</td><td>2017-660015086</td><td>DININGER, RANDALL C &amp;</td><td>17</td><td>95,818</td><td>0</td><td>10,496</td><td>964.00</td></tr> <tr><td>2016</td><td>2016-660015086</td><td>DININGER, RANDALL C &amp;</td><td>17</td><td>93,152</td><td>0</td><td>9,997</td><td>938.00</td></tr> <tr><td>2015</td><td>2015-660015086</td><td>DININGER, RANDALL C &amp;</td><td>17</td><td>94,304</td><td>0</td><td>9,521</td><td>859.00</td></tr> <tr><td>2014</td><td>2014-660015086</td><td>DININGER, RANDALL C &amp;</td><td>17</td><td>95,241</td><td>0</td><td>9,067</td><td>841.00</td></tr> <tr><td>2013</td><td>2013-660015086</td><td>DININGER, RANDALL C &amp;</td><td>17</td><td>91,588</td><td>0</td><td>8,636</td><td>790.00</td></tr> </tbody> </table>					Tax Year	Statement Number	Billed Owner	Tax Area	Total Value	Exemptions	Taxable Value	Billed Tax	2025	2025-660015086	SMITH, MIKE T	17	121,334	0	13,347	1,234.00	2024	2024-660015086	SMITH, MIKE T	17	121,920	0	13,002	1,202.00	2023	2023-660015086	SMITH, MIKE T	17	116,179	0	12,383	1,134.00	2022	2022-660015086	SMITH, MIKE T	17	107,214	0	11,794	1,092.00	2021	2021-660015086	SMITH, MIKE T	17	111,513	0	12,013	1,061.00	2020	2020-660015086	SMITH, MIKE T	17	104,007	0	11,441	1,048.00	2019	2019-660015086	SMITH, MIKE T	17	101,554	0	11,171	1,035.00	2018	2018-660015086	SMITH, MIKE T	17	105,463	0	11,601	1,072.00	2017	2017-660015086	DININGER, RANDALL C &	17	95,818	0	10,496	964.00	2016	2016-660015086	DININGER, RANDALL C &	17	93,152	0	9,997	938.00	2015	2015-660015086	DININGER, RANDALL C &	17	94,304	0	9,521	859.00	2014	2014-660015086	DININGER, RANDALL C &	17	95,241	0	9,067	841.00	2013	2013-660015086	DININGER, RANDALL C &	17	91,588	0	8,636	790.00
Tax Year	Statement Number	Billed Owner	Tax Area	Total Value	Exemptions	Taxable Value	Billed Tax																																																																																																													
2025	2025-660015086	SMITH, MIKE T	17	121,334	0	13,347	1,234.00																																																																																																													
2024	2024-660015086	SMITH, MIKE T	17	121,920	0	13,002	1,202.00																																																																																																													
2023	2023-660015086	SMITH, MIKE T	17	116,179	0	12,383	1,134.00																																																																																																													
2022	2022-660015086	SMITH, MIKE T	17	107,214	0	11,794	1,092.00																																																																																																													
2021	2021-660015086	SMITH, MIKE T	17	111,513	0	12,013	1,061.00																																																																																																													
2020	2020-660015086	SMITH, MIKE T	17	104,007	0	11,441	1,048.00																																																																																																													
2019	2019-660015086	SMITH, MIKE T	17	101,554	0	11,171	1,035.00																																																																																																													
2018	2018-660015086	SMITH, MIKE T	17	105,463	0	11,601	1,072.00																																																																																																													
2017	2017-660015086	DININGER, RANDALL C &	17	95,818	0	10,496	964.00																																																																																																													
2016	2016-660015086	DININGER, RANDALL C &	17	93,152	0	9,997	938.00																																																																																																													
2015	2015-660015086	DININGER, RANDALL C &	17	94,304	0	9,521	859.00																																																																																																													
2014	2014-660015086	DININGER, RANDALL C &	17	95,241	0	9,067	841.00																																																																																																													
2013	2013-660015086	DININGER, RANDALL C &	17	91,588	0	8,636	790.00																																																																																																													



# Rogers

## Assessment Property Record Card for Tax Year 2026

Data provided by LISA DELOZIER County Assessor

Date 04/16/2026  
Time 23:58:15  
Page 2

Lot Data		Square-Foot - NBHD 1177 #1
Lot Size		
Lot Count		
Units Buildable	15112	
Non-Ag Acres	0.3295	
Topography		
Street Access		
Utilities		
Amenities	LAND QUALITY	
Method	Square-Foot	
Base Lot Value	14,355.00 x 2.62 = 37,592	
Factor Value		
Adjustments		
Lot Value	37,592	



\\tsclient\T\LOGAN\LOGAN RESIDENTIAL VI\2023-8-15\IMG\_002I 8/15/2023

Residential Data	
Type	1 Single Family Residence
Condition	3 - Average
Quality	2 - Fair
Architecture	R3 Res Nbhd 3
Style	100% 1 1/2 Story Finished
Exterior Wall	100% Frame, Siding, Vinyl
Base/Total Area	1,184 / 1,568
Style	100% 1 1/2 Story Finished
HVAC	100% Warmed & Cooled Air
Roof Cover	1 Composition Shingle
Area on Slab	0
Fixture/RghIn	8 /
Bed/F/H Bath	3 / 2.0 /
Basement Area	
Garage Type	
Remodel	
Year/Eff Age	1973 / 40

GRM Approach	
GRM Code	
Gross Rent	0.00
Indicated Value	

Multiple Regression			
MRA Code	1	Test	
Adusted R	0.8445		
Indicated Value	97,272	62.04	Per SqFt

Direct Comparables			
Selection Model	A	Adam Test	
Adjustment Model	1	2022 Residential	
Comparables	8		
Indicated Value	149,580		Per SqFt

Cost Approach				Manual : 01/2025			
Base Cost	79.27	Total Misc Impr	+	7,179			
Roofing Adj	+ 3.17	Garage Cost	+				
Subfloor Adj	+ 1.85	Total RCN	=	164,873			
Heat/Cool Adj	+ 10.30	Depreciation ( 50%)	-	82,437			
Plumbing Adj	+ 5.98	Lump Sums	+	3,910			
Basement Adj	+ 0.00	RCNLD	=	86,346			
Adj Base Cost	= 100.57	Lot Value	+	37,592			
Total Area	x 1,568	Indicated Value	=	123,938			
Adjusted Cost	= 157,694	Value Per SqFt		79.04			

Value Reconciliation			
Selected Approach	Cost Approach		
Improvements	86,346		
Lot Value	37,592		
Indicated Value	123,938	79.04	Per SqFt
Agland Value			
Site Improvements			
Total Value	123,938	79.04	Total Value Per SqFt

Miscellaneous Improvements								
Code	Description	Sketch ID	Size	Year	Units	Unit Cost	Depr	Value
FPR1	FIREPLACE - RESIDENTIAL 1 STORY	0		1	1	4,576.55		4,577
PATO	SLAB PORCH - OPEN	36255	3x3		9	10.24		92
PRCH	SLAB PORCH - COVERED	36256	15x8		120	20.92		2,510
WODO	WOOD DECK - OPEN	36257	15x8		120	23.27	30%	1,955
WODO	WOOD DECK - OPEN	36258	15x8		120	23.27	30%	1,955



# Rogers

## Assessment Property Record Card for Tax Year 2026

Data provided by LISA DELOZIER County Assessor

Date 04/16/2026  
 Time 23:58:15  
 Page 3

### Sketch Image

660015086

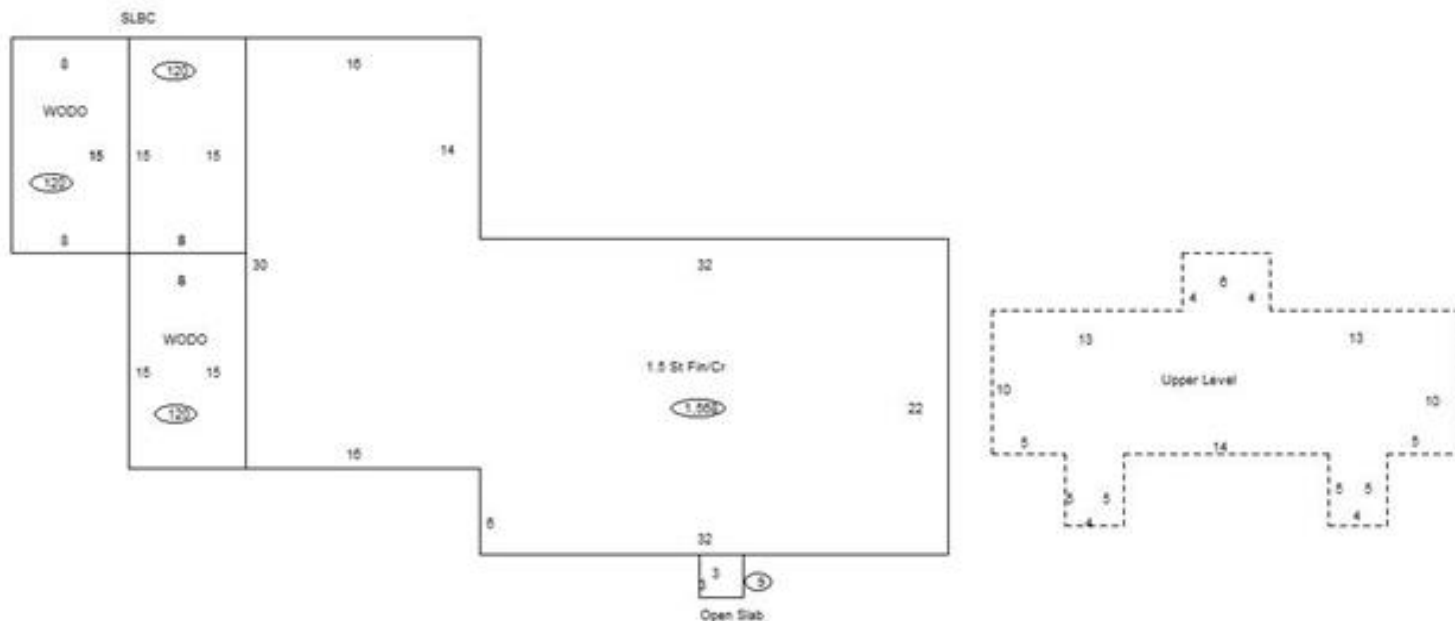

### Sketch Vector Information

Sequence	Code	Type	Built Over	Scale	Section Label	Base Area	Multiplier	Total Area
1	R	5	Crawl	10	1.5 St Fin/Cr	1,184	1.324	1,568
2	U	^UL	Overhang	10	Upper Level	384	1.000	384
3	M	PATO		10	Open Slab	9	1.000	9
4	M	PRCH		10	SLBC	120	1.000	120
5	M	WODO		10	WODO	120	1.000	120
6	M	WODO		10	WODO	120	1.000	120
<b>Total Building Area</b>						<b>1,184</b>		<b>1,568</b>



# Rogers

## Assessment Property Record Card for Tax Year 2026

Data provided by LISA DELOZIER County Assessor

Date 04/16/2026  
Time 23:58:15  
Page 4

660015086

### Outbuildings/Site Improvements

Building Image	Code	Description	Dimensions	Floor	Roofing	Total Units
	STF Qual 2	STG FAIR Cond	0x0x0 Year		Eff Age	
<b>Valuation Summary</b>		<b>Modifier Total</b>	<b>RCN</b>	<b>Depr (0% Phys/ % Func)</b>	<b>RCNLD</b>	
Base Cost (4.68 x )						
	STF Qual 2	STG FAIR Cond	0x0x0 Year		Eff Age	
<b>Valuation Summary</b>		<b>Modifier Total</b>	<b>RCN</b>	<b>Depr (0% Phys/ % Func)</b>	<b>RCNLD</b>	
Base Cost (4.68 x )						
	STF Qual 2	STG FAIR Cond	0x0x0 Year		Eff Age	
<b>Valuation Summary</b>		<b>Modifier Total</b>	<b>RCN</b>	<b>Depr (0% Phys/ % Func)</b>	<b>RCNLD</b>	
Base Cost (4.68 x )						
	STF Qual 2	STG FAIR Cond	0x0x0 Year		Eff Age	
<b>Valuation Summary</b>		<b>Modifier Total</b>	<b>RCN</b>	<b>Depr (0% Phys/ % Func)</b>	<b>RCNLD</b>	
Base Cost (4.68 x )						