



Rogers

Assessment Property Record Card for Tax Year 2026

Data provided by LISA DELOZIER County Assessor

Date 04/16/2026
Time 23:24:48
Page 1

Assessment Data					Primary Image																																																																																																																				
Account 660015145 Parcel ID 000000-00-0-10080-001-0019 Cadastral ID 16-21-16-01940 Property Type REAL - Real Property Property Class URP VI Area 1 Tax Area 17 - CLAREMORE OT Name ID 338267 MCCLELLAND, ERIN & LISA LIVING TRUST 523 S MARYLAND AVE CLAREMORE OK 74017-0000 Parcel Location Situs 00523 S MARYLAND AVE Subdivision DENNISON Lot/Block 0019 / 0001 Parcel Size 1 - Lots Sec/Twn/Rng 16 / 21 / 16 / 5 Neighborhood 1161 - R-V01-SW CLAREMORE School District S001 - CLAREMORE SCHOOLS																																																																																																																									
Legal Description Lot/Long: 36.30589747 -95.61379673																																																																																																																									
Legal Description LOT 19 BLOCK 1 DENNISON					Building Permits <table border="1"> <thead> <tr> <th>Number</th> <th>Description</th> <th>Opened</th> <th>Closed</th> <th>Amount</th> </tr> </thead> <tbody> <tr> <td colspan="5"> </td> </tr> </tbody> </table>					Number	Description	Opened	Closed	Amount																																																																																																											
Number	Description	Opened	Closed	Amount																																																																																																																					
Exemptions <table border="1"> <thead> <tr> <th>Code</th> <th>Type</th> <th>Active</th> <th>Maximum</th> <th>Exemption</th> </tr> </thead> <tbody> <tr> <td>H</td> <td>Homestead</td> <td>No</td> <td>1,000</td> <td></td> </tr> <tr> <td>PD</td> <td>Add-Homestead</td> <td>No</td> <td>1,000</td> <td></td> </tr> </tbody> </table>					Code	Type	Active	Maximum	Exemption	H	Homestead	No	1,000		PD	Add-Homestead	No	1,000		Sale History <table border="1"> <thead> <tr> <th>Bk/Pg</th> <th>Grantor</th> <th>Date</th> <th>Price</th> <th>Code</th> </tr> </thead> <tbody> <tr> <td>/</td> <td>RCH HOMES LLC</td> <td>05/06/2022</td> <td>166,000</td> <td>YES</td> </tr> <tr> <td>/</td> <td>ALLISON, DARRELL A &</td> <td>01/26/2022</td> <td>113,000</td> <td>10</td> </tr> <tr> <td>2718/663</td> <td>BLACKWELL, JOYCE F-TRUSTEE</td> <td>06/19/2018</td> <td>118,500</td> <td>YES</td> </tr> <tr> <td>2362/152</td> <td>SEC OF HUD</td> <td>10/11/2013</td> <td>0</td> <td>1</td> </tr> <tr> <td>2359/934</td> <td>WILSON, SHARON J</td> <td>07/10/2013</td> <td>0</td> <td>10</td> </tr> <tr> <td>1490/211</td> <td>METZ, DAVID LEE & TAMMY T</td> <td>06/20/2003</td> <td>100,000</td> <td>YES</td> </tr> </tbody> </table>					Bk/Pg	Grantor	Date	Price	Code	/	RCH HOMES LLC	05/06/2022	166,000	YES	/	ALLISON, DARRELL A &	01/26/2022	113,000	10	2718/663	BLACKWELL, JOYCE F-TRUSTEE	06/19/2018	118,500	YES	2362/152	SEC OF HUD	10/11/2013	0	1	2359/934	WILSON, SHARON J	07/10/2013	0	10	1490/211	METZ, DAVID LEE & TAMMY T	06/20/2003	100,000	YES																																																														
Code	Type	Active	Maximum	Exemption																																																																																																																					
H	Homestead	No	1,000																																																																																																																						
PD	Add-Homestead	No	1,000																																																																																																																						
Bk/Pg	Grantor	Date	Price	Code																																																																																																																					
/	RCH HOMES LLC	05/06/2022	166,000	YES																																																																																																																					
/	ALLISON, DARRELL A &	01/26/2022	113,000	10																																																																																																																					
2718/663	BLACKWELL, JOYCE F-TRUSTEE	06/19/2018	118,500	YES																																																																																																																					
2362/152	SEC OF HUD	10/11/2013	0	1																																																																																																																					
2359/934	WILSON, SHARON J	07/10/2013	0	10																																																																																																																					
1490/211	METZ, DAVID LEE & TAMMY T	06/20/2003	100,000	YES																																																																																																																					
Parcel Valuation <table border="1"> <thead> <tr> <th>Source</th> <th>REAL</th> <th>Fair Cash</th> <th>Capped</th> <th>Asmnt Level</th> <th>Assessed</th> <th>Levy Rate</th> <th>92.430</th> <th>Current Tax</th> </tr> </thead> <tbody> <tr> <td>Remove Cap</td> <td>2023</td> <td>Land Value 33,880</td> <td>33,880</td> <td>11%</td> <td>3,727</td> <td>Assessed</td> <td>20,347</td> <td>1,880.67</td> </tr> <tr> <td>Year Frozen</td> <td>2016</td> <td>Improvements 151,093</td> <td>151,093</td> <td></td> <td>16,620</td> <td>Penalty</td> <td>0</td> <td></td> </tr> <tr> <td>Uncapped Value</td> <td>0</td> <td>Mobile Home 0</td> <td>0</td> <td></td> <td>0</td> <td>Exemption</td> <td>0</td> <td>0.00</td> </tr> <tr> <td>TIF Project ID</td> <td>0</td> <td>Total Value 184,973</td> <td>184,973</td> <td></td> <td>20,347</td> <td>Total Taxable</td> <td>20,347</td> <td>1,881.00</td> </tr> </tbody> </table>										Source	REAL	Fair Cash	Capped	Asmnt Level	Assessed	Levy Rate	92.430	Current Tax	Remove Cap	2023	Land Value 33,880	33,880	11%	3,727	Assessed	20,347	1,880.67	Year Frozen	2016	Improvements 151,093	151,093		16,620	Penalty	0		Uncapped Value	0	Mobile Home 0	0		0	Exemption	0	0.00	TIF Project ID	0	Total Value 184,973	184,973		20,347	Total Taxable	20,347	1,881.00																																																																			
Source	REAL	Fair Cash	Capped	Asmnt Level	Assessed	Levy Rate	92.430	Current Tax																																																																																																																	
Remove Cap	2023	Land Value 33,880	33,880	11%	3,727	Assessed	20,347	1,880.67																																																																																																																	
Year Frozen	2016	Improvements 151,093	151,093		16,620	Penalty	0																																																																																																																		
Uncapped Value	0	Mobile Home 0	0		0	Exemption	0	0.00																																																																																																																	
TIF Project ID	0	Total Value 184,973	184,973		20,347	Total Taxable	20,347	1,881.00																																																																																																																	
Assessment History <table border="1"> <thead> <tr> <th>Tax Year</th> <th>Statement Number</th> <th>Billed Owner</th> <th>Tax Area</th> <th>Total Value</th> <th>Exemptions</th> <th>Taxable Value</th> <th>Billed Tax</th> </tr> </thead> <tbody> <tr><td>2025</td><td>2025-660015145</td><td>MCCLELLAND, ERIN & LISA</td><td>17</td><td>179,457</td><td>0</td><td>19,741</td><td>1,825.00</td></tr> <tr><td>2024</td><td>2024-660015145</td><td>MCCLELLAND, LISA &</td><td>17</td><td>186,752</td><td>0</td><td>19,173</td><td>1,772.00</td></tr> <tr><td>2023</td><td>2023-660015145</td><td>MCCLELLAND, LISA &</td><td>17</td><td>166,000</td><td>0</td><td>18,260</td><td>1,673.00</td></tr> <tr><td>2022</td><td>2022-660015145</td><td>MCCLELLAND, LISA &</td><td>17</td><td>143,620</td><td>0</td><td>15,142</td><td>1,402.00</td></tr> <tr><td>2021</td><td>2021-660015145</td><td>ALLISON, DARRELL A &</td><td>17</td><td>131,104</td><td>0</td><td>14,421</td><td>1,273.00</td></tr> <tr><td>2020</td><td>2020-660015145</td><td>ALLISON, DARRELL A &</td><td>17</td><td>128,633</td><td>0</td><td>14,104</td><td>1,292.00</td></tr> <tr><td>2019</td><td>2019-660015145</td><td>ALLISON, DARRELL A &</td><td>17</td><td>122,114</td><td>0</td><td>13,433</td><td>1,244.00</td></tr> <tr><td>2018</td><td>2018-660015145</td><td>ALLISON, DARRELL A &</td><td>17</td><td>127,032</td><td>2000</td><td>11,468</td><td>1,060.00</td></tr> <tr><td>2017</td><td>2017-660015145</td><td>BLACKWELL, JOYCE F-TRUSTEE</td><td>17</td><td>125,790</td><td>2000</td><td>11,468</td><td>1,053.00</td></tr> <tr><td>2016</td><td>2016-660015145</td><td>BLACKWELL, JOYCE F-TRUSTEE</td><td>17</td><td>122,436</td><td>2000</td><td>11,468</td><td>1,076.00</td></tr> <tr><td>2015</td><td>2015-660015145</td><td>BLACKWELL, JOYCE F-TRUSTEE</td><td>17</td><td>119,891</td><td>1000</td><td>12,188</td><td>1,099.00</td></tr> <tr><td>2014</td><td>2014-660015145</td><td>BLACKWELL, JOYCE F-TRUSTEE</td><td>17</td><td>122,121</td><td>1000</td><td>12,433</td><td>1,153.00</td></tr> <tr><td>2013</td><td>2013-660015145</td><td>WILSON, SHARON J</td><td>17</td><td>114,575</td><td>0</td><td>12,344</td><td>1,130.00</td></tr> </tbody> </table>										Tax Year	Statement Number	Billed Owner	Tax Area	Total Value	Exemptions	Taxable Value	Billed Tax	2025	2025-660015145	MCCLELLAND, ERIN & LISA	17	179,457	0	19,741	1,825.00	2024	2024-660015145	MCCLELLAND, LISA &	17	186,752	0	19,173	1,772.00	2023	2023-660015145	MCCLELLAND, LISA &	17	166,000	0	18,260	1,673.00	2022	2022-660015145	MCCLELLAND, LISA &	17	143,620	0	15,142	1,402.00	2021	2021-660015145	ALLISON, DARRELL A &	17	131,104	0	14,421	1,273.00	2020	2020-660015145	ALLISON, DARRELL A &	17	128,633	0	14,104	1,292.00	2019	2019-660015145	ALLISON, DARRELL A &	17	122,114	0	13,433	1,244.00	2018	2018-660015145	ALLISON, DARRELL A &	17	127,032	2000	11,468	1,060.00	2017	2017-660015145	BLACKWELL, JOYCE F-TRUSTEE	17	125,790	2000	11,468	1,053.00	2016	2016-660015145	BLACKWELL, JOYCE F-TRUSTEE	17	122,436	2000	11,468	1,076.00	2015	2015-660015145	BLACKWELL, JOYCE F-TRUSTEE	17	119,891	1000	12,188	1,099.00	2014	2014-660015145	BLACKWELL, JOYCE F-TRUSTEE	17	122,121	1000	12,433	1,153.00	2013	2013-660015145	WILSON, SHARON J	17	114,575	0	12,344	1,130.00
Tax Year	Statement Number	Billed Owner	Tax Area	Total Value	Exemptions	Taxable Value	Billed Tax																																																																																																																		
2025	2025-660015145	MCCLELLAND, ERIN & LISA	17	179,457	0	19,741	1,825.00																																																																																																																		
2024	2024-660015145	MCCLELLAND, LISA &	17	186,752	0	19,173	1,772.00																																																																																																																		
2023	2023-660015145	MCCLELLAND, LISA &	17	166,000	0	18,260	1,673.00																																																																																																																		
2022	2022-660015145	MCCLELLAND, LISA &	17	143,620	0	15,142	1,402.00																																																																																																																		
2021	2021-660015145	ALLISON, DARRELL A &	17	131,104	0	14,421	1,273.00																																																																																																																		
2020	2020-660015145	ALLISON, DARRELL A &	17	128,633	0	14,104	1,292.00																																																																																																																		
2019	2019-660015145	ALLISON, DARRELL A &	17	122,114	0	13,433	1,244.00																																																																																																																		
2018	2018-660015145	ALLISON, DARRELL A &	17	127,032	2000	11,468	1,060.00																																																																																																																		
2017	2017-660015145	BLACKWELL, JOYCE F-TRUSTEE	17	125,790	2000	11,468	1,053.00																																																																																																																		
2016	2016-660015145	BLACKWELL, JOYCE F-TRUSTEE	17	122,436	2000	11,468	1,076.00																																																																																																																		
2015	2015-660015145	BLACKWELL, JOYCE F-TRUSTEE	17	119,891	1000	12,188	1,099.00																																																																																																																		
2014	2014-660015145	BLACKWELL, JOYCE F-TRUSTEE	17	122,121	1000	12,433	1,153.00																																																																																																																		
2013	2013-660015145	WILSON, SHARON J	17	114,575	0	12,344	1,130.00																																																																																																																		



Rogers

Assessment Property Record Card for Tax Year 2026

Data provided by LISA DELOZIER County Assessor

Date 04/16/2026
 Time 23:24:48
 Page 2

Lot Data	Square-Foot - NBHD 1161 #1	Primary Image
Lot Size		
Lot Count	1	
Units Buildable	1	
Non-Ag Acres	0.1414	
Topography		
Street Access		
Utilities		
Amenities	LAND QUALITY	
	0	
	0	
Method	Square-Foot	
Base Lot Value	6,160.00 x 5.50 = 33,880	
Factor Value		
Adjustments	1.0000	
Lot Value	33,880	

Residential Data	
Type	1 Single Family Residence
Condition	3 - Average
Quality	2.5 - Fair
Architecture	R3 Res Nbhd 3
Style	100% One Story
Exterior Wall	100% Frame, Siding, Wood
Base/Total Area	1,639 / 1,639
Style	100% One Story
HVAC	100% Warmed & Cooled Air
Roof Cover	1 Composition Shingle
Area on Slab	1,639
Fixture/RghIn	11 /
Bed/F/H Bath	3 / 2.0 /
Basement Area	
Garage Type	
Remodel	
Year/Eff Age	2002 / 18



\\tsclient\T\LOGAN\LOGAN RESIDENTIAL VI\2023-8-9\IMG_0059. 8/9/2023

GRM Approach	
GRM Code	
Gross Rent	0.00
Indicated Value	

Multiple Regression			
MRA Code	1	Test	
Adusted R	0.8445		
Indicated Value	154,604	94.33	Per SqFt

Direct Comparables			
Selection Model	A	Adam Test	
Adjustment Model	1	2022 Residential	
Comparables	3		
Indicated Value	173,340		Per SqFt

Value Reconciliation			
Selected Approach	Cost Approach		
Improvements	148,021		
Lot Value	33,880		
Indicated Value	181,901	110.98	Per SqFt
Agland Value			
Site Improvements	3,072		
Total Value	184,973	112.86	Total Value Per SqFt

Cost Approach				Manual : 01/2025			
Base Cost	91.67	Total Misc Impr	+	1,564			
Roofing Adj	+ 4.25	Garage Cost	+				
Subfloor Adj	+ -1.15	Total RCN	=	189,770			
Heat/Cool Adj	+ 11.47	Depreciation (22%)	-	41,749			
Plumbing Adj	+ 8.59	Lump Sums	+	0			
Basement Adj	+ 0.00	RCNLD	=	148,021			
Adj Base Cost	= 114.83	Lot Value	+	33,880			
Total Area	x 1,639	Indicated Value	=	181,901			
Adjusted Cost	= 188,206	Value Per SqFt		110.98			

Miscellaneous Improvements								
Code	Description	Sketch ID	Size	Year	Units	Unit Cost	Depr	Value
PRCH	SLAB PORCH - COVERED	36376	13x5		65	24.06		1,564



Rogers

Assessment Property Record Card for Tax Year 2026

Data provided by LISA DELOZIER County Assessor

Date 04/16/2026
Time 23:24:48
Page 3

Sketch Image

660015145

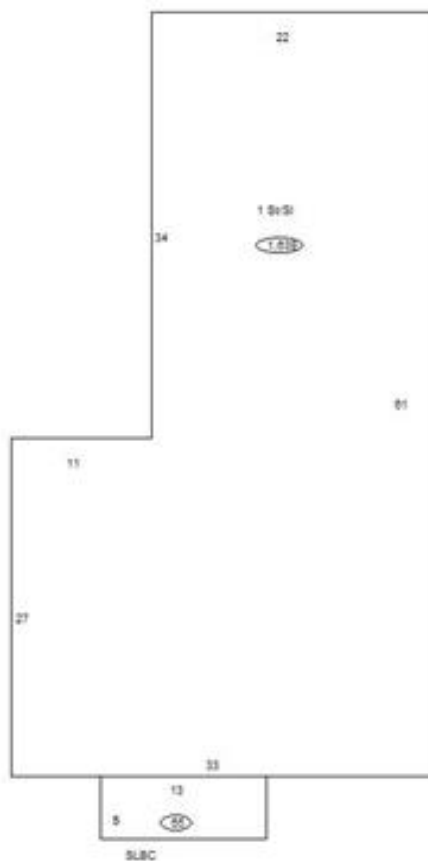

Sketch Vector Information

Sequence	Code	Type	Built Over	Scale	Section Label	Base Area	Multiplier	Total Area
1	R	1	Slab	10	1 St/SI	1,639	1.000	1,639
2	M	PRCH		10	SLBC	65	1.000	65
Total Building Area						1,639		1,639



Rogers



Assessment Property Record Card for Tax Year 2026

Data provided by LISA DELOZIER County Assessor

Date 04/16/2026
Time 23:24:48
Page 4

660015145

Outbuildings/Site Improvements

Building Image	Code	Description	Dimensions	Floor	Roofing	Total Units	
	DTGF	DETACHED GARAGE FAIR	0x0x0			320	
	Qual	2	Cond 3	Year	Eff Age		
	Valuation Summary		Modifier Total		RCN	Depr (40% Phys/ % Func)	RCNLD
	Base Cost (16.00 x 320)		5,120		5,120	2,048	3,072
	CP	CARPORT DIRT	0x0x0				
	Qual		Cond	Year	Eff Age		
	Valuation Summary		Modifier Total		RCN	Depr (100% Phys/ % Func)	RCNLD
	Base Cost (3.50 x)						