



Rogers

Assessment Property Record Card for Tax Year 2026

Data provided by LISA DELOZIER County Assessor

Date 04/16/2026
Time 23:09:48
Page 1

Assessment Data					Primary Image				
Account	660015313								
Parcel ID	000000-00-0-10410-004-0004								
Cadastral ID	16-21-16-06250								
Property Type	REAL - Real Property								
Property Class	URP	VI Area	1						
Tax Area	17 - CLAREMORE OT								
Name ID	321174								
WHITMORE, SHAWN M & ANNA R									
907 W 9TH PL S CLAREMORE OK 74017-0000									
Parcel Location									
Situs	00907 W 9TH PL S								
Subdivision	SPRING MILL SOUTH								
Lot/Block	0004 / 0004	Parcel Size	1 - Lots						
Sec/Twn/Rng	16 / 21 / 16 / 5								
Neighborhood	1161 - R-V01-SW CLAREMORE								
School District	S001 - CLAREMORE SCHOOLS								
Legal Description Lat/Long: 36.29851930 -95.61395826									
Building Permits									
LOT 4 BLOCK 4 SPRINGMILL SOUTH									
Exemptions									
Code	Type	Active	Maximum	Exemption	Bk/Pg	Grantor	Date	Price	Code
H	Homestead	Yes	1,000	1,000	2626/841	HUNT, KATARINA LYNN	04/22/2017	79,000	YES
					2570/303	WILLIAMS, MAYBELLE	08/09/2016	0	4
					1002/496	THOMAS, KYLE W &	09/19/1995	52,115	Yes
					900/292	PATE, JAMES BRETT &	11/25/1992	45,000	Yes
Parcel Valuation									
Source	REAL	Fair Cash	Capped	Asmnt Level	Assessed	Levy Rate	92.430	Current Tax	
Remove Cap	2018	Land Value	52,300	20,606	11%	2,267	Assessed	9,284	858.12
Year Frozen	1998	Improvements	87,418	63,793		7,017	Penalty	0	
Uncapped Value	0	Mobile Home	0	0		0	Exemption	1,000	-92.00
TIF Project ID	0	Total Value	139,718	84,399		9,284	Total Taxable	8,284	766.00
Assessment History									
Tax Year	Statement Number	Billed Owner	Tax Area	Total Value	Exemptions	Taxable Value	Billed Tax		
2025	2025-660015313	WHITMORE, SHAWN M & ANNA R	17	136,626	1000	8,014	741.00		
2024	2024-660015313	WHITMORE, SHAWN M & ANNA R	17	137,892	1000	7,752	716.00		
2023	2023-660015313	WHITMORE, SHAWN M & ANNA R	17	92,682	1000	7,497	687.00		
2022	2022-660015313	WHITMORE, SHAWN M & ANNA R	17	74,989	1000	7,249	671.00		
2021	2021-660015313	WHITMORE, SHAWN M & ANNA R	17	78,930	1000	7,682	678.00		
2020	2020-660015313	WHITMORE, SHAWN M & ANNA R	17	79,790	1000	7,777	712.00		
2019	2019-660015313	WHITMORE, SHAWN M & ANNA R	17	78,261	1000	7,609	705.00		
2018	2018-660015313	WHITMORE, SHAWN M & ANNA R	17	81,820	1000	8,000	739.00		
2017	2017-660015313	WHITMORE, SHAWN M & ANNA R	17	94,685	0	6,025	553.00		
2016	2016-660015313	HUNT, KATARINA LYNN	17	92,348	2000	3,738	351.00		
2015	2015-660015313	WILLIAMS, MAYBELLE	17	67,965	2000	3,738	337.00		
2014	2014-660015313	WILLIAMS, MAYBELLE	17	68,442	2000	3,738	347.00		
2013	2013-660015313	WILLIAMS, MAYBELLE	17	66,182	2000	3,738	342.00		



Rogers

Assessment Property Record Card for Tax Year 2026

Data provided by LISA DELOZIER County Assessor

Date 04/16/2026
Time 23:09:48
Page 2

Lot Data		Square-Foot - NBHD 1161 #1	
Lot Size			
Lot Count	1		
Units Buildable	1		
Non-Ag Acres	0.2183		
Topography			
Street Access			
Utilities			
Amenities	LAND QUALITY	0	
		0	
Method	Square-Foot		
Base Lot Value	9,509.00 x 5.50 = 52,300		
Factor Value			
Adjustments	1.0000		
Lot Value	52,300		



\\tsclient\T\LOGAN\LOGAN RESIDENTIAL VI\2023-8-15\IMG_001 8/15/2023

Residential Data	
Type	1 Single Family Residence
Condition	3 - Average
Quality	2 - Fair
Architecture	
Style	100% One Story
Exterior Wall	100% Veneer, Stone
Base/Total Area	1,062 / 1,062
Style	100% One Story
HVAC	100% Warmed & Cooled Air
Roof Cover	1 Composition Shingle
Area on Slab	1,062
Fixture/RghIn	7 /
Bed/F/H Bath	2 / 1.5 /
Basement Area	
Garage Type	472 Attached Garage - Unfinished
Remodel	
Year/Eff Age	1983 / 32

GRM Approach	
GRM Code	
Gross Rent	0.00
Indicated Value	

Multiple Regression			
MRA Code	1	Test	
Adjusted R	0.8445		
Indicated Value	123,928	116.69	Per SqFt

Direct Comparables			
Selection Model	A	Adam Test	
Adjustment Model	1	2022 Residential	
Comparables	8		
Indicated Value	130,220		Per SqFt

Cost Approach		Manual : 01/2025	
Base Cost	109.45	Total Misc Impr	+ 4,996
Roofing Adj	+ 4.23	Garage Cost	+ 11,158
Subfloor Adj	+ 0.00	Total RCN	= 156,104
Heat/Cool Adj	+ 10.30	Depreciation (44%)	- 68,686
Plumbing Adj	+ 7.80	Lump Sums	+ 0
Basement Adj	+ 0.00	RCNLD	= 87,418
Adj Base Cost	= 131.78	Lot Value	+ 52,300
Total Area	x 1,062	Indicated Value	= 139,718
Adjusted Cost	= 139,950	Value Per SqFt	131.56

Value Reconciliation			
Selected Approach	Cost Approach		
Improvements	87,418		
Lot Value	52,300		
Indicated Value	139,718	131.56	Per SqFt
Agland Value			
Site Improvements			
Total Value	139,718	131.56	Total Value Per SqFt

Miscellaneous Improvements								
Code	Description	Sketch ID	Size	Year	Units	Unit Cost	Depr	Value
PRCH	SLAB PORCH - COVERED	36811	16x12		192	20.69		3,972
PATO	SLAB PORCH - OPEN	36812	10x10		100	10.24		1,024



Rogers

Assessment Property Record Card for Tax Year 2026

Data provided by LISA DELOZIER County Assessor

Date 04/16/2026
 Time 23:09:48
 Page 3

Sketch Image

660015313

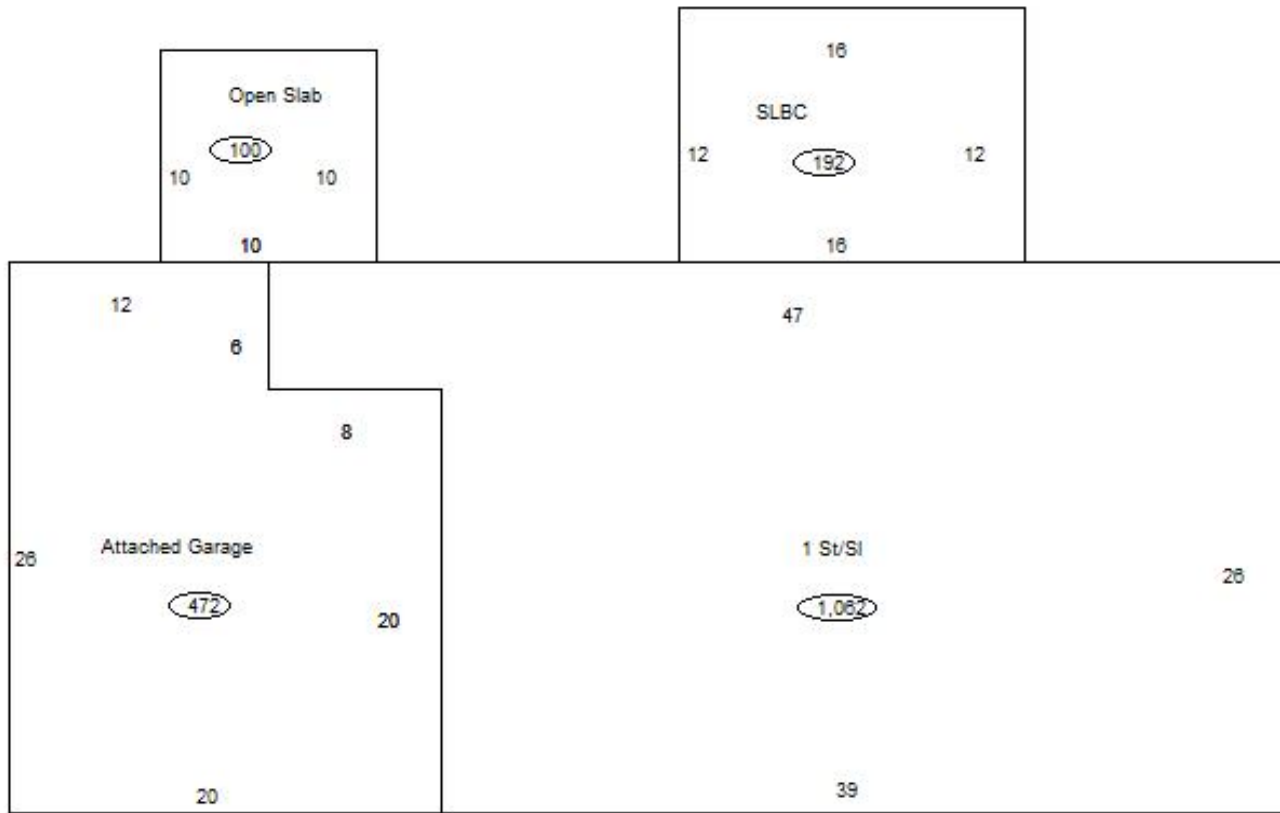

Sketch Vector Information

Sequence	Code	Type	Built Over	Scale	Section Label	Base Area	Multiplier	Total Area
1	R	1	Slab	10	1 St/SI	1,062	1.000	1,062
2	G	1		10	Attached Garage	472	1.000	472
3	M	PRCH		10	SLBC	192	1.000	192
4	M	PATO		10	Open Slab	100	1.000	100
Total Building Area						1,062		1,062