



# Rogers

## Assessment Property Record Card for Tax Year 2026

Data provided by LISA DELOZIER County Assessor

Date 04/18/2026  
Time 06:36:14  
Page 1

Assessment Data					Primary Image																																																																																																																				
<b>Account</b> 660015321 <b>Parcel ID</b> 000000-00-0-10410-004-0012 <b>Cadastral ID</b> 16-21-16-06330 <b>Property Type</b> REAL - Real Property <b>Property Class</b> URP VI Area 1 <b>Tax Area</b> 17 - CLAREMORE OT <b>Name ID</b> 324949 MURRAY PROPERTIES LLC  % MICHAEL & PAMELA MURRAY PO BOX 984 CLAREMORE OK 74018-0000  <b>Parcel Location</b> <b>Situs</b> 00105 E 9TH PL S <b>Subdivision</b> SPRING MILL SOUTH <b>Lot/Block</b> 0012 / 0004 <b>Parcel Size</b> 1 - Lots <b>Sec/Twn/Rng</b> 16 / 21 / 16 / 5 <b>Neighborhood</b> 1161 - R-V01-SW CLAREMORE <b>School District</b> S001 - CLAREMORE SCHOOLS																																																																																																																									
<b>Legal Description</b> Lot/Long: 36.29824594 -95.61198603																																																																																																																									
<b>Building Permits</b>					<table border="1"> <thead> <tr> <th>Number</th> <th>Description</th> <th>Opened</th> <th>Closed</th> <th>Amount</th> </tr> </thead> <tbody> <tr> <td></td> <td></td> <td></td> <td></td> <td></td> </tr> </tbody> </table>					Number	Description	Opened	Closed	Amount																																																																																																											
Number	Description	Opened	Closed	Amount																																																																																																																					
<b>Exemptions</b>					<b>Sale History</b>																																																																																																																				
<table border="1"> <thead> <tr> <th>Code</th> <th>Type</th> <th>Active</th> <th>Maximum</th> <th>Exemption</th> </tr> </thead> <tbody> <tr> <td>H</td> <td>Homestead</td> <td>No</td> <td>1,000</td> <td></td> </tr> </tbody> </table>					Code	Type	Active	Maximum	Exemption	H	Homestead	No	1,000		<table border="1"> <thead> <tr> <th>Bk/Pg</th> <th>Grantor</th> <th>Date</th> <th>Price</th> <th>Code</th> </tr> </thead> <tbody> <tr> <td>/</td> <td>CLARKE, RUBY C</td> <td>02/26/2019</td> <td>63,500</td> <td>19</td> </tr> <tr> <td>2587/239</td> <td>CLARKE, RUBY C</td> <td>10/25/2016</td> <td>0</td> <td>4</td> </tr> <tr> <td>2582/105</td> <td>CLARKE, RUBY C &amp;</td> <td>10/04/2016</td> <td>0</td> <td>4</td> </tr> </tbody> </table>					Bk/Pg	Grantor	Date	Price	Code	/	CLARKE, RUBY C	02/26/2019	63,500	19	2587/239	CLARKE, RUBY C	10/25/2016	0	4	2582/105	CLARKE, RUBY C &	10/04/2016	0	4																																																																																		
Code	Type	Active	Maximum	Exemption																																																																																																																					
H	Homestead	No	1,000																																																																																																																						
Bk/Pg	Grantor	Date	Price	Code																																																																																																																					
/	CLARKE, RUBY C	02/26/2019	63,500	19																																																																																																																					
2587/239	CLARKE, RUBY C	10/25/2016	0	4																																																																																																																					
2582/105	CLARKE, RUBY C &	10/04/2016	0	4																																																																																																																					
<b>Parcel Valuation</b>																																																																																																																									
<table border="1"> <thead> <tr> <th>Source</th> <th>REAL</th> <th>Fair Cash</th> <th>Capped</th> <th>Asmnt Level</th> <th>Assessed</th> <th>Levy Rate</th> <th>92.430</th> <th>Current Tax</th> </tr> </thead> <tbody> <tr> <td>Remove Cap</td> <td>2020</td> <td>Land Value</td> <td>59,917</td> <td>27,462</td> <td>11%</td> <td>3,021</td> <td>Assessed</td> <td>11,636</td> <td>1,075.52</td> </tr> <tr> <td>Year Frozen</td> <td>2005</td> <td>Improvements</td> <td>80,057</td> <td>78,322</td> <td></td> <td>8,615</td> <td>Penalty</td> <td>0</td> <td></td> </tr> <tr> <td>Uncapped Value</td> <td>0</td> <td>Mobile Home</td> <td>0</td> <td>0</td> <td></td> <td>0</td> <td>Exemption</td> <td>0</td> <td>0.00</td> </tr> <tr> <td>TIF Project ID</td> <td>0</td> <td>Total Value</td> <td>139,974</td> <td>105,784</td> <td></td> <td>11,636</td> <td>Total Taxable</td> <td>11,636</td> <td>1,076.00</td> </tr> </tbody> </table>		Source	REAL	Fair Cash	Capped	Asmnt Level	Assessed	Levy Rate	92.430	Current Tax	Remove Cap	2020	Land Value	59,917	27,462	11%	3,021	Assessed	11,636	1,075.52	Year Frozen	2005	Improvements	80,057	78,322		8,615	Penalty	0		Uncapped Value	0	Mobile Home	0	0		0	Exemption	0	0.00	TIF Project ID	0	Total Value	139,974	105,784		11,636	Total Taxable	11,636	1,076.00																																																																							
Source	REAL	Fair Cash	Capped	Asmnt Level	Assessed	Levy Rate	92.430	Current Tax																																																																																																																	
Remove Cap	2020	Land Value	59,917	27,462	11%	3,021	Assessed	11,636	1,075.52																																																																																																																
Year Frozen	2005	Improvements	80,057	78,322		8,615	Penalty	0																																																																																																																	
Uncapped Value	0	Mobile Home	0	0		0	Exemption	0	0.00																																																																																																																
TIF Project ID	0	Total Value	139,974	105,784		11,636	Total Taxable	11,636	1,076.00																																																																																																																
<b>Assessment History</b>																																																																																																																									
<table border="1"> <thead> <tr> <th>Tax Year</th> <th>Statement Number</th> <th>Billed Owner</th> <th>Tax Area</th> <th>Total Value</th> <th>Exemptions</th> <th>Taxable Value</th> <th>Billed Tax</th> </tr> </thead> <tbody> <tr><td>2025</td><td>2025-660015321</td><td>MURRAY PROPERTIES LLC</td><td>17</td><td>137,217</td><td>0</td><td>11,082</td><td>1,024.00</td></tr> <tr><td>2024</td><td>2024-660015321</td><td>MURRAY PROPERTIES LLC</td><td>17</td><td>137,532</td><td>0</td><td>10,555</td><td>975.00</td></tr> <tr><td>2023</td><td>2023-660015321</td><td>MURRAY PROPERTIES LLC</td><td>17</td><td>103,470</td><td>0</td><td>10,052</td><td>921.00</td></tr> <tr><td>2022</td><td>2022-660015321</td><td>MURRAY PROPERTIES LLC</td><td>17</td><td>87,030</td><td>0</td><td>9,573</td><td>886.00</td></tr> <tr><td>2021</td><td>2021-660015321</td><td>MURRAY PROPERTIES LLC</td><td>17</td><td>90,435</td><td>0</td><td>9,948</td><td>878.00</td></tr> <tr><td>2020</td><td>2020-660015321</td><td>MURRAY PROPERTIES LLC</td><td>17</td><td>90,001</td><td>0</td><td>9,900</td><td>907.00</td></tr> <tr><td>2019</td><td>2019-660015321</td><td>MURRAY PROPERTIES LLC</td><td>17</td><td>85,902</td><td>1000</td><td>5,881</td><td>545.00</td></tr> <tr><td>2018</td><td>2018-660015321</td><td>CLARKE, RUBY C</td><td>17</td><td>90,253</td><td>1000</td><td>5,881</td><td>543.00</td></tr> <tr><td>2017</td><td>2017-660015321</td><td>CLARKE, RUBY C</td><td>17</td><td>89,533</td><td>1000</td><td>5,881</td><td>540.00</td></tr> <tr><td>2016</td><td>2016-660015321</td><td>CLARKE, RUBY C &amp;</td><td>17</td><td>87,362</td><td>1000</td><td>5,880</td><td>552.00</td></tr> <tr><td>2015</td><td>2015-660015321</td><td>CLARKE, RUBY C &amp;</td><td>17</td><td>64,361</td><td>1000</td><td>5,880</td><td>530.00</td></tr> <tr><td>2014</td><td>2014-660015321</td><td>CLARKE, RUBY C &amp;</td><td>17</td><td>65,673</td><td>1000</td><td>5,880</td><td>545.00</td></tr> <tr><td>2013</td><td>2013-660015321</td><td>CLARKE, RUBY C &amp;</td><td>17</td><td>63,080</td><td>1000</td><td>5,880</td><td>538.00</td></tr> </tbody> </table>										Tax Year	Statement Number	Billed Owner	Tax Area	Total Value	Exemptions	Taxable Value	Billed Tax	2025	2025-660015321	MURRAY PROPERTIES LLC	17	137,217	0	11,082	1,024.00	2024	2024-660015321	MURRAY PROPERTIES LLC	17	137,532	0	10,555	975.00	2023	2023-660015321	MURRAY PROPERTIES LLC	17	103,470	0	10,052	921.00	2022	2022-660015321	MURRAY PROPERTIES LLC	17	87,030	0	9,573	886.00	2021	2021-660015321	MURRAY PROPERTIES LLC	17	90,435	0	9,948	878.00	2020	2020-660015321	MURRAY PROPERTIES LLC	17	90,001	0	9,900	907.00	2019	2019-660015321	MURRAY PROPERTIES LLC	17	85,902	1000	5,881	545.00	2018	2018-660015321	CLARKE, RUBY C	17	90,253	1000	5,881	543.00	2017	2017-660015321	CLARKE, RUBY C	17	89,533	1000	5,881	540.00	2016	2016-660015321	CLARKE, RUBY C &	17	87,362	1000	5,880	552.00	2015	2015-660015321	CLARKE, RUBY C &	17	64,361	1000	5,880	530.00	2014	2014-660015321	CLARKE, RUBY C &	17	65,673	1000	5,880	545.00	2013	2013-660015321	CLARKE, RUBY C &	17	63,080	1000	5,880	538.00
Tax Year	Statement Number	Billed Owner	Tax Area	Total Value	Exemptions	Taxable Value	Billed Tax																																																																																																																		
2025	2025-660015321	MURRAY PROPERTIES LLC	17	137,217	0	11,082	1,024.00																																																																																																																		
2024	2024-660015321	MURRAY PROPERTIES LLC	17	137,532	0	10,555	975.00																																																																																																																		
2023	2023-660015321	MURRAY PROPERTIES LLC	17	103,470	0	10,052	921.00																																																																																																																		
2022	2022-660015321	MURRAY PROPERTIES LLC	17	87,030	0	9,573	886.00																																																																																																																		
2021	2021-660015321	MURRAY PROPERTIES LLC	17	90,435	0	9,948	878.00																																																																																																																		
2020	2020-660015321	MURRAY PROPERTIES LLC	17	90,001	0	9,900	907.00																																																																																																																		
2019	2019-660015321	MURRAY PROPERTIES LLC	17	85,902	1000	5,881	545.00																																																																																																																		
2018	2018-660015321	CLARKE, RUBY C	17	90,253	1000	5,881	543.00																																																																																																																		
2017	2017-660015321	CLARKE, RUBY C	17	89,533	1000	5,881	540.00																																																																																																																		
2016	2016-660015321	CLARKE, RUBY C &	17	87,362	1000	5,880	552.00																																																																																																																		
2015	2015-660015321	CLARKE, RUBY C &	17	64,361	1000	5,880	530.00																																																																																																																		
2014	2014-660015321	CLARKE, RUBY C &	17	65,673	1000	5,880	545.00																																																																																																																		
2013	2013-660015321	CLARKE, RUBY C &	17	63,080	1000	5,880	538.00																																																																																																																		



# Rogers

## Assessment Property Record Card for Tax Year 2026

Data provided by LISA DELOZIER County Assessor

Date 04/18/2026  
 Time 06:36:15  
 Page 2

Lot Data		Square-Foot - NBHD 1161 #1	
Lot Size			
Lot Count	1		
Units Buildable	1		
Non-Ag Acres	0.2501		
Topography			
Street Access			
Utilities			
Amenities	LAND QUALITY	0	0
Method	Square-Foot		
Base Lot Value	10,894.00 x 5.50 = 59,917		
Factor Value			
Adjustments	1.0000		
Lot Value	59,917		



\\tsclient\T\LOGAN\LOGAN RESIDENTIAL VI\2023-8-15\IMG\_001 8/15/2023

Residential Data	
Type	1 Single Family Residence
Condition	3 - Average
Quality	2 - Fair
Architecture	R3 Res Nbhd 3
Style	100% One Story
Exterior Wall	100% Veneer, Masonry
Base/Total Area	1,036 / 1,036
Style	100% One Story
HVAC	100% Warmed & Cooled Air
Roof Cover	1 Composition Shingle
Area on Slab	1,036
Fixture/RghIn	7 /
Bed/F/H Bath	2 / 1.5 /
Basement Area	
Garage Type	472 Attached Garage - Unfinished
Remodel	
Year/Eff Age	1982 / 33

GRM Approach	
GRM Code	
Gross Rent	0.00
Indicated Value	

Multiple Regression			
MRA Code	1	Test	
Adusted R	0.8445		
Indicated Value	121,676	117.45	Per SqFt

Direct Comparables			
Selection Model	A	Adam Test	
Adjustment Model	1	2022 Residential	
Comparables	8		
Indicated Value	137,730		Per SqFt

Cost Approach				Manual : 01/2025			
Base Cost	103.98	Total Misc Impr	+	3,306			
Roofing Adj	+ 4.26	Garage Cost	+	11,158			
Subfloor Adj	+ 0.00	Total RCN	=	145,559			
Heat/Cool Adj	+ 10.30	Depreciation ( 45%)	-	65,502			
Plumbing Adj	+ 8.00	Lump Sums	+	0			
Basement Adj	+ 0.00	RCNLD	=	80,057			
Adj Base Cost	= 126.54	Lot Value	+	59,917			
Total Area	x 1,036	Indicated Value	=	139,974			
Adjusted Cost	= 131,095	Value Per SqFt		135.11			

Value Reconciliation			
Selected Approach	Cost Approach		
Improvements	80,057		
Lot Value	59,917		
Indicated Value	139,974	135.11	Per SqFt
Agland Value			
Site Improvements			
Total Value	139,974	135.11	Total Value Per SqFt

Miscellaneous Improvements								
Code	Description	Sketch ID	Size	Year	Units	Unit Cost	Depr	Value
PRCH	SLAB PORCH - COVERED	36841	20x5		100	20.98		2,098
PATO	SLAB PORCH - OPEN	36842	12x10		120	10.07		1,208



**Rogers**  
**Assessment Property Record Card for Tax Year 2026**

Data provided by LISA DELOZIER County Assessor

Date 04/18/2026  
 Time 06:36:15  
 Page 3

Sketch Image

660015321

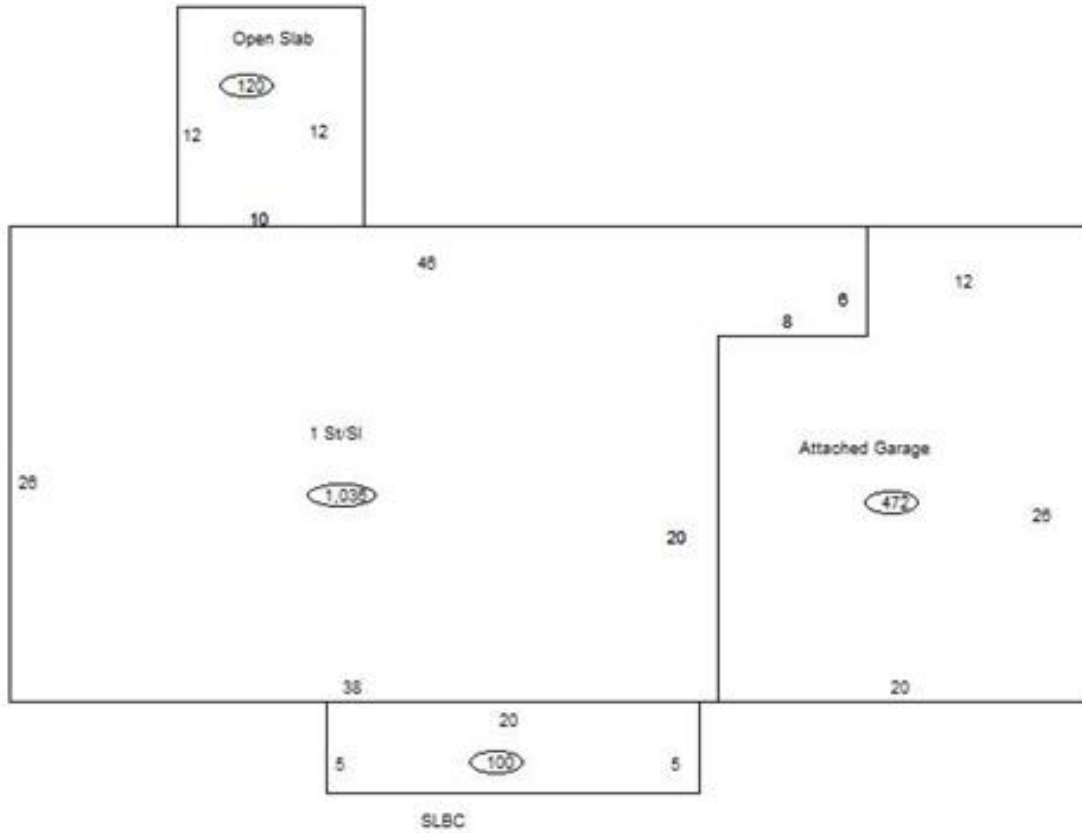

**Sketch Vector Information**

Sequence	Code	Type	Built Over	Scale	Section Label	Base Area	Multiplier	Total Area
1	R	1	Slab	10	1 St/SI	1,036	1.000	1,036
2	G	1		10	Attached Garage	472	1.000	472
3	M	PRCH		10	SLBC	100	1.000	100
4	M	PATO		10	Open Slab	120	1.000	120
<b>Total Building Area</b>						1,036		1,036



# Rogers

## Assessment Property Record Card for Tax Year 2026

Data provided by LISA DELOZIER County Assessor

Date 04/18/2026  
Time 06:36:15  
Page 4

660015321

### Outbuildings/Site Improvements

Building Image	Code	Description	Dimensions	Floor	Roofing	Total Units
	STF	STG FAIR	0x0x0			
	Qual	2	Cond	Year	Eff Age	
<b>Valuation Summary</b>			<b>Modifier Total</b>	<b>RCN</b>	<b>Depr (100% Phys/ % Func)</b>	<b>RCNLD</b>
Base Cost (4.68 x )						