



Rogers

Assessment Property Record Card for Tax Year 2026

Data provided by LISA DELOZIER County Assessor

Date 04/16/2026
Time 21:21:42
Page 1

Assessment Data					Primary Image																																																																																																																				
Account 660015454 Parcel ID 000000-00-0-10195-001-0011 Cadastral ID 16-21-16-07670 Property Type REAL - Real Property Property Class URP VI Area 1 Tax Area 17 - CLAREMORE OT Name ID 254059 LAWSON, PATRICIA L 726 S MARYLAND CLAREMORE OK 74017-0000 Parcel Location Situs 00726 S MARYLAND AVE Subdivision HOMEBUILDERS Lot/Block 0011 / 0001 Parcel Size .5 - Lots Sec/Twn/Rng 16 / 21 / 16 / 5 Neighborhood 1161 - R-V01-SW CLAREMORE School District S001 - CLAREMORE SCHOOLS					<p>\\tsclient\T\LOGAN\LOGAN RESIDENTIAL VI\2023-8-18\IMG_004I 8/18/2023</p>																																																																																																																				
Legal Description Lat/Long: 36.30249458 -95.61347299 S 65' TRACT 11 BEING A PT W 500.9 SW NW NW & W 500.91' NW SW NW HOMEBUILDERS																																																																																																																									
Exemptions					Building Permits																																																																																																																				
<table border="1"> <thead> <tr> <th>Code</th> <th>Type</th> <th>Active</th> <th>Maximum</th> <th>Exemption</th> </tr> </thead> <tbody> <tr> <td></td> <td></td> <td></td> <td></td> <td></td> </tr> </tbody> </table>					Code	Type	Active	Maximum	Exemption						<table border="1"> <thead> <tr> <th>Number</th> <th>Description</th> <th>Opened</th> <th>Closed</th> <th>Amount</th> </tr> </thead> <tbody> <tr> <td></td> <td></td> <td></td> <td></td> <td></td> </tr> </tbody> </table>					Number	Description	Opened	Closed	Amount																																																																																																	
Code	Type	Active	Maximum	Exemption																																																																																																																					
Number	Description	Opened	Closed	Amount																																																																																																																					
<table border="1"> <thead> <tr> <th>Code</th> <th>Type</th> <th>Active</th> <th>Maximum</th> <th>Exemption</th> </tr> </thead> <tbody> <tr> <td></td> <td></td> <td></td> <td></td> <td></td> </tr> </tbody> </table>					Code	Type	Active	Maximum	Exemption						Sale History <table border="1"> <thead> <tr> <th>Bk/Pg</th> <th>Grantor</th> <th>Date</th> <th>Price</th> <th>Code</th> </tr> </thead> <tbody> <tr> <td>2578/569</td> <td>HOUSING AUTHORITY OF</td> <td>09/13/2016</td> <td>0</td> <td>9</td> </tr> <tr> <td>850/256</td> <td></td> <td></td> <td>6,000</td> <td>No</td> </tr> </tbody> </table>					Bk/Pg	Grantor	Date	Price	Code	2578/569	HOUSING AUTHORITY OF	09/13/2016	0	9	850/256			6,000	No																																																																																							
Code	Type	Active	Maximum	Exemption																																																																																																																					
Bk/Pg	Grantor	Date	Price	Code																																																																																																																					
2578/569	HOUSING AUTHORITY OF	09/13/2016	0	9																																																																																																																					
850/256			6,000	No																																																																																																																					
Parcel Valuation <table border="1"> <thead> <tr> <th>Source</th> <th>REAL</th> <th>Fair Cash</th> <th>Capped</th> <th>Asmnt Level</th> <th>Assessed</th> <th>Levy Rate</th> <th>92.430</th> <th>Current Tax</th> </tr> </thead> <tbody> <tr> <td>Remove Cap</td> <td>2017</td> <td>Land Value 67,900</td> <td>29,390</td> <td>11%</td> <td>3,233</td> <td>Assessed</td> <td>12,799</td> <td>1,183.01</td> </tr> <tr> <td>Year Frozen</td> <td>0</td> <td>Improvements 87,074</td> <td>86,962</td> <td></td> <td>9,566</td> <td>Penalty</td> <td>0</td> <td></td> </tr> <tr> <td>Uncapped Value</td> <td>0</td> <td>Mobile Home 0</td> <td>0</td> <td></td> <td>0</td> <td>Exemption</td> <td>0</td> <td>0.00</td> </tr> <tr> <td>TIF Project ID</td> <td>0</td> <td>Total Value 154,974</td> <td>116,352</td> <td></td> <td>12,799</td> <td>Total Taxable</td> <td>12,799</td> <td>1,183.00</td> </tr> </tbody> </table>										Source	REAL	Fair Cash	Capped	Asmnt Level	Assessed	Levy Rate	92.430	Current Tax	Remove Cap	2017	Land Value 67,900	29,390	11%	3,233	Assessed	12,799	1,183.01	Year Frozen	0	Improvements 87,074	86,962		9,566	Penalty	0		Uncapped Value	0	Mobile Home 0	0		0	Exemption	0	0.00	TIF Project ID	0	Total Value 154,974	116,352		12,799	Total Taxable	12,799	1,183.00																																																																			
Source	REAL	Fair Cash	Capped	Asmnt Level	Assessed	Levy Rate	92.430	Current Tax																																																																																																																	
Remove Cap	2017	Land Value 67,900	29,390	11%	3,233	Assessed	12,799	1,183.01																																																																																																																	
Year Frozen	0	Improvements 87,074	86,962		9,566	Penalty	0																																																																																																																		
Uncapped Value	0	Mobile Home 0	0		0	Exemption	0	0.00																																																																																																																	
TIF Project ID	0	Total Value 154,974	116,352		12,799	Total Taxable	12,799	1,183.00																																																																																																																	
Assessment History <table border="1"> <thead> <tr> <th>Tax Year</th> <th>Statement Number</th> <th>Billed Owner</th> <th>Tax Area</th> <th>Total Value</th> <th>Exemptions</th> <th>Taxable Value</th> <th>Billed Tax</th> </tr> </thead> <tbody> <tr><td>2025</td><td>2025-660015454</td><td>LAWSON, PATRICIA L</td><td>17</td><td>155,354</td><td>0</td><td>12,189</td><td>1,127.00</td></tr> <tr><td>2024</td><td>2024-660015454</td><td>LAWSON, PATRICIA L</td><td>17</td><td>158,176</td><td>0</td><td>11,609</td><td>1,073.00</td></tr> <tr><td>2023</td><td>2023-660015454</td><td>LAWSON, PATRICIA L</td><td>17</td><td>111,150</td><td>0</td><td>11,056</td><td>1,013.00</td></tr> <tr><td>2022</td><td>2022-660015454</td><td>LAWSON, PATRICIA L</td><td>17</td><td>95,725</td><td>0</td><td>10,530</td><td>975.00</td></tr> <tr><td>2021</td><td>2021-660015454</td><td>LAWSON, PATRICIA L</td><td>17</td><td>95,443</td><td>0</td><td>10,499</td><td>927.00</td></tr> <tr><td>2020</td><td>2020-660015454</td><td>LAWSON, PATRICIA L</td><td>17</td><td>93,946</td><td>0</td><td>10,334</td><td>946.00</td></tr> <tr><td>2019</td><td>2019-660015454</td><td>LAWSON, PATRICIA L</td><td>17</td><td>90,215</td><td>0</td><td>9,924</td><td>919.00</td></tr> <tr><td>2018</td><td>2018-660015454</td><td>LAWSON, PATRICIA L</td><td>17</td><td>93,599</td><td>0</td><td>10,296</td><td>951.00</td></tr> <tr><td>2017</td><td>2017-660015454</td><td>LAWSON, PATRICIA L</td><td>17</td><td>92,864</td><td>0</td><td>10,215</td><td>938.00</td></tr> <tr><td>2016</td><td>2016-660015454</td><td>LAWSON, PATRICIA L</td><td>17</td><td>88,557</td><td>0</td><td></td><td>.00</td></tr> <tr><td>2015</td><td>2015-660015454</td><td>HOUSING AUTHORITY OF</td><td>17</td><td>88,557</td><td>0</td><td></td><td>.00</td></tr> <tr><td>2014</td><td>2014-660015454</td><td>HOUSING AUTHORITY OF</td><td>17</td><td>88,557</td><td>0</td><td></td><td>.00</td></tr> <tr><td>2013</td><td>2013-660015454</td><td>HOUSING AUTHORITY OF</td><td>17</td><td>83,531</td><td>0</td><td></td><td>.00</td></tr> </tbody> </table>										Tax Year	Statement Number	Billed Owner	Tax Area	Total Value	Exemptions	Taxable Value	Billed Tax	2025	2025-660015454	LAWSON, PATRICIA L	17	155,354	0	12,189	1,127.00	2024	2024-660015454	LAWSON, PATRICIA L	17	158,176	0	11,609	1,073.00	2023	2023-660015454	LAWSON, PATRICIA L	17	111,150	0	11,056	1,013.00	2022	2022-660015454	LAWSON, PATRICIA L	17	95,725	0	10,530	975.00	2021	2021-660015454	LAWSON, PATRICIA L	17	95,443	0	10,499	927.00	2020	2020-660015454	LAWSON, PATRICIA L	17	93,946	0	10,334	946.00	2019	2019-660015454	LAWSON, PATRICIA L	17	90,215	0	9,924	919.00	2018	2018-660015454	LAWSON, PATRICIA L	17	93,599	0	10,296	951.00	2017	2017-660015454	LAWSON, PATRICIA L	17	92,864	0	10,215	938.00	2016	2016-660015454	LAWSON, PATRICIA L	17	88,557	0		.00	2015	2015-660015454	HOUSING AUTHORITY OF	17	88,557	0		.00	2014	2014-660015454	HOUSING AUTHORITY OF	17	88,557	0		.00	2013	2013-660015454	HOUSING AUTHORITY OF	17	83,531	0		.00
Tax Year	Statement Number	Billed Owner	Tax Area	Total Value	Exemptions	Taxable Value	Billed Tax																																																																																																																		
2025	2025-660015454	LAWSON, PATRICIA L	17	155,354	0	12,189	1,127.00																																																																																																																		
2024	2024-660015454	LAWSON, PATRICIA L	17	158,176	0	11,609	1,073.00																																																																																																																		
2023	2023-660015454	LAWSON, PATRICIA L	17	111,150	0	11,056	1,013.00																																																																																																																		
2022	2022-660015454	LAWSON, PATRICIA L	17	95,725	0	10,530	975.00																																																																																																																		
2021	2021-660015454	LAWSON, PATRICIA L	17	95,443	0	10,499	927.00																																																																																																																		
2020	2020-660015454	LAWSON, PATRICIA L	17	93,946	0	10,334	946.00																																																																																																																		
2019	2019-660015454	LAWSON, PATRICIA L	17	90,215	0	9,924	919.00																																																																																																																		
2018	2018-660015454	LAWSON, PATRICIA L	17	93,599	0	10,296	951.00																																																																																																																		
2017	2017-660015454	LAWSON, PATRICIA L	17	92,864	0	10,215	938.00																																																																																																																		
2016	2016-660015454	LAWSON, PATRICIA L	17	88,557	0		.00																																																																																																																		
2015	2015-660015454	HOUSING AUTHORITY OF	17	88,557	0		.00																																																																																																																		
2014	2014-660015454	HOUSING AUTHORITY OF	17	88,557	0		.00																																																																																																																		
2013	2013-660015454	HOUSING AUTHORITY OF	17	83,531	0		.00																																																																																																																		



Rogers

Assessment Property Record Card for Tax Year 2026

Data provided by LISA DELOZIER County Assessor

Date 04/16/2026
Time 21:21:42
Page 2

Lot Data	Square-Foot - NBHD 1161 #1	Primary Image
Lot Size Lot Count 1 Units Buildable 7981 Non-Ag Acres 0.2929 Topography Street Access Utilities Amenities LAND QUALITY 0 0 Method Square-Foot Base Lot Value 12,760.00 x 5.32 = 67,900 Factor Value Adjustments 1.0000 Lot Value 67,900		<p>\\tsclient\T\LOGAN\LOGAN RESIDENTIAL VI\2023-8-18\IMG_004I 8/18/2023</p>

Residential Data	
Type	1 Single Family Residence
Condition	3 - Average
Quality	2 - Fair
Architecture	R3 Res Nbhd 3
Style	100% One Story
Exterior Wall	100% Veneer, Masonry
Base/Total Area	1,108 / 1,108
Style	100% One Story
HVAC	100% Forced Air Furnace
Roof Cover	1 Composition Shingle
Area on Slab	1,108
Fixture/RghIn	4 /
Bed/F/H Bath	3 / 1.0 /
Basement Area	
Garage Type	345 Attached Garage - Unfinished
Remodel	
Year/Eff Age	1993 / 25

Cost Approach		Manual : 01/2025	
Base Cost	102.12	Total Misc Impr	+ 967
Roofing Adj	+ 4.17	Garage Cost	+ 8,929
Subfloor Adj	+ 0.00	Total RCN	= 138,213
Heat/Cool Adj	+ 5.00	Depreciation (37%)	- 51,139
Plumbing Adj	+ 4.52	Lump Sums	+ 0
Basement Adj	+ 0.00	RCNLD	= 87,074
Adj Base Cost	= 115.81	Lot Value	+ 67,900
Total Area	x 1,108	Indicated Value	= 154,974
Adjusted Cost	= 128,317	Value Per SqFt	139.87

GRM Approach	
GRM Code	
Gross Rent	0.00
Indicated Value	

Multiple Regression			
MRA Code	1 Test		
Adusted R	0.8445		
Indicated Value	125,305	113.09	Per SqFt

Direct Comparables			
Selection Model	A Adam Test		
Adjustment Model	1 2022 Residential		
Comparables	8		
Indicated Value	137,480		Per SqFt

Value Reconciliation			
Selected Approach	Cost Approach		
Improvements	87,074		
Lot Value	67,900		
Indicated Value	154,974	139.87	Per SqFt
Agland Value			
Site Improvements			
Total Value	154,974	139.87	Total Value Per SqFt

Miscellaneous Improvements								
Code	Description	Sketch ID	Size	Year	Units	Unit Cost	Depr	Value
PRCH	SLAB PORCH - COVERED	37202	9x4		36	21.18		762
PATO	SLAB PORCH - OPEN	142562	5x4		20	10.24		205



Rogers

Assessment Property Record Card for Tax Year 2026

Data provided by LISA DELOZIER County Assessor

Date 04/16/2026
 Time 21:21:42
 Page 3

Sketch Image

660015454

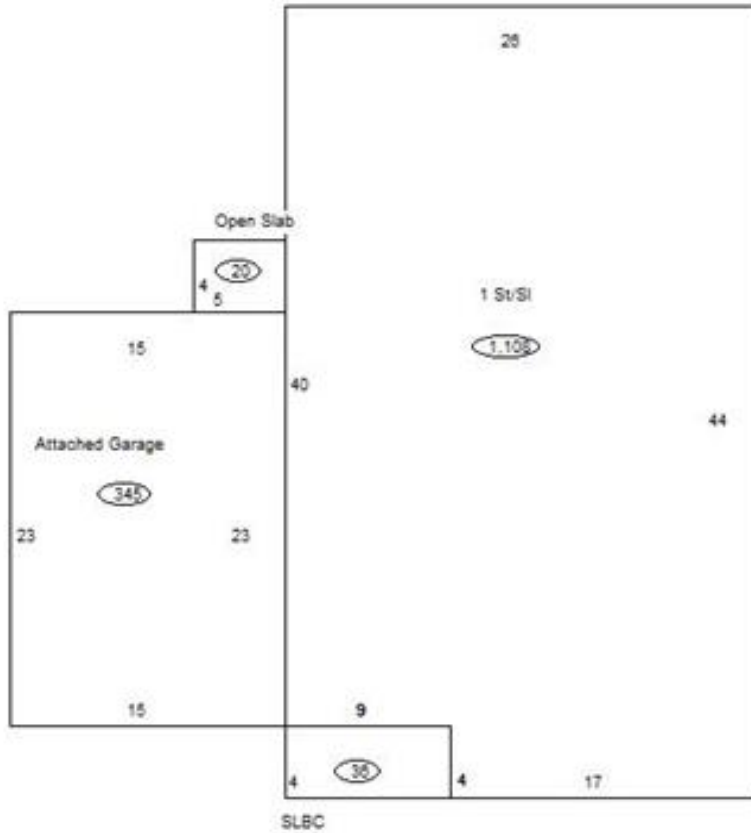

Sketch Vector Information

Sequence	Code	Type	Built Over	Scale	Section Label	Base Area	Multiplier	Total Area
1	R	1	Slab	10	1 St/SI	1,108	1.000	1,108
2	G	1		10	Attached Garage	345	1.000	345
3	M	PRCH		10	SLBC	36	1.000	36
4	M	PATO		10	Open Slab	20	1.000	20
Total Building Area						1,108		1,108