



Rogers

Assessment Property Record Card for Tax Year 2026

Data provided by LISA DELOZIER County Assessor

Date 04/16/2026
Time 21:11:49
Page 1

Assessment Data					Primary Image																																																																																																																				
Account 660015460 Parcel ID 000000-00-0-10195-001-0014 Cadastral ID 16-21-16-07730 Property Type REAL - Real Property Property Class URP VI Area 1 Tax Area 17 - CLAREMORE OT Name ID 331388 PEREZ, JUAN A LEON 23064 BESSIE BLVD CLAREMORE OK 74019-0000 Parcel Location Situs 00700 S MARYLAND AVE Subdivision HOMEBUILDERS Lot/Block 0014 / 0001 Parcel Size .2 - Lots Sec/Twn/Rng 16 / 21 / 16 / 5 Neighborhood 1161 - R-V01-SW CLAREMORE School District S001 - CLAREMORE SCHOOLS																																																																																																																									
Legal Description Lat/Long: 36.30379851 -95.61357640 N 50' S 100' W 110' TRACT 14 HOMEBUILDERS										Building Permits <table border="1"> <thead> <tr> <th>Number</th> <th>Description</th> <th>Opened</th> <th>Closed</th> <th>Amount</th> </tr> </thead> <tbody> <tr> <td colspan="5"> </td> </tr> </tbody> </table>					Number	Description	Opened	Closed	Amount																																																																																																						
Number	Description	Opened	Closed	Amount																																																																																																																					
Exemptions <table border="1"> <thead> <tr> <th>Code</th> <th>Type</th> <th>Active</th> <th>Maximum</th> <th>Exemption</th> </tr> </thead> <tbody> <tr> <td colspan="5"> </td> </tr> </tbody> </table>					Code	Type	Active	Maximum	Exemption						Sale History <table border="1"> <thead> <tr> <th>Bk/Pg</th> <th>Grantor</th> <th>Date</th> <th>Price</th> <th>Code</th> </tr> </thead> <tbody> <tr> <td>/</td> <td>SEPTEMBER SIX LLC</td> <td>05/24/2022</td> <td>43,000</td> <td>YES</td> </tr> <tr> <td>/</td> <td>CONKINS, JUDITH SUE</td> <td>04/12/2022</td> <td>25,000</td> <td>YES</td> </tr> <tr> <td>2162/888</td> <td>HOLLAND, WILLIAM V (MRS)</td> <td>03/19/2011</td> <td>0</td> <td>16</td> </tr> </tbody> </table>					Bk/Pg	Grantor	Date	Price	Code	/	SEPTEMBER SIX LLC	05/24/2022	43,000	YES	/	CONKINS, JUDITH SUE	04/12/2022	25,000	YES	2162/888	HOLLAND, WILLIAM V (MRS)	03/19/2011	0	16																																																																																		
Code	Type	Active	Maximum	Exemption																																																																																																																					
Bk/Pg	Grantor	Date	Price	Code																																																																																																																					
/	SEPTEMBER SIX LLC	05/24/2022	43,000	YES																																																																																																																					
/	CONKINS, JUDITH SUE	04/12/2022	25,000	YES																																																																																																																					
2162/888	HOLLAND, WILLIAM V (MRS)	03/19/2011	0	16																																																																																																																					
Parcel Valuation <table border="1"> <thead> <tr> <th>Source</th> <th>REAL</th> <th>Fair Cash</th> <th>Capped</th> <th>Asmnt Level</th> <th>Assessed</th> <th>Levy Rate</th> <th>92.430</th> <th>Current Tax</th> </tr> </thead> <tbody> <tr> <td>Remove Cap</td> <td>2023</td> <td>Land Value 30,795</td> <td>12,032</td> <td>11%</td> <td>1,324</td> <td>Assessed</td> <td>5,476</td> <td>506.15</td> </tr> <tr> <td>Year Frozen</td> <td>0</td> <td>Improvements 38,902</td> <td>37,745</td> <td></td> <td>4,152</td> <td>Penalty</td> <td>0</td> <td></td> </tr> <tr> <td>Uncapped Value</td> <td>0</td> <td>Mobile Home 0</td> <td>0</td> <td></td> <td>0</td> <td>Exemption</td> <td>0</td> <td>0.00</td> </tr> <tr> <td>TIF Project ID</td> <td>0</td> <td>Total Value 69,697</td> <td>49,777</td> <td></td> <td>5,476</td> <td>Total Taxable</td> <td>5,476</td> <td>506.00</td> </tr> </tbody> </table>										Source	REAL	Fair Cash	Capped	Asmnt Level	Assessed	Levy Rate	92.430	Current Tax	Remove Cap	2023	Land Value 30,795	12,032	11%	1,324	Assessed	5,476	506.15	Year Frozen	0	Improvements 38,902	37,745		4,152	Penalty	0		Uncapped Value	0	Mobile Home 0	0		0	Exemption	0	0.00	TIF Project ID	0	Total Value 69,697	49,777		5,476	Total Taxable	5,476	506.00																																																																			
Source	REAL	Fair Cash	Capped	Asmnt Level	Assessed	Levy Rate	92.430	Current Tax																																																																																																																	
Remove Cap	2023	Land Value 30,795	12,032	11%	1,324	Assessed	5,476	506.15																																																																																																																	
Year Frozen	0	Improvements 38,902	37,745		4,152	Penalty	0																																																																																																																		
Uncapped Value	0	Mobile Home 0	0		0	Exemption	0	0.00																																																																																																																	
TIF Project ID	0	Total Value 69,697	49,777		5,476	Total Taxable	5,476	506.00																																																																																																																	
Assessment History <table border="1"> <thead> <tr> <th>Tax Year</th> <th>Statement Number</th> <th>Billed Owner</th> <th>Tax Area</th> <th>Total Value</th> <th>Exemptions</th> <th>Taxable Value</th> <th>Billed Tax</th> </tr> </thead> <tbody> <tr><td>2025</td><td>2025-660015460</td><td>PEREZ, JUAN A LEON</td><td>17</td><td>68,593</td><td>0</td><td>5,214</td><td>482.00</td></tr> <tr><td>2024</td><td>2024-660015460</td><td>PEREZ, JUAN A LEON</td><td>17</td><td>68,647</td><td>0</td><td>4,966</td><td>459.00</td></tr> <tr><td>2023</td><td>2023-660015460</td><td>PEREZ, JUAN A LEON</td><td>17</td><td>43,000</td><td>0</td><td>4,731</td><td>433.00</td></tr> <tr><td>2022</td><td>2022-660015460</td><td>PEREZ, JUAN A LEON</td><td>17</td><td>32,076</td><td>0</td><td>3,143</td><td>291.00</td></tr> <tr><td>2021</td><td>2021-660015460</td><td>CONKINS, JUDITH SUE</td><td>17</td><td>27,215</td><td>0</td><td>2,994</td><td>264.00</td></tr> <tr><td>2020</td><td>2020-660015460</td><td>CONKINS, JUDITH SUE</td><td>17</td><td>26,930</td><td>0</td><td>2,962</td><td>271.00</td></tr> <tr><td>2019</td><td>2019-660015460</td><td>CONKINS, JUDITH SUE</td><td>17</td><td>26,739</td><td>0</td><td>2,941</td><td>272.00</td></tr> <tr><td>2018</td><td>2018-660015460</td><td>CONKINS, JUDITH SUE</td><td>17</td><td>28,915</td><td>0</td><td>3,181</td><td>294.00</td></tr> <tr><td>2017</td><td>2017-660015460</td><td>CONKINS, JUDITH SUE</td><td>17</td><td>28,753</td><td>0</td><td>3,163</td><td>290.00</td></tr> <tr><td>2016</td><td>2016-660015460</td><td>CONKINS, JUDITH SUE</td><td>17</td><td>28,217</td><td>0</td><td>3,104</td><td>291.00</td></tr> <tr><td>2015</td><td>2015-660015460</td><td>CONKINS, JUDITH SUE</td><td>17</td><td>30,492</td><td>0</td><td>3,354</td><td>302.00</td></tr> <tr><td>2014</td><td>2014-660015460</td><td>CONKINS, JUDITH SUE</td><td>17</td><td>30,670</td><td>0</td><td>3,272</td><td>303.00</td></tr> <tr><td>2013</td><td>2013-660015460</td><td>CONKINS, JUDITH SUE</td><td>17</td><td>32,271</td><td>0</td><td>3,117</td><td>285.00</td></tr> </tbody> </table>										Tax Year	Statement Number	Billed Owner	Tax Area	Total Value	Exemptions	Taxable Value	Billed Tax	2025	2025-660015460	PEREZ, JUAN A LEON	17	68,593	0	5,214	482.00	2024	2024-660015460	PEREZ, JUAN A LEON	17	68,647	0	4,966	459.00	2023	2023-660015460	PEREZ, JUAN A LEON	17	43,000	0	4,731	433.00	2022	2022-660015460	PEREZ, JUAN A LEON	17	32,076	0	3,143	291.00	2021	2021-660015460	CONKINS, JUDITH SUE	17	27,215	0	2,994	264.00	2020	2020-660015460	CONKINS, JUDITH SUE	17	26,930	0	2,962	271.00	2019	2019-660015460	CONKINS, JUDITH SUE	17	26,739	0	2,941	272.00	2018	2018-660015460	CONKINS, JUDITH SUE	17	28,915	0	3,181	294.00	2017	2017-660015460	CONKINS, JUDITH SUE	17	28,753	0	3,163	290.00	2016	2016-660015460	CONKINS, JUDITH SUE	17	28,217	0	3,104	291.00	2015	2015-660015460	CONKINS, JUDITH SUE	17	30,492	0	3,354	302.00	2014	2014-660015460	CONKINS, JUDITH SUE	17	30,670	0	3,272	303.00	2013	2013-660015460	CONKINS, JUDITH SUE	17	32,271	0	3,117	285.00
Tax Year	Statement Number	Billed Owner	Tax Area	Total Value	Exemptions	Taxable Value	Billed Tax																																																																																																																		
2025	2025-660015460	PEREZ, JUAN A LEON	17	68,593	0	5,214	482.00																																																																																																																		
2024	2024-660015460	PEREZ, JUAN A LEON	17	68,647	0	4,966	459.00																																																																																																																		
2023	2023-660015460	PEREZ, JUAN A LEON	17	43,000	0	4,731	433.00																																																																																																																		
2022	2022-660015460	PEREZ, JUAN A LEON	17	32,076	0	3,143	291.00																																																																																																																		
2021	2021-660015460	CONKINS, JUDITH SUE	17	27,215	0	2,994	264.00																																																																																																																		
2020	2020-660015460	CONKINS, JUDITH SUE	17	26,930	0	2,962	271.00																																																																																																																		
2019	2019-660015460	CONKINS, JUDITH SUE	17	26,739	0	2,941	272.00																																																																																																																		
2018	2018-660015460	CONKINS, JUDITH SUE	17	28,915	0	3,181	294.00																																																																																																																		
2017	2017-660015460	CONKINS, JUDITH SUE	17	28,753	0	3,163	290.00																																																																																																																		
2016	2016-660015460	CONKINS, JUDITH SUE	17	28,217	0	3,104	291.00																																																																																																																		
2015	2015-660015460	CONKINS, JUDITH SUE	17	30,492	0	3,354	302.00																																																																																																																		
2014	2014-660015460	CONKINS, JUDITH SUE	17	30,670	0	3,272	303.00																																																																																																																		
2013	2013-660015460	CONKINS, JUDITH SUE	17	32,271	0	3,117	285.00																																																																																																																		



Rogers

Assessment Property Record Card for Tax Year 2026

Data provided by LISA DELOZIER County Assessor

Date 04/16/2026
 Time 21:11:49
 Page 2

Lot Data		Square-Foot - NBHD 1161 #1	
Lot Size			
Lot Count	1		
Units Buildable	4127		
Non-Ag Acres	0.1285		
Topography			
Street Access			
Utilities			
Amenities	LAND QUALITY	0	0
Method	Square-Foot		
Base Lot Value	5,599.00 x 5.50 = 30,795		
Factor Value			
Adjustments	1.0000		
Lot Value	30,795		



\\tsclient\T\LOGAN\LOGAN RESIDENTIAL VI\2023-8-21\IMG_000 8/21/2023

Residential Data	
Type	1 Single Family Residence
Condition	3 - Average
Quality	2 - Fair
Architecture	R3 Res Nbhd 3
Style	100% One Story
Exterior Wall	100% Frame, Siding, Wood
Base/Total Area	1,008 / 1,008
Style	100% One Story
HVAC	100% Floor Furnace
Roof Cover	1 Composition Shingle
Area on Slab	0
Fixture/RghIn	4 /
Bed/F/H Bath	3 / 1.0 /
Basement Area	
Garage Type	
Remodel	
Year/Eff Age	1950 / 57

GRM Approach	
GRM Code	
Gross Rent	0.00
Indicated Value	

Multiple Regression			
MRA Code	1	Test	
Adusted R	0.8445		
Indicated Value	51,273	50.87	Per SqFt

Direct Comparables			
Selection Model	A	Adam Test	
Adjustment Model	1	2022 Residential	
Comparables	8		
Indicated Value	99,540		Per SqFt

Cost Approach				Manual : 01/2025			
Base Cost	94.03	Total Misc Impr	+	3,001			
Roofing Adj	+ 4.21	Garage Cost	+				
Subfloor Adj	+ 2.43	Total RCN	=	111,149			
Heat/Cool Adj	+ 1.65	Depreciation (65%)	-	72,247			
Plumbing Adj	+ 4.97	Lump Sums	+	0			
Basement Adj	+ 0.00	RCNLD	=	38,902			
Adj Base Cost	= 107.29	Lot Value	+	30,795			
Total Area	x 1,008	Indicated Value	=	69,697			
Adjusted Cost	= 108,148	Value Per SqFt		69.14			

Value Reconciliation			
Selected Approach	Cost Approach		
Improvements	38,902		
Lot Value	30,795		
Indicated Value	69,697	69.14	Per SqFt
Agland Value			
Site Improvements			
Total Value	69,697	69.14	Total Value Per SqFt

Miscellaneous Improvements								
Code	Description	Sketch ID	Size	Year	Units	Unit Cost	Depr	Value
PRCH	SLAB PORCH - COVERED	37220	18x8		144	20.84		3,001



Rogers

Assessment Property Record Card for Tax Year 2026

Data provided by LISA DELOZIER County Assessor

Date 04/16/2026

Time 21:11:49

Page 3

Sketch Image

660015460

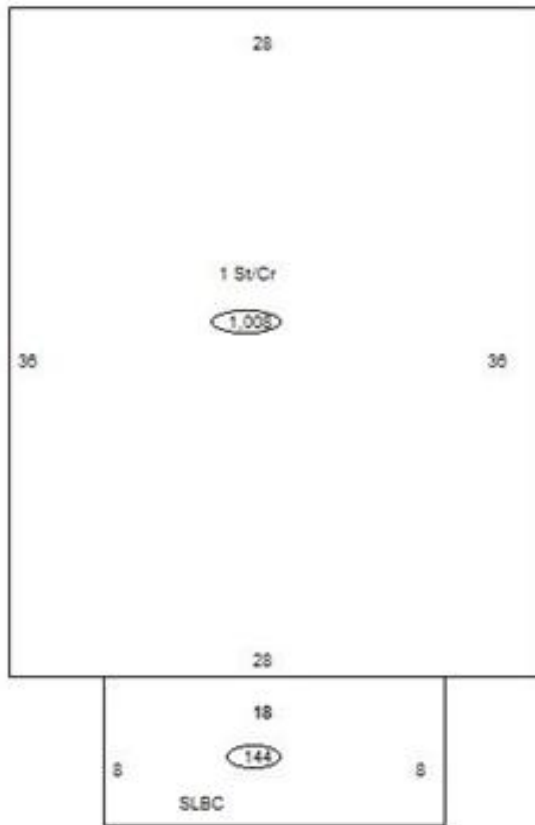

Sketch Vector Information

Sequence	Code	Type	Built Over	Scale	Section Label	Base Area	Multiplier	Total Area
1	R	1	Crawl	10	1 St/Cr	1,008	1.000	1,008
2	M	PRCH		10	SLBC	144	1.000	144
Total Building Area						1,008		1,008