



Rogers

Assessment Property Record Card for Tax Year 2026

Data provided by LISA DELOZIER County Assessor

Date 04/16/2026
Time 23:28:26
Page 1

Assessment Data					Primary Image																																																																																																																				
Account 660015469 Parcel ID 000000-00-0-10195-001-0016 Cadastral ID 16-21-16-07820 Property Type REAL - Real Property Property Class URP VI Area 1 Tax Area 17 - CLAREMORE OT Name ID 281621 SIXKILLER, STEVE 610 S MARYLAND CLAREMORE OK 74017-0000 Parcel Location Situs 00610 S MARYLAND AVE Subdivision HOMEBUILDERS Lot/Block 0016 / 0001 Parcel Size .5 - Lots Sec/Twn/Rng 16 / 21 / 16 / 5 Neighborhood 1161 - R-V01-SW CLAREMORE School District S001 - CLAREMORE SCHOOLS																																																																																																																									
Legal Description Lat/Long: 36.30466270 -95.61377689 N 50', S 100', W 120' TR 16 HOMEBUILDERS																																																																																																																									
Exemptions <table border="1"> <thead> <tr> <th>Code</th> <th>Type</th> <th>Active</th> <th>Maximum</th> <th>Exemption</th> </tr> </thead> <tbody> <tr> <td>H</td> <td>Homestead</td> <td>Yes</td> <td>1,000</td> <td>1,000</td> </tr> </tbody> </table>					Code	Type	Active	Maximum	Exemption	H	Homestead	Yes	1,000	1,000	Building Permits <table border="1"> <thead> <tr> <th>Number</th> <th>Description</th> <th>Opened</th> <th>Closed</th> <th>Amount</th> </tr> </thead> <tbody> <tr> <td></td> <td></td> <td></td> <td></td> <td></td> </tr> </tbody> </table>					Number	Description	Opened	Closed	Amount																																																																																																	
Code	Type	Active	Maximum	Exemption																																																																																																																					
H	Homestead	Yes	1,000	1,000																																																																																																																					
Number	Description	Opened	Closed	Amount																																																																																																																					
Parcel Valuation <table border="1"> <thead> <tr> <th>Source</th> <th>REAL</th> <th>Fair Cash</th> <th>Capped</th> <th>Asmnt Level</th> <th>Assessed</th> <th>Levy Rate</th> <th>92.430</th> <th>Current Tax</th> </tr> </thead> <tbody> <tr> <td>Remove Cap</td> <td>2003</td> <td>Land Value</td> <td>27,654</td> <td>27,165</td> <td>11%</td> <td>2,988</td> <td>Assessed</td> <td>8,307 767.82</td> </tr> <tr> <td>Year Frozen</td> <td>2019</td> <td>Improvements</td> <td>49,222</td> <td>48,352</td> <td></td> <td>5,319</td> <td>Penalty</td> <td>0</td> </tr> <tr> <td>Uncapped Value</td> <td>0</td> <td>Mobile Home</td> <td>0</td> <td>0</td> <td></td> <td>0</td> <td>Exemption</td> <td>1,000 -93.00</td> </tr> <tr> <td>TIF Project ID</td> <td>0</td> <td>Total Value</td> <td>76,876</td> <td>75,517</td> <td></td> <td>8,307</td> <td>Total Taxable</td> <td>7,307 675.00</td> </tr> </tbody> </table>					Source	REAL	Fair Cash	Capped	Asmnt Level	Assessed	Levy Rate	92.430	Current Tax	Remove Cap	2003	Land Value	27,654	27,165	11%	2,988	Assessed	8,307 767.82	Year Frozen	2019	Improvements	49,222	48,352		5,319	Penalty	0	Uncapped Value	0	Mobile Home	0	0		0	Exemption	1,000 -93.00	TIF Project ID	0	Total Value	76,876	75,517		8,307	Total Taxable	7,307 675.00	Sale History <table border="1"> <thead> <tr> <th>Bk/Pg</th> <th>Grantor</th> <th>Date</th> <th>Price</th> <th>Code</th> </tr> </thead> <tbody> <tr> <td>1437/133</td> <td>GOLBEK, DARYL WAYNE &</td> <td>12/31/2002</td> <td>62,000</td> <td>YES</td> </tr> <tr> <td>1356/438</td> <td>LANHART, LEONARD G</td> <td>02/15/2002</td> <td>55,000</td> <td>YES</td> </tr> <tr> <td>1225/204</td> <td>GOLBEK, YVONNE ALLESA &</td> <td>04/26/2000</td> <td>49,500</td> <td>No</td> </tr> <tr> <td>958/685</td> <td>SELLER</td> <td>05/27/1994</td> <td>0</td> <td>No</td> </tr> </tbody> </table>					Bk/Pg	Grantor	Date	Price	Code	1437/133	GOLBEK, DARYL WAYNE &	12/31/2002	62,000	YES	1356/438	LANHART, LEONARD G	02/15/2002	55,000	YES	1225/204	GOLBEK, YVONNE ALLESA &	04/26/2000	49,500	No	958/685	SELLER	05/27/1994	0	No																																										
Source	REAL	Fair Cash	Capped	Asmnt Level	Assessed	Levy Rate	92.430	Current Tax																																																																																																																	
Remove Cap	2003	Land Value	27,654	27,165	11%	2,988	Assessed	8,307 767.82																																																																																																																	
Year Frozen	2019	Improvements	49,222	48,352		5,319	Penalty	0																																																																																																																	
Uncapped Value	0	Mobile Home	0	0		0	Exemption	1,000 -93.00																																																																																																																	
TIF Project ID	0	Total Value	76,876	75,517		8,307	Total Taxable	7,307 675.00																																																																																																																	
Bk/Pg	Grantor	Date	Price	Code																																																																																																																					
1437/133	GOLBEK, DARYL WAYNE &	12/31/2002	62,000	YES																																																																																																																					
1356/438	LANHART, LEONARD G	02/15/2002	55,000	YES																																																																																																																					
1225/204	GOLBEK, YVONNE ALLESA &	04/26/2000	49,500	No																																																																																																																					
958/685	SELLER	05/27/1994	0	No																																																																																																																					
Assessment History <table border="1"> <thead> <tr> <th>Tax Year</th> <th>Statement Number</th> <th>Billed Owner</th> <th>Tax Area</th> <th>Total Value</th> <th>Exemptions</th> <th>Taxable Value</th> <th>Billed Tax</th> </tr> </thead> <tbody> <tr><td>2025</td><td>2025-660015469</td><td>SIXKILLER, STEVE</td><td>17</td><td>75,517</td><td>1000</td><td>7,307</td><td>675.00</td></tr> <tr><td>2024</td><td>2024-660015469</td><td>SIXKILLER, STEVE</td><td>17</td><td>76,714</td><td>1000</td><td>7,438</td><td>687.00</td></tr> <tr><td>2023</td><td>2023-660015469</td><td>SIXKILLER, STEVE</td><td>17</td><td>103,474</td><td>1000</td><td>7,701</td><td>705.00</td></tr> <tr><td>2022</td><td>2022-660015469</td><td>SIXKILLER, STEVE</td><td>17</td><td>79,722</td><td>1000</td><td>7,702</td><td>713.00</td></tr> <tr><td>2021</td><td>2021-660015469</td><td>SIXKILLER, STEVE</td><td>17</td><td>84,665</td><td>1000</td><td>7,702</td><td>680.00</td></tr> <tr><td>2020</td><td>2020-660015469</td><td>SIXKILLER, STEVE</td><td>17</td><td>83,240</td><td>1000</td><td>7,701</td><td>705.00</td></tr> <tr><td>2019</td><td>2019-660015469</td><td>SIXKILLER, STEVE</td><td>17</td><td>79,105</td><td>1000</td><td>7,702</td><td>713.00</td></tr> <tr><td>2018</td><td>2018-660015469</td><td>SIXKILLER, STEVE</td><td>17</td><td>84,034</td><td>1000</td><td>8,244</td><td>762.00</td></tr> <tr><td>2017</td><td>2017-660015469</td><td>SIXKILLER, STEVE</td><td>17</td><td>83,304</td><td>1000</td><td>8,035</td><td>738.00</td></tr> <tr><td>2016</td><td>2016-660015469</td><td>SIXKILLER, STEVE</td><td>17</td><td>80,990</td><td>1000</td><td>7,772</td><td>729.00</td></tr> <tr><td>2015</td><td>2015-660015469</td><td>SIXKILLER, STEVE</td><td>17</td><td>79,300</td><td>1000</td><td>7,517</td><td>678.00</td></tr> <tr><td>2014</td><td>2014-660015469</td><td>SIXKILLER, STEVE</td><td>17</td><td>79,937</td><td>1000</td><td>7,269</td><td>674.00</td></tr> <tr><td>2013</td><td>2013-660015469</td><td>SIXKILLER, STEVE</td><td>17</td><td>76,483</td><td>1000</td><td>7,028</td><td>643.00</td></tr> </tbody> </table>										Tax Year	Statement Number	Billed Owner	Tax Area	Total Value	Exemptions	Taxable Value	Billed Tax	2025	2025-660015469	SIXKILLER, STEVE	17	75,517	1000	7,307	675.00	2024	2024-660015469	SIXKILLER, STEVE	17	76,714	1000	7,438	687.00	2023	2023-660015469	SIXKILLER, STEVE	17	103,474	1000	7,701	705.00	2022	2022-660015469	SIXKILLER, STEVE	17	79,722	1000	7,702	713.00	2021	2021-660015469	SIXKILLER, STEVE	17	84,665	1000	7,702	680.00	2020	2020-660015469	SIXKILLER, STEVE	17	83,240	1000	7,701	705.00	2019	2019-660015469	SIXKILLER, STEVE	17	79,105	1000	7,702	713.00	2018	2018-660015469	SIXKILLER, STEVE	17	84,034	1000	8,244	762.00	2017	2017-660015469	SIXKILLER, STEVE	17	83,304	1000	8,035	738.00	2016	2016-660015469	SIXKILLER, STEVE	17	80,990	1000	7,772	729.00	2015	2015-660015469	SIXKILLER, STEVE	17	79,300	1000	7,517	678.00	2014	2014-660015469	SIXKILLER, STEVE	17	79,937	1000	7,269	674.00	2013	2013-660015469	SIXKILLER, STEVE	17	76,483	1000	7,028	643.00
Tax Year	Statement Number	Billed Owner	Tax Area	Total Value	Exemptions	Taxable Value	Billed Tax																																																																																																																		
2025	2025-660015469	SIXKILLER, STEVE	17	75,517	1000	7,307	675.00																																																																																																																		
2024	2024-660015469	SIXKILLER, STEVE	17	76,714	1000	7,438	687.00																																																																																																																		
2023	2023-660015469	SIXKILLER, STEVE	17	103,474	1000	7,701	705.00																																																																																																																		
2022	2022-660015469	SIXKILLER, STEVE	17	79,722	1000	7,702	713.00																																																																																																																		
2021	2021-660015469	SIXKILLER, STEVE	17	84,665	1000	7,702	680.00																																																																																																																		
2020	2020-660015469	SIXKILLER, STEVE	17	83,240	1000	7,701	705.00																																																																																																																		
2019	2019-660015469	SIXKILLER, STEVE	17	79,105	1000	7,702	713.00																																																																																																																		
2018	2018-660015469	SIXKILLER, STEVE	17	84,034	1000	8,244	762.00																																																																																																																		
2017	2017-660015469	SIXKILLER, STEVE	17	83,304	1000	8,035	738.00																																																																																																																		
2016	2016-660015469	SIXKILLER, STEVE	17	80,990	1000	7,772	729.00																																																																																																																		
2015	2015-660015469	SIXKILLER, STEVE	17	79,300	1000	7,517	678.00																																																																																																																		
2014	2014-660015469	SIXKILLER, STEVE	17	79,937	1000	7,269	674.00																																																																																																																		
2013	2013-660015469	SIXKILLER, STEVE	17	76,483	1000	7,028	643.00																																																																																																																		



Rogers

Assessment Property Record Card for Tax Year 2026

Data provided by LISA DELOZIER County Assessor

Date 04/16/2026
 Time 23:28:26
 Page 2

Lot Data	Square-Foot - NBHD 1161 #1	Primary Image
Lot Size Lot Count 1 Units Buildable 4500 Non-Ag Acres 0.1154 Topography Street Access Utilities Amenities LAND QUALITY 0 0 Method Square-Foot Base Lot Value 5,028.00 x 5.50 = 27,654 Factor Value Adjustments 1.0000 Lot Value 27,654		

Residential Data	
Type	1 Single Family Residence
Condition	3 - Average
Quality	2 - Fair
Architecture	R3 Res Nbhd 3
Style	100% 1 1/2 Story Finished
Exterior Wall	100% Frame, Siding, Wood
Base/Total Area	1,120 / 1,444
Style	100% 1 1/2 Story Finished
HVAC	100% Floor Furnace
Roof Cover	1 Composition Shingle
Area on Slab	0
Fixture/RghIn	4 /
Bed/F/H Bath	2 / 1.0 /
Basement Area	
Garage Type	392 Carport - Shed Roof
Remodel	
Year/Eff Age	1950 / 57

GRM Approach
GRM Code Gross Rent 0.00 Indicated Value

Multiple Regression
MRA Code 1 Test Adusted R 0.8445 Indicated Value 108,385 75.06 Per SqFt

Direct Comparables
Selection Model A Adam Test Adjustment Model 1 2022 Residential Comparables 8 Indicated Value 144,760 Per SqFt

Cost Approach				Manual : 01/2025			
Base Cost	81.45	Total Misc Impr	+ 1,912	Roofing Adj	+ 3.33	Garage Cost	+ 4,128
Subfloor Adj	+ 1.96	Total RCN	= 138,686	Heat/Cool Adj	+ 1.65	Depreciation (65%)	- 90,146
Plumbing Adj	+ 3.47	Lump Sums	+ 0	Basement Adj	+ 0.00	RCNLD	= 48,540
Adj Base Cost	= 91.86	Lot Value	+ 27,654	Total Area	x 1,444	Indicated Value	= 76,194
		Value Per SqFt	52.77	Adjusted Cost	= 132,646		

Value Reconciliation
Selected Approach Cost Approach Improvements 48,540 Lot Value 27,654 Indicated Value 76,194 52.77 Per SqFt Agland Value Site Improvements 682 Total Value 76,876 53.24 Total Value Per SqFt

Miscellaneous Improvements								
Code	Description	Sketch ID	Size	Year	Units	Unit Cost	Depr	Value
PRCH	SLAB PORCH - COVERED	37235	13x7		91	21.01		1,912



Rogers

Assessment Property Record Card for Tax Year 2026

Data provided by LISA DELOZIER County Assessor

Date 04/16/2026

Time 23:28:26

Page 3

Sketch Image

660015469

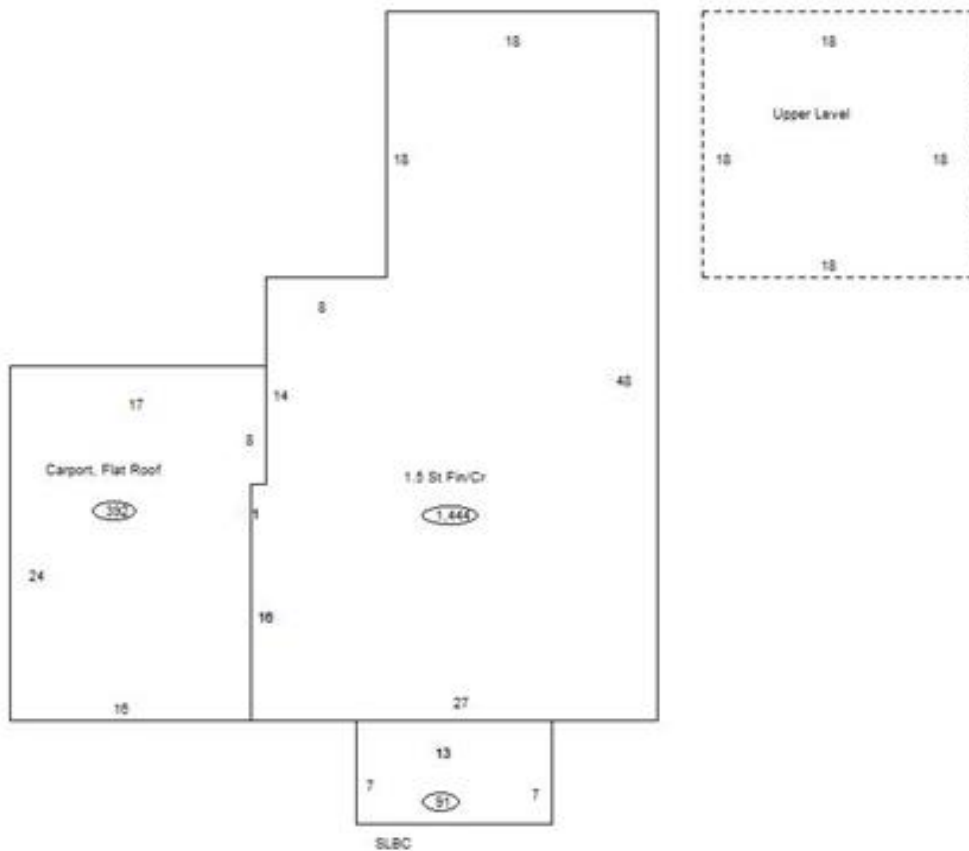

Sketch Vector Information

Sequence	Code	Type	Built Over	Scale	Section Label	Base Area	Multiplier	Total Area
1	R	5	Crawl	10	1.5 St Fin/Cr	1,120	1.289	1,444
2	M	PRCH		10	SLBC	91	1.000	91
3	G	4		10	Carport, Flat Roof	392	1.000	392
4	U	^UL	Overhang	10	Upper Level	324	1.000	324
Total Building Area						1,120		1,444



Rogers



Assessment Property Record Card for Tax Year 2026

Data provided by LISA DELOZIER County Assessor

Date 04/16/2026
Time 23:28:26
Page 4

660015469

Outbuildings/Site Improvements

Building Image	Code	Description	Dimensions	Floor	Roofing	Total Units
	STF Qual 2	STG FAIR Cond 3	0x0x0 Year		Eff Age	364
		Valuation Summary	Modifier Total	RCN	Depr (60% Phys/ % Func)	RCNLD
		Base Cost (4.68 x 364)	1,704		1,704	1,022
	STF Qual 2	STG FAIR Cond	0x0x0 Year		Eff Age	
		Valuation Summary	Modifier Total	RCN	Depr (100% Phys/ % Func)	RCNLD
		Base Cost (4.68 x)				