



Rogers

Assessment Property Record Card for Tax Year 2026

Data provided by LISA DELOZIER County Assessor

Date 04/16/2026
Time 23:18:31
Page 1

Assessment Data					Primary Image																																																																																																																				
Account 660015482 Parcel ID 000000-00-0-10215-001-0006 Cadastral ID 16-21-16-08000 Property Type REAL - Real Property Property Class URP VI Area 1 Tax Area 17 - CLAREMORE OT Name ID 338882 BALANZATEGUI, MICHAEL JOSEPH & KORI LEE 5701 E 142ND PL N COLLINSVILLE OK 74021-0000 Parcel Location Situs 00906 S CHOCTAW AVE Subdivision KELLEY HEIGHTS Lot/Block 0006 / 0001 Parcel Size 1 - Lots Sec/Twn/Rng 16 / 21 / 16 / 5 Neighborhood 1161 - R-V01-SW CLAREMORE School District S001 - CLAREMORE SCHOOLS																																																																																																																									
Legal Description Lot/Long: 36.29948792 -95.60994305																																																																																																																									
Building Permits					<table border="1"> <thead> <tr> <th>Number</th> <th>Description</th> <th>Opened</th> <th>Closed</th> <th>Amount</th> </tr> </thead> <tbody> <tr> <td colspan="5"> </td> </tr> </tbody> </table>					Number	Description	Opened	Closed	Amount																																																																																																											
Number	Description	Opened	Closed	Amount																																																																																																																					
Exemptions					Sale History																																																																																																																				
<table border="1"> <thead> <tr> <th>Code</th> <th>Type</th> <th>Active</th> <th>Maximum</th> <th>Exemption</th> </tr> </thead> <tbody> <tr> <td colspan="5"> </td> </tr> </tbody> </table>					Code	Type	Active	Maximum	Exemption						<table border="1"> <thead> <tr> <th>Bk/Pg</th> <th>Grantor</th> <th>Date</th> <th>Price</th> <th>Code</th> </tr> </thead> <tbody> <tr> <td>/</td> <td>MESSIMORE, TYLER</td> <td>06/30/2022</td> <td>109,000</td> <td>YES</td> </tr> <tr> <td>2491/469</td> <td>BBS PROPERTIES LLC 2/3 INT &</td> <td>08/06/2015</td> <td>77,000</td> <td>YES</td> </tr> <tr> <td>2481/562</td> <td>BBS PROPERTIES LLC</td> <td>05/13/2015</td> <td>0</td> <td>4</td> </tr> <tr> <td>2122/501</td> <td>MOODY, LARRY & BRENDA</td> <td>08/24/2010</td> <td>100,000</td> <td>11</td> </tr> </tbody> </table>					Bk/Pg	Grantor	Date	Price	Code	/	MESSIMORE, TYLER	06/30/2022	109,000	YES	2491/469	BBS PROPERTIES LLC 2/3 INT &	08/06/2015	77,000	YES	2481/562	BBS PROPERTIES LLC	05/13/2015	0	4	2122/501	MOODY, LARRY & BRENDA	08/24/2010	100,000	11																																																																													
Code	Type	Active	Maximum	Exemption																																																																																																																					
Bk/Pg	Grantor	Date	Price	Code																																																																																																																					
/	MESSIMORE, TYLER	06/30/2022	109,000	YES																																																																																																																					
2491/469	BBS PROPERTIES LLC 2/3 INT &	08/06/2015	77,000	YES																																																																																																																					
2481/562	BBS PROPERTIES LLC	05/13/2015	0	4																																																																																																																					
2122/501	MOODY, LARRY & BRENDA	08/24/2010	100,000	11																																																																																																																					
Parcel Valuation																																																																																																																									
<table border="1"> <thead> <tr> <th>Source</th> <th>REAL</th> <th>Fair Cash</th> <th>Capped</th> <th>Asmnt Level</th> <th>Assessed</th> <th>Levy Rate</th> <th>92.430</th> <th>Current Tax</th> </tr> </thead> <tbody> <tr> <td>Remove Cap</td> <td>2023</td> <td>Land Value</td> <td>53,620</td> <td>53,620</td> <td>11%</td> <td>5,898</td> <td>Assessed</td> <td>12,272</td> <td>1,134.30</td> </tr> <tr> <td>Year Frozen</td> <td>0</td> <td>Improvements</td> <td>57,947</td> <td>57,947</td> <td></td> <td>6,374</td> <td>Penalty</td> <td>0</td> <td></td> </tr> <tr> <td>Uncapped Value</td> <td>0</td> <td>Mobile Home</td> <td>0</td> <td>0</td> <td></td> <td>0</td> <td>Exemption</td> <td>0</td> <td>0.00</td> </tr> <tr> <td>TIF Project ID</td> <td>0</td> <td>Total Value</td> <td>111,567</td> <td>111,567</td> <td></td> <td>12,272</td> <td>Total Taxable</td> <td>12,272</td> <td>1,134.00</td> </tr> </tbody> </table>		Source	REAL	Fair Cash	Capped	Asmnt Level	Assessed	Levy Rate	92.430	Current Tax	Remove Cap	2023	Land Value	53,620	53,620	11%	5,898	Assessed	12,272	1,134.30	Year Frozen	0	Improvements	57,947	57,947		6,374	Penalty	0		Uncapped Value	0	Mobile Home	0	0		0	Exemption	0	0.00	TIF Project ID	0	Total Value	111,567	111,567		12,272	Total Taxable	12,272	1,134.00																																																																							
Source	REAL	Fair Cash	Capped	Asmnt Level	Assessed	Levy Rate	92.430	Current Tax																																																																																																																	
Remove Cap	2023	Land Value	53,620	53,620	11%	5,898	Assessed	12,272	1,134.30																																																																																																																
Year Frozen	0	Improvements	57,947	57,947		6,374	Penalty	0																																																																																																																	
Uncapped Value	0	Mobile Home	0	0		0	Exemption	0	0.00																																																																																																																
TIF Project ID	0	Total Value	111,567	111,567		12,272	Total Taxable	12,272	1,134.00																																																																																																																
Assessment History																																																																																																																									
<table border="1"> <thead> <tr> <th>Tax Year</th> <th>Statement Number</th> <th>Billed Owner</th> <th>Tax Area</th> <th>Total Value</th> <th>Exemptions</th> <th>Taxable Value</th> <th>Billed Tax</th> </tr> </thead> <tbody> <tr> <td>2025</td> <td>2025-660015482</td> <td>BALANZATEGUI, MICHAEL JOSEPH &</td> <td>17</td> <td>109,672</td> <td>0</td> <td>12,064</td> <td>1,115.00</td> </tr> <tr> <td>2024</td> <td>2024-660015482</td> <td>BALANZATEGUI, MICHAEL JOSEPH &</td> <td>17</td> <td>109,000</td> <td>0</td> <td>11,990</td> <td>1,108.00</td> </tr> <tr> <td>2023</td> <td>2023-660015482</td> <td>BALANZATEGUI, MICHAEL JOSEPH &</td> <td>17</td> <td>109,000</td> <td>0</td> <td>11,990</td> <td>1,098.00</td> </tr> <tr> <td>2022</td> <td>2022-660015482</td> <td>BALANZATEGUI, MICHAEL JOSEPH &</td> <td>17</td> <td>80,645</td> <td>0</td> <td>8,871</td> <td>821.00</td> </tr> <tr> <td>2021</td> <td>2021-660015482</td> <td>MESSIMORE, TYLER</td> <td>17</td> <td>82,750</td> <td>0</td> <td>9,103</td> <td>804.00</td> </tr> <tr> <td>2020</td> <td>2020-660015482</td> <td>MESSIMORE, TYLER</td> <td>17</td> <td>81,503</td> <td>0</td> <td>8,965</td> <td>821.00</td> </tr> <tr> <td>2019</td> <td>2019-660015482</td> <td>MESSIMORE, TYLER</td> <td>17</td> <td>79,134</td> <td>0</td> <td>8,705</td> <td>806.00</td> </tr> <tr> <td>2018</td> <td>2018-660015482</td> <td>MESSIMORE, TYLER</td> <td>17</td> <td>82,234</td> <td>0</td> <td>9,046</td> <td>836.00</td> </tr> <tr> <td>2017</td> <td>2017-660015482</td> <td>MESSIMORE, TYLER</td> <td>17</td> <td>81,596</td> <td>0</td> <td>8,976</td> <td>824.00</td> </tr> <tr> <td>2016</td> <td>2016-660015482</td> <td>MESSIMORE, TYLER</td> <td>17</td> <td>79,672</td> <td>0</td> <td>8,764</td> <td>823.00</td> </tr> <tr> <td>2015</td> <td>2015-660015482</td> <td>MESSIMORE, TYLER</td> <td>17</td> <td>63,235</td> <td>0</td> <td>6,956</td> <td>627.00</td> </tr> <tr> <td>2014</td> <td>2014-660015482</td> <td>BBS PROPERTIES LLC</td> <td>17</td> <td>63,685</td> <td>0</td> <td>7,005</td> <td>650.00</td> </tr> <tr> <td>2013</td> <td>2013-660015482</td> <td>BBS PROPERTIES LLC</td> <td>17</td> <td>61,170</td> <td>0</td> <td>6,729</td> <td>616.00</td> </tr> </tbody> </table>										Tax Year	Statement Number	Billed Owner	Tax Area	Total Value	Exemptions	Taxable Value	Billed Tax	2025	2025-660015482	BALANZATEGUI, MICHAEL JOSEPH &	17	109,672	0	12,064	1,115.00	2024	2024-660015482	BALANZATEGUI, MICHAEL JOSEPH &	17	109,000	0	11,990	1,108.00	2023	2023-660015482	BALANZATEGUI, MICHAEL JOSEPH &	17	109,000	0	11,990	1,098.00	2022	2022-660015482	BALANZATEGUI, MICHAEL JOSEPH &	17	80,645	0	8,871	821.00	2021	2021-660015482	MESSIMORE, TYLER	17	82,750	0	9,103	804.00	2020	2020-660015482	MESSIMORE, TYLER	17	81,503	0	8,965	821.00	2019	2019-660015482	MESSIMORE, TYLER	17	79,134	0	8,705	806.00	2018	2018-660015482	MESSIMORE, TYLER	17	82,234	0	9,046	836.00	2017	2017-660015482	MESSIMORE, TYLER	17	81,596	0	8,976	824.00	2016	2016-660015482	MESSIMORE, TYLER	17	79,672	0	8,764	823.00	2015	2015-660015482	MESSIMORE, TYLER	17	63,235	0	6,956	627.00	2014	2014-660015482	BBS PROPERTIES LLC	17	63,685	0	7,005	650.00	2013	2013-660015482	BBS PROPERTIES LLC	17	61,170	0	6,729	616.00
Tax Year	Statement Number	Billed Owner	Tax Area	Total Value	Exemptions	Taxable Value	Billed Tax																																																																																																																		
2025	2025-660015482	BALANZATEGUI, MICHAEL JOSEPH &	17	109,672	0	12,064	1,115.00																																																																																																																		
2024	2024-660015482	BALANZATEGUI, MICHAEL JOSEPH &	17	109,000	0	11,990	1,108.00																																																																																																																		
2023	2023-660015482	BALANZATEGUI, MICHAEL JOSEPH &	17	109,000	0	11,990	1,098.00																																																																																																																		
2022	2022-660015482	BALANZATEGUI, MICHAEL JOSEPH &	17	80,645	0	8,871	821.00																																																																																																																		
2021	2021-660015482	MESSIMORE, TYLER	17	82,750	0	9,103	804.00																																																																																																																		
2020	2020-660015482	MESSIMORE, TYLER	17	81,503	0	8,965	821.00																																																																																																																		
2019	2019-660015482	MESSIMORE, TYLER	17	79,134	0	8,705	806.00																																																																																																																		
2018	2018-660015482	MESSIMORE, TYLER	17	82,234	0	9,046	836.00																																																																																																																		
2017	2017-660015482	MESSIMORE, TYLER	17	81,596	0	8,976	824.00																																																																																																																		
2016	2016-660015482	MESSIMORE, TYLER	17	79,672	0	8,764	823.00																																																																																																																		
2015	2015-660015482	MESSIMORE, TYLER	17	63,235	0	6,956	627.00																																																																																																																		
2014	2014-660015482	BBS PROPERTIES LLC	17	63,685	0	7,005	650.00																																																																																																																		
2013	2013-660015482	BBS PROPERTIES LLC	17	61,170	0	6,729	616.00																																																																																																																		



Rogers

Assessment Property Record Card for Tax Year 2026

Data provided by LISA DELOZIER County Assessor

Date 04/16/2026
Time 23:18:31
Page 2

Lot Data		Square-Foot - NBHD 1161 #1		Primary Image	
Lot Size					
Lot Count	1				
Units Buildable	1				
Non-Ag Acres	0.1922				
Topography					
Street Access					
Utilities					
Amenities	LAND QUALITY	0			
		0			
Method	Square-Foot				
Base Lot Value	8,372.00 x 5.50 = 46,046				
Factor Value					
Adjustments	1.1645				
Lot Value	53,620				
Residential Data				<p>\\tsclient\T\LOGAN\LOGAN RESIDENTIAL VI\2023-8-21\IMG_002I 8/21/2023</p>	
Type	1 Single Family Residence			GRM Approach	
Condition	3 - Average			GRM Code	
Quality	2 - Fair			Gross Rent 0.00	
Architecture				Indicated Value	
Style	100% One Story			Multiple Regression	
Exterior Wall	75% Veneer, Masonry 25% Frame, Siding, Wood			MRA Code 1 Test	
Base/Total Area	840 / 840			Adusted R 0.8445	
Style	100% One Story			Indicated Value 83,385 99.27 Per SqFt	
HVAC	100% Warmed & Cooled Air			Direct Comparables	
Roof Cover	1 Composition Shingle			Selection Model A Adam Test	
Area on Slab	840			Adjustment Model 1 2022 Residential	
Fixture/RghIn	4 /			Comparables 7	
Bed/F/H Bath	3 / 1.0 /			Indicated Value 109,030 Per SqFt	
Basement Area				Value Reconciliation	
Garage Type	264 Attached Garage - Unfinished			Selected Approach Cost Approach	
Remodel				Improvements 57,947	
Year/Eff Age	1971 / 41			Lot Value 53,620	
Cost Approach		Manual : 01/2025		Indicated Value 111,567 132.82 Per SqFt	
Base Cost	106.83	Total Misc Impr	+ 3,701	Agland Value	
Roofing Adj	+ 4.46	Garage Cost	+ 7,408	Site Improvements	
Subfloor Adj	+ 0.00	Total RCN	= 118,259	Total Value 111,567 132.82 Total Value Per SqFt	
Heat/Cool Adj	+ 10.30	Depreciation (51%)	- 60,312		
Plumbing Adj	+ 5.97	Lump Sums	+ 0		
Basement Adj	+ 0.00	RCNLD	= 57,947		
Adj Base Cost	= 127.56	Lot Value	+ 53,620		
Total Area	x 840	Indicated Value	= 111,567		
Adjusted Cost	= 107,150	Value Per SqFt	132.82		

Miscellaneous Improvements							
Code	Description	Sketch ID	Size	Year	Units	Unit Cost	Depr Value
PRCH	SLAB PORCH - COVERED	37274	14x4		56	21.12	1,183
PATO	SLAB PORCH - OPEN	37275	32x10		320	7.87	2,518



Rogers

Assessment Property Record Card for Tax Year 2026

Data provided by LISA DELOZIER County Assessor

Date 04/16/2026
 Time 23:18:31
 Page 3

Sketch Image

660015482

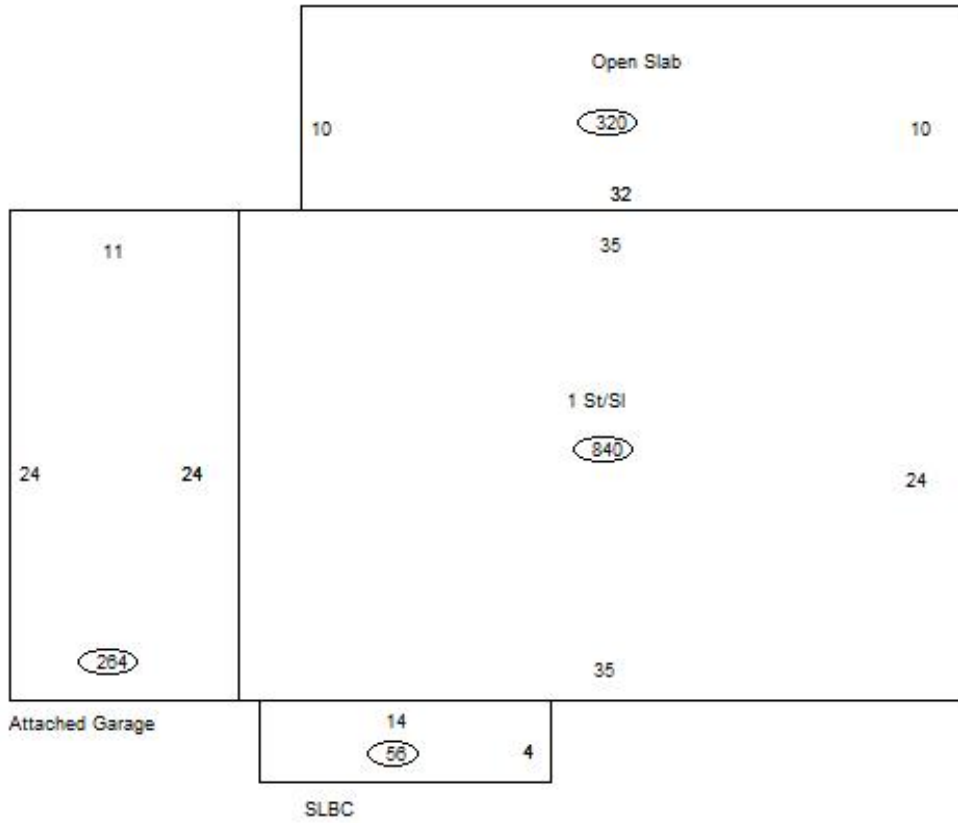

Sketch Vector Information

Sequence	Code	Type	Built Over	Scale	Section Label	Base Area	Multiplier	Total Area
1	R	1	Slab	10	1 St/SI	840	1.000	840
2	G	1		10	Attached Garage	264	1.000	264
3	M	PRCH		10	SLBC	56	1.000	56
4	M	PATO		10	Open Slab	320	1.000	320
Total Building Area						840		840