



# Rogers

## Assessment Property Record Card for Tax Year 2026

Data provided by LISA DELOZIER County Assessor

Date 04/16/2026  
Time 23:19:29  
Page 1

Assessment Data					Primary Image																																																																																																																				
<b>Account</b> 660015537 <b>Parcel ID</b> 000000-00-0-10215-002-0028 <b>Cadastral ID</b> 16-21-16-08440 <b>Property Type</b> REAL - Real Property <b>Property Class</b> URP VI Area 1 <b>Tax Area</b> 17 - CLAREMORE OT <b>Name ID</b> 329956 KNIGHT RENTALS LLC  1605 COLLEGE PARK RD CLAREMORE OK 74017-0000  <b>Parcel Location</b> <b>Situs</b> 01004 S CHOCTAW PL <b>Subdivision</b> KELLEY HEIGHTS <b>Lot/Block</b> 0028 / 0002 <b>Parcel Size</b> 1 - Lots <b>Sec/Twn/Rng</b> 16 / 21 / 16 / 5 <b>Neighborhood</b> 1161 - R-V01-SW CLAREMORE <b>School District</b> S001 - CLAREMORE SCHOOLS																																																																																																																									
<b>Legal Description</b> Lot/Long: 36.29857776 -95.60888865																																																																																																																									
<b>Legal Description</b> LOT 28 BLOCK 2 KELLEY HEIGHTS					<b>Building Permits</b> <table border="1"> <thead> <tr> <th>Number</th> <th>Description</th> <th>Opened</th> <th>Closed</th> <th>Amount</th> </tr> </thead> <tbody> <tr> <td> </td> <td> </td> <td> </td> <td> </td> <td> </td> </tr> </tbody> </table>					Number	Description	Opened	Closed	Amount																																																																																																											
Number	Description	Opened	Closed	Amount																																																																																																																					
<b>Exemptions</b> <table border="1"> <thead> <tr> <th>Code</th> <th>Type</th> <th>Active</th> <th>Maximum</th> <th>Exemption</th> </tr> </thead> <tbody> <tr> <td>H</td> <td>Homestead</td> <td>No</td> <td>1,000</td> <td> </td> </tr> <tr> <td>H</td> <td>Homestead</td> <td>No</td> <td>1,000</td> <td> </td> </tr> </tbody> </table>					Code	Type	Active	Maximum	Exemption	H	Homestead	No	1,000		H	Homestead	No	1,000		<b>Sale History</b> <table border="1"> <thead> <tr> <th>Bk/Pg</th> <th>Grantor</th> <th>Date</th> <th>Price</th> <th>Code</th> </tr> </thead> <tbody> <tr> <td>/</td> <td>LEPP, RONALD E</td> <td>04/01/2025</td> <td>125,000</td> <td>YES</td> </tr> <tr> <td>2532/465</td> <td>KING, CATHY J</td> <td>02/25/2016</td> <td>81,000</td> <td>YES</td> </tr> <tr> <td>1036/651</td> <td>CONKINS, ROBERT L</td> <td>09/20/1996</td> <td>45,000</td> <td>Yes</td> </tr> </tbody> </table>					Bk/Pg	Grantor	Date	Price	Code	/	LEPP, RONALD E	04/01/2025	125,000	YES	2532/465	KING, CATHY J	02/25/2016	81,000	YES	1036/651	CONKINS, ROBERT L	09/20/1996	45,000	Yes																																																																													
Code	Type	Active	Maximum	Exemption																																																																																																																					
H	Homestead	No	1,000																																																																																																																						
H	Homestead	No	1,000																																																																																																																						
Bk/Pg	Grantor	Date	Price	Code																																																																																																																					
/	LEPP, RONALD E	04/01/2025	125,000	YES																																																																																																																					
2532/465	KING, CATHY J	02/25/2016	81,000	YES																																																																																																																					
1036/651	CONKINS, ROBERT L	09/20/1996	45,000	Yes																																																																																																																					
<b>Parcel Valuation</b> <table border="1"> <thead> <tr> <th>Source</th> <th>REAL</th> <th>Fair Cash</th> <th>Capped</th> <th>Asmnt Level</th> <th>Assessed</th> <th>Levy Rate</th> <th>92.430</th> <th>Current Tax</th> </tr> </thead> <tbody> <tr> <td>Remove Cap</td> <td>2026</td> <td>Land Value 47,908</td> <td>47,908</td> <td>11%</td> <td>5,270</td> <td>Assessed</td> <td>13,750</td> <td>1,270.91</td> </tr> <tr> <td>Year Frozen</td> <td>0</td> <td>Improvements 77,092</td> <td>77,092</td> <td> </td> <td>8,480</td> <td>Penalty</td> <td>0</td> <td> </td> </tr> <tr> <td>Uncapped Value</td> <td>0</td> <td>Mobile Home 0</td> <td>0</td> <td> </td> <td>0</td> <td>Exemption</td> <td>0</td> <td>0.00</td> </tr> <tr> <td>TIF Project ID</td> <td>0</td> <td>Total Value 125,000</td> <td>125,000</td> <td> </td> <td>13,750</td> <td>Total Taxable</td> <td>13,750</td> <td>1,271.00</td> </tr> </tbody> </table>										Source	REAL	Fair Cash	Capped	Asmnt Level	Assessed	Levy Rate	92.430	Current Tax	Remove Cap	2026	Land Value 47,908	47,908	11%	5,270	Assessed	13,750	1,270.91	Year Frozen	0	Improvements 77,092	77,092		8,480	Penalty	0		Uncapped Value	0	Mobile Home 0	0		0	Exemption	0	0.00	TIF Project ID	0	Total Value 125,000	125,000		13,750	Total Taxable	13,750	1,271.00																																																																			
Source	REAL	Fair Cash	Capped	Asmnt Level	Assessed	Levy Rate	92.430	Current Tax																																																																																																																	
Remove Cap	2026	Land Value 47,908	47,908	11%	5,270	Assessed	13,750	1,270.91																																																																																																																	
Year Frozen	0	Improvements 77,092	77,092		8,480	Penalty	0																																																																																																																		
Uncapped Value	0	Mobile Home 0	0		0	Exemption	0	0.00																																																																																																																	
TIF Project ID	0	Total Value 125,000	125,000		13,750	Total Taxable	13,750	1,271.00																																																																																																																	
<b>Assessment History</b> <table border="1"> <thead> <tr> <th>Tax Year</th> <th>Statement Number</th> <th>Billed Owner</th> <th>Tax Area</th> <th>Total Value</th> <th>Exemptions</th> <th>Taxable Value</th> <th>Billed Tax</th> </tr> </thead> <tbody> <tr><td>2025</td><td>2025-660015537</td><td>KNIGHT RENTALS LLC</td><td>17</td><td>111,890</td><td>1000</td><td>8,883</td><td>821.00</td></tr> <tr><td>2024</td><td>2024-660015537</td><td>LEPP, RONALD E</td><td>17</td><td>111,777</td><td>1000</td><td>8,596</td><td>794.00</td></tr> <tr><td>2023</td><td>2023-660015537</td><td>LEPP, RONALD E</td><td>17</td><td>108,823</td><td>1000</td><td>8,316</td><td>762.00</td></tr> <tr><td>2022</td><td>2022-660015537</td><td>LEPP, RONALD E</td><td>17</td><td>89,131</td><td>1000</td><td>8,045</td><td>745.00</td></tr> <tr><td>2021</td><td>2021-660015537</td><td>LEPP, RONALD E</td><td>17</td><td>92,876</td><td>1000</td><td>7,782</td><td>687.00</td></tr> <tr><td>2020</td><td>2020-660015537</td><td>LEPP, RONALD E</td><td>17</td><td>92,460</td><td>1000</td><td>7,526</td><td>689.00</td></tr> <tr><td>2019</td><td>2019-660015537</td><td>LEPP, RONALD E</td><td>17</td><td>75,250</td><td>1000</td><td>7,278</td><td>674.00</td></tr> <tr><td>2018</td><td>2018-660015537</td><td>LEPP, RONALD E</td><td>17</td><td>80,889</td><td>1000</td><td>7,898</td><td>730.00</td></tr> <tr><td>2017</td><td>2017-660015537</td><td>LEPP, RONALD E</td><td>17</td><td>80,248</td><td>1000</td><td>7,827</td><td>719.00</td></tr> <tr><td>2016</td><td>2016-660015537</td><td>LEPP, RONALD E</td><td>17</td><td>65,041</td><td>1000</td><td>6,155</td><td>578.00</td></tr> <tr><td>2015</td><td>2015-660015537</td><td>KING, CATHY J</td><td>17</td><td>63,227</td><td>1000</td><td>5,955</td><td>537.00</td></tr> <tr><td>2014</td><td>2014-660015537</td><td>KING, CATHY J</td><td>17</td><td>65,316</td><td>1000</td><td>6,185</td><td>574.00</td></tr> <tr><td>2013</td><td>2013-660015537</td><td>KING, CATHY J</td><td>17</td><td>64,306</td><td>1000</td><td>6,074</td><td>556.00</td></tr> </tbody> </table>										Tax Year	Statement Number	Billed Owner	Tax Area	Total Value	Exemptions	Taxable Value	Billed Tax	2025	2025-660015537	KNIGHT RENTALS LLC	17	111,890	1000	8,883	821.00	2024	2024-660015537	LEPP, RONALD E	17	111,777	1000	8,596	794.00	2023	2023-660015537	LEPP, RONALD E	17	108,823	1000	8,316	762.00	2022	2022-660015537	LEPP, RONALD E	17	89,131	1000	8,045	745.00	2021	2021-660015537	LEPP, RONALD E	17	92,876	1000	7,782	687.00	2020	2020-660015537	LEPP, RONALD E	17	92,460	1000	7,526	689.00	2019	2019-660015537	LEPP, RONALD E	17	75,250	1000	7,278	674.00	2018	2018-660015537	LEPP, RONALD E	17	80,889	1000	7,898	730.00	2017	2017-660015537	LEPP, RONALD E	17	80,248	1000	7,827	719.00	2016	2016-660015537	LEPP, RONALD E	17	65,041	1000	6,155	578.00	2015	2015-660015537	KING, CATHY J	17	63,227	1000	5,955	537.00	2014	2014-660015537	KING, CATHY J	17	65,316	1000	6,185	574.00	2013	2013-660015537	KING, CATHY J	17	64,306	1000	6,074	556.00
Tax Year	Statement Number	Billed Owner	Tax Area	Total Value	Exemptions	Taxable Value	Billed Tax																																																																																																																		
2025	2025-660015537	KNIGHT RENTALS LLC	17	111,890	1000	8,883	821.00																																																																																																																		
2024	2024-660015537	LEPP, RONALD E	17	111,777	1000	8,596	794.00																																																																																																																		
2023	2023-660015537	LEPP, RONALD E	17	108,823	1000	8,316	762.00																																																																																																																		
2022	2022-660015537	LEPP, RONALD E	17	89,131	1000	8,045	745.00																																																																																																																		
2021	2021-660015537	LEPP, RONALD E	17	92,876	1000	7,782	687.00																																																																																																																		
2020	2020-660015537	LEPP, RONALD E	17	92,460	1000	7,526	689.00																																																																																																																		
2019	2019-660015537	LEPP, RONALD E	17	75,250	1000	7,278	674.00																																																																																																																		
2018	2018-660015537	LEPP, RONALD E	17	80,889	1000	7,898	730.00																																																																																																																		
2017	2017-660015537	LEPP, RONALD E	17	80,248	1000	7,827	719.00																																																																																																																		
2016	2016-660015537	LEPP, RONALD E	17	65,041	1000	6,155	578.00																																																																																																																		
2015	2015-660015537	KING, CATHY J	17	63,227	1000	5,955	537.00																																																																																																																		
2014	2014-660015537	KING, CATHY J	17	65,316	1000	6,185	574.00																																																																																																																		
2013	2013-660015537	KING, CATHY J	17	64,306	1000	6,074	556.00																																																																																																																		



# Rogers

## Assessment Property Record Card for Tax Year 2026

Data provided by LISA DELOZIER County Assessor

Date 04/16/2026  
Time 23:19:29  
Page 2

Lot Data	Square-Foot - NBHD 1161 #1	Primary Image
Lot Size		
Lot Count	1	
Units Buildable	1	
Non-Ag Acres	0.1903	
Topography		
Street Access		
Utilities		
Amenities	LAND QUALITY	
	0	
	0	
Method	Square-Foot	
Base Lot Value	8,291.00 x 5.50 = 45,601	
Factor Value		
Adjustments	1.0506	
Lot Value	47,908	

Residential Data	
Type	1 Single Family Residence
Condition	3 - Average
Quality	2 - Fair
Architecture	
Style	100% One Story
Exterior Wall	100% Veneer, Masonry
Base/Total Area	941 / 941
Style	100% One Story
HVAC	100% Warmed & Cooled Air
Roof Cover	1 Composition Shingle
Area on Slab	941
Fixture/RghIn	4 /
Bed/F/H Bath	3 / 1.0 /
Basement Area	
Garage Type	486 Attached Garage - Unfinished
Remodel	KITCHEN/BA -
Year/Eff Age	1972 / 33



\\tsclient\T\LOGAN\LOGAN RESIDENTIAL VI\2023-8-22\IMG\_003I 8/22/2023

GRM Approach	
GRM Code	
Gross Rent	0.00
Indicated Value	

Multiple Regression			
MRA Code	1	Test	
Adjusted R	0.8445		
Indicated Value	109,054	115.89	Per SqFt

Direct Comparables			
Selection Model	A	Adam Test	
Adjustment Model	1	2022 Residential	
Comparables	8		
Indicated Value	133,450		Per SqFt

Cost Approach				Manual : 01/2025			
Base Cost	107.28	Total Misc Impr	+	8,977			
Roofing Adj	+ 4.39	Garage Cost	+	11,402			
Subfloor Adj	+ 0.00	Total RCN	=	140,168			
Heat/Cool Adj	+ 10.30	Depreciation ( 45%)	-	63,076			
Plumbing Adj	+ 5.33	Lump Sums	+	0			
Basement Adj	+ 0.00	RCNLD	=	77,092			
Adj Base Cost	= 127.30	Lot Value	+	47,908			
Total Area	x 941	Indicated Value	=	125,000			
Adjusted Cost	= 119,789	Value Per SqFt		132.84			

Value Reconciliation			
Selected Approach	Cost Approach		
Improvements	77,092		
Lot Value	47,908		
Indicated Value	125,000	132.84	Per SqFt
Agland Value			
Site Improvements			
Total Value	125,000	132.84	Total Value Per SqFt

Miscellaneous Improvements								
Code	Description	Sketch ID	Size	Year	Units	Unit Cost	Depr	Value
PRCH	SLAB PORCH - COVERED	37465	8x4		32	21.19		678
PRCH	SLAB PORCH - COVERED	37466	32x10		320	20.32		6,502
PATO	SLAB PORCH - OPEN	142507	27x7		189	9.51		1,797



# Rogers

## Assessment Property Record Card for Tax Year 2026

Data provided by LISA DELOZIER County Assessor

Date 04/16/2026  
 Time 23:19:29  
 Page 3

### Sketch Image

660015537

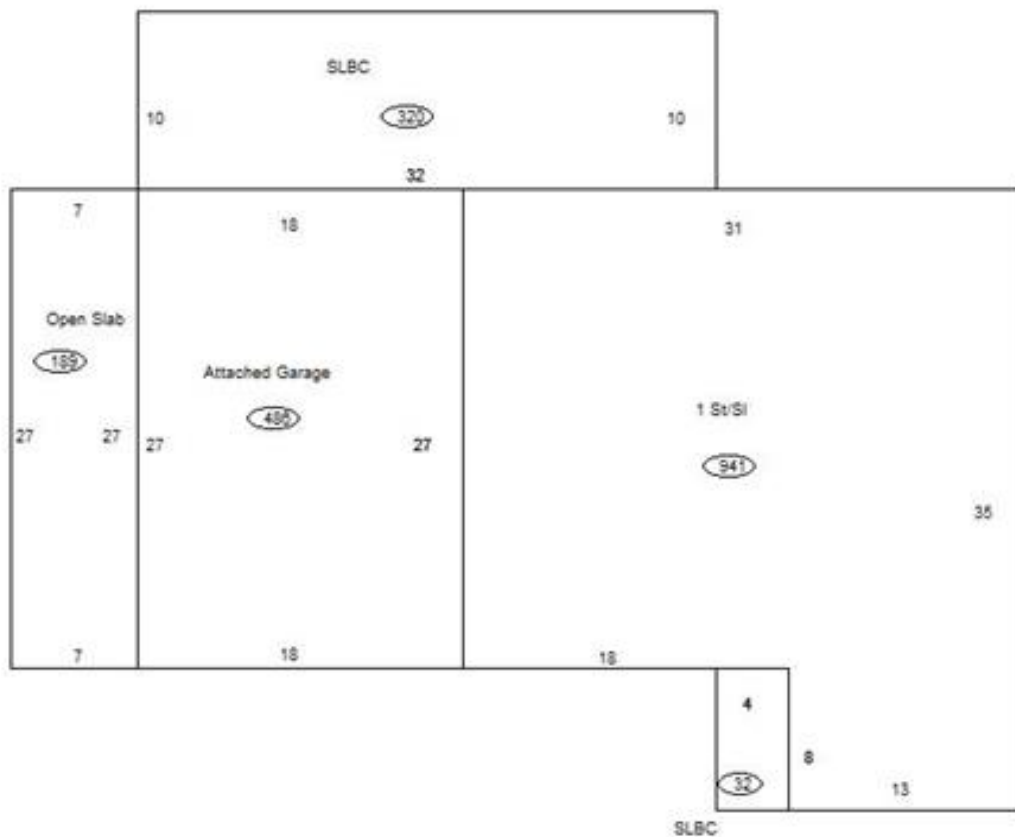

### Sketch Vector Information

Sequence	Code	Type	Built Over	Scale	Section Label	Base Area	Multiplier	Total Area
1	R	1	Slab	10	1 St/SI	941	1.000	941
2	G	1		10	Attached Garage	486	1.000	486
3	M	PRCH		10	SLBC	32	1.000	32
4	M	PRCH		10	SLBC	320	1.000	320
5	M	PATO		10	Open Slab	189	1.000	189
<b>Total Building Area</b>						<b>941</b>		<b>941</b>



# Rogers

## Assessment Property Record Card for Tax Year 2026

Data provided by LISA DELOZIER County Assessor

Date 04/16/2026  
Time 23:19:29  
Page 4

660015537

### Outbuildings/Site Improvements

Building Image	Code	Description	Dimensions	Floor	Roofing	Total Units
	STF	STG FAIR	0x0x0			
	Qual	2	Cond	Year	Eff Age	
<b>Valuation Summary</b>			<b>Modifier Total</b>	<b>RCN</b>	<b>Depr (100% Phys/ % Func)</b>	<b>RCNLD</b>
		Base Cost (4.68 x )				