



Rogers

Assessment Property Record Card for Tax Year 2026

Data provided by LISA DELOZIER County Assessor

Date 04/16/2026
Time 22:58:20
Page 1

Assessment Data					Primary Image																																																																																																																				
Account 660015692 Parcel ID 22N16E-16-3-00000-000-0000 Cadastral ID 16-22-16-02300 Property Type REAL - Real Property Property Class RA VI Area 1 Tax Area 10 - OOLOGAH RURAL/NW FIRE Name ID 280145 PARK, BRIAN M 15741 S 4150 RD CLAREMORE OK 74017-0000 Parcel Location Situs 15741 S 4150 RD Subdivision Lot/Block / Parcel Size 10 - Acres Sec/Twn/Rng 16 / 22 / 16 / 3 Neighborhood 6050 - UNPLATTED School District S004 - OOLOGAH SCHOOLS					 <p>\\tsclient\C\Users\rln\Pictures\2019-03-14\IMG_0039.JPG 3/15/2019</p>																																																																																																																				
Legal Description Lat/Long: 36.38302848 -95.61266626 N 330' SW SW																																																																																																																									
Exemptions <table border="1"> <thead> <tr> <th>Code</th> <th>Type</th> <th>Active</th> <th>Maximum</th> <th>Exemption</th> </tr> </thead> <tbody> <tr> <td>H</td> <td>Homestead</td> <td>Yes</td> <td>1,000</td> <td>1,000</td> </tr> </tbody> </table>					Code	Type	Active	Maximum	Exemption	H	Homestead	Yes	1,000	1,000	Building Permits <table border="1"> <thead> <tr> <th>Number</th> <th>Description</th> <th>Opened</th> <th>Closed</th> <th>Amount</th> </tr> </thead> <tbody> <tr> <td colspan="5" style="height: 100px;"> </td> </tr> </tbody> </table>					Number	Description	Opened	Closed	Amount																																																																																																	
Code	Type	Active	Maximum	Exemption																																																																																																																					
H	Homestead	Yes	1,000	1,000																																																																																																																					
Number	Description	Opened	Closed	Amount																																																																																																																					
Parcel Valuation <table border="1"> <thead> <tr> <th>Source</th> <th>REAL</th> <th>Fair Cash</th> <th>Capped</th> <th>Asmnt Level</th> <th>Assessed</th> <th>Levy Rate</th> <th>108.182</th> <th>Current Tax</th> </tr> </thead> <tbody> <tr> <td>Remove Cap</td> <td>2003</td> <td>Land Value 1,080</td> <td>1,080</td> <td>11%</td> <td>119</td> <td>Assessed</td> <td>12,732</td> <td>1,377.37</td> </tr> <tr> <td>Year Frozen</td> <td>0</td> <td>Improvements 115,873</td> <td>114,665</td> <td></td> <td>12,613</td> <td>Penalty</td> <td>0</td> <td></td> </tr> <tr> <td>Uncapped Value</td> <td>0</td> <td>Mobile Home 0</td> <td>0</td> <td></td> <td>0</td> <td>Exemption</td> <td>1,000</td> <td>-94.00</td> </tr> <tr> <td>TIF Project ID</td> <td>0</td> <td>Total Value 116,953</td> <td>115,745</td> <td></td> <td>12,732</td> <td>Total Taxable</td> <td>11,732</td> <td>1,283.00</td> </tr> </tbody> </table>					Source	REAL	Fair Cash	Capped	Asmnt Level	Assessed	Levy Rate	108.182	Current Tax	Remove Cap	2003	Land Value 1,080	1,080	11%	119	Assessed	12,732	1,377.37	Year Frozen	0	Improvements 115,873	114,665		12,613	Penalty	0		Uncapped Value	0	Mobile Home 0	0		0	Exemption	1,000	-94.00	TIF Project ID	0	Total Value 116,953	115,745		12,732	Total Taxable	11,732	1,283.00	Sale History <table border="1"> <thead> <tr> <th>Bk/Pg</th> <th>Grantor</th> <th>Date</th> <th>Price</th> <th>Code</th> </tr> </thead> <tbody> <tr> <td>1387/794</td> <td>HORNER, DEWEY M</td> <td>06/26/2002</td> <td>125,000</td> <td>YES</td> </tr> </tbody> </table>					Bk/Pg	Grantor	Date	Price	Code	1387/794	HORNER, DEWEY M	06/26/2002	125,000	YES																																																									
Source	REAL	Fair Cash	Capped	Asmnt Level	Assessed	Levy Rate	108.182	Current Tax																																																																																																																	
Remove Cap	2003	Land Value 1,080	1,080	11%	119	Assessed	12,732	1,377.37																																																																																																																	
Year Frozen	0	Improvements 115,873	114,665		12,613	Penalty	0																																																																																																																		
Uncapped Value	0	Mobile Home 0	0		0	Exemption	1,000	-94.00																																																																																																																	
TIF Project ID	0	Total Value 116,953	115,745		12,732	Total Taxable	11,732	1,283.00																																																																																																																	
Bk/Pg	Grantor	Date	Price	Code																																																																																																																					
1387/794	HORNER, DEWEY M	06/26/2002	125,000	YES																																																																																																																					
Assessment History <table border="1"> <thead> <tr> <th>Tax Year</th> <th>Statement Number</th> <th>Billed Owner</th> <th>Tax Area</th> <th>Total Value</th> <th>Exemptions</th> <th>Taxable Value</th> <th>Billed Tax</th> </tr> </thead> <tbody> <tr><td>2025</td><td>2025-660015692</td><td>PARK, BRIAN M</td><td>10</td><td>112,374</td><td>1000</td><td>11,361</td><td>1,243.00</td></tr> <tr><td>2024</td><td>2024-660015692</td><td>PARK, BRIAN M</td><td>10</td><td>120,291</td><td>1000</td><td>11,410</td><td>1,209.00</td></tr> <tr><td>2023</td><td>2023-660015692</td><td>PARK, BRIAN M</td><td>10</td><td>109,531</td><td>1000</td><td>11,049</td><td>1,163.00</td></tr> <tr><td>2022</td><td>2022-660015692</td><td>PARK, BRIAN M</td><td>10</td><td>110,595</td><td>1000</td><td>11,166</td><td>1,169.00</td></tr> <tr><td>2021</td><td>2021-660015692</td><td>PARK, BRIAN M</td><td>10</td><td>115,679</td><td>1000</td><td>11,725</td><td>1,236.00</td></tr> <tr><td>2020</td><td>2020-660015692</td><td>PARK, BRIAN M</td><td>10</td><td>114,935</td><td>1000</td><td>11,535</td><td>1,234.00</td></tr> <tr><td>2019</td><td>2019-660015692</td><td>PARK, BRIAN M</td><td>10</td><td>110,636</td><td>1000</td><td>11,170</td><td>1,174.00</td></tr> <tr><td>2018</td><td>2018-660015692</td><td>PARK, BRIAN M</td><td>10</td><td>117,011</td><td>1000</td><td>11,609</td><td>1,260.00</td></tr> <tr><td>2017</td><td>2017-660015692</td><td>PARK, BRIAN M</td><td>10</td><td>115,870</td><td>1000</td><td>11,242</td><td>1,291.00</td></tr> <tr><td>2016</td><td>2016-660015692</td><td>PARK, BRIAN M</td><td>10</td><td>112,333</td><td>1000</td><td>10,886</td><td>1,141.00</td></tr> <tr><td>2015</td><td>2015-660015692</td><td>PARK, BRIAN M</td><td>10</td><td>110,111</td><td>1000</td><td>10,539</td><td>1,046.00</td></tr> <tr><td>2014</td><td>2014-660015692</td><td>PARK, BRIAN M</td><td>10</td><td>112,445</td><td>1000</td><td>10,203</td><td>1,010.00</td></tr> <tr><td>2013</td><td>2013-660015692</td><td>PARK, BRIAN M</td><td>10</td><td>107,173</td><td>1000</td><td>9,877</td><td>946.00</td></tr> </tbody> </table>										Tax Year	Statement Number	Billed Owner	Tax Area	Total Value	Exemptions	Taxable Value	Billed Tax	2025	2025-660015692	PARK, BRIAN M	10	112,374	1000	11,361	1,243.00	2024	2024-660015692	PARK, BRIAN M	10	120,291	1000	11,410	1,209.00	2023	2023-660015692	PARK, BRIAN M	10	109,531	1000	11,049	1,163.00	2022	2022-660015692	PARK, BRIAN M	10	110,595	1000	11,166	1,169.00	2021	2021-660015692	PARK, BRIAN M	10	115,679	1000	11,725	1,236.00	2020	2020-660015692	PARK, BRIAN M	10	114,935	1000	11,535	1,234.00	2019	2019-660015692	PARK, BRIAN M	10	110,636	1000	11,170	1,174.00	2018	2018-660015692	PARK, BRIAN M	10	117,011	1000	11,609	1,260.00	2017	2017-660015692	PARK, BRIAN M	10	115,870	1000	11,242	1,291.00	2016	2016-660015692	PARK, BRIAN M	10	112,333	1000	10,886	1,141.00	2015	2015-660015692	PARK, BRIAN M	10	110,111	1000	10,539	1,046.00	2014	2014-660015692	PARK, BRIAN M	10	112,445	1000	10,203	1,010.00	2013	2013-660015692	PARK, BRIAN M	10	107,173	1000	9,877	946.00
Tax Year	Statement Number	Billed Owner	Tax Area	Total Value	Exemptions	Taxable Value	Billed Tax																																																																																																																		
2025	2025-660015692	PARK, BRIAN M	10	112,374	1000	11,361	1,243.00																																																																																																																		
2024	2024-660015692	PARK, BRIAN M	10	120,291	1000	11,410	1,209.00																																																																																																																		
2023	2023-660015692	PARK, BRIAN M	10	109,531	1000	11,049	1,163.00																																																																																																																		
2022	2022-660015692	PARK, BRIAN M	10	110,595	1000	11,166	1,169.00																																																																																																																		
2021	2021-660015692	PARK, BRIAN M	10	115,679	1000	11,725	1,236.00																																																																																																																		
2020	2020-660015692	PARK, BRIAN M	10	114,935	1000	11,535	1,234.00																																																																																																																		
2019	2019-660015692	PARK, BRIAN M	10	110,636	1000	11,170	1,174.00																																																																																																																		
2018	2018-660015692	PARK, BRIAN M	10	117,011	1000	11,609	1,260.00																																																																																																																		
2017	2017-660015692	PARK, BRIAN M	10	115,870	1000	11,242	1,291.00																																																																																																																		
2016	2016-660015692	PARK, BRIAN M	10	112,333	1000	10,886	1,141.00																																																																																																																		
2015	2015-660015692	PARK, BRIAN M	10	110,111	1000	10,539	1,046.00																																																																																																																		
2014	2014-660015692	PARK, BRIAN M	10	112,445	1000	10,203	1,010.00																																																																																																																		
2013	2013-660015692	PARK, BRIAN M	10	107,173	1000	9,877	946.00																																																																																																																		



Rogers

Assessment Property Record Card for Tax Year 2026

Data provided by LISA DELOZIER County Assessor

Date 04/16/2026

Time 22:58:20

Page 3

Sketch Image

660015692

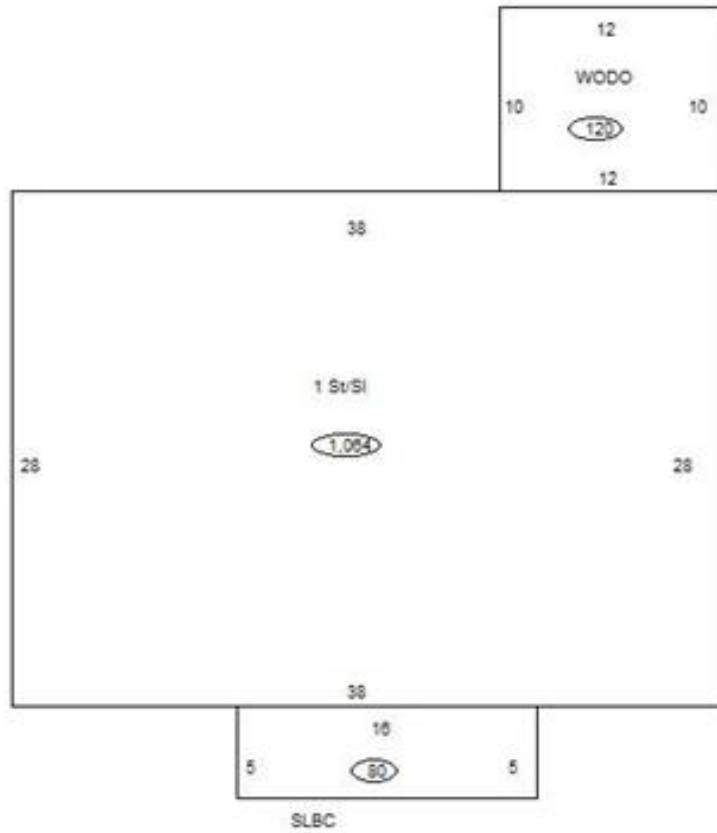

Sketch Vector Information

Sequence	Code	Type	Built Over	Scale	Section Label	Base Area	Multiplier	Total Area
1	R	1	Slab	10	1 St/SI	1,064	1.000	1,064
2	M	PRCH		10	SLBC	80	1.000	80
3	M	WODO		10	WODO	120	1.000	120
Total Building Area						1,064		1,064



Rogers

Assessment Property Record Card for Tax Year 2026

Data provided by LISA DELOZIER County Assessor

Date 04/16/2026
Time 22:58:21
Page 4

Lot Data		Primary Image						
Lot Size	-	 <p>\\tsclient\C\Users\rln\Pictures\2019-03-14\IMG_0039.JPG 3/15/2019</p>						
Lot Count								
Units Buildable								
Non-Ag Acres	0							
Topography								
Street Access								
Utilities								
Amenities	LAND QUALITY							
Method								
Base Lot Value								
Factor Value								
Adjustments								
Lot Value								
Residential Data								
Type	1 Single Family Residence							
Condition	2 - Fair							
Quality	2 - Fair							
Architecture								
Style	100% 1 1/2 Story Finished							
Exterior Wall	100% Frame, Siding, Wood							
Base/Total Area	896 / 1,280							
Style	100% 1 1/2 Story Finished							
HVAC	100% Wall Furnace							
Roof Cover	1 Composition Shingle							
Area on Slab	0							
Fixture/RghIn	11 /							
Bed/F/H Bath	2 / 2.0 /							
Basement Area								
Garage Type								
Remodel								
Year/Eff Age	1989 / 37							
Cost Approach		Manual : 01/2025						
Base Cost	79.30	Total Misc Impr	+ 4,999					
Roofing Adj	+ 3.06	Garage Cost	+					
Subfloor Adj	+ 1.73	Total RCN	= 126,253					
Heat/Cool Adj	+ 0.76	Depreciation (48%)	- 60,601					
Plumbing Adj	+ 9.88	Lump Sums	+ 0					
Basement Adj	+ 0.00	RCNLD	= 65,652					
Adj Base Cost	= 94.73	Lot Value	+					
Total Area	x 1,280	Indicated Value	= 65,652					
Adjusted Cost	= 121,254	Value Per SqFt	51.29					
Miscellaneous Improvements								
Code	Description	Sketch ID	Size	Year	Units	Unit Cost	Depr	Value
PRCH	SLAB PORCH - COVERED	37861	20x6		120	20.92		2,510
PRCH	SLAB PORCH - COVERED	37862	17x7		119	20.92		2,489

\\tsclient\C\Users\rln\Pictures\2019-03-14\IMG_0039.JPG 3/15/2019

GRM Approach

GRM Code	
Gross Rent	0.00
Indicated Value	

Multiple Regression

MRA Code	
Adjusted R	
Indicated Value	

Direct Comparables

Selection Model	1 Res
Adjustment Model	A2 AO Test
Comparables	
Indicated Value	

Value Reconciliation

Selected Approach	Cost Approach		
Improvements	65,652		
Lot Value			
Indicated Value	65,652	51.29	Per SqFt
Agland Value			
Site Improvements	1,381		
Total Value	67,033	52.37	Total Value Per SqFt



Rogers

Assessment Property Record Card for Tax Year 2026

Data provided by LISA DELOZIER County Assessor

Date 04/16/2026
 Time 22:58:21
 Page 5

Sketch Image

660015692

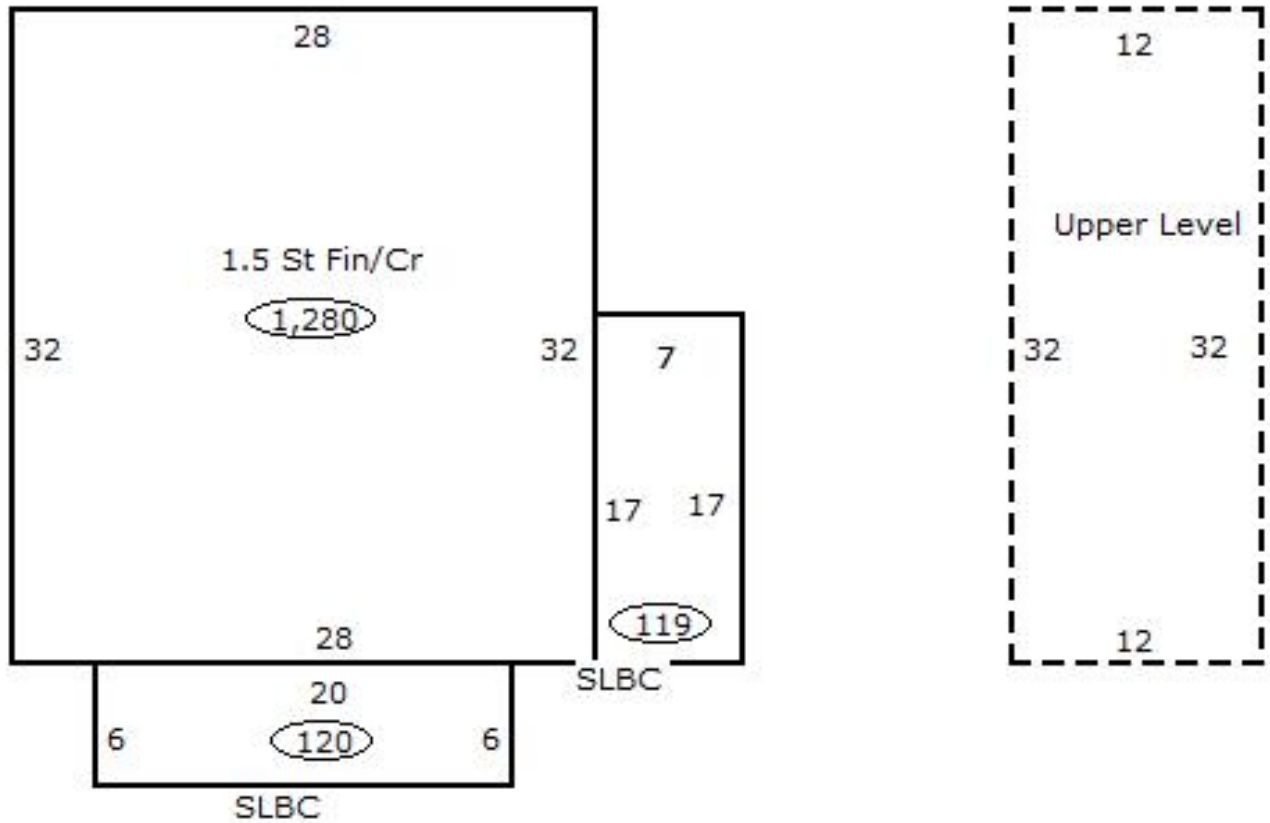

Sketch Vector Information

Sequence	Code	Type	Built Over	Scale	Section Label	Base Area	Multiplier	Total Area
1	R	5	Crawl	13	1.5 St Fin/Cr	896	1.429	1,280
2	M	PRCH		13	SLBC	120	1.000	120
3	M	PRCH		13	SLBC	119	1.000	119
4	U	^UL	Overhang	13	Upper Level	384	1.000	384
Total Building Area						896		1,280



Rogers

Assessment Property Record Card for Tax Year 2026

Data provided by LISA DELOZIER County Assessor

Date 04/16/2026
Time 22:58:21
Page 6

660015692

Outbuildings/Site Improvements

Building Image	Code	Description	Dimensions	Floor	Roofing	Total Units	
	STF	STG FAIR	0x0x0			360	
	Qual	2	Cond 3	Year	Eff Age		
	Valuation Summary		Modifier Total	RCN	Depr (50% Phys/ % Func)	RCNLD	
	Base Cost (4.68 x 360)		1,685		1,685	843	842
	STF	STG FAIR	0x0x0			288	
	Qual	2	Cond 3	Year	Eff Age		
	Valuation Summary		Modifier Total	RCN	Depr (60% Phys/ % Func)	RCNLD	
	Base Cost (4.68 x 288)		1,348		1,348	809	539
	STF	STG FAIR	0x0x0				
	Qual	2	Cond	Year	Eff Age		
	Valuation Summary		Modifier Total	RCN	Depr (100% Phys/ % Func)	RCNLD	
	Base Cost (4.68 x)						
	STF	STG FAIR	0x0x0				
	Qual	2	Cond	Year	Eff Age		
	Valuation Summary		Modifier Total	RCN	Depr (100% Phys/ % Func)	RCNLD	
	Base Cost (4.68 x)						



Rogers

Assessment Property Record Card for Tax Year 2026

Data provided by LISA DELOZIER County Assessor

Date 04/16/2026
Time 22:58:21
Page 7

Agland Inventory

660015692

Soi	Description	Land Use	LPI	Adj Type	Adj Code	Acres	Use/Acre	Mkt/Acre	Use Value	Market Value
DBC	DENNIS-BATES COMPLEX 2-5%	TMBR	60			10.000	108	108	1,080	1,080
TMBR Totals						10.000			1,080	1,080
Total Agland						10.000			1,080	1,080