



# Rogers

## Assessment Property Record Card for Tax Year 2026

Data provided by LISA DELOZIER County Assessor

Date 04/16/2026  
Time 23:16:37  
Page 1

Assessment Data					Primary Image																																																	
<b>Account</b> 660015973 <b>Parcel ID</b> 000000-00-0-10035-002-0012 <b>Cadastral ID</b> 17-21-16-00180 <b>Property Type</b> REAL - Real Property <b>Property Class</b> URP VI Area 1 <b>Tax Area</b> 17 - CLAREMORE OT <b>Name ID</b> 347984 BATES, ISAAC ALEXANDER JR & ISABELLE ROSE  1408 W BERT ST CLAREMORE OK 74017-0000  <b>Parcel Location</b> <b>Situs</b> 01408 BERT <b>Subdivision</b> BERT HALL <b>Lot/Block</b> 0012 / 0002 <b>Parcel Size</b> 1 - Lots <b>Sec/Twn/Rng</b> 17 / 21 / 16 / 5 <b>Neighborhood</b> 1177 - R-V01-SW CLAREMORE <b>School District</b> S001 - CLAREMORE SCHOOLS					<p>\\tsclient\A\TOMMY DUNLAP\New folder (261)\IMG_0031.JPG 9/6/2023</p>																																																	
<b>Legal Description</b> Lot/Long: 36.30677439 -95.62716937																																																						
<b>Building Permits</b>					<table border="1"> <thead> <tr> <th>Number</th> <th>Description</th> <th>Opened</th> <th>Closed</th> <th>Amount</th> </tr> </thead> <tbody> <tr> <td colspan="5" style="height: 100px;"> </td> </tr> </tbody> </table>					Number	Description	Opened	Closed	Amount																																								
Number	Description	Opened	Closed	Amount																																																		
<b>Exemptions</b>					<b>Sale History</b>																																																	
<b>Code</b>	<b>Type</b>	<b>Active</b>	<b>Maximum</b>	<b>Exemption</b>	<b>Bk/Pg</b>	<b>Grantor</b>	<b>Date</b>	<b>Price</b>	<b>Code</b>																																													
H	Homestead	No	1,000		/	KEEVER, ANDREW	08/28/2025	200,000	YES																																													
					/	BOYD, GARY A & SANDY	12/18/2020	150,000	YES																																													
					1205/702	PAYNE, JIM BOB	12/10/1999	77,000	Yes																																													
					978/603	BINKLEY, GEORGE W &	01/06/1995	0	No																																													
<b>Parcel Valuation</b>					<table border="1"> <thead> <tr> <th>Source</th> <th>REAL</th> <th>Fair Cash</th> <th>Capped</th> <th>Asmnt Level</th> <th>Assessed</th> <th>Levy Rate</th> <th>92.430</th> <th>Current Tax</th> </tr> </thead> <tbody> <tr> <td>Remove Cap</td> <td>2026</td> <td>Land Value 63,220</td> <td>63,220</td> <td>11%</td> <td>6,954</td> <td>Assessed</td> <td>22,000</td> <td>2,033.46</td> </tr> <tr> <td>Year Frozen</td> <td>2020</td> <td>Improvements 136,781</td> <td>136,781</td> <td></td> <td>15,046</td> <td>Penalty</td> <td>0</td> <td></td> </tr> <tr> <td>Uncapped Value</td> <td>0</td> <td>Mobile Home 0</td> <td>0</td> <td></td> <td>0</td> <td>Exemption</td> <td>0</td> <td>0.00</td> </tr> <tr> <td>TIF Project ID</td> <td>0</td> <td>Total Value 200,001</td> <td>200,001</td> <td></td> <td>22,000</td> <td>Total Taxable</td> <td>22,000</td> <td>2,033.00</td> </tr> </tbody> </table>					Source	REAL	Fair Cash	Capped	Asmnt Level	Assessed	Levy Rate	92.430	Current Tax	Remove Cap	2026	Land Value 63,220	63,220	11%	6,954	Assessed	22,000	2,033.46	Year Frozen	2020	Improvements 136,781	136,781		15,046	Penalty	0		Uncapped Value	0	Mobile Home 0	0		0	Exemption	0	0.00	TIF Project ID	0	Total Value 200,001	200,001		22,000	Total Taxable	22,000	2,033.00
Source	REAL	Fair Cash	Capped	Asmnt Level	Assessed	Levy Rate	92.430	Current Tax																																														
Remove Cap	2026	Land Value 63,220	63,220	11%	6,954	Assessed	22,000	2,033.46																																														
Year Frozen	2020	Improvements 136,781	136,781		15,046	Penalty	0																																															
Uncapped Value	0	Mobile Home 0	0		0	Exemption	0	0.00																																														
TIF Project ID	0	Total Value 200,001	200,001		22,000	Total Taxable	22,000	2,033.00																																														
<b>Assessment History</b>																																																						
Tax Year	Statement Number	Billed Owner	Tax Area	Total Value	Exemptions	Taxable Value	Billed Tax																																															
2025	2025-660015973	BATES, ISAAC ALEXANDER JR &	17	169,298	0	18,192	1,681.00																																															
2024	2024-660015973	KEEVER, ANDREW	17	172,843	0	17,326	1,601.00																																															
2023	2023-660015973	KEEVER, ANDREW	17	150,000	0	16,500	1,511.00																																															
2022	2022-660015973	KEEVER, ANDREW	17	153,209	0	16,853	1,560.00																																															
2021	2021-660015973	KEEVER, ANDREW	17	148,254	0	16,308	1,440.00																																															
2020	2020-660015973	BOYD, GARY A & SANDY	17	93,493	1000	8,605	788.00																																															
2019	2019-660015973	BOYD, GARY A & SANDY	17	84,773	1000	8,325	771.00																																															
2018	2018-660015973	BOYD, GARY A & SANDY	17	89,814	1000	8,880	821.00																																															
2017	2017-660015973	BOYD, GARY A & SANDY	17	89,131	1000	8,804	809.00																																															
2016	2016-660015973	BOYD, GARY A & SANDY	17	90,163	1000	8,918	837.00																																															
2015	2015-660015973	BOYD, GARY A & SANDY	17	88,239	1000	8,706	785.00																																															
2014	2014-660015973	BOYD, GARY A & SANDY	17	91,004	1000	8,532	791.00																																															
2013	2013-660015973	BOYD, GARY A & SANDY	17	87,516	1000	8,254	755.00																																															



# Rogers

## Assessment Property Record Card for Tax Year 2026

Data provided by LISA DELOZIER County Assessor

Date 04/16/2026  
Time 23:16:37  
Page 2

Lot Data		Square-Foot - NBHD 1177 #1		Primary Image	
Lot Size					
Lot Count					
Units Buildable	1				
Non-Ag Acres	0.2972				
Topography					
Street Access					
Utilities					
Amenities	LAND QUALITY	0	0		
Method	Square-Foot				
Base Lot Value	12,946.00 x 2.83 = 36,592				
Factor Value				\\tsclient\A\TOMMY DUNLAP\New folder (261)\IMG_0031.JPG 9/6/2023	
Adjustments	1.7277			<b>GRM Approach</b>	
Lot Value	63,220			GRM Code Gross Rent 0.00 Indicated Value	
<b>Residential Data</b>				<b>Multiple Regression</b>	
Type	1 Single Family Residence			MRA Code 1 Test Adjusted R 0.8445 Indicated Value 153,646 108.51 Per SqFt	
Condition	3.5 - Average			<b>Direct Comparables</b>	
Quality	2.5 - Fair			Selection Model A Adam Test Adjustment Model 1 2022 Residential Comparables 5 Indicated Value 172,820 Per SqFt	
Architecture				<b>Value Reconciliation</b>	
Style	100% One Story			Selected Approach Cost Approach Improvements 123,643 Lot Value 63,220 Indicated Value 186,863 131.97 Per SqFt Agland Value Site Improvements 13,138 Total Value 200,001 141.24 Total Value Per SqFt	
Exterior Wall	90% Frame, Siding, Vinyl 10% Veneer, Stone				
Base/Total Area	1,416 / 1,416				
Style	100% One Story				
HVAC	100% Warmed & Cooled Air				
Roof Cover	1 Composition Shingle				
Area on Slab	0				
Fixture/RghIn	20 /				
Bed/F/H Bath	4 / 2.0 /				
Basement Area					
Garage Type	440 Attached Garage - Unfinished 2 Stalls				
Remodel	PARTIAL -				
Year/Eff Age	1966 / 28				
<b>Cost Approach</b>		<b>Manual : 01/2025</b>			
Base Cost	96.11	Total Misc Impr	+ 1,739		
Roofing Adj	+ 4.40	Garage Cost	+ 12,487		
Subfloor Adj	+ 1.16	Total RCN	= 199,425		
Heat/Cool Adj	+ 11.47	Depreciation ( 38%)	- 75,782		
Plumbing Adj	+ 17.65	Lump Sums	+ 0		
Basement Adj	+ 0.00	RCNLD	= 123,643		
Adj Base Cost	= 130.79	Lot Value	+ 63,220		
Total Area	x 1,416	Indicated Value	= 186,863		
Adjusted Cost	= 185,199	Value Per SqFt	131.97		

<b>Miscellaneous Improvements</b>								
Code	Description	Sketch ID	Size	Year	Units	Unit Cost	Depr	Value
PRCH	SLAB PORCH - COVERED	38252	8x6		48	24.12		1,158
PRCH	SLAB PORCH - COVERED	38253	6x4		24	24.19		581



# Rogers

## Assessment Property Record Card for Tax Year 2026

Data provided by LISA DELOZIER County Assessor

Date 04/16/2026  
 Time 23:16:37  
 Page 3

### Sketch Image

660015973

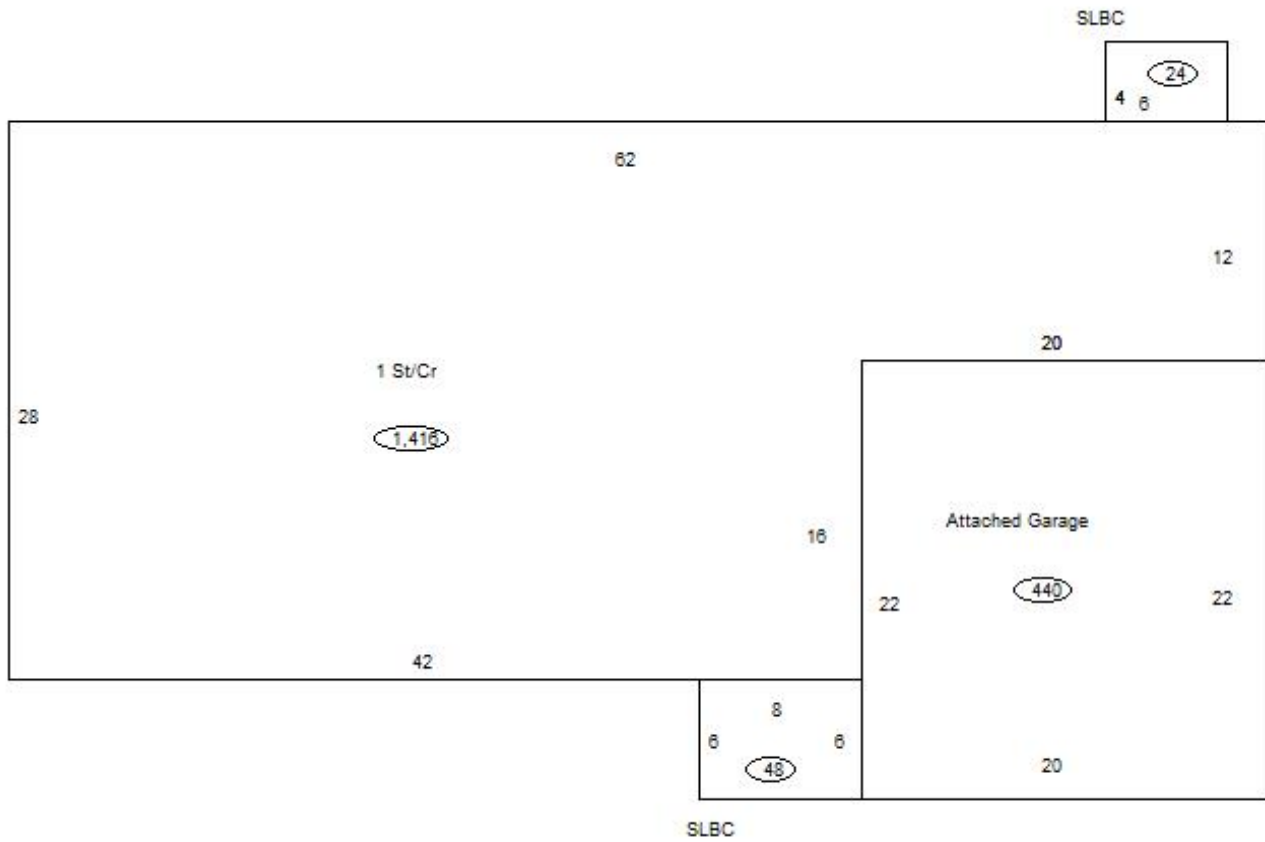

### Sketch Vector Information

Sequence	Code	Type	Built Over	Scale	Section Label	Base Area	Multiplier	Total Area
1	R	1	Crawl	10	1 St/Cr	1,416	1.000	1,416
2	G	1		10	Attached Garage	440	1.000	440
3	M	PRCH		10	SLBC	48	1.000	48
4	M	PRCH		10	SLBC	24	1.000	24
<b>Total Building Area</b>						1,416		1,416



# Rogers

## Assessment Property Record Card for Tax Year 2026

Data provided by LISA DELOZIER County Assessor

Date 04/16/2026  
Time 23:16:37  
Page 4

660015973

### Outbuildings/Site Improvements

Building Image	Code	Description	Dimensions	Floor	Roofing	Total Units
	UTIL	SHOP BUILDING	0x0x0			600
	Qual 2	Cond 3	Year	Eff Age		
<b>Valuation Summary</b>		<b>Modifier Total</b>	<b>RCN</b>	<b>Depr (30% Phys/ % Func)</b>	<b>RCNLD</b>	
Base Cost (31.28 x 600)		18,768	18,768	5,630	13,138	