



Rogers

Assessment Property Record Card for Tax Year 2026

Data provided by LISA DELOZIER County Assessor

Date 04/16/2026
Time 22:34:22
Page 1

Assessment Data					Primary Image																																																																																																																				
Account 660016014 Parcel ID 000000-00-0-10035-006-0011 Cadastral ID 17-21-16-00580 Property Type REAL - Real Property Property Class URP VI Area 1 Tax Area 17 - CLAREMORE OT Name ID 338731 BOURLAND, COLLIN CLINTON 1408 W DANNY ST CLAREMORE OK 74017-0000 Parcel Location Situs 01408 W DANNY ST Subdivision BERT HALL Lot/Block 0011 / 0006 Parcel Size 1 - Lots Sec/Twn/Rng 17 / 21 / 16 / 5 Neighborhood 1177 - R-V01-SW CLAREMORE School District S001 - CLAREMORE SCHOOLS																																																																																																																									
Legal Description Lot/Long: 36.30496070 -95.62758261																																																																																																																									
Building Permits					<table border="1"> <thead> <tr> <th>Number</th> <th>Description</th> <th>Opened</th> <th>Closed</th> <th>Amount</th> </tr> </thead> <tbody> <tr> <td colspan="5"> </td> </tr> </tbody> </table>					Number	Description	Opened	Closed	Amount																																																																																																											
Number	Description	Opened	Closed	Amount																																																																																																																					
Exemptions					Sale History																																																																																																																				
<table border="1"> <thead> <tr> <th>Code</th> <th>Type</th> <th>Active</th> <th>Maximum</th> <th>Exemption</th> </tr> </thead> <tbody> <tr> <td>H</td> <td>Homestead</td> <td>No</td> <td></td> <td></td> </tr> </tbody> </table>					Code	Type	Active	Maximum	Exemption	H	Homestead	No			<table border="1"> <thead> <tr> <th>Bk/Pg</th> <th>Grantor</th> <th>Date</th> <th>Price</th> <th>Code</th> </tr> </thead> <tbody> <tr> <td>/</td> <td>COFFEE, COLLIN G & AUBREY N</td> <td>06/03/2022</td> <td>180,000</td> <td>YES</td> </tr> <tr> <td>/</td> <td>CHEEK, JAMES ALBERT</td> <td>03/08/2021</td> <td>154,000</td> <td>YES</td> </tr> <tr> <td>2698/703</td> <td>GIBMO LLC</td> <td>03/09/2018</td> <td>127,000</td> <td>YES</td> </tr> <tr> <td>2620/293</td> <td>MOBERLY, TRACY L &</td> <td>03/17/2017</td> <td>0</td> <td>4</td> </tr> <tr> <td>2620/291</td> <td>FEDERAL HOME LOAN MTG CORP</td> <td>01/30/2017</td> <td>55,500</td> <td>3</td> </tr> <tr> <td>2584/878</td> <td>SNYDER, GEORGE HENRY &</td> <td>10/05/2016</td> <td>0</td> <td>10</td> </tr> </tbody> </table>					Bk/Pg	Grantor	Date	Price	Code	/	COFFEE, COLLIN G & AUBREY N	06/03/2022	180,000	YES	/	CHEEK, JAMES ALBERT	03/08/2021	154,000	YES	2698/703	GIBMO LLC	03/09/2018	127,000	YES	2620/293	MOBERLY, TRACY L &	03/17/2017	0	4	2620/291	FEDERAL HOME LOAN MTG CORP	01/30/2017	55,500	3	2584/878	SNYDER, GEORGE HENRY &	10/05/2016	0	10																																																																			
Code	Type	Active	Maximum	Exemption																																																																																																																					
H	Homestead	No																																																																																																																							
Bk/Pg	Grantor	Date	Price	Code																																																																																																																					
/	COFFEE, COLLIN G & AUBREY N	06/03/2022	180,000	YES																																																																																																																					
/	CHEEK, JAMES ALBERT	03/08/2021	154,000	YES																																																																																																																					
2698/703	GIBMO LLC	03/09/2018	127,000	YES																																																																																																																					
2620/293	MOBERLY, TRACY L &	03/17/2017	0	4																																																																																																																					
2620/291	FEDERAL HOME LOAN MTG CORP	01/30/2017	55,500	3																																																																																																																					
2584/878	SNYDER, GEORGE HENRY &	10/05/2016	0	10																																																																																																																					
Parcel Valuation																																																																																																																									
<table border="1"> <thead> <tr> <th>Source</th> <th>REAL</th> <th>Fair Cash</th> <th>Capped</th> <th>Asmnt Level</th> <th>Assessed</th> <th>Levy Rate</th> <th>92.430</th> <th>Current Tax</th> </tr> </thead> <tbody> <tr> <td>Remove Cap</td> <td>2023</td> <td>Land Value 63,901</td> <td>63,901</td> <td>11%</td> <td>7,029</td> <td>Assessed</td> <td>19,493</td> <td>1,801.74</td> </tr> <tr> <td>Year Frozen</td> <td>2019</td> <td>Improvements 113,309</td> <td>113,309</td> <td></td> <td>12,464</td> <td>Penalty</td> <td>0</td> <td></td> </tr> <tr> <td>Uncapped Value</td> <td>0</td> <td>Mobile Home 0</td> <td>0</td> <td></td> <td>0</td> <td>Exemption</td> <td>0</td> <td>0.00</td> </tr> <tr> <td>TIF Project ID</td> <td>0</td> <td>Total Value 177,210</td> <td>177,210</td> <td></td> <td>19,493</td> <td>Total Taxable</td> <td>19,493</td> <td>1,802.00</td> </tr> </tbody> </table>		Source	REAL	Fair Cash	Capped	Asmnt Level	Assessed	Levy Rate	92.430	Current Tax	Remove Cap	2023	Land Value 63,901	63,901	11%	7,029	Assessed	19,493	1,801.74	Year Frozen	2019	Improvements 113,309	113,309		12,464	Penalty	0		Uncapped Value	0	Mobile Home 0	0		0	Exemption	0	0.00	TIF Project ID	0	Total Value 177,210	177,210		19,493	Total Taxable	19,493	1,802.00																																																																											
Source	REAL	Fair Cash	Capped	Asmnt Level	Assessed	Levy Rate	92.430	Current Tax																																																																																																																	
Remove Cap	2023	Land Value 63,901	63,901	11%	7,029	Assessed	19,493	1,801.74																																																																																																																	
Year Frozen	2019	Improvements 113,309	113,309		12,464	Penalty	0																																																																																																																		
Uncapped Value	0	Mobile Home 0	0		0	Exemption	0	0.00																																																																																																																	
TIF Project ID	0	Total Value 177,210	177,210		19,493	Total Taxable	19,493	1,802.00																																																																																																																	
Assessment History																																																																																																																									
<table border="1"> <thead> <tr> <th>Tax Year</th> <th>Statement Number</th> <th>Billed Owner</th> <th>Tax Area</th> <th>Total Value</th> <th>Exemptions</th> <th>Taxable Value</th> <th>Billed Tax</th> </tr> </thead> <tbody> <tr><td>2025</td><td>2025-660016014</td><td>BOURLAND, COLLIN CLINTON</td><td>17</td><td>175,552</td><td>0</td><td>19,311</td><td>1,785.00</td></tr> <tr><td>2024</td><td>2024-660016014</td><td>BOURLAND, COLLIN CLINTON</td><td>17</td><td>180,000</td><td>0</td><td>19,800</td><td>1,830.00</td></tr> <tr><td>2023</td><td>2023-660016014</td><td>BOURLAND, COLLIN CLINTON</td><td>17</td><td>180,000</td><td>0</td><td>19,800</td><td>1,814.00</td></tr> <tr><td>2022</td><td>2022-660016014</td><td>BOURLAND, COLLIN CLINTON</td><td>17</td><td>154,000</td><td>0</td><td>16,940</td><td>1,568.00</td></tr> <tr><td>2021</td><td>2021-660016014</td><td>COFFEE, COLLIN G & AUBREY N</td><td>17</td><td>136,041</td><td>1000</td><td>7,595</td><td>671.00</td></tr> <tr><td>2020</td><td>2020-660016014</td><td>CHEEK, JAMES ALBERT</td><td>17</td><td>133,783</td><td>1000</td><td>7,595</td><td>695.00</td></tr> <tr><td>2019</td><td>2019-660016014</td><td>CHEEK, JAMES ALBERT</td><td>17</td><td>128,738</td><td>1000</td><td>7,595</td><td>703.00</td></tr> <tr><td>2018</td><td>2018-660016014</td><td>CHEEK, JAMES ALBERT</td><td>17</td><td>96,606</td><td>0</td><td>10,627</td><td>982.00</td></tr> <tr><td>2017</td><td>2017-660016014</td><td>GIBMO LLC</td><td>17</td><td>95,821</td><td>0</td><td>10,447</td><td>959.00</td></tr> <tr><td>2016</td><td>2016-660016014</td><td>SNYDER, GEORGE HENRY &</td><td>17</td><td>96,982</td><td>0</td><td>9,949</td><td>934.00</td></tr> <tr><td>2015</td><td>2015-660016014</td><td>SNYDER, GEORGE HENRY &</td><td>17</td><td>94,040</td><td>0</td><td>9,476</td><td>855.00</td></tr> <tr><td>2014</td><td>2014-660016014</td><td>SNYDER, GEORGE HENRY &</td><td>17</td><td>97,090</td><td>0</td><td>9,024</td><td>837.00</td></tr> <tr><td>2013</td><td>2013-660016014</td><td>SNYDER, GEORGE HENRY &</td><td>17</td><td>93,020</td><td>2000</td><td>6,595</td><td>604.00</td></tr> </tbody> </table>										Tax Year	Statement Number	Billed Owner	Tax Area	Total Value	Exemptions	Taxable Value	Billed Tax	2025	2025-660016014	BOURLAND, COLLIN CLINTON	17	175,552	0	19,311	1,785.00	2024	2024-660016014	BOURLAND, COLLIN CLINTON	17	180,000	0	19,800	1,830.00	2023	2023-660016014	BOURLAND, COLLIN CLINTON	17	180,000	0	19,800	1,814.00	2022	2022-660016014	BOURLAND, COLLIN CLINTON	17	154,000	0	16,940	1,568.00	2021	2021-660016014	COFFEE, COLLIN G & AUBREY N	17	136,041	1000	7,595	671.00	2020	2020-660016014	CHEEK, JAMES ALBERT	17	133,783	1000	7,595	695.00	2019	2019-660016014	CHEEK, JAMES ALBERT	17	128,738	1000	7,595	703.00	2018	2018-660016014	CHEEK, JAMES ALBERT	17	96,606	0	10,627	982.00	2017	2017-660016014	GIBMO LLC	17	95,821	0	10,447	959.00	2016	2016-660016014	SNYDER, GEORGE HENRY &	17	96,982	0	9,949	934.00	2015	2015-660016014	SNYDER, GEORGE HENRY &	17	94,040	0	9,476	855.00	2014	2014-660016014	SNYDER, GEORGE HENRY &	17	97,090	0	9,024	837.00	2013	2013-660016014	SNYDER, GEORGE HENRY &	17	93,020	2000	6,595	604.00
Tax Year	Statement Number	Billed Owner	Tax Area	Total Value	Exemptions	Taxable Value	Billed Tax																																																																																																																		
2025	2025-660016014	BOURLAND, COLLIN CLINTON	17	175,552	0	19,311	1,785.00																																																																																																																		
2024	2024-660016014	BOURLAND, COLLIN CLINTON	17	180,000	0	19,800	1,830.00																																																																																																																		
2023	2023-660016014	BOURLAND, COLLIN CLINTON	17	180,000	0	19,800	1,814.00																																																																																																																		
2022	2022-660016014	BOURLAND, COLLIN CLINTON	17	154,000	0	16,940	1,568.00																																																																																																																		
2021	2021-660016014	COFFEE, COLLIN G & AUBREY N	17	136,041	1000	7,595	671.00																																																																																																																		
2020	2020-660016014	CHEEK, JAMES ALBERT	17	133,783	1000	7,595	695.00																																																																																																																		
2019	2019-660016014	CHEEK, JAMES ALBERT	17	128,738	1000	7,595	703.00																																																																																																																		
2018	2018-660016014	CHEEK, JAMES ALBERT	17	96,606	0	10,627	982.00																																																																																																																		
2017	2017-660016014	GIBMO LLC	17	95,821	0	10,447	959.00																																																																																																																		
2016	2016-660016014	SNYDER, GEORGE HENRY &	17	96,982	0	9,949	934.00																																																																																																																		
2015	2015-660016014	SNYDER, GEORGE HENRY &	17	94,040	0	9,476	855.00																																																																																																																		
2014	2014-660016014	SNYDER, GEORGE HENRY &	17	97,090	0	9,024	837.00																																																																																																																		
2013	2013-660016014	SNYDER, GEORGE HENRY &	17	93,020	2000	6,595	604.00																																																																																																																		



Rogers

Assessment Property Record Card for Tax Year 2026

Data provided by LISA DELOZIER County Assessor

Date 04/16/2026
 Time 22:34:23
 Page 2

Lot Data		Square-Foot - NBHD 1177 #1	
Lot Size			
Lot Count			
Units Buildable	1		
Non-Ag Acres	0.269		
Topography			
Street Access			
Utilities			
Amenities	LAND QUALITY	0	0
Method	Square-Foot		
Base Lot Value	11,717.00 x 3.05 = 35,719		
Factor Value			
Adjustments	1.7890		
Lot Value	63,901		



\\tsclient\A\TOMMY DUNLAP\New folder (266)\IMG_0056.JPG 9/11/2023

Residential Data	
Type	1 Single Family Residence
Condition	3 - Average
Quality	2.5 - Fair
Architecture	
Style	100% One Story
Exterior Wall	100% Veneer, Masonry
Base/Total Area	1,408 / 1,408
Style	100% One Story
HVAC	100% Warmed & Cooled Air
Roof Cover	1 Composition Shingle
Area on Slab	0
Fixture/RghIn	11 /
Bed/F/H Bath	3 / 2.0 /
Basement Area	
Garage Type	480 Attached Garage - Unfinished 2 Stalls
Remodel	
Year/Eff Age	1977 / 37

GRM Approach

GRM Code	
Gross Rent	0.00
Indicated Value	

Multiple Regression

MRA Code	1 Test
Adusted R	0.8445
Indicated Value	153,199 108.81 Per SqFt

Direct Comparables

Selection Model	A Adam Test
Adjustment Model	1 2022 Residential
Comparables	8
Indicated Value	177,960 Per SqFt

Value Reconciliation

Selected Approach	Cost Approach
Improvements	113,309
Lot Value	63,901
Indicated Value	177,210 125.86 Per SqFt
Agland Value	
Site Improvements	
Total Value	177,210 125.86 Total Value Per SqFt

Cost Approach		Manual : 01/2025	
Base Cost	106.04	Total Misc Impr	+ 8,975
Roofing Adj	+ 4.50	Garage Cost	+ 13,282
Subfloor Adj	+ 1.21	Total RCN	= 209,831
Heat/Cool Adj	+ 11.47	Depreciation (46%)	- 96,522
Plumbing Adj	+ 10.00	Lump Sums	+ 0
Basement Adj	+ 0.00	RCNLD	= 113,309
Adj Base Cost	= 133.22	Lot Value	+ 63,901
Total Area	x 1,408	Indicated Value	= 177,210
Adjusted Cost	= 187,574	Value Per SqFt	125.86

Miscellaneous Improvements

Code	Description	Sketch ID	Size	Year	Units	Unit Cost	Depr	Value
FPR1	FIREPLACE - RESIDENTIAL 1 STORY	0		1	1	5,095.98		5,096
PATO	SLAB PORCH - OPEN	38415	20x12		240	9.35		2,244
PRCH	SLAB PORCH - COVERED	38416	68		68	24.05		1,635



Rogers
Assessment Property Record Card for Tax Year 2026

Data provided by LISA DELOZIER County Assessor

Date 04/16/2026
 Time 22:34:23
 Page 3

Sketch Image

660016014

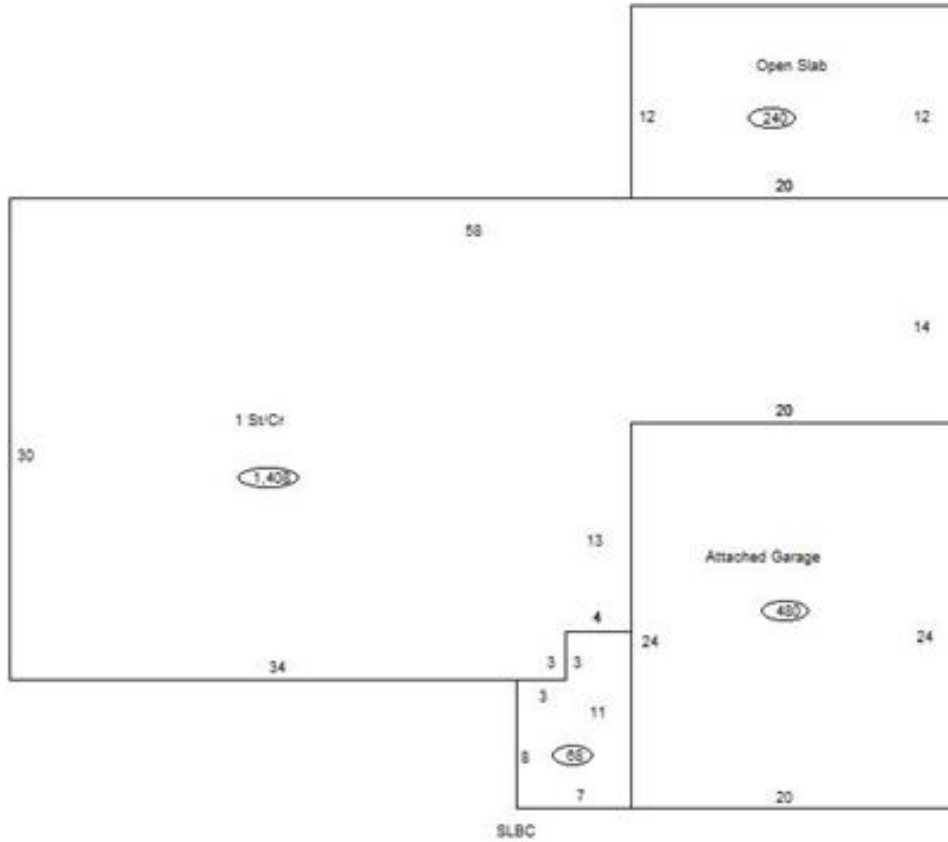

Sketch Vector Information

Sequence	Code	Type	Built Over	Scale	Section Label	Base Area	Multiplier	Total Area
1	R	1	Crawl	10	1 St/Cr	1,408	1.000	1,408
2	G	1		10	Attached Garage	480	1.000	480
3	M	PATO		10	Open Slab	240	1.000	240
4	M	PRCH		10	SLBC	68	1.000	68
Total Building Area						1,408		1,408



Rogers

Assessment Property Record Card for Tax Year 2026

Data provided by LISA DELOZIER County Assessor

Date 04/16/2026
Time 22:34:23
Page 4

660016014

Outbuildings/Site Improvements

Building Image	Code	Description	Dimensions	Floor	Roofing	Total Units
	STF	STG FAIR	0x0x0			
	Qual	2	Cond	Year	Eff Age	
Valuation Summary		Modifier Total	RCN	Depr (100% Phys/ % Func)	RCNLD	
Base Cost (4.68 x)						