



Rogers

Assessment Property Record Card for Tax Year 2026

Data provided by LISA DELOZIER County Assessor

Date 04/16/2026
Time 23:29:37
Page 1

Assessment Data					Primary Image																																																	
Account 660016110 Parcel ID 000000-00-0-10225-004-0001 Cadastral ID 17-21-16-01630 Property Type REAL - Real Property Property Class URP VI Area 1 Tax Area 17 - CLAREMORE OT Name ID 71304 KNEESE, MICHAEL R 1301 GRAHAM ST CLAREMORE OK 74017-0000 Parcel Location Situs 01301 GRAHAM Subdivision LEEWOOD ESTATES Lot/Block 0001 / 0004 Parcel Size 1 - Lots Sec/Twn/Rng 17 / 21 / 16 / 5 Neighborhood 1161 - R-V01-SW CLAREMORE School District S001 - CLAREMORE SCHOOLS					 <p>\\tsclient\A\TOMMY DUNLAP\New folder (249)\IMG_0015.JPG 8/18/2023</p>																																																	
Legal Description Lat/Long: 36.29604479 -95.62571776																																																						
LOT 1 BLOCK 4 LEEWOOD ESTATES					Building Permits <table border="1"> <thead> <tr> <th>Number</th> <th>Description</th> <th>Opened</th> <th>Closed</th> <th>Amount</th> </tr> </thead> <tbody> <tr> <td> </td> <td> </td> <td> </td> <td> </td> <td> </td> </tr> </tbody> </table>					Number	Description	Opened	Closed	Amount																																								
Number	Description	Opened	Closed	Amount																																																		
Exemptions					Sale History																																																	
Code	Type	Active	Maximum	Exemption	Bk/Pg	Grantor	Date	Price	Code																																													
H	Homestead	Yes	1,000	1,000																																																		
Parcel Valuation					<table border="1"> <thead> <tr> <th>Source</th> <th>REAL</th> <th>Fair Cash</th> <th>Capped</th> <th>Asmnt Level</th> <th>Assessed</th> <th>Levy Rate</th> <th>92.430</th> <th>Current Tax</th> </tr> </thead> <tbody> <tr> <td>Remove Cap</td> <td>0</td> <td>Land Value 52,723</td> <td>15,176</td> <td>11%</td> <td>1,669</td> <td>Assessed</td> <td>10,685</td> <td>987.61</td> </tr> <tr> <td>Year Frozen</td> <td>0</td> <td>Improvements 104,736</td> <td>81,968</td> <td> </td> <td>9,016</td> <td>Penalty</td> <td>0</td> <td> </td> </tr> <tr> <td>Uncapped Value</td> <td>0</td> <td>Mobile Home 0</td> <td>0</td> <td> </td> <td>0</td> <td>Exemption</td> <td>1,000</td> <td>-93.00</td> </tr> <tr> <td>TIF Project ID</td> <td>0</td> <td>Total Value 157,459</td> <td>97,144</td> <td> </td> <td>10,685</td> <td>Total Taxable</td> <td>9,685</td> <td>895.00</td> </tr> </tbody> </table>					Source	REAL	Fair Cash	Capped	Asmnt Level	Assessed	Levy Rate	92.430	Current Tax	Remove Cap	0	Land Value 52,723	15,176	11%	1,669	Assessed	10,685	987.61	Year Frozen	0	Improvements 104,736	81,968		9,016	Penalty	0		Uncapped Value	0	Mobile Home 0	0		0	Exemption	1,000	-93.00	TIF Project ID	0	Total Value 157,459	97,144		10,685	Total Taxable	9,685	895.00
Source	REAL	Fair Cash	Capped	Asmnt Level	Assessed	Levy Rate	92.430	Current Tax																																														
Remove Cap	0	Land Value 52,723	15,176	11%	1,669	Assessed	10,685	987.61																																														
Year Frozen	0	Improvements 104,736	81,968		9,016	Penalty	0																																															
Uncapped Value	0	Mobile Home 0	0		0	Exemption	1,000	-93.00																																														
TIF Project ID	0	Total Value 157,459	97,144		10,685	Total Taxable	9,685	895.00																																														
Assessment History																																																						
Tax Year	Statement Number	Billed Owner	Tax Area	Total Value	Exemptions	Taxable Value	Billed Tax																																															
2025	2025-660016110	KNEESE, MICHAEL R	17	154,092	1000	9,375	867.00																																															
2024	2024-660016110	KNEESE, MICHAEL R	17	156,486	1000	9,073	839.00																																															
2023	2023-660016110	KNEESE, MICHAEL R	17	111,147	1000	8,779	804.00																																															
2022	2022-660016110	KNEESE, MICHAEL R	17	86,312	1000	8,494	786.00																																															
2021	2021-660016110	KNEESE, MICHAEL R	17	89,375	1000	8,831	780.00																																															
2020	2020-660016110	KNEESE, MICHAEL R	17	90,344	1000	8,938	818.00																																															
2019	2019-660016110	KNEESE, MICHAEL R	17	88,063	1000	8,687	805.00																																															
2018	2018-660016110	KNEESE, MICHAEL R	17	93,451	1000	9,280	857.00																																															
2017	2017-660016110	KNEESE, MICHAEL R	17	92,658	1000	9,079	834.00																																															
2016	2016-660016110	KNEESE, MICHAEL R	17	90,192	1000	8,785	825.00																																															
2015	2015-660016110	KNEESE, MICHAEL R	17	96,395	1000	8,500	767.00																																															
2014	2014-660016110	KNEESE, MICHAEL R	17	99,436	1000	8,223	763.00																																															
2013	2013-660016110	KNEESE, MICHAEL R	17	93,429	1000	7,955	728.00																																															



Rogers

Assessment Property Record Card for Tax Year 2026

Data provided by LISA DELOZIER County Assessor

Date 04/16/2026
Time 23:29:37
Page 2

Lot Data		Square-Foot - NBHD 1161 #1		Primary Image	
Lot Size					
Lot Count	1				
Units Buildable	8500				
Non-Ag Acres	0.2201				
Topography					
Street Access					
Utilities					
Amenities	LAND QUALITY	0	0		
Method	Square-Foot				
Base Lot Value	9,586.00 x 5.50 = 52,723				
Factor Value				\\tsclient\A\TOMMY DUNLAP\New folder (249)\IMG_0015.JPG 8/18/2023	
Adjustments	1.0000			GRM Approach	
Lot Value	52,723			GRM Code Gross Rent 0.00 Indicated Value	
Residential Data				Multiple Regression	
Type	1 Single Family Residence			MRA Code 1 Test Adjusted R 0.8445 Indicated Value 151,829 122.64 Per SqFt	
Condition	3 - Average			Direct Comparables	
Quality	2.5 - Fair			Selection Model A Adam Test Adjustment Model 1 2022 Residential Comparables 8 Indicated Value 138,860 Per SqFt	
Architecture	R3 Res Nbhd 3			Value Reconciliation	
Style	100% One Story			Selected Approach Cost Approach Improvements 104,736 Lot Value 52,723 Indicated Value 157,459 127.19 Per SqFt Agland Value Site Improvements Total Value 157,459 127.19 Total Value Per SqFt	
Exterior Wall	60% Veneer, Masonry 40% Frame, Siding, Wood				
Base/Total Area	1,238 / 1,238				
Style	100% One Story				
HVAC	100% Warmed & Cooled Air				
Roof Cover	1 Composition Shingle				
Area on Slab	1,238				
Fixture/RghIn	11 /				
Bed/F/H Bath	3 / 2.0 /				
Basement Area					
Garage Type	550 Attached Garage - Unfinished				
Remodel					
Year/Eff Age	1980 / 35				
Cost Approach		Manual : 01/2025			
Base Cost	108.04	Total Misc Impr	+ 5,869		
Roofing Adj	+ 4.72	Garage Cost	+ 14,784		
Subfloor Adj	+ -1.21	Total RCN	= 187,028		
Heat/Cool Adj	+ 11.47	Depreciation (44%)	- 82,292		
Plumbing Adj	+ 11.37	Lump Sums	+ 0		
Basement Adj	+ 0.00	RCNLD	= 104,736		
Adj Base Cost	= 134.39	Lot Value	+ 52,723		
Total Area	x 1,238	Indicated Value	= 157,459		
Adjusted Cost	= 166,375	Value Per SqFt	127.19		

Miscellaneous Improvements							
Code	Description	Sketch ID	Size	Year	Units	Unit Cost	Depr Value
FPR1	FIREPLACE - RESIDENTIAL 1 STORY	0		1	1	5,095.98	5,096
PRCH	SLAB PORCH - COVERED	38746	8x4		32	24.17	773



Rogers

Assessment Property Record Card for Tax Year 2026

Data provided by LISA DELOZIER County Assessor

Date 04/16/2026

Time 23:29:37

Page 3

Sketch Image

660016110

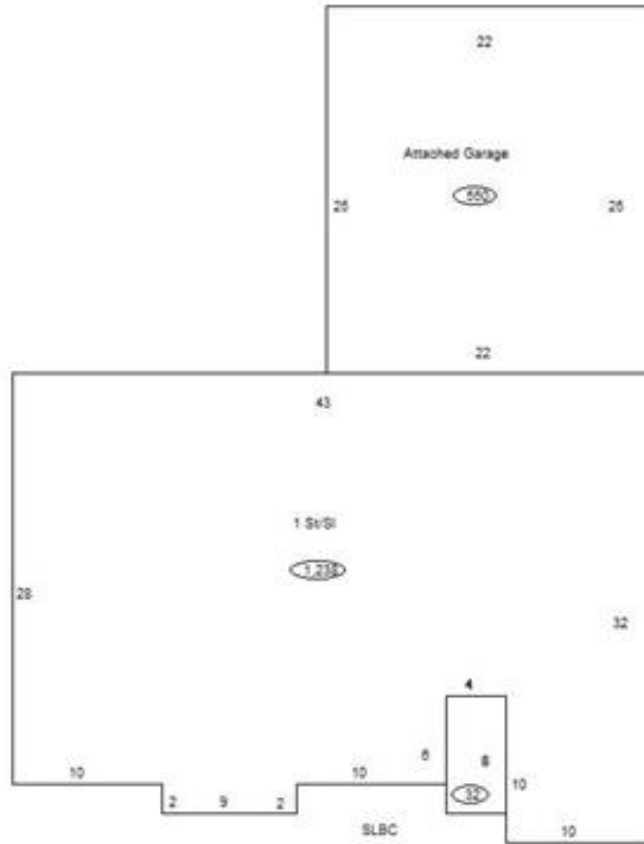

Sketch Vector Information

Sequence	Code	Type	Built Over	Scale	Section Label	Base Area	Multiplier	Total Area
1	R	1	Slab	10	1 St/SI	1,238	1.000	1,238
2	G	1		10	Attached Garage	550	1.000	550
3	M	PRCH		10	SLBC	32	1.000	32
Total Building Area						1,238		1,238



Rogers

Assessment Property Record Card for Tax Year 2026

Data provided by LISA DELOZIER County Assessor

Date 04/16/2026
Time 23:29:37
Page 4

660016110

Outbuildings/Site Improvements

Building Image	Code	Description	Dimensions	Floor	Roofing	Total Units
	STF	STG FAIR	0x0x0			
	Qual	2	Cond	Year	Eff Age	
Valuation Summary			Modifier Total	RCN	Depr (100% Phys/ % Func)	RCNLD
Base Cost (4.68 x)						