



# Rogers

## Assessment Property Record Card for Tax Year 2026

Data provided by LISA DELOZIER County Assessor

Date 04/18/2026  
 Time 06:17:51  
 Page 1

Assessment Data					Primary Image				
Account	660016393								
Parcel ID	21N16E-17-2-00000-000-0000								
Cadastral ID	17-21-16-16400								
Property Type	REAL - Real Property								
Property Class	UC	VI Area	1						
Tax Area	17 - CLAREMORE OT								
Name ID	71384								
MCKERROW, JOE G									
PO BOX 1228 CLAREMORE OK 74018-0000									
Parcel Location									
Situs	00940 S LYNN RIGGS BLVD								
Subdivision									
Lot/Block	/	Parcel Size	2.99 - Acres						
Sec/Twn/Rng	17 / 21 / 16 / 2								
Neighborhood	90000 - COMMERCIAL								
School District	S001 - CLAREMORE SCHOOLS								
Legal Description Lat/Long: 36.30064774 -95.62455713									
TR IN SE SE NW & IN NE NE SW BEG: AT A PT 91' S OF CENTER OF SD SEC 17; N 75-50 W 238'; N 6.35'; N 75-50 W 84.25'; N 24-09-26 W 91 12'; N 60-30 W 130.40' TO PT ON ELY ROW/L OF NEW FOUR LANE HWY 66; NELY ALG SD ROW 346.44' TH S 77-06-34 E 186.43' TO NW/C OF THE REUPPEL TR; S 27-08-08 W 131.39'; S 62-40									
Building Permits									
Number	Description	Opened	Closed	Amount					
2198	REMODEL	04/1999	12/2000						
Exemptions									
Code	Type	Active	Maximum	Exemption					
Sale History									
Bk/Pg	Grantor	Date	Price	Code					
Parcel Valuation									
Source	REAL	Fair Cash	Capped	Asmnt Level	Assessed	Levy Rate	92.430	Current Tax	
Remove Cap	0	Land Value	523,250	523,250	11%	57,558	Assessed	163,962	15,155.01
Year Frozen	0	Improvements	1,097,428	967,307		106,404	Penalty	0	
Uncapped Value	0	Mobile Home	0	0		0	Exemption	0	0.00
TIF Project ID	0	Total Value	1,620,678	1,490,557		163,962	Total Taxable	163,962	15,155.00
Assessment History									
Tax Year	Statement Number	Billed Owner	Tax Area	Total Value	Exemptions	Taxable Value	Billed Tax		
2025	2025-660016393	MCKERROW, JOE G	17	1,721,051	0	156,154	14,433.00		
2024	2024-660016393	MCKERROW, JOE G	17	1,351,980	0	148,718	13,745.00		
2023	2023-660016393	MCKERROW, JOE G	17	1,418,706	0	156,058	14,295.00		
2022	2022-660016393	MCKERROW, JOE G	17	1,411,516	0	155,267	14,373.00		
2021	2021-660016393	MCKERROW, JOE G	17	1,561,281	0	156,137	13,787.00		
2020	2020-660016393	MCKERROW, JOE G	17	1,561,281	0	148,702	13,617.00		
2019	2019-660016393	MCKERROW, JOE G	17	1,834,069	0	141,621	13,117.00		
2018	2018-660016393	MCKERROW, JOE G	17	1,705,291	0	134,877	12,463.00		
2017	2017-660016393	MCKERROW, JOE G	17	1,705,291	0	128,455	11,797.00		
2016	2016-660016393	MCKERROW, JOE G	17	1,112,157	0	122,338	11,483.00		
2015	2015-660016393	MCKERROW, JOE G	17	1,112,157	0	122,338	11,034.00		
2014	2014-660016393	MCKERROW, JOE G	17	1,112,157	0	122,338	11,344.00		
2013	2013-660016393	MCKERROW, JOE G	17	1,112,157	0	122,338	11,195.00		



# Rogers

## Assessment Property Record Card for Tax Year 2026

Data provided by LISA DELOZIER County Assessor

Date 04/18/2026  
 Time 06:17:51  
 Page 2

Lot Data		Primary Image	
Lot Size	0 x 0		
Lot Count	0		
Units Buildable	2.99		
Non-Ag Acres	0		
Topography			
Street Access			
Utilities			
Amenities	0		
	0		
Value Model	1482 (UNITS BUILDABLE)		
Value Method	Units-Buildable		
Base Lot Value	523,250.00 x 1.00 = 523,250		
Factor Value	0		
Adjustments			
Lot Value	523,250		
Cost Approach		Image Information	
Manual Date	01/2025	Image ID	1026718
Total Building Area	31,766	Image Date	6/13/2023
Total Base Value	4,109,612	Name	IMG_0017.JPG
Modifier Value		Description	REVAL 2024
Misc Improvements			
Replacement Cost New	4,109,612		
Phys/Func Depreciation Loss	()		
RCN Less Phys/Func	1,004,099		
Economic Depreciation			
RCNLD (All Sources)	1,004,099		
Depreciated Improvements			
Outbuilding Value	93,329		
Total Improvement Value	1,097,428		
Land Value	523,250		
Cost Approach Value	1,620,678	51.02/SqFt	
Income Approach		Value Reconciliation	
Potential Gross Income (PGI)		Selected Valuation Method	Cost Approach
Vacancy & Collection Loss		Total Improvement Value	93,329
Miscellaneous Income		Land Value	523,250
Effective Gross Income (EGI)		Total Appraised Value	1,620,678
Total Expenses			51.02/SqFt
Net Operating Income (NOI)			
Income Capitalization Rate			
Indicated Value	0.00		



# Rogers

## Assessment Property Record Card for Tax Year 2026

Data provided by LISA DELOZIER County Assessor

Date 04/18/2026  
 Time 06:17:51  
 Page 3

Sketch Image

660016393

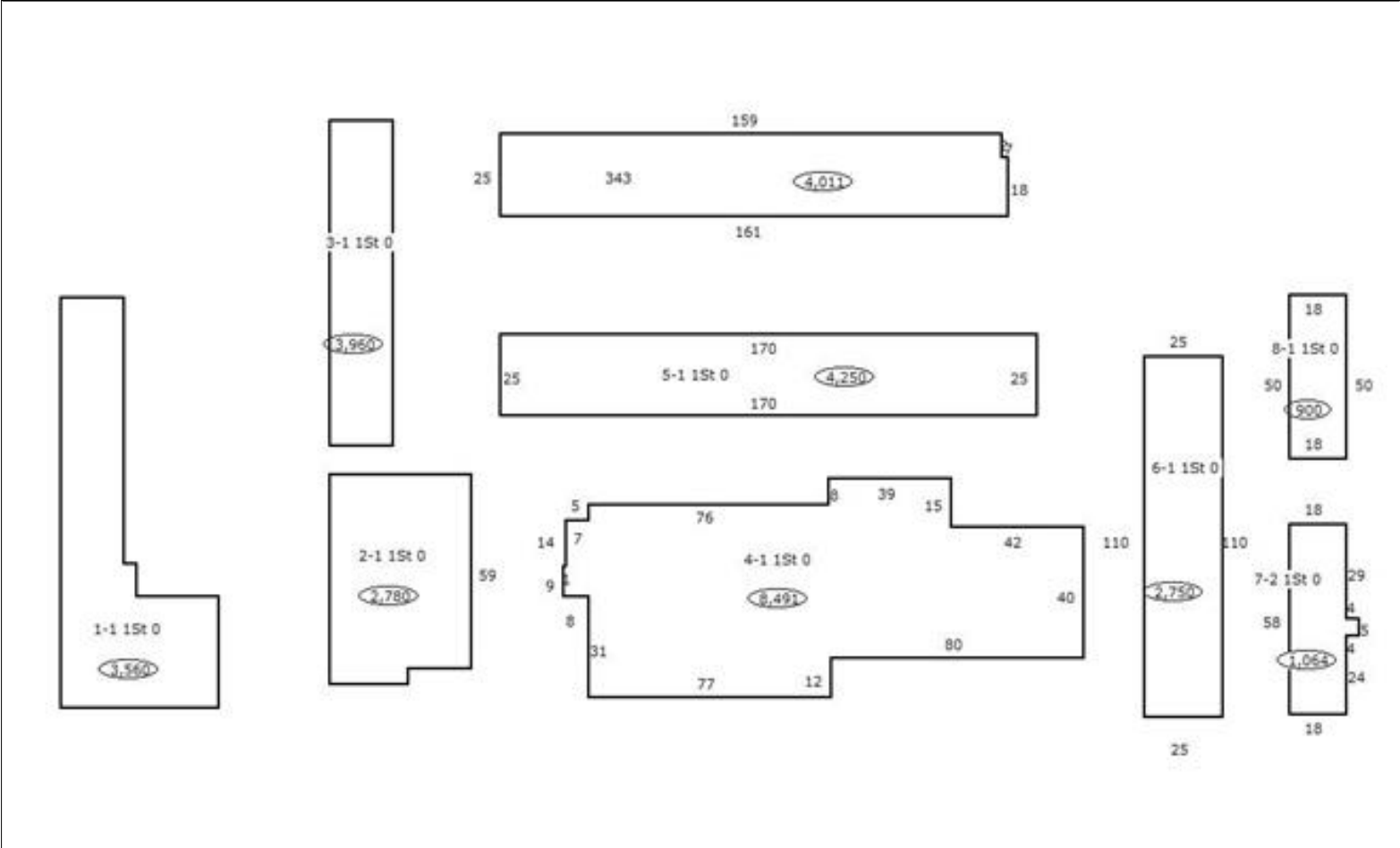

### Sketch Vector Information

Sequence	Code	Type	Built Over	Scale	Section Label	Base Area	Multiplier	Total Area
1	C	544		40	1-1 1St 0	3,560	1.000	3,560
2	C	336		40	2-1 1St 0	2,780	1.000	2,780
3	C	343		40	3-1 1St 0	1,980	2.000	3,960
4	C	412		40	4-1 1St 0	8,491	1.000	8,491
5	C	343		40	5-1 1St 0	4,250	1.000	4,250
6	C	343		40	6-1 1St 0	2,750	1.000	2,750
7	C	343		40	7-2 1St 0	1,064	1.000	1,064
8	C	343		40	8-1 1St 0	900	1.000	900
9	C	343		40	343	4,011	1.000	4,011
<b>Total Building Area</b>						29,786		31,766



# Rogers

## Assessment Property Record Card for Tax Year 2026

Data provided by LISA DELOZIER County Assessor

Date 04/18/2026  
Time 06:17:51  
Page 4

Account 660016393  
Parcel ID 21N16E-17-2-00000-000-0000  
Cadastral ID 17-21-16-16400

Tax Area Code 17  
Property Class UC  
Owners Name MCKERROW, JOE G

### Building Data

Building ID 1365  
Building Sequence 1  
Occupancy 1 544 Motel, Office-Apartment 100%  
Occupancy 2  
Occupancy 3  
Total Floor Area 3,560  
Average Perimeter 350  
Number Of Storys 1.00  
Average Wall Ht 8.00  
Year Built 1982  
Effective Age 29  
Construction Class 2 - Heavier Wood or Steel Stud Frame  
Quality 2.5 - Fair  
Condition 2 - Fair  
Exterior Wall 2 - Ashlar Stone Veneer w/Block Backup  
Heating/Cooling 7 - Package Unit  
Roof Type  
Roof Cover Composition

Basement Area  
Basement Levels  
Basement Finish  
Finish Code - 1  
Finish Area - 1  
Finish Code - 2  
Finish Area - 2

### Building Image



### Image Information

Image Name IMG\_0017.JPG  
Image Date 6/13/2023  
Image Name IMG\_0017.JPG  
Description REVAL 2024

### Cost Calculations

Appraisal Zone 1  
Zone Description  
Base Cost 100.31  
Wall Cost 68.16  
HVAC Cost 15.93  
Basement Cost 0.00  
Total Base Cost 184.40  
Total Area 3,560  
Base RCN 656,464  
Misc Impr Value

Manual Date 01/2025  
Base Year 2026  
Modifier Value  
Total Replacement Cost 656,464  
Physical Depreciation 73%  
Functional Depreciation  
Total Depreciation 73% (479,219)  
Total RCNLD 177,245  
Lump Sums  
Total Building Value 177,245 \$ 49.79 Per SqFt



# Rogers

## Assessment Property Record Card for Tax Year 2026

Data provided by LISA DELOZIER County Assessor

Date 04/18/2026  
 Time 06:17:51  
 Page 5

Account 660016393  
 Parcel ID 21N16E-17-2-00000-000-0000  
 Cadastral ID 17-21-16-16400

Tax Area Code 17  
 Property Class UC  
 Owners Name MCKERROW, JOE G

### Building Data

Building ID 1357  
 Building Sequence 2  
 Occupancy 1 336 Laundromat 100%  
 Occupancy 2  
 Occupancy 3  
 Total Floor Area 2,780  
 Average Perimeter 218  
 Number Of Storys 1.00  
 Average Wall Ht 8.00  
 Year Built 1994  
 Effective Age 21  
 Construction Class 2 - Heavier Wood or Steel Stud Frame  
 Quality 2 - Fair  
 Condition 2 - Fair  
 Exterior Wall 92 - Stud Stucco  
 Heating/Cooling 15 - No HVAC  
 Roof Type  
 Roof Cover Composition

Basement Area  
 Basement Levels  
 Basement Finish  
 Finish Code - 1  
 Finish Area - 1  
 Finish Code - 2  
 Finish Area - 2

### Building Image



### Image Information

Image Name IMG\_0036.JPG  
 Image Date 1/22/2020  
 Image Name IMG\_0036.JPG  
 Description REVAL 2020

### Cost Calculations

Appraisal Zone 1  
 Zone Description  
 Base Cost 61.59  
 Wall Cost 25.41  
 HVAC Cost 0.00  
 Basement Cost 0.00  
 Total Base Cost 87.00  
 Total Area 2,780  
 Base RCN 241,860  
 Misc Impr Value

Manual Date 01/2025  
 Base Year 2026  
 Modifier Value  
 Total Replacement Cost 241,860  
 Physical Depreciation 57%  
 Functional Depreciation  
 Total Depreciation 57% (137,860)  
 Total RCNLD 104,000  
 Lump Sums  
 Total Building Value 104,000 \$ 37.41 Per SqFt



# Rogers

## Assessment Property Record Card for Tax Year 2026

Data provided by LISA DELOZIER County Assessor

Date 04/18/2026  
Time 06:17:51  
Page 6

Account 660016393  
Parcel ID 21N16E-17-2-00000-000-0000  
Cadastral ID 17-21-16-16400

Tax Area Code 17  
Property Class UC  
Owners Name MCKERROW, JOE G

### Building Data

Building ID 1358  
Building Sequence 3  
Occupancy 1 343 Motel 100%  
Occupancy 2  
Occupancy 3  
Total Floor Area 3,960  
Average Perimeter 238  
Number Of Storys 2.00  
Average Wall Ht 8.00  
Year Built 1973  
Effective Age 34  
Construction Class 2 - Heavier Wood or Steel Stud Frame  
Quality 2 - Fair  
Condition 2 - Fair  
Exterior Wall 92 - Stud Stucco  
Heating/Cooling 7 - Package Unit  
Roof Type  
Roof Cover Composition

Basement Area  
Basement Levels  
Basement Finish  
Finish Code - 1  
Finish Area - 1  
Finish Code - 2  
Finish Area - 2

### Building Image



### Image Information

Image Name IMG\_0014.JPG  
Image Date 6/13/2023  
Image Name IMG\_0014.JPG  
Description REVAL 2024

### Cost Calculations

Appraisal Zone 1  
Zone Description  
Base Cost 80.14  
Wall Cost 29.51  
HVAC Cost 14.73  
Basement Cost 0.00  
Total Base Cost 124.38  
Total Area 3,960  
Base RCN 492,545  
Misc Impr Value

Manual Date 01/2025  
Base Year 2026  
Modifier Value  
Total Replacement Cost 492,545  
Physical Depreciation 80%  
Functional Depreciation  
Total Depreciation 80% (394,036)  
Total RCNLD 98,509  
Lump Sums  
Total Building Value 98,509 \$ 24.88 Per SqFt



# Rogers

## Assessment Property Record Card for Tax Year 2026

Data provided by LISA DELOZIER County Assessor

Date 04/18/2026  
Time 06:17:51  
Page 7

Account 660016393  
Parcel ID 21N16E-17-2-00000-000-0000  
Cadastral ID 17-21-16-16400

Tax Area Code 17  
Property Class UC  
Owners Name MCKERROW, JOE G

### Building Data

Building ID 1359  
Building Sequence 4  
Occupancy 1 412 Neighborhood Shopping Ctr 100%  
Occupancy 2  
Occupancy 3  
Total Floor Area 8,491  
Average Perimeter 464  
Number Of Storys 1.00  
Average Wall Ht 12.00  
Year Built 1982  
Effective Age 29  
Construction Class 2 - Heavier Wood or Steel Stud Frame  
Quality 2 - Fair  
Condition 2 - Fair  
Exterior Wall 92 - Stud Stucco  
Heating/Cooling 7 - Package Unit  
Roof Type  
Roof Cover Composition

Basement Area  
Basement Levels  
Basement Finish  
Finish Code - 1  
Finish Area - 1  
Finish Code - 2  
Finish Area - 2

### Building Image



### Image Information

Image Name IMG\_0017.JPG  
Image Date 6/13/2023  
Image Name IMG\_0017.JPG  
Description REVAL 2024

### Cost Calculations

Appraisal Zone 1  
Zone Description  
Base Cost 67.46  
Wall Cost 21.22  
HVAC Cost 14.73  
Basement Cost 0.00  
Total Base Cost 103.41  
Total Area 8,491  
Base RCN 878,054  
Misc Impr Value

Manual Date 01/2025  
Base Year 2026  
Modifier Value  
Total Replacement Cost 878,054  
Physical Depreciation 78%  
Functional Depreciation  
Total Depreciation 78% (684,882)  
Total RCNLD 193,172  
Lump Sums  
Total Building Value 193,172 \$ 22.75 Per SqFt



# Rogers

## Assessment Property Record Card for Tax Year 2026

Data provided by LISA DELOZIER County Assessor

Date 04/18/2026  
Time 06:17:51  
Page 8

Account 660016393  
Parcel ID 21N16E-17-2-00000-000-0000  
Cadastral ID 17-21-16-16400

Tax Area Code 17  
Property Class UC  
Owners Name MCKERROW, JOE G

### Building Data

Building ID 1360  
Building Sequence 5  
Occupancy 1 343 Motel 100%  
Occupancy 2  
Occupancy 3  
Total Floor Area 4,250  
Average Perimeter 390  
Number Of Storys 1.00  
Average Wall Ht 10.00  
Year Built 1973  
Effective Age 34  
Construction Class 2 - Heavier Wood or Steel Stud Frame  
Quality 2 - Fair  
Condition 2 - Fair  
Exterior Wall 92 - Stud Stucco  
Heating/Cooling 7 - Package Unit  
Roof Type  
Roof Cover Composition

Basement Area  
Basement Levels  
Basement Finish  
Finish Code - 1  
Finish Area - 1  
Finish Code - 2  
Finish Area - 2

### Building Image



### Image Information

Image Name IMG\_0016.JPG  
Image Date 6/13/2023  
Image Name IMG\_0016.JPG  
Description REVAL 2024

### Cost Calculations

Appraisal Zone 1  
Zone Description  
Base Cost 89.06  
Wall Cost 32.68  
HVAC Cost 14.73  
Basement Cost 0.00  
Total Base Cost 136.47  
Total Area 4,250  
Base RCN 579,998  
Misc Impr Value

Manual Date 01/2025  
Base Year 2026  
Modifier Value  
Total Replacement Cost 579,998  
Physical Depreciation 80%  
Functional Depreciation  
Total Depreciation 80% (463,998)  
Total RCNLD 116,000  
Lump Sums  
Total Building Value 116,000 \$ 27.29 Per SqFt



# Rogers

## Assessment Property Record Card for Tax Year 2026

Data provided by LISA DELOZIER County Assessor

Date 04/18/2026  
Time 06:17:51  
Page 9

Account 660016393  
Parcel ID 21N16E-17-2-00000-000-0000  
Cadastral ID 17-21-16-16400

Tax Area Code 17  
Property Class UC  
Owners Name MCKERROW, JOE G

### Building Data

Building ID 1361  
Building Sequence 6  
Occupancy 1 343 Motel 100%  
Occupancy 2  
Occupancy 3  
Total Floor Area 2,750  
Average Perimeter 270  
Number Of Storys 1.00  
Average Wall Ht 10.00  
Year Built 1973  
Effective Age 27  
Construction Class 2 - Heavier Wood or Steel Stud Frame  
Quality 2 - Fair  
Condition 3 - Average  
Exterior Wall 92 - Stud Stucco  
Heating/Cooling 7 - Package Unit  
Roof Type  
Roof Cover Composition

Basement Area  
Basement Levels  
Basement Finish  
Finish Code - 1  
Finish Area - 1  
Finish Code - 2  
Finish Area - 2

### Building Image



### Image Information

Image Name IMG\_0014.JPG  
Image Date 6/13/2023  
Image Name IMG\_0014.JPG  
Description REVAL 2024

### Cost Calculations

Appraisal Zone 1  
Zone Description  
Base Cost 90.29  
Wall Cost 34.97  
HVAC Cost 14.73  
Basement Cost 0.00  
Total Base Cost 139.99  
Total Area 2,750  
Base RCN 384,973  
Misc Impr Value

Manual Date 01/2025  
Base Year 2026  
Modifier Value  
Total Replacement Cost 384,973  
Physical Depreciation 75%  
Functional Depreciation  
Total Depreciation 75% (288,730)  
Total RCNLD 96,243  
Lump Sums  
Total Building Value 96,243 \$ 35.00 Per SqFt



# Rogers

## Assessment Property Record Card for Tax Year 2026

Data provided by LISA DELOZIER County Assessor

Date 04/18/2026  
Time 06:17:52  
Page 10

Account 660016393  
Parcel ID 21N16E-17-2-00000-000-0000  
Cadastral ID 17-21-16-16400

Tax Area Code 17  
Property Class UC  
Owners Name MCKERROW, JOE G

### Building Data

Building ID 1362  
Building Sequence 7  
Occupancy 1 343 Motel 100%  
Occupancy 2  
Occupancy 3  
Total Floor Area 1,064  
Average Perimeter 160  
Number Of Storys 1.00  
Average Wall Ht 10.00  
Year Built 1973  
Effective Age 27  
Construction Class 2 - Heavier Wood or Steel Stud Frame  
Quality 2 - Fair  
Condition 3 - Average  
Exterior Wall 92 - Stud Stucco  
Heating/Cooling 7 - Package Unit  
Roof Type  
Roof Cover Composition

Basement Area  
Basement Levels  
Basement Finish  
Finish Code - 1  
Finish Area - 1  
Finish Code - 2  
Finish Area - 2

### Building Image



### Image Information

Image Name IMG\_0015.JPG  
Image Date 6/13/2023  
Image Name IMG\_0015.JPG  
Description REVAL 2024

### Cost Calculations

Appraisal Zone 1  
Zone Description  
Base Cost 97.22  
Wall Cost 53.56  
HVAC Cost 14.73  
Basement Cost 0.00  
Total Base Cost 165.51  
Total Area 1,064  
Base RCN 176,103  
Misc Impr Value

Manual Date 01/2025  
Base Year 2026  
Modifier Value  
Total Replacement Cost 176,103  
Physical Depreciation 75%  
Functional Depreciation  
Total Depreciation 75% (132,077)  
Total RCNLD 44,026  
Lump Sums  
Total Building Value 44,026 \$ 41.38 Per SqFt



# Rogers

## Assessment Property Record Card for Tax Year 2026

Data provided by LISA DELOZIER County Assessor

Date 04/18/2026  
Time 06:17:52  
Page 11

Account 660016393  
Parcel ID 21N16E-17-2-00000-000-0000  
Cadastral ID 17-21-16-16400

Tax Area Code 17  
Property Class UC  
Owners Name MCKERROW, JOE G

### Building Data

Building ID 1363  
Building Sequence 8  
Occupancy 1 343 Motel 100%  
Occupancy 2  
Occupancy 3  
Total Floor Area 900  
Average Perimeter 136  
Number Of Storys 1.00  
Average Wall Ht 10.00  
Year Built 1973  
Effective Age 27  
Construction Class 2 - Heavier Wood or Steel Stud Frame  
Quality 2 - Fair  
Condition 3 - Average  
Exterior Wall 92 - Stud Stucco  
Heating/Cooling 7 - Package Unit  
Roof Type  
Roof Cover Composition

Basement Area  
Basement Levels  
Basement Finish  
Finish Code - 1  
Finish Area - 1  
Finish Code - 2  
Finish Area - 2

### Building Image



### Image Information

Image Name IMG\_0034.JPG  
Image Date 1/22/2020  
Image Name IMG\_0034.JPG  
Description \\tsclient\C\TOMS PC PICS\2019-11-27\IMG\_0034.JPG

### Cost Calculations

Appraisal Zone 1  
Zone Description  
Base Cost 98.37  
Wall Cost 53.82  
HVAC Cost 14.73  
Basement Cost 0.00  
Total Base Cost 166.92  
Total Area 900  
Base RCN 150,228  
Misc Impr Value

Manual Date 01/2025  
Base Year 2026  
Modifier Value  
Total Replacement Cost 150,228  
Physical Depreciation 75%  
Functional Depreciation  
Total Depreciation 75% (112,671)  
Total RCNLD 37,557  
Lump Sums  
Total Building Value 37,557 \$ 41.73 Per SqFt



# Rogers

## Assessment Property Record Card for Tax Year 2026

Data provided by LISA DELOZIER County Assessor

Date 04/18/2026  
 Time 06:17:52  
 Page 12

Account 660016393  
 Parcel ID 21N16E-17-2-00000-000-0000  
 Cadastral ID 17-21-16-16400

Tax Area Code 17  
 Property Class UC  
 Owners Name MCKERROW, JOE G

### Building Data

Building ID 1364  
 Building Sequence 9  
 Occupancy 1 343 Motel 100%  
 Occupancy 2  
 Occupancy 3  
 Total Floor Area 4,011  
 Average Perimeter 372  
 Number Of Storys 1.00  
 Average Wall Ht 10.00  
 Year Built 1973  
 Effective Age 27  
 Construction Class 2 - Heavier Wood or Steel Stud Frame  
 Quality 2 - Fair  
 Condition 3 - Average  
 Exterior Wall 92 - Stud Stucco  
 Heating/Cooling 7 - Package Unit  
 Roof Type  
 Roof Cover Composition

Basement Area  
 Basement Levels  
 Basement Finish  
 Finish Code - 1  
 Finish Area - 1  
 Finish Code - 2  
 Finish Area - 2

### Building Image



### Image Information

Image Name IMG\_0015.JPG  
 Image Date 6/13/2023  
 Image Name IMG\_0015.JPG  
 Description REVAL 2024

### Cost Calculations

Appraisal Zone 1  
 Zone Description  
 Base Cost 89.21  
 Wall Cost 33.03  
 HVAC Cost 14.73  
 Basement Cost 0.00  
 Total Base Cost 136.97  
 Total Area 4,011  
 Base RCN 549,387  
 Misc Impr Value

Manual Date 01/2025  
 Base Year 2026  
 Modifier Value  
 Total Replacement Cost 549,387  
 Physical Depreciation 75%  
 Functional Depreciation  
 Total Depreciation 75% (412,040)  
 Total RCNLD 137,347  
 Lump Sums  
 Total Building Value 137,347 \$ 34.24 Per SqFt

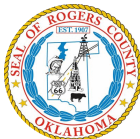

# Rogers

## Assessment Property Record Card for Tax Year 2026

Data provided by LISA DELOZIER County Assessor

Date 04/18/2026

Time 06:17:52

Page 13

660016393

### Outbuildings/Site Improvements

Building Image	Code	Description	Dimensions	Floor	Roofing	Total Units
	FLV	POOL 20X40	0x0x0			58,000
	<b>Qual</b>	<b>Cond</b>	<b>Year</b>	<b>Eff Age</b>		
	<b>Valuation Summary</b>		<b>Modifier Total</b>	<b>RCN</b>	<b>Depr (% Phys/ % Func)</b>	<b>RCNLD</b>
	Base Cost (1.00 x 58,000)			58,000	23,200	34,800
	FLV	PAVING 15000SF	0x0x0			57,900
	<b>Qual</b>	<b>Cond</b>	<b>Year</b>	<b>Eff Age</b>		
	<b>Valuation Summary</b>		<b>Modifier Total</b>	<b>RCN</b>	<b>Depr (% Phys/ % Func)</b>	<b>RCNLD</b>
	Base Cost (1.00 x 57,900)			57,900	23,160	34,740
	FLV	SIGN DFPI 8X12	0x0x0			13,440
	<b>Qual</b>	<b>Cond</b>	<b>Year</b>	<b>Eff Age</b>		
	<b>Valuation Summary</b>		<b>Modifier Total</b>	<b>RCN</b>	<b>Depr (% Phys/ % Func)</b>	<b>RCNLD</b>
	Base Cost (1.00 x 13,440)			13,440	5,376	8,064
	FLV	SIGN DFPI 4X8	0x0x0			5,760
	<b>Qual</b>	<b>Cond</b>	<b>Year</b>	<b>Eff Age</b>		
	<b>Valuation Summary</b>		<b>Modifier Total</b>	<b>RCN</b>	<b>Depr (% Phys/ % Func)</b>	<b>RCNLD</b>
	Base Cost (1.00 x 5,760)			5,760	2,304	3,456
	FLV	SIGN POLE 10" 2@14'	0x0x0			3,248
	<b>Qual</b>	<b>Cond</b>	<b>Year</b>	<b>Eff Age</b>		
	<b>Valuation Summary</b>		<b>Modifier Total</b>	<b>RCN</b>	<b>Depr (% Phys/ % Func)</b>	<b>RCNLD</b>
	Base Cost (1.00 x 3,248)			3,248	1,299	1,949
	FLV	WRIX4 150'	0x0x0			1,920
	<b>Qual</b>	<b>Cond</b>	<b>Year</b>	<b>Eff Age</b>		
	<b>Valuation Summary</b>		<b>Modifier Total</b>	<b>RCN</b>	<b>Depr (% Phys/ % Func)</b>	<b>RCNLD</b>
	Base Cost (1.00 x 1,920)			1,920	768	1,152
	FLV	FR CANOPY 25X20	0x0x0			12,400
	<b>Qual</b>	<b>Cond</b>	<b>Year</b>	<b>Eff Age</b>		
	<b>Valuation Summary</b>		<b>Modifier Total</b>	<b>RCN</b>	<b>Depr (% Phys/ % Func)</b>	<b>RCNLD</b>
	Base Cost (1.00 x 12,400)			12,400	4,960	7,440

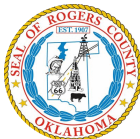

# Rogers

## Assessment Property Record Card for Tax Year 2026

Data provided by LISA DELOZIER County Assessor

Date 04/18/2026  
Time 06:17:52  
Page 14

---

FLV	CS UNDER CNPY 25X20	0x0x0			2,880
<b>Qual</b>	<b>Cond</b>	<b>Year</b>	<b>Eff Age</b>		

---

<b>Valuation Summary</b>	<b>Modifier Total</b>	<b>RCN</b>	<b>Depr (% Phys/ % Func)</b>	<b>RCNLD</b>
Base Cost (1.00 x 2,880)		2,880	1,152	1,728

---

<b>Total Site Improvement Value</b>	<b>93,329</b>
-------------------------------------	---------------