



Rogers

Assessment Property Record Card for Tax Year 2026

Data provided by LISA DELOZIER County Assessor

Date 04/16/2026
Time 22:20:18
Page 1

Assessment Data					Primary Image																																																																																																																				
Account 660016654 Parcel ID 000000-00-0-00150-002-0002 Cadastral ID 18-21-15-02810 Property Type REAL - Real Property Property Class RRP VI Area 4 Tax Area 3 - OWASSO RURAL/NO FIRE Name ID 262673 MORT, TIMOTHY R & ANGELA D 4826 E 490 RD CLAREMORE OK 74019-0000																																																																																																																									
Parcel Location Situs 04826 E 490 RD Subdivision CHAPARRAL ESTATES 1 Lot/Block 0002 / 0002 Parcel Size 2 - Lots Sec/Twn/Rng 18 / 21 / 15 / 5 Neighborhood 1106 - R-V01,4-SW CLAREMORE School District S021 - OWASSO SCHOOLS																																																																																																																									
Legal Description Lat/Long: 36.30657160 -95.74325781					Building Permits																																																																																																																				
LOTS 2 & 3 BLOCK 2 CHAPARRAL ESTATES 1					<table border="1"> <thead> <tr> <th>Number</th> <th>Description</th> <th>Opened</th> <th>Closed</th> <th>Amount</th> </tr> </thead> <tbody> <tr> <td>R19</td> <td>R19- ADD ON TO SHOP</td> <td>09/2018</td> <td>11/2018</td> <td></td> </tr> </tbody> </table>					Number	Description	Opened	Closed	Amount	R19	R19- ADD ON TO SHOP	09/2018	11/2018																																																																																																							
Number	Description	Opened	Closed	Amount																																																																																																																					
R19	R19- ADD ON TO SHOP	09/2018	11/2018																																																																																																																						
Exemptions					Sale History																																																																																																																				
<table border="1"> <thead> <tr> <th>Code</th> <th>Type</th> <th>Active</th> <th>Maximum</th> <th>Exemption</th> </tr> </thead> <tbody> <tr> <td>H</td> <td>Homestead</td> <td>Yes</td> <td>1,000</td> <td>1,000</td> </tr> </tbody> </table>					Code	Type	Active	Maximum	Exemption	H	Homestead	Yes	1,000	1,000	<table border="1"> <thead> <tr> <th>Bk/Pg</th> <th>Grantor</th> <th>Date</th> <th>Price</th> <th>Code</th> </tr> </thead> <tbody> <tr> <td>1017/177</td> <td>WYLIE CONSTRUCTION CO</td> <td>02/23/1996</td> <td>27,000</td> <td>No</td> </tr> </tbody> </table>					Bk/Pg	Grantor	Date	Price	Code	1017/177	WYLIE CONSTRUCTION CO	02/23/1996	27,000	No																																																																																												
Code	Type	Active	Maximum	Exemption																																																																																																																					
H	Homestead	Yes	1,000	1,000																																																																																																																					
Bk/Pg	Grantor	Date	Price	Code																																																																																																																					
1017/177	WYLIE CONSTRUCTION CO	02/23/1996	27,000	No																																																																																																																					
Parcel Valuation																																																																																																																									
<table border="1"> <thead> <tr> <th>Source</th> <th>REAL</th> <th>Fair Cash</th> <th>Capped</th> <th>Asmnt Level</th> <th>Assessed</th> <th>Levy Rate</th> <th>97.960</th> <th>Current Tax</th> </tr> </thead> <tbody> <tr> <td>Remove Cap</td> <td>0</td> <td>Land Value 99,116</td> <td>74,295</td> <td>11%</td> <td>8,172</td> <td>Assessed</td> <td>32,911</td> <td>3,223.96</td> </tr> <tr> <td>Year Frozen</td> <td>0</td> <td>Improvements 365,370</td> <td>224,899</td> <td></td> <td>24,739</td> <td>Penalty</td> <td>0</td> <td></td> </tr> <tr> <td>Uncapped Value</td> <td>0</td> <td>Mobile Home 0</td> <td>0</td> <td></td> <td>0</td> <td>Exemption</td> <td>1,000</td> <td>-98.00</td> </tr> <tr> <td>TIF Project ID</td> <td>0</td> <td>Total Value 464,486</td> <td>299,194</td> <td></td> <td>32,911</td> <td>Total Taxable</td> <td>31,911</td> <td>3,126.00</td> </tr> </tbody> </table>		Source	REAL	Fair Cash	Capped	Asmnt Level	Assessed	Levy Rate	97.960	Current Tax	Remove Cap	0	Land Value 99,116	74,295	11%	8,172	Assessed	32,911	3,223.96	Year Frozen	0	Improvements 365,370	224,899		24,739	Penalty	0		Uncapped Value	0	Mobile Home 0	0		0	Exemption	1,000	-98.00	TIF Project ID	0	Total Value 464,486	299,194		32,911	Total Taxable	31,911	3,126.00																																																																											
Source	REAL	Fair Cash	Capped	Asmnt Level	Assessed	Levy Rate	97.960	Current Tax																																																																																																																	
Remove Cap	0	Land Value 99,116	74,295	11%	8,172	Assessed	32,911	3,223.96																																																																																																																	
Year Frozen	0	Improvements 365,370	224,899		24,739	Penalty	0																																																																																																																		
Uncapped Value	0	Mobile Home 0	0		0	Exemption	1,000	-98.00																																																																																																																	
TIF Project ID	0	Total Value 464,486	299,194		32,911	Total Taxable	31,911	3,126.00																																																																																																																	
Assessment History																																																																																																																									
<table border="1"> <thead> <tr> <th>Tax Year</th> <th>Statement Number</th> <th>Billed Owner</th> <th>Tax Area</th> <th>Total Value</th> <th>Exemptions</th> <th>Taxable Value</th> <th>Billed Tax</th> </tr> </thead> <tbody> <tr><td>2025</td><td>2025-660016654</td><td>MORT, TIMOTHY R &</td><td>3</td><td>445,171</td><td>1000</td><td>30,952</td><td>3,032.00</td></tr> <tr><td>2024</td><td>2024-660016654</td><td>MORT, TIMOTHY R &</td><td>3</td><td>465,016</td><td>1000</td><td>30,022</td><td>2,884.00</td></tr> <tr><td>2023</td><td>2023-660016654</td><td>MORT, TIMOTHY R &</td><td>3</td><td>464,310</td><td>1000</td><td>29,119</td><td>2,729.00</td></tr> <tr><td>2022</td><td>2022-660016654</td><td>MORT, TIMOTHY R &</td><td>3</td><td>467,026</td><td>1000</td><td>28,241</td><td>2,767.00</td></tr> <tr><td>2021</td><td>2021-660016654</td><td>MORT, TIMOTHY R &</td><td>3</td><td>416,527</td><td>1000</td><td>27,390</td><td>2,650.00</td></tr> <tr><td>2020</td><td>2020-660016654</td><td>MORT, TIMOTHY R &</td><td>3</td><td>411,390</td><td>1000</td><td>26,563</td><td>2,566.00</td></tr> <tr><td>2019</td><td>2019-660016654</td><td>MORT, TIMOTHY R &</td><td>3</td><td>399,067</td><td>2000</td><td>24,761</td><td>2,394.00</td></tr> <tr><td>2018</td><td>2018-660016654</td><td>MORT, TIMOTHY R &</td><td>3</td><td>400,879</td><td>1000</td><td>24,255</td><td>2,258.00</td></tr> <tr><td>2017</td><td>2017-660016654</td><td>MORT, TIMOTHY R &</td><td>3</td><td>398,365</td><td>1000</td><td>23,519</td><td>2,212.00</td></tr> <tr><td>2016</td><td>2016-660016654</td><td>MORT, TIMOTHY R &</td><td>3</td><td>390,513</td><td>1000</td><td>22,805</td><td>2,147.00</td></tr> <tr><td>2015</td><td>2015-660016654</td><td>MORT, TIMOTHY R &</td><td>3</td><td>381,290</td><td>1000</td><td>22,112</td><td>2,097.00</td></tr> <tr><td>2014</td><td>2014-660016654</td><td>MORT, TIMOTHY R &</td><td>3</td><td>386,017</td><td>1000</td><td>21,439</td><td>2,052.00</td></tr> <tr><td>2013</td><td>2013-660016654</td><td>MORT, TIMOTHY R &</td><td>3</td><td>369,056</td><td>1000</td><td>20,786</td><td>1,947.00</td></tr> </tbody> </table>										Tax Year	Statement Number	Billed Owner	Tax Area	Total Value	Exemptions	Taxable Value	Billed Tax	2025	2025-660016654	MORT, TIMOTHY R &	3	445,171	1000	30,952	3,032.00	2024	2024-660016654	MORT, TIMOTHY R &	3	465,016	1000	30,022	2,884.00	2023	2023-660016654	MORT, TIMOTHY R &	3	464,310	1000	29,119	2,729.00	2022	2022-660016654	MORT, TIMOTHY R &	3	467,026	1000	28,241	2,767.00	2021	2021-660016654	MORT, TIMOTHY R &	3	416,527	1000	27,390	2,650.00	2020	2020-660016654	MORT, TIMOTHY R &	3	411,390	1000	26,563	2,566.00	2019	2019-660016654	MORT, TIMOTHY R &	3	399,067	2000	24,761	2,394.00	2018	2018-660016654	MORT, TIMOTHY R &	3	400,879	1000	24,255	2,258.00	2017	2017-660016654	MORT, TIMOTHY R &	3	398,365	1000	23,519	2,212.00	2016	2016-660016654	MORT, TIMOTHY R &	3	390,513	1000	22,805	2,147.00	2015	2015-660016654	MORT, TIMOTHY R &	3	381,290	1000	22,112	2,097.00	2014	2014-660016654	MORT, TIMOTHY R &	3	386,017	1000	21,439	2,052.00	2013	2013-660016654	MORT, TIMOTHY R &	3	369,056	1000	20,786	1,947.00
Tax Year	Statement Number	Billed Owner	Tax Area	Total Value	Exemptions	Taxable Value	Billed Tax																																																																																																																		
2025	2025-660016654	MORT, TIMOTHY R &	3	445,171	1000	30,952	3,032.00																																																																																																																		
2024	2024-660016654	MORT, TIMOTHY R &	3	465,016	1000	30,022	2,884.00																																																																																																																		
2023	2023-660016654	MORT, TIMOTHY R &	3	464,310	1000	29,119	2,729.00																																																																																																																		
2022	2022-660016654	MORT, TIMOTHY R &	3	467,026	1000	28,241	2,767.00																																																																																																																		
2021	2021-660016654	MORT, TIMOTHY R &	3	416,527	1000	27,390	2,650.00																																																																																																																		
2020	2020-660016654	MORT, TIMOTHY R &	3	411,390	1000	26,563	2,566.00																																																																																																																		
2019	2019-660016654	MORT, TIMOTHY R &	3	399,067	2000	24,761	2,394.00																																																																																																																		
2018	2018-660016654	MORT, TIMOTHY R &	3	400,879	1000	24,255	2,258.00																																																																																																																		
2017	2017-660016654	MORT, TIMOTHY R &	3	398,365	1000	23,519	2,212.00																																																																																																																		
2016	2016-660016654	MORT, TIMOTHY R &	3	390,513	1000	22,805	2,147.00																																																																																																																		
2015	2015-660016654	MORT, TIMOTHY R &	3	381,290	1000	22,112	2,097.00																																																																																																																		
2014	2014-660016654	MORT, TIMOTHY R &	3	386,017	1000	21,439	2,052.00																																																																																																																		
2013	2013-660016654	MORT, TIMOTHY R &	3	369,056	1000	20,786	1,947.00																																																																																																																		



Rogers

Assessment Property Record Card for Tax Year 2026

Data provided by LISA DELOZIER County Assessor

Date 04/16/2026
Time 22:20:18
Page 2

Lot Data		Square-Foot - NBHD 1106 #1		Primary Image				
Lot Size								
Lot Count								
Units Buildable	2							
Non-Ag Acres	2.444							
Topography								
Street Access								
Utilities								
Amenities		0						
		0						
Method	Square-Foot							
Base Lot Value	106,459.00 x .93 = 99,116							
Factor Value								
Adjustments	1.0000							
Lot Value	99,116							
Residential Data				\\tsclient\C\Users\Randy Necessary\Pictures\101_0510\IMG_0018. 5/10/2022				
Type	1 Single Family Residence			GRM Approach				
Condition	3 - Average			GRM Code				
Quality	3 - Average			Gross Rent 0.00				
Architecture				Indicated Value				
Style	100% 1 1/2 Story Finished			Multiple Regression				
Exterior Wall	90% Veneer, Masonry 10% Frame, Siding, Wood			MRA Code 1 Test				
Base/Total Area	2,066 / 3,550			Adusted R 0.8445				
Style	100% 1 1/2 Story Finished			Indicated Value 424,182 119.49 Per SqFt				
HVAC	100% Warmed & Cooled Air			Direct Comparables				
Roof Cover	1 Composition Shingle			Selection Model A Adam Test				
Area on Slab	2,066			Adjustment Model 1 2022 Residential				
Fixture/RghIn	14 /			Comparables				
Bed/F/H Bath	4 / 2.5 /			Indicated Value				
Basement Area				Value Reconciliation				
Garage Type	702 Attached Garage - Unfinished			Selected Approach Cost Approach				
Remodel				Improvements 309,983				
Year/Eff Age	1997 / 22			Lot Value 99,116				
Cost Approach		Manual : 01/2025		Indicated Value 409,099 115.24 Per SqFt				
Base Cost	88.97	Total Misc Impr	+ 12,553	Agland Value				
Roofing Adj	+ 2.71	Garage Cost	+ 20,990	Site Improvements 55,387				
Subfloor Adj	+ -1.27	Total RCN	= 418,896	Total Value 464,486 130.84 Total Value Per SqFt				
Heat/Cool Adj	+ 12.64	Depreciation (26%)	- 108,913					
Plumbing Adj	+ 5.50	Lump Sums	+ 0					
Basement Adj	+ 0.00	RCNLD	= 309,983					
Adj Base Cost	= 108.55	Lot Value	+ 99,116					
Total Area	x 3,550	Indicated Value	= 409,099					
Adjusted Cost	= 385,353	Value Per SqFt	115.24					
Miscellaneous Improvements								
Code	Description	Sketch ID	Size	Year	Units	Unit Cost	Depr	Value
PRCH	SLAB PORCH - COVERED	39864	43x7		301	25.99		7,823
PATO	SLAB PORCH - OPEN	39866	50x11		550	8.60		4,730



Rogers

Assessment Property Record Card for Tax Year 2026

Data provided by LISA DELOZIER County Assessor

Date 04/16/2026

Time 22:20:18

Page 3

Sketch Image

660016654

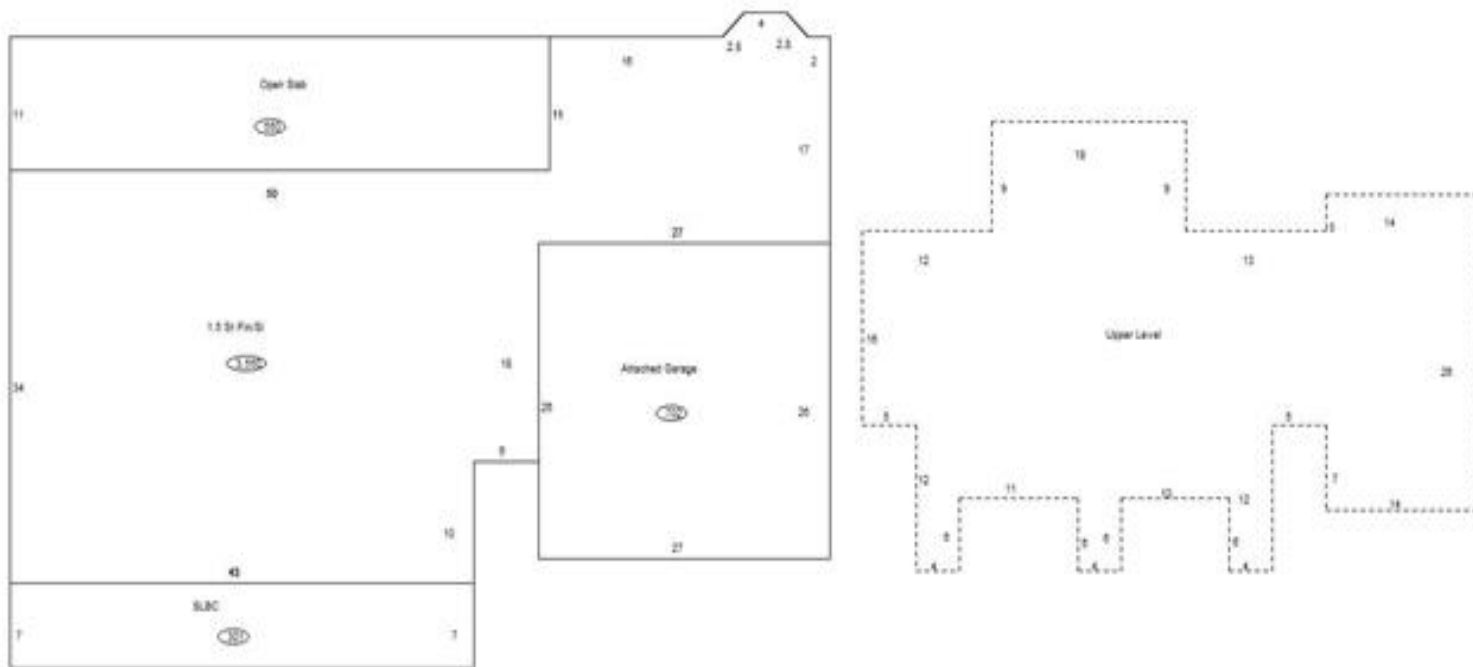

Sketch Vector Information

Sequence	Code	Type	Built Over	Scale	Section Label	Base Area	Multiplier	Total Area
1	R	5	Slab	10	1.5 St Fin/SI	2,066	1.718	3,550
2	G	1		10	Attached Garage	702	1.000	702
3	M	PRCH		10	SLBC	301	1.000	301
4	U	^UL	Overhang	10	Upper Level	1,484	1.000	1,484
5	M	PATO		10	Open Slab	550	1.000	550
Total Building Area						2,066		3,550



Rogers

Assessment Property Record Card for Tax Year 2026

Data provided by LISA DELOZIER County Assessor

Date 04/16/2026
 Time 22:20:18
 Page 4

660016654

Outbuildings/Site Improvements

Building Image	Code	Description	Dimensions	Floor	Roofing	Total Units
	UTIL	SHOP BUILDING	42x20x0			840
	Qual 2	Cond 3	Year 2018	Eff Age	6	
	Valuation Summary		Modifier Total		RCN	Depr (11% Phys/ % Func)
Base Cost (32.93 x 840)		27,661		27,661	3,043	24,618
	UTIL	SHOP BUILDING	0x0x0			960
	Qual 2	Cond 3	Year	Eff Age		
	Valuation Summary		Modifier Total		RCN	Depr (1% Phys/ % Func)
Base Cost (31.28 x 960)		30,029		30,029	300	29,729
	LT	LEAN-TO	0x0x0			360
	Qual 3	Cond 3	Year	Eff Age		
	Valuation Summary		Modifier Total		RCN	Depr (1% Phys/ % Func)
Base Cost (2.92 x 360)		1,051		1,051	11	1,040
	LT	LEAN-TO	0x0x0			
	Qual 2	Cond 3	Year	Eff Age		
	Valuation Summary		Modifier Total		RCN	Depr (100% Phys/ % Func)
Base Cost (2.92 x)						