



Rogers

Assessment Property Record Card for Tax Year 2026

Data provided by LISA DELOZIER County Assessor

Date 04/17/2026
 Time 09:18:50
 Page 1

Assessment Data					Primary Image																																																																																																																				
Account 660016657 Parcel ID 000000-00-0-00150-002-0007 Cadastral ID 18-21-15-02840 Property Type REAL - Real Property Property Class RRP VI Area 4 Tax Area 3 - OWASSO RURAL/NO FIRE Name ID 318400 RONQUILLO, KERRY K & KATHERINE E 4976 E 490 RD CLAREMORE OK 74019-0000 Parcel Location Situs 04976 E 490 RD Subdivision CHAPARRAL ESTATES 1 Lot/Block 0007 / 0002 Parcel Size 1 - Lots Sec/Twn/Rng 18 / 21 / 15 / 5 Neighborhood 1106 - R-V01,4-SW CLAREMORE School District S021 - OWASSO SCHOOLS																																																																																																																									
Legal Description Lat/Long: 36.30726579 -95.74388592																																																																																																																									
Legal Description N/2 LOTS 6 & 7 BLOCK 2 CHAPARRAL ESTATES I.					Building Permits <table border="1"> <thead> <tr> <th>Number</th> <th>Description</th> <th>Opened</th> <th>Closed</th> <th>Amount</th> </tr> </thead> <tbody> <tr> <td>R18 000028</td> <td>R19- DTCHD ACC BLDG 40X50</td> <td>02/2018</td> <td>05/2018</td> <td>26,000</td> </tr> </tbody> </table>					Number	Description	Opened	Closed	Amount	R18 000028	R19- DTCHD ACC BLDG 40X50	02/2018	05/2018	26,000																																																																																																						
Number	Description	Opened	Closed	Amount																																																																																																																					
R18 000028	R19- DTCHD ACC BLDG 40X50	02/2018	05/2018	26,000																																																																																																																					
Exemptions <table border="1"> <thead> <tr> <th>Code</th> <th>Type</th> <th>Active</th> <th>Maximum</th> <th>Exemption</th> </tr> </thead> <tbody> <tr> <td>H</td> <td>Homestead</td> <td>Yes</td> <td>1,000</td> <td>1,000</td> </tr> <tr> <td>H</td> <td>Homestead</td> <td>No</td> <td>1,000</td> <td></td> </tr> </tbody> </table>					Code	Type	Active	Maximum	Exemption	H	Homestead	Yes	1,000	1,000	H	Homestead	No	1,000		Sale History <table border="1"> <thead> <tr> <th>Bk/Pg</th> <th>Grantor</th> <th>Date</th> <th>Price</th> <th>Code</th> </tr> </thead> <tbody> <tr> <td>2551/394</td> <td>IVEY, RONALD D</td> <td>05/16/2016</td> <td>360,000</td> <td>YES</td> </tr> <tr> <td>1831/449</td> <td>ATKINSON, MAY</td> <td>11/28/2006</td> <td>345,000</td> <td>YES</td> </tr> <tr> <td>1135/293</td> <td>LARSEN, BRETT C & SHERRIE-K</td> <td>09/25/1998</td> <td>40,000</td> <td>No</td> </tr> <tr> <td>1007/156</td> <td>WYLIE CONSTRUCTION CO</td> <td>10/30/1995</td> <td>22,500</td> <td>No</td> </tr> </tbody> </table>					Bk/Pg	Grantor	Date	Price	Code	2551/394	IVEY, RONALD D	05/16/2016	360,000	YES	1831/449	ATKINSON, MAY	11/28/2006	345,000	YES	1135/293	LARSEN, BRETT C & SHERRIE-K	09/25/1998	40,000	No	1007/156	WYLIE CONSTRUCTION CO	10/30/1995	22,500	No																																																																								
Code	Type	Active	Maximum	Exemption																																																																																																																					
H	Homestead	Yes	1,000	1,000																																																																																																																					
H	Homestead	No	1,000																																																																																																																						
Bk/Pg	Grantor	Date	Price	Code																																																																																																																					
2551/394	IVEY, RONALD D	05/16/2016	360,000	YES																																																																																																																					
1831/449	ATKINSON, MAY	11/28/2006	345,000	YES																																																																																																																					
1135/293	LARSEN, BRETT C & SHERRIE-K	09/25/1998	40,000	No																																																																																																																					
1007/156	WYLIE CONSTRUCTION CO	10/30/1995	22,500	No																																																																																																																					
Parcel Valuation <table border="1"> <thead> <tr> <th>Source</th> <th>REAL</th> <th>Fair Cash</th> <th>Capped</th> <th>Asmnt Level</th> <th>Assessed</th> <th>Levy Rate</th> <th>97.960</th> <th>Current Tax</th> </tr> </thead> <tbody> <tr> <td>Remove Cap</td> <td>2017</td> <td>Land Value 101,840</td> <td>75,091</td> <td>11%</td> <td>8,260</td> <td>Assessed</td> <td>50,881</td> <td>4,984.30</td> </tr> <tr> <td>Year Frozen</td> <td>0</td> <td>Improvements 464,408</td> <td>387,465</td> <td></td> <td>42,621</td> <td>Penalty</td> <td>0</td> <td></td> </tr> <tr> <td>Uncapped Value</td> <td>0</td> <td>Mobile Home 0</td> <td>0</td> <td></td> <td>0</td> <td>Exemption</td> <td>1,000</td> <td>-98.00</td> </tr> <tr> <td>TIF Project ID</td> <td>0</td> <td>Total Value 566,248</td> <td>462,556</td> <td></td> <td>50,881</td> <td>Total Taxable</td> <td>49,881</td> <td>4,886.00</td> </tr> </tbody> </table>										Source	REAL	Fair Cash	Capped	Asmnt Level	Assessed	Levy Rate	97.960	Current Tax	Remove Cap	2017	Land Value 101,840	75,091	11%	8,260	Assessed	50,881	4,984.30	Year Frozen	0	Improvements 464,408	387,465		42,621	Penalty	0		Uncapped Value	0	Mobile Home 0	0		0	Exemption	1,000	-98.00	TIF Project ID	0	Total Value 566,248	462,556		50,881	Total Taxable	49,881	4,886.00																																																																			
Source	REAL	Fair Cash	Capped	Asmnt Level	Assessed	Levy Rate	97.960	Current Tax																																																																																																																	
Remove Cap	2017	Land Value 101,840	75,091	11%	8,260	Assessed	50,881	4,984.30																																																																																																																	
Year Frozen	0	Improvements 464,408	387,465		42,621	Penalty	0																																																																																																																		
Uncapped Value	0	Mobile Home 0	0		0	Exemption	1,000	-98.00																																																																																																																	
TIF Project ID	0	Total Value 566,248	462,556		50,881	Total Taxable	49,881	4,886.00																																																																																																																	
Assessment History <table border="1"> <thead> <tr> <th>Tax Year</th> <th>Statement Number</th> <th>Billed Owner</th> <th>Tax Area</th> <th>Total Value</th> <th>Exemptions</th> <th>Taxable Value</th> <th>Billed Tax</th> </tr> </thead> <tbody> <tr><td>2025</td><td>2025-660016657</td><td>RONQUILLO, KERRY K &</td><td>3</td><td>532,240</td><td>1000</td><td>48,398</td><td>4,741.00</td></tr> <tr><td>2024</td><td>2024-660016657</td><td>RONQUILLO, KERRY K &</td><td>3</td><td>554,571</td><td>1000</td><td>46,961</td><td>4,512.00</td></tr> <tr><td>2023</td><td>2023-660016657</td><td>RONQUILLO, KERRY K &</td><td>3</td><td>469,439</td><td>1000</td><td>45,564</td><td>4,270.00</td></tr> <tr><td>2022</td><td>2022-660016657</td><td>RONQUILLO, KERRY K &</td><td>3</td><td>463,104</td><td>1000</td><td>44,207</td><td>4,331.00</td></tr> <tr><td>2021</td><td>2021-660016657</td><td>RONQUILLO, KERRY K &</td><td>3</td><td>399,006</td><td>1000</td><td>42,891</td><td>4,149.00</td></tr> <tr><td>2020</td><td>2020-660016657</td><td>RONQUILLO, KERRY K &</td><td>3</td><td>396,737</td><td>1000</td><td>42,131</td><td>4,070.00</td></tr> <tr><td>2019</td><td>2019-660016657</td><td>RONQUILLO, KERRY K &</td><td>3</td><td>380,677</td><td>1000</td><td>40,874</td><td>3,951.00</td></tr> <tr><td>2018</td><td>2018-660016657</td><td>RONQUILLO, KERRY K &</td><td>3</td><td>374,358</td><td>1000</td><td>40,179</td><td>3,740.00</td></tr> <tr><td>2017</td><td>2017-660016657</td><td>RONQUILLO, KERRY K &</td><td>3</td><td>371,256</td><td>1000</td><td>39,838</td><td>3,747.00</td></tr> <tr><td>2016</td><td>2016-660016657</td><td>RONQUILLO, KERRY K &</td><td>3</td><td>405,266</td><td>0</td><td>44,579</td><td>4,197.00</td></tr> <tr><td>2015</td><td>2015-660016657</td><td>IVEY, RONALD D</td><td>3</td><td>394,920</td><td>1000</td><td>42,441</td><td>4,025.00</td></tr> <tr><td>2014</td><td>2014-660016657</td><td>IVEY, RONALD D</td><td>3</td><td>402,680</td><td>1000</td><td>41,395</td><td>3,962.00</td></tr> <tr><td>2013</td><td>2013-660016657</td><td>IVEY, RONALD D</td><td>3</td><td>382,757</td><td>1000</td><td>40,160</td><td>3,762.00</td></tr> </tbody> </table>										Tax Year	Statement Number	Billed Owner	Tax Area	Total Value	Exemptions	Taxable Value	Billed Tax	2025	2025-660016657	RONQUILLO, KERRY K &	3	532,240	1000	48,398	4,741.00	2024	2024-660016657	RONQUILLO, KERRY K &	3	554,571	1000	46,961	4,512.00	2023	2023-660016657	RONQUILLO, KERRY K &	3	469,439	1000	45,564	4,270.00	2022	2022-660016657	RONQUILLO, KERRY K &	3	463,104	1000	44,207	4,331.00	2021	2021-660016657	RONQUILLO, KERRY K &	3	399,006	1000	42,891	4,149.00	2020	2020-660016657	RONQUILLO, KERRY K &	3	396,737	1000	42,131	4,070.00	2019	2019-660016657	RONQUILLO, KERRY K &	3	380,677	1000	40,874	3,951.00	2018	2018-660016657	RONQUILLO, KERRY K &	3	374,358	1000	40,179	3,740.00	2017	2017-660016657	RONQUILLO, KERRY K &	3	371,256	1000	39,838	3,747.00	2016	2016-660016657	RONQUILLO, KERRY K &	3	405,266	0	44,579	4,197.00	2015	2015-660016657	IVEY, RONALD D	3	394,920	1000	42,441	4,025.00	2014	2014-660016657	IVEY, RONALD D	3	402,680	1000	41,395	3,962.00	2013	2013-660016657	IVEY, RONALD D	3	382,757	1000	40,160	3,762.00
Tax Year	Statement Number	Billed Owner	Tax Area	Total Value	Exemptions	Taxable Value	Billed Tax																																																																																																																		
2025	2025-660016657	RONQUILLO, KERRY K &	3	532,240	1000	48,398	4,741.00																																																																																																																		
2024	2024-660016657	RONQUILLO, KERRY K &	3	554,571	1000	46,961	4,512.00																																																																																																																		
2023	2023-660016657	RONQUILLO, KERRY K &	3	469,439	1000	45,564	4,270.00																																																																																																																		
2022	2022-660016657	RONQUILLO, KERRY K &	3	463,104	1000	44,207	4,331.00																																																																																																																		
2021	2021-660016657	RONQUILLO, KERRY K &	3	399,006	1000	42,891	4,149.00																																																																																																																		
2020	2020-660016657	RONQUILLO, KERRY K &	3	396,737	1000	42,131	4,070.00																																																																																																																		
2019	2019-660016657	RONQUILLO, KERRY K &	3	380,677	1000	40,874	3,951.00																																																																																																																		
2018	2018-660016657	RONQUILLO, KERRY K &	3	374,358	1000	40,179	3,740.00																																																																																																																		
2017	2017-660016657	RONQUILLO, KERRY K &	3	371,256	1000	39,838	3,747.00																																																																																																																		
2016	2016-660016657	RONQUILLO, KERRY K &	3	405,266	0	44,579	4,197.00																																																																																																																		
2015	2015-660016657	IVEY, RONALD D	3	394,920	1000	42,441	4,025.00																																																																																																																		
2014	2014-660016657	IVEY, RONALD D	3	402,680	1000	41,395	3,962.00																																																																																																																		
2013	2013-660016657	IVEY, RONALD D	3	382,757	1000	40,160	3,762.00																																																																																																																		



Rogers

Assessment Property Record Card for Tax Year 2026

Data provided by LISA DELOZIER County Assessor

Date 04/17/2026
Time 09:18:50
Page 2

Lot Data	Square-Foot - NBHD 1106 #1	Primary Image
Lot Size Lot Count Units Buildable 1 Non-Ag Acres 2.6226 Topography Street Access Utilities Amenities 0 Method Square-Foot Base Lot Value 114,241.00 x .89 = 101,840 Factor Value Adjustments 1.0000 Lot Value 101,840		

Residential Data	
Type	1 Single Family Residence
Condition	3 - Average
Quality	3.5 - Average
Architecture	
Style	100% 1 1/2 Story Finished
Exterior Wall	70% Veneer, Masonry 30% Frame, Siding, Vinyl
Base/Total Area	3,066 / 3,788
Style	100% 1 1/2 Story Finished
HVAC	100% Warmed & Cooled Air
Roof Cover	1 Composition Shingle
Area on Slab	3,066
Fixture/RghIn	14 /
Bed/F/H Bath	4 / 3.0 /
Basement Area	
Garage Type	834 Attached Garage - Unfinished
Remodel	
Year/Eff Age	2000 / 20

\\tsclient\C\Users\Randy Necessary\Pictures\101_0510\IMG_0034. 5/11/2022

GRM Approach	
GRM Code	
Gross Rent	0.00
Indicated Value	

Multiple Regression			
MRA Code	1	Test	
Adjusted R	0.8445		
Indicated Value	583,138	153.94	Per SqFt

Direct Comparables	
Selection Model	A Adam Test
Adjustment Model	1 2022 Residential
Comparables	
Indicated Value	

Cost Approach				Manual : 01/2025			
Base Cost	93.37	Total Misc Impr	+ 10,264				
Roofing Adj	+ 4.04	Garage Cost	+ 31,033				
Subfloor Adj	+ -2.60	Total RCN	= 477,599				
Heat/Cool Adj	+ 14.47	Depreciation (31%)	- 148,056				
Plumbing Adj	+ 5.90	Lump Sums	+ 0				
Basement Adj	+ 0.00	RCNLD	= 329,543				
Adj Base Cost	= 115.18	Lot Value	+ 101,840				
Total Area	x 3,788	Indicated Value	= 431,383				
Adjusted Cost	= 436,302	Value Per SqFt	113.88				

Value Reconciliation			
Selected Approach	Cost Approach		
Improvements	329,543		
Lot Value	101,840		
Indicated Value	431,383	113.88	Per SqFt
Agland Value			
Site Improvements	134,865		
Total Value	566,248	149.48	Total Value Per SqFt

Miscellaneous Improvements							
Code	Description	Sketch ID	Size	Year	Units	Unit Cost	Depr Value
SHLT	STORM SHELTER	0		1 2017	1	0.00	
PRCH	SLAB PORCH - COVERED	39869	120		120	29.13	3,496
PRCH	SLAB PORCH - COVERED	39870	236		236	28.68	6,768



Rogers

Assessment Property Record Card for Tax Year 2026

Data provided by LISA DELOZIER County Assessor

Date 04/17/2026

Time 09:18:50

Page 3

Sketch Image

660016657

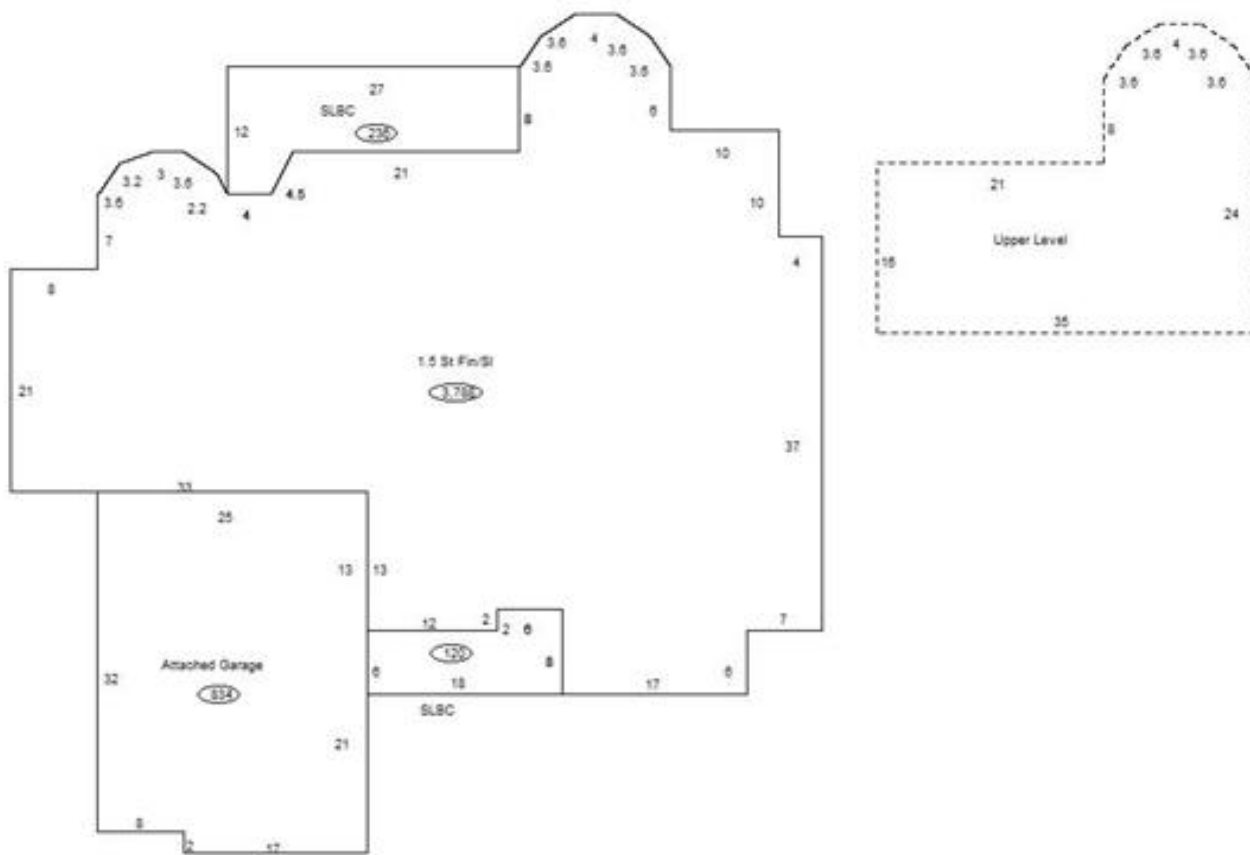

Sketch Vector Information

Sequence	Code	Type	Built Over	Scale	Section Label	Base Area	Multiplier	Total Area
1	R	5	Slab	13	1.5 St Fin/SI	3,066	1.235	3,788
2	G	1		13	Attached Garage	834	1.000	834
3	M	PRCH		13	SLBC	120	1.000	120
4	M	PRCH		13	SLBC	236	1.000	236
5	U	^UL		13	Upper Level	722	1.000	722
Total Building Area						3,066		3,788



Rogers





Assessment Property Record Card for Tax Year 2026

Data provided by LISA DELOZIER County Assessor

Date 04/17/2026
 Time 09:18:50
 Page 4

660016657

Outbuildings/Site Improvements

Building Image	Code	Description	Dimensions	Floor	Roofing	Total Units	
	UTIL	SHOP BUILDING	110x40x0			4,400	
	Qual 2	Cond 3	Year 2008	Eff Age			
	Valuation Summary		Modifier Total	RCN	Depr (1% Phys/ % Func)	RCNLD	
	Base Cost (23.47 x 4,400)		103,268		103,268	1,033	102,235
	GRDT	GARAGE - DETACHED	0x0x0			625	
	Qual 3	Cond 3	Year	Eff Age			
	Valuation Summary		Modifier Total	RCN	Depr (5% Phys/ % Func)	RCNLD	
	Base Cost (27.78 x 625)		17,363		17,363	868	16,495
	GRC	Apartment Garages, Detached	0x0x0			625	
	Qual 3	Cond 3	Year	Eff Age			
	Valuation Summary		Modifier Total	RCN	Depr (5% Phys/ % Func)	RCNLD	
	Base Cost (25.86 x 625)		16,163		16,163	808	15,355
	LT	LEAN-TO	15x18x0			270	
	Qual 3	Cond 3	Year	Eff Age			
	Valuation Summary		Modifier Total	RCN	Depr (1% Phys/ % Func)	RCNLD	
	Base Cost (2.92 x 270)		788		788	8	780