



# Rogers

## Assessment Property Record Card for Tax Year 2026

Data provided by LISA DELOZIER County Assessor

Date 04/16/2026  
Time 23:26:05  
Page 1

Assessment Data					Primary Image																																																																																																																			
<b>Account</b> 660016676 <b>Parcel ID</b> 000000-00-0-10190-001-0001 <b>Cadastral ID</b> 18-21-16-01640 <b>Property Type</b> REAL - Real Property <b>Property Class</b> URP VI Area 1 <b>Tax Area</b> 17 - CLAREMORE OT <b>Name ID</b> 319778 BARNES, MICHAEL L & HOLLIE  712 CHRISTMAS LN CLAREMORE OK 74017-0000  <b>Parcel Location</b> <b>Situs</b> 00712 CHRISTMAS LN <b>Subdivision</b> HOLIDAY HILLS <b>Lot/Block</b> 0001 / 0001 <b>Parcel Size</b> 1 - Lots <b>Sec/Twn/Rng</b> 18 / 21 / 16 / 5 <b>Neighborhood</b> 1170 - R-V01-SW CLAREMORE <b>School District</b> S001 - CLAREMORE SCHOOLS					<p>\\tsclient\T\LOGAN\LOGAN RESIDENTIAL VI\2023-9-6\IMG_0001. 9/6/2023</p>																																																																																																																			
<b>Legal Description</b> Lot/Long: 36.30691781 -95.63685524 LOT 1 BLOCK 1 HOLIDAY HILLS																																																																																																																								
<b>Exemptions</b> <table border="1"> <thead> <tr> <th>Code</th> <th>Type</th> <th>Active</th> <th>Maximum</th> <th>Exemption</th> </tr> </thead> <tbody> <tr> <td>H</td> <td>Homestead</td> <td>No</td> <td>1,000</td> <td></td> </tr> </tbody> </table>					Code	Type	Active	Maximum	Exemption	H	Homestead	No	1,000		<b>Building Permits</b> <table border="1"> <thead> <tr> <th>Number</th> <th>Description</th> <th>Opened</th> <th>Closed</th> <th>Amount</th> </tr> </thead> <tbody> <tr> <td></td> <td></td> <td></td> <td></td> <td></td> </tr> </tbody> </table>					Number	Description	Opened	Closed	Amount																																																																																																
Code	Type	Active	Maximum	Exemption																																																																																																																				
H	Homestead	No	1,000																																																																																																																					
Number	Description	Opened	Closed	Amount																																																																																																																				
<b>Parcel Valuation</b> <table border="1"> <thead> <tr> <th>Source</th> <th>REAL</th> <th>Fair Cash</th> <th>Capped</th> <th>Asmnt Level</th> <th>Assessed</th> <th>Levy Rate</th> <th>92.430</th> <th>Current Tax</th> </tr> </thead> <tbody> <tr> <td>Remove Cap</td> <td>2017</td> <td>Land Value 65,571</td> <td>52,610</td> <td>11%</td> <td>5,787</td> <td>Assessed</td> <td>22,046</td> <td>2,037.71</td> </tr> <tr> <td>Year Frozen</td> <td>0</td> <td>Improvements 154,532</td> <td>147,805</td> <td></td> <td>16,259</td> <td>Penalty</td> <td>0</td> <td></td> </tr> <tr> <td>Uncapped Value</td> <td>0</td> <td>Mobile Home 0</td> <td>0</td> <td></td> <td>0</td> <td>Exemption</td> <td>0</td> <td>0.00</td> </tr> <tr> <td>TIF Project ID</td> <td>0</td> <td>Total Value 220,103</td> <td>200,415</td> <td></td> <td>22,046</td> <td>Total Taxable</td> <td>22,046</td> <td>2,038.00</td> </tr> </tbody> </table>					Source	REAL	Fair Cash	Capped	Asmnt Level	Assessed	Levy Rate	92.430	Current Tax	Remove Cap	2017	Land Value 65,571	52,610	11%	5,787	Assessed	22,046	2,037.71	Year Frozen	0	Improvements 154,532	147,805		16,259	Penalty	0		Uncapped Value	0	Mobile Home 0	0		0	Exemption	0	0.00	TIF Project ID	0	Total Value 220,103	200,415		22,046	Total Taxable	22,046	2,038.00	<b>Sale History</b> <table border="1"> <thead> <tr> <th>Bk/Pg</th> <th>Grantor</th> <th>Date</th> <th>Price</th> <th>Code</th> </tr> </thead> <tbody> <tr> <td>2586/212</td> <td>HEREFORD, RICHARD DALE &amp;</td> <td>10/19/2016</td> <td>152,000</td> <td>YES</td> </tr> <tr> <td>2482/606</td> <td>HEREFORD, RICHARD DALE</td> <td>06/26/2015</td> <td>0</td> <td>4</td> </tr> </tbody> </table>					Bk/Pg	Grantor	Date	Price	Code	2586/212	HEREFORD, RICHARD DALE &	10/19/2016	152,000	YES	2482/606	HEREFORD, RICHARD DALE	06/26/2015	0	4																																																			
Source	REAL	Fair Cash	Capped	Asmnt Level	Assessed	Levy Rate	92.430	Current Tax																																																																																																																
Remove Cap	2017	Land Value 65,571	52,610	11%	5,787	Assessed	22,046	2,037.71																																																																																																																
Year Frozen	0	Improvements 154,532	147,805		16,259	Penalty	0																																																																																																																	
Uncapped Value	0	Mobile Home 0	0		0	Exemption	0	0.00																																																																																																																
TIF Project ID	0	Total Value 220,103	200,415		22,046	Total Taxable	22,046	2,038.00																																																																																																																
Bk/Pg	Grantor	Date	Price	Code																																																																																																																				
2586/212	HEREFORD, RICHARD DALE &	10/19/2016	152,000	YES																																																																																																																				
2482/606	HEREFORD, RICHARD DALE	06/26/2015	0	4																																																																																																																				
<b>Assessment History</b> <table border="1"> <thead> <tr> <th>Tax Year</th> <th>Statement Number</th> <th>Billed Owner</th> <th>Tax Area</th> <th>Total Value</th> <th>Exemptions</th> <th>Taxable Value</th> <th>Billed Tax</th> </tr> </thead> <tbody> <tr><td>2025</td><td>2025-660016676</td><td>BARNES, MICHAEL L &amp; HOLLIE</td><td>17</td><td>208,001</td><td>0</td><td>20,997</td><td>1,941.00</td></tr> <tr><td>2024</td><td>2024-660016676</td><td>BARNES, MICHAEL L &amp; HOLLIE</td><td>17</td><td>202,024</td><td>0</td><td>19,996</td><td>1,848.00</td></tr> <tr><td>2023</td><td>2023-660016676</td><td>BARNES, MICHAEL L &amp; HOLLIE</td><td>17</td><td>183,163</td><td>0</td><td>19,044</td><td>1,744.00</td></tr> <tr><td>2022</td><td>2022-660016676</td><td>BARNES, MICHAEL L &amp; HOLLIE</td><td>17</td><td>164,884</td><td>0</td><td>18,137</td><td>1,679.00</td></tr> <tr><td>2021</td><td>2021-660016676</td><td>BARNES, MICHAEL L &amp; HOLLIE</td><td>17</td><td>161,611</td><td>0</td><td>17,692</td><td>1,562.00</td></tr> <tr><td>2020</td><td>2020-660016676</td><td>BARNES, MICHAEL L &amp; HOLLIE</td><td>17</td><td>153,180</td><td>0</td><td>16,850</td><td>1,543.00</td></tr> <tr><td>2019</td><td>2019-660016676</td><td>BARNES, MICHAEL L &amp; HOLLIE</td><td>17</td><td>148,664</td><td>0</td><td>16,354</td><td>1,515.00</td></tr> <tr><td>2018</td><td>2018-660016676</td><td>BARNES, MICHAEL L &amp; HOLLIE</td><td>17</td><td>156,235</td><td>0</td><td>17,186</td><td>1,588.00</td></tr> <tr><td>2017</td><td>2017-660016676</td><td>BARNES, MICHAEL L &amp; HOLLIE</td><td>17</td><td>155,106</td><td>0</td><td>17,062</td><td>1,567.00</td></tr> <tr><td>2016</td><td>2016-660016676</td><td>HEREFORD, RICHARD DALE &amp;</td><td>17</td><td>121,221</td><td>1000</td><td>10,874</td><td>1,021.00</td></tr> <tr><td>2015</td><td>2015-660016676</td><td>HEREFORD, RICHARD DALE &amp;</td><td>17</td><td>117,859</td><td>1000</td><td>10,528</td><td>950.00</td></tr> <tr><td>2014</td><td>2014-660016676</td><td>HEREFORD, RICHARD DALE</td><td>17</td><td>118,809</td><td>1000</td><td>10,193</td><td>945.00</td></tr> <tr><td>2013</td><td>2013-660016676</td><td>HEREFORD, RICHARD DALE</td><td>17</td><td>113,912</td><td>1000</td><td>9,867</td><td>903.00</td></tr> </tbody> </table>									Tax Year	Statement Number	Billed Owner	Tax Area	Total Value	Exemptions	Taxable Value	Billed Tax	2025	2025-660016676	BARNES, MICHAEL L & HOLLIE	17	208,001	0	20,997	1,941.00	2024	2024-660016676	BARNES, MICHAEL L & HOLLIE	17	202,024	0	19,996	1,848.00	2023	2023-660016676	BARNES, MICHAEL L & HOLLIE	17	183,163	0	19,044	1,744.00	2022	2022-660016676	BARNES, MICHAEL L & HOLLIE	17	164,884	0	18,137	1,679.00	2021	2021-660016676	BARNES, MICHAEL L & HOLLIE	17	161,611	0	17,692	1,562.00	2020	2020-660016676	BARNES, MICHAEL L & HOLLIE	17	153,180	0	16,850	1,543.00	2019	2019-660016676	BARNES, MICHAEL L & HOLLIE	17	148,664	0	16,354	1,515.00	2018	2018-660016676	BARNES, MICHAEL L & HOLLIE	17	156,235	0	17,186	1,588.00	2017	2017-660016676	BARNES, MICHAEL L & HOLLIE	17	155,106	0	17,062	1,567.00	2016	2016-660016676	HEREFORD, RICHARD DALE &	17	121,221	1000	10,874	1,021.00	2015	2015-660016676	HEREFORD, RICHARD DALE &	17	117,859	1000	10,528	950.00	2014	2014-660016676	HEREFORD, RICHARD DALE	17	118,809	1000	10,193	945.00	2013	2013-660016676	HEREFORD, RICHARD DALE	17	113,912	1000	9,867	903.00
Tax Year	Statement Number	Billed Owner	Tax Area	Total Value	Exemptions	Taxable Value	Billed Tax																																																																																																																	
2025	2025-660016676	BARNES, MICHAEL L & HOLLIE	17	208,001	0	20,997	1,941.00																																																																																																																	
2024	2024-660016676	BARNES, MICHAEL L & HOLLIE	17	202,024	0	19,996	1,848.00																																																																																																																	
2023	2023-660016676	BARNES, MICHAEL L & HOLLIE	17	183,163	0	19,044	1,744.00																																																																																																																	
2022	2022-660016676	BARNES, MICHAEL L & HOLLIE	17	164,884	0	18,137	1,679.00																																																																																																																	
2021	2021-660016676	BARNES, MICHAEL L & HOLLIE	17	161,611	0	17,692	1,562.00																																																																																																																	
2020	2020-660016676	BARNES, MICHAEL L & HOLLIE	17	153,180	0	16,850	1,543.00																																																																																																																	
2019	2019-660016676	BARNES, MICHAEL L & HOLLIE	17	148,664	0	16,354	1,515.00																																																																																																																	
2018	2018-660016676	BARNES, MICHAEL L & HOLLIE	17	156,235	0	17,186	1,588.00																																																																																																																	
2017	2017-660016676	BARNES, MICHAEL L & HOLLIE	17	155,106	0	17,062	1,567.00																																																																																																																	
2016	2016-660016676	HEREFORD, RICHARD DALE &	17	121,221	1000	10,874	1,021.00																																																																																																																	
2015	2015-660016676	HEREFORD, RICHARD DALE &	17	117,859	1000	10,528	950.00																																																																																																																	
2014	2014-660016676	HEREFORD, RICHARD DALE	17	118,809	1000	10,193	945.00																																																																																																																	
2013	2013-660016676	HEREFORD, RICHARD DALE	17	113,912	1000	9,867	903.00																																																																																																																	



# Rogers

## Assessment Property Record Card for Tax Year 2026

Data provided by LISA DELOZIER County Assessor

Date 04/16/2026  
 Time 23:26:05  
 Page 2

Lot Data		Square-Foot - NBHD 1170 #1	
Lot Size			
Lot Count			
Units Buildable			
Non-Ag Acres	1.0452		
Topography			
Street Access			
Utilities			
Amenities	LAND QUALITY	0	
		0	
Method	Square-Foot		
Base Lot Value	45,530.00 x 1.44 = 65,571		
Factor Value			
Adjustments	1.0000		
Lot Value	65,571		



\\tsclient\T\LOGAN\LOGAN RESIDENTIAL VI\2023-9-6\IMG\_0001. 9/6/2023

Residential Data	
Type	1 Single Family Residence
Condition	3 - Average
Quality	3 - Average
Architecture	
Style	100% One Story
Exterior Wall	100% Veneer, Masonry
Base/Total Area	1,844 / 1,844
Style	100% One Story
HVAC	100% Warmed & Cooled Air
Roof Cover	1 Composition Shingle
Area on Slab	1,844
Fixture/RghIn	8 /
Bed/F/H Bath	3 / 2.0 /
Basement Area	
Garage Type	440 Attached Garage - Unfinished
Remodel	
Year/Eff Age	1963 / 47

GRM Approach	
GRM Code	
Gross Rent	0.00
Indicated Value	

Multiple Regression			
MRA Code	1	Test	
Adusted R	0.8445		
Indicated Value	215,034	116.61	Per SqFt

Direct Comparables			
Selection Model	A	Adam Test	
Adjustment Model	1	2022 Residential	
Comparables	8		
Indicated Value	239,190		Per SqFt

Cost Approach				Manual : 01/2025			
Base Cost	109.34	Total Misc Impr	+ 7,854				
Roofing Adj	+ 4.78	Garage Cost	+ 14,498				
Subfloor Adj	+ -2.28	Total RCN	= 263,381				
Heat/Cool Adj	+ 12.64	Depreciation ( 52%)	- 136,958				
Plumbing Adj	+ 6.23	Lump Sums	+ 0				
Basement Adj	+ 0.00	RCNLD	= 126,423				
Adj Base Cost	= 130.71	Lot Value	+ 65,571				
Total Area	x 1,844	Indicated Value	= 191,994				
Adjusted Cost	= 241,029	Value Per SqFt	104.12				

Value Reconciliation			
Selected Approach	Cost Approach		
Improvements	126,423		
Lot Value	65,571		
Indicated Value	191,994	104.12	Per SqFt
Agland Value			
Site Improvements	28,109		
Total Value	220,103	119.36	Total Value Per SqFt

Miscellaneous Improvements								
Code	Description	Sketch ID	Size	Year	Units	Unit Cost	Depr	Value
FPR1	FIREPLACE - RESIDENTIAL 1 STORY	0		1	1	5,615.40		5,615
PRCH	SLAB PORCH - COVERED	39941	21x4		84	26.66		2,239



# Rogers

## Assessment Property Record Card for Tax Year 2026

Data provided by LISA DELOZIER County Assessor

Date 04/16/2026  
 Time 23:26:05  
 Page 3

Sketch Image

660016676

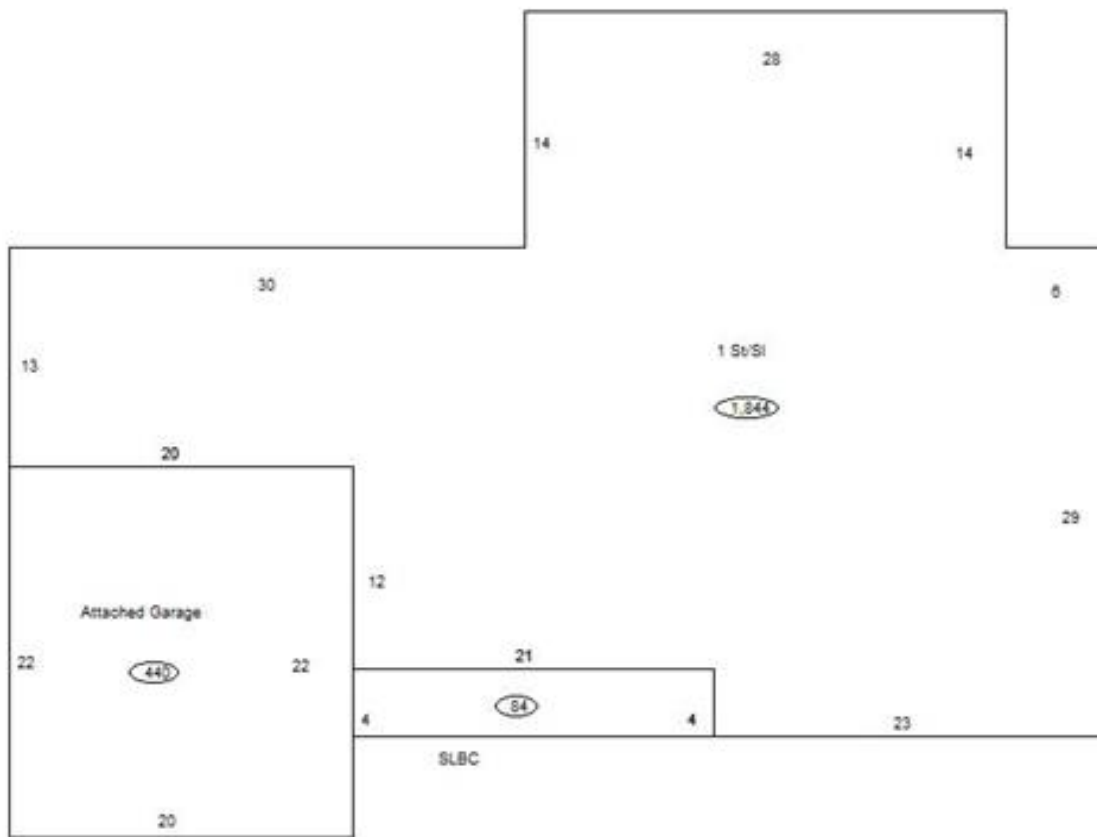

### Sketch Vector Information

Sequence	Code	Type	Built Over	Scale	Section Label	Base Area	Multiplier	Total Area
1	R	1	Slab	10	1 St/SI	1,844	1.000	1,844
2	G	1		10	Attached Garage	440	1.000	440
3	M	PRCH		10	SLBC	84	1.000	84
<b>Total Building Area</b>						1,844		1,844



# Rogers

## Assessment Property Record Card for Tax Year 2026

Data provided by LISA DELOZIER County Assessor

Date 04/16/2026  
Time 23:26:05  
Page 4

660016676

### Outbuildings/Site Improvements

Building Image	Code	Description	Dimensions	Floor	Roofing	Total Units
	UTIL	SHOP BUILDING	0x0x0			1,152
	Qual 2	Cond 3	Year	Eff Age		
		<b>Valuation Summary</b>	<b>Modifier Total</b>	<b>RCN</b>	<b>Depr (20% Phys/ % Func)</b>	<b>RCNLD</b>
		Base Cost (30.50 x 1,152)	35,136	35,136	7,027	28,109