



# Rogers

## Assessment Property Record Card for Tax Year 2026

Data provided by LISA DELOZIER County Assessor

Date 04/16/2026  
Time 23:26:24  
Page 1

Assessment Data					Primary Image																																																																																																																				
<b>Account</b> 660016694 <b>Parcel ID</b> 000000-00-0-10190-001-0016 <b>Cadastral ID</b> 18-21-16-01820 <b>Property Type</b> REAL - Real Property <b>Property Class</b> URP VI Area 1 <b>Tax Area</b> 17 - CLAREMORE OT <b>Name ID</b> 73554 WOOD, PHYLLIS O  2202 FALL LN CLAREMORE OK 74017-0000  <b>Parcel Location</b> <b>Situs</b> 02202 FALL LN <b>Subdivision</b> HOLIDAY HILLS <b>Lot/Block</b> 0016 / 0001 <b>Parcel Size</b> 1 - Lots <b>Sec/Twn/Rng</b> 18 / 21 / 16 / 5 <b>Neighborhood</b> 1170 - R-V01-SW CLAREMORE <b>School District</b> S001 - CLAREMORE SCHOOLS																																																																																																																									
<b>Legal Description</b> Lat/Long: 36.30083997 -95.63553744																																																																																																																									
<b>E2 OF TR 16 BLOCK 1 HOLIDAY HILLS</b>					<b>Building Permits</b> <table border="1"> <thead> <tr> <th>Number</th> <th>Description</th> <th>Opened</th> <th>Closed</th> <th>Amount</th> </tr> </thead> <tbody> <tr> <td colspan="5"> </td> </tr> </tbody> </table>					Number	Description	Opened	Closed	Amount																																																																																																											
Number	Description	Opened	Closed	Amount																																																																																																																					
<b>Exemptions</b> <table border="1"> <thead> <tr> <th>Code</th> <th>Type</th> <th>Active</th> <th>Maximum</th> <th>Exemption</th> </tr> </thead> <tbody> <tr> <td>H</td> <td>Homestead</td> <td>Yes</td> <td>1,000</td> <td>1,000</td> </tr> </tbody> </table>					Code	Type	Active	Maximum	Exemption	H	Homestead	Yes	1,000	1,000	<b>Sale History</b> <table border="1"> <thead> <tr> <th>Bk/Pg</th> <th>Grantor</th> <th>Date</th> <th>Price</th> <th>Code</th> </tr> </thead> <tbody> <tr> <td colspan="5"> </td> </tr> </tbody> </table>					Bk/Pg	Grantor	Date	Price	Code																																																																																																	
Code	Type	Active	Maximum	Exemption																																																																																																																					
H	Homestead	Yes	1,000	1,000																																																																																																																					
Bk/Pg	Grantor	Date	Price	Code																																																																																																																					
<b>Parcel Valuation</b> <table border="1"> <thead> <tr> <th>Source</th> <th>REAL</th> <th>Fair Cash</th> <th>Capped</th> <th>Asmnt Level</th> <th>Assessed</th> <th>Levy Rate</th> <th>92.430</th> <th>Current Tax</th> </tr> </thead> <tbody> <tr> <td>Remove Cap</td> <td>0</td> <td>Land Value 73,438</td> <td>25,277</td> <td>11%</td> <td>2,780</td> <td>Assessed</td> <td>6,307</td> <td>582.96</td> </tr> <tr> <td>Year Frozen</td> <td>2005</td> <td>Improvements 93,145</td> <td>32,061</td> <td></td> <td>3,527</td> <td>Penalty</td> <td>0</td> <td></td> </tr> <tr> <td>Uncapped Value</td> <td>0</td> <td>Mobile Home 0</td> <td>0</td> <td></td> <td>0</td> <td>Exemption</td> <td>1,000</td> <td>-92.00</td> </tr> <tr> <td>TIF Project ID</td> <td>0</td> <td>Total Value 166,583</td> <td>57,338</td> <td></td> <td>6,307</td> <td>Total Taxable</td> <td>5,307</td> <td>491.00</td> </tr> </tbody> </table>										Source	REAL	Fair Cash	Capped	Asmnt Level	Assessed	Levy Rate	92.430	Current Tax	Remove Cap	0	Land Value 73,438	25,277	11%	2,780	Assessed	6,307	582.96	Year Frozen	2005	Improvements 93,145	32,061		3,527	Penalty	0		Uncapped Value	0	Mobile Home 0	0		0	Exemption	1,000	-92.00	TIF Project ID	0	Total Value 166,583	57,338		6,307	Total Taxable	5,307	491.00																																																																			
Source	REAL	Fair Cash	Capped	Asmnt Level	Assessed	Levy Rate	92.430	Current Tax																																																																																																																	
Remove Cap	0	Land Value 73,438	25,277	11%	2,780	Assessed	6,307	582.96																																																																																																																	
Year Frozen	2005	Improvements 93,145	32,061		3,527	Penalty	0																																																																																																																		
Uncapped Value	0	Mobile Home 0	0		0	Exemption	1,000	-92.00																																																																																																																	
TIF Project ID	0	Total Value 166,583	57,338		6,307	Total Taxable	5,307	491.00																																																																																																																	
<b>Assessment History</b> <table border="1"> <thead> <tr> <th>Tax Year</th> <th>Statement Number</th> <th>Billed Owner</th> <th>Tax Area</th> <th>Total Value</th> <th>Exemptions</th> <th>Taxable Value</th> <th>Billed Tax</th> </tr> </thead> <tbody> <tr><td>2025</td><td>2025-660016694</td><td>WOOD, PHYLLIS O</td><td>17</td><td>163,688</td><td>1000</td><td>5,308</td><td>491.00</td></tr> <tr><td>2024</td><td>2024-660016694</td><td>WOOD, PHYLLIS O</td><td>17</td><td>152,224</td><td>1000</td><td>5,307</td><td>490.00</td></tr> <tr><td>2023</td><td>2023-660016694</td><td>WOOD, PHYLLIS O</td><td>17</td><td>124,922</td><td>1000</td><td>5,307</td><td>486.00</td></tr> <tr><td>2022</td><td>2022-660016694</td><td>WOOD, PHYLLIS O</td><td>17</td><td>108,254</td><td>1000</td><td>5,307</td><td>491.00</td></tr> <tr><td>2021</td><td>2021-660016694</td><td>WOOD, PHYLLIS O</td><td>17</td><td>110,871</td><td>1000</td><td>5,308</td><td>469.00</td></tr> <tr><td>2020</td><td>2020-660016694</td><td>WOOD, PHYLLIS O</td><td>17</td><td>104,371</td><td>1000</td><td>5,307</td><td>486.00</td></tr> <tr><td>2019</td><td>2019-660016694</td><td>WOOD, PHYLLIS O</td><td>17</td><td>102,241</td><td>1000</td><td>5,307</td><td>492.00</td></tr> <tr><td>2018</td><td>2018-660016694</td><td>WOOD, PHYLLIS O</td><td>17</td><td>107,921</td><td>1000</td><td>5,307</td><td>490.00</td></tr> <tr><td>2017</td><td>2017-660016694</td><td>WOOD, PHYLLIS O</td><td>17</td><td>107,145</td><td>1000</td><td>5,307</td><td>487.00</td></tr> <tr><td>2016</td><td>2016-660016694</td><td>WOOD, PHYLLIS O</td><td>17</td><td>104,630</td><td>1000</td><td>5,307</td><td>498.00</td></tr> <tr><td>2015</td><td>2015-660016694</td><td>WOOD, PHYLLIS O</td><td>17</td><td>105,875</td><td>1000</td><td>5,307</td><td>479.00</td></tr> <tr><td>2014</td><td>2014-660016694</td><td>WOOD, PHYLLIS O</td><td>17</td><td>106,644</td><td>1000</td><td>5,308</td><td>492.00</td></tr> <tr><td>2013</td><td>2013-660016694</td><td>WOOD, PHYLLIS O</td><td>17</td><td>101,218</td><td>1000</td><td>5,307</td><td>486.00</td></tr> </tbody> </table>										Tax Year	Statement Number	Billed Owner	Tax Area	Total Value	Exemptions	Taxable Value	Billed Tax	2025	2025-660016694	WOOD, PHYLLIS O	17	163,688	1000	5,308	491.00	2024	2024-660016694	WOOD, PHYLLIS O	17	152,224	1000	5,307	490.00	2023	2023-660016694	WOOD, PHYLLIS O	17	124,922	1000	5,307	486.00	2022	2022-660016694	WOOD, PHYLLIS O	17	108,254	1000	5,307	491.00	2021	2021-660016694	WOOD, PHYLLIS O	17	110,871	1000	5,308	469.00	2020	2020-660016694	WOOD, PHYLLIS O	17	104,371	1000	5,307	486.00	2019	2019-660016694	WOOD, PHYLLIS O	17	102,241	1000	5,307	492.00	2018	2018-660016694	WOOD, PHYLLIS O	17	107,921	1000	5,307	490.00	2017	2017-660016694	WOOD, PHYLLIS O	17	107,145	1000	5,307	487.00	2016	2016-660016694	WOOD, PHYLLIS O	17	104,630	1000	5,307	498.00	2015	2015-660016694	WOOD, PHYLLIS O	17	105,875	1000	5,307	479.00	2014	2014-660016694	WOOD, PHYLLIS O	17	106,644	1000	5,308	492.00	2013	2013-660016694	WOOD, PHYLLIS O	17	101,218	1000	5,307	486.00
Tax Year	Statement Number	Billed Owner	Tax Area	Total Value	Exemptions	Taxable Value	Billed Tax																																																																																																																		
2025	2025-660016694	WOOD, PHYLLIS O	17	163,688	1000	5,308	491.00																																																																																																																		
2024	2024-660016694	WOOD, PHYLLIS O	17	152,224	1000	5,307	490.00																																																																																																																		
2023	2023-660016694	WOOD, PHYLLIS O	17	124,922	1000	5,307	486.00																																																																																																																		
2022	2022-660016694	WOOD, PHYLLIS O	17	108,254	1000	5,307	491.00																																																																																																																		
2021	2021-660016694	WOOD, PHYLLIS O	17	110,871	1000	5,308	469.00																																																																																																																		
2020	2020-660016694	WOOD, PHYLLIS O	17	104,371	1000	5,307	486.00																																																																																																																		
2019	2019-660016694	WOOD, PHYLLIS O	17	102,241	1000	5,307	492.00																																																																																																																		
2018	2018-660016694	WOOD, PHYLLIS O	17	107,921	1000	5,307	490.00																																																																																																																		
2017	2017-660016694	WOOD, PHYLLIS O	17	107,145	1000	5,307	487.00																																																																																																																		
2016	2016-660016694	WOOD, PHYLLIS O	17	104,630	1000	5,307	498.00																																																																																																																		
2015	2015-660016694	WOOD, PHYLLIS O	17	105,875	1000	5,307	479.00																																																																																																																		
2014	2014-660016694	WOOD, PHYLLIS O	17	106,644	1000	5,308	492.00																																																																																																																		
2013	2013-660016694	WOOD, PHYLLIS O	17	101,218	1000	5,307	486.00																																																																																																																		



# Rogers

## Assessment Property Record Card for Tax Year 2026

Data provided by LISA DELOZIER County Assessor

Date 04/16/2026  
 Time 23:26:24  
 Page 2

Lot Data		Square-Foot - NBHD 1170 #1	
Lot Size			
Lot Count			
Units Buildable	1		
Non-Ag Acres	1.1957		
Topography			
Street Access			
Utilities			
Amenities	LAND QUALITY	0	0
Method	Square-Foot		
Base Lot Value	52,086.00 x 1.41 = 73,438		
Factor Value			
Adjustments	1.0000		
Lot Value	73,438		



\\tsclient\TLOGAN\LOGAN RESIDENTIAL VI\2023-9-6\IMG\_0020. 9/6/2023

Residential Data	
Type	1 Single Family Residence
Condition	3 - Average
Quality	2.5 - Fair
Architecture	
Style	100% One Story
Exterior Wall	25% Veneer, Masonry 75% Frame, Siding, Vinyl
Base/Total Area	1,477 / 1,477
Style	100% One Story
HVAC	100% Warmed & Cooled Air
Roof Cover	1 Composition Shingle
Area on Slab	0
Fixture/RghIn	7 /
Bed/F/H Bath	3 / 1.5 /
Basement Area	
Garage Type	580 Attached Garage - Unfinished
Remodel	
Year/Eff Age	1965 / 46

GRM Approach	
GRM Code	
Gross Rent	0.00
Indicated Value	

Multiple Regression			
MRA Code	1	Test	
Adjusted R	0.8445		
Indicated Value	155,934	105.57	Per SqFt

Direct Comparables			
Selection Model	A	Adam Test	
Adjustment Model	1	2022 Residential	
Comparables	8		
Indicated Value	177,330		Per SqFt

Cost Approach				Manual : 01/2025			
Base Cost	100.10	Total Misc Impr	+ 363				
Roofing Adj	+ 4.53	Garage Cost	+ 15,393				
Subfloor Adj	+ 1.17	Total RCN	= 198,180				
Heat/Cool Adj	+ 11.47	Depreciation ( 53%)	- 105,035				
Plumbing Adj	+ 6.24	Lump Sums	+ 0				
Basement Adj	+ 0.00	RCNLD	= 93,145				
Adj Base Cost	= 123.51	Lot Value	+ 73,438				
Total Area	x 1,477	Indicated Value	= 166,583				
Adjusted Cost	= 182,424	Value Per SqFt	112.78				

Value Reconciliation			
Selected Approach	Cost Approach		
Improvements	93,145		
Lot Value	73,438		
Indicated Value	166,583	112.78	Per SqFt
Agland Value			
Site Improvements			
Total Value	166,583	112.78	Total Value Per SqFt

Miscellaneous Improvements								
Code	Description	Sketch ID	Size	Year	Units	Unit Cost	Depr	Value
PRCH	SLAB PORCH - COVERED	40014	5x3		15	24.22		363



# Rogers

## Assessment Property Record Card for Tax Year 2026

Data provided by LISA DELOZIER County Assessor

Date 04/16/2026

Time 23:26:24

Page 3

Sketch Image

660016694

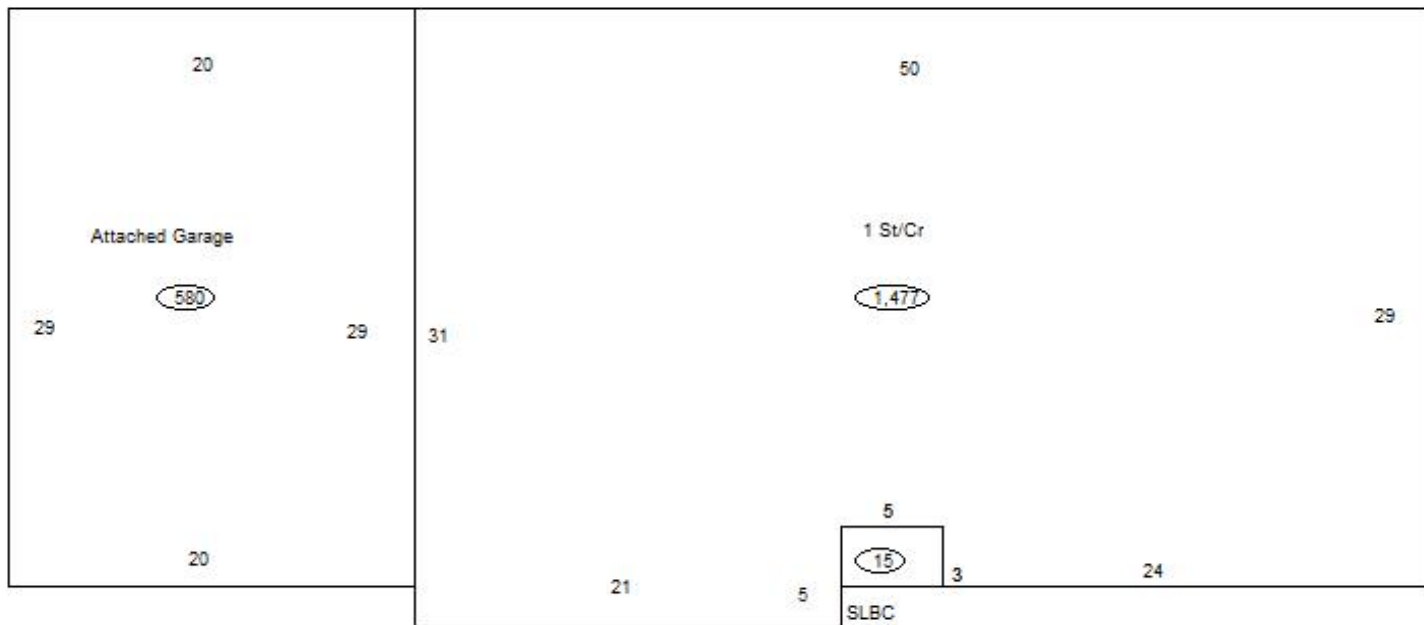

### Sketch Vector Information

Sequence	Code	Type	Built Over	Scale	Section Label	Base Area	Multiplier	Total Area
1	R	1	Crawl	10	1 St/Cr	1,477	1.000	1,477
2	G	1		10	Attached Garage	580	1.000	580
3	M	PRCH		10	SLBC	15	1.000	15
<b>Total Building Area</b>						<b>1,477</b>		<b>1,477</b>