



Rogers

Assessment Property Record Card for Tax Year 2026

Data provided by LISA DELOZIER County Assessor

Date 04/16/2026
Time 23:26:27
Page 1

Assessment Data					Primary Image																																																																																																																				
Account 660016703 Parcel ID 000000-00-0-10190-001-0024 Cadastral ID 18-21-16-01910 Property Type REAL - Real Property Property Class URP VI Area 1 Tax Area 17 - CLAREMORE OT Name ID 320887 MARTIN, LYNNE LOUISE TRUSTEE 730 CHRISTMAS LN CLAREMORE OK 74017-0000 Parcel Location Situs 00730 CHRISTMAS LN Subdivision HOLIDAY HILLS Lot/Block 0024 / 0001 Parcel Size 1 - Lots Sec/Twn/Rng 18 / 21 / 16 / 5 Neighborhood 1170 - R-V01-SW CLAREMORE School District S001 - CLAREMORE SCHOOLS																																																																																																																									
Legal Description Lat/Long: 36.30444562 -95.63611028																																																																																																																									
Legal Description TR 24 LESS N 33' OF E2 OF TR 24 BLOCK 1 HOLIDAY HILLS					Building Permits <table border="1"> <thead> <tr> <th>Number</th> <th>Description</th> <th>Opened</th> <th>Closed</th> <th>Amount</th> </tr> </thead> <tbody> <tr> <td></td> <td></td> <td></td> <td></td> <td></td> </tr> </tbody> </table>					Number	Description	Opened	Closed	Amount																																																																																																											
Number	Description	Opened	Closed	Amount																																																																																																																					
Exemptions <table border="1"> <thead> <tr> <th>Code</th> <th>Type</th> <th>Active</th> <th>Maximum</th> <th>Exemption</th> </tr> </thead> <tbody> <tr> <td>H</td> <td>Homestead</td> <td>No</td> <td>1,000</td> <td></td> </tr> <tr> <td>H</td> <td>Homestead</td> <td>No</td> <td>1,000</td> <td></td> </tr> <tr> <td>A</td> <td>Add-Homestead</td> <td>No</td> <td>1,000</td> <td></td> </tr> <tr> <td>A</td> <td>Add-Homestead</td> <td>No</td> <td>1,000</td> <td></td> </tr> </tbody> </table>					Code	Type	Active	Maximum	Exemption	H	Homestead	No	1,000		H	Homestead	No	1,000		A	Add-Homestead	No	1,000		A	Add-Homestead	No	1,000		Sale History <table border="1"> <thead> <tr> <th>Bk/Pg</th> <th>Grantor</th> <th>Date</th> <th>Price</th> <th>Code</th> </tr> </thead> <tbody> <tr> <td>2648/267</td> <td>MARTIN, LYNNE LOUISE</td> <td>07/20/2017</td> <td>0</td> <td>4</td> </tr> <tr> <td>2618/378</td> <td>FOSSA, THOMAS J & MARJORIE &</td> <td>03/14/2017</td> <td>125,000</td> <td>YES</td> </tr> <tr> <td>1461/830</td> <td>FOSSA, THOMAS J & MARJORIE-F</td> <td>03/26/2003</td> <td>0</td> <td>4</td> </tr> <tr> <td>1461/474</td> <td>BREEN, JACK FREDERICK</td> <td>03/10/2003</td> <td>85,000</td> <td>YES</td> </tr> </tbody> </table>					Bk/Pg	Grantor	Date	Price	Code	2648/267	MARTIN, LYNNE LOUISE	07/20/2017	0	4	2618/378	FOSSA, THOMAS J & MARJORIE &	03/14/2017	125,000	YES	1461/830	FOSSA, THOMAS J & MARJORIE-F	03/26/2003	0	4	1461/474	BREEN, JACK FREDERICK	03/10/2003	85,000	YES																																																														
Code	Type	Active	Maximum	Exemption																																																																																																																					
H	Homestead	No	1,000																																																																																																																						
H	Homestead	No	1,000																																																																																																																						
A	Add-Homestead	No	1,000																																																																																																																						
A	Add-Homestead	No	1,000																																																																																																																						
Bk/Pg	Grantor	Date	Price	Code																																																																																																																					
2648/267	MARTIN, LYNNE LOUISE	07/20/2017	0	4																																																																																																																					
2618/378	FOSSA, THOMAS J & MARJORIE &	03/14/2017	125,000	YES																																																																																																																					
1461/830	FOSSA, THOMAS J & MARJORIE-F	03/26/2003	0	4																																																																																																																					
1461/474	BREEN, JACK FREDERICK	03/10/2003	85,000	YES																																																																																																																					
Parcel Valuation <table border="1"> <thead> <tr> <th>Source</th> <th>REAL</th> <th>Fair Cash</th> <th>Capped</th> <th>Asmnt Level</th> <th>Assessed</th> <th>Levy Rate</th> <th>92.430</th> <th>Current Tax</th> </tr> </thead> <tbody> <tr> <td>Remove Cap</td> <td>2018</td> <td>Land Value 81,998</td> <td>51,661</td> <td>11%</td> <td>5,683</td> <td>Assessed</td> <td>16,158</td> <td>1,493.48</td> </tr> <tr> <td>Year Frozen</td> <td>0</td> <td>Improvements 99,293</td> <td>95,224</td> <td></td> <td>10,475</td> <td>Penalty</td> <td>0</td> <td></td> </tr> <tr> <td>Uncapped Value</td> <td>0</td> <td>Mobile Home 0</td> <td>0</td> <td></td> <td>0</td> <td>Exemption</td> <td>0</td> <td>0.00</td> </tr> <tr> <td>TIF Project ID</td> <td>0</td> <td>Total Value 181,291</td> <td>146,885</td> <td></td> <td>16,158</td> <td>Total Taxable</td> <td>16,158</td> <td>1,493.00</td> </tr> </tbody> </table>										Source	REAL	Fair Cash	Capped	Asmnt Level	Assessed	Levy Rate	92.430	Current Tax	Remove Cap	2018	Land Value 81,998	51,661	11%	5,683	Assessed	16,158	1,493.48	Year Frozen	0	Improvements 99,293	95,224		10,475	Penalty	0		Uncapped Value	0	Mobile Home 0	0		0	Exemption	0	0.00	TIF Project ID	0	Total Value 181,291	146,885		16,158	Total Taxable	16,158	1,493.00																																																																			
Source	REAL	Fair Cash	Capped	Asmnt Level	Assessed	Levy Rate	92.430	Current Tax																																																																																																																	
Remove Cap	2018	Land Value 81,998	51,661	11%	5,683	Assessed	16,158	1,493.48																																																																																																																	
Year Frozen	0	Improvements 99,293	95,224		10,475	Penalty	0																																																																																																																		
Uncapped Value	0	Mobile Home 0	0		0	Exemption	0	0.00																																																																																																																	
TIF Project ID	0	Total Value 181,291	146,885		16,158	Total Taxable	16,158	1,493.00																																																																																																																	
Assessment History <table border="1"> <thead> <tr> <th>Tax Year</th> <th>Statement Number</th> <th>Billed Owner</th> <th>Tax Area</th> <th>Total Value</th> <th>Exemptions</th> <th>Taxable Value</th> <th>Billed Tax</th> </tr> </thead> <tbody> <tr><td>2025</td><td>2025-660016703</td><td>MARTIN, LYNNE LOUISE</td><td>17</td><td>178,211</td><td>0</td><td>15,388</td><td>1,422.00</td></tr> <tr><td>2024</td><td>2024-660016703</td><td>MARTIN, LYNNE LOUISE</td><td>17</td><td>179,878</td><td>1000</td><td>13,655</td><td>1,262.00</td></tr> <tr><td>2023</td><td>2023-660016703</td><td>MARTIN, LYNNE LOUISE</td><td>17</td><td>130,363</td><td>1000</td><td>13,228</td><td>1,212.00</td></tr> <tr><td>2022</td><td>2022-660016703</td><td>MARTIN, LYNNE LOUISE</td><td>17</td><td>125,583</td><td>1000</td><td>12,814</td><td>1,186.00</td></tr> <tr><td>2021</td><td>2021-660016703</td><td>MARTIN, LYNNE LOUISE</td><td>17</td><td>132,489</td><td>1000</td><td>13,024</td><td>1,150.00</td></tr> <tr><td>2020</td><td>2020-660016703</td><td>MARTIN, LYNNE LOUISE</td><td>17</td><td>123,779</td><td>1000</td><td>12,616</td><td>1,155.00</td></tr> <tr><td>2019</td><td>2019-660016703</td><td>MARTIN, LYNNE LOUISE</td><td>17</td><td>121,404</td><td>1000</td><td>12,354</td><td>1,144.00</td></tr> <tr><td>2018</td><td>2018-660016703</td><td>MARTIN, LYNNE LOUISE</td><td>17</td><td>127,775</td><td>1000</td><td>13,055</td><td>1,206.00</td></tr> <tr><td>2017</td><td>2017-660016703</td><td>MARTIN, LYNNE LOUISE</td><td>17</td><td>126,882</td><td>1000</td><td>12,859</td><td>1,181.00</td></tr> <tr><td>2016</td><td>2016-660016703</td><td>FOSSA, THOMAS J & MARJORIE &</td><td>17</td><td>124,153</td><td>2000</td><td>11,455</td><td>1,075.00</td></tr> <tr><td>2015</td><td>2015-660016703</td><td>FOSSA, THOMAS J & MARJORIE &</td><td>17</td><td>124,666</td><td>2000</td><td>11,063</td><td>998.00</td></tr> <tr><td>2014</td><td>2014-660016703</td><td>FOSSA, THOMAS J & MARJORIE &</td><td>17</td><td>125,516</td><td>2000</td><td>10,683</td><td>991.00</td></tr> <tr><td>2013</td><td>2013-660016703</td><td>FOSSA, THOMAS J & MARJORIE &</td><td>17</td><td>120,372</td><td>2000</td><td>10,313</td><td>944.00</td></tr> </tbody> </table>										Tax Year	Statement Number	Billed Owner	Tax Area	Total Value	Exemptions	Taxable Value	Billed Tax	2025	2025-660016703	MARTIN, LYNNE LOUISE	17	178,211	0	15,388	1,422.00	2024	2024-660016703	MARTIN, LYNNE LOUISE	17	179,878	1000	13,655	1,262.00	2023	2023-660016703	MARTIN, LYNNE LOUISE	17	130,363	1000	13,228	1,212.00	2022	2022-660016703	MARTIN, LYNNE LOUISE	17	125,583	1000	12,814	1,186.00	2021	2021-660016703	MARTIN, LYNNE LOUISE	17	132,489	1000	13,024	1,150.00	2020	2020-660016703	MARTIN, LYNNE LOUISE	17	123,779	1000	12,616	1,155.00	2019	2019-660016703	MARTIN, LYNNE LOUISE	17	121,404	1000	12,354	1,144.00	2018	2018-660016703	MARTIN, LYNNE LOUISE	17	127,775	1000	13,055	1,206.00	2017	2017-660016703	MARTIN, LYNNE LOUISE	17	126,882	1000	12,859	1,181.00	2016	2016-660016703	FOSSA, THOMAS J & MARJORIE &	17	124,153	2000	11,455	1,075.00	2015	2015-660016703	FOSSA, THOMAS J & MARJORIE &	17	124,666	2000	11,063	998.00	2014	2014-660016703	FOSSA, THOMAS J & MARJORIE &	17	125,516	2000	10,683	991.00	2013	2013-660016703	FOSSA, THOMAS J & MARJORIE &	17	120,372	2000	10,313	944.00
Tax Year	Statement Number	Billed Owner	Tax Area	Total Value	Exemptions	Taxable Value	Billed Tax																																																																																																																		
2025	2025-660016703	MARTIN, LYNNE LOUISE	17	178,211	0	15,388	1,422.00																																																																																																																		
2024	2024-660016703	MARTIN, LYNNE LOUISE	17	179,878	1000	13,655	1,262.00																																																																																																																		
2023	2023-660016703	MARTIN, LYNNE LOUISE	17	130,363	1000	13,228	1,212.00																																																																																																																		
2022	2022-660016703	MARTIN, LYNNE LOUISE	17	125,583	1000	12,814	1,186.00																																																																																																																		
2021	2021-660016703	MARTIN, LYNNE LOUISE	17	132,489	1000	13,024	1,150.00																																																																																																																		
2020	2020-660016703	MARTIN, LYNNE LOUISE	17	123,779	1000	12,616	1,155.00																																																																																																																		
2019	2019-660016703	MARTIN, LYNNE LOUISE	17	121,404	1000	12,354	1,144.00																																																																																																																		
2018	2018-660016703	MARTIN, LYNNE LOUISE	17	127,775	1000	13,055	1,206.00																																																																																																																		
2017	2017-660016703	MARTIN, LYNNE LOUISE	17	126,882	1000	12,859	1,181.00																																																																																																																		
2016	2016-660016703	FOSSA, THOMAS J & MARJORIE &	17	124,153	2000	11,455	1,075.00																																																																																																																		
2015	2015-660016703	FOSSA, THOMAS J & MARJORIE &	17	124,666	2000	11,063	998.00																																																																																																																		
2014	2014-660016703	FOSSA, THOMAS J & MARJORIE &	17	125,516	2000	10,683	991.00																																																																																																																		
2013	2013-660016703	FOSSA, THOMAS J & MARJORIE &	17	120,372	2000	10,313	944.00																																																																																																																		



Rogers

Assessment Property Record Card for Tax Year 2026

Data provided by LISA DELOZIER County Assessor

Date 04/16/2026
 Time 23:26:28
 Page 2

Lot Data	Square-Foot - NBHD 1170 #1	Primary Image
Lot Size Lot Count Units Buildable 1 Non-Ag Acres 2.1178 Topography Street Access Utilities Amenities LAND QUALITY 0 0 Method Square-Foot Base Lot Value 92,252.00 x .89 = 81,998 Factor Value Adjustments 1.0000 Lot Value 81,998		<p>09/06/2023</p> <p>\\tsclient\TLOGAN\LOGAN RESIDENTIAL VI\2023-9-6\IMG_0029. 9/6/2023</p>

Residential Data	
Type	1 Single Family Residence
Condition	3 - Average
Quality	2.5 - Fair
Architecture	
Style	100% 1 1/2 Story Finished
Exterior Wall	100% Veneer, Masonry
Base/Total Area	1,219 / 1,751
Style	100% 1 1/2 Story Finished
HVAC	100% Warmed & Cooled Air
Roof Cover	1 Composition Shingle
Area on Slab	0
Fixture/RghIn	8 /
Bed/F/H Bath	3 / 2.0 /
Basement Area	
Garage Type	399 Attached Garage - Unfinished
Remodel	
Year/Eff Age	1965 / 46



GRM Approach	
GRM Code	
Gross Rent	0.00
Indicated Value	

Multiple Regression			
MRA Code	1	Test	
Adusted R	0.8445		
Indicated Value	156,567	89.42	Per SqFt

Direct Comparables			
Selection Model	A	Adam Test	
Adjustment Model	1	2022 Residential	
Comparables	8		
Indicated Value	196,960		Per SqFt

Cost Approach				Manual : 01/2025			
Base Cost	89.75	Total Misc Impr	+ 4,977				
Roofing Adj	+ 3.16	Garage Cost	+ 11,679				
Subfloor Adj	+ 0.80	Total RCN	= 211,262				
Heat/Cool Adj	+ 11.47	Depreciation (53%)	- 111,969				
Plumbing Adj	+ 5.96	Lump Sums	+ 0				
Basement Adj	+ 0.00	RCNLD	= 99,293				
Adj Base Cost	= 111.14	Lot Value	+ 81,998				
Total Area	x 1,751	Indicated Value	= 181,291				
Adjusted Cost	= 194,606	Value Per SqFt	103.54				

Value Reconciliation			
Selected Approach	Cost Approach		
Improvements	99,293		
Lot Value	81,998		
Indicated Value	181,291	103.54	Per SqFt
Agland Value			
Site Improvements			
Total Value	181,291	103.54	Total Value Per SqFt

Miscellaneous Improvements								
Code	Description	Sketch ID	Size	Year	Units	Unit Cost	Depr	Value
PRCH	SLAB PORCH - COVERED	40049	22x4		88	23.99		2,111
PRCH	SLAB PORCH - COVERED	40051	12x10		120	23.88		2,866



Rogers

Assessment Property Record Card for Tax Year 2026

Data provided by LISA DELOZIER County Assessor

Date 04/16/2026
 Time 23:26:28
 Page 3

Sketch Image

660016703

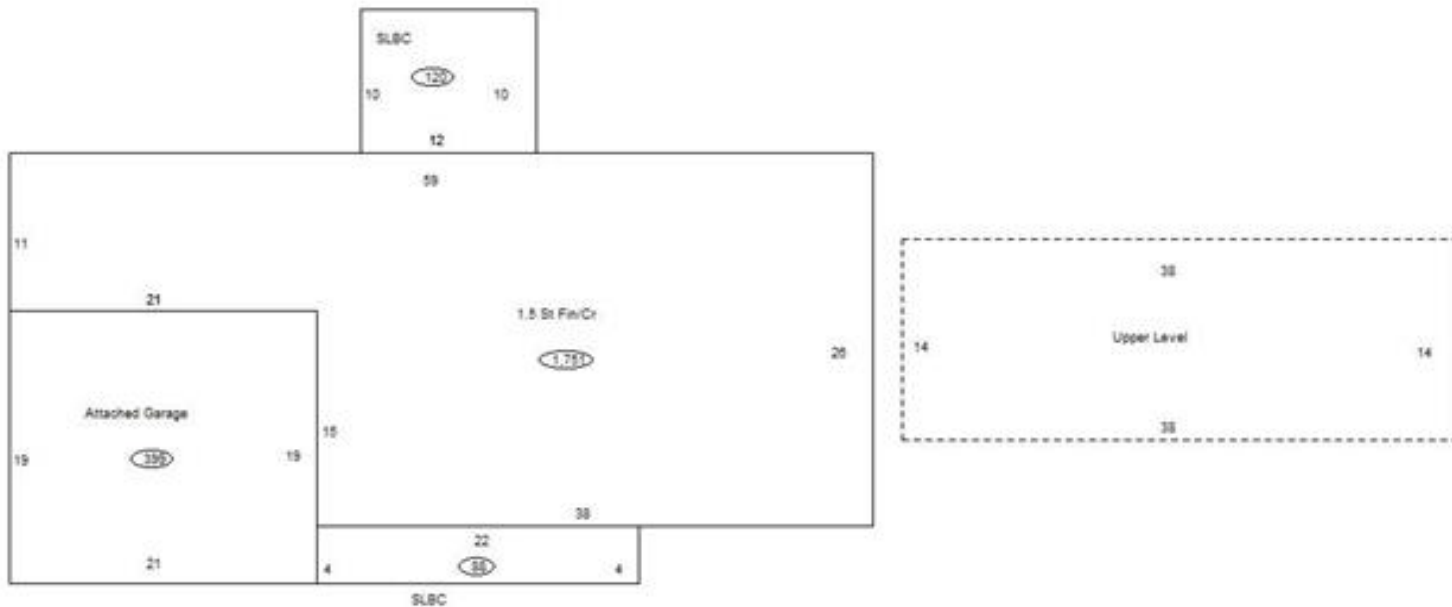

Sketch Vector Information

Sequence	Code	Type	Built Over	Scale	Section Label	Base Area	Multiplier	Total Area
1	R	5	Crawl	10	1.5 St Fin/Cr	1,219	1.436	1,751
2	G	1		10	Attached Garage	399	1.000	399
3	M	PRCH		10	SLBC	88	1.000	88
4	U	^UL	Overhang	10	Upper Level	532	1.000	532
5	M	PRCH		10	SLBC	120	1.000	120
Total Building Area						1,219		1,751



Rogers



Assessment Property Record Card for Tax Year 2026

Data provided by LISA DELOZIER County Assessor

Date 04/16/2026
Time 23:26:28
Page 4

660016703

Outbuildings/Site Improvements

Building Image	Code	Description	Dimensions	Floor	Roofing	Total Units
	STF Qual 2	STG FAIR Cond	0x0x0 Year		Eff Age	
	Valuation Summary		Modifier Total	RCN	Depr (100% Phys/ % Func)	RCNLD
	Base Cost (4.68 x)					
	STF Qual 2	STG FAIR Cond	0x0x0 Year		Eff Age	
	Valuation Summary		Modifier Total	RCN	Depr (100% Phys/ % Func)	RCNLD
	Base Cost (4.68 x)					
	STF Qual 2	STG FAIR Cond	0x0x0 Year		Eff Age	
	Valuation Summary		Modifier Total	RCN	Depr (100% Phys/ % Func)	RCNLD
	Base Cost (4.68 x)					