



# Rogers

## Assessment Property Record Card for Tax Year 2026

Data provided by LISA DELOZIER County Assessor

Date 04/16/2026  
Time 23:26:38  
Page 1

Assessment Data					Primary Image									
Account	660016718													
Parcel ID	000000-00-0-10190-001-0037													
Cadastral ID	18-21-16-02050													
Property Type	REAL - Real Property													
Property Class	URP	VI Area	1											
Tax Area	17 - CLAREMORE OT													
Name ID	302870													
SHISLER, VICKI E														
715 CHRISTMAS LN CLAREMORE OK 74017-0000														
Parcel Location														
Situs	00715 CHRISTMAS LN													
Subdivision	HOLIDAY HILLS													
Lot/Block	0037 / 0001	Parcel Size	1 - Lots											
Sec/Twn/Rng	18 / 21 / 16 / 5													
Neighborhood	1170 - R-V01-SW CLAREMORE													
School District	S001 - CLAREMORE SCHOOLS													
Legal Description Lat/Long: 36.30628495 -95.63785227														
E2 OF TR 37 BLOCK 1 HOLIDAY HILLS														
Building Permits														
<table border="1"> <thead> <tr> <th>Number</th> <th>Description</th> <th>Opened</th> <th>Closed</th> <th>Amount</th> </tr> </thead> <tbody> <tr> <td colspan="5"> </td> </tr> </tbody> </table>					Number	Description	Opened	Closed	Amount					
Number	Description	Opened	Closed	Amount										
Exemptions														
Sale History														
Code	Type	Active	Maximum	Exemption	Bk/Pg	Grantor	Date	Price	Code					
					2104/867	KASSICK, ALFRED A TRUST	05/24/2010	111,500	YES					
Parcel Valuation														
Source	REAL		Fair Cash	Capped	Asmnt Level	Assessed	Levy Rate	92.430	Current Tax					
Remove Cap	2011	Land Value	73,123	47,514	11%	5,227	Assessed	17,266	1,595.90					
Year Frozen	0	Improvements	109,444	109,444		12,039	Penalty	0						
Uncapped Value	0	Mobile Home	0	0		0	Exemption	0	0.00					
TIF Project ID	0	Total Value	182,567	156,958		17,266	Total Taxable	17,266	1,596.00					
Assessment History														
Tax Year	Statement Number	Billed Owner			Tax Area	Total Value	Exemptions	Taxable Value	Billed Tax					
2025	2025-660016718	SHISLER, VICKI E			17	179,153	0	16,443	1,520.00					
2024	2024-660016718	SHISLER, VICKI E			17	176,595	0	15,660	1,447.00					
2023	2023-660016718	SHISLER, VICKI E			17	147,876	0	14,914	1,366.00					
2022	2022-660016718	SHISLER, VICKI E			17	129,131	0	14,204	1,315.00					
2021	2021-660016718	SHISLER, VICKI E			17	128,930	0	14,099	1,245.00					
2020	2020-660016718	SHISLER, VICKI E			17	122,070	0	13,428	1,230.00					
2019	2019-660016718	SHISLER, VICKI E			17	119,293	0	13,122	1,215.00					
2018	2018-660016718	SHISLER, VICKI E			17	125,886	0	13,847	1,279.00					
2017	2017-660016718	SHISLER, VICKI E			17	124,889	0	13,738	1,262.00					
2016	2016-660016718	SHISLER, VICKI E			17	121,881	0	13,407	1,258.00					
2015	2015-660016718	SHISLER, VICKI E			17	122,562	0	13,482	1,216.00					
2014	2014-660016718	SHISLER, VICKI E			17	123,503	0	13,438	1,246.00					
2013	2013-660016718	SHISLER, VICKI E			17	119,431	0	12,798	1,171.00					



# Rogers

## Assessment Property Record Card for Tax Year 2026

Data provided by LISA DELOZIER County Assessor

Date 04/16/2026  
 Time 23:26:39  
 Page 2

Lot Data		Square-Foot - NBHD 1170 #1	
Lot Size			
Lot Count			
Units Buildable	1		
Non-Ag Acres	1.1897		
Topography			
Street Access			
Utilities			
Amenities	LAND QUALITY	0	
		0	
Method	Square-Foot		
Base Lot Value	51,823.00 x 1.41 = 73,123		
Factor Value			
Adjustments	1.0000		
Lot Value	73,123		



\\tsclient\T\LOGAN\LOGAN RESIDENTIAL VI\2023-9-11\IMG\_0001 9/11/2023

Residential Data	
Type	1 Single Family Residence
Condition	3 - Average
Quality	2.5 - Fair
Architecture	
Style	100% One Story
Exterior Wall	100% Veneer, Masonry
Base/Total Area	1,557 / 1,557
Style	100% One Story
HVAC	100% Warmed & Cooled Air
Roof Cover	1 Composition Shingle
Area on Slab	0
Fixture/RghIn	8 /
Bed/F/H Bath	3 / 2.0 /
Basement Area	
Garage Type	400 Attached Garage - Unfinished
Remodel	
Year/Eff Age	1963 / 47

### GRM Approach

GRM Code	
Gross Rent	0.00
Indicated Value	

### Multiple Regression

MRA Code	1 Test
Adusted R	0.8445
Indicated Value	143,120 91.92 Per SqFt

### Direct Comparables

Selection Model	A Adam Test
Adjustment Model	1 2022 Residential
Comparables	8
Indicated Value	166,450 Per SqFt

### Value Reconciliation

Selected Approach	Cost Approach
Improvements	109,444
Lot Value	73,123
Indicated Value	182,567 117.26 Per SqFt
Agland Value	
Site Improvements	
Total Value	182,567 117.26 Total Value Per SqFt

Cost Approach		Manual : 01/2025	
Base Cost	103.57	Total Misc Impr	+ 28,063
Roofing Adj	+ 4.38	Garage Cost	+ 11,700
Subfloor Adj	+ 1.15	Total RCN	= 237,922
Heat/Cool Adj	+ 11.47	Depreciation ( 54%)	- 128,478
Plumbing Adj	+ 6.70	Lump Sums	+ 0
Basement Adj	+ 0.00	RCNLD	= 109,444
Adj Base Cost	= 127.27	Lot Value	+ 73,123
Total Area	x 1,557	Indicated Value	= 182,567
Adjusted Cost	= 198,159	Value Per SqFt	117.26

### Miscellaneous Improvements

Code	Description	Sketch ID	Size	Year	Units	Unit Cost	Depr	Value
FPR1	FIREPLACE - RESIDENTIAL 1 STORY	0		1	1	5,095.98		5,096
PRCH	SLAB PORCH - COVERED	40094	23x5		115	23.90		2,749
PRCH	SLAB PORCH - COVERED	40095	200		200	23.56		4,712
EPSW	ENCLOSED PORCH - SOLID WALL	40096	18x14		252	61.53		15,506



# Rogers

## Assessment Property Record Card for Tax Year 2026

Data provided by LISA DELOZIER County Assessor

Date 04/16/2026  
 Time 23:26:39  
 Page 3

### Sketch Image

660016718

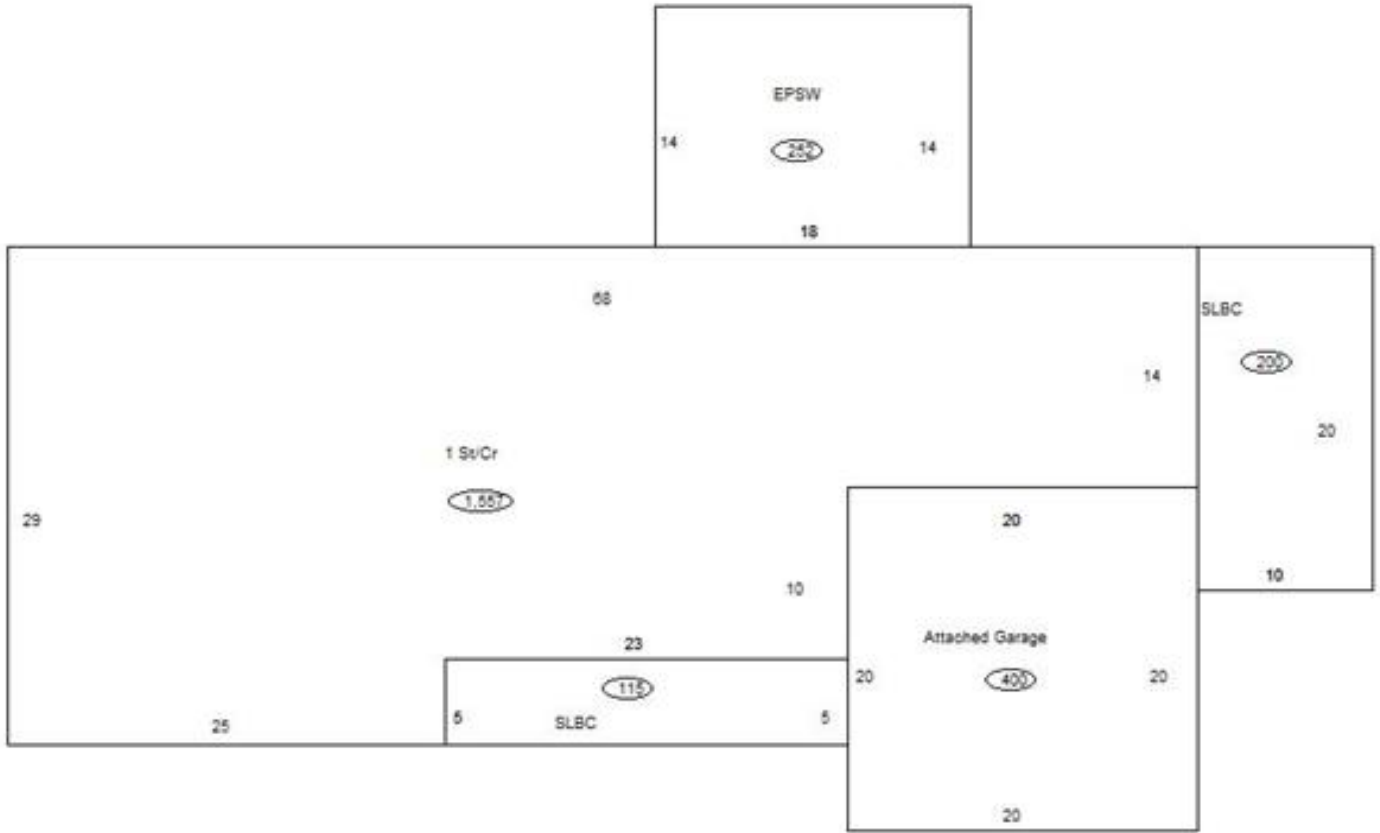

### Sketch Vector Information

Sequence	Code	Type	Built Over	Scale	Section Label	Base Area	Multiplier	Total Area
1	R	1	Crawl	10	1 St/Cr	1,557	1.000	1,557
2	G	1		10	Attached Garage	400	1.000	400
3	M	PRCH		10	SLBC	115	1.000	115
4	M	PRCH		10	SLBC	200	1.000	200
5	M	EPSW		10	EPSW	252	1.000	252
<b>Total Building Area</b>						<b>1,557</b>		<b>1,557</b>