



# Rogers

## Assessment Property Record Card for Tax Year 2026

Data provided by LISA DELOZIER County Assessor

Date 04/17/2026  
Time 05:20:30  
Page 1

Assessment Data					Primary Image																																																	
<b>Account</b> 660016781 <b>Parcel ID</b> 000000-00-0-10190-001-0071 <b>Cadastral ID</b> 18-21-16-02690 <b>Property Type</b> REAL - Real Property <b>Property Class</b> URP VI Area 1 <b>Tax Area</b> 17 - CLAREMORE OT <b>Name ID</b> 286106 SMITH, LARRY H & JUDY L-TRUSTEES  727 WINTER LN CLAREMORE OK 74017-0000  <b>Parcel Location</b> <b>Situs</b> 00727 WINTER LN <b>Subdivision</b> HOLIDAY HILLS <b>Lot/Block</b> 0071 / 0001 <b>Parcel Size</b> 1 - Lots <b>Sec/Twn/Rng</b> 18 / 21 / 16 / 5 <b>Neighborhood</b> 1170 - R-V01-SW CLAREMORE <b>School District</b> S001 - CLAREMORE SCHOOLS					<p>\\tsclient\T\LOGAN\LOGAN RESIDENTIAL VI\2023-9-12\IMG_003 9/12/2023</p>																																																	
<b>Legal Description</b> Lat/Long: 36.30497246 -95.64231328																																																						
S2 TRACT 71 BLOCK 1 HOLIDAY HILLS					<b>Building Permits</b> <table border="1"> <thead> <tr> <th>Number</th> <th>Description</th> <th>Opened</th> <th>Closed</th> <th>Amount</th> </tr> </thead> <tbody> <tr> <td> </td> <td> </td> <td> </td> <td> </td> <td> </td> </tr> </tbody> </table>					Number	Description	Opened	Closed	Amount																																								
Number	Description	Opened	Closed	Amount																																																		
<b>Exemptions</b>					<b>Sale History</b>																																																	
<b>Code</b>	<b>Type</b>	<b>Active</b>	<b>Maximum</b>	<b>Exemption</b>	<b>Bk/Pg</b>	<b>Grantor</b>	<b>Date</b>	<b>Price</b>	<b>Code</b>																																													
H	Homestead	Yes	1,000	1,000	2456/767	SMITH, LARRY H &	02/25/2015	0	4																																													
					1607/387	BUTLER, CLIFFORD R EST	07/26/2004	90,000	YES																																													
<b>Parcel Valuation</b>					<table border="1"> <thead> <tr> <th>Source</th> <th>REAL</th> <th>Fair Cash</th> <th>Capped</th> <th>Asmnt Level</th> <th>Assessed</th> <th>Levy Rate</th> <th>92.430</th> <th>Current Tax</th> </tr> </thead> <tbody> <tr> <td>Remove Cap</td> <td>2005</td> <td>Land Value 69,142</td> <td>41,569</td> <td>11%</td> <td>4,573</td> <td>Assessed</td> <td>15,920</td> <td>1,471.49</td> </tr> <tr> <td>Year Frozen</td> <td>2026</td> <td>Improvements 107,825</td> <td>103,160</td> <td> </td> <td>11,347</td> <td>Penalty</td> <td>0</td> <td> </td> </tr> <tr> <td>Uncapped Value</td> <td>0</td> <td>Mobile Home 0</td> <td>0</td> <td> </td> <td>0</td> <td>Exemption</td> <td>1,000</td> <td>-92.00</td> </tr> <tr> <td>TIF Project ID</td> <td>0</td> <td>Total Value 176,967</td> <td>144,729</td> <td> </td> <td>15,920</td> <td>Total Taxable</td> <td>14,920</td> <td>1,379.00</td> </tr> </tbody> </table>					Source	REAL	Fair Cash	Capped	Asmnt Level	Assessed	Levy Rate	92.430	Current Tax	Remove Cap	2005	Land Value 69,142	41,569	11%	4,573	Assessed	15,920	1,471.49	Year Frozen	2026	Improvements 107,825	103,160		11,347	Penalty	0		Uncapped Value	0	Mobile Home 0	0		0	Exemption	1,000	-92.00	TIF Project ID	0	Total Value 176,967	144,729		15,920	Total Taxable	14,920	1,379.00
Source	REAL	Fair Cash	Capped	Asmnt Level	Assessed	Levy Rate	92.430	Current Tax																																														
Remove Cap	2005	Land Value 69,142	41,569	11%	4,573	Assessed	15,920	1,471.49																																														
Year Frozen	2026	Improvements 107,825	103,160		11,347	Penalty	0																																															
Uncapped Value	0	Mobile Home 0	0		0	Exemption	1,000	-92.00																																														
TIF Project ID	0	Total Value 176,967	144,729		15,920	Total Taxable	14,920	1,379.00																																														
<b>Assessment History</b>																																																						
Tax Year	Statement Number	Billed Owner	Tax Area	Total Value	Exemptions	Taxable Value	Billed Tax																																															
2025	2025-660016781	SMITH, LARRY H &	17	173,875	0	15,456	1,429.00																																															
2024	2024-660016781	SMITH, LARRY H &	17	164,736	0	14,720	1,360.00																																															
2023	2023-660016781	SMITH, LARRY H &	17	138,112	0	14,020	1,284.00																																															
2022	2022-660016781	SMITH, LARRY H &	17	121,382	0	13,352	1,236.00																																															
2021	2021-660016781	SMITH, LARRY H &	17	124,853	0	13,358	1,180.00																																															
2020	2020-660016781	SMITH, LARRY H &	17	118,061	0	12,721	1,165.00																																															
2019	2019-660016781	SMITH, LARRY H &	17	110,141	0	12,116	1,122.00																																															
2018	2018-660016781	SMITH, LARRY H &	17	116,112	0	12,772	1,180.00																																															
2017	2017-660016781	SMITH, LARRY H &	17	115,230	0	12,675	1,164.00																																															
2016	2016-660016781	SMITH, LARRY H &	17	112,474	0	12,372	1,161.00																																															
2015	2015-660016781	SMITH, LARRY H &	17	113,946	0	12,534	1,130.00																																															
2014	2014-660016781	SMITH, LARRY H &	17	114,926	0	12,236	1,135.00																																															
2013	2013-660016781	SMITH, LARRY H &	17	108,914	0	11,653	1,066.00																																															



# Rogers

## Assessment Property Record Card for Tax Year 2026

Data provided by LISA DELOZIER County Assessor

Date 04/17/2026  
Time 05:20:31  
Page 2

Lot Data	Square-Foot - NBHD 1170 #1	Primary Image
Lot Size		
Lot Count		
Units Buildable	1	
Non-Ag Acres	1.1135	
Topography		
Street Access		
Utilities		
Amenities	LAND QUALITY	
	0	
	0	
Method	Square-Foot	
Base Lot Value	48,506.00 x 1.43 = 69,142	
Factor Value		
Adjustments	1.0000	
Lot Value	69,142	

Residential Data	
Type	1 Single Family Residence
Condition	3 - Average
Quality	2.5 - Fair
Architecture	R3 Res Nbhd 3
Style	100% One Story
Exterior Wall	40% Veneer, Stone 60% Frame, Siding, Wood
Base/Total Area	1,512 / 1,512
Style	100% One Story
HVAC	100% Warmed & Cooled Air
Roof Cover	1 Composition Shingle
Area on Slab	0
Fixture/RghIn	7 /
Bed/F/H Bath	3 / 1.5 /
Basement Area	
Garage Type	400 Attached Garage - Unfinished
Remodel	
Year/Eff Age	1965 / 46

Cost Approach		Manual : 01/2025	
Base Cost	101,25	Total Misc Impr	+ 5,484
Roofing Adj	+ 4.40	Garage Cost	+ 11,700
Subfloor Adj	+ 1.15	Total RCN	= 205,231
Heat/Cool Adj	+ 11.47	Depreciation ( 53%)	- 108,772
Plumbing Adj	+ 6.10	Lump Sums	+ 6,245
Basement Adj	+ 0.00	RCNLD	= 102,704
Adj Base Cost	= 124.37	Lot Value	+ 69,142
Total Area	x 1,512	Indicated Value	= 171,846
Adjusted Cost	= 188,047	Value Per SqFt	113.65



\\tsclient\T\LOGAN\LOGAN RESIDENTIAL VI\2023-9-12\IMG\_003 9/12/2023

GRM Approach	
GRM Code	
Gross Rent	0.00
Indicated Value	

Multiple Regression			
MRA Code	1	Test	
Adusted R	0.8445		
Indicated Value	147,116	97.30	Per SqFt

Direct Comparables	
Selection Model	A Adam Test
Adjustment Model	1 2022 Residential
Comparables	8
Indicated Value	170,140 Per SqFt

Value Reconciliation			
Selected Approach	Cost Approach		
Improvements	102,704		
Lot Value	69,142		
Indicated Value	171,846	113.65	Per SqFt
Agland Value			
Site Improvements	5,121		
Total Value	176,967	117.04	Total Value Per SqFt

Miscellaneous Improvements								
Code	Description	Sketch ID	Size	Year	Units	Unit Cost	Depr	Value
FPR1	FIREPLACE - RESIDENTIAL 1 STORY	0		1	1	5,095.98		5,096
WODO	WOOD DECK - OPEN	40359	18x12		216	20.09	30%	3,038
PRCH	SLAB PORCH - COVERED	40360	4x4		16	24.22		388
WODO	WOOD DECK - OPEN	40361	245		245	18.70	30%	3,207



# Rogers

## Assessment Property Record Card for Tax Year 2026

Data provided by LISA DELOZIER County Assessor

Date 04/17/2026  
 Time 05:20:31  
 Page 3

### Sketch Image

660016781

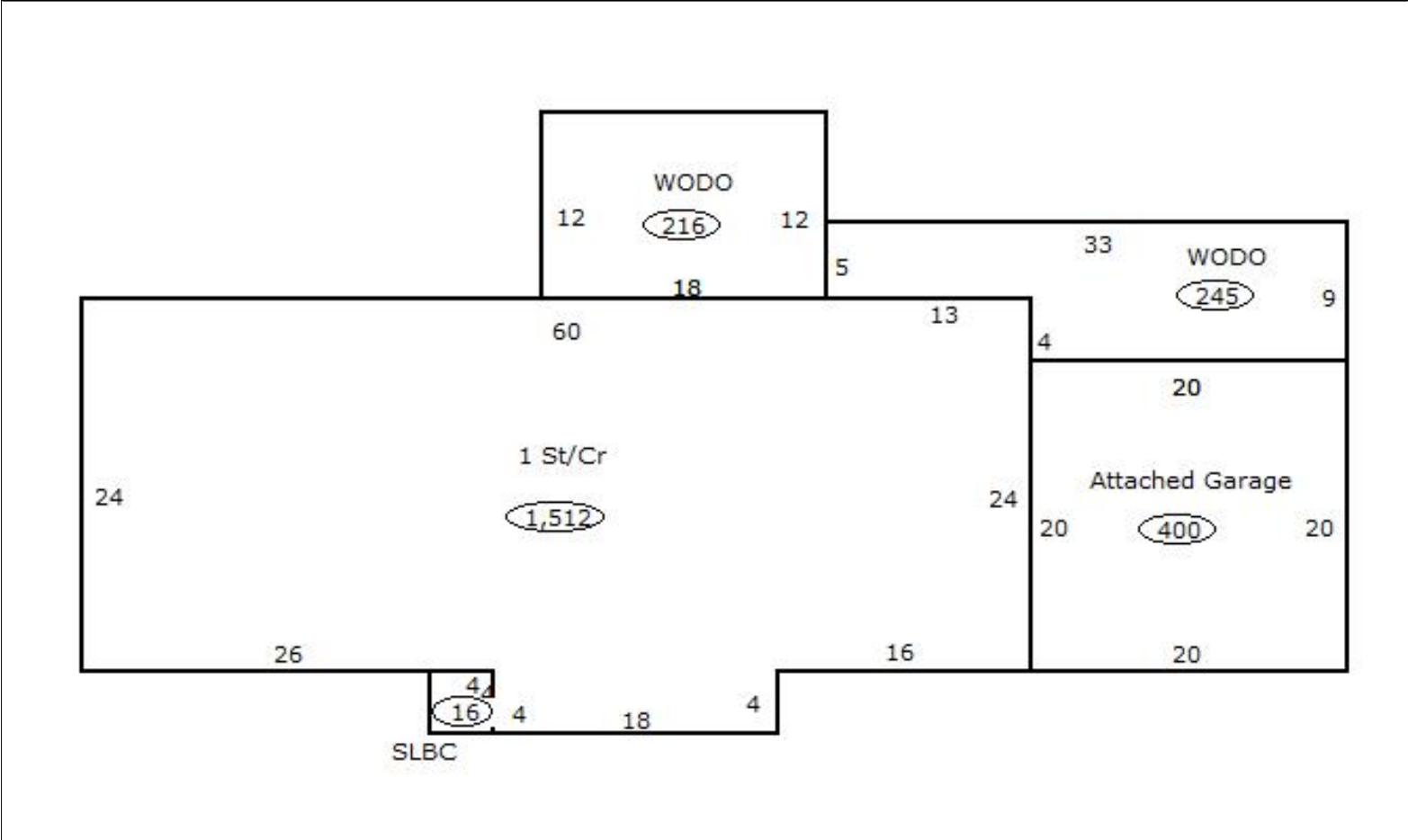

### Sketch Vector Information

Sequence	Code	Type	Built Over	Scale	Section Label	Base Area	Multiplier	Total Area
1	R	1	Crawl	13	1 St/Cr	1,512	1.000	1,512
2	G	1		13	Attached Garage	400	1.000	400
3	M	WODO		13	WODO	216	1.000	216
4	M	PRCH		13	SLBC	16	1.000	16
5	M	WODO		13	WODO	245	1.000	245
<b>Total Building Area</b>						1,512		1,512



# Rogers



## Assessment Property Record Card for Tax Year 2026

Data provided by LISA DELOZIER County Assessor

Date 04/17/2026  
 Time 05:20:31  
 Page 4

660016781

### Outbuildings/Site Improvements

Building Image	Code	Description	Dimensions	Floor	Roofing	Total Units	
	STF	STG FAIR	24x32x0			768	
	Qual	2	Cond 3	Year	Eff Age 1520		
	<b>Valuation Summary</b>		<b>Modifier Total</b>		<b>RCN</b>	<b>Depr (5% Phys/ % Func)</b>	<b>RCNLD</b>
Base Cost (4.68 x 768)		3,594			3,594	180	3,414
	STF	STG FAIR	16x24x0			384	
	Qual	2	Cond 3	Year	Eff Age 1520		
	<b>Valuation Summary</b>		<b>Modifier Total</b>		<b>RCN</b>	<b>Depr (5% Phys/ % Func)</b>	<b>RCNLD</b>
Base Cost (4.68 x 384)		1,797			1,797	90	1,707
	CP	CARPORT DIRT	0x0x0				
	Qual		Cond	Year	Eff Age		
	<b>Valuation Summary</b>		<b>Modifier Total</b>		<b>RCN</b>	<b>Depr (100% Phys/ % Func)</b>	<b>RCNLD</b>
Base Cost (3.50 x )							