



Rogers

Assessment Property Record Card for Tax Year 2026

Data provided by LISA DELOZIER County Assessor

Date 04/16/2026
Time 22:25:16
Page 1

Assessment Data					Primary Image																																																																																																																				
Account 660016920 Parcel ID 22N16E-18-4-00000-000-0000 Cadastral ID 18-22-16-01430 Property Type REAL - Real Property Property Class RR VI Area 1 Tax Area 10 - OOLOGAH RURAL/NW FIRE Name ID 39374 GREEVER, FRANCIS M PO BOX 1647 CLAREMORE OK 74018-0000 Parcel Location Situs 15600 S CANYON OAKS LN Subdivision Lot/Block / Parcel Size 1.81 - Acres Sec/Twn/Rng 18 / 22 / 16 / 4 Neighborhood 6030 - UNPLATTED School District S004 - OOLOGAH SCHOOLS																																																																																																																									
Legal Description Lat/Long: 36.38670350 -95.64091897 TR IN W2 SE, BEG SE/C SE, W 1636.98', N 805.68', N 31-57 W 1689.56', N 112.61', TO TRUE POB, E 252.70', AROUND CUL-DE- SAC (RAD 60) 71.41', N 220.29' W 290', S 275.91' TO POB																																																																																																																									
Exemptions <table border="1"> <thead> <tr> <th>Code</th> <th>Type</th> <th>Active</th> <th>Maximum</th> <th>Exemption</th> </tr> </thead> <tbody> <tr> <td>H</td> <td>Homestead</td> <td>Yes</td> <td>1,000</td> <td>1,000</td> </tr> </tbody> </table>					Code	Type	Active	Maximum	Exemption	H	Homestead	Yes	1,000	1,000	Building Permits <table border="1"> <thead> <tr> <th>Number</th> <th>Description</th> <th>Opened</th> <th>Closed</th> <th>Amount</th> </tr> </thead> <tbody> <tr> <td></td> <td></td> <td></td> <td></td> <td></td> </tr> </tbody> </table>					Number	Description	Opened	Closed	Amount																																																																																																	
Code	Type	Active	Maximum	Exemption																																																																																																																					
H	Homestead	Yes	1,000	1,000																																																																																																																					
Number	Description	Opened	Closed	Amount																																																																																																																					
Parcel Valuation <table border="1"> <thead> <tr> <th>Source</th> <th>REAL</th> <th>Fair Cash</th> <th>Capped</th> <th>Asmnt Level</th> <th>Assessed</th> <th>Levy Rate</th> <th>108.182</th> <th>Current Tax</th> </tr> </thead> <tbody> <tr> <td>Remove Cap</td> <td>0</td> <td>Land Value 62,503</td> <td>30,346</td> <td>11%</td> <td>3,338</td> <td>Assessed</td> <td>26,796</td> <td>2,898.83</td> </tr> <tr> <td>Year Frozen</td> <td>0</td> <td>Improvements 263,087</td> <td>213,259</td> <td></td> <td>23,458</td> <td>Penalty</td> <td>0</td> <td></td> </tr> <tr> <td>Uncapped Value</td> <td>0</td> <td>Mobile Home 0</td> <td>0</td> <td></td> <td>0</td> <td>Exemption</td> <td>1,000</td> <td>-94.00</td> </tr> <tr> <td>TIF Project ID</td> <td>0</td> <td>Total Value 325,590</td> <td>243,605</td> <td></td> <td>26,796</td> <td>Total Taxable</td> <td>25,796</td> <td>2,805.00</td> </tr> </tbody> </table>					Source	REAL	Fair Cash	Capped	Asmnt Level	Assessed	Levy Rate	108.182	Current Tax	Remove Cap	0	Land Value 62,503	30,346	11%	3,338	Assessed	26,796	2,898.83	Year Frozen	0	Improvements 263,087	213,259		23,458	Penalty	0		Uncapped Value	0	Mobile Home 0	0		0	Exemption	1,000	-94.00	TIF Project ID	0	Total Value 325,590	243,605		26,796	Total Taxable	25,796	2,805.00	Sale History <table border="1"> <thead> <tr> <th>Bk/Pg</th> <th>Grantor</th> <th>Date</th> <th>Price</th> <th>Code</th> </tr> </thead> <tbody> <tr> <td>828/412</td> <td></td> <td></td> <td>15,500</td> <td>No</td> </tr> <tr> <td>827/516</td> <td></td> <td></td> <td>7,000</td> <td>No</td> </tr> </tbody> </table>					Bk/Pg	Grantor	Date	Price	Code	828/412			15,500	No	827/516			7,000	No																																																				
Source	REAL	Fair Cash	Capped	Asmnt Level	Assessed	Levy Rate	108.182	Current Tax																																																																																																																	
Remove Cap	0	Land Value 62,503	30,346	11%	3,338	Assessed	26,796	2,898.83																																																																																																																	
Year Frozen	0	Improvements 263,087	213,259		23,458	Penalty	0																																																																																																																		
Uncapped Value	0	Mobile Home 0	0		0	Exemption	1,000	-94.00																																																																																																																	
TIF Project ID	0	Total Value 325,590	243,605		26,796	Total Taxable	25,796	2,805.00																																																																																																																	
Bk/Pg	Grantor	Date	Price	Code																																																																																																																					
828/412			15,500	No																																																																																																																					
827/516			7,000	No																																																																																																																					
Assessment History <table border="1"> <thead> <tr> <th>Tax Year</th> <th>Statement Number</th> <th>Billed Owner</th> <th>Tax Area</th> <th>Total Value</th> <th>Exemptions</th> <th>Taxable Value</th> <th>Billed Tax</th> </tr> </thead> <tbody> <tr><td>2025</td><td>2025-660016920</td><td>GREEVER, FRANCIS M</td><td>10</td><td>302,584</td><td>1000</td><td>25,016</td><td>2,721.00</td></tr> <tr><td>2024</td><td>2024-660016920</td><td>GREEVER, FRANCIS M</td><td>10</td><td>319,292</td><td>1000</td><td>24,258</td><td>2,555.00</td></tr> <tr><td>2023</td><td>2023-660016920</td><td>GREEVER, FRANCIS M</td><td>10</td><td>225,124</td><td>1000</td><td>23,522</td><td>2,461.00</td></tr> <tr><td>2022</td><td>2022-660016920</td><td>GREEVER, FRANCIS M</td><td>10</td><td>231,005</td><td>1000</td><td>22,808</td><td>2,375.00</td></tr> <tr><td>2021</td><td>2021-660016920</td><td>GREEVER, FRANCIS M</td><td>10</td><td>217,563</td><td>1000</td><td>22,115</td><td>2,319.00</td></tr> <tr><td>2020</td><td>2020-660016920</td><td>GREEVER, FRANCIS M</td><td>10</td><td>212,990</td><td>1000</td><td>21,441</td><td>2,282.00</td></tr> <tr><td>2019</td><td>2019-660016920</td><td>GREEVER, FRANCIS M</td><td>10</td><td>198,075</td><td>1000</td><td>20,788</td><td>2,171.00</td></tr> <tr><td>2018</td><td>2018-660016920</td><td>GREEVER, FRANCIS M</td><td>10</td><td>205,882</td><td>1000</td><td>21,647</td><td>2,338.00</td></tr> <tr><td>2017</td><td>2017-660016920</td><td>GREEVER, FRANCIS M</td><td>10</td><td>204,079</td><td>1000</td><td>21,001</td><td>2,401.00</td></tr> <tr><td>2016</td><td>2016-660016920</td><td>GREEVER, FRANCIS M</td><td>10</td><td>198,516</td><td>1000</td><td>20,360</td><td>2,122.00</td></tr> <tr><td>2015</td><td>2015-660016920</td><td>GREEVER, FRANCIS M</td><td>10</td><td>193,020</td><td>1000</td><td>19,738</td><td>1,946.00</td></tr> <tr><td>2014</td><td>2014-660016920</td><td>GREEVER, FRANCIS M</td><td>10</td><td>196,608</td><td>1000</td><td>19,134</td><td>1,884.00</td></tr> <tr><td>2013</td><td>2013-660016920</td><td>GREEVER, FRANCIS M</td><td>10</td><td>184,357</td><td>1000</td><td>18,548</td><td>1,767.00</td></tr> </tbody> </table>										Tax Year	Statement Number	Billed Owner	Tax Area	Total Value	Exemptions	Taxable Value	Billed Tax	2025	2025-660016920	GREEVER, FRANCIS M	10	302,584	1000	25,016	2,721.00	2024	2024-660016920	GREEVER, FRANCIS M	10	319,292	1000	24,258	2,555.00	2023	2023-660016920	GREEVER, FRANCIS M	10	225,124	1000	23,522	2,461.00	2022	2022-660016920	GREEVER, FRANCIS M	10	231,005	1000	22,808	2,375.00	2021	2021-660016920	GREEVER, FRANCIS M	10	217,563	1000	22,115	2,319.00	2020	2020-660016920	GREEVER, FRANCIS M	10	212,990	1000	21,441	2,282.00	2019	2019-660016920	GREEVER, FRANCIS M	10	198,075	1000	20,788	2,171.00	2018	2018-660016920	GREEVER, FRANCIS M	10	205,882	1000	21,647	2,338.00	2017	2017-660016920	GREEVER, FRANCIS M	10	204,079	1000	21,001	2,401.00	2016	2016-660016920	GREEVER, FRANCIS M	10	198,516	1000	20,360	2,122.00	2015	2015-660016920	GREEVER, FRANCIS M	10	193,020	1000	19,738	1,946.00	2014	2014-660016920	GREEVER, FRANCIS M	10	196,608	1000	19,134	1,884.00	2013	2013-660016920	GREEVER, FRANCIS M	10	184,357	1000	18,548	1,767.00
Tax Year	Statement Number	Billed Owner	Tax Area	Total Value	Exemptions	Taxable Value	Billed Tax																																																																																																																		
2025	2025-660016920	GREEVER, FRANCIS M	10	302,584	1000	25,016	2,721.00																																																																																																																		
2024	2024-660016920	GREEVER, FRANCIS M	10	319,292	1000	24,258	2,555.00																																																																																																																		
2023	2023-660016920	GREEVER, FRANCIS M	10	225,124	1000	23,522	2,461.00																																																																																																																		
2022	2022-660016920	GREEVER, FRANCIS M	10	231,005	1000	22,808	2,375.00																																																																																																																		
2021	2021-660016920	GREEVER, FRANCIS M	10	217,563	1000	22,115	2,319.00																																																																																																																		
2020	2020-660016920	GREEVER, FRANCIS M	10	212,990	1000	21,441	2,282.00																																																																																																																		
2019	2019-660016920	GREEVER, FRANCIS M	10	198,075	1000	20,788	2,171.00																																																																																																																		
2018	2018-660016920	GREEVER, FRANCIS M	10	205,882	1000	21,647	2,338.00																																																																																																																		
2017	2017-660016920	GREEVER, FRANCIS M	10	204,079	1000	21,001	2,401.00																																																																																																																		
2016	2016-660016920	GREEVER, FRANCIS M	10	198,516	1000	20,360	2,122.00																																																																																																																		
2015	2015-660016920	GREEVER, FRANCIS M	10	193,020	1000	19,738	1,946.00																																																																																																																		
2014	2014-660016920	GREEVER, FRANCIS M	10	196,608	1000	19,134	1,884.00																																																																																																																		
2013	2013-660016920	GREEVER, FRANCIS M	10	184,357	1000	18,548	1,767.00																																																																																																																		



Rogers

Assessment Property Record Card for Tax Year 2026

Data provided by LISA DELOZIER County Assessor

Date 04/16/2026
Time 22:25:17
Page 2

Lot Data	Square-Foot - UNPLATTED (ACRES)	Primary Image
Lot Size		
Lot Count		
Units Buildable	1.81	
Non-Ag Acres	1.7543	
Topography		
Street Access		
Utilities		
Amenities	LAND QUALITY	
	0	
	0	
Method	Square-Foot	
Base Lot Value	76,417.00 x .82 = 62,503	
Factor Value		
Adjustments	1.0000	
Lot Value	62,503	

Residential Data	
Type	1 Single Family Residence
Condition	3 - Average
Quality	4 - Good
Architecture	
Style	100% 1 1/2 Story Finished
Exterior Wall	30% Veneer, Stone 70% Frame, Siding, Vinyl
Base/Total Area	2,075 / 2,697
Style	100% 1 1/2 Story Finished
HVAC	100% Warmed & Cooled Air
Roof Cover	1 Composition Shingle
Area on Slab	2,075
Fixture/RghIn	14 /
Bed/F/H Bath	3 / 2.5 /
Basement Area	
Garage Type	668 Attached Garage - Unfinished
Remodel	
Year/Eff Age	1990 / 27



\\tsclient\T\LOGAN\LOGAN RESIDENTIAL VI\2022-12-3\IMG_002' 12/5/2022

GRM Approach	
GRM Code	
Gross Rent	0.00
Indicated Value	

Multiple Regression			
MRA Code	1	Test	
Adusted R	0.8445		
Indicated Value	361,899	134.19	Per SqFt

Direct Comparables	
Selection Model	1 Res
Adjustment Model	A2 AO Test
Comparables	
Indicated Value	

Cost Approach				Manual : 01/2025			
Base Cost	100.34	Total Misc Impr	+	8,633			
Roofing Adj	+ 4.62	Garage Cost	+	30,675			
Subfloor Adj	+ -3.55	Total RCN	=	381,989			
Heat/Cool Adj	+ 16.31	Depreciation (34%)	-	129,876			
Plumbing Adj	+ 9.34	Lump Sums	+	10,300			
Basement Adj	+ 0.00	RCNLD	=	262,413			
Adj Base Cost	= 127.06	Lot Value	+	62,503			
Total Area	x 2,697	Indicated Value	=	324,916			
Adjusted Cost	= 342,681	Value Per SqFt		120.47			

Value Reconciliation			
Selected Approach	Cost Approach		
Improvements	262,413		
Lot Value	62,503		
Indicated Value	324,916	120.47	Per SqFt
Agland Value			
Site Improvements	674		
Total Value	325,590	120.72	Total Value Per SqFt

Miscellaneous Improvements								
Code	Description	Sketch ID	Size	Year	Units	Unit Cost	Depr	Value
FPR1	FIREPLACE - RESIDENTIAL 1 STORY	0		1	1	7,243.87		7,244
PRCH	SLAB PORCH - COVERED	40767		7x6	42	33.06		1,389
WODO	WOOD DECK - OPEN	40768		974	974	21.15	50%	10,300



Rogers

Assessment Property Record Card for Tax Year 2026

Data provided by LISA DELOZIER County Assessor

Date 04/16/2026
 Time 22:25:17
 Page 3

Sketch Image

660016920

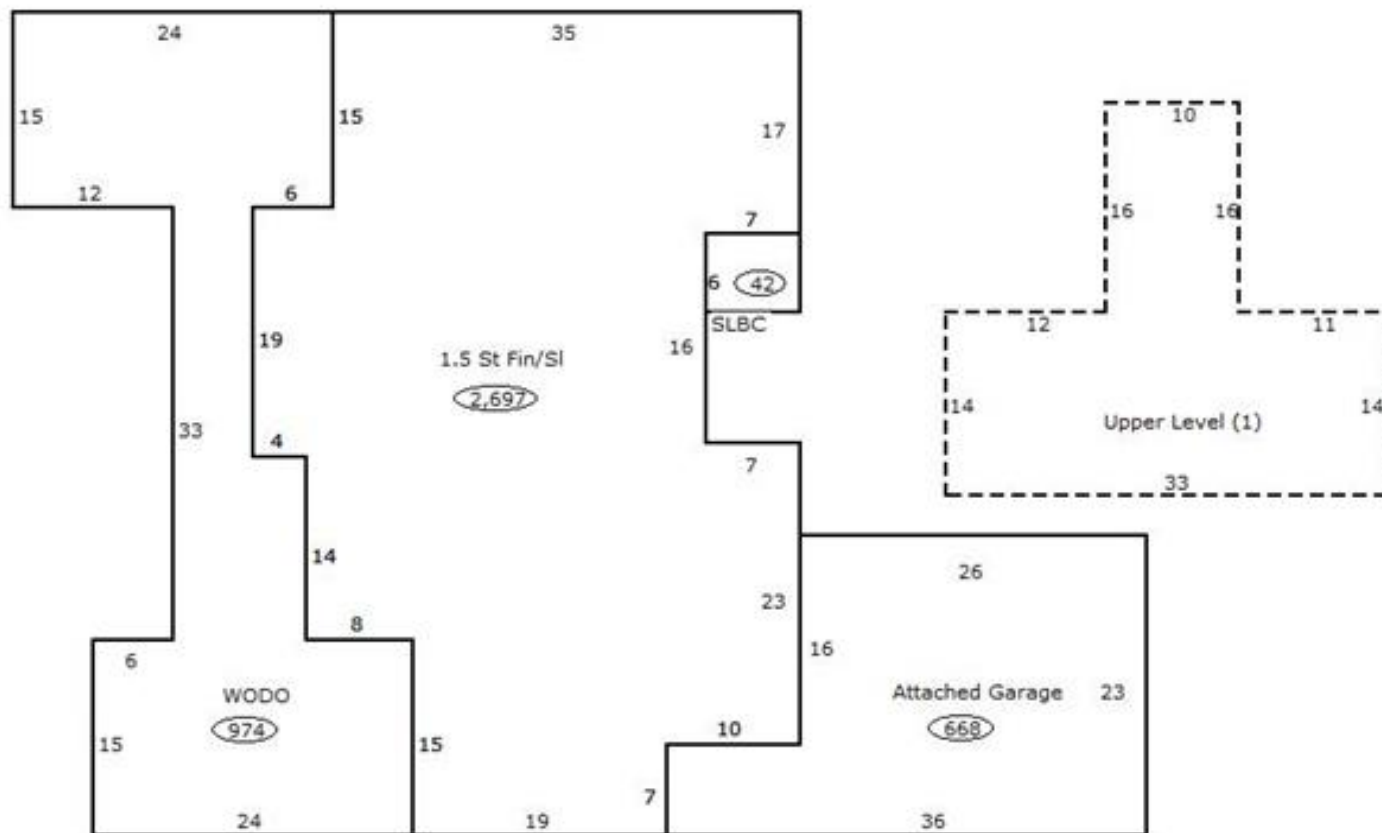

Sketch Vector Information

Sequence	Code	Type	Built Over	Scale	Section Label	Base Area	Multiplier	Total Area
1	R	5	Slab	13	1.5 St Fin/SI	2,075	1.300	2,697
2	G	1		13	Attached Garage	668	1.000	668
3	M	PRCH		13	SLBC	42	1.000	42
4	M	WODO		13	WODO	974	1.000	974
5	U	^UL		13	Upper Level (1)	622	1.000	622
Total Building Area						2,075		2,697



Rogers

Assessment Property Record Card for Tax Year 2026

Data provided by LISA DELOZIER County Assessor

Date 04/16/2026
Time 22:25:17
Page 4

660016920

Outbuildings/Site Improvements

Building Image	Code	Description	Dimensions	Floor	Roofing	Total Units
	STF	STG FAIR	0x0x0			320
	Qual	2	Cond 3	Year	Eff Age	
Valuation Summary		Modifier Total		RCN	Depr (55% Phys/ % Func)	RCNLD
Base Cost (4.68 x 320)		1,498		1,498	824	674