



Rogers

Assessment Property Record Card for Tax Year 2026

Data provided by LISA DELOZIER County Assessor

Date 04/16/2026
Time 21:57:17
Page 1

Assessment Data					Primary Image																																																																																																																				
Account 660016956 Parcel ID 000000-00-0-00114-003-0016 Cadastral ID 18-22-16-02010 Property Type REAL - Real Property Property Class RRP VI Area 1 Tax Area 10 - OOLOGAH RURAL/NW FIRE Name ID 202044 INGRAM, PATRICIA TRUSTEE 15611 S CANYON OAKS LN CLAREMORE OK 74017-0000 Parcel Location Situs 15611 S CANYON OAKS LN Subdivision CANYON OAKS Lot/Block 0016 / 0003 Parcel Size 2 - Lots Sec/Twn/Rng 18 / 22 / 16 / 5 Neighborhood 1151 - R-V01,4-NW OOLOGAH School District S004 - OOLOGAH SCHOOLS																																																																																																																									
Legal Description Lat/Long: 36.38661345 -95.63985256																																																																																																																									
Legal Description LOTS 16 & 17 BLOCK 3 CANYON OAKS					Building Permits <table border="1"> <thead> <tr> <th>Number</th> <th>Description</th> <th>Opened</th> <th>Closed</th> <th>Amount</th> </tr> </thead> <tbody> <tr> <td></td> <td></td> <td></td> <td></td> <td></td> </tr> </tbody> </table>					Number	Description	Opened	Closed	Amount																																																																																																											
Number	Description	Opened	Closed	Amount																																																																																																																					
Exemptions <table border="1"> <thead> <tr> <th>Code</th> <th>Type</th> <th>Active</th> <th>Maximum</th> <th>Exemption</th> </tr> </thead> <tbody> <tr> <td>H</td> <td>Homestead</td> <td>Yes</td> <td>1,000</td> <td>1,000</td> </tr> </tbody> </table>					Code	Type	Active	Maximum	Exemption	H	Homestead	Yes	1,000	1,000	Sale History <table border="1"> <thead> <tr> <th>Bk/Pg</th> <th>Grantor</th> <th>Date</th> <th>Price</th> <th>Code</th> </tr> </thead> <tbody> <tr> <td>2693/258</td> <td>INGRAM, PATRICIA</td> <td>02/22/2018</td> <td>0</td> <td>4</td> </tr> <tr> <td>2692/414</td> <td>INGRAM, WESLEY M &</td> <td>02/09/2018</td> <td>0</td> <td>4</td> </tr> <tr> <td>836/867</td> <td></td> <td></td> <td>18,000</td> <td>No</td> </tr> </tbody> </table>					Bk/Pg	Grantor	Date	Price	Code	2693/258	INGRAM, PATRICIA	02/22/2018	0	4	2692/414	INGRAM, WESLEY M &	02/09/2018	0	4	836/867			18,000	No																																																																																		
Code	Type	Active	Maximum	Exemption																																																																																																																					
H	Homestead	Yes	1,000	1,000																																																																																																																					
Bk/Pg	Grantor	Date	Price	Code																																																																																																																					
2693/258	INGRAM, PATRICIA	02/22/2018	0	4																																																																																																																					
2692/414	INGRAM, WESLEY M &	02/09/2018	0	4																																																																																																																					
836/867			18,000	No																																																																																																																					
Parcel Valuation <table border="1"> <thead> <tr> <th>Source</th> <th>REAL</th> <th>Fair Cash</th> <th>Capped</th> <th>Asmnt Level</th> <th>Assessed</th> <th>Levy Rate</th> <th>108.182</th> <th>Current Tax</th> </tr> </thead> <tbody> <tr> <td>Remove Cap</td> <td>0</td> <td>Land Value 92,498</td> <td>27,596</td> <td>11%</td> <td>3,036</td> <td>Assessed</td> <td>32,918</td> <td>3,561.12</td> </tr> <tr> <td>Year Frozen</td> <td>0</td> <td>Improvements 319,696</td> <td>271,656</td> <td></td> <td>29,882</td> <td>Penalty</td> <td>0</td> <td></td> </tr> <tr> <td>Uncapped Value</td> <td>0</td> <td>Mobile Home 0</td> <td>0</td> <td></td> <td>0</td> <td>Exemption</td> <td>1,000</td> <td>-94.00</td> </tr> <tr> <td>TIF Project ID</td> <td>0</td> <td>Total Value 412,194</td> <td>299,252</td> <td></td> <td>32,918</td> <td>Total Taxable</td> <td>31,918</td> <td>3,467.00</td> </tr> </tbody> </table>										Source	REAL	Fair Cash	Capped	Asmnt Level	Assessed	Levy Rate	108.182	Current Tax	Remove Cap	0	Land Value 92,498	27,596	11%	3,036	Assessed	32,918	3,561.12	Year Frozen	0	Improvements 319,696	271,656		29,882	Penalty	0		Uncapped Value	0	Mobile Home 0	0		0	Exemption	1,000	-94.00	TIF Project ID	0	Total Value 412,194	299,252		32,918	Total Taxable	31,918	3,467.00																																																																			
Source	REAL	Fair Cash	Capped	Asmnt Level	Assessed	Levy Rate	108.182	Current Tax																																																																																																																	
Remove Cap	0	Land Value 92,498	27,596	11%	3,036	Assessed	32,918	3,561.12																																																																																																																	
Year Frozen	0	Improvements 319,696	271,656		29,882	Penalty	0																																																																																																																		
Uncapped Value	0	Mobile Home 0	0		0	Exemption	1,000	-94.00																																																																																																																	
TIF Project ID	0	Total Value 412,194	299,252		32,918	Total Taxable	31,918	3,467.00																																																																																																																	
Assessment History <table border="1"> <thead> <tr> <th>Tax Year</th> <th>Statement Number</th> <th>Billed Owner</th> <th>Tax Area</th> <th>Total Value</th> <th>Exemptions</th> <th>Taxable Value</th> <th>Billed Tax</th> </tr> </thead> <tbody> <tr><td>2025</td><td>2025-660016956</td><td>INGRAM, PATRICIA</td><td>10</td><td>410,129</td><td>1000</td><td>30,959</td><td>3,363.00</td></tr> <tr><td>2024</td><td>2024-660016956</td><td>INGRAM, PATRICIA</td><td>10</td><td>423,310</td><td>1000</td><td>30,028</td><td>3,159.00</td></tr> <tr><td>2023</td><td>2023-660016956</td><td>INGRAM, PATRICIA</td><td>10</td><td>310,886</td><td>1000</td><td>29,125</td><td>3,043.00</td></tr> <tr><td>2022</td><td>2022-660016956</td><td>INGRAM, PATRICIA</td><td>10</td><td>301,274</td><td>1000</td><td>28,247</td><td>2,937.00</td></tr> <tr><td>2021</td><td>2021-660016956</td><td>INGRAM, PATRICIA</td><td>10</td><td>300,641</td><td>1000</td><td>27,395</td><td>2,869.00</td></tr> <tr><td>2020</td><td>2020-660016956</td><td>INGRAM, PATRICIA</td><td>10</td><td>301,498</td><td>1000</td><td>26,568</td><td>2,824.00</td></tr> <tr><td>2019</td><td>2019-660016956</td><td>INGRAM, PATRICIA</td><td>10</td><td>285,429</td><td>1000</td><td>25,766</td><td>2,688.00</td></tr> <tr><td>2018</td><td>2018-660016956</td><td>INGRAM, PATRICIA</td><td>10</td><td>287,221</td><td>1000</td><td>24,986</td><td>2,697.00</td></tr> <tr><td>2017</td><td>2017-660016956</td><td>INGRAM, WESLEY M &</td><td>10</td><td>284,389</td><td>1000</td><td>24,229</td><td>2,768.00</td></tr> <tr><td>2016</td><td>2016-660016956</td><td>INGRAM, WESLEY M &</td><td>10</td><td>276,746</td><td>1000</td><td>23,494</td><td>2,447.00</td></tr> <tr><td>2015</td><td>2015-660016956</td><td>INGRAM, WESLEY M &</td><td>10</td><td>267,720</td><td>1000</td><td>22,781</td><td>2,245.00</td></tr> <tr><td>2014</td><td>2014-660016956</td><td>INGRAM, WESLEY M &</td><td>10</td><td>273,453</td><td>1000</td><td>22,088</td><td>2,173.00</td></tr> <tr><td>2013</td><td>2013-660016956</td><td>INGRAM, WESLEY M &</td><td>10</td><td>257,253</td><td>1000</td><td>21,416</td><td>2,038.00</td></tr> </tbody> </table>										Tax Year	Statement Number	Billed Owner	Tax Area	Total Value	Exemptions	Taxable Value	Billed Tax	2025	2025-660016956	INGRAM, PATRICIA	10	410,129	1000	30,959	3,363.00	2024	2024-660016956	INGRAM, PATRICIA	10	423,310	1000	30,028	3,159.00	2023	2023-660016956	INGRAM, PATRICIA	10	310,886	1000	29,125	3,043.00	2022	2022-660016956	INGRAM, PATRICIA	10	301,274	1000	28,247	2,937.00	2021	2021-660016956	INGRAM, PATRICIA	10	300,641	1000	27,395	2,869.00	2020	2020-660016956	INGRAM, PATRICIA	10	301,498	1000	26,568	2,824.00	2019	2019-660016956	INGRAM, PATRICIA	10	285,429	1000	25,766	2,688.00	2018	2018-660016956	INGRAM, PATRICIA	10	287,221	1000	24,986	2,697.00	2017	2017-660016956	INGRAM, WESLEY M &	10	284,389	1000	24,229	2,768.00	2016	2016-660016956	INGRAM, WESLEY M &	10	276,746	1000	23,494	2,447.00	2015	2015-660016956	INGRAM, WESLEY M &	10	267,720	1000	22,781	2,245.00	2014	2014-660016956	INGRAM, WESLEY M &	10	273,453	1000	22,088	2,173.00	2013	2013-660016956	INGRAM, WESLEY M &	10	257,253	1000	21,416	2,038.00
Tax Year	Statement Number	Billed Owner	Tax Area	Total Value	Exemptions	Taxable Value	Billed Tax																																																																																																																		
2025	2025-660016956	INGRAM, PATRICIA	10	410,129	1000	30,959	3,363.00																																																																																																																		
2024	2024-660016956	INGRAM, PATRICIA	10	423,310	1000	30,028	3,159.00																																																																																																																		
2023	2023-660016956	INGRAM, PATRICIA	10	310,886	1000	29,125	3,043.00																																																																																																																		
2022	2022-660016956	INGRAM, PATRICIA	10	301,274	1000	28,247	2,937.00																																																																																																																		
2021	2021-660016956	INGRAM, PATRICIA	10	300,641	1000	27,395	2,869.00																																																																																																																		
2020	2020-660016956	INGRAM, PATRICIA	10	301,498	1000	26,568	2,824.00																																																																																																																		
2019	2019-660016956	INGRAM, PATRICIA	10	285,429	1000	25,766	2,688.00																																																																																																																		
2018	2018-660016956	INGRAM, PATRICIA	10	287,221	1000	24,986	2,697.00																																																																																																																		
2017	2017-660016956	INGRAM, WESLEY M &	10	284,389	1000	24,229	2,768.00																																																																																																																		
2016	2016-660016956	INGRAM, WESLEY M &	10	276,746	1000	23,494	2,447.00																																																																																																																		
2015	2015-660016956	INGRAM, WESLEY M &	10	267,720	1000	22,781	2,245.00																																																																																																																		
2014	2014-660016956	INGRAM, WESLEY M &	10	273,453	1000	22,088	2,173.00																																																																																																																		
2013	2013-660016956	INGRAM, WESLEY M &	10	257,253	1000	21,416	2,038.00																																																																																																																		



Rogers

Assessment Property Record Card for Tax Year 2026

Data provided by LISA DELOZIER County Assessor

Date 04/16/2026
Time 21:57:17
Page 2

Lot Data	Square-Foot - NBHD 1151 #1	Primary Image
Lot Size		
Lot Count		
Units Buildable	36000	
Non-Ag Acres	2.067	
Topography		
Street Access		
Utilities		
Amenities	LAND QUALITY	
	0	
	0	
Method	Square-Foot	
Base Lot Value	90,039.00 x 1.03 = 92,498	
Factor Value		
Adjustments	1.0000	
Lot Value	92,498	

Residential Data	
Type	1 Single Family Residence
Condition	3 - Average
Quality	3.5 - Average
Architecture	
Style	100% 1 1/2 Story Finished
Exterior Wall	100% Veneer, Masonry
Base/Total Area	2,136 / 3,204
Style	100% 1 1/2 Story Finished
HVAC	100% Warmed & Cooled Air
Roof Cover	1 Composition Shingle
Area on Slab	2,136
Fixture/RghIn	21 /
Bed/F/H Bath	4 / 3.5 /
Basement Area	
Garage Type	840 Attached Garage - Unfinished
Remodel	
Year/Eff Age	1992 / 26



\\tsclient\T\LOGAN\LOGAN RESIDENTIAL VI\2022-12-1\IMG_003 12/1/2022

GRM Approach	
GRM Code	
Gross Rent	0.00
Indicated Value	

Multiple Regression			
MRA Code	1	Test	
Adusted R	0.8445		
Indicated Value	409,227	127.72	Per SqFt

Direct Comparables			
Selection Model	A	Adam Test	
Adjustment Model	1	2022 Residential	
Comparables	3		
Indicated Value	404,640		Per SqFt

Value Reconciliation			
Selected Approach	Cost Approach		
Improvements	299,696		
Lot Value	92,498		
Indicated Value	392,194	122.41	Per SqFt
Agland Value			
Site Improvements	20,000		
Total Value	412,194	128.65	Total Value Per SqFt

Cost Approach				Manual : 01/2025			
Base Cost	96.41	Total Misc Impr	+	17,079			
Roofing Adj	+ 3.53	Garage Cost	+	31,256			
Subfloor Adj	+ -2.27	Total RCN	=	440,729			
Heat/Cool Adj	+ 14.47	Depreciation (32%)	-	141,033			
Plumbing Adj	+ 10.33	Lump Sums	+	0			
Basement Adj	+ 0.00	RCNLD	=	299,696			
Adj Base Cost	= 122.47	Lot Value	+	92,498			
Total Area	x 3,204	Indicated Value	=	392,194			
Adjusted Cost	= 392,394	Value Per SqFt		122.41			

Miscellaneous Improvements								
Code	Description	Sketch ID	Size	Year	Units	Unit Cost	Depr	Value
FPR1	FIREPLACE - RESIDENTIAL 1 STORY	0		1	1	6,429.63		6,430
PRCH	SLAB PORCH - COVERED	40895	15x12		180	28.88		5,198
PRCH	SLAB PORCH - COVERED	40896	27x7		189	28.84		5,451



Rogers

Assessment Property Record Card for Tax Year 2026

Data provided by LISA DELOZIER County Assessor

Date 04/16/2026
 Time 21:57:17
 Page 3

Sketch Image

660016956

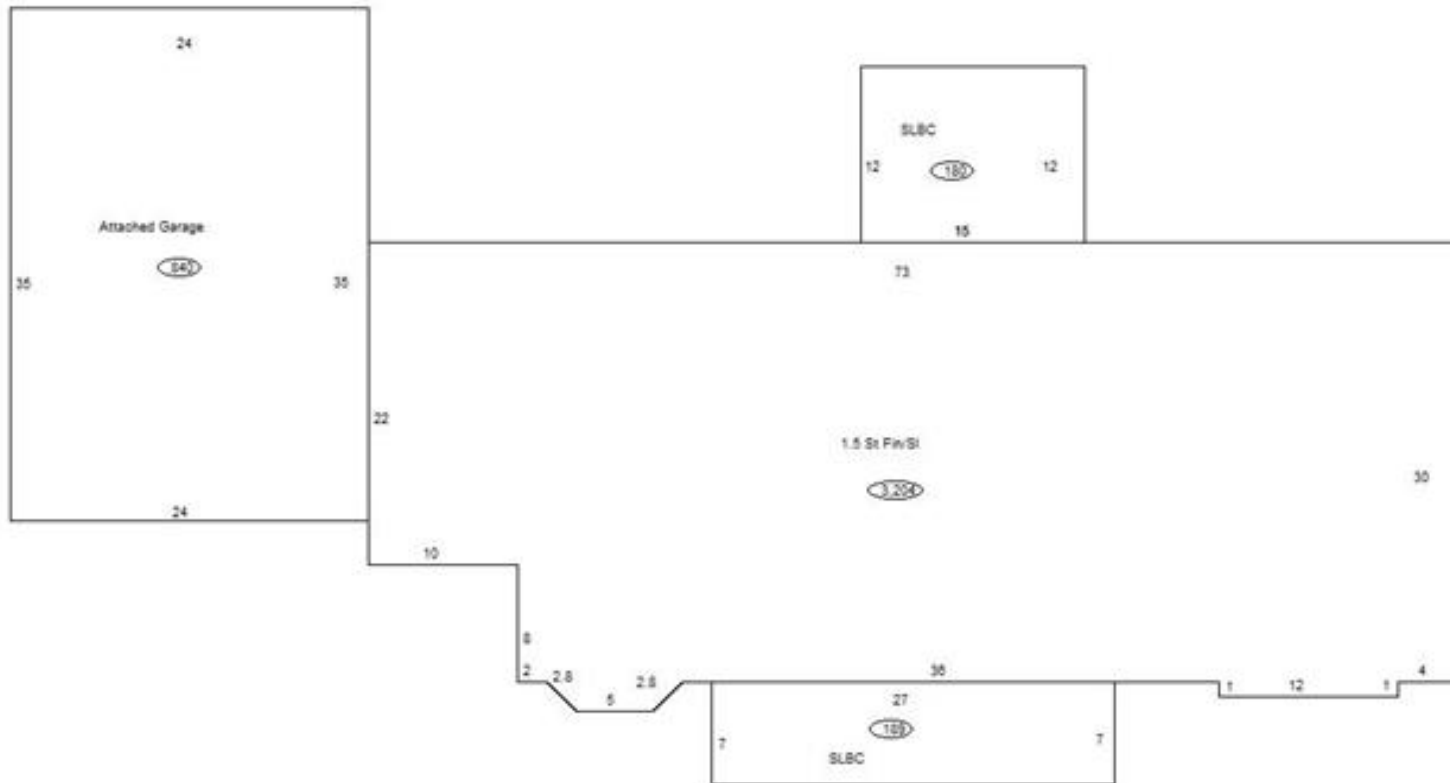

Sketch Vector Information

Sequence	Code	Type	Built Over	Scale	Section Label	Base Area	Multiplier	Total Area
1	R	5	Slab	10	1.5 St Fin/SI	2,136	1.500	3,204
2	G	1		10	Attached Garage	840	1.000	840
3	M	PRCH		10	SLBC	180	1.000	180
4	M	PRCH		10	SLBC	189	1.000	189
Total Building Area						2,136		3,204



Rogers

Assessment Property Record Card for Tax Year 2026

Data provided by LISA DELOZIER County Assessor

Date 04/16/2026
Time 21:57:17
Page 4

660016956

Outbuildings/Site Improvements

Building Image	Code	Description	Dimensions	Floor	Roofing	Total Units
	SV	SWIM VINYL	0x0x0			1
	Qual 3	Cond 3	Year	Eff Age		
Valuation Summary		Modifier Total	RCN	Depr (20% Phys/ % Func)	RCNLD	
Base Cost (25,000.00 x 1)		25,000	25,000	5,000	20,000	