



Rogers

Assessment Property Record Card for Tax Year 2026

Data provided by LISA DELOZIER County Assessor

Date 04/16/2026
Time 21:32:46
Page 1

Assessment Data					Primary Image																																																																																																																				
Account 660016972 Parcel ID 000000-00-0-00114-006-0002 Cadastral ID 18-22-16-02170 Property Type REAL - Real Property Property Class RRP VI Area 1 Tax Area 10 - OOLOGAH RURAL/NW FIRE Name ID 268528 TAYLOR, JIMMY E & CONNIE E 10847 E CANYON OAKS RD CLAREMORE OK 74017-0000 Parcel Location Situs 10847 E CANYON OAKS RD Subdivision CANYON OAKS Lot/Block 0002 / 0006 Parcel Size 1 - Lots Sec/Twn/Rng 18 / 22 / 16 / 5 Neighborhood 1151 - R-V01,4-NW OOLOGAH School District S004 - OOLOGAH SCHOOLS																																																																																																																									
Legal Description Lot/Long: 36.38183980 -95.63501150																																																																																																																									
Building Permits					\\tsclient\T\LOGAN\LOGAN RESIDENTIAL VI\2022-12-1\IMG_003: 12/1/2022																																																																																																																				
LOT 2 BLOCK 6 CANYON OAKS					<table border="1"> <thead> <tr> <th>Number</th> <th>Description</th> <th>Opened</th> <th>Closed</th> <th>Amount</th> </tr> </thead> <tbody> <tr> <td>R12</td> <td>R12-NEW 1930 SQ FT SFR</td> <td>09/2011</td> <td>11/2011</td> <td></td> </tr> </tbody> </table>					Number	Description	Opened	Closed	Amount	R12	R12-NEW 1930 SQ FT SFR	09/2011	11/2011																																																																																																							
Number	Description	Opened	Closed	Amount																																																																																																																					
R12	R12-NEW 1930 SQ FT SFR	09/2011	11/2011																																																																																																																						
Exemptions					Sale History																																																																																																																				
<table border="1"> <thead> <tr> <th>Code</th> <th>Type</th> <th>Active</th> <th>Maximum</th> <th>Exemption</th> </tr> </thead> <tbody> <tr> <td>HV</td> <td>Veteran</td> <td>Yes</td> <td>999,999</td> <td>24,643</td> </tr> </tbody> </table>					Code	Type	Active	Maximum	Exemption	HV	Veteran	Yes	999,999	24,643	<table border="1"> <thead> <tr> <th>Bk/Pg</th> <th>Grantor</th> <th>Date</th> <th>Price</th> <th>Code</th> </tr> </thead> <tbody> <tr> <td>1113/360</td> <td>AULT, LESLIE H &</td> <td>05/21/1998</td> <td>8,000</td> <td>Yes</td> </tr> </tbody> </table>					Bk/Pg	Grantor	Date	Price	Code	1113/360	AULT, LESLIE H &	05/21/1998	8,000	Yes																																																																																												
Code	Type	Active	Maximum	Exemption																																																																																																																					
HV	Veteran	Yes	999,999	24,643																																																																																																																					
Bk/Pg	Grantor	Date	Price	Code																																																																																																																					
1113/360	AULT, LESLIE H &	05/21/1998	8,000	Yes																																																																																																																					
Parcel Valuation																																																																																																																									
<table border="1"> <thead> <tr> <th>Source</th> <th>REAL</th> <th>Fair Cash</th> <th>Capped</th> <th>Asmnt Level</th> <th>Assessed</th> <th>Levy Rate</th> <th>108.182</th> <th>Current Tax</th> </tr> </thead> <tbody> <tr> <td>Remove Cap</td> <td>1999</td> <td>Land Value 69,728</td> <td>38,579</td> <td>11%</td> <td>4,244</td> <td>Assessed</td> <td>24,643</td> <td>2,665.92</td> </tr> <tr> <td>Year Frozen</td> <td>2017</td> <td>Improvements 335,189</td> <td>185,451</td> <td></td> <td>20,399</td> <td>Penalty</td> <td>0</td> <td></td> </tr> <tr> <td>Uncapped Value</td> <td>0</td> <td>Mobile Home 0</td> <td>0</td> <td></td> <td>0</td> <td>Exemption</td> <td>24,643</td> <td>-2,321.00</td> </tr> <tr> <td>TIF Project ID</td> <td>0</td> <td>Total Value 404,917</td> <td>224,030</td> <td></td> <td>24,643</td> <td>Total Taxable</td> <td>0</td> <td>345.00</td> </tr> </tbody> </table>		Source	REAL	Fair Cash	Capped	Asmnt Level	Assessed	Levy Rate	108.182	Current Tax	Remove Cap	1999	Land Value 69,728	38,579	11%	4,244	Assessed	24,643	2,665.92	Year Frozen	2017	Improvements 335,189	185,451		20,399	Penalty	0		Uncapped Value	0	Mobile Home 0	0		0	Exemption	24,643	-2,321.00	TIF Project ID	0	Total Value 404,917	224,030		24,643	Total Taxable	0	345.00																																																																											
Source	REAL	Fair Cash	Capped	Asmnt Level	Assessed	Levy Rate	108.182	Current Tax																																																																																																																	
Remove Cap	1999	Land Value 69,728	38,579	11%	4,244	Assessed	24,643	2,665.92																																																																																																																	
Year Frozen	2017	Improvements 335,189	185,451		20,399	Penalty	0																																																																																																																		
Uncapped Value	0	Mobile Home 0	0		0	Exemption	24,643	-2,321.00																																																																																																																	
TIF Project ID	0	Total Value 404,917	224,030		24,643	Total Taxable	0	345.00																																																																																																																	
Assessment History																																																																																																																									
<table border="1"> <thead> <tr> <th>Tax Year</th> <th>Statement Number</th> <th>Billed Owner</th> <th>Tax Area</th> <th>Total Value</th> <th>Exemptions</th> <th>Taxable Value</th> <th>Billed Tax</th> </tr> </thead> <tbody> <tr><td>2025</td><td>2025-660016972</td><td>TAYLOR, JIMMY E & CONNIE E</td><td>10</td><td>390,524</td><td>24643</td><td></td><td>345.00</td></tr> <tr><td>2024</td><td>2024-660016972</td><td>TAYLOR, JIMMY E & CONNIE E</td><td>10</td><td>408,514</td><td>24643</td><td></td><td>345.00</td></tr> <tr><td>2023</td><td>2023-660016972</td><td>TAYLOR, JIMMY E & CONNIE E</td><td>10</td><td>307,765</td><td>24643</td><td></td><td>345.00</td></tr> <tr><td>2022</td><td>2022-660016972</td><td>TAYLOR, JIMMY E & CONNIE E</td><td>10</td><td>310,231</td><td>24644</td><td></td><td>337.00</td></tr> <tr><td>2021</td><td>2021-660016972</td><td>TAYLOR, JIMMY E & CONNIE E</td><td>10</td><td>265,623</td><td>24643</td><td></td><td>335.00</td></tr> <tr><td>2020</td><td>2020-660016972</td><td>TAYLOR, JIMMY E & CONNIE E</td><td>10</td><td>256,009</td><td>24643</td><td></td><td>346.00</td></tr> <tr><td>2019</td><td>2019-660016972</td><td>TAYLOR, JIMMY E & CONNIE E</td><td>10</td><td>225,985</td><td>24644</td><td></td><td>348.00</td></tr> <tr><td>2018</td><td>2018-660016972</td><td>TAYLOR, JIMMY E & CONNIE E</td><td>10</td><td>231,440</td><td>24643</td><td></td><td>348.00</td></tr> <tr><td>2017</td><td>2017-660016972</td><td>TAYLOR, JIMMY E & CONNIE E</td><td>10</td><td>228,641</td><td>1000</td><td>23,643</td><td>2,701.00</td></tr> <tr><td>2016</td><td>2016-660016972</td><td>TAYLOR, JIMMY E & CONNIE E</td><td>10</td><td>223,023</td><td>1000</td><td>22,926</td><td>2,388.00</td></tr> <tr><td>2015</td><td>2015-660016972</td><td>TAYLOR, JIMMY E & CONNIE E</td><td>10</td><td>216,110</td><td>1000</td><td>22,229</td><td>2,190.00</td></tr> <tr><td>2014</td><td>2014-660016972</td><td>TAYLOR, JIMMY E & CONNIE E</td><td>10</td><td>218,267</td><td>1000</td><td>21,552</td><td>2,120.00</td></tr> <tr><td>2013</td><td>2013-660016972</td><td>TAYLOR, JIMMY E & CONNIE E</td><td>10</td><td>205,747</td><td>1000</td><td>20,895</td><td>1,989.00</td></tr> </tbody> </table>										Tax Year	Statement Number	Billed Owner	Tax Area	Total Value	Exemptions	Taxable Value	Billed Tax	2025	2025-660016972	TAYLOR, JIMMY E & CONNIE E	10	390,524	24643		345.00	2024	2024-660016972	TAYLOR, JIMMY E & CONNIE E	10	408,514	24643		345.00	2023	2023-660016972	TAYLOR, JIMMY E & CONNIE E	10	307,765	24643		345.00	2022	2022-660016972	TAYLOR, JIMMY E & CONNIE E	10	310,231	24644		337.00	2021	2021-660016972	TAYLOR, JIMMY E & CONNIE E	10	265,623	24643		335.00	2020	2020-660016972	TAYLOR, JIMMY E & CONNIE E	10	256,009	24643		346.00	2019	2019-660016972	TAYLOR, JIMMY E & CONNIE E	10	225,985	24644		348.00	2018	2018-660016972	TAYLOR, JIMMY E & CONNIE E	10	231,440	24643		348.00	2017	2017-660016972	TAYLOR, JIMMY E & CONNIE E	10	228,641	1000	23,643	2,701.00	2016	2016-660016972	TAYLOR, JIMMY E & CONNIE E	10	223,023	1000	22,926	2,388.00	2015	2015-660016972	TAYLOR, JIMMY E & CONNIE E	10	216,110	1000	22,229	2,190.00	2014	2014-660016972	TAYLOR, JIMMY E & CONNIE E	10	218,267	1000	21,552	2,120.00	2013	2013-660016972	TAYLOR, JIMMY E & CONNIE E	10	205,747	1000	20,895	1,989.00
Tax Year	Statement Number	Billed Owner	Tax Area	Total Value	Exemptions	Taxable Value	Billed Tax																																																																																																																		
2025	2025-660016972	TAYLOR, JIMMY E & CONNIE E	10	390,524	24643		345.00																																																																																																																		
2024	2024-660016972	TAYLOR, JIMMY E & CONNIE E	10	408,514	24643		345.00																																																																																																																		
2023	2023-660016972	TAYLOR, JIMMY E & CONNIE E	10	307,765	24643		345.00																																																																																																																		
2022	2022-660016972	TAYLOR, JIMMY E & CONNIE E	10	310,231	24644		337.00																																																																																																																		
2021	2021-660016972	TAYLOR, JIMMY E & CONNIE E	10	265,623	24643		335.00																																																																																																																		
2020	2020-660016972	TAYLOR, JIMMY E & CONNIE E	10	256,009	24643		346.00																																																																																																																		
2019	2019-660016972	TAYLOR, JIMMY E & CONNIE E	10	225,985	24644		348.00																																																																																																																		
2018	2018-660016972	TAYLOR, JIMMY E & CONNIE E	10	231,440	24643		348.00																																																																																																																		
2017	2017-660016972	TAYLOR, JIMMY E & CONNIE E	10	228,641	1000	23,643	2,701.00																																																																																																																		
2016	2016-660016972	TAYLOR, JIMMY E & CONNIE E	10	223,023	1000	22,926	2,388.00																																																																																																																		
2015	2015-660016972	TAYLOR, JIMMY E & CONNIE E	10	216,110	1000	22,229	2,190.00																																																																																																																		
2014	2014-660016972	TAYLOR, JIMMY E & CONNIE E	10	218,267	1000	21,552	2,120.00																																																																																																																		
2013	2013-660016972	TAYLOR, JIMMY E & CONNIE E	10	205,747	1000	20,895	1,989.00																																																																																																																		



Rogers

Assessment Property Record Card for Tax Year 2026

Data provided by LISA DELOZIER County Assessor

Date 04/16/2026
 Time 21:32:46
 Page 2

Lot Data		Square-Foot - NBHD 1151 #1	
Lot Size			
Lot Count			
Units Buildable	18000		
Non-Ag Acres	1.2319		
Topography			
Street Access			
Utilities			
Amenities	LAND QUALITY	0	
		0	
Method	Square-Foot		
Base Lot Value	53,662.00 x 1.30 = 69,728		
Factor Value			
Adjustments	1.0000		
Lot Value	69,728		



\\tsclient\T\LOGAN\LOGAN RESIDENTIAL VI\2022-12-1\IMG_003: 12/1/2022

Residential Data	
Type	1 Single Family Residence
Condition	3 - Average
Quality	3 - Average
Architecture	
Style	100% One Story
Exterior Wall	90% Veneer, Masonry 10% Frame, Siding, Wood
Base/Total Area	2,016 / 2,016
Style	100% One Story
HVAC	100% Warmed & Cooled Air
Roof Cover	1 Composition Shingle
Area on Slab	2,016
Fixture/RghIn	14 /
Bed/F/H Bath	3 / 2.5 /
Basement Area	
Garage Type	820 Attached Garage - Unfinished
Remodel	
Year/Eff Age	2011 / 11

GRM Approach	
GRM Code	
Gross Rent	0.00
Indicated Value	

Multiple Regression			
MRA Code	1	Test	
Adjusted R	0.8445		
Indicated Value	337,569	167.44	Per SqFt

Direct Comparables			
Selection Model	A	Adam Test	
Adjustment Model	1	2022 Residential	
Comparables	1		
Indicated Value	136,660		Per SqFt

Cost Approach				Manual : 01/2025			
Base Cost	106.47	Total Misc Impr	+	29,422			
Roofing Adj	+ 4.69	Garage Cost	+	24,428			
Subfloor Adj	+ -2.19	Total RCN	=	318,551			
Heat/Cool Adj	+ 12.64	Depreciation (11%)	-	35,041			
Plumbing Adj	+ 9.69	Lump Sums	+	0			
Basement Adj	+ 0.00	RCNLD	=	283,510			
Adj Base Cost	= 131.30	Lot Value	+	69,728			
Total Area	x 2,016	Indicated Value	=	353,238			
Adjusted Cost	= 264,701	Value Per SqFt		175.22			

Value Reconciliation			
Selected Approach	Cost Approach		
Improvements	283,510		
Lot Value	69,728		
Indicated Value	353,238	175.22	Per SqFt
Agland Value			
Site Improvements	51,679		
Total Value	404,917	200.85	Total Value Per SqFt

Miscellaneous Improvements								
Code	Description	Sketch ID	Size	Year	Units	Unit Cost	Depr	Value
EPSW	ENCLOSED PORCH - SOLID WALL	40969	28x11		308	68.27		21,027
PRCH	SLAB PORCH - COVERED	40970	324		324	25.91		8,395



Rogers

Assessment Property Record Card for Tax Year 2026

Data provided by LISA DELOZIER County Assessor

Date 04/16/2026
 Time 21:32:46
 Page 3

Sketch Image

660016972

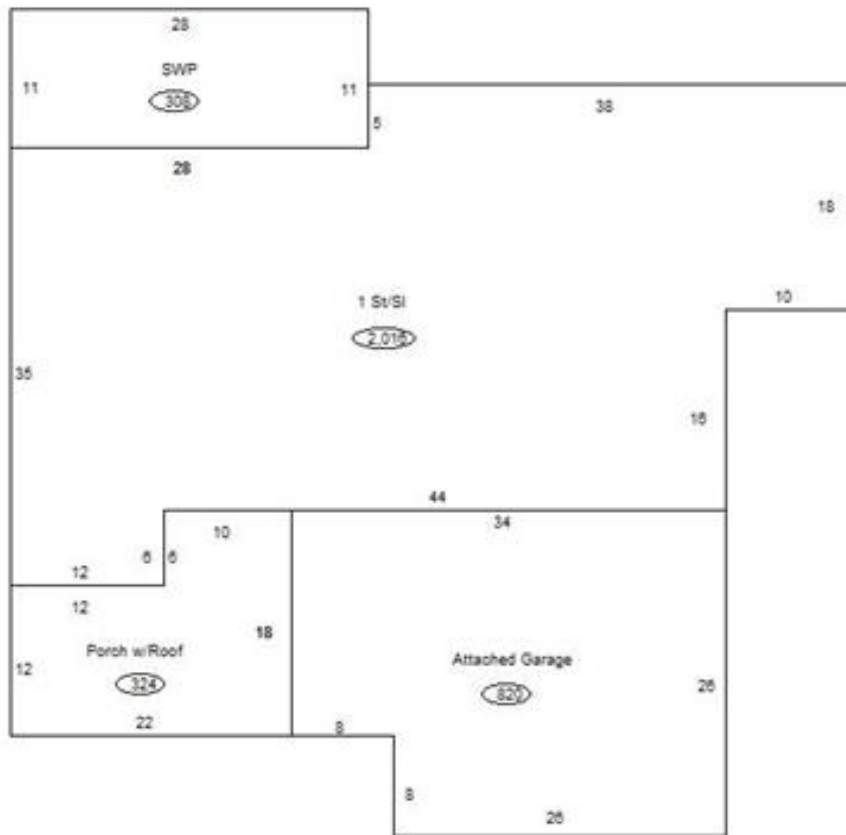

Sketch Vector Information

Sequence	Code	Type	Built Over	Scale	Section Label	Base Area	Multiplier	Total Area
1	R	1	Slab	13	1 St/SI	2,016	1.000	2,016
2	G	1		13	Attached Garage	820	1.000	820
3	M	EPSW		13	EPSW	308	1.000	308
4	M	PRCH		13	SLBC	324	1.000	324
Total Building Area						2,016		2,016



Rogers



Assessment Property Record Card for Tax Year 2026

Data provided by LISA DELOZIER County Assessor

Date 04/16/2026
 Time 21:32:46
 Page 4

660016972

Outbuildings/Site Improvements

Building Image	Code	Description	Dimensions	Floor	Roofing	Total Units	
	GRDT	GARAGE - DETACHED	40x40x0			1,600	
	Qual	4	Cond	3	Year	Eff Age	
	Valuation Summary		Modifier Total		RCN	Depr (20% Phys/ % Func)	RCNLD
	Base Cost (37.96 x 1,600)		60,736		60,736	12,147	48,589
	GF	GAZEBO FAIR	0x0x0			1	
	Qual	2	Cond		Year	Eff Age	
	Valuation Summary		Modifier Total		RCN	Depr (0% Phys/ % Func)	RCNLD
	Base Cost (2,950.00 x 1)		2,950		2,950		2,950
	LT	LEAN-TO	6x10x0			60	
	Qual	4	Cond	3	Year	Eff Age	
	Valuation Summary		Modifier Total		RCN	Depr (20% Phys/ % Func)	RCNLD
	Base Cost (2.92 x 60)		175		175	35	140