



Rogers

Assessment Property Record Card for Tax Year 2026

Data provided by LISA DELOZIER County Assessor

Date 04/16/2026
Time 23:02:00
Page 1

Assessment Data					Primary Image																																																																																																																				
Account 660016998 Parcel ID 22N17E-18-2-00000-000-0000 Cadastral ID 18-22-17-00420 Property Type REAL - Real Property Property Class RR VI Area 2 Tax Area 75 - SEQUOYAH/FOYIL FD Name ID 32484 LEWIS, JOHN PAUL 15280 S 4192 RD CLAREMORE OK 74017-0000 Parcel Location Situs 15280 S 4192 RD Subdivision Lot/Block / Parcel Size 2.5 - Acres Sec/Twn/Rng 18 / 22 / 17 / 2 Neighborhood 4070 - FOYIL SEQUOYAH AREA School District S006 - SEQUOYAH SCHOOLS																																																																																																																									
Legal Description Lat/Long: 36.39030198 -95.54138589 NE NW GOV'T LOT 2																																																																																																																									
Exemptions <table border="1"> <thead> <tr> <th>Code</th> <th>Type</th> <th>Active</th> <th>Maximum</th> <th>Exemption</th> </tr> </thead> <tbody> <tr> <td>H</td> <td>Homestead</td> <td>Yes</td> <td>1,000</td> <td>1,000</td> </tr> </tbody> </table>					Code	Type	Active	Maximum	Exemption	H	Homestead	Yes	1,000	1,000	Building Permits <table border="1"> <thead> <tr> <th>Number</th> <th>Description</th> <th>Opened</th> <th>Closed</th> <th>Amount</th> </tr> </thead> <tbody> <tr> <td colspan="5"> </td> </tr> </tbody> </table>					Number	Description	Opened	Closed	Amount																																																																																																	
Code	Type	Active	Maximum	Exemption																																																																																																																					
H	Homestead	Yes	1,000	1,000																																																																																																																					
Number	Description	Opened	Closed	Amount																																																																																																																					
Parcel Valuation <table border="1"> <thead> <tr> <th>Source</th> <th>REAL</th> <th>Fair Cash</th> <th>Capped</th> <th>Asmnt Level</th> <th>Assessed</th> <th>Levy Rate</th> <th>101.310</th> <th>Current Tax</th> </tr> </thead> <tbody> <tr> <td>Remove Cap</td> <td>0</td> <td>Land Value 48,549</td> <td>20,601</td> <td>11%</td> <td>2,266</td> <td>Assessed</td> <td>11,933</td> <td>1,208.93</td> </tr> <tr> <td>Year Frozen</td> <td>2010</td> <td>Improvements 207,096</td> <td>87,878</td> <td></td> <td>9,667</td> <td>Penalty</td> <td>0</td> <td></td> </tr> <tr> <td>Uncapped Value</td> <td>0</td> <td>Mobile Home 0</td> <td>0</td> <td></td> <td>0</td> <td>Exemption</td> <td>1,000</td> <td>-88.00</td> </tr> <tr> <td>TIF Project ID</td> <td>0</td> <td>Total Value 255,645</td> <td>108,479</td> <td></td> <td>11,933</td> <td>Total Taxable</td> <td>10,933</td> <td>1,121.00</td> </tr> </tbody> </table>					Source	REAL	Fair Cash	Capped	Asmnt Level	Assessed	Levy Rate	101.310	Current Tax	Remove Cap	0	Land Value 48,549	20,601	11%	2,266	Assessed	11,933	1,208.93	Year Frozen	2010	Improvements 207,096	87,878		9,667	Penalty	0		Uncapped Value	0	Mobile Home 0	0		0	Exemption	1,000	-88.00	TIF Project ID	0	Total Value 255,645	108,479		11,933	Total Taxable	10,933	1,121.00	Sale History <table border="1"> <thead> <tr> <th>Bk/Pg</th> <th>Grantor</th> <th>Date</th> <th>Price</th> <th>Code</th> </tr> </thead> <tbody> <tr> <td colspan="5"> </td> </tr> </tbody> </table>					Bk/Pg	Grantor	Date	Price	Code																																																														
Source	REAL	Fair Cash	Capped	Asmnt Level	Assessed	Levy Rate	101.310	Current Tax																																																																																																																	
Remove Cap	0	Land Value 48,549	20,601	11%	2,266	Assessed	11,933	1,208.93																																																																																																																	
Year Frozen	2010	Improvements 207,096	87,878		9,667	Penalty	0																																																																																																																		
Uncapped Value	0	Mobile Home 0	0		0	Exemption	1,000	-88.00																																																																																																																	
TIF Project ID	0	Total Value 255,645	108,479		11,933	Total Taxable	10,933	1,121.00																																																																																																																	
Bk/Pg	Grantor	Date	Price	Code																																																																																																																					
Assessment History <table border="1"> <thead> <tr> <th>Tax Year</th> <th>Statement Number</th> <th>Billed Owner</th> <th>Tax Area</th> <th>Total Value</th> <th>Exemptions</th> <th>Taxable Value</th> <th>Billed Tax</th> </tr> </thead> <tbody> <tr> <td>2025</td> <td>2025-660016998</td> <td>LEWIS, JOHN PAUL</td> <td>75</td> <td>251,641</td> <td>1000</td> <td>10,933</td> <td>1,121.00</td> </tr> <tr> <td>2024</td> <td>2024-660016998</td> <td>LEWIS, JOHN PAUL</td> <td>75</td> <td>219,661</td> <td>1000</td> <td>10,933</td> <td>1,127.00</td> </tr> <tr> <td>2023</td> <td>2023-660016998</td> <td>LEWIS, JOHN PAUL</td> <td>75</td> <td>183,029</td> <td>1000</td> <td>10,933</td> <td>1,152.00</td> </tr> <tr> <td>2022</td> <td>2022-660016998</td> <td>LEWIS, JOHN PAUL</td> <td>75</td> <td>176,483</td> <td>1000</td> <td>10,933</td> <td>1,177.00</td> </tr> <tr> <td>2021</td> <td>2021-660016998</td> <td>LEWIS, JOHN PAUL</td> <td>75</td> <td>185,729</td> <td>1000</td> <td>10,933</td> <td>1,144.00</td> </tr> <tr> <td>2020</td> <td>2020-660016998</td> <td>LEWIS, JOHN PAUL</td> <td>75</td> <td>178,130</td> <td>1000</td> <td>10,933</td> <td>1,186.00</td> </tr> <tr> <td>2019</td> <td>2019-660016998</td> <td>LEWIS, JOHN PAUL &</td> <td>75</td> <td>163,832</td> <td>1000</td> <td>10,932</td> <td>1,177.00</td> </tr> <tr> <td>2018</td> <td>2018-660016998</td> <td>LEWIS, JOHN PAUL &</td> <td>75</td> <td>170,365</td> <td>1000</td> <td>10,933</td> <td>1,183.00</td> </tr> <tr> <td>2017</td> <td>2017-660016998</td> <td>LEWIS, JOHN PAUL &</td> <td>75</td> <td>168,790</td> <td>1000</td> <td>10,932</td> <td>1,175.00</td> </tr> <tr> <td>2016</td> <td>2016-660016998</td> <td>LEWIS, JOHN PAUL &</td> <td>75</td> <td>165,285</td> <td>1000</td> <td>10,933</td> <td>1,174.00</td> </tr> <tr> <td>2015</td> <td>2015-660016998</td> <td>LEWIS, JOHN PAUL &</td> <td>75</td> <td>163,471</td> <td>1000</td> <td>10,933</td> <td>1,194.00</td> </tr> <tr> <td>2014</td> <td>2014-660016998</td> <td>LEWIS, JOHN PAUL &</td> <td>75</td> <td>163,699</td> <td>1000</td> <td>10,933</td> <td>1,210.00</td> </tr> <tr> <td>2013</td> <td>2013-660016998</td> <td>LEWIS, JOHN PAUL &</td> <td>75</td> <td>156,128</td> <td>1000</td> <td>10,933</td> <td>1,182.00</td> </tr> </tbody> </table>										Tax Year	Statement Number	Billed Owner	Tax Area	Total Value	Exemptions	Taxable Value	Billed Tax	2025	2025-660016998	LEWIS, JOHN PAUL	75	251,641	1000	10,933	1,121.00	2024	2024-660016998	LEWIS, JOHN PAUL	75	219,661	1000	10,933	1,127.00	2023	2023-660016998	LEWIS, JOHN PAUL	75	183,029	1000	10,933	1,152.00	2022	2022-660016998	LEWIS, JOHN PAUL	75	176,483	1000	10,933	1,177.00	2021	2021-660016998	LEWIS, JOHN PAUL	75	185,729	1000	10,933	1,144.00	2020	2020-660016998	LEWIS, JOHN PAUL	75	178,130	1000	10,933	1,186.00	2019	2019-660016998	LEWIS, JOHN PAUL &	75	163,832	1000	10,932	1,177.00	2018	2018-660016998	LEWIS, JOHN PAUL &	75	170,365	1000	10,933	1,183.00	2017	2017-660016998	LEWIS, JOHN PAUL &	75	168,790	1000	10,932	1,175.00	2016	2016-660016998	LEWIS, JOHN PAUL &	75	165,285	1000	10,933	1,174.00	2015	2015-660016998	LEWIS, JOHN PAUL &	75	163,471	1000	10,933	1,194.00	2014	2014-660016998	LEWIS, JOHN PAUL &	75	163,699	1000	10,933	1,210.00	2013	2013-660016998	LEWIS, JOHN PAUL &	75	156,128	1000	10,933	1,182.00
Tax Year	Statement Number	Billed Owner	Tax Area	Total Value	Exemptions	Taxable Value	Billed Tax																																																																																																																		
2025	2025-660016998	LEWIS, JOHN PAUL	75	251,641	1000	10,933	1,121.00																																																																																																																		
2024	2024-660016998	LEWIS, JOHN PAUL	75	219,661	1000	10,933	1,127.00																																																																																																																		
2023	2023-660016998	LEWIS, JOHN PAUL	75	183,029	1000	10,933	1,152.00																																																																																																																		
2022	2022-660016998	LEWIS, JOHN PAUL	75	176,483	1000	10,933	1,177.00																																																																																																																		
2021	2021-660016998	LEWIS, JOHN PAUL	75	185,729	1000	10,933	1,144.00																																																																																																																		
2020	2020-660016998	LEWIS, JOHN PAUL	75	178,130	1000	10,933	1,186.00																																																																																																																		
2019	2019-660016998	LEWIS, JOHN PAUL &	75	163,832	1000	10,932	1,177.00																																																																																																																		
2018	2018-660016998	LEWIS, JOHN PAUL &	75	170,365	1000	10,933	1,183.00																																																																																																																		
2017	2017-660016998	LEWIS, JOHN PAUL &	75	168,790	1000	10,932	1,175.00																																																																																																																		
2016	2016-660016998	LEWIS, JOHN PAUL &	75	165,285	1000	10,933	1,174.00																																																																																																																		
2015	2015-660016998	LEWIS, JOHN PAUL &	75	163,471	1000	10,933	1,194.00																																																																																																																		
2014	2014-660016998	LEWIS, JOHN PAUL &	75	163,699	1000	10,933	1,210.00																																																																																																																		
2013	2013-660016998	LEWIS, JOHN PAUL &	75	156,128	1000	10,933	1,182.00																																																																																																																		



Rogers

Assessment Property Record Card for Tax Year 2026

Data provided by LISA DELOZIER County Assessor

Date 04/16/2026
Time 23:02:00
Page 2

Lot Data	Square-Foot - NBHD 4070 #1	Primary Image
Lot Size Lot Count Units Buildable 2.5 Non-Ag Acres 2.4581 Topography Street Access Utilities Amenities LAND QUALITY 0 0 Method Square-Foot Base Lot Value 107,077.00 x .45 = 48,549 Factor Value Adjustments 1.0000 Lot Value 48,549		

Residential Data	
Type	1 Single Family Residence
Condition	3 - Average
Quality	3 - Average
Architecture	TRAD TRADITIONAL
Style	100% One Story
Exterior Wall	100% Frame, Siding, Wood
Base/Total Area	2,030 / 2,030
Style	100% One Story
HVAC	100% Warmed & Cooled Air
Roof Cover	1 Composition Shingle
Area on Slab	2,030
Fixture/RghIn	11 /
Bed/F/H Bath	3 / 2.0 /
Basement Area	
Garage Type	504 Attached Garage - Unfinished
Remodel	
Year/Eff Age	1988 / 29



\\tsclient\TCASEY\CASEY BOOTH VISUAL INSPECTION\2020-1' 11/4/2020

GRM Approach	
GRM Code	
Gross Rent	0.00
Indicated Value	

Multiple Regression			
MRA Code	1	Test	
Adjusted R	0.8445		
Indicated Value	256,355	126.28	Per SqFt

Direct Comparables	
Selection Model	1 Res
Adjustment Model	A2 AO Test
Comparables	
Indicated Value	

Cost Approach				Manual : 01/2025	
Base Cost	96.77	Total Misc Impr	+	23,102	
Roofing Adj	+ 4.58	Garage Cost	+	16,032	
Subfloor Adj	+ -2.43	Total RCN	=	281,110	
Heat/Cool Adj	+ 12.64	Depreciation (36%)	-	101,200	
Plumbing Adj	+ 7.64	Lump Sums	+	0	
Basement Adj	+ 0.00	RCNLD	=	179,910	
Adj Base Cost	= 119.20	Lot Value	+	48,549	
Total Area	x 2,030	Indicated Value	=	228,459	
Adjusted Cost	= 241,976	Value Per SqFt		112.54	

Value Reconciliation			
Selected Approach	Cost Approach		
Improvements	179,910		
Lot Value	48,549		
Indicated Value	228,459	112.54	Per SqFt
Agland Value			
Site Improvements	27,186		
Total Value	255,645	125.93	Total Value Per SqFt

Miscellaneous Improvements								
Code	Description	Sketch ID	Size	Year	Units	Unit Cost	Depr	Value
FPR1	FIREPLACE - RESIDENTIAL 1 STORY	0		1	1	5,615.40		5,615
EPKS	ENCLOSED PORCH - KNEEWALL SCREEN	41065	42x7		294	28.75		8,453
EPKS	ENCLOSED PORCH - KNEEWALL SCREEN	41066	35x9		315	28.68		9,034



Rogers

Assessment Property Record Card for Tax Year 2026

Data provided by LISA DELOZIER County Assessor

Date 04/16/2026
 Time 23:02:00
 Page 3

Sketch Image

660016998

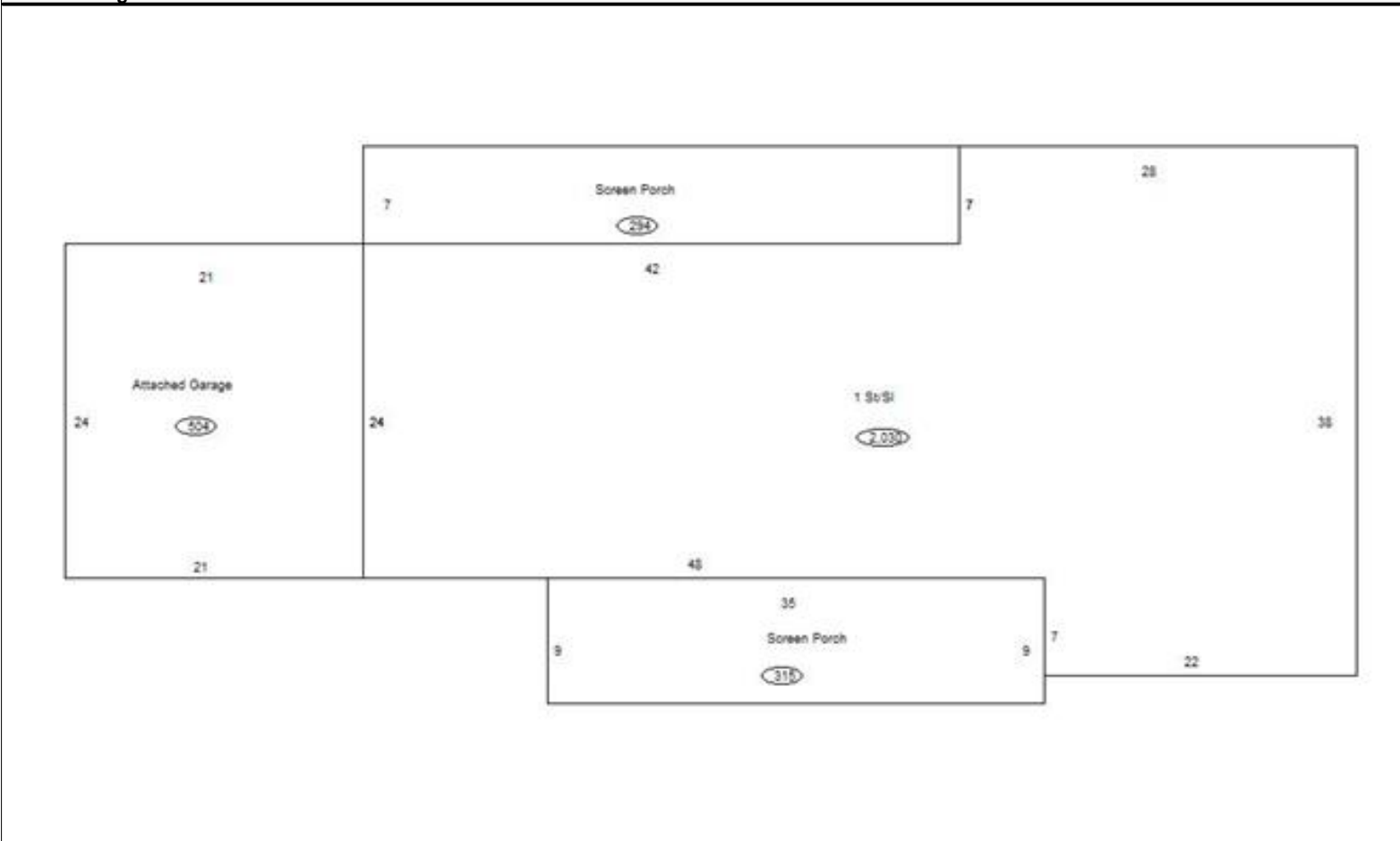

Sketch Vector Information

Sequence	Code	Type	Built Over	Scale	Section Label	Base Area	Multiplier	Total Area
1	R	1	Slab	10	1 St/Sl	2,030	1.000	2,030
2	G	1		10	Attached Garage	504	1.000	504
3	M	EPKS		10	Screen Porch	294	1.000	294
4	M	EPKS		10	Screen Porch	315	1.000	315
Total Building Area						2,030		2,030



Rogers

Assessment Property Record Card for Tax Year 2026

Data provided by LISA DELOZIER County Assessor

Date 04/16/2026
Time 23:02:00
Page 4

660016998

Outbuildings/Site Improvements

Building Image	Code	Description	Dimensions	Floor	Roofing	Total Units
	UTIL	Shop Building	56x30x10	Concrete	Galvanized Metal	1,680
	Qual 3	Cond 3	Year 2000	Eff Age		
Valuation Summary		Modifier Total	RCN	Depr (40% Phys/ % Func)		RCNLD
Base Cost (26.97 x 1,680)		45,310	45,310	18,124		27,186