



Rogers

Assessment Property Record Card for Tax Year 2026

Data provided by LISA DELOZIER County Assessor

Date 04/18/2026
Time 08:16:44
Page 1

Assessment Data					Primary Image									
Account	660017009													
Parcel ID	22N17E-18-1-00000-000-0000													
Cadastral ID	18-22-17-01400													
Property Type	REAL - Real Property													
Property Class	RR	VI Area 2												
Tax Area	75 - SEQUOYAH/FOYIL FD													
Name ID	344564													
CHOCKLEY, ANDY L														
15455 S 4195 RD CLAREMORE OK 74017-0000														
Parcel Location														
Situs	15455 S 4195 RD													
Subdivision														
Lot/Block	/	Parcel Size	1.2 - Acres											
Sec/Twn/Rng	18 / 22 / 17 / 1													
Neighborhood	4070 - FOYIL SEQUOYAH AREA													
School District	S006 - SEQUOYAH SCHOOLS													
Legal Description Lat/Long: 36.38738801 -95.53360370														
S2 S2 SW NE LESS E 1026' THEREOF & LESS N 150' THEREOF & LESS S 30' THEREOF.														
Building Permits														
<table border="1"> <thead> <tr> <th>Number</th> <th>Description</th> <th>Opened</th> <th>Closed</th> <th>Amount</th> </tr> </thead> <tbody> <tr> <td colspan="5"> </td> </tr> </tbody> </table>					Number	Description	Opened	Closed	Amount					
Number	Description	Opened	Closed	Amount										
Exemptions														
Code	Type	Active	Maximum	Exemption										
H	Homestead	No	1,000											
Sale History														
Bk/Pg	Grantor	Date	Price	Code										
/	MORRISON, JASON C &	05/03/2024	218,000	YES										
2466/264	MORRISON, CHRISTINA J	04/10/2015	0	4										
2466/260	HAGOOD, LARRY L &	04/10/2015	0	4										
2215/401	BELDA, CHRISTINA J	12/27/2011	0	4										
1403/381	FOSTER, JAMES WELDON &	08/30/2002	155,000	YES										
1134/884	PATTERSON, MARGARET A ROBBINS	09/22/1998	40,000	Yes										
Parcel Valuation														
Source	REAL	Fair Cash	Capped	Asmnt Level	Assessed	Levy Rate	101.310	Current Tax						
Remove Cap	2025	Land Value	106,654	106,654	11%	11,732	Assessed	23,397 2,370.35						
Year Frozen	2014	Improvements	106,042	106,042		11,665	Penalty	0						
Uncapped Value	0	Mobile Home	0	0		0	Exemption	0 0.00						
TIF Project ID	0	Total Value	212,696	212,696		23,397	Total Taxable	23,397 2,370.00						
Assessment History														
Tax Year	Statement Number	Billed Owner	Tax Area	Total Value	Exemptions	Taxable Value	Billed Tax							
2025	2025-660017009	CHOCKLEY, ANDY L	75	218,000	0	23,980	2,430.00							
2024	2024-660017009	CHOCKLEY, ANDY L	75	136,905	0	12,256	1,249.00							
2023	2023-660017009	MORRISON, JASON C &	75	124,757	0	11,672	1,216.00							
2022	2022-660017009	MORRISON, JASON C &	75	123,005	0	11,116	1,181.00							
2021	2021-660017009	MORRISON, JASON C &	75	100,020	0	10,587	1,094.00							
2020	2020-660017009	MORRISON, JASON C &	75	96,344	0	10,083	1,079.00							
2019	2019-660017009	MORRISON, JASON C &	75	87,295	0	9,602	1,019.00							
2018	2018-660017009	MORRISON, JASON C &	75	89,476	0	9,842	1,050.00							
2017	2017-660017009	MORRISON, JASON C &	75	88,588	0	9,745	1,033.00							
2016	2016-660017009	MORRISON, JASON C &	75	87,958	0	9,528	1,008.00							
2015	2015-660017009	MORRISON, JASON C &	75	85,550	1000	8,074	886.00							
2014	2014-660017009	HAGOOD, LARRY L &	75	84,876	1000	8,075	899.00							
2013	2013-660017009	HAGOOD, LARRY L &	75	80,963	1000	7,810	849.00							



Rogers

Assessment Property Record Card for Tax Year 2026

Data provided by LISA DELOZIER County Assessor

Date 04/18/2026
Time 08:16:44
Page 2

Lot Data	Square-Foot - NBHD 4070 #1	Primary Image
Lot Size		
Lot Count		
Units Buildable	1.2	
Non-Ag Acres	1.0033	
Topography		
Street Access		
Utilities		
Amenities	LAND QUALITY	
	0	
	0	
Method	Square-Foot	
Base Lot Value	43,702.00 x .55 = 24,022	
Factor Value		
Adjustments	4.4398	
Lot Value	106,654	

Residential Data	
Type	1 Single Family Residence
Condition	3 - Average
Quality	2 - Fair
Architecture	TRAD TRADITIONAL
Style	100% One Story
Exterior Wall	100% Veneer, Stone
Base/Total Area	576 / 576
Style	100% One Story
HVAC	100% Warmed & Cooled Air
Roof Cover	4 Metal, Preformed
Area on Slab	576
Fixture/RghIn	4 /
Bed/F/H Bath	1 / 1.0 /
Basement Area	
Garage Type	
Remodel	
Year/Eff Age	2012 / 11



\\tsclient\TCASEY\CASEY BOOTH VISUAL INSPECTION\2020-1' 11/5/2020

GRM Approach	
GRM Code	
Gross Rent	0.00
Indicated Value	

Multiple Regression			
MRA Code	1	Test	
Adusted R	0.8445		
Indicated Value	119,639	207.71	Per SqFt

Direct Comparables	
Selection Model	1 Res
Adjustment Model	A2 AO Test
Comparables	
Indicated Value	

Cost Approach				Manual : 01/2025	
Base Cost	122.63	Total Misc Impr	+	8,889	
Roofing Adj	+ 5.57	Garage Cost	+		
Subfloor Adj	+ 0.00	Total RCN	=	93,676	
Heat/Cool Adj	+ 10.30	Depreciation (14%)	-	13,115	
Plumbing Adj	+ 8.70	Lump Sums	+	0	
Basement Adj	+ 0.00	RCNLD	=	80,561	
Adj Base Cost	= 147.20	Lot Value	+	106,654	
Total Area	x 576	Indicated Value	=	187,215	
Adjusted Cost	= 84,787	Value Per SqFt		325.03	

Value Reconciliation			
Selected Approach	Cost Approach		
Improvements	80,561		
Lot Value	106,654		
Indicated Value	187,215	325.03	Per SqFt
Agland Value			
Site Improvements	25,481		
Total Value	212,696	369.26	Total Value Per SqFt

Miscellaneous Improvements								
Code	Description	Sketch ID	Size	Year	Units	Unit Cost	Depr	Value
FPR1	FIREPLACE - RESIDENTIAL 1 STORY	0		1	1	4,576.55		4,577
PRCH	SLAB PORCH - COVERED	116903	24x8		192	20.69		3,972
PRCH	SLAB PORCH - COVERED	116904	4x4		16	21.24		340



Rogers

Assessment Property Record Card for Tax Year 2026

Data provided by LISA DELOZIER County Assessor

Date 04/18/2026

Time 08:16:44

Page 3

Sketch Image

660017009

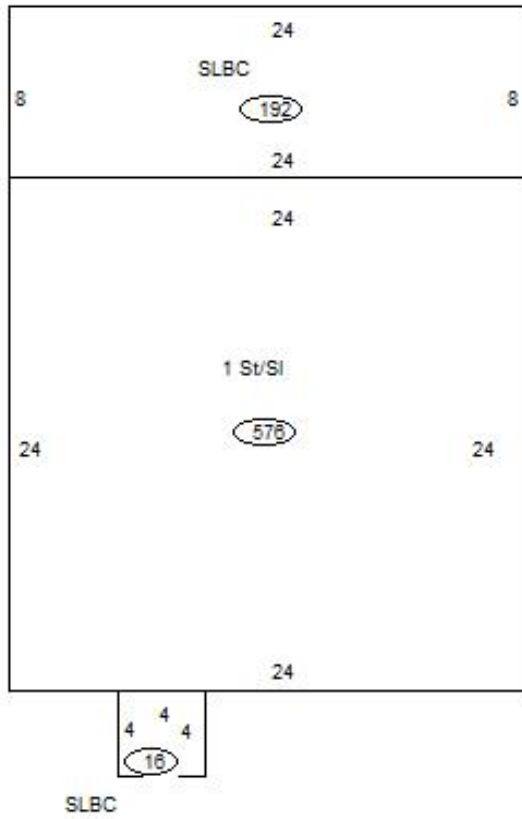

Sketch Vector Information

Sequence	Code	Type	Built Over	Scale	Section Label	Base Area	Multiplier	Total Area
1	R	1	Slab	10	1 St/SI	576	1.000	576
2	M	PRCH		10	SLBC	192	1.000	192
3	M	PRCH		10	SLBC	16	1.000	16
Total Building Area						576		576



Rogers

Assessment Property Record Card for Tax Year 2026

Data provided by LISA DELOZIER County Assessor

Date 04/18/2026
 Time 08:16:44
 Page 4

660017009

Outbuildings/Site Improvements

Building Image	Code	Description	Dimensions	Floor	Roofing	Total Units
	UTIL	Shop Building	20x22x10	Concrete	Galvanized Metal	440
	Qual	3.5	Cond 3	Year 2012	Eff Age 11	
	Valuation Summary		Modifier Total		RCN	Depr (22% Phys/ % Func)
Base Cost (32.54 x 440)		14,318		14,318	3,150	11,168
	GA	GAZEBO AVG	0x0x0			1
	Qual	3	Cond	Year 2012	Eff Age	
	Valuation Summary		Modifier Total		RCN	Depr (10% Phys/ % Func)
Base Cost (8,350.00 x 1)		8,350		8,350	835	7,515
	UTIL	Shop Building	20x24x6	Concrete	Galvanized Metal	480
	Qual	3	Cond 3	Year	Eff Age	
	Valuation Summary		Modifier Total		RCN	Depr (55% Phys/ % Func)
Base Cost (31.47 x 480)		15,106		15,106	8,308	6,798