



# Rogers

## Assessment Property Record Card for Tax Year 2026

Data provided by LISA DELOZIER County Assessor

Date 04/16/2026  
 Time 21:09:24  
 Page 1

Assessment Data					Primary Image																																																																																																																				
<b>Account</b> 660017121 <b>Parcel ID</b> 20N15E-19-3-00000-000-0000 <b>Cadastral ID</b> 19-20-15-01000 <b>Property Type</b> REAL - Real Property <b>Property Class</b> UC VI Area 3 <b>Tax Area</b> 1 - CATOOSA OT <b>Name ID</b> 333289 CPCC HOLDINGS LLC  2610 S HWY 167 STE 200 CATOOSA OK 74015-0000  <b>Parcel Location</b> <b>Situs</b> 02610 N HWY 167 <b>Subdivision</b> <b>Lot/Block</b> / <b>Parcel Size</b> 1.55 - Acres <b>Sec/Twn/Rng</b> 19 / 20 / 15 / 3 <b>Neighborhood</b> 5001 - TASC 2016 <b>School District</b> S002 - CATOOSA SCHOOLS																																																																																																																									
<b>Legal Description</b> Lat/Long: 36.19718216 -95.75929342																																																																																																																									
<b>TR IN NE 10 AC LOT 3, BEG: SW/ C NE 10 AC, N 157.25' E 423.09' S 157 44'; W 435 TO POBTO POB</b>					<b>Building Permits</b> <table border="1"> <thead> <tr> <th>Number</th> <th>Description</th> <th>Opened</th> <th>Closed</th> <th>Amount</th> </tr> </thead> <tbody> <tr> <td> </td> <td> </td> <td> </td> <td> </td> <td> </td> </tr> </tbody> </table>					Number	Description	Opened	Closed	Amount																																																																																																											
Number	Description	Opened	Closed	Amount																																																																																																																					
<b>Exemptions</b> <table border="1"> <thead> <tr> <th>Code</th> <th>Type</th> <th>Active</th> <th>Maximum</th> <th>Exemption</th> </tr> </thead> <tbody> <tr> <td> </td> <td> </td> <td> </td> <td> </td> <td> </td> </tr> </tbody> </table>					Code	Type	Active	Maximum	Exemption						<b>Sale History</b> <table border="1"> <thead> <tr> <th>Bk/Pg</th> <th>Grantor</th> <th>Date</th> <th>Price</th> <th>Code</th> </tr> </thead> <tbody> <tr> <td>/</td> <td>SHULANBERGER, DICKEY J &amp;</td> <td>01/11/2021</td> <td>315,000</td> <td>YES</td> </tr> <tr> <td>963/260</td> <td>POORBOY, ANNA C</td> <td>07/19/1994</td> <td>110,000</td> <td>Yes</td> </tr> </tbody> </table>					Bk/Pg	Grantor	Date	Price	Code	/	SHULANBERGER, DICKEY J &	01/11/2021	315,000	YES	963/260	POORBOY, ANNA C	07/19/1994	110,000	Yes																																																																																							
Code	Type	Active	Maximum	Exemption																																																																																																																					
Bk/Pg	Grantor	Date	Price	Code																																																																																																																					
/	SHULANBERGER, DICKEY J &	01/11/2021	315,000	YES																																																																																																																					
963/260	POORBOY, ANNA C	07/19/1994	110,000	Yes																																																																																																																					
<b>Parcel Valuation</b> <table border="1"> <thead> <tr> <th>Source</th> <th>REAL</th> <th>Fair Cash</th> <th>Capped</th> <th>Asmnt Level</th> <th>Assessed</th> <th>Levy Rate</th> <th>106.660</th> <th>Current Tax</th> </tr> </thead> <tbody> <tr> <td>Remove Cap</td> <td>2022</td> <td>Land Value 63,670</td> <td>63,670</td> <td>11%</td> <td>7,004</td> <td>Assessed 16,746</td> <td>16,746</td> <td>1,786.13</td> </tr> <tr> <td>Year Frozen</td> <td>0</td> <td>Improvements 247,368</td> <td>88,566</td> <td></td> <td>9,742</td> <td>Penalty 0</td> <td>0</td> <td></td> </tr> <tr> <td>Uncapped Value</td> <td>0</td> <td>Mobile Home 0</td> <td>0</td> <td></td> <td>0</td> <td>Exemption 0</td> <td>0</td> <td>0.00</td> </tr> <tr> <td>TIF Project ID</td> <td>0</td> <td>Total Value 311,038</td> <td>152,236</td> <td></td> <td>16,746</td> <td>Total Taxable 16,746</td> <td>16,746</td> <td>1,786.00</td> </tr> </tbody> </table>										Source	REAL	Fair Cash	Capped	Asmnt Level	Assessed	Levy Rate	106.660	Current Tax	Remove Cap	2022	Land Value 63,670	63,670	11%	7,004	Assessed 16,746	16,746	1,786.13	Year Frozen	0	Improvements 247,368	88,566		9,742	Penalty 0	0		Uncapped Value	0	Mobile Home 0	0		0	Exemption 0	0	0.00	TIF Project ID	0	Total Value 311,038	152,236		16,746	Total Taxable 16,746	16,746	1,786.00																																																																			
Source	REAL	Fair Cash	Capped	Asmnt Level	Assessed	Levy Rate	106.660	Current Tax																																																																																																																	
Remove Cap	2022	Land Value 63,670	63,670	11%	7,004	Assessed 16,746	16,746	1,786.13																																																																																																																	
Year Frozen	0	Improvements 247,368	88,566		9,742	Penalty 0	0																																																																																																																		
Uncapped Value	0	Mobile Home 0	0		0	Exemption 0	0	0.00																																																																																																																	
TIF Project ID	0	Total Value 311,038	152,236		16,746	Total Taxable 16,746	16,746	1,786.00																																																																																																																	
<b>Assessment History</b> <table border="1"> <thead> <tr> <th>Tax Year</th> <th>Statement Number</th> <th>Billed Owner</th> <th>Tax Area</th> <th>Total Value</th> <th>Exemptions</th> <th>Taxable Value</th> <th>Billed Tax</th> </tr> </thead> <tbody> <tr><td>2025</td><td>2025-660017121</td><td>CPCC HOLDINGS LLC</td><td>1</td><td>317,084</td><td>0</td><td>15,949</td><td>1,701.00</td></tr> <tr><td>2024</td><td>2024-660017121</td><td>CPCC HOLDINGS LLC</td><td>1</td><td>138,083</td><td>0</td><td>15,189</td><td>1,602.00</td></tr> <tr><td>2023</td><td>2023-660017121</td><td>CPCC HOLDINGS LLC</td><td>1</td><td>315,000</td><td>0</td><td>34,650</td><td>3,556.00</td></tr> <tr><td>2022</td><td>2022-660017121</td><td>CPCC HOLDINGS LLC</td><td>1</td><td>305,203</td><td>0</td><td>33,573</td><td>3,370.00</td></tr> <tr><td>2021</td><td>2021-660017121</td><td>CPCC HOLDINGS LLC</td><td>1</td><td>164,922</td><td>0</td><td>14,696</td><td>1,293.00</td></tr> <tr><td>2020</td><td>2020-660017121</td><td>SHULANBERGER, DICKEY J &amp;</td><td>1</td><td>164,922</td><td>0</td><td>13,997</td><td>1,240.00</td></tr> <tr><td>2019</td><td>2019-660017121</td><td>SHULANBERGER, DICKEY J &amp;</td><td>1</td><td>164,922</td><td>0</td><td>13,330</td><td>1,197.00</td></tr> <tr><td>2018</td><td>2018-660017121</td><td>SHULANBERGER, DICKEY J &amp;</td><td>1</td><td>157,805</td><td>0</td><td>12,695</td><td>1,133.00</td></tr> <tr><td>2017</td><td>2017-660017121</td><td>SHULANBERGER, DICKEY J &amp;</td><td>1</td><td>157,805</td><td>0</td><td>12,090</td><td>1,092.00</td></tr> <tr><td>2016</td><td>2016-660017121</td><td>SHULANBERGER, DICKEY J &amp;</td><td>1</td><td>157,805</td><td>0</td><td>11,515</td><td>1,024.00</td></tr> <tr><td>2015</td><td>2015-660017121</td><td>SHULANBERGER, DICKEY J &amp;</td><td>1</td><td>99,697</td><td>0</td><td>10,967</td><td>980.00</td></tr> <tr><td>2014</td><td>2014-660017121</td><td>SHULANBERGER, DICKEY J &amp;</td><td>1</td><td>99,697</td><td>0</td><td>10,967</td><td>992.00</td></tr> <tr><td>2013</td><td>2013-660017121</td><td>SHULANBERGER, DICKEY J &amp;</td><td>1</td><td>99,697</td><td>0</td><td>10,966</td><td>982.00</td></tr> </tbody> </table>										Tax Year	Statement Number	Billed Owner	Tax Area	Total Value	Exemptions	Taxable Value	Billed Tax	2025	2025-660017121	CPCC HOLDINGS LLC	1	317,084	0	15,949	1,701.00	2024	2024-660017121	CPCC HOLDINGS LLC	1	138,083	0	15,189	1,602.00	2023	2023-660017121	CPCC HOLDINGS LLC	1	315,000	0	34,650	3,556.00	2022	2022-660017121	CPCC HOLDINGS LLC	1	305,203	0	33,573	3,370.00	2021	2021-660017121	CPCC HOLDINGS LLC	1	164,922	0	14,696	1,293.00	2020	2020-660017121	SHULANBERGER, DICKEY J &	1	164,922	0	13,997	1,240.00	2019	2019-660017121	SHULANBERGER, DICKEY J &	1	164,922	0	13,330	1,197.00	2018	2018-660017121	SHULANBERGER, DICKEY J &	1	157,805	0	12,695	1,133.00	2017	2017-660017121	SHULANBERGER, DICKEY J &	1	157,805	0	12,090	1,092.00	2016	2016-660017121	SHULANBERGER, DICKEY J &	1	157,805	0	11,515	1,024.00	2015	2015-660017121	SHULANBERGER, DICKEY J &	1	99,697	0	10,967	980.00	2014	2014-660017121	SHULANBERGER, DICKEY J &	1	99,697	0	10,967	992.00	2013	2013-660017121	SHULANBERGER, DICKEY J &	1	99,697	0	10,966	982.00
Tax Year	Statement Number	Billed Owner	Tax Area	Total Value	Exemptions	Taxable Value	Billed Tax																																																																																																																		
2025	2025-660017121	CPCC HOLDINGS LLC	1	317,084	0	15,949	1,701.00																																																																																																																		
2024	2024-660017121	CPCC HOLDINGS LLC	1	138,083	0	15,189	1,602.00																																																																																																																		
2023	2023-660017121	CPCC HOLDINGS LLC	1	315,000	0	34,650	3,556.00																																																																																																																		
2022	2022-660017121	CPCC HOLDINGS LLC	1	305,203	0	33,573	3,370.00																																																																																																																		
2021	2021-660017121	CPCC HOLDINGS LLC	1	164,922	0	14,696	1,293.00																																																																																																																		
2020	2020-660017121	SHULANBERGER, DICKEY J &	1	164,922	0	13,997	1,240.00																																																																																																																		
2019	2019-660017121	SHULANBERGER, DICKEY J &	1	164,922	0	13,330	1,197.00																																																																																																																		
2018	2018-660017121	SHULANBERGER, DICKEY J &	1	157,805	0	12,695	1,133.00																																																																																																																		
2017	2017-660017121	SHULANBERGER, DICKEY J &	1	157,805	0	12,090	1,092.00																																																																																																																		
2016	2016-660017121	SHULANBERGER, DICKEY J &	1	157,805	0	11,515	1,024.00																																																																																																																		
2015	2015-660017121	SHULANBERGER, DICKEY J &	1	99,697	0	10,967	980.00																																																																																																																		
2014	2014-660017121	SHULANBERGER, DICKEY J &	1	99,697	0	10,967	992.00																																																																																																																		
2013	2013-660017121	SHULANBERGER, DICKEY J &	1	99,697	0	10,966	982.00																																																																																																																		





# Rogers

## Assessment Property Record Card for Tax Year 2026

Data provided by LISA DELOZIER County Assessor

Date 04/16/2026

Time 21:09:24

Page 3

### Sketch Image

660017121

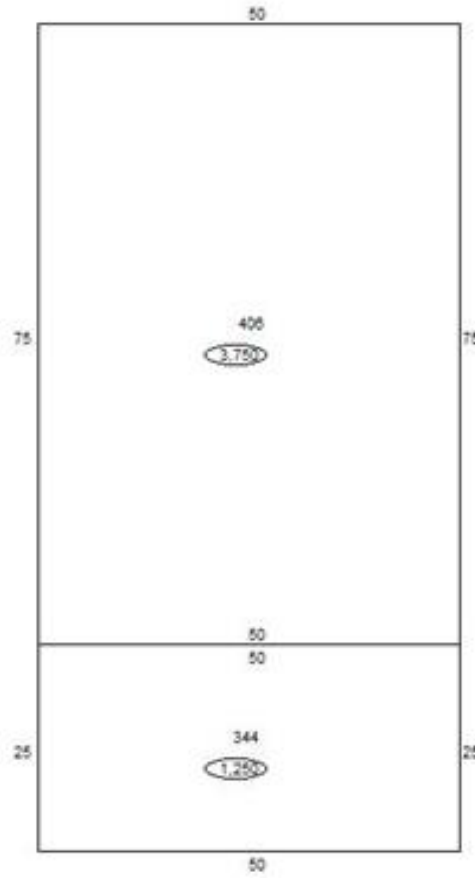

### Sketch Vector Information

Sequence	Code	Type	Built Over	Scale	Section Label	Base Area	Multiplier	Total Area
1	C	344		20	344	1,250	1.000	1,250
2	C	406		20	406	3,750	1.000	3,750
<b>Total Building Area</b>						<b>5,000</b>		<b>5,000</b>



# Rogers

## Assessment Property Record Card for Tax Year 2026

Data provided by LISA DELOZIER County Assessor

Date 04/16/2026  
 Time 21:09:24  
 Page 4

Account 660017121  
 Parcel ID 20N15E-19-3-00000-000-0000  
 Cadastral ID 19-20-15-01000

Tax Area Code 1  
 Property Class UC  
 Owners Name CPCC HOLDINGS LLC

### Building Data

Building ID 3465  
 Building Sequence 1  
 Occupancy 1 344 Office Building 100%  
 Occupancy 2  
 Occupancy 3  
 Total Floor Area 1,250  
 Average Perimeter 150  
 Number Of Storys 1.00  
 Average Wall Ht 14.00  
 Year Built 1985  
 Effective Age 21  
 Construction Class 7 - Pre-Engineered Steel Frame  
 Quality 2 - Fair  
 Condition 3 - Average  
 Exterior Wall 88 - Stud Metal Siding  
 Heating/Cooling 7 - Package Unit  
 Roof Type Gable  
 Roof Cover

Basement Area  
 Basement Levels  
 Basement Finish  
 Finish Code - 1  
 Finish Area - 1  
 Finish Code - 2  
 Finish Area - 2

### Building Image



### Image Information

Image Name IMG\_0001.JPG  
 Image Date 4/16/2021  
 Image Name IMG\_0001.JPG  
 Description REVAL 2022

### Cost Calculations

Appraisal Zone 3  
 Zone Description  
 Base Cost 86.59  
 Wall Cost 31.95  
 HVAC Cost 17.98  
 Basement Cost 0.00  
 Total Base Cost 136.52  
 Total Area 1,250  
 Base RCN 170,650  
 Misc Impr Value

Manual Date 01/2025  
 Base Year 2026  
 Modifier Value  
 Total Replacement Cost 170,650  
 Physical Depreciation 32%  
 Functional Depreciation  
 Total Depreciation 32% (54,608)  
 Total RCNLD 116,042  
 Lump Sums  
 Total Building Value 116,042 \$ 92.83 Per SqFt



# Rogers

## Assessment Property Record Card for Tax Year 2026

Data provided by LISA DELOZIER County Assessor

Date 04/16/2026  
Time 21:09:25  
Page 5

Account 660017121  
Parcel ID 20N15E-19-3-00000-000-0000  
Cadastral ID 19-20-15-01000

Tax Area Code 1  
Property Class UC  
Owners Name CPCC HOLDINGS LLC

### Building Data

Building ID 3464  
Building Sequence 2  
Occupancy 1 406 Storage Warehouse 100%  
Occupancy 2  
Occupancy 3  
Total Floor Area 3,750  
Average Perimeter 250  
Number Of Storys 1.00  
Average Wall Ht 14.00  
Year Built 1985  
Effective Age 21  
Construction Class 7 - Pre-Engineered Steel Frame  
Quality 2 - Fair  
Condition 3 - Average  
Exterior Wall 116 - Single Metal on Steel Frame  
Heating/Cooling 15 - No HVAC  
Roof Type Gable  
Roof Cover Metal

Basement Area  
Basement Levels  
Basement Finish  
Finish Code - 1  
Finish Area - 1  
Finish Code - 2  
Finish Area - 2

### Building Image



### Image Information

Image Name IMG\_0003.JPG  
Image Date 4/16/2021  
Image Name IMG\_0003.JPG  
Description REVAL 2022

### Cost Calculations

Appraisal Zone 3  
Zone Description  
Base Cost 42.63  
Wall Cost 17.75  
HVAC Cost 0.00  
Basement Cost 0.00  
Total Base Cost 60.38  
Total Area 3,750  
Base RCN 226,425  
Misc Impr Value

Manual Date 01/2025  
Base Year 2026  
Modifier Value  
Total Replacement Cost 226,425  
Physical Depreciation 42%  
Functional Depreciation  
Total Depreciation 42% (95,099)  
Total RCNLD 131,326  
Lump Sums  
Total Building Value 131,326 \$ 35.02 Per SqFt