



# Rogers

## Assessment Property Record Card for Tax Year 2026

Data provided by LISA DELOZIER County Assessor

Date 04/16/2026  
Time 22:44:45  
Page 1

Assessment Data					Primary Image																																																																																																																				
<b>Account</b> 660017134 <b>Parcel ID</b> 000000-00-0-20010-004-0006 <b>Cadastral ID</b> 19-20-15-01570 <b>Property Type</b> REAL - Real Property <b>Property Class</b> URP VI Area 3 <b>Tax Area</b> 1 - CATOOSA OT <b>Name ID</b> 302311 HAYDEN, RICHARD A  FAMILY TRUST 15670 E NEWTON ST TULSA OK 74116-0000  <b>Parcel Location</b> <b>Situs</b> 00306 N FRISCO ST <b>Subdivision</b> CATOOSA O T <b>Lot/Block</b> 0006 / 0004 <b>Parcel Size</b> .5 - Lots <b>Sec/Twn/Rng</b> 19 / 20 / 15 / 5 <b>Neighborhood</b> 1184 - R-V03-SW CATOOSA <b>School District</b> S002 - CATOOSA SCHOOLS					 <p>660017134 08/20/25</p>																																																																																																																				
<b>Legal Description</b> Lat/Long: 36.19352132 -95.74623542																																																																																																																									
<b>E 100' LOT 6 BLOCK 4 CATOOSA O T</b>					<b>Building Permits</b>																																																																																																																				
					<table border="1"> <thead> <tr> <th>Number</th> <th>Description</th> <th>Opened</th> <th>Closed</th> <th>Amount</th> </tr> </thead> <tbody> <tr> <td>R25</td> <td>NEW SFR</td> <td>01/2025</td> <td>08/2025</td> <td></td> </tr> <tr> <td>S24</td> <td>S25 SPLIT</td> <td>01/2025</td> <td>02/2025</td> <td></td> </tr> </tbody> </table>					Number	Description	Opened	Closed	Amount	R25	NEW SFR	01/2025	08/2025		S24	S25 SPLIT	01/2025	02/2025																																																																																																		
Number	Description	Opened	Closed	Amount																																																																																																																					
R25	NEW SFR	01/2025	08/2025																																																																																																																						
S24	S25 SPLIT	01/2025	02/2025																																																																																																																						
<b>Exemptions</b>					<b>Sale History</b>																																																																																																																				
<table border="1"> <thead> <tr> <th>Code</th> <th>Type</th> <th>Active</th> <th>Maximum</th> <th>Exemption</th> </tr> </thead> <tbody> <tr> <td></td> <td></td> <td></td> <td></td> <td></td> </tr> </tbody> </table>					Code	Type	Active	Maximum	Exemption						<table border="1"> <thead> <tr> <th>Bk/Pg</th> <th>Grantor</th> <th>Date</th> <th>Price</th> <th>Code</th> </tr> </thead> <tbody> <tr> <td>/</td> <td>RCH HOMES LLC</td> <td>11/20/2025</td> <td>0</td> <td>4</td> </tr> <tr> <td>/</td> <td>RIMER PLUMBING INC</td> <td>05/06/2024</td> <td>75,000</td> <td>15</td> </tr> <tr> <td>/</td> <td>WRIGHT, TERRI &amp;</td> <td>12/09/2021</td> <td>30,000</td> <td>YES</td> </tr> <tr> <td>/</td> <td>HEAPE, SANDRA PERRYMAN</td> <td>01/14/2021</td> <td>0</td> <td>WB</td> </tr> </tbody> </table>					Bk/Pg	Grantor	Date	Price	Code	/	RCH HOMES LLC	11/20/2025	0	4	/	RIMER PLUMBING INC	05/06/2024	75,000	15	/	WRIGHT, TERRI &	12/09/2021	30,000	YES	/	HEAPE, SANDRA PERRYMAN	01/14/2021	0	WB																																																																													
Code	Type	Active	Maximum	Exemption																																																																																																																					
Bk/Pg	Grantor	Date	Price	Code																																																																																																																					
/	RCH HOMES LLC	11/20/2025	0	4																																																																																																																					
/	RIMER PLUMBING INC	05/06/2024	75,000	15																																																																																																																					
/	WRIGHT, TERRI &	12/09/2021	30,000	YES																																																																																																																					
/	HEAPE, SANDRA PERRYMAN	01/14/2021	0	WB																																																																																																																					
<b>Parcel Valuation</b>																																																																																																																									
<table border="1"> <thead> <tr> <th>Source</th> <th>REAL</th> </tr> </thead> <tbody> <tr> <td>Remove Cap</td> <td>2025</td> </tr> <tr> <td>Year Frozen</td> <td>0</td> </tr> <tr> <td>Uncapped Value</td> <td>196,886</td> </tr> <tr> <td>TIF Project ID</td> <td>0</td> </tr> </tbody> </table>		Source	REAL	Remove Cap	2025	Year Frozen	0	Uncapped Value	196,886	TIF Project ID	0	<table border="1"> <thead> <tr> <th>Fair Cash</th> <th>Capped</th> <th>Asmnt Level</th> <th>Assessed</th> </tr> </thead> <tbody> <tr> <td>Land Value</td> <td>37,501</td> <td>37,501</td> <td>4,125</td> </tr> <tr> <td>Improvements</td> <td>196,886</td> <td>196,886</td> <td>21,657</td> </tr> <tr> <td>Mobile Home</td> <td>0</td> <td>0</td> <td>0</td> </tr> <tr> <td>Total Value</td> <td>234,387</td> <td>234,387</td> <td>25,782</td> </tr> </tbody> </table>			Fair Cash	Capped	Asmnt Level	Assessed	Land Value	37,501	37,501	4,125	Improvements	196,886	196,886	21,657	Mobile Home	0	0	0	Total Value	234,387	234,387	25,782	<table border="1"> <thead> <tr> <th>Levy Rate</th> <th>Current Tax</th> </tr> </thead> <tbody> <tr> <td>106.660</td> <td>2,749.91</td> </tr> <tr> <td>Assessed</td> <td>25,782</td> </tr> <tr> <td>Penalty</td> <td>0</td> </tr> <tr> <td>Exemption</td> <td>0</td> </tr> <tr> <td>Total Taxable</td> <td>25,782</td> </tr> </tbody> </table>		Levy Rate	Current Tax	106.660	2,749.91	Assessed	25,782	Penalty	0	Exemption	0	Total Taxable	25,782																																																																									
Source	REAL																																																																																																																								
Remove Cap	2025																																																																																																																								
Year Frozen	0																																																																																																																								
Uncapped Value	196,886																																																																																																																								
TIF Project ID	0																																																																																																																								
Fair Cash	Capped	Asmnt Level	Assessed																																																																																																																						
Land Value	37,501	37,501	4,125																																																																																																																						
Improvements	196,886	196,886	21,657																																																																																																																						
Mobile Home	0	0	0																																																																																																																						
Total Value	234,387	234,387	25,782																																																																																																																						
Levy Rate	Current Tax																																																																																																																								
106.660	2,749.91																																																																																																																								
Assessed	25,782																																																																																																																								
Penalty	0																																																																																																																								
Exemption	0																																																																																																																								
Total Taxable	25,782																																																																																																																								
<b>Assessment History</b>																																																																																																																									
<table border="1"> <thead> <tr> <th>Tax Year</th> <th>Statement Number</th> <th>Billed Owner</th> <th>Tax Area</th> <th>Total Value</th> <th>Exemptions</th> <th>Taxable Value</th> <th>Billed Tax</th> </tr> </thead> <tbody> <tr><td>2025</td><td>2025-660017134</td><td>RCH HOMES LLC</td><td>1</td><td>37,501</td><td>0</td><td>4,125</td><td>440.00</td></tr> <tr><td>2024</td><td>2024-660017134</td><td>RCH HOMES LLC</td><td>1</td><td>71,546</td><td>0</td><td>3,465</td><td>366.00</td></tr> <tr><td>2023</td><td>2023-660017134</td><td>RIMER PLUMBING INC</td><td>1</td><td>30,000</td><td>0</td><td>3,300</td><td>339.00</td></tr> <tr><td>2022</td><td>2022-660017134</td><td>RIMER PLUMBING INC</td><td>1</td><td>30,000</td><td>0</td><td>3,300</td><td>331.00</td></tr> <tr><td>2021</td><td>2021-660017134</td><td>WRIGHT, TERRI &amp;</td><td>1</td><td>19,563</td><td>1000</td><td>1,152</td><td>101.00</td></tr> <tr><td>2020</td><td>2020-660017134</td><td>MCMILLAN, SANDRA J</td><td>1</td><td>19,332</td><td>1000</td><td>1,127</td><td>100.00</td></tr> <tr><td>2019</td><td>2019-660017134</td><td>MCMILLAN, SANDRA J</td><td>1</td><td>19,210</td><td>1000</td><td>1,113</td><td>100.00</td></tr> <tr><td>2018</td><td>2018-660017134</td><td>MCMILLAN, SANDRA J</td><td>1</td><td>21,036</td><td>1000</td><td>1,314</td><td>117.00</td></tr> <tr><td>2017</td><td>2017-660017134</td><td>MCMILLAN, SANDRA J</td><td>1</td><td>20,910</td><td>1000</td><td>1,300</td><td>117.00</td></tr> <tr><td>2016</td><td>2016-660017134</td><td>MCMILLAN, SANDRA J</td><td>1</td><td>20,468</td><td>1000</td><td>1,251</td><td>111.00</td></tr> <tr><td>2015</td><td>2015-660017134</td><td>MCMILLAN, SANDRA J</td><td>1</td><td>20,172</td><td>1000</td><td>1,219</td><td>109.00</td></tr> <tr><td>2014</td><td>2014-660017134</td><td>MCMILLAN, SANDRA J</td><td>1</td><td>20,293</td><td>1000</td><td>1,232</td><td>111.00</td></tr> <tr><td>2013</td><td>2013-660017134</td><td>MCMILLAN, SANDRA J</td><td>1</td><td>21,018</td><td>1000</td><td>1,312</td><td>117.00</td></tr> </tbody> </table>										Tax Year	Statement Number	Billed Owner	Tax Area	Total Value	Exemptions	Taxable Value	Billed Tax	2025	2025-660017134	RCH HOMES LLC	1	37,501	0	4,125	440.00	2024	2024-660017134	RCH HOMES LLC	1	71,546	0	3,465	366.00	2023	2023-660017134	RIMER PLUMBING INC	1	30,000	0	3,300	339.00	2022	2022-660017134	RIMER PLUMBING INC	1	30,000	0	3,300	331.00	2021	2021-660017134	WRIGHT, TERRI &	1	19,563	1000	1,152	101.00	2020	2020-660017134	MCMILLAN, SANDRA J	1	19,332	1000	1,127	100.00	2019	2019-660017134	MCMILLAN, SANDRA J	1	19,210	1000	1,113	100.00	2018	2018-660017134	MCMILLAN, SANDRA J	1	21,036	1000	1,314	117.00	2017	2017-660017134	MCMILLAN, SANDRA J	1	20,910	1000	1,300	117.00	2016	2016-660017134	MCMILLAN, SANDRA J	1	20,468	1000	1,251	111.00	2015	2015-660017134	MCMILLAN, SANDRA J	1	20,172	1000	1,219	109.00	2014	2014-660017134	MCMILLAN, SANDRA J	1	20,293	1000	1,232	111.00	2013	2013-660017134	MCMILLAN, SANDRA J	1	21,018	1000	1,312	117.00
Tax Year	Statement Number	Billed Owner	Tax Area	Total Value	Exemptions	Taxable Value	Billed Tax																																																																																																																		
2025	2025-660017134	RCH HOMES LLC	1	37,501	0	4,125	440.00																																																																																																																		
2024	2024-660017134	RCH HOMES LLC	1	71,546	0	3,465	366.00																																																																																																																		
2023	2023-660017134	RIMER PLUMBING INC	1	30,000	0	3,300	339.00																																																																																																																		
2022	2022-660017134	RIMER PLUMBING INC	1	30,000	0	3,300	331.00																																																																																																																		
2021	2021-660017134	WRIGHT, TERRI &	1	19,563	1000	1,152	101.00																																																																																																																		
2020	2020-660017134	MCMILLAN, SANDRA J	1	19,332	1000	1,127	100.00																																																																																																																		
2019	2019-660017134	MCMILLAN, SANDRA J	1	19,210	1000	1,113	100.00																																																																																																																		
2018	2018-660017134	MCMILLAN, SANDRA J	1	21,036	1000	1,314	117.00																																																																																																																		
2017	2017-660017134	MCMILLAN, SANDRA J	1	20,910	1000	1,300	117.00																																																																																																																		
2016	2016-660017134	MCMILLAN, SANDRA J	1	20,468	1000	1,251	111.00																																																																																																																		
2015	2015-660017134	MCMILLAN, SANDRA J	1	20,172	1000	1,219	109.00																																																																																																																		
2014	2014-660017134	MCMILLAN, SANDRA J	1	20,293	1000	1,232	111.00																																																																																																																		
2013	2013-660017134	MCMILLAN, SANDRA J	1	21,018	1000	1,312	117.00																																																																																																																		



# Rogers

## Assessment Property Record Card for Tax Year 2026

Data provided by LISA DELOZIER County Assessor

Date 04/16/2026  
Time 22:44:45  
Page 2

Lot Data		Square-Foot - NBHD 1184 #1	
Lot Size	0	0	
Lot Count	0		
Units Buildable	0		
Non-Ag Acres	0		
Topography			
Street Access			
Utilities			
Amenities	LAND QUALITY		0
			0
Method	Square-Foot		
Base Lot Value	9,998.00 x 3.00 = 29,994		
Factor Value			
Adjustments	1.2503		
Lot Value	37,501		



Residential Data	
Type	1 Single Family Residence
Condition	3 - Average
Quality	2.5 - Fair
Architecture	TRAD TRADITIONAL
Style	100% One Story
Exterior Wall	100% Veneer, Masonry
Base/Total Area	1,371 / 1,371
Style	100% One Story
HVAC	100% Warmed & Cooled Air
Roof Cover	1 Composition Shingle
Area on Slab	1,371
Fixture/RghIn	/
Bed/F/H Bath	3 / 2.0 /
Basement Area	
Garage Type	449 Attached Garage - Finished
Remodel	
Year/Eff Age	2025 / 1

GRM Approach	
GRM Code	
Gross Rent	0.00
Indicated Value	

Multiple Regression	
MRA Code	
Adjusted R	
Indicated Value	

Direct Comparables	
Selection Model	A Adam Test
Adjustment Model	1 2022 Residential
Comparables	
Indicated Value	

Cost Approach		Manual : 01/2025	
Base Cost	109.23	Total Misc Impr	+ 2,420
Roofing Adj	+ 4.62	Garage Cost	+ 15,881
Subfloor Adj	+ -1.22	Total RCN	= 198,875
Heat/Cool Adj	+ 11.47	Depreciation ( 1%)	- 1,989
Plumbing Adj	+ 7.61	Lump Sums	+ 0
Basement Adj	+ 0.00	RCNLD	= 196,886
Adj Base Cost	= 131.71	Lot Value	+ 37,501
Total Area	x 1,371	Indicated Value	= 234,387
Adjusted Cost	= 180,574	Value Per SqFt	170.96

Value Reconciliation			
Selected Approach	Cost Approach		
Improvements	196,886		
Lot Value	37,501		
Indicated Value	234,387	170.96	Per SqFt
Agland Value			
Site Improvements			
Total Value	234,387	170.96	Total Value Per SqFt

Miscellaneous Improvements								
Code	Description	Sketch ID	Size	Year	Units	Unit Cost	Depr	Value
PRCH	Porch	173121	7x5		35	24.16		846
PATC	Patio - Covered	173122	10x6		60	19.00		1,140
PATO	Patio - Open	173123	10x4		40	10.86		434



# Rogers

## Assessment Property Record Card for Tax Year 2026

Data provided by LISA DELOZIER County Assessor

Date 04/16/2026

Time 22:44:45

Page 3

Sketch Image

660017134

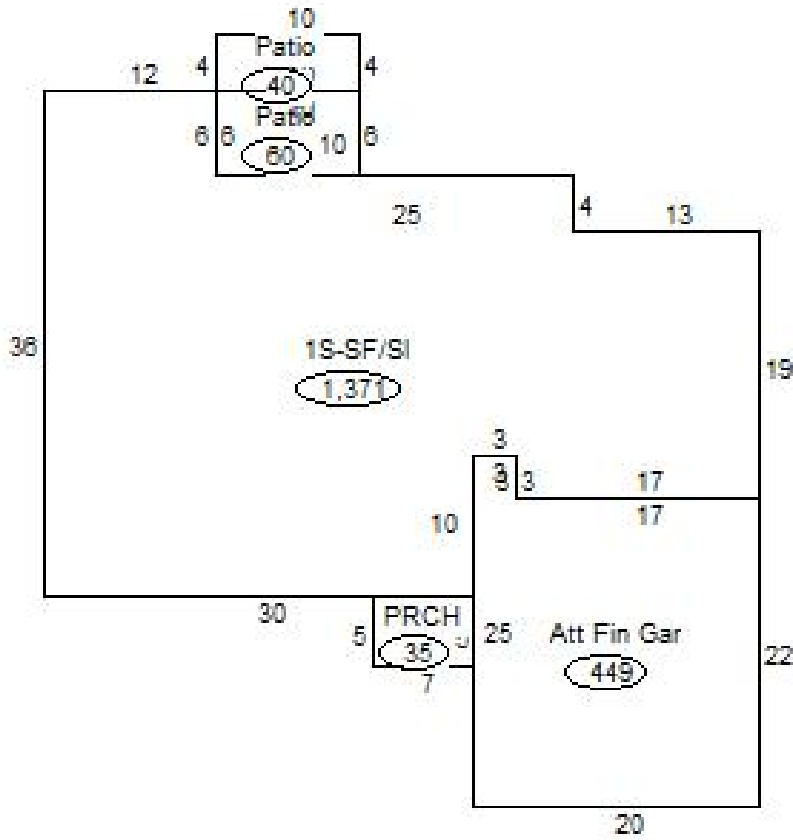

### Sketch Vector Information

Sequence	Code	Type	Built Over	Scale	Section Label	Base Area	Multiplier	Total Area
1	R	1	Slab	20	1S-SF/Sl	1,371	1.000	1,371
2	G	5		20	Att Fin Gar	449	1.000	449
3	M	PRCH		20	PRCH	35	1.000	35
4	M	PATC		20	Patio	60	1.000	60
5	M	PATO		20	Patio	40	1.000	40
<b>Total Building Area</b>						<b>1,371</b>		<b>1,371</b>