



Rogers

Assessment Property Record Card for Tax Year 2026

Data provided by LISA DELOZIER County Assessor

Date 04/17/2026
 Time 14:43:29
 Page 1

Assessment Data					Primary Image									
Account	660017611													
Parcel ID	22N16E-19-2-00000-000-0000													
Cadastral ID	19-22-16-00400													
Property Type	REAL - Real Property													
Property Class	RA	VI Area 1												
Tax Area	10 - OOLOGAH RURAL/NW FIRE													
Name ID	269924													
HOPKINS, JAMES & KRISTI														
10231 E 445 RD CLAREMORE OK 74017-0000														
Parcel Location														
Situs	10231 E 445 RD													
Subdivision														
Lot/Block	/	Parcel Size	14.68 - Acres											
Sec/Twn/Rng	19 / 22 / 16 / 2													
Neighborhood	6030 - UNPLATTED													
School District	S004 - OOLOGAH SCHOOLS													
Legal Description Lat/Long: 36.37526999 -95.64581014														
GOV'T LOT 2 LESS S 660' & LESS W 990' THEREOF & W2 SE NW LESS E 82.5' & LESS S 660' THEREOF & A TR BEG AT PT 742.50' W SE/C W2 SE NW TH N 660', W 20' , S 660', E 20' TO POB														
Building Permits														
<table border="1"> <thead> <tr> <th>Number</th> <th>Description</th> <th>Opened</th> <th>Closed</th> <th>Amount</th> </tr> </thead> <tbody> <tr> <td></td> <td></td> <td></td> <td></td> <td></td> </tr> </tbody> </table>					Number	Description	Opened	Closed	Amount					
Number	Description	Opened	Closed	Amount										
Exemptions														
Code	Type	Active	Maximum	Exemption	Sale History									
H	Homestead	Yes	1,000	1,000	Bk/Pg	Grantor	Date	Price	Code					
					1142/341	CHISUM, CRAIG	11/16/1998	57,500	Yes					
					1113/273	WHITEFIELD, DAVID A	02/27/1998	0	No					
					1045/656	CHISUM, CRAIG	11/10/1996	64,000	Yes					
					921/598	CHISUM, FINIS LAVELL	07/09/1993	47,000	No					
Parcel Valuation														
Source	REAL	Fair Cash	Capped	Asmnt Level	Assessed	Levy Rate	108.182	Current Tax						
Remove Cap	2000	Land Value	3,288	3,288	11%	362	Assessed	21,094	2,281.98					
Year Frozen	0	Improvements	254,582	188,472		20,732	Penalty	0						
Uncapped Value	0	Mobile Home	0	0		0	Exemption	1,000	-94.00					
TIF Project ID	0	Total Value	257,870	191,760		21,094	Total Taxable	20,094	2,188.00					
Assessment History														
Tax Year	Statement Number	Billed Owner	Tax Area	Total Value	Exemptions	Taxable Value	Billed Tax							
2025	2025-660017611	HOPKINS, JAMES & KRISTI	10	225,510	1000	19,479	2,121.00							
2024	2024-660017611	HOPKINS, JAMES & KRISTI	10	213,286	1000	18,884	1,992.00							
2023	2023-660017611	HOPKINS, JAMES & KRISTI	10	202,651	1000	18,304	1,917.00							
2022	2022-660017611	HOPKINS, JAMES & KRISTI	10	200,445	1000	17,742	1,850.00							
2021	2021-660017611	HOPKINS, JAMES & KRISTI	10	184,945	1000	17,196	1,806.00							
2020	2020-660017611	HOPKINS, JAMES & KRISTI	10	181,531	1000	16,666	1,777.00							
2019	2019-660017611	HOPKINS, JAMES & KRISTI	10	172,935	1000	16,152	1,690.00							
2018	2018-660017611	HOPKINS, JAMES & KRISTI	10	180,841	1000	15,652	1,694.00							
2017	2017-660017611	HOPKINS, JAMES & KRISTI	10	178,483	1000	15,167	1,738.00							
2016	2016-660017611	HOPKINS, JAMES & KRISTI	10	173,827	1000	14,696	1,536.00							
2015	2015-660017611	HOPKINS, JAMES & KRISTI	10	169,320	1000	14,239	1,407.00							
2014	2014-660017611	HOPKINS, JAMES & KRISTI	10	159,822	1000	12,859	1,270.00							
2013	2013-660017611	HOPKINS, JAMES & KRISTI	10	150,007	1000	12,455	1,190.00							



Rogers

Assessment Property Record Card for Tax Year 2026

Data provided by LISA DELOZIER County Assessor

Date 04/17/2026
Time 14:43:29
Page 2

Lot Data	Units-Buildable - UNPLATTED (UNITS BUILDABLE)	Primary Image																																													
Lot Size Lot Count Units Buildable Non-Ag Acres 0 Topography Street Access Utilities Amenities LAND QUALITY Method Units-Buildable Base Lot Value Factor Value Adjustments Lot Value		 <p>\\tsclient\T\LOGAN\LOGAN RESIDENTIAL VI\2022-12-07\IMG_00 12/9/2022</p>																																													
Residential Data Type 1 Single Family Residence Condition 3 - Average Quality 3 - Average Architecture Style 100% One Story Exterior Wall 80% Frame, Siding, Vinyl 20% Veneer, Masonry Base/Total Area 2,010 / 2,010 Style 100% One Story HVAC 100% Warmed & Cooled Air Roof Cover 4 Metal, Preformed Area on Slab 2,010 Fixture/RghIn 11 / Bed/F/H Bath 3 / 2.0 / Basement Area Garage Type 972 Attached Garage - Unfinished Remodel Year/Eff Age 1999 / 20		GRM Approach GRM Code Gross Rent 0.00 Indicated Value Multiple Regression MRA Code Adusted R Indicated Value Direct Comparables Selection Model 1 Res Adjustment Model A2 AO Test Comparables Indicated Value Value Reconciliation <table border="0"> <tr> <td>Selected Approach</td> <td>Cost Approach</td> <td></td> <td></td> </tr> <tr> <td>Improvements</td> <td>219,288</td> <td></td> <td></td> </tr> <tr> <td>Lot Value</td> <td></td> <td></td> <td></td> </tr> <tr> <td>Indicated Value</td> <td>219,288</td> <td>109.10</td> <td>Per SqFt</td> </tr> <tr> <td>Agland Value</td> <td>3,288</td> <td></td> <td></td> </tr> <tr> <td>Site Improvements</td> <td>35,294</td> <td></td> <td></td> </tr> <tr> <td>Total Value</td> <td>257,870</td> <td>128.29</td> <td>Total Value Per SqFt</td> </tr> </table>	Selected Approach	Cost Approach			Improvements	219,288			Lot Value				Indicated Value	219,288	109.10	Per SqFt	Agland Value	3,288			Site Improvements	35,294			Total Value	257,870	128.29	Total Value Per SqFt																	
Selected Approach	Cost Approach																																														
Improvements	219,288																																														
Lot Value																																															
Indicated Value	219,288	109.10	Per SqFt																																												
Agland Value	3,288																																														
Site Improvements	35,294																																														
Total Value	257,870	128.29	Total Value Per SqFt																																												
Cost Approach Manual : 01/2025 <table border="0"> <tr> <td>Base Cost</td> <td>97.90</td> <td>Total Misc Impr</td> <td>+</td> <td>12,242</td> </tr> <tr> <td>Roofing Adj</td> <td>+ 5.36</td> <td>Garage Cost</td> <td>+</td> <td>28,956</td> </tr> <tr> <td>Subfloor Adj</td> <td>+ -2.43</td> <td>Total RCN</td> <td>=</td> <td>284,790</td> </tr> <tr> <td>Heat/Cool Adj</td> <td>+ 12.64</td> <td>Depreciation (23%)</td> <td>-</td> <td>65,502</td> </tr> <tr> <td>Plumbing Adj</td> <td>+ 7.72</td> <td>Lump Sums</td> <td>+</td> <td>0</td> </tr> <tr> <td>Basement Adj</td> <td>+ 0.00</td> <td>RCNLD</td> <td>=</td> <td>219,288</td> </tr> <tr> <td>Adj Base Cost</td> <td>= 121.19</td> <td>Lot Value</td> <td>+</td> <td></td> </tr> <tr> <td>Total Area</td> <td>x 2,010</td> <td>Indicated Value</td> <td>=</td> <td>219,288</td> </tr> <tr> <td>Adjusted Cost</td> <td>= 243,592</td> <td>Value Per SqFt</td> <td></td> <td>109.10</td> </tr> </table>		Base Cost	97.90	Total Misc Impr	+	12,242	Roofing Adj	+ 5.36	Garage Cost	+	28,956	Subfloor Adj	+ -2.43	Total RCN	=	284,790	Heat/Cool Adj	+ 12.64	Depreciation (23%)	-	65,502	Plumbing Adj	+ 7.72	Lump Sums	+	0	Basement Adj	+ 0.00	RCNLD	=	219,288	Adj Base Cost	= 121.19	Lot Value	+		Total Area	x 2,010	Indicated Value	=	219,288	Adjusted Cost	= 243,592	Value Per SqFt		109.10	
Base Cost	97.90	Total Misc Impr	+	12,242																																											
Roofing Adj	+ 5.36	Garage Cost	+	28,956																																											
Subfloor Adj	+ -2.43	Total RCN	=	284,790																																											
Heat/Cool Adj	+ 12.64	Depreciation (23%)	-	65,502																																											
Plumbing Adj	+ 7.72	Lump Sums	+	0																																											
Basement Adj	+ 0.00	RCNLD	=	219,288																																											
Adj Base Cost	= 121.19	Lot Value	+																																												
Total Area	x 2,010	Indicated Value	=	219,288																																											
Adjusted Cost	= 243,592	Value Per SqFt		109.10																																											
Miscellaneous Improvements <table border="1"> <thead> <tr> <th>Code</th> <th>Description</th> <th>Sketch ID</th> <th>Size</th> <th>Year</th> <th>Units</th> <th>Unit Cost</th> <th>Depr</th> <th>Value</th> </tr> </thead> <tbody> <tr> <td>PRCH</td> <td>SLAB PORCH - COVERED</td> <td>42655</td> <td>24x12</td> <td></td> <td>288</td> <td>26.03</td> <td></td> <td>7,497</td> </tr> <tr> <td>PRCH</td> <td>SLAB PORCH - COVERED</td> <td>42656</td> <td>30x6</td> <td></td> <td>180</td> <td>26.36</td> <td></td> <td>4,745</td> </tr> </tbody> </table>			Code	Description	Sketch ID	Size	Year	Units	Unit Cost	Depr	Value	PRCH	SLAB PORCH - COVERED	42655	24x12		288	26.03		7,497	PRCH	SLAB PORCH - COVERED	42656	30x6		180	26.36		4,745																		
Code	Description	Sketch ID	Size	Year	Units	Unit Cost	Depr	Value																																							
PRCH	SLAB PORCH - COVERED	42655	24x12		288	26.03		7,497																																							
PRCH	SLAB PORCH - COVERED	42656	30x6		180	26.36		4,745																																							



Rogers

Assessment Property Record Card for Tax Year 2026

Data provided by LISA DELOZIER County Assessor

Date 04/17/2026
 Time 14:43:29
 Page 3

Sketch Image

660017611

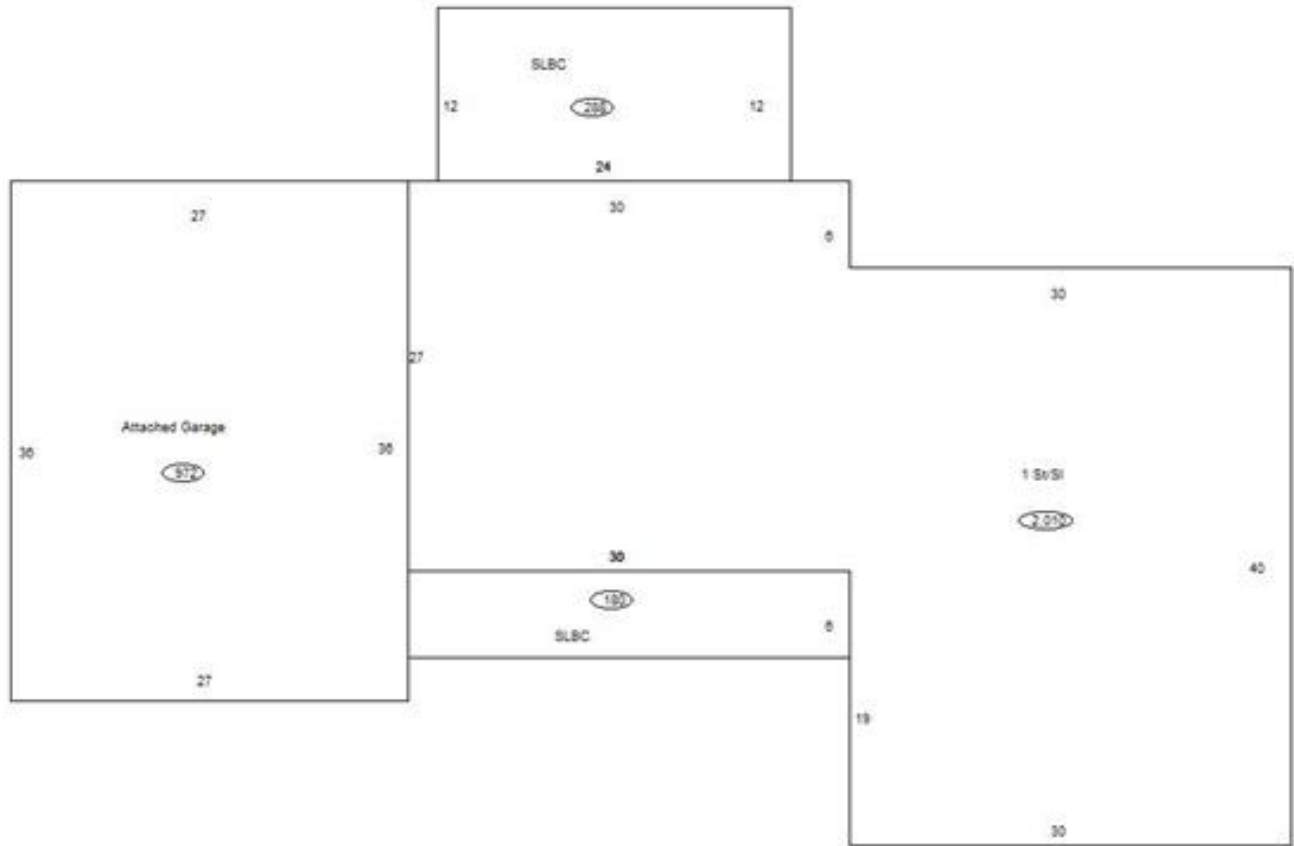

Sketch Vector Information

Sequence	Code	Type	Built Over	Scale	Section Label	Base Area	Multiplier	Total Area
1	R	1	Slab	10	1 St/SI	2,010	1.000	2,010
2	G	1		10	Attached Garage	972	1.000	972
3	M	PRCH		10	SLBC	288	1.000	288
4	M	PRCH		10	SLBC	180	1.000	180
Total Building Area						2,010		2,010



Rogers

Assessment Property Record Card for Tax Year 2026

Data provided by LISA DELOZIER County Assessor

Date 04/17/2026
Time 14:43:29
Page 4

660017611

Outbuildings/Site Improvements

Building Image	Code	Description	Dimensions	Floor	Roofing	Total Units
	BARN	BARN	30x48x0			1,440
	Qual	3	Cond 3	Year 2014	Eff Age 9	
	Valuation Summary		Modifier Total	RCN	Depr (0% Phys/ % Func)	RCNLD
		Base Cost (9.88 x 1,440)	14,227		14,227	14,227
	LT	LEAN-TO	15x48x0			720
	Qual	3	Cond 3	Year 2014	Eff Age	
	Valuation Summary		Modifier Total	RCN	Depr (0% Phys/ % Func)	RCNLD
		Base Cost (2.92 x 720)	2,102		2,102	2,102
	BARN	BARN	0x0x0			1,500
	Qual	3	Cond 3	Year	Eff Age	
	Valuation Summary		Modifier Total	RCN	Depr (5% Phys/ % Func)	RCNLD
		Base Cost (9.80 x 1,500)	14,700		14,700 735	13,965
	LT	LEAN-TO	16x50x0			800
	Qual	3	Cond 3	Year	Eff Age	
	Valuation Summary		Modifier Total	RCN	Depr (5% Phys/ % Func)	RCNLD
		Base Cost (2.92 x 800)	2,336		2,336 117	2,219
	LF	LOAFING SHED	12x20x0			240
	Qual	3	Cond 3	Year	Eff Age	
	Valuation Summary		Modifier Total	RCN	Depr (50% Phys/ % Func)	RCNLD
		Base Cost (4.26 x 240)	1,022		1,022 511	511
	LF	LOAFING SHED	12x24x0			288
	Qual	3	Cond 3	Year	Eff Age	
	Valuation Summary		Modifier Total	RCN	Depr (5% Phys/ % Func)	RCNLD
		Base Cost (4.26 x 288)	1,227		1,227 61	1,166
	LF	LOAFING SHED	12x36x0			432
	Qual	3	Cond 3	Year	Eff Age	
	Valuation Summary		Modifier Total	RCN	Depr (40% Phys/ % Func)	RCNLD
		Base Cost (4.26 x 432)	1,840		1,840 736	1,104



Rogers

Assessment Property Record Card for Tax Year 2026

Data provided by LISA DELOZIER County Assessor

Date 04/17/2026
Time 14:43:30
Page 5

660017611

Outbuildings/Site Improvements

Building Image	Code	Description	Dimensions	Floor	Roofing	Total Units
	STF	STG FAIR	0x0x0			
	Qual	2	Cond	Year	Eff Age	
Valuation Summary		Modifier Total	RCN	Depr (100% Phys/ % Func)	RCNLD	
Base Cost (4.68 x)						



Rogers

Assessment Property Record Card for Tax Year 2026

Data provided by LISA DELOZIER County Assessor

Date 04/17/2026
Time 14:43:30
Page 6

Agland Inventory

660017611

Soi	Description	Land Use	LPI	Adj Type	Adj Code	Acres	Use/Acre	Mkt/Acre	Use Value	Market Value
NAB	NEWTONIA SILT LOAM 1-3% S	IMP PST	80		0	14.680	224	224	3,288	3,288
IMP PST Totals						14.680			3,288	3,288
Total Agland						14.680			3,288	3,288