



# Rogers

## Assessment Property Record Card for Tax Year 2026

Data provided by LISA DELOZIER County Assessor

Date 04/16/2026  
Time 23:24:08  
Page 1

Assessment Data					Primary Image																																																																																																																				
<b>Account</b> 660018177 <b>Parcel ID</b> 000000-00-0-10200-001-0014 <b>Cadastral ID</b> 20-21-16-01800 <b>Property Type</b> REAL - Real Property <b>Property Class</b> URP VI Area 1 <b>Tax Area</b> 17 - CLAREMORE OT <b>Name ID</b> 269245 INGLE, MAURICE O III  22145 S 4180 RD CLAREMORE OK 74019-0000  <b>Parcel Location</b> <b>Situs</b> 02205 SW WOLF RUN DR <b>Subdivision</b> HUNTERS TRAIL <b>Lot/Block</b> 0014 / 0001 <b>Parcel Size</b> 1 - Lots <b>Sec/Twn/Rng</b> 20 / 21 / 16 / 5 <b>Neighborhood</b> 1166 - R-V01-SW CLAREMORE <b>School District</b> S001 - CLAREMORE SCHOOLS																																																																																																																									
<b>Legal Description</b> Lot/Long: 36.28564374 -95.63197342																																																																																																																									
<b>Building Permits</b>					\\tsclient\T\LOGAN\LOGAN RESIDENTIAL VI\2023-9-28\IMG_004; 9/29/2023																																																																																																																				
<b>Exemptions</b>					<b>Sale History</b>																																																																																																																				
<table border="1"> <thead> <tr> <th>Code</th> <th>Type</th> <th>Active</th> <th>Maximum</th> <th>Exemption</th> </tr> </thead> <tbody> <tr> <td>H</td> <td>Homestead</td> <td>Yes</td> <td>1,000</td> <td>1,000</td> </tr> </tbody> </table>					Code	Type	Active	Maximum	Exemption	H	Homestead	Yes	1,000	1,000	<table border="1"> <thead> <tr> <th>Number</th> <th>Description</th> <th>Opened</th> <th>Closed</th> <th>Amount</th> </tr> </thead> <tbody> <tr> <td>1125/588</td> <td>ANDERSON, LINDA ANN</td> <td>07/31/1998</td> <td></td> <td>82,500 Yes</td> </tr> <tr> <td>869/458</td> <td></td> <td>12/16/1991</td> <td></td> <td>69,000 No</td> </tr> <tr> <td>866/791</td> <td></td> <td>10/25/1991</td> <td></td> <td>0 No</td> </tr> <tr> <td>865/526</td> <td></td> <td>10/09/1991</td> <td></td> <td>8,500 No</td> </tr> </tbody> </table>					Number	Description	Opened	Closed	Amount	1125/588	ANDERSON, LINDA ANN	07/31/1998		82,500 Yes	869/458		12/16/1991		69,000 No	866/791		10/25/1991		0 No	865/526		10/09/1991		8,500 No																																																																													
Code	Type	Active	Maximum	Exemption																																																																																																																					
H	Homestead	Yes	1,000	1,000																																																																																																																					
Number	Description	Opened	Closed	Amount																																																																																																																					
1125/588	ANDERSON, LINDA ANN	07/31/1998		82,500 Yes																																																																																																																					
869/458		12/16/1991		69,000 No																																																																																																																					
866/791		10/25/1991		0 No																																																																																																																					
865/526		10/09/1991		8,500 No																																																																																																																					
<b>Parcel Valuation</b>					<table border="1"> <thead> <tr> <th>Source</th> <th>REAL</th> <th>Fair Cash</th> <th>Capped</th> <th>Asmnt Level</th> <th>Assessed</th> <th>Levy Rate</th> <th>92.430</th> <th>Current Tax</th> </tr> </thead> <tbody> <tr> <td>Remove Cap</td> <td>1999</td> <td>Land Value 50,782</td> <td>22,958</td> <td>11%</td> <td>2,525</td> <td>Assessed</td> <td>14,498</td> <td>1,340.05</td> </tr> <tr> <td>Year Frozen</td> <td>0</td> <td>Improvements 133,255</td> <td>108,845</td> <td></td> <td>11,973</td> <td>Penalty</td> <td>0</td> <td></td> </tr> <tr> <td>Uncapped Value</td> <td>0</td> <td>Mobile Home 0</td> <td>0</td> <td></td> <td>0</td> <td>Exemption</td> <td>1,000</td> <td>-92.00</td> </tr> <tr> <td>TIF Project ID</td> <td>0</td> <td>Total Value 184,037</td> <td>131,803</td> <td></td> <td>14,498</td> <td>Total Taxable</td> <td>13,498</td> <td>1,248.00</td> </tr> </tbody> </table>					Source	REAL	Fair Cash	Capped	Asmnt Level	Assessed	Levy Rate	92.430	Current Tax	Remove Cap	1999	Land Value 50,782	22,958	11%	2,525	Assessed	14,498	1,340.05	Year Frozen	0	Improvements 133,255	108,845		11,973	Penalty	0		Uncapped Value	0	Mobile Home 0	0		0	Exemption	1,000	-92.00	TIF Project ID	0	Total Value 184,037	131,803		14,498	Total Taxable	13,498	1,248.00																																																																			
Source	REAL	Fair Cash	Capped	Asmnt Level	Assessed	Levy Rate	92.430	Current Tax																																																																																																																	
Remove Cap	1999	Land Value 50,782	22,958	11%	2,525	Assessed	14,498	1,340.05																																																																																																																	
Year Frozen	0	Improvements 133,255	108,845		11,973	Penalty	0																																																																																																																		
Uncapped Value	0	Mobile Home 0	0		0	Exemption	1,000	-92.00																																																																																																																	
TIF Project ID	0	Total Value 184,037	131,803		14,498	Total Taxable	13,498	1,248.00																																																																																																																	
<b>Assessment History</b>					<table border="1"> <thead> <tr> <th>Tax Year</th> <th>Statement Number</th> <th>Billed Owner</th> <th>Tax Area</th> <th>Total Value</th> <th>Exemptions</th> <th>Taxable Value</th> <th>Billed Tax</th> </tr> </thead> <tbody> <tr><td>2025</td><td>2025-660018177</td><td>INGLE, MAURICE O III</td><td>17</td><td>179,443</td><td>1000</td><td>13,076</td><td>1,209.00</td></tr> <tr><td>2024</td><td>2024-660018177</td><td>INGLE, MAURICE O III</td><td>17</td><td>153,508</td><td>1000</td><td>12,666</td><td>1,171.00</td></tr> <tr><td>2023</td><td>2023-660018177</td><td>INGLE, MAURICE O III</td><td>17</td><td>120,620</td><td>1000</td><td>12,268</td><td>1,124.00</td></tr> <tr><td>2022</td><td>2022-660018177</td><td>INGLE, MAURICE O III</td><td>17</td><td>118,884</td><td>1000</td><td>12,077</td><td>1,118.00</td></tr> <tr><td>2021</td><td>2021-660018177</td><td>INGLE, MAURICE O III</td><td>17</td><td>123,569</td><td>1000</td><td>12,593</td><td>1,112.00</td></tr> <tr><td>2020</td><td>2020-660018177</td><td>INGLE, MAURICE O III</td><td>17</td><td>122,961</td><td>1000</td><td>12,526</td><td>1,147.00</td></tr> <tr><td>2019</td><td>2019-660018177</td><td>INGLE, MAURICE O III</td><td>17</td><td>123,420</td><td>1000</td><td>12,576</td><td>1,165.00</td></tr> <tr><td>2018</td><td>2018-660018177</td><td>INGLE, MAURICE O III</td><td>17</td><td>128,208</td><td>1000</td><td>13,103</td><td>1,211.00</td></tr> <tr><td>2017</td><td>2017-660018177</td><td>INGLE, MAURICE O III</td><td>17</td><td>127,156</td><td>1000</td><td>12,987</td><td>1,193.00</td></tr> <tr><td>2016</td><td>2016-660018177</td><td>INGLE, MAURICE O III</td><td>17</td><td>123,947</td><td>1000</td><td>12,634</td><td>1,186.00</td></tr> <tr><td>2015</td><td>2015-660018177</td><td>INGLE, MAURICE O III</td><td>17</td><td>122,039</td><td>1000</td><td>12,419</td><td>1,120.00</td></tr> <tr><td>2014</td><td>2014-660018177</td><td>INGLE, MAURICE O III</td><td>17</td><td>123,011</td><td>1000</td><td>12,028</td><td>1,115.00</td></tr> <tr><td>2013</td><td>2013-660018177</td><td>INGLE, MAURICE O III</td><td>17</td><td>116,214</td><td>1000</td><td>11,649</td><td>1,066.00</td></tr> </tbody> </table>					Tax Year	Statement Number	Billed Owner	Tax Area	Total Value	Exemptions	Taxable Value	Billed Tax	2025	2025-660018177	INGLE, MAURICE O III	17	179,443	1000	13,076	1,209.00	2024	2024-660018177	INGLE, MAURICE O III	17	153,508	1000	12,666	1,171.00	2023	2023-660018177	INGLE, MAURICE O III	17	120,620	1000	12,268	1,124.00	2022	2022-660018177	INGLE, MAURICE O III	17	118,884	1000	12,077	1,118.00	2021	2021-660018177	INGLE, MAURICE O III	17	123,569	1000	12,593	1,112.00	2020	2020-660018177	INGLE, MAURICE O III	17	122,961	1000	12,526	1,147.00	2019	2019-660018177	INGLE, MAURICE O III	17	123,420	1000	12,576	1,165.00	2018	2018-660018177	INGLE, MAURICE O III	17	128,208	1000	13,103	1,211.00	2017	2017-660018177	INGLE, MAURICE O III	17	127,156	1000	12,987	1,193.00	2016	2016-660018177	INGLE, MAURICE O III	17	123,947	1000	12,634	1,186.00	2015	2015-660018177	INGLE, MAURICE O III	17	122,039	1000	12,419	1,120.00	2014	2014-660018177	INGLE, MAURICE O III	17	123,011	1000	12,028	1,115.00	2013	2013-660018177	INGLE, MAURICE O III	17	116,214	1000	11,649	1,066.00
Tax Year	Statement Number	Billed Owner	Tax Area	Total Value	Exemptions	Taxable Value	Billed Tax																																																																																																																		
2025	2025-660018177	INGLE, MAURICE O III	17	179,443	1000	13,076	1,209.00																																																																																																																		
2024	2024-660018177	INGLE, MAURICE O III	17	153,508	1000	12,666	1,171.00																																																																																																																		
2023	2023-660018177	INGLE, MAURICE O III	17	120,620	1000	12,268	1,124.00																																																																																																																		
2022	2022-660018177	INGLE, MAURICE O III	17	118,884	1000	12,077	1,118.00																																																																																																																		
2021	2021-660018177	INGLE, MAURICE O III	17	123,569	1000	12,593	1,112.00																																																																																																																		
2020	2020-660018177	INGLE, MAURICE O III	17	122,961	1000	12,526	1,147.00																																																																																																																		
2019	2019-660018177	INGLE, MAURICE O III	17	123,420	1000	12,576	1,165.00																																																																																																																		
2018	2018-660018177	INGLE, MAURICE O III	17	128,208	1000	13,103	1,211.00																																																																																																																		
2017	2017-660018177	INGLE, MAURICE O III	17	127,156	1000	12,987	1,193.00																																																																																																																		
2016	2016-660018177	INGLE, MAURICE O III	17	123,947	1000	12,634	1,186.00																																																																																																																		
2015	2015-660018177	INGLE, MAURICE O III	17	122,039	1000	12,419	1,120.00																																																																																																																		
2014	2014-660018177	INGLE, MAURICE O III	17	123,011	1000	12,028	1,115.00																																																																																																																		
2013	2013-660018177	INGLE, MAURICE O III	17	116,214	1000	11,649	1,066.00																																																																																																																		



# Rogers

## Assessment Property Record Card for Tax Year 2026

Data provided by LISA DELOZIER County Assessor

Date 04/16/2026  
Time 23:24:08  
Page 2

Lot Data		Square-Foot - NBHD 1166 #1		Primary Image				
Lot Size								
Lot Count								
Units Buildable	1							
Non-Ag Acres	0.1619							
Topography								
Street Access								
Utilities								
Amenities	LAND QUALITY	0	0					
Method	Square-Foot							
Base Lot Value	7,053.00 x 6.00 = 42,318							
Factor Value				\\tsclient\T\LOGAN\LOGAN RESIDENTIAL VI\2023-9-28\IMG_004; 9/29/2023				
Adjustments	1.2000			<b>GRM Approach</b>				
Lot Value	50,782			GRM Code				
<b>Residential Data</b>				Gross Rent 0.00				
Type	1 Single Family Residence			Indicated Value				
Condition	3 - Average			<b>Multiple Regression</b>				
Quality	2.5 - Fair			MRA Code 1 Test				
Architecture				Adusted R 0.8445				
Style	100% One Story			Indicated Value 159,518 113.94 Per SqFt				
Exterior Wall	50% Veneer, Masonry 50% Frame, Siding, Wood			<b>Direct Comparables</b>				
Base/Total Area	1,400 / 1,400			Selection Model A Adam Test				
Style	100% One Story			Adjustment Model 1 2022 Residential				
HVAC	100% Warmed & Cooled Air			Comparables 6				
Roof Cover	1 Composition Shingle			Indicated Value 177,710 Per SqFt				
Area on Slab	1,400			<b>Value Reconciliation</b>				
Fixture/RghIn	14 /			Selected Approach Cost Approach				
Bed/F/H Bath	3 / 3.0 /			Improvements 133,255				
Basement Area				Lot Value 50,782				
Garage Type	400 Attached Garage - Unfinished			Indicated Value 184,037 131.46 Per SqFt				
Remodel				Agland Value				
Year/Eff Age	1991 / 26			Site Improvements				
<b>Cost Approach</b>				Manual : 01/2025				
Base Cost 104.33				Total Misc Impr + 8,732				
Roofing Adj + 4.60				Garage Cost + 11,700				
Subfloor Adj + -1.22				Total RCN = 205,008				
Heat/Cool Adj + 11.47				Depreciation ( 35%) - 71,753				
Plumbing Adj + 12.66				Lump Sums + 0				
Basement Adj + 0.00				RCNLD = 133,255				
Adj Base Cost = 131.84				Lot Value + 50,782				
Total Area x 1,400				Indicated Value = 184,037				
Adjusted Cost = 184,576				Value Per SqFt 131.46				
<b>Miscellaneous Improvements</b>								
Code	Description	Sketch ID	Size	Year	Units	Unit Cost	Depr	Value
FPR1	FIREPLACE - RESIDENTIAL 1 STORY	0		1	1	5,095.98		5,096
PRCH	SLAB PORCH - COVERED	43762		28	28	24.18		677
PRCH	SLAB PORCH - COVERED	43763		124	124	23.86		2,959



# Rogers

## Assessment Property Record Card for Tax Year 2026

Data provided by LISA DELOZIER County Assessor

Date 04/16/2026  
 Time 23:24:08  
 Page 3

Sketch Image

660018177

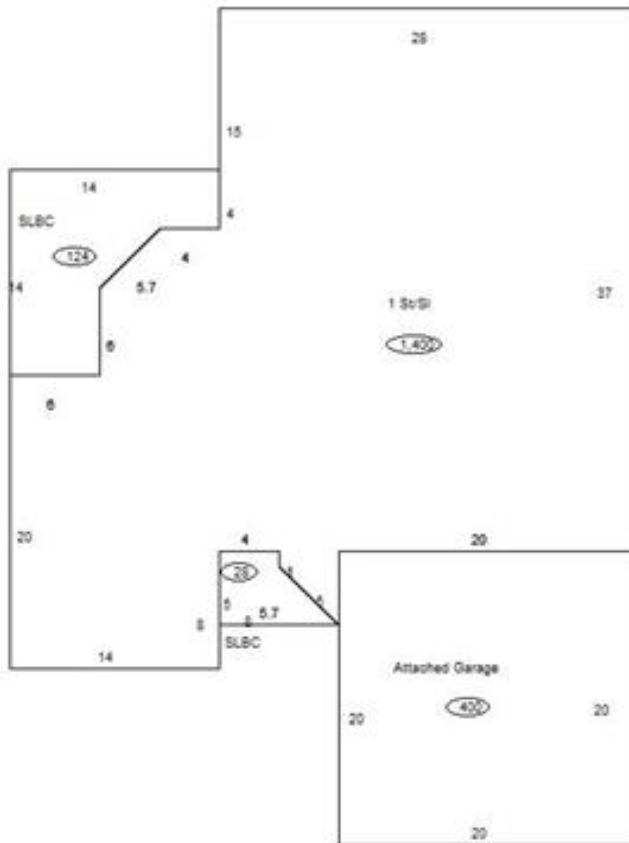

### Sketch Vector Information

Sequence	Code	Type	Built Over	Scale	Section Label	Base Area	Multiplier	Total Area
1	R	1	Slab	10	1 St/SI	1,400	1.000	1,400
2	G	1		10	Attached Garage	400	1.000	400
3	M	PRCH		10	SLBC	28	1.000	28
4	M	PRCH		10	SLBC	124	1.000	124
<b>Total Building Area</b>						<b>1,400</b>		<b>1,400</b>