



Rogers

Assessment Property Record Card for Tax Year 2026

Data provided by LISA DELOZIER County Assessor

Date 04/17/2026
 Time 07:47:34
 Page 1

Assessment Data					Primary Image																																																																																																																				
Account 660018312 Parcel ID 000000-00-0-10400-004-0007 Cadastral ID 20-21-16-03780 Property Type REAL - Real Property Property Class URP VI Area 1 Tax Area 17 - CLAREMORE OT Name ID 321155 CLAUNTS, BOBBY JOE & BEAUFALLA FAYE 615 W 19TH ST S CLAREMORE OK 74019-0000 Parcel Location Situs 00615 W 19TH ST S Subdivision SOUTH POINTE Lot/Block 0007 / 0004 Parcel Size 1 - Lots Sec/Twn/Rng 20 / 21 / 16 / 5 Neighborhood 1166 - R-V01-SW CLAREMORE School District S001 - CLAREMORE SCHOOLS																																																																																																																									
Legal Description Lot/Long: 36.29075389 -95.61731719 LOT 7 BLOCK 4 SOUTH POINTE																																																																																																																									
Exemptions <table border="1"> <thead> <tr> <th>Code</th> <th>Type</th> <th>Active</th> <th>Maximum</th> <th>Exemption</th> </tr> </thead> <tbody> <tr> <td>H</td> <td>Homestead</td> <td>Yes</td> <td>1,000</td> <td>1,000</td> </tr> <tr> <td>H</td> <td>Homestead</td> <td>No</td> <td>1,000</td> <td></td> </tr> </tbody> </table>					Code	Type	Active	Maximum	Exemption	H	Homestead	Yes	1,000	1,000	H	Homestead	No	1,000		Building Permits <table border="1"> <thead> <tr> <th>Number</th> <th>Description</th> <th>Opened</th> <th>Closed</th> <th>Amount</th> </tr> </thead> <tbody> <tr> <td></td> <td></td> <td></td> <td></td> <td></td> </tr> </tbody> </table>					Number	Description	Opened	Closed	Amount																																																																																												
Code	Type	Active	Maximum	Exemption																																																																																																																					
H	Homestead	Yes	1,000	1,000																																																																																																																					
H	Homestead	No	1,000																																																																																																																						
Number	Description	Opened	Closed	Amount																																																																																																																					
Parcel Valuation <table border="1"> <thead> <tr> <th>Source</th> <th>REAL</th> <th>Fair Cash</th> <th>Capped</th> <th>Asmnt Level</th> <th>Assessed</th> <th>Levy Rate</th> <th>92.430</th> <th>Current Tax</th> </tr> </thead> <tbody> <tr> <td>Remove Cap</td> <td>2018</td> <td>Land Value</td> <td>40,812</td> <td>26,478</td> <td>11%</td> <td>2,913</td> <td>Assessed</td> <td>10,680 987.15</td> </tr> <tr> <td>Year Frozen</td> <td>2018</td> <td>Improvements</td> <td>108,833</td> <td>70,608</td> <td></td> <td>7,767</td> <td>Penalty</td> <td>0</td> </tr> <tr> <td>Uncapped Value</td> <td>0</td> <td>Mobile Home</td> <td>0</td> <td>0</td> <td></td> <td>0</td> <td>Exemption</td> <td>1,000 -92.00</td> </tr> <tr> <td>TIF Project ID</td> <td>0</td> <td>Total Value</td> <td>149,645</td> <td>97,086</td> <td></td> <td>10,680</td> <td>Total Taxable</td> <td>9,680 895.00</td> </tr> </tbody> </table>					Source	REAL	Fair Cash	Capped	Asmnt Level	Assessed	Levy Rate	92.430	Current Tax	Remove Cap	2018	Land Value	40,812	26,478	11%	2,913	Assessed	10,680 987.15	Year Frozen	2018	Improvements	108,833	70,608		7,767	Penalty	0	Uncapped Value	0	Mobile Home	0	0		0	Exemption	1,000 -92.00	TIF Project ID	0	Total Value	149,645	97,086		10,680	Total Taxable	9,680 895.00	Sale History <table border="1"> <thead> <tr> <th>Bk/Pg</th> <th>Grantor</th> <th>Date</th> <th>Price</th> <th>Code</th> </tr> </thead> <tbody> <tr> <td>2626/194</td> <td>PALMOUR, KENNETH W & PATRICIA J</td> <td>04/10/2017</td> <td>97,000</td> <td>YES</td> </tr> <tr> <td>2260/92</td> <td>TAYLOR, LORALEE & JAMES</td> <td>07/25/2012</td> <td>76,000</td> <td>YES</td> </tr> <tr> <td>2260/91</td> <td>HOUSING AUTHORITY OF</td> <td>07/09/2012</td> <td>0</td> <td>1</td> </tr> <tr> <td>1659/49</td> <td>LEWIS, BARBARA A</td> <td>02/24/2005</td> <td>78,000</td> <td>1</td> </tr> <tr> <td>1269/856</td> <td>CAMPBELL, JAMES A &</td> <td>02/08/2001</td> <td>74,000</td> <td>Yes</td> </tr> <tr> <td>1028/75</td> <td>ST PIERRE, CAROL</td> <td>06/06/1996</td> <td>7,500</td> <td>No</td> </tr> </tbody> </table>					Bk/Pg	Grantor	Date	Price	Code	2626/194	PALMOUR, KENNETH W & PATRICIA J	04/10/2017	97,000	YES	2260/92	TAYLOR, LORALEE & JAMES	07/25/2012	76,000	YES	2260/91	HOUSING AUTHORITY OF	07/09/2012	0	1	1659/49	LEWIS, BARBARA A	02/24/2005	78,000	1	1269/856	CAMPBELL, JAMES A &	02/08/2001	74,000	Yes	1028/75	ST PIERRE, CAROL	06/06/1996	7,500	No																																
Source	REAL	Fair Cash	Capped	Asmnt Level	Assessed	Levy Rate	92.430	Current Tax																																																																																																																	
Remove Cap	2018	Land Value	40,812	26,478	11%	2,913	Assessed	10,680 987.15																																																																																																																	
Year Frozen	2018	Improvements	108,833	70,608		7,767	Penalty	0																																																																																																																	
Uncapped Value	0	Mobile Home	0	0		0	Exemption	1,000 -92.00																																																																																																																	
TIF Project ID	0	Total Value	149,645	97,086		10,680	Total Taxable	9,680 895.00																																																																																																																	
Bk/Pg	Grantor	Date	Price	Code																																																																																																																					
2626/194	PALMOUR, KENNETH W & PATRICIA J	04/10/2017	97,000	YES																																																																																																																					
2260/92	TAYLOR, LORALEE & JAMES	07/25/2012	76,000	YES																																																																																																																					
2260/91	HOUSING AUTHORITY OF	07/09/2012	0	1																																																																																																																					
1659/49	LEWIS, BARBARA A	02/24/2005	78,000	1																																																																																																																					
1269/856	CAMPBELL, JAMES A &	02/08/2001	74,000	Yes																																																																																																																					
1028/75	ST PIERRE, CAROL	06/06/1996	7,500	No																																																																																																																					
Assessment History <table border="1"> <thead> <tr> <th>Tax Year</th> <th>Statement Number</th> <th>Billed Owner</th> <th>Tax Area</th> <th>Total Value</th> <th>Exemptions</th> <th>Taxable Value</th> <th>Billed Tax</th> </tr> </thead> <tbody> <tr><td>2025</td><td>2025-660018312</td><td>CLAUNTS, BOBBY JOE &</td><td>17</td><td>148,653</td><td>1000</td><td>9,679</td><td>895.00</td></tr> <tr><td>2024</td><td>2024-660018312</td><td>CLAUNTS, BOBBY JOE &</td><td>17</td><td>130,399</td><td>1000</td><td>9,679</td><td>895.00</td></tr> <tr><td>2023</td><td>2023-660018312</td><td>CLAUNTS, BOBBY JOE &</td><td>17</td><td>104,531</td><td>1000</td><td>9,680</td><td>887.00</td></tr> <tr><td>2022</td><td>2022-660018312</td><td>CLAUNTS, BOBBY JOE &</td><td>17</td><td>102,003</td><td>1000</td><td>9,679</td><td>896.00</td></tr> <tr><td>2021</td><td>2021-660018312</td><td>CLAUNTS, BOBBY JOE &</td><td>17</td><td>98,185</td><td>1000</td><td>9,680</td><td>855.00</td></tr> <tr><td>2020</td><td>2020-660018312</td><td>CLAUNTS, BOBBY JOE &</td><td>17</td><td>98,631</td><td>1000</td><td>9,679</td><td>886.00</td></tr> <tr><td>2019</td><td>2019-660018312</td><td>CLAUNTS, BOBBY JOE &</td><td>17</td><td>97,086</td><td>1000</td><td>9,679</td><td>896.00</td></tr> <tr><td>2018</td><td>2018-660018312</td><td>CLAUNTS, BOBBY JOE &</td><td>17</td><td>99,887</td><td>1000</td><td>9,988</td><td>923.00</td></tr> <tr><td>2017</td><td>2017-660018312</td><td>CLAUNTS, BOBBY JOE &</td><td>17</td><td>80,259</td><td>0</td><td>8,825</td><td>810.00</td></tr> <tr><td>2016</td><td>2016-660018312</td><td>PALMOUR, KENNETH W & PATRICIA J</td><td>17</td><td>78,295</td><td>1000</td><td>7,404</td><td>695.00</td></tr> <tr><td>2015</td><td>2015-660018312</td><td>PALMOUR, KENNETH W & PATRICIA J</td><td>17</td><td>78,670</td><td>1000</td><td>7,404</td><td>668.00</td></tr> <tr><td>2014</td><td>2014-660018312</td><td>PALMOUR, KENNETH W & PATRICIA J</td><td>17</td><td>80,227</td><td>1000</td><td>7,404</td><td>687.00</td></tr> <tr><td>2013</td><td>2013-660018312</td><td>PALMOUR, KENNETH W & PATRICIA J</td><td>17</td><td>76,402</td><td>1000</td><td>7,404</td><td>678.00</td></tr> </tbody> </table>										Tax Year	Statement Number	Billed Owner	Tax Area	Total Value	Exemptions	Taxable Value	Billed Tax	2025	2025-660018312	CLAUNTS, BOBBY JOE &	17	148,653	1000	9,679	895.00	2024	2024-660018312	CLAUNTS, BOBBY JOE &	17	130,399	1000	9,679	895.00	2023	2023-660018312	CLAUNTS, BOBBY JOE &	17	104,531	1000	9,680	887.00	2022	2022-660018312	CLAUNTS, BOBBY JOE &	17	102,003	1000	9,679	896.00	2021	2021-660018312	CLAUNTS, BOBBY JOE &	17	98,185	1000	9,680	855.00	2020	2020-660018312	CLAUNTS, BOBBY JOE &	17	98,631	1000	9,679	886.00	2019	2019-660018312	CLAUNTS, BOBBY JOE &	17	97,086	1000	9,679	896.00	2018	2018-660018312	CLAUNTS, BOBBY JOE &	17	99,887	1000	9,988	923.00	2017	2017-660018312	CLAUNTS, BOBBY JOE &	17	80,259	0	8,825	810.00	2016	2016-660018312	PALMOUR, KENNETH W & PATRICIA J	17	78,295	1000	7,404	695.00	2015	2015-660018312	PALMOUR, KENNETH W & PATRICIA J	17	78,670	1000	7,404	668.00	2014	2014-660018312	PALMOUR, KENNETH W & PATRICIA J	17	80,227	1000	7,404	687.00	2013	2013-660018312	PALMOUR, KENNETH W & PATRICIA J	17	76,402	1000	7,404	678.00
Tax Year	Statement Number	Billed Owner	Tax Area	Total Value	Exemptions	Taxable Value	Billed Tax																																																																																																																		
2025	2025-660018312	CLAUNTS, BOBBY JOE &	17	148,653	1000	9,679	895.00																																																																																																																		
2024	2024-660018312	CLAUNTS, BOBBY JOE &	17	130,399	1000	9,679	895.00																																																																																																																		
2023	2023-660018312	CLAUNTS, BOBBY JOE &	17	104,531	1000	9,680	887.00																																																																																																																		
2022	2022-660018312	CLAUNTS, BOBBY JOE &	17	102,003	1000	9,679	896.00																																																																																																																		
2021	2021-660018312	CLAUNTS, BOBBY JOE &	17	98,185	1000	9,680	855.00																																																																																																																		
2020	2020-660018312	CLAUNTS, BOBBY JOE &	17	98,631	1000	9,679	886.00																																																																																																																		
2019	2019-660018312	CLAUNTS, BOBBY JOE &	17	97,086	1000	9,679	896.00																																																																																																																		
2018	2018-660018312	CLAUNTS, BOBBY JOE &	17	99,887	1000	9,988	923.00																																																																																																																		
2017	2017-660018312	CLAUNTS, BOBBY JOE &	17	80,259	0	8,825	810.00																																																																																																																		
2016	2016-660018312	PALMOUR, KENNETH W & PATRICIA J	17	78,295	1000	7,404	695.00																																																																																																																		
2015	2015-660018312	PALMOUR, KENNETH W & PATRICIA J	17	78,670	1000	7,404	668.00																																																																																																																		
2014	2014-660018312	PALMOUR, KENNETH W & PATRICIA J	17	80,227	1000	7,404	687.00																																																																																																																		
2013	2013-660018312	PALMOUR, KENNETH W & PATRICIA J	17	76,402	1000	7,404	678.00																																																																																																																		



Rogers

Assessment Property Record Card for Tax Year 2026

Data provided by LISA DELOZIER County Assessor

Date 04/17/2026
 Time 07:47:34
 Page 2

Lot Data		Square-Foot - NBHD 1166 #1	
Lot Size			
Lot Count			
Units Buildable	1		
Non-Ag Acres	0.1561		
Topography			
Street Access			
Utilities			
Amenities	LAND QUALITY	0	0
Method	Square-Foot		
Base Lot Value	6,802.00 x 6.00 = 40,812		
Factor Value			
Adjustments	1.0000		
Lot Value	40,812		



Residential Data	
Type	1 Single Family Residence
Condition	3 - Average
Quality	2.5 - Fair
Architecture	
Style	100% One Story
Exterior Wall	10% Veneer, Masonry 90% Frame, Siding, Wood
Base/Total Area	1,102 / 1,102
Style	100% One Story
HVAC	100% Warmed & Cooled Air
Roof Cover	1 Composition Shingle
Area on Slab	1,102
Fixture/RghIn	11 /
Bed/F/H Bath	3 / 2.0 /
Basement Area	
Garage Type	384 Attached Garage - Unfinished
Remodel	
Year/Eff Age	1996 / 23

GRM Approach

GRM Code	
Gross Rent	0.00
Indicated Value	

Multiple Regression

MRA Code	1 Test
Adusted R	0.8445
Indicated Value	145,459 132.00 Per SqFt

Direct Comparables

Selection Model	A Adam Test
Adjustment Model	1 2022 Residential
Comparables	8
Indicated Value	136,650 Per SqFt

Value Reconciliation

Selected Approach	Cost Approach
Improvements	108,833
Lot Value	40,812
Indicated Value	149,645 135.79 Per SqFt
Agland Value	
Site Improvements	
Total Value	149,645 135.79 Total Value Per SqFt

Cost Approach		Manual : 01/2025	
Base Cost	100.66	Total Misc Impr	+ 2,749
Roofing Adj	+ 4.60	Garage Cost	+ 11,351
Subfloor Adj	+ -1.21	Total RCN	= 155,476
Heat/Cool Adj	+ 11.47	Depreciation (30%)	- 46,643
Plumbing Adj	+ 12.77	Lump Sums	+ 0
Basement Adj	+ 0.00	RCNLD	= 108,833
Adj Base Cost	= 128.29	Lot Value	+ 40,812
Total Area	x 1,102	Indicated Value	= 149,645
Adjusted Cost	= 141,376	Value Per SqFt	135.79

Miscellaneous Improvements

Code	Description	Sketch ID	Size	Year	Units	Unit Cost	Depr	Value
PRCH	SLAB PORCH - COVERED	44315	23x5		115	23.90		2,749



Rogers

Assessment Property Record Card for Tax Year 2026

Data provided by LISA DELOZIER County Assessor

Date 04/17/2026

Time 07:47:34

Page 3

Sketch Image

660018312

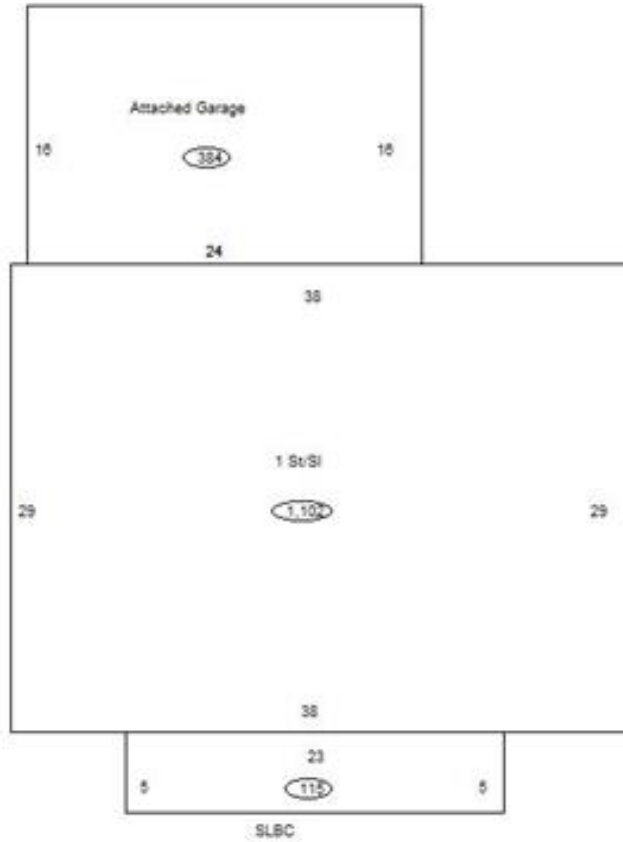

Sketch Vector Information

Sequence	Code	Type	Built Over	Scale	Section Label	Base Area	Multiplier	Total Area
1	R	1	Slab	10	1 St/SI	1,102	1.000	1,102
2	G	1		10	Attached Garage	384	1.000	384
3	M	PRCH		10	SLBC	115	1.000	115
Total Building Area						1,102		1,102



Rogers



Assessment Property Record Card for Tax Year 2026

Data provided by LISA DELOZIER County Assessor

Date 04/17/2026
Time 07:47:34
Page 4

660018312

Outbuildings/Site Improvements

Building Image	Code	Description	Dimensions	Floor	Roofing	Total Units
	CP	CARPORT DIRT	0x0x0			
	Qual	Cond	Year	Eff Age		
	Valuation Summary		Modifier Total	RCN	Depr (100% Phys/ % Func)	RCNLD
	Base Cost (3.50 x)					
	STF	STG FAIR	0x0x0			
	Qual	2 Cond	Year	Eff Age		
	Valuation Summary		Modifier Total	RCN	Depr (100% Phys/ % Func)	RCNLD
	Base Cost (4.68 x)					