



Rogers

Assessment Property Record Card for Tax Year 2026

Data provided by LISA DELOZIER County Assessor

Date 04/16/2026
Time 22:57:09
Page 1

Assessment Data					Primary Image																																																	
Account 660018375 Parcel ID 000000-00-0-10400-007-0004 Cadastral ID 20-21-16-04510 Property Type REAL - Real Property Property Class CNTU VI Area 1 Tax Area 17 - CLAREMORE OT Name ID 11734 HOUSING AUTHORITY OF CHEROKEE NATION PO BOX 1007 TAHLEQUAH OK 74465-1007 Parcel Location Situs 02003 MISSOURI CT Subdivision SOUTH POINTE Lot/Block 0004 / 0007 Parcel Size 1 - Lots Sec/Twn/Rng 20 / 21 / 16 / 5 Neighborhood 1167 - R-V01-SW CLAREMORE School District S001 - CLAREMORE SCHOOLS					<p>\\tsclient\A\TOMMY DUNLAP\New folder (272)\IMG_0021.JPG 9/19/2023</p>																																																	
Legal Description Lat/Long: 36.28991070 -95.61866129																																																						
LOT 4 BLOCK 7 SOUTH POINTE					Building Permits <table border="1"> <thead> <tr> <th>Number</th> <th>Description</th> <th>Opened</th> <th>Closed</th> <th>Amount</th> </tr> </thead> <tbody> <tr><td> </td><td> </td><td> </td><td> </td><td> </td></tr> <tr><td> </td><td> </td><td> </td><td> </td><td> </td></tr> <tr><td> </td><td> </td><td> </td><td> </td><td> </td></tr> <tr><td> </td><td> </td><td> </td><td> </td><td> </td></tr> </tbody> </table>					Number	Description	Opened	Closed	Amount																																								
Number	Description	Opened	Closed	Amount																																																		
Exemptions					Sale History																																																	
Code	Type	Active	Maximum	Exemption	Bk/Pg	Grantor	Date	Price	Code																																													
					961/292		05/26/1994	323,000	No																																													
					909/713	FIRST FEDERAL SAVINGS	03/25/1993	367,500	No																																													
					903/196	SWOPES, GREGORY C &	12/29/1992	0	No																																													
					900/548	FIRST FEDERAL SAVINGS	12/01/1992	8,500	Yes																																													
					900/549	FIRST FEDERAL SAVINGS	12/01/1992	0	No																																													
Parcel Valuation					<table border="1"> <thead> <tr> <th>Source</th> <th>REAL</th> <th>Fair Cash</th> <th>Capped</th> <th>Asmnt Level</th> <th>Assessed</th> <th>Levy Rate</th> <th>92.430</th> <th>Current Tax</th> </tr> </thead> <tbody> <tr> <td>Remove Cap</td> <td>0</td> <td>Land Value 3</td> <td>0</td> <td>11%</td> <td>0</td> <td>Assessed</td> <td>0</td> <td>0.00</td> </tr> <tr> <td>Year Frozen</td> <td>0</td> <td>Improvements 116,515</td> <td>0</td> <td> </td> <td>0</td> <td>Penalty</td> <td>0</td> <td> </td> </tr> <tr> <td>Uncapped Value</td> <td>0</td> <td>Mobile Home 0</td> <td>0</td> <td> </td> <td>0</td> <td>Exemption</td> <td>0</td> <td>0.00</td> </tr> <tr> <td>TIF Project ID</td> <td>0</td> <td>Total Value 116,518</td> <td>0</td> <td> </td> <td>0</td> <td>Total Taxable</td> <td>0</td> <td>0.00</td> </tr> </tbody> </table>					Source	REAL	Fair Cash	Capped	Asmnt Level	Assessed	Levy Rate	92.430	Current Tax	Remove Cap	0	Land Value 3	0	11%	0	Assessed	0	0.00	Year Frozen	0	Improvements 116,515	0		0	Penalty	0		Uncapped Value	0	Mobile Home 0	0		0	Exemption	0	0.00	TIF Project ID	0	Total Value 116,518	0		0	Total Taxable	0	0.00
Source	REAL	Fair Cash	Capped	Asmnt Level	Assessed	Levy Rate	92.430	Current Tax																																														
Remove Cap	0	Land Value 3	0	11%	0	Assessed	0	0.00																																														
Year Frozen	0	Improvements 116,515	0		0	Penalty	0																																															
Uncapped Value	0	Mobile Home 0	0		0	Exemption	0	0.00																																														
TIF Project ID	0	Total Value 116,518	0		0	Total Taxable	0	0.00																																														
Assessment History																																																						
Tax Year	Statement Number	Billed Owner	Tax Area	Total Value	Exemptions	Taxable Value	Billed Tax																																															
2025	2025-660018375	HOUSING AUTHORITY OF	17	117,587	0		.00																																															
2024	2024-660018375	HOUSING AUTHORITY OF	17	124,625	0		.00																																															
2023	2023-660018375	HOUSING AUTHORITY OF	17	115,076	0		.00																																															
2022	2022-660018375	HOUSING AUTHORITY OF	17	110,552	0		.00																																															
2021	2021-660018375	HOUSING AUTHORITY OF	17	110,552	0		.00																																															
2020	2020-660018375	HOUSING AUTHORITY OF	17	108,754	0		.00																																															
2019	2019-660018375	HOUSING AUTHORITY OF	17	108,205	0		.00																																															
2018	2018-660018375	HOUSING AUTHORITY OF	17	111,301	0		.00																																															
2017	2017-660018375	HOUSING AUTHORITY OF	17	110,368	0		.00																																															
2016	2016-660018375	HOUSING AUTHORITY OF	17	105,011	0		.00																																															
2015	2015-660018375	HOUSING AUTHORITY OF	17	105,011	0		.00																																															
2014	2014-660018375	HOUSING AUTHORITY OF	17	105,011	0		.00																																															
2013	2013-660018375	HOUSING AUTHORITY OF	17	99,858	0		.00																																															



Rogers

Assessment Property Record Card for Tax Year 2026

Data provided by LISA DELOZIER County Assessor

Date 04/16/2026
 Time 22:57:10
 Page 2

Lot Data		Square-Foot -	Primary Image	
Lot Size			<p>\\tsclient\A\TOMMY DUNLAP\New folder (272)\IMG_0021.JPG 9/19/2023</p>	
Lot Count				
Units Buildable	1			
Non-Ag Acres	0.144			
Topography				
Street Access				
Utilities				
Amenities	LAND QUALITY			
Method	Square-Foot			
Base Lot Value	6,275.00 x 2.80 = 17,570			
Factor Value			GRM Approach	
Adjustments			GRM Code	
Lot Value	17,570		Gross Rent	0.00
Residential Data			Indicated Value	
Type	1 Single Family Residence		Multiple Regression	
Condition	3 - Average		MRA Code	1 Test
Quality	2 - Fair		Adusted R	0.8445
Architecture			Indicated Value	149,817 106.03 Per SqFt
Style	100% One Story		Direct Comparables	
Exterior Wall	100% Veneer, Masonry		Selection Model	A Adam Test
Base/Total Area	1,413 / 1,413		Adjustment Model	1 2022 Residential
Style	100% One Story		Comparables	8
HVAC	100% Warmed & Cooled Air		Indicated Value	143,590 Per SqFt
Roof Cover	1 Composition Shingle		Value Reconciliation	
Area on Slab	1,413		Selected Approach	Cost Approach
Fixture/RghIn	11 /		Improvements	116,515
Bed/F/H Bath	3 / 2.0 /		Lot Value	17,570
Basement Area			Indicated Value	134,085 94.89 Per SqFt
Garage Type	400 Attached Garage - Unfinished		Agland Value	
Remodel			Site Improvements	
Year/Eff Age	1997 / 22		Total Value	134,085 94.89 Total Value Per SqFt
Cost Approach			Manual : 01/2025	
Base Cost	97.91	Total Misc Impr	+	883
Roofing Adj	+ 4.03	Garage Cost	+	9,944
Subfloor Adj	+ 0.00	Total RCN	=	182,054
Heat/Cool Adj	+ 10.30	Depreciation (36%)	-	65,539
Plumbing Adj	+ 8.94	Lump Sums	+	0
Basement Adj	+ 0.00	RCNLD	=	116,515
Adj Base Cost	= 121.18	Lot Value	+	17,570
Total Area	x 1,413	Indicated Value	=	134,085
Adjusted Cost	= 171,227	Value Per SqFt		94.89

Miscellaneous Improvements							
Code	Description	Sketch ID	Size	Year	Units	Unit Cost	Depr Value
PRCH	SLAB PORCH - COVERED	44576	8x4		32	21.19	678
PATO	SLAB PORCH - OPEN	44577	5x4		20	10.24	205



Rogers

Assessment Property Record Card for Tax Year 2026

Data provided by LISA DELOZIER County Assessor

Date 04/16/2026

Time 22:57:10

Page 3

Sketch Image

660018375

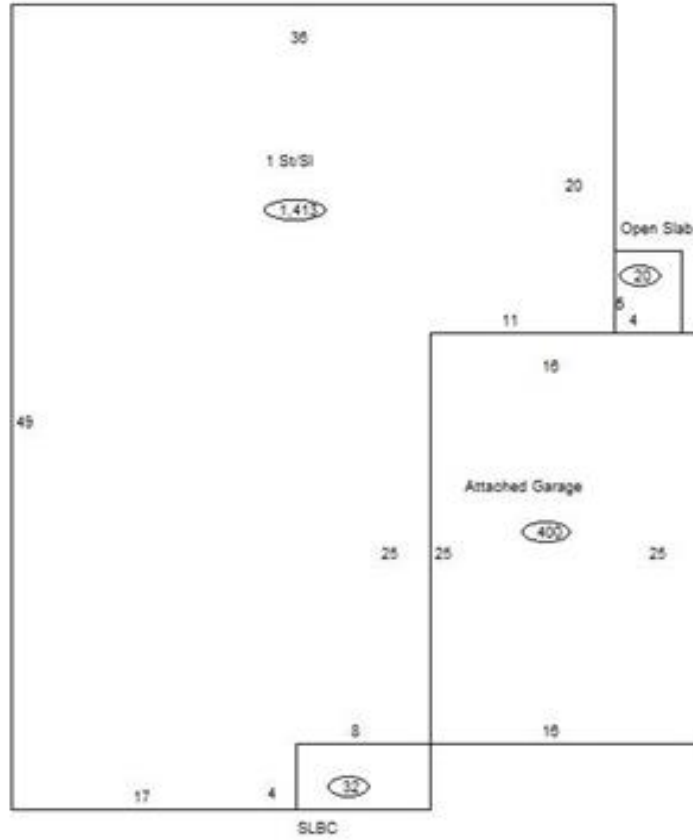

Sketch Vector Information

Sequence	Code	Type	Built Over	Scale	Section Label	Base Area	Multiplier	Total Area
1	R	1	Slab	10	1 St/Sl	1,413	1.000	1,413
2	G	1		10	Attached Garage	400	1.000	400
3	M	PRCH		10	SLBC	32	1.000	32
4	M	PATO		10	Open Slab	20	1.000	20
Total Building Area						1,413		1,413