



Rogers

Assessment Property Record Card for Tax Year 2026

Data provided by LISA DELOZIER County Assessor

Date 04/17/2026
 Time 08:54:24
 Page 1

Assessment Data					Primary Image																																																																																																																				
Account 660018651 Parcel ID 24N17E-20-1-00000-000-0000 Cadastral ID 20-24-17-00700 Property Type REAL - Real Property Property Class RA VI Area 2 Tax Area 14 - CHELSEA RURAL Name ID 292980 CUETO, LORENZO & NORMA 4220 S 4210 RD CHELSEA OK 74016-1757 Parcel Location Situs 04220 S 4210 RD Subdivision Lot/Block / Parcel Size 10 - Acres Sec/Twn/Rng 20 / 24 / 17 / 1 Neighborhood 4050 - CHELSEA FOYIL RURAL School District S003 - CHELSEA SCHOOLS					<p>660018651 06/13/24</p> <p style="text-align: right;">6/13/2024</p>																																																																																																																				
Legal Description Lat/Long: 36.54933477 -95.50858255																																																																																																																									
NE/4 SE/4 NE/4					Building Permits <table border="1"> <thead> <tr> <th>Number</th> <th>Description</th> <th>Opened</th> <th>Closed</th> <th>Amount</th> </tr> </thead> <tbody> <tr> <td> </td> <td> </td> <td> </td> <td> </td> <td> </td> </tr> </tbody> </table>					Number	Description	Opened	Closed	Amount																																																																																																											
Number	Description	Opened	Closed	Amount																																																																																																																					
Exemptions <table border="1"> <thead> <tr> <th>Code</th> <th>Type</th> <th>Active</th> <th>Maximum</th> <th>Exemption</th> </tr> </thead> <tbody> <tr> <td>H</td> <td>Homestead</td> <td>Yes</td> <td>1,000</td> <td>1,000</td> </tr> </tbody> </table>					Code	Type	Active	Maximum	Exemption	H	Homestead	Yes	1,000	1,000	Sale History <table border="1"> <thead> <tr> <th>Bk/Pg</th> <th>Grantor</th> <th>Date</th> <th>Price</th> <th>Code</th> </tr> </thead> <tbody> <tr> <td>1732/356</td> <td>WATTS, MASHELL</td> <td>11/21/2005</td> <td>96,500</td> <td>11</td> </tr> <tr> <td>1704/523</td> <td>MULLINS, LEON C</td> <td>08/22/2005</td> <td>0</td> <td>4</td> </tr> <tr> <td>883/332</td> <td>KELLY PROPERTIES LTD</td> <td>05/29/1992</td> <td>50,000</td> <td>No</td> </tr> </tbody> </table>					Bk/Pg	Grantor	Date	Price	Code	1732/356	WATTS, MASHELL	11/21/2005	96,500	11	1704/523	MULLINS, LEON C	08/22/2005	0	4	883/332	KELLY PROPERTIES LTD	05/29/1992	50,000	No																																																																																		
Code	Type	Active	Maximum	Exemption																																																																																																																					
H	Homestead	Yes	1,000	1,000																																																																																																																					
Bk/Pg	Grantor	Date	Price	Code																																																																																																																					
1732/356	WATTS, MASHELL	11/21/2005	96,500	11																																																																																																																					
1704/523	MULLINS, LEON C	08/22/2005	0	4																																																																																																																					
883/332	KELLY PROPERTIES LTD	05/29/1992	50,000	No																																																																																																																					
Parcel Valuation <table border="1"> <thead> <tr> <th>Source</th> <th>REAL</th> <th>Fair Cash</th> <th>Capped</th> <th>Asmnt Level</th> <th>Assessed</th> <th>Levy Rate</th> <th>82.750</th> <th>Current Tax</th> </tr> </thead> <tbody> <tr> <td>Remove Cap</td> <td>2007</td> <td>Land Value 280</td> <td>280</td> <td>11%</td> <td>31</td> <td>Assessed</td> <td>17,164</td> <td>1,420.32</td> </tr> <tr> <td>Year Frozen</td> <td>0</td> <td>Improvements 173,233</td> <td>155,757</td> <td></td> <td>17,133</td> <td>Penalty</td> <td>0</td> <td></td> </tr> <tr> <td>Uncapped Value</td> <td>25,738</td> <td>Mobile Home 0</td> <td>0</td> <td></td> <td>0</td> <td>Exemption</td> <td>1,000</td> <td>-82.00</td> </tr> <tr> <td>TIF Project ID</td> <td>0</td> <td>Total Value 173,513</td> <td>156,037</td> <td></td> <td>17,164</td> <td>Total Taxable</td> <td>16,164</td> <td>1,338.00</td> </tr> </tbody> </table>										Source	REAL	Fair Cash	Capped	Asmnt Level	Assessed	Levy Rate	82.750	Current Tax	Remove Cap	2007	Land Value 280	280	11%	31	Assessed	17,164	1,420.32	Year Frozen	0	Improvements 173,233	155,757		17,133	Penalty	0		Uncapped Value	25,738	Mobile Home 0	0		0	Exemption	1,000	-82.00	TIF Project ID	0	Total Value 173,513	156,037		17,164	Total Taxable	16,164	1,338.00																																																																			
Source	REAL	Fair Cash	Capped	Asmnt Level	Assessed	Levy Rate	82.750	Current Tax																																																																																																																	
Remove Cap	2007	Land Value 280	280	11%	31	Assessed	17,164	1,420.32																																																																																																																	
Year Frozen	0	Improvements 173,233	155,757		17,133	Penalty	0																																																																																																																		
Uncapped Value	25,738	Mobile Home 0	0		0	Exemption	1,000	-82.00																																																																																																																	
TIF Project ID	0	Total Value 173,513	156,037		17,164	Total Taxable	16,164	1,338.00																																																																																																																	
Assessment History <table border="1"> <thead> <tr> <th>Tax Year</th> <th>Statement Number</th> <th>Billed Owner</th> <th>Tax Area</th> <th>Total Value</th> <th>Exemptions</th> <th>Taxable Value</th> <th>Billed Tax</th> </tr> </thead> <tbody> <tr><td>2025</td><td>2025-660018651</td><td>CUETO, LORENZO & NORMA</td><td>14</td><td>133,342</td><td>1000</td><td>12,916</td><td>1,069.00</td></tr> <tr><td>2024</td><td>2024-660018651</td><td>CUETO, LORENZO & NORMA</td><td>14</td><td>137,401</td><td>1000</td><td>12,511</td><td>1,056.00</td></tr> <tr><td>2023</td><td>2023-660018651</td><td>CUETO, LORENZO & NORMA</td><td>14</td><td>119,243</td><td>1000</td><td>12,117</td><td>1,033.00</td></tr> <tr><td>2022</td><td>2022-660018651</td><td>CUETO, LORENZO & NORMA</td><td>14</td><td>117,588</td><td>1000</td><td>11,872</td><td>1,004.00</td></tr> <tr><td>2021</td><td>2021-660018651</td><td>CUETO, LORENZO & NORMA</td><td>14</td><td>113,612</td><td>1000</td><td>11,498</td><td>975.00</td></tr> <tr><td>2020</td><td>2020-660018651</td><td>CUETO, LORENZO & NORMA</td><td>14</td><td>110,421</td><td>1000</td><td>11,147</td><td>945.00</td></tr> <tr><td>2019</td><td>2019-660018651</td><td>CUETO, LORENZO & NORMA</td><td>14</td><td>109,742</td><td>1000</td><td>11,072</td><td>951.00</td></tr> <tr><td>2018</td><td>2018-660018651</td><td>CUETO, LORENZO & NORMA</td><td>14</td><td>116,348</td><td>1000</td><td>11,798</td><td>1,008.00</td></tr> <tr><td>2017</td><td>2017-660018651</td><td>CUETO, LORENZO & NORMA</td><td>14</td><td>115,379</td><td>1000</td><td>11,692</td><td>1,003.00</td></tr> <tr><td>2016</td><td>2016-660018651</td><td>CUETO, LORENZO & NORMA</td><td>14</td><td>112,533</td><td>1000</td><td>11,326</td><td>987.00</td></tr> <tr><td>2015</td><td>2015-660018651</td><td>CUETO, LORENZO & NORMA</td><td>14</td><td>108,792</td><td>1000</td><td>10,967</td><td>945.00</td></tr> <tr><td>2014</td><td>2014-660018651</td><td>CUETO, LORENZO & NORMA</td><td>14</td><td>110,005</td><td>1000</td><td>11,101</td><td>989.00</td></tr> <tr><td>2013</td><td>2013-660018651</td><td>CUETO, LORENZO & NORMA</td><td>14</td><td>107,154</td><td>1000</td><td>10,787</td><td>957.00</td></tr> </tbody> </table>										Tax Year	Statement Number	Billed Owner	Tax Area	Total Value	Exemptions	Taxable Value	Billed Tax	2025	2025-660018651	CUETO, LORENZO & NORMA	14	133,342	1000	12,916	1,069.00	2024	2024-660018651	CUETO, LORENZO & NORMA	14	137,401	1000	12,511	1,056.00	2023	2023-660018651	CUETO, LORENZO & NORMA	14	119,243	1000	12,117	1,033.00	2022	2022-660018651	CUETO, LORENZO & NORMA	14	117,588	1000	11,872	1,004.00	2021	2021-660018651	CUETO, LORENZO & NORMA	14	113,612	1000	11,498	975.00	2020	2020-660018651	CUETO, LORENZO & NORMA	14	110,421	1000	11,147	945.00	2019	2019-660018651	CUETO, LORENZO & NORMA	14	109,742	1000	11,072	951.00	2018	2018-660018651	CUETO, LORENZO & NORMA	14	116,348	1000	11,798	1,008.00	2017	2017-660018651	CUETO, LORENZO & NORMA	14	115,379	1000	11,692	1,003.00	2016	2016-660018651	CUETO, LORENZO & NORMA	14	112,533	1000	11,326	987.00	2015	2015-660018651	CUETO, LORENZO & NORMA	14	108,792	1000	10,967	945.00	2014	2014-660018651	CUETO, LORENZO & NORMA	14	110,005	1000	11,101	989.00	2013	2013-660018651	CUETO, LORENZO & NORMA	14	107,154	1000	10,787	957.00
Tax Year	Statement Number	Billed Owner	Tax Area	Total Value	Exemptions	Taxable Value	Billed Tax																																																																																																																		
2025	2025-660018651	CUETO, LORENZO & NORMA	14	133,342	1000	12,916	1,069.00																																																																																																																		
2024	2024-660018651	CUETO, LORENZO & NORMA	14	137,401	1000	12,511	1,056.00																																																																																																																		
2023	2023-660018651	CUETO, LORENZO & NORMA	14	119,243	1000	12,117	1,033.00																																																																																																																		
2022	2022-660018651	CUETO, LORENZO & NORMA	14	117,588	1000	11,872	1,004.00																																																																																																																		
2021	2021-660018651	CUETO, LORENZO & NORMA	14	113,612	1000	11,498	975.00																																																																																																																		
2020	2020-660018651	CUETO, LORENZO & NORMA	14	110,421	1000	11,147	945.00																																																																																																																		
2019	2019-660018651	CUETO, LORENZO & NORMA	14	109,742	1000	11,072	951.00																																																																																																																		
2018	2018-660018651	CUETO, LORENZO & NORMA	14	116,348	1000	11,798	1,008.00																																																																																																																		
2017	2017-660018651	CUETO, LORENZO & NORMA	14	115,379	1000	11,692	1,003.00																																																																																																																		
2016	2016-660018651	CUETO, LORENZO & NORMA	14	112,533	1000	11,326	987.00																																																																																																																		
2015	2015-660018651	CUETO, LORENZO & NORMA	14	108,792	1000	10,967	945.00																																																																																																																		
2014	2014-660018651	CUETO, LORENZO & NORMA	14	110,005	1000	11,101	989.00																																																																																																																		
2013	2013-660018651	CUETO, LORENZO & NORMA	14	107,154	1000	10,787	957.00																																																																																																																		



Rogers

Assessment Property Record Card for Tax Year 2026

Data provided by LISA DELOZIER County Assessor

Date 04/17/2026
 Time 08:54:24
 Page 2

Units Buildable - CHELSEA FOYIL RURAL (UNITS BUILDABLE)	
Lot Size	
Lot Count	
Units Buildable	
Non-Ag Acres	0
Topography	
Street Access	
Utilities	
Amenities	LAND QUALITY
Method	Units-Buildable
Base Lot Value	
Factor Value	
Adjustments	
Lot Value	



Residential Data	
Type	1 Single Family Residence
Condition	3 - Average
Quality	2 - Fair
Architecture	
Style	100% One Story
Exterior Wall	100% Veneer, Masonry
Base/Total Area	1,848 / 1,848
Style	100% One Story
HVAC	100% Warmed & Cooled Air
Roof Cover	1 Composition Shingle
Area on Slab	1,848
Fixture/RghIn	4 /
Bed/F/H Bath	3 / 1.0 /
Basement Area	
Garage Type	704 Attached Garage - Unfinished
Remodel	
Year/Eff Age	1965 / 46

GRM Approach	
GRM Code	
Gross Rent	0.00
Indicated Value	

Multiple Regression	
MRA Code	
Adjusted R	
Indicated Value	

Direct Comparables	
Selection Model	1 Res
Adjustment Model	A2 AO Test
Comparables	
Indicated Value	

Cost Approach		Manual : 01/2025	
Base Cost	89.16	Total Misc Impr	+ 9,685
Roofing Adj	+ 3.73	Garage Cost	+ 15,096
Subfloor Adj	+ 0.00	Total RCN	= 220,004
Heat/Cool Adj	+ 10.09	Depreciation (55%)	- 121,002
Plumbing Adj	+ 2.66	Lump Sums	+ 0
Basement Adj	+ 0.00	RCNLD	= 99,002
Adj Base Cost	= 105.64	Lot Value	+ 99,002
Total Area	x 1,848	Indicated Value	= 99,002
Adjusted Cost	= 195,223	Value Per SqFt	53.57

Value Reconciliation			
Selected Approach	Cost Approach		
Improvements	99,002		
Lot Value			
Indicated Value	99,002	53.57	Per SqFt
Agland Value	280		
Site Improvements	74,231		
Total Value	173,513	93.89	Total Value Per SqFt

Miscellaneous Improvements								
Code	Description	Sketch ID	Size	Year	Units	Unit Cost	Depr	Value
PRCH	SLAB PORCH - COVERED	45349	120		120	20.50		2,460
PRCH	SLAB PORCH - COVERED	45350	26x14		364	19.85		7,225



Rogers
Assessment Property Record Card for Tax Year 2026
 Data provided by LISA DELOZIER County Assessor

Date 04/17/2026
 Time 08:54:25
 Page 3

Sketch Image

660018651

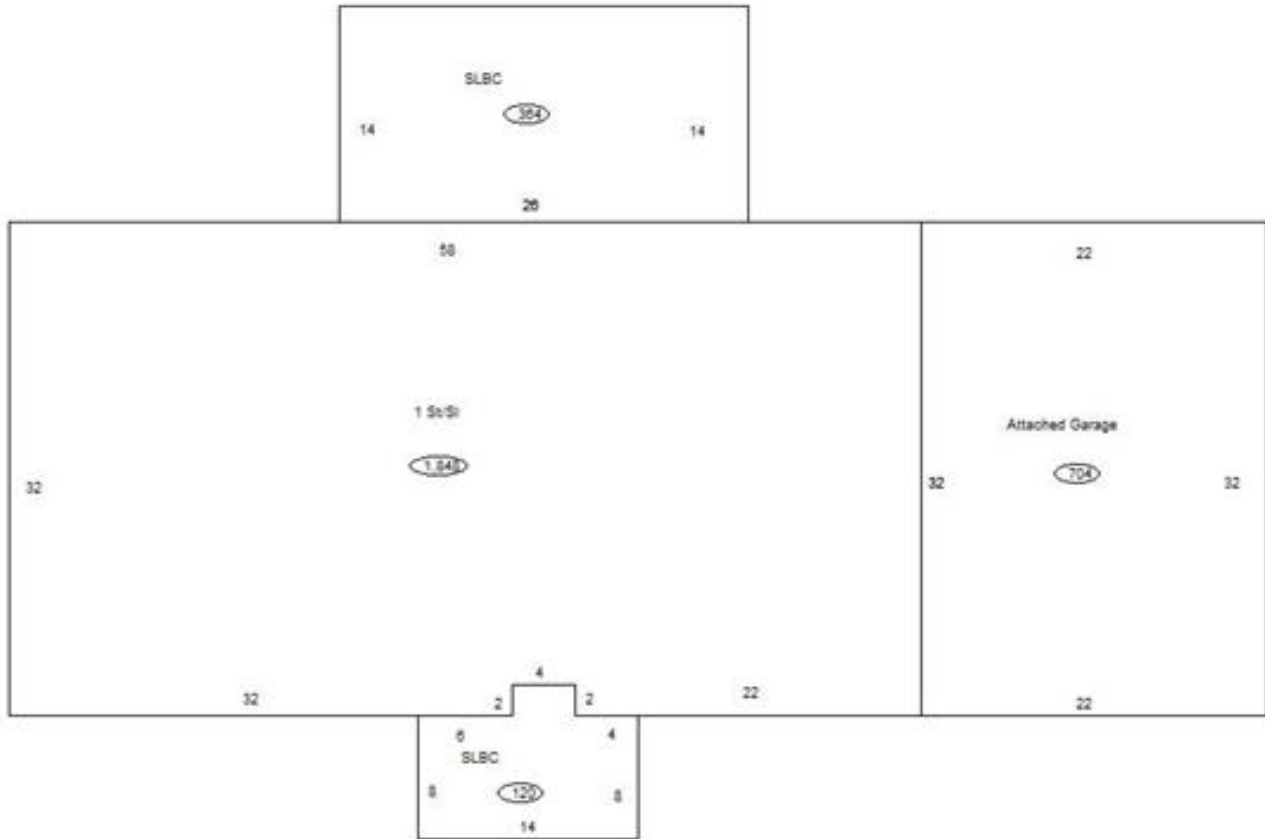

Sketch Vector Information

Sequence	Code	Type	Built Over	Scale	Section Label	Base Area	Multiplier	Total Area
1	R	1	Slab	10	1 St/SI	1,848	1.000	1,848
2	G	1		10	Attached Garage	704	1.000	704
3	M	PRCH		10	SLBC	120	1.000	120
4	M	PRCH		10	SLBC	364	1.000	364
Total Building Area						1,848		1,848



Rogers

Assessment Property Record Card for Tax Year 2026

Data provided by LISA DELOZIER County Assessor

Date 04/17/2026
Time 08:54:25
Page 4

660018651

Outbuildings/Site Improvements

Building Image	Code	Description	Dimensions	Floor	Roofing	Total Units
	BARN	Barn	82x32x12	Dirt		2,624
	Qual	2	Cond 2	Year	2023	Eff Age 3
	Valuation Summary		Modifier Total	RCN	Depr (11% Phys/ % Func)	
Base Cost (7.90 x 2,624)		20,730		20,730	2,280	18,450
	LNT0	Lean To - Attached	80x16x12	Dirt	Formed Metal	1,280
	Qual	2	Cond 2	Year	2023	Eff Age 3
	Valuation Summary		Modifier Total	RCN	Depr (19% Phys/ % Func)	
Base Cost (7.03 x 1,280)		8,998		8,998	1,710	7,288
	UTIL	SHOP BUILDING	32x70x0			2,240
	Qual	2	Cond 3	Year	2013	Eff Age 10
	Valuation Summary		Modifier Total	RCN	Depr (20% Phys/ % Func)	
Base Cost (25.15 x 2,240)		56,336		56,336	11,267	45,069
	LNT0	Lean - To	10x24x0	Base		240
	Qual	3	Cond 3	Year		Eff Age 1520
	Valuation Summary		Modifier Total	RCN	Depr (0% Phys/ % Func)	
Base Cost (8.64 x 240)		2,074		2,074		2,074
	LF	LOAFING SHED	16x22x0			352
	Qual	2	Cond 3	Year		Eff Age
	Valuation Summary		Modifier Total	RCN	Depr (10% Phys/ % Func)	
Base Cost (4.26 x 352)		1,500		1,500	150	1,350
	SHDS	Shed - Small	0x0x0	Base		
	Qual	3	Cond	Year		Eff Age
	Valuation Summary		Modifier Total	RCN	Depr (100% Phys/ % Func)	
Base Cost (39.31 x)						



Rogers

Assessment Property Record Card for Tax Year 2026

Data provided by LISA DELOZIER County Assessor

Date 04/17/2026
Time 08:54:25
Page 5

Agland Inventory

660018651

Soi	Description	Land Use	LPI	Adj Type	Adj Code	Acres	Use/Acre	Mkt/Acre	Use Value	Market Value
SM	STRIP MINES	IMP PST	10		0	10.000	28	28	280	280
IMP PST Totals						10.000			280	280
Total Agland						10.000			280	280